

13260

RACCORDO A L INTERMEDIO

ELBOW CONNECTOR
WINKELVERSCHRAUBUNG
RACCORD EQUERRE
RACOR A L INTERMEDIO
CONEXÃO EM "L" TUBO-TUBO

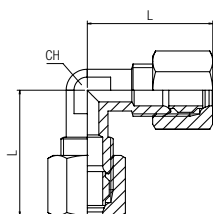

Code	Tube	L	CH	Pack.
13260 00 001	4	21.5	8	10
13260 00 002	6	24	9	10
13260 00 003	8	30	11	10
13260 00 004	10	33	13	10
13260 00 005	12	36	14	10
13260 00 006	14	37	17	10
13260 00 007	15	38	17	10
13260 00 008	16	39.5	17	10
13260 00 009	18	41.5	20	10
13260 00 010	22	44.5	27	10

13280

RACCORDO A L MASCHIO

ELBOW MALE ADAPTOR
WINKELVERSCHRAUBUNG KONISCH
EQUERRE MÂLE, CONIQUE
RACOR A L MACHO
CONEXÃO EM "L" COM ROSCA MACHO

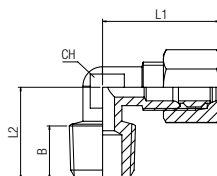

Code	Tube	A	L1	L2	CH	Pack.
13280 00 001	4	1/8	21.5	15	8	10
13280 00 002	6	1/8	24	17	9	10
13280 00 003	6	1/4	24	19	9	10
13280 00 004	8	1/8	30	18	11	10
13280 00 005	8	1/4	30	21.5	11	10
13280 00 006	8	3/8	30.5	24	13	10
13280 00 007	10	1/4	33	23.5	13	10
13280 00 008	10	3/8	33	24.5	13	10
13280 00 009	10	1/2	35	25	14	10
13280 00 010	12	1/4	36	24	14	10
13280 00 011	12	3/8	36	26	14	10
13280 00 012	12	1/2	36	25	14	10
13280 00 013	14	3/8	39	26	17	10
13280 00 014	14	1/2	39	28.5	17	10
13280 00 015	15	1/2	39	28.5	17	10
13280 00 016	16	1/2	40	28	17	10
13280 00 017	18	1/2	41.5	29.5	20	10
13280 00 018	18	3/4	41.5	32	20	10
13280 00 019	22	3/4	44.5	34	27	10

13290

RACCORDO A L FEMMINA

ELBOW FEMALE ADAPTOR
WINKELVERSCHRAUBUNG INNENGEWINDE
EQUERRE FEMELLE
RACOR A L HEMBRA
CONEXÃO EM "L" COM ROSCA FÊMEA

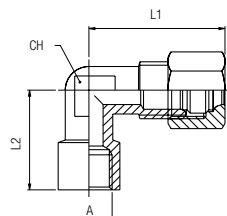

Code	Tube	A	L1	L2	CH	Pack.
13290 00 001	4	1/8	23	18	8	10
13290 00 002	6	1/8	24	18	9	10
13290 00 003	6	1/4	24.5	22.5	11	10
13290 00 004	8	1/8	30	21	11	10
13290 00 005	8	1/4	30.5	25.5	13	10
13290 00 006	8	3/8	31	25	14	10
13290 00 007	10	1/4	34	25	13	10
13290 00 008	10	3/8	34	25	14	10
13290 00 009	10	1/2	34	27	15	10
13290 00 010	12	1/4	36	26	14	10
13290 00 011	12	3/8	36	26	14	10
13290 00 012	12	1/2	36	27	15	10
13290 00 013	14	1/2	39	30	18	10
13290 00 014	15	1/2	39	30	18	10
13290 00 015	16	1/2	41.5	30	18	10
13290 00 016	18	1/2	41.5	29	20	10
13290 00 017	18	3/4	44.5	33.5	20	10

13300

RACCORDO A L ORIENTABILE MASCHIO

ORIENTING ELBOW MALE ADAPTOR
 WINKELVERSCHRAUBUNG (DREHBAR)
 EQUERRE ORIENTABLE MÂLE
 RACOR A L ORIENTABLE MACHO
 CONEXÃO MACHO EM "L" ORIENTÁVEL

New

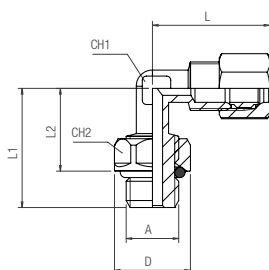

Code	Tube	A	L	L1	L2	D	CH1	CH2	Pack.
13300 00 001	4	1/8	23	22,5	15,5	15	9	14	10
13300 00 002	4	1/4	23	30	19	19	9	17	10
13300 00 003	6	1/8	24,5	23	15,5	15	9	14	10
13300 00 004	6	1/4	24	21	19	19	9	17	10
13300 00 005	8	1/8	29	23	15,5	15	9	14	10
13300 00 006	8	1/4	29	29,5	19	19	9	17	10
13300 00 007	8	3/8	29,5	30,5	19	22	13	20	10
13300 00 008	10	1/4	32,5	30	19	19	13	17	10
13300 00 009	10	3/8	32,5	30,5	19	22	13	20	10
13300 00 010	10	1/2	33,5	39	24	25	17	23	10
13300 00 011	14	3/8	38,5	33,5	19	22	17	20	10
13300 00 012	14	1/2	38,5	39	24	25	17	23	10
13300 00 013	18	1/2	41,5	39,5	24	25	20	23	10
13300 00 014	18	3/4	41,5	42	25,5	32	20	30	10
13300 00 015	22	3/4	44,5	50	25,5	32	20	30	10
13300 00 016	22	1"	44,5	54	35	44	27	41	10

	Temperature	min	max
		- 20 °C	+ 80 °C

13460

RACCORDO DIRITTO INTERMEDIO

STRAIGHT CONNECTOR
 VERBINDUNGSVERSCHRAUBUNG
 RACCORD UNION DOUBLE
 RACOR RECTO INTERMEDIO
 CONEXÃO RETA TUBO-TUBO

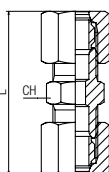

Code	Tube	L	CH	Pack.
13460 00 001	4	33	10	10
13460 00 002	6	36	11	10
13460 00 003	8	40	13	10
13460 00 004	10	45,5	16	10
13460 00 005	12	47	18	10
13460 00 006	14	47,5	21	10
13460 00 007	15	52	21	10
13460 00 008	16	52,5	22	10
13460 00 009	18	56	26	10
13460 00 010	22	58,5	30	10

13465

RACCORDO INTERMEDIO DI ATTRAVERSAMENTO

BULKHEAD CONNECTOR
 SCHOTTVERSCHRAUBUNG
 RACCORD DROIT TRAVERSÉE DE CLOISON
 RACOR INTERMEDIO PASATABIQUES
 CONEXÃO PASSAMURO TUBO-TUBO

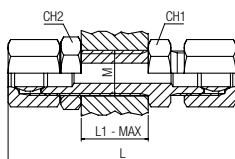

Code	Tube	L	L max	CH1	CH2	M	Pack.
13465 00 001	4	49	12	10	13	M8x1	10
13465 00 002	6	52,5	12,5	13	14	M10x1	10
13465 00 003	8	56,5	12,5	14	17	M12x1	10
13465 00 004	10	63,5	13	19	22	M16x1,5	10
13465 00 005	12	70,5	17	22	22	M18x1,5	10
13465 00 006	14	72,5	19	24	24	M20x1,5	10

13480

RACCORDO DIRITTO MASCHIO CONICO

STRAIGHT MALE ADAPTOR (TAPER)
 GERADE EINSCHRAUBVERSCHRAUBUNG KONISCH
 RACCORD DROIT MÂLE CONIQUE
 RACOR RECTO MACHO CÔNICO
 CONEXÃO RETA COM ROSCA MACHO CÔNICA

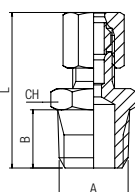

Code	Tube	A	L	CH	Pack.
13480 00 001	4	1/8	26,5	11	10
13480 00 002	4	1/4	29,5	14	10
13480 00 003	6	1/8	28	11	10
13480 00 004	6	1/4	31,5	14	10
13480 00 005	6	3/8	32	17	10
13480 00 006	8	1/8	30	13	10
13480 00 007	8	1/4	33,5	14	10
13480 00 008	8	3/8	34	17	10
13480 00 009	10	1/4	36	16	10
13480 00 010	10	3/8	36,5	17	10
13480 00 011	10	1/2	38	21	10
13480 00 012	12	1/4	37	18	10
13480 00 013	12	3/8	37,5	18	10
13480 00 014	12	1/2	39	21	10
13480 00 015	14	3/8	37,5	20	10
13480 00 016	14	1/2	40	21	10
13480 00 017	15	1/2	40	21	10
13480 00 018	16	1/2	42,5	22	10
13480 00 019	16	3/4	44	27	10
13480 00 020	18	1/2	43,5	24	10
13480 00 021	18	3/4	45	27	10
13480 00 022	22	1/2	46	30	10
13480 00 023	22	3/4	47,5	30	10

13483**New****RACCORDO DIRITTO MASCHIO CILINDRICO CON OR**

STRAIGHT MALE ADAPTOR WITH OR (PARALLEL)

EINSCHRAUBVERSCHRAUBUNG ZYLINDRISCH MIT OR

RACCORD DROIT AVEC JOINT TORIQUE MALE CYLINDRIQUE

RACOR RECTO MACHO CILÍNDRICO CON TÓRICA

CONEXÃO RETA COM ROSCA MACHO PARALELA COM O-RING

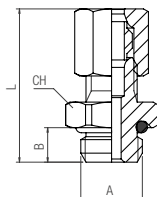

Code	Tube	A	L	B	CH	Pack.
13483 00 001	4	1/8	24	5,5	13	10
13483 00 002	6	1/8	25	5,5	13	10
13483 00 003	6	1/4	27,5	8	16	10
13483 00 004	8	1/8	27	5,5	13	10
13483 00 005	8	1/4	29,5	8	16	10
13483 00 006	8	3/8	30,5	8	20	10
13483 00 007	10	1/4	32	8	16	10
13483 00 008	10	3/8	32,5	8	20	10
13483 00 027	12	1/4	33,5	8	18	10
13483 00 028	12	3/8	33	8	20	10
13483 00 029	12	1/2	36	9,5	25	10
13483 00 009	14	3/8	34	8	22	10
13483 00 010	14	1/2	36,5	9,5	25	10
13483 00 030	15	3/8	34	8	22	10
13483 00 025	15	1/2	37	9,5	25	10
13483 00 031	16	3/8	37	8	22	10
13483 00 032	16	1/2	39,5	9,5	25	10
13483 00 033	18	1/2	40,5	9,5	25	10
13483 00 034	18	3/4	45	11	34	10
13483 00 011	22	3/4	48	11	34	10
13483 00 012	22	1"	48,5	12	40	10

min

max



Temperature

- 20 °C

+ 80 °C

13485**RACCORDO DIRITTO MASCHIO CILINDRICO**

STRAIGHT MALE ADAPTOR (PARALLEL)

GERADE EINSCHRAUBVERSCHRAUBUNG ZYLINDRISCH

RACCORD DROIT MÂLE CYLINDRIQUE

RACOR RECTO MACHO CILÍNDRICO

CONEXÃO RETA COM ROSCA MACHO PARALELA

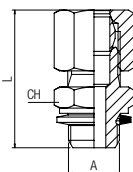

Code	Tube	A	L	CH	Pack.
13485 00 001	4	1/8	26	13	10
13485 00 002	6	1/8	27	13	10
13485 00 003	6	1/4	30,5	17	10
13485 00 004	8	1/8	30	13	10
13485 00 005	8	1/4	32,5	17	10
13485 00 006	8	3/8	36,5	22	10
13485 00 007	10	1/4	35	17	10
13485 00 008	10	3/8	39	22	10
13485 00 009	14	3/8	40	22	10
13485 00 010	14	1/2	42	27	10
13485 00 011	22	3/4	49	32	10
13485 00 012	22	1"	52	40	10

min

max



Temperature

- 20 °C

+ 80 °C

13500

RACCORDO DIRITTO FEMMINA
 STRAIGHT FEMALE ADAPTOR
 AUFSCHRAUBVERSCHRAUBUNG
 RACCORD DROIT TARAUEE
 RACOR RECTO HEMBRA
 CONEXÃO RETA COM ROSCA FÊMEA

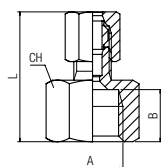

Code	Tube	A	L	CH	Pack.
13500 00 001	4	1/8	25	14	10
13500 00 002	4	1/4	27.5	17	10
13500 00 003	6	1/8	26	14	10
13500 00 004	6	1/4	28.5	17	10
13500 00 005	8	1/8	28	14	10
13500 00 006	8	1/4	30.5	17	10
13500 00 007	8	3/8	31.5	20	10
13500 00 008	10	1/4	33	17	10
13500 00 009	10	3/8	33.5	20	10
13500 00 010	10	1/2	35.5	24	10
13500 00 011	12	1/4	34	18	10
13500 00 012	12	3/8	34.5	20	10
13500 00 013	12	1/2	34	24	10
13500 00 014	14	3/8	36.5	20	10
13500 00 015	14	1/2	34	24	10
13500 00 016	15	1/2	36.5	24	10
13500 00 017	16	1/2	39	24	10
13500 00 018	16	3/4	40.5	30	10
13500 00 019	18	1/2	40	24	10
13500 00 020	18	3/4	41.5	30	10
13500 00 021	22	3/4	41.5	30	10

13510

RACCORDO A CROCE
 EQUAL CROSS
 KREUZVERSCHRAUBUNG
 RACCORD EN CROIX
 RACOR A CRUZ
 CONEXÃO TIPO CRUZETA TUBO-TUBO

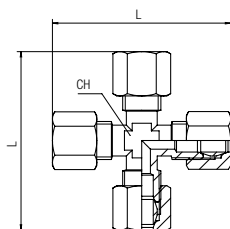

Code	Tube	L	CH	Pack.
13510 00 001	4	47	8	10
13510 00 002	6	48	9	10
13510 00 003	8	58	11	10
13510 00 004	10	66	13	10
13510 00 005	12	74.5	17	10
13510 00 006	14	74.5	17	10

13530

ADATTATORE ORIENTABILE MASCHIO CILINDRICO
 ORIENTING MALE ADAPTOR PARALLEL
 EINSCHRAUBSTECKVERSCHRAUBUNG ZYLINDRISCH
 ADAPTATEUR D'ORIENTATION CYLINDRIQUE
 ADAPTADOR ORIENTABLE MACHO CILÍNDRICO
 ADAPTADOR ORIENTÁVEL COM ROSCA MACHO PARALELA

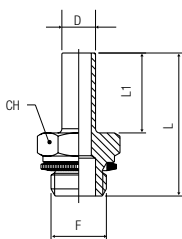

Code	D	F	L	L1	CH	Pack.
13530 00 001	6	1/8	27.5	16	13	10
13530 00 002	6	1/4	31	16	17	10
13530 00 003	8	1/8	31.5	19	13	10
13530 00 004	8	1/4	34	19	17	10
13530 00 005	8	3/8	38	19	22	10
13530 00 006	10	1/4	35	20	17	10
13530 00 007	10	3/8	39	20	22	10
13530 00 008	14	3/8	40	21	22	10
13530 00 009	14	1/2	42	21	27	10



Temperature

min - 20 °C
 max + 80 °C