

IDLER SPROCKETS WITH BALL BEARING



IDLER SPROCKETS WITH BALL BEARING



IDLER SPROCKETS WITH BALL BEARING

Description

Idler sprockets are manufactured to internationally recognised standards DIN8187-ISO/R 606 and are produced from C45 steel UNI EN 10083-1 having a minimum strength of 600 N/mm². Conveniently stocked with an integral ball bearing fitted (dimension 'D' for bore size).

Available from stock to suit British standard roller chains from 05B (8mm pitch) up to 20B (1-1/4" pitch) sizes in Simplex (single) row of teeth.

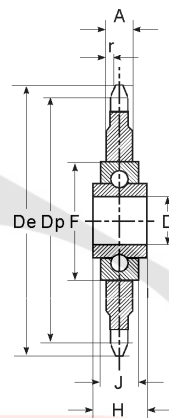

05B-1 TO 20B-1

Teeth	De	Dp	Part No.	Chain Type	B1	A	D	F	H	J
23	62.00	58.75	PW105B/23 IDLER	05B-1 8x1/8"	2.8	7	16 +0.13 +0.26	40	18.3	12
21	68.00	63.91	3SR21-IDLER	0B6-1 3/8"x7/32"	5.3	7	16 +0.13 +0.26	40	18.3	12
18	78.90	73.14	PW081/18 IDLER	081-1 1/2"x1/8"	3	7	16 +0.13 +0.26	40	18.3	12
18	78.90	73.14	PW083/18 IDLER	083-1 1/2"x3/16"	4.5	7	16 +0.13 +0.26	40	18.3	12
16	69.50	65.10	4SR16-IDLER	08B-1 1/2"x5/16"	7.2	7.2	16 +0.13 +0.26	40	18.3	12
18	77.80	73.14	4SR18-IDLER	08B-1 1/2"x5/16"	7.2	7.2	16 +0.13 +0.26	40	18.3	12
14	78.00	71.34	5SR14-IDLER	10B-1 5/8"x3/8"	9.1	9.1	16 +0.13 +0.26	40	18.3	12
15	83.00	76.36	5SR15-IDLER	10B-1 5/8"x3/8"	9.1	9.1	16 +0.13 +0.26	40	18.3	12
17	3.00	86.30	5SR17-IDLER	10B-1 5/8"x3/8"	9.1	9.1	16 +0.13 +0.26	40	18.3	12
13	87.50	79.59	6SR13-IDLER	12B-1 3/4"x7/16"	11.1	11.1	16 +0.13 +0.26	40	18.3	12
15	99.80	91.63	6SR15-IDLER	12B-1 3/4"x7/16"	11.1	11.1	16 +0.13 +0.26	40	18.3	12
12	109.00	98.14	8SR12-IDLER	16B-1 1"x17.02	16.2	16.2	20 +0.00 +0.01	47	17.7	14
13	147.80	132.65	10SR13-IDLER	20B-1 1"1/4x3/4"	18.5	18.5	25 +0.00 +0.01	52	21	15