



**RODAVIGO, S.A.**  
RODAMIENTOS VIGO, S.A.

[www.rodavigo.net](http://www.rodavigo.net)

**+34 986 288118**  
Servicio de Att. al Cliente

**FYH**

# **15 Dimensional Tables for Ball Bearing Units**



**15 Dimensional Tables for Ball Bearing Units (contents)**

**1 Pillow Block Units**

**Pillow Block Units**

UCP ( <i>d</i> 12 ~ 140) .....	82
NAP ( <i>d</i> 12 ~ 75) .....	88
NAP-E ( <i>d</i> 1 3/16 ~ 2 15/16) .....	90
NAPK ( <i>d</i> 12 ~ 75) .....	92
NCP ( <i>d</i> 20 ~ 60) .....	94
UKP ( <i>d</i> <sub>1</sub> 20 ~ 125) .....	96

**Thick Pillow Block Units**

UCIP ( <i>d</i> 40 ~ 140) .....	102
UKIP ( <i>d</i> <sub>1</sub> 35 ~ 125) .....	104

**Tapped-Base Pillow Block Units**

UCPA ( <i>d</i> 12 ~ 50) .....	106
UCPAN ( <i>d</i> 20 ~ 35) .....	108
NCPA ( <i>d</i> 20 ~ 50) .....	110
NCPAN ( <i>d</i> 20 ~ 35) .....	112

**High-Base Pillow Block Units**

UCPH ( <i>d</i> 12 ~ 50) .....	114
--------------------------------	-----

**Narrow Inner Ring Bearing Pillow Block Units**

SBP-RKP8 ( <i>d</i> 20 ~ 40) .....	116
SAP-FP9 ( <i>d</i> 20 ~ 55) .....	116
SBPAN-RKP8 ( <i>d</i> 20 ~ 35) .....	118
SAPAN-FP9 ( <i>d</i> 20 ~ 35) .....	118

**Light Pillow Block Units**

BLP ( <i>d</i> 12 ~ 40) .....	120
ALP ( <i>d</i> 12 ~ 40) .....	120

**Compact Pillow Block Units**

UP ( <i>d</i> 10 ~ 30) .....	122
------------------------------	-----

**Corrosion Resistant Series Pillow Block Units**

UCSP-H1S6 ( <i>d</i> 12 ~ 60) .....	124
UCSPA-H1S6 ( <i>d</i> 12 ~ 40) .....	126
USP-S6 ( <i>d</i> 10 ~ 30) .....	128
UCVP-S6 ( <i>d</i> 20 ~ 50) .....	130
UCVP-ES7 ( <i>d</i> 20 ~ 50) .....	132
UCVPAN-ES7 ( <i>d</i> 20 ~ 35) .....	134

**Stamped Steel Pillow Block Units**

SBPP ( <i>d</i> 12 ~ 30) .....	136
SAPP ( <i>d</i> 12 ~ 30) .....	136

**2 4-Bolt Flange Units**

**4-Bolt Flange Units**

UCF ( <i>d</i> 12 ~ 140) .....	138
UCF-E ( <i>d</i> 12 ~ 85) .....	144
NANF ( <i>d</i> 12 ~ 60) .....	148
NCF ( <i>d</i> 20 ~ 60) .....	150
NCF-E ( <i>d</i> 20 ~ 60) .....	152
UKF ( <i>d</i> <sub>1</sub> 20 ~ 125) .....	154

**Square Piloted 4-Bolt Flange Units**

UCFS ( <i>d</i> 25 ~ 140) .....	160
UKFS ( <i>d</i> <sub>1</sub> 20 ~ 125) .....	162

**Narrow Inner Ring Bearing 4-Bolt Flange Units**

SBF-RKP8 ( <i>d</i> 20 ~ 40) .....	164
SAF-FP9 ( <i>d</i> 20 ~ 55) .....	164

**Corrosion Resistant Series 4-Bolt Flange Units**

UCSF-H1S6 ( <i>d</i> 20 ~ 60) .....	166
UCSF-EH1S6 ( <i>d</i> 20 ~ 60) .....	168
UCVF-S6 ( <i>d</i> 20 ~ 40) .....	170
UCVF-ES7 ( <i>d</i> 20 ~ 40) .....	172

**3 Oval Flange Units**

**2-Bolt Flange Units**

UCFL ( <i>d</i> 12 ~ 120) .....	174
UCFL-E ( <i>d</i> 12 ~ 85) .....	180
NANFL ( <i>d</i> 12 ~ 55) .....	184
NCFL ( <i>d</i> 20 ~ 60) .....	186
NCFL-E ( <i>d</i> 20 ~ 60) .....	188
UKFL ( <i>d</i> <sub>1</sub> 20 ~ 110) .....	190

**Adjustable 2-Bolt Flange Units**

UCFA ( <i>d</i> 12 ~ 55) .....	194
--------------------------------	-----

**3-Bolt Flange Units**

UCFB ( <i>d</i> 12 ~ 50) .....	196
--------------------------------	-----

**Narrow Inner Ring Bearing 2-Bolt Flange Units**

SBFL-RKP8 ( <i>d</i> 20 ~ 40) .....	198
SAFL-FP9 ( <i>d</i> 20 ~ 55) .....	198

**Light 3-Bolt Flange Units**

SBTFD-H4RKP8 ( <i>d</i> 12 ~ 35) .....	200
SATFD-FH4P9 ( <i>d</i> 12 ~ 35) .....	200

**Light 2-Bolt Flange Units**

BLF ( <i>d</i> 12 ~ 35) .....	202
ALF ( <i>d</i> 12 ~ 35) .....	202

**Compact 2-Bolt Flange Units**

UFL ( <i>d</i> 8 ~ 30) .....	204
------------------------------	-----

**Corrosion Resistant Series 2-Bolt Flange Units**

UCSFL-H1S6 ( <i>d</i> 12 ~ 50) .....	206
UCSFL-EH1S6 ( <i>d</i> 12 ~ 50) .....	208
USFL-S6 ( <i>d</i> 10 ~ 30) .....	210
UCVFL-S6 ( <i>d</i> 20 ~ 40) .....	212
UCVFL-ES7 ( <i>d</i> 20 ~ 40) .....	214

**Corrosion Resistant Series 3-Bolt Flange Units**

UCVFB-ES7 ( <i>d</i> 20 ~ 35) .....	216
-------------------------------------	-----



**4 4-Bolt Flange Cartridge Units**

**4-Bolt Flange Cartridge Units**

UCFC (d 12 ~ 100) .....	218
UCFCX-E (d 25 ~ 100) .....	222
UCFCF (d 25 ~ 55) .....	224
NCFC (d 20 ~ 60) .....	226
UKFC (d <sub>1</sub> 20 ~ 90) .....	228

**Narrow Inner Ring Bearing**

**4-Bolt Flange Cartridge Units**

SBFC-RKP8 (d 20 ~ 40) .....	232
SAFC-FP9 (d 20 ~ 55) .....	232

**Corrosion Resistant Series**

**4-Bolt Flange Cartridge Units**

UCSFC-H1S6 (d 20 ~ 40) .....	234
------------------------------	-----

**5 Stamped Steel Flange Units**

**Stamped Steel 3-Bolt Flange Cartridge Units**

SBPF (d 12 ~ 35) .....	236
SAPF (d 12 ~ 35) .....	236

**Stamped Steel 2-Bolt Flange Units**

SBPFL (d 12 ~ 35) .....	238
SAPFL (d 12 ~ 35) .....	238

**6 Take-Up Units**

**Take-Up Units**

UCT (d 12 ~ 140) .....	240
UCT-E (d 12 ~ 85) .....	246
NAT-E (d 12 ~ 75) .....	250
NCT (d 20 ~ 60) .....	252
NCT-E (d 20 ~ 60) .....	254
UKT (d <sub>1</sub> 20 ~ 125) .....	256

**Narrow Slot Take-Up Units**

UCTRS (d 25 ~ 35) .....	260
-------------------------	-----

**Corrosion Resistant Series Take-Up Units**

UCST-H1S6 (d 20 ~ 50) .....	262
UCST-EH1S6 (d 20 ~ 50) .....	264

**Section Steel Frame Take-Up Units**

UCTH (d 12 ~ 65) .....	266
------------------------	-----

**Channel Steel Frame Take-Up Units**

UCTL (d 20 ~ 45) .....	268
UCTU (d 40 ~ 90) .....	270

**Steel Plate Frame Take-Up Units**

SBPTH (d 12 ~ 25) .....	274
SBNPTH (d 12 ~ 25) .....	276

**7 Other Units**

**Cartridge Units**

UCC (d 12 ~ 140) .....	278
UKC (d 20 ~ 125) .....	282

**Hanger Units**

UCHA (d 12 ~ 75) .....	284
------------------------	-----

**8 Ball Bearing Inserts**

**Cylindrical bore (with set screws)**

UC, SB, SB-RKP8, SU (d 8 ~ 140).....	286
--------------------------------------	-----

**Stainless steel series Cylindrical bore (with set screws)**

UC-S6, SU-S6 (d 10 ~ 60).....	294
-------------------------------	-----

**Cylindrical bore (with eccentric locking collar)**

SA, SA-F, NA (d 12 ~ 75).....	296
-------------------------------	-----

**Cylindrical bore (with concentric locking collar)**

NC2 (d 20 ~ 60).....	302
----------------------	-----

**Cylindrical bore (with concentric locking collar)**

**Cylindrical O. D.**

ERC (d 20 ~ 60).....	304
----------------------	-----

**Tapered bore (with adapter)**

UK (d <sub>1</sub> 20 ~ 125).....	306
-----------------------------------	-----

**Cylindrical bore (with set screws)**

**Cylindrical O. D.**

ER, RB (d 12 ~ 60) .....	312
--------------------------	-----

**Cylindrical bore (with set screws)**

**Cylindrical O. D.**

SBB-RK (d 12 ~ 55).....	314
-------------------------	-----

**Cylindrical bore (with eccentric locking collar)**

**Cylindrical O. D.**

SAA-FP7 (d 12 ~ 55) .....	314
---------------------------	-----

**Cylindrical bore**

SC (d 17 ~ 40) .....	316
----------------------	-----

**9 Bearing Adapter**

H2300X (d <sub>1</sub> 20 ~ 125).....	318
---------------------------------------	-----



**Pillow Block Units**

**UCP  
Cylindrical bore (with set screws)**

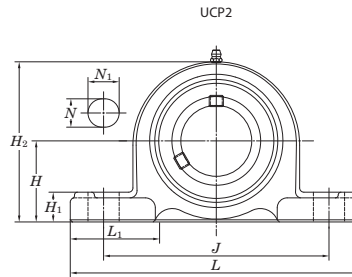
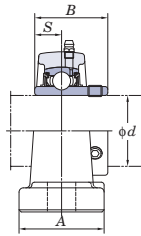

Shaft Dia. mm inch	Dimensions inch mm											Bolt Size inch mm	Standard			
	H	L	A	J	N	N <sub>1</sub>	H <sub>1</sub>	H <sub>2</sub>	L <sub>1</sub>	B	S		Unit No.	Housing No.	Bearing No.	
12 15	1/2	1 3/16	5	1 1/2	3 3/4	1/2	23/32	5/8	2 3/8	1 13/32	1.220	0.500	3/8 M10	UCP201 UCP201-8 UCP202 UCP202-10 UCP203	P203	UC201 UC201-8 UC202 UC202-10 UC203
	5/8	30.2	127	38	95	13	18	16	60	36	31	12.7				
17 20	3/4	1 5/16	5	1 1/2	3 3/4	1/2	23/32	5/8	2 9/16	1 13/32	1.220	0.500	3/8 M10	UCP204-12 UCP204	P204	UC204-12 UC204
	5/8	33.3	127	38	95	13	18	16	65	36	31	12.7				
25	7/8	1 7/16	5 1/2	1 1/2	4 1/8	1/2	23/32	5/8	2 3/4	1 1/2	1.343	0.563	3/8 M10	UCP205-14 UCP205-15 UCP205 UCP205-16	P205	UC205-14 UC205-15 UC205 UC205-16
	15/16	36.5	140	38	105	13	18	16	70	38	34.1	14.3				
	1	1 3/4	6 1/4	2	4 11/16	21/32	31/32	5/8	3 3/8	1 27/32	1.500	0.626	1/2 M14	UCPX05 UCPX05-16	PX05	UCX05 UCX05-16
	1	44.4	159	51	119	17	25	16	86	47	38.1	15.9				
1	1 49/64	6 7/8	1 3/4	5 3/16	21/32	25/32	5/8	3 11/32	2 5/32	1.496	0.591	1/2	UCP305 UCP305-16	P305	UC305 UC305-16	
30	1 1/8	1 11/16	6 1/2	1 7/8	4 3/4	21/32	13/16	21/32	3 5/16	1 7/8	1.500	0.626	1/2 M14	UCP206-18 UCP206 UCP206-19 UCP206-20	P206	UC206-18 UC206 UC206-19 UC206-20
	1 3/16	42.9	165	48	121	17	21	17	84	48	38.1	15.9				
	1 1/4	1 7/8	6 7/8	2 1/4	5	21/32	31/32	21/32	3 21/32	2 5/32	1.689	0.689	1/2 M14	UCPX06 UCPX06-19 UCPX06-20	PX06	UCX06 UCX06-19 UCX06-20
	1 3/16	47.6	175	57	127	17	25	17	93	55	42.9	17.5				
1 1/4	1 31/32	7 3/32	1 31/32	5 1/2	21/32	25/32	21/32	3 3/4	2 3/32	1.693	0.669	1/2	UCP306	P306	UC306	
35	1 1/4	1 7/8	6 9/16	1 7/8	5	21/32	13/16	23/32	3 3/4	1 27/32	1.689	0.689	1/2 M14	UCP207-20 UCP207-21 UCP207-22 UCP207 UCP207-23	P207	UC207-20 UC207-21 UC207-22 UC207 UC207-23
	1 5/16	47.6	167	48	127	17	21	18	95	47	42.9	17.5				
	1 3/8	2 1/8	8	2 1/4	5 21/32	21/32	1 3/16	3/4	4 1/8	2 17/32	1.937	0.748	1/2 M14	UCPX07-22 UCPX07 UCPX07-23	PX07	UCX07-22 UCX07 UCX07-23
	1 7/16	54	203	57	144	17	30	19	105	64	49.2	19				
1 7/16	2 13/64	8 9/32	2 7/32	6 5/16	21/32	31/32	3/4	4 7/32	2 9/16	1.890	0.748	1/2	UCP307	P307	UC307	
40	1 1/2	1 15/16	7 1/4	2 1/8	5 13/32	21/32	13/16	23/32	3 27/32	2 3/32	1.937	0.748	1/2 M14	UCP208-24 UCP208-25 UCP208	P208	UC208-24 UC208-25 UC208
	1 9/16	49.2	184	54	137	17	21	18	98	53	49.2	19				
	1 1/2	2 5/16	8 3/4	2 5/8	6 5/32	25/32	1 1/4	13/16	4 1/2	2 25/32	1.937	0.748	5/8 M16	UCPX08-24 UCPX08	PX08	UCX08-24 UCX08
1 1/2	58.7	222	67	156	20	32	21	114	71	49.2	19					
1 1/2	2 23/64	8 21/32	2 3/8	6 11/16	21/32	1 1/16	3/4	4 21/32	2 9/16	2.047	0.748	1/2	UCP308-24 UCP308	P308	UC308-24 UC308	
45	1 5/8	2 1/8	7 15/32	2 1/8	5 3/4	21/32	13/16	25/32	4 3/16	2 5/32	1.937	0.748	1/2 M14	UCP209-26 UCP209-27 UCP209-28 UCP209	P209	UC209-26 UC209-27 UC209-28 UC209
	1 11/16	54	190	54	146	17	21	20	106	55	49.2	19				
	1 3/4	2 5/16	8 3/4	2 5/8	6 5/32	25/32	1 5/16	13/16	4 9/16	2 25/32	2.031	0.748	5/8 M16	UCPX09-27 UCPX09-28 UCPX09	PX09	UCX09-27 UCX09-28 UCX09
	1 11/16	58.7	222	67	156	20	33	21	116	71	51.6	19				

Remarks 1. In Part No. of unit and units with covers, fitting codes follow bore diameter numbers. (See Table 10.5 in P.62.)  
2. Part No. of applicable grease fittings are shown below.  
A-1/4-28UNF ..... 201~210, X05~X09, 305~308  
A-R1/8 ..... 211~218, X10~X20, 309~328

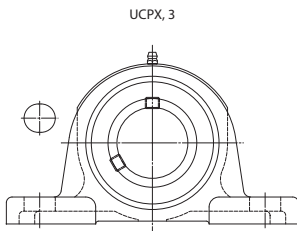

With Pressed Steel Cover

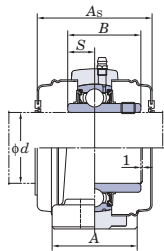

With Cast Iron Cover

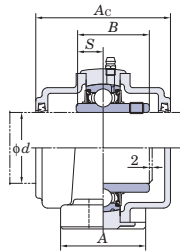

Variations of tolerance of distance from mounting bottom to center of spherical bore ( $\Delta H_{2c}$ )

Housing No.			Unit: mm
P203~P210	PX05~PX10	P305~P310	$\pm 0.15$
P211~P218	PX11~PX18	P311~P318	$\pm 0.2$
	PX20	P319~P328	$\pm 0.3$

Forms and dimensions of  $H_{2c}$  of P204JE3 and P205JE3 (housing with cast iron cover) are shown below.

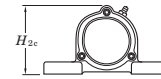

P204JE3  $H_{2c} = 70$  mm  
P205JE3  $H_{2c} = 77$  mm

Mass kg	Basic Load Ratings kN		Factor $f_0$	With Pressed Steel Cover			Mass kg	With Cast Iron Cover			Mass kg		
	$C_r$	$C_{0r}$		Unit No. Open Type	Unit No. One Side Closed Type	Dimension mm		Dimension inch	Unit No. Open Type	Unit No. One Side Closed Type		Dimension mm	Dimension inch
0.63	12.8	6.65	13.2	UCP201C	UCP201CD	45	1 25/32	0.63	-	-	-	-	
0.63				-	-	-	-	-	-	-	-	-	-
0.61				UCP202C	UCP202CD	45	1 25/32	0.61	-	-	-	-	-
0.61				-	-	-	-	-	-	-	-	-	-
0.60				UCP203C	UCP203CD	45	1 25/32	0.60	-	-	-	-	-
0.66	12.8	6.65	13.2	-	-	-	-	-	-	-	-	-	
0.66				UCP204C	UCP204CD	45	1 25/32	0.66	UCP204FC	UCP204FCD	62	2 7/16	0.96
0.80				-	-	-	-	-	-	-	-	-	-
0.80				UCP205C	UCP205CD	49	1 15/16	0.80	UCP205FC	UCP205FCD	66	2 19/32	1.2
0.80				-	-	-	-	-	-	-	-	-	-
1.5	19.5	11.3	13.9	UCPX05C	UCPX05CD	53	2 3/32	1.5	-	-	-	-	
1.5				-	-	-	-	-	-	-	-	-	
1.7	21.2	10.9	12.6	-	-	-	-	-	UCP305C	UCP305CD	76	3	2.3
1.7				-	-	-	-	-	-	-	-	-	-
1.3	19.5	11.3	13.9	-	-	-	-	-	-	-	-	-	
1.3				UCP206C	UCP206CD	53	2 3/32	1.3	UCP206FC	UCP206FCD	70	2 3/4	1.8
1.3				-	-	-	-	-	-	-	-	-	-
1.3				-	-	-	-	-	-	-	-	-	-
2.1	25.7	15.4	13.9	UCPX06C	UCPX06CD	60	2 3/8	2.1	-	-	-	-	
2.1				-	-	-	-	-	-	-	-	-	
2.1				-	-	-	-	-	-	-	-	-	
2.2	26.7	15.0	13.3	-	-	-	-	-	UCP306C	UCP306CD	82	3 7/32	2.8
1.6	25.7	15.4	13.9	-	-	-	-	-	-	-	-	-	
1.6				-	-	-	-	-	-	-	-	-	-
1.6				UCP207C	UCP207CD	60	2 3/8	1.6	UCP207FC	UCP207FCD	78	3 1/16	2.3
1.6				-	-	-	-	-	-	-	-	-	-
1.6				-	-	-	-	-	-	-	-	-	-
2.7	29.1	17.8	14.0	-	-	-	-	-	-	-	-	-	
2.7				UCPX07C	UCPX07CD	69	2 23/32	2.7	-	-	-	-	
2.7				-	-	-	-	-	-	-	-	-	
3.0	33.4	19.3	13.2	-	-	-	-	-	UCP307C	UCP307CD	88	3 15/32	3.8
2.0	29.1	17.8	14.0	-	-	-	-	-	-	-	-	-	
2.0				UCP208C	UCP208CD	69	2 23/32	2.0	UCP208FC	UCP208FCD	86	3 3/8	2.8
2.0				-	-	-	-	-	-	-	-	-	
3.5	34.1	21.3	14.0	-	-	-	-	-	-	-	-		
3.5				UCPX08C	UCPX08CD	69	2 23/32	3.5	-	-	-	-	
3.8	40.7	24.0	13.2	-	-	-	-	-	-	-	-		
3.8				-	-	-	-	-	UCP308C	UCP308CD	96	3 25/32	4.8
2.2	34.1	21.3	14.0	-	-	-	-	-	-	-	-		
2.2				-	-	-	-	-	-	-	-	-	
2.2				UCP209C	UCP209CD	69	2 23/32	2.2	UCP209FC	UCP209FCD	88	3 15/32	3.0
2.2				-	-	-	-	-	-	-	-	-	
3.7	35.1	23.3	14.4	-	-	-	-	-	-	-	-		
3.7				-	-	-	-	-	-	-	-	-	
3.7				UCPX09C	UCPX09CD	74	2 29/32	3.7	-	-	-	-	

- As for the triple seal type product (from 201 to 205 are the double seal type products), suffix code L3 (or L2) follows the Part No. of unit or bearing. (Example of Part No. : UCP206JL3, UC206L3)
- For the dimensions and forms of applicable bearings, see the dimensional tables of ball bearing for unit.
- Representative examples of the forms of housing are indicated.
- Housings of nodular graphite cast iron are also available.



**Pillow Block Units**

**UCP  
Cylindrical bore (with set screws)**

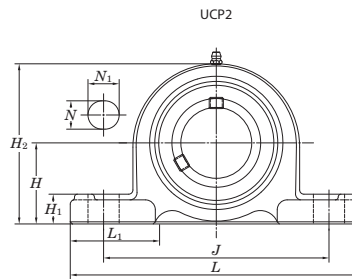
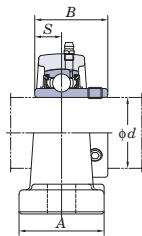

Shaft Dia. mm inch	Dimensions inch mm												Bolt Size inch mm	Standard				
	H	L	A	J	N	N <sub>1</sub>	H <sub>1</sub>	H <sub>2</sub>	L <sub>1</sub>	B	S	Unit No.		Housing No.	Bearing No.			
45 1 3/4	2 41/64	9 21/32	2 5/8	7 15/32	25/32	1 3/16	13/16	5 3/16	2 15/16	2.244	0.866	5/8	UCP309-28 UCP309	P309	UC309-28 UC309			
	67	245	67	190	20	30	21	132	75	57	22	M16						
50 1 7/8 1 15/16 2 1 15/16	2 1/4	8 1/8	2 3/8	6 1/4	25/32	7/8	13/16	4 7/16	2 3/8	2.031	0.748	5/8	UCP210-30 UCP210-31 UCP210 UCP210-32	P210	UC210-30 UC210-31 UC210 UC210-32			
	57.2	206	60	159	20	22	21	113	60	51.6	19	M16						
	2 1/2	9 1/2	2 7/8	6 23/32	25/32	1 13/32	7/8	4 31/32	3	2.189	0.874	5/8				UCPX10-31 UCPX10 UCPX10-32	PX10	UCX10-31 UCX10 UCX10-32
	63.5	241	73	171	20	36	22	126	76	55.6	22.2	M16						
2 61/64	10 13/16	2 15/16	8 11/32	25/32	1 3/8	15/16	5 13/16	3 15/32	2.402	0.866	5/8	UCP310	P310	UC310				
75	275	75	212	20	35	24	148	88	61	22	M16							
55 2 2 1/8 2 3/16	2 1/2	8 5/8	2 3/8	6 23/32	25/32	7/8	29/32	4 29/32	2 9/16	2.189	0.874	5/8	UCP211-32 UCP211-34 UCP211 UCP211-35	P211	UC211-32 UC211-34 UC211 UC211-35			
	63.5	219	60	171	20	22	23	125	65	55.6	22.2	M16						
	2 3/4	10 1/4	3 1/8	7 1/4	31/32	1 13/32	1 3/32	5 15/32	3 9/32	2.563	1.000	3/4				UCPX11 UCPX11-35 UCPX11-36	PX11	UCX11 UCX11-35 UCX11-36
	69.8	260	79	184	25	36	28	139	83	65.1	25.4	M20						
2	3 5/32	12 7/32	3 5/32	9 9/32	25/32	1 1/2	1 1/16	6 7/32	3 17/32	2.598	0.984	5/8	UCP311-32 UCP311 UCP311-35	P311	UC311-32 UC311 UC311-35			
80	310	80	236	20	38	27	158	90	66	25	M16							
60 2 1/4 2 3/8 2 7/16	2 3/4	9 1/2	2 3/4	7 1/4	25/32	31/32	31/32	5 7/16	2 7/8	2.563	1.000	5/8	UCP212-36 UCP212 UCP212-38 UCP212-39	P212	UC212-36 UC212 UC212-38 UC212-39			
	69.8	241	70	184	20	25	25	138	73	65.1	25.4	M16						
	3	11 1/4	3 1/4	8	31/32	1 9/16	1 3/32	5 31/32	3 15/32	2.563	1.000	3/4				UCPX12 UCPX12-39	PX12	UCX12 UCX12-39
	76.2	286	83	203	25	40	28	152	88	65.1	25.4	M20						
2 7/16	3 11/32	13	3 11/32	9 27/32	31/32	1 1/2	1 5/32	6 9/16	4 1/16	2.795	1.024	3/4	UCP312 UCP312-39	P312	UC312 UC312-39			
85	330	85	250	25	38	29	167	103	71	26	M20							
65 2 1/2 2 1/2 2 1/2	3	10 7/16	2 3/4	8	31/32	1 3/16	1 1/16	5 29/32	3 1/16	2.563	1.000	3/4	UCP213-40 UCP213	P213	UC213-40 UC213			
	76.2	265	70	203	25	30	27	150	78	65.1	25.4	M20						
	3	11 1/4	3 1/4	8	31/32	1 9/16	1 3/32	6 3/32	3 15/32	2.937	1.189	3/4				UCPX13-40 UCPX13	PX13	UCX13-40 UCX13
	76.2	286	83	203	25	40	28	155	88	74.6	30.2	M20						
2 1/2	3 35/64	13 3/8	3 17/32	10 1/4	31/32	1 1/2	1 1/4	6 15/16	4 11/32	2.953	1.181	3/4	UCP313-40 UCP313	P313	UC313-40 UC313			
90	340	90	260	25	38	32	176	110	75	30	M20							
70 2 3/4 2 3/4 2 3/4	3 1/8	10 15/32	2 27/32	8 9/32	31/32	1 3/16	1 1/16	6 3/16	2 15/16	2.937	1.189	3/4	UCP214-44 UCP214	P214	UC214-44 UC214			
	79.4	266	72	210	25	30	27	157	75	74.6	30.2	M20						
	3 1/2	13	3 1/2	9	1 1/16	1 31/32	1 1/4	6 23/32	3 27/32	3.063	1.331	7/8				UCPX14-44 UCPX14	PX14	UCX14-44 UCX14
	88.9	330	89	229	27	50	32	171	98	77.8	33.3	M22						
2 3/4	3 47/64	14 3/16	3 17/32	11 1/32	1 1/16	1 9/16	1 3/8	7 5/16	4 11/32	3.071	1.299	7/8	UCP314-44 UCP314	P314	UC314-44 UC314			
95	360	90	280	27	40	35	186	110	78	33	M22							
75 2 15/16 3 2 15/16	3 1/4	10 13/16	2 29/32	8 17/32	31/32	1 3/16	1 3/32	6 3/8	3 1/16	3.063	1.311	3/4	UCP215-47 UCP215 UCP215-48	P215	UC215-47 UC215 UC215-48			
	82.6	275	74	217	25	30	28	162	78	77.8	33.3	M20						
	3 1/2	13	3 1/2	9	1 1/16	1 31/32	1 1/4	6 7/8	3 29/32	3.252	1.311	7/8				UCPX15-47 UCPX15	PX15	UCX15-47 UCX15
88.9	330	89	229	27	50	32	175	99	82.6	33.3	M22							

Remarks 1. In Part No. of unit and units with covers, fitting codes follow bore diameter numbers. (See Table 10.5 in P62.)  
2. Part No. of applicable grease fittings are shown below.  
A-1/4-28UNF ..... 201~210, X05~X09, 305~308  
A-R1/8..... 211~218, X10~X20, 309~328

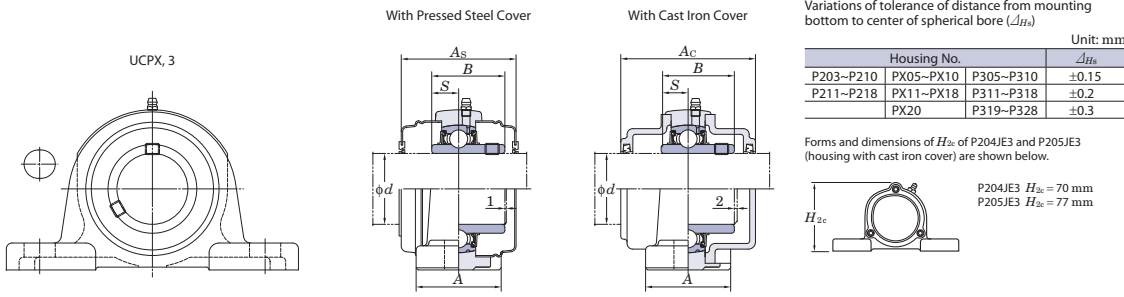

Mass	Basic Load Ratings		Factor	With Pressed Steel Cover			Mass	With Cast Iron Cover			Mass	
	kg	$C_r$		$C_{0r}$	Unit No.	Dimension		mm	inch	Unit No.		Dimension
			$f_0$	Open Type	One Side Closed Type	$A_s$		Open Type	One Side Closed Type	$A_c$		
4.9	48.9	29.5	13.3	-	-	-	-	-	-	-	-	
4.9	48.9	29.5	13.3	-	-	-	-	UCP309C	UCP309CD	102	4 1/32	
2.9	35.1	23.3	14.4	-	-	-	-	-	-	-	-	
2.9	35.1	23.3	14.4	-	-	-	-	-	-	-	-	
2.9	35.1	23.3	14.4	UCP210C	UCP210CD	74	2 29/32	2.9	UCP210FC	UCP210FCD	97	3 13/16
2.9	35.1	23.3	14.4	-	-	-	-	-	-	-	-	
4.6	43.4	29.4	14.4	-	-	-	-	-	-	-	-	
4.6	43.4	29.4	14.4	UCPX10C	UCPX10CD	76	3	4.6	-	-	-	
4.6	43.4	29.4	14.4	-	-	-	-	-	-	-	-	
6.6	62.0	38.3	13.2	-	-	-	-	-	-	-	-	
6.6	62.0	38.3	13.2	-	-	-	-	UCP310C	UCP310CD	110	4 11/32	
3.6	43.4	29.4	14.4	-	-	-	-	-	-	-	-	
3.6	43.4	29.4	14.4	-	-	-	-	-	-	-	-	
3.6	43.4	29.4	14.4	UCP211C	UCP211CD	76	3	3.6	UCP211FC	UCP211FCD	99	3 29/32
3.6	43.4	29.4	14.4	-	-	-	-	-	-	-	-	
6.5	52.4	36.2	14.4	UCPX11C	UCPX11CD	89	3 1/2	6.5	-	-	-	
6.5	52.4	36.2	14.4	-	-	-	-	-	-	-	-	
6.5	52.4	36.2	14.4	-	-	-	-	-	-	-	-	
7.9	71.6	45.0	13.2	-	-	-	-	-	-	-	-	
7.9	71.6	45.0	13.2	-	-	-	-	-	-	-	-	
7.9	71.6	45.0	13.2	-	-	-	-	UCP311C	UCP311CD	114	4 1/2	
7.9	71.6	45.0	13.2	-	-	-	-	-	-	-	-	
4.9	52.4	36.2	14.4	-	-	-	-	-	-	-	-	
4.9	52.4	36.2	14.4	UCP212C	UCP212CD	89	3 1/2	4.9	UCP212FC	UCP212FCD	114	4 1/2
4.9	52.4	36.2	14.4	-	-	-	-	-	-	-	-	
4.9	52.4	36.2	14.4	-	-	-	-	-	-	-	-	
7.7	57.2	40.1	14.4	UCPX12C	UCPX12CD	89	3 1/2	7.7	-	-	-	
7.7	57.2	40.1	14.4	-	-	-	-	-	-	-	-	
9.5	81.9	52.2	13.2	-	-	-	-	-	-	-	-	
9.5	81.9	52.2	13.2	-	-	-	-	UCP312C	UCP312CD	124	4 7/8	
9.5	81.9	52.2	13.2	-	-	-	-	-	-	-	-	
5.9	57.2	40.1	14.4	-	-	-	-	-	-	-	-	
5.9	57.2	40.1	14.4	UCP213C	UCP213CD	89	3 1/2	5.9	UCP213FC	UCP213FCD	114	4 1/2
5.9	57.2	40.1	14.4	-	-	-	-	-	-	-	-	
8.1	62.2	44.1	14.5	-	-	-	-	-	-	-	-	
8.1	62.2	44.1	14.5	UCPX13C	UCPX13CD	99	3 29/32	8.1	-	-	-	
10.7	92.7	59.9	13.2	-	-	-	-	-	-	-	-	
10.7	92.7	59.9	13.2	-	-	-	-	UCP313C	UCP313CD	122	4 13/16	
10.7	92.7	59.9	13.2	-	-	-	-	-	-	-	-	
6.8	62.2	44.1	14.5	-	-	-	-	-	-	-	-	
6.8	62.2	44.1	14.5	UCP214C	UCP214CD	99	3 29/32	6.8	UCP214FC	UCP214FCD	124	4 7/8
6.8	62.2	44.1	14.5	-	-	-	-	-	-	-	-	
10.2	67.4	48.3	14.5	-	-	-	-	-	-	-	-	
10.2	67.4	48.3	14.5	UCPX14C	UCPX14CD	99	3 29/32	10.2	-	-	-	
10.2	67.4	48.3	14.5	-	-	-	-	-	-	-	-	
12.4	104	68.2	13.2	-	-	-	-	-	-	-	-	
12.4	104	68.2	13.2	-	-	-	-	UCP314C	UCP314CD	124	4 7/8	
12.4	104	68.2	13.2	-	-	-	-	-	-	-	-	
7.4	67.4	48.3	14.5	-	-	-	-	-	-	-	-	
7.4	67.4	48.3	14.5	UCP215C	UCP215CD	99	3 29/32	7.4	UCP215FC	UCP215FCD	124	4 7/8
7.4	67.4	48.3	14.5	-	-	-	-	-	-	-	-	
10.8	72.7	53.0	14.6	-	-	-	-	-	-	-	-	
10.8	72.7	53.0	14.6	UCPX15C	UCPX15CD	109	4 9/32	10.8	-	-	-	
10.8	72.7	53.0	14.6	-	-	-	-	-	-	-	-	

- As for the triple seal type product (from 201 to 205 are the double seal type products), suffix code L3 (or L2) follows the Part No. of unit or bearing. (Example of Part No. : UCP206JL3, UC206L3)
- For the dimensions and forms of applicable bearings, see the dimensional tables of ball bearing for unit.
- Representative examples of the forms of housing are indicated.
- Housings of nodular graphite cast iron are also available.



**Pillow Block Units**

**UCP  
Cylindrical bore (with set screws)**

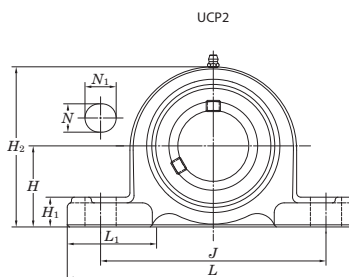
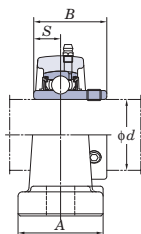

Shaft Dia. mm inch	Dimensions inch mm												Bolt Size inch mm	Standard		
	H	L	A	J	N	N <sub>1</sub>	H <sub>1</sub>	H <sub>2</sub>	L <sub>1</sub>	B	S	Unit No.		Housing No.	Bearing No.	
d																
75 3	2 15/16	3 15/16	14 31/32	3 15/16	11 13/32	1 1/16	1 9/16	1 3/8	7 25/32	4 7/32	3.228	1.260	7/8 M22	UCP315-47 UCP315 UCP315-48	P315	UC315-47 UC315 UC315-48
	3 1/8	100	380	100	290	27	40	35	198	107	82	32				
80	3 1/8	3 1/2	11 1/2	3 1/16	9 1/8	3 1/32	1 3/8	1 3/16	6 27/32	3 9/32	3.252	1.311	3/4 M20	UCP216-50 UCP216	P216	UC216-50 UC216
	—	4	15	4	11 1/8	1 1/16	2 9/32	1 11/32	7 11/16	4 9/16	3.374	1.343	7/8 M22	UCPX16	PX16	UCX16
	—	101.6	381	102	283	27	58	34	195	116	85.7	34.1				
	—	4 11/64	15 3/4	4 11/32	11 13/16	1 1/16	1 9/16	1 3/8	8 7/32	4 23/32	3.386	1.339	7/8 M22	UCP316	P316	UC316
85	3 1/4	3 3/4	12 7/32	3 9/32	9 23/32	3 1/32	1 3/8	1 1/4	7 9/32	3 7/16	3.374	1.343	3/4 M20	UCP217-52 UCP217	P217	UC217-52 UC217
	—	95.2	310	83	247	25	35	32	185	87	85.7	34.1				
	—	4	15	4	11 1/8	1 1/16	2 3/8	1 11/32	7 7/8	4 9/16	3.780	1.563	7/8 M22	UCPX17	PX17	UCX17
	—	101.6	381	102	283	27	60	34	200	116	96	39.7				
90	3 1/2	4 13/32	16 17/32	4 11/32	12 19/32	1 5/16	1 25/32	1 9/16	8 21/32	4 23/32	3.780	1.575	1 M27	UCP317	P317	UC317
	—	112	420	110	320	33	45	40	220	120	96	40				
	—	4	12 7/8	3 15/32	10 5/16	1 1/16	1 9/16	1 5/16	7 25/32	3 11/16	3.780	1.563	7/8 M22	UCP218-56 UCP218	P218	UC218-56 UC218
	—	101.6	327	88	262	27	40	33	198	94	96	39.7				
95	3 1/2	4	15	4 3/8	11 1/8	1 1/16	2 3/8	1 1/2	8 1/32	4 9/16	4.094	1.689	7/8 M22	UCPX18	PX18	UCX18
	—	101.6	381	111	283	27	60	38	204	116	104	42.9				
	—	4 41/64	16 15/16	4 11/32	13	1 5/16	1 25/32	1 9/16	9 7/32	4 23/32	3.780	1.575	1 M27	UCP318-56 UCP318	P318	UC318-56 UC318
	—	118	430	110	330	33	45	40	234	120	96	40				
100	—	4 59/64	18 1/2	4 23/32	14 3/16	1 13/32	1 31/32	1 13/16	9 3/4	4 29/32	4.055	1.614	1 1/8 M30	UCP319	P319	UC319
	—	125	470	120	360	36	50	46	248	125	103	41				
105	3 15/16	5	17	4 3/4	13 1/4	1 5/16	2 9/16	1 25/32	9 21/32	4 31/32	4.626	1.937	1 M27	UCPX20 UCPX20-63 UCPX20-64	PX20	UCX20 UCX20-63 UCX20-64
	—	127	432	121	337	33	65	45	245	126	117.5	49.2				
	—	5 33/64	19 9/32	4 23/32	14 31/32	1 13/32	1 31/32	1 13/16	10 3/4	5 1/2	4.252	1.654	1 1/8 M30	UCP320 UCP320-63 UCP320-64	P320	UC320 UC320-63 UC320-64
110	—	140	490	120	380	36	50	46	273	140	108	42				
	—	5 29/32	20 15/32	5 1/2	15 3/4	1 9/16	2 5/32	1 31/32	11 21/32	5 29/32	4.606	1.811	1 1/4 M33	UCP321	P321	UC321
120	—	150	520	140	400	40	55	50	296	150	117	46				
	—	6 19/64	22 7/16	5 1/2	17 23/32	1 9/16	2 5/32	1 31/32	12 7/16	6 5/16	4.961	2.008	1 1/4 M33	UCP322	P322	UC322
130	—	160	570	140	450	40	55	50	316	160	126	51				
	—	7 3/32	23 5/8	5 1/2	18 29/32	1 9/16	2 5/32	1 31/32	13 21/32	7 11/16	5.315	2.126	1 1/4 M33	UCP323	P323	UC323
140	—	180	600	140	480	40	55	50	355	195	135	54				
	—	7 7/8	24 13/32	5 1/2	19 11/16	1 9/16	2 5/32	2 3/8	15 15/32	7 9/32	5.709	2.323	1 1/4 M33	UCP324	P324	UC324
140	—	200	620	140	500	40	55	60	393	185	145	59				
	—	7 7/8	24 13/32	5 1/2	19 11/16	1 9/16	2 5/32	2 3/8	15 15/32	7 9/32	5.709	2.323	1 1/4 M33	UCP328	P328	UC328

Remarks 1. In Part No. of unit and units with covers, fitting codes follow bore diameter numbers. (See Table 10.5 in P62.)  
 2. Part No. of applicable grease fittings are shown below.  
 A-1/4-28UNF ..... 201~210, X05~X09, 305~308  
 A-R1/8 ..... 211~218, X10~X20, 309~328



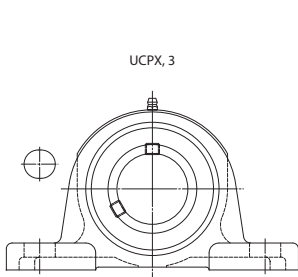

With Pressed Steel Cover

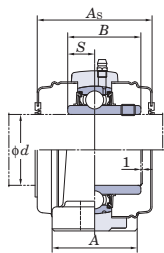

With Cast Iron Cover

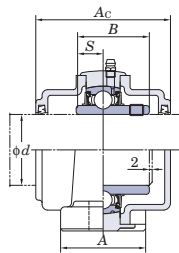

Variations of tolerance of distance from mounting bottom to center of spherical bore ( $\Delta H_{2c}$ )

Housing No.			Unit: mm
P203~P210	PX05~PX10	P305~P310	$\pm 0.15$
P211~P218	PX11~PX18	P311~P318	$\pm 0.2$
	PX20	P319~P328	$\pm 0.3$

Forms and dimensions of  $H_{2c}$  of P204JE3 and P205JE3 (housing with cast iron cover) are shown below.

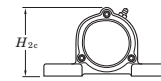

P204JE3  $H_{2c} = 70$  mm  
P205JE3  $H_{2c} = 77$  mm

Mass	Basic Load Ratings		Factor	With Pressed Steel Cover			Mass	With Cast Iron Cover			Mass
	kg	$C_r$		$C_{0r}$	Unit No.	Dimension		Unit No.	Dimension		
			$f_0$	Open Type	One Side Closed Type	mm inch		Open Type	One Side Closed Type	mm inch	
						$A_s$				$A_c$	
14.8				-	-	-	-	-	-	-	-
14.8	113	77.2	13.2	-	-	-	-	UCP315C	UCP315CD	134 5 <sup>9</sup> / <sub>32</sub>	17.3
14.8				-	-	-	-	-	-	-	-
9.0				-	-	-	-	-	-	-	-
9.0	72.7	53.0	14.6	UCP216C	UCP216CD	109 4 <sup>9</sup> / <sub>32</sub>	9.0	UCP216FC	UCP216FCD	138 5 <sup>7</sup> / <sub>16</sub>	11.4
				-	-	-	-	-	-	-	-
15.3	84.0	61.9	14.5	UCPX16C	UCPX16CD	113 4 <sup>7</sup> / <sub>16</sub>	15.3	-	-	-	-
				-	-	-	-	-	-	-	-
18.5	123	86.7	13.3	-	-	-	-	UCP316C	UCP316CD	138 5 <sup>7</sup> / <sub>16</sub>	21.4
				-	-	-	-	-	-	-	-
10.8				-	-	-	-	-	-	-	-
10.8	84.0	61.9	14.5	UCP217C	UCP217CD	113 4 <sup>7</sup> / <sub>16</sub>	10.8	UCP217FC	UCP217FCD	142 5 <sup>19</sup> / <sub>32</sub>	13.5
16.1				-	-	-	-	-	-	-	-
16.1	96.1	71.5	14.5	UCPX17C	UCPX17CD	123 4 <sup>27</sup> / <sub>32</sub>	16.1	-	-	-	-
				-	-	-	-	-	-	-	-
20.3	133	96.8	13.3	-	-	-	-	UCP317C	UCP317CD	146 5 <sup>3</sup> / <sub>4</sub>	23.6
				-	-	-	-	-	-	-	-
13.9				-	-	-	-	-	-	-	-
13.9	96.1	71.5	14.5	UCP218C	UCP218CD	123 4 <sup>27</sup> / <sub>32</sub>	13.9	UCP218FC	UCP218FCD	152 6	17.0
				-	-	-	-	-	-	-	-
19.1	109	81.9	14.4	-	-	-	-	UCPX18C	UCPX18C	158 6 <sup>7</sup> / <sub>32</sub>	22.5
				-	-	-	-	-	-	-	-
22.8				-	-	-	-	-	-	-	-
22.8	143	107	13.3	-	-	-	-	UCP318C	UCP318CD	150 5 <sup>29</sup> / <sub>32</sub>	26.6
				-	-	-	-	-	-	-	-
29.0	153	119	13.3	-	-	-	-	UCP319C	UCP319CD	162 6 <sup>3</sup> / <sub>8</sub>	33.3
				-	-	-	-	-	-	-	-
30.4				-	-	-	-	-	-	-	-
30.4	133	105	14.4	-	-	-	-	UCPX20C	UCPX20CD	186 7 <sup>5</sup> / <sub>16</sub>	34.9
30.4				-	-	-	-	-	-	-	-
				-	-	-	-	-	-	-	-
35.1				-	-	-	-	UCP320C	UCP320CD	174 6 <sup>27</sup> / <sub>32</sub>	40.7
35.1	173	141	13.2	-	-	-	-	-	-	-	-
35.1				-	-	-	-	-	-	-	-
				-	-	-	-	-	-	-	-
37.6	184	153	13.2	-	-	-	-	UCP321C	UCP321CD	178 7	43.6
				-	-	-	-	-	-	-	-
44.0	205	180	13.2	-	-	-	-	UCP322C	UCP322CD	188 7 <sup>13</sup> / <sub>32</sub>	50.8
				-	-	-	-	-	-	-	-
55.4	207	185	13.5	-	-	-	-	UCP324C	UCP324CD	196 7 <sup>23</sup> / <sub>32</sub>	64.9
				-	-	-	-	-	-	-	-
72.1	229	214	13.6	-	-	-	-	UCP326C	UCP326CD	214 8 <sup>7</sup> / <sub>16</sub>	84.2
				-	-	-	-	-	-	-	-
92.5	253	246	13.6	-	-	-	-	UCP328C	UCP328CD	222 8 <sup>3</sup> / <sub>4</sub>	108

- As for the triple seal type product (from 201 to 205 are the double seal type products), suffix code L3 (or L2) follows the Part No. of unit or bearing. (Example of Part No. : UCP206JL3, UC206L3)
- For the dimensions and forms of applicable bearings, see the dimensional tables of ball bearing for unit.
- Representative examples of the forms of housing are indicated.
- Housings of nodular graphite cast iron are also available.



**Pillow Block Units**

**NAP  
Cylindrical bore  
(with eccentric locking collar)**

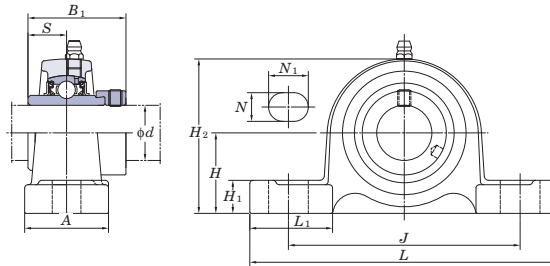

Shaft Dia. mm inch	Dimensions inch mm												Bolt Size inch mm	Unit No.	Housing No.	Bearing No.
	H	L	A	J	N	N <sub>1</sub>	H <sub>1</sub>	H <sub>2</sub>	L <sub>1</sub>	B <sub>1</sub>	S					
12 15 17	1/2	1 3/16	5	1 1/2	3 3/4	1/2	23/32	5/8	2 3/8	1 13/32	1.720	0.673	3/8 M10	NAP201 NAP201-8 NAP202 NAP202-10 NAP203	P203	NA201 NA201-8 NA202 NA202-10 NA203
	5/8	30.2	127	38	95	13	18	16	60	36	43.7	17.1				
20	3/4	1 5/16	5	1 1/2	3 3/4	1/2	23/32	5/8	2 9/16	1 13/32	1.720	0.673	3/8 M10	NAP204-12 NAP204	P204	NA204-12 NA204
		33.3	127	38	95	13	18	16	65	36	43.7	17.1				
25	7/8	1 7/16	5 1/2	1 1/2	4 1/8	1/2	23/32	5/8	2 3/4	1 1/2	1.748	0.689	3/8 M10	NAP205-14 NAP205-15 NAP205 NAP205-16	P205	NA205-14 NA205-15 NA205 NA205-16
	15/16	36.5	140	38	105	13	18	16	70	38	44.4	17.5				
30	1 1/8	1 11/16	6 1/2	1 7/8	4 3/4	21/32	13/16	21/32	3 5/16	1 7/8	1.906	0.720	1/2 M14	NAP206-18 NAP206 NAP206-19 NAP206-20	P206	NA206-18 NA206 NA206-19 NA206-20
	1 3/16	42.9	165	48	121	17	21	17	84	48	48.4	18.3				
35	1 1/4	1 7/8	6 9/16	1 7/8	5	21/32	13/16	23/32	3 3/4	1 27/32	2.012	0.740	1/2 M14	NAP207-20 NAP207-21 NAP207-22 NAP207	P207	NA207-20 NA207-21 NA207-22 NA207
	1 5/16	47.6	167	48	127	17	21	18	95	47	51.1	18.8				
40	1 1/2	1 5/16	7 1/4	2 1/8	5 13/32	21/32	13/16	23/32	3 27/32	2 3/32	2.217	0.843	1/2 M14	NAP208-24 NAP208-25 NAP208	P208	NA208-24 NA208-25 NA208
	1 9/16	49.2	184	54	137	17	21	18	98	53	56.3	21.4				
45	1 5/8	2 1/8	7 15/32	2 1/8	5 3/4	21/32	13/16	25/32	4 3/16	2 5/32	2.217	0.843	1/2 M14	NAP209-26 NAP209-27 NAP209-28 NAP209	P209	NA209-26 NA209-27 NA209-28 NA209
	1 11/16	54	190	54	146	17	21	20	106	55	56.3	21.4				
50	1 7/8	2 1/4	8 1/8	2 3/8	6 1/4	25/32	7/8	13/16	4 7/16	2 3/8	2.469	0.969	5/8 M16	NAP210-30 NAP210-31 NAP210 NAP210-32	P210	NA210-30 NA210-31 NA210 NA210-32
	1 15/16	57.2	206	60	159	20	22	21	113	60	62.7	24.6				
55	2	2 1/2	8 5/8	2 3/8	6 23/32	25/32	7/8	29/32	4 29/32	2 9/16	2.811	1.094	5/8 M16	NAP211-32 NAP211-34 NAP211 NAP211-35	P211	NA211-32 NA211-34 NA211 NA211-35
	2 3/16	63.5	219	60	171	20	22	23	125	65	71.4	27.8				
60	2 1/4	2 3/4	9 1/2	2 3/4	7 1/4	25/32	31/32	31/32	5 7/16	2 7/8	3.063	1.220	5/8 M16	NAP212-36 NAP212 NAP212-38 NAP212-39	P212	NA212-36 NA212 NA212-38 NA212-39
	2 3/8	69.8	241	70	184	20	25	25	138	73	77.8	31				
65	2 1/2	3	10 7/16	2 3/4	8	31/32	1 3/16	1 1/16	5 29/32	3 1/16	3.374	1.343	3/4 M20	NAP213-40 NAP213	P213	NA213-40 NA213
		76.2	265	70	203	25	30	27	150	78	85.7	34.1				
70	2 3/4	3 1/8	10 15/32	2 27/32	8 9/32	31/32	1 3/16	1 1/16	6 3/16	2 15/16	3.374	1.343	3/4 M20	NAP214-44 NAP214	P214	NA214-44 NA214
		79.4	266	72	210	25	30	27	157	75	85.7	34.1				
75	2 15/16	3 1/4	10 13/16	2 29/32	8 17/32	31/32	1 3/16	1 3/32	6 3/8	3 1/16	3.626	1.469	3/4 M20	NAP215-47 NAP215	P215	NA215-47 NA215
		82.6	275	74	217	25	30	28	162	78	92.1	37.3				

Remarks 1. In Part No. of unit, fitting codes follow bore diameter numbers. (See Table 10.5 in P.62)  
2. Part No. of applicable grease fittings are shown below.  
A-1/4-28UNF ..... 201~210  
A-R1/8..... 211~215



# FYH

Variations of tolerance of distance from mounting bottom to center of spherical bore ( $\Delta H_b$ )

Unit: mm

Housing No.	$\Delta H_b$
P203~P210	$\pm 0.15$
P211~P215	$\pm 0.2$

	Basic Load Ratings kN		Factor	Mass
	$C_r$	$C_{0r}$	$f_0$	kg
				0.71
	12.8	6.65	13.2	0.69
				0.66
	12.8	6.65	13.2	0.73
	14.0	7.85	13.9	0.87
	19.5	11.3	13.9	1.4
	25.7	15.4	13.9	1.8
	29.1	17.8	14.0	2.1
	34.1	21.3	14.0	2.4
	35.1	23.3	14.4	3.1
	43.4	29.4	14.4	3.9
	52.4	36.2	14.4	5.2
	57.2	40.1	14.4	6.5
	62.2	44.1	14.5	7.7
	67.4	48.3	14.5	7.9

3. As for the triple seal type product (from 201 to 205 are the double seal type products), suffix code L3 (or L2) follows the Part No. of unit or bearing.  
(Example of Part No. : NAP206JL3, NA206L3)

4. For the dimensions and forms of applicable bearings, see the dimensional tables of ball bearing for unit.

5. Representative examples of the forms of housing are indicated.

6. Housings of nodular graphite cast iron are also available.



**Pillow Block Units**

**NAP-E  
Cylindrical bore  
(with eccentric locking collar)**

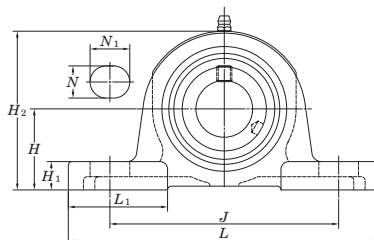
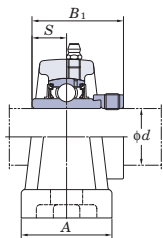

Shaft Dia. inch	Dimensions												Bolt Size inch mm	Unit No.	Housing No.	Bearing No.
	inch mm															
<i>d</i>	<i>H</i>	<i>L</i>	<i>A</i>	<i>J</i>	<i>N</i>	<i>N<sub>1</sub></i>	<i>H<sub>1</sub></i>	<i>H<sub>2</sub></i>	<i>L<sub>1</sub></i>	<i>B<sub>1</sub></i>	<i>S</i>					
1 3/16	1 7/8	7 3/32	1 31/32	5 1/2	21/32	25/32	9/16	3 21/32	2 3/32	1.969	0.689	1/2 M14	NAP306-19E	P306E	NA306-19	
	47.6	180	50	140	17	20	14.6	92.6	53	50	17.5					
1 7/16	2 1/8	8 9/32	2 7/32	6 5/16	21/32	31/32	21/32	4 1/8	2 9/16	2.031	0.720	1/2 M14	NAP307-23E	P307E	NA307-23	
	54	210	56	160	17	25	17	105	65	51.6	18.3					
1 1/2	2 3/8	8 21/32	2 3/8	6 11/16	21/32	1 1/16	3/4	4 21/32	2 9/16	2.248	0.780	1/2 M14	NAP308-24E	P308E	NA308-24	
	60.3	220	60	170	17	27	19.3	118.3	65	57.1	19.8					
1 11/16	2 5/8	9 21/32	2 5/8	7 15/32	25/32	1 3/16	13/16	5 3/16	2 15/16	2.311	0.780	5/8 M16	NAP309-27E	P309E	NA309-27	
	66.7	245	67	190	20	30	20.7	131.7	75	58.7	19.8					
1 15/16	2 13/16	10 13/16	2 15/16	8 11/32	25/32	1 3/8	13/16	5 11/16	3 15/32	2.622	0.969	5/8 M16	NAP310-31E	P310E	NA310-31	
	71.4	275	75	212	20	35	20.4	144.4	88	66.6	24.6					
2 3/16	3 1/16	12 7/32	3 5/32	9 9/32	25/32	1 1/2	31/32	6 1/8	3 17/32	2.874	1.094	5/8 M16	NAP311-35E	P311E	NA311-35	
	77.8	310	80	236	20	38	24.8	155.8	90	73	27.8					
2 7/16	3 5/16	13	3 11/32	9 27/32	31/32	1 1/2	1 3/32	6 17/32	4 1/16	3.126	1.220	3/4 M20	NAP312-39E	P312E	NA312-39	
	84.1	330	85	250	25	38	28.1	166.1	103	79.4	31					
2 11/16	3 13/16	14 3/16	3 17/32	11 1/32	1 1/16	1 9/16	1 7/16	7 13/32	4 11/32	3.626	1.343	7/8 M22	NAP314-43E	P314E	NA314-43	
	96.8	360	90	280	27	40	36.8	187.8	110	92.1	34.1					
2 15/16	4 1/8	14 31/32	3 15/16	11 13/32	1 1/16	1 23/32	1 9/16	7 31/32	4 7/32	3.937	1.469	7/8 M22	NAP315-47E	P315E	NA315-47	
	104.8	380	100	290	27	44	39.8	202.8	107	100	37.3					

Remarks 1. In Part No. of unit, fitting codes follow bore diameter numbers. (See Table 10.5 in P.62.)  
 2. Part No. of applicable grease fittings are shown below.  
 A-1/4-28UNF ..... 306-308  
 A-R1/8..... 309-315



# FYH

Variations of tolerance of distance from mounting bottom to center of spherical bore ( $\Delta H_b$ )

Unit: mm

Housing No.	$\Delta H_b$
P306E~P310E	$\pm 0.15$
P311E~P315E	$\pm 0.2$

	Basic Load Ratings kN		Factor	Mass
	$C_r$	$C_{0r}$	$f_0$	kg
	26.7	15.0	13.3	2.3
	33.4	19.3	13.2	3.1
	40.7	24.0	13.2	4.1
	48.9	29.5	13.3	5.1
	62.0	38.3	13.2	7
	71.6	45.0	13.2	8.5
	81.9	52.2	13.2	10.1
	104	68.2	13.2	13.8
	113	77.2	13.2	16.8

3. As for the triple seal type product (from 201 to 205 are the double seal type products), suffix code L3 (or L2) follows the Part No. of unit or bearing.  
(Example of Part No. : NAP306JEL3, NA306L3)

4. For the dimensions and forms of applicable bearings, see the dimensional tables of ball bearing for unit.

5. Representative examples of the forms of housing are indicated.

6. Housings of nodular graphite cast iron are also available.



**Pillow Block Units**

**NAPK**  
**Cylindrical bore**  
**(with eccentric locking collar)**

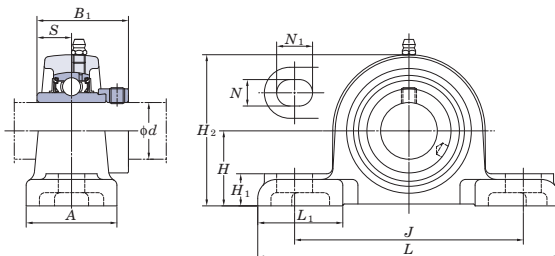

Shaft Dia		Dimensions											Bolt Size	Unit No.	Housing No.	Bearing No.
mm	inch	inch mm														
d		H	L	A	J	N	N <sub>1</sub>	H <sub>1</sub>	H <sub>2</sub>	L <sub>1</sub>	B <sub>1</sub>	S				
12	1/2												3/8	NAPK201 NAPK201-8 NAPK202 NAPK202-10 NAPK203 NAPK204-12 NAPK204	PK204	NA201 NA201-8 NA202 NA202-10 NA203 NA204-12 NA204
15	5/8	1 1/4	5 1/4	1 5/8	3 27/32	7/16	9/16	9/16	2 15/32	1 25/32	1.72	0.673				
17	3/4	31.8	133	41	98	11	14	14	63	45	43.7	17.1				
20																
25	7/8 15/16	1 5/16	5 1/2	1 23/32	4 1/8	7/16	9/16	5/8	2 11/16	1 25/32	1.748	0.689	3/8	NAPK205-14 NAPK205-15 NAPK205 NAPK205-16	PK205	NA205-14 NA205-15 NA205 NA205-16
	1	33.3	140	44	105	11	14	16	68	45	44.4	17.5				
30	1 1/8 1 3/16 1 1/4	1 9/16	6 5/16	1 7/8	4 3/4	9/16	3/4	21/32	3 5/32	1 25/32	1.906	0.72	1/2	NAPK206-18 NAPK206 NAPK206-19 NAPK206-20	PK206	NA206-18 NA206 NA206-19 NA206-20
	1 1/4	39.7	160	48	121	14	19	17	80	45	48.4	18.3				
35	1 3/16 1 3/8 1 7/16	1 13/16	6 9/16	1 7/8	5	9/16	3/4	3/4	3 5/8	1 25/32	2.012	0.74	1/2	NAPK207-20 NAPK207-21 NAPK207-22 NAPK207 NAPK207-23	PK207	NA207-20 NA207-21 NA207-22 NA207 NA207-23
	1 1/2	46	167	48	127	14	19	19	92	45	51.1	18.8				
40	1 1/2 1 9/16	1 15/16	7 1/8	2 1/8	5 3/8	9/16	1 1/32	3/4	3 15/16	1 31/32	2.217	0.843	1/2	NAPK208-24 NAPK208-25 NAPK208	PK208	NA208-24 NA208-25 NA208
	1 5/8	49.2	181	54	136.5	14	26.3	19	100	50	56.3	21.4				
45	1 5/8 1 11/16 1 3/4	2 1/16	7 15/32	2 1/8	5 7/8	9/16	1 1/8	25/32	4 3/16	2 1/16	2.217	0.843	1/2	NAPK209-26 NAPK209-27 NAPK209-28 NAPK209	PK209	NA209-26 NA209-27 NA209-28 NA209
	1 7/8	52.4	190	54	149.2	14	28.6	20	106	52	56.3	21.4				
50	1 7/8 1 15/16 2	2 3/16	8	2 1/4	6 1/4	9/16	3/4	7/8	4 13/32	25/32	2.469	0.969	1/2	NAPK210-30 NAPK210-31 NAPK210 NAPK210-32	PK210	NA210-30 NA210-31 NA210 NA210-32
	2	55.6	203	57	159	14	19	22	112	55	62.7	24.6				
55	2 1/8 2 3/16 2 1/4	2 7/16	9 1/8	2 3/8	7 1/8	23/32	15/16	31/32	4 7/8	2 19/32	2.811	1.094	5/8	NAPK211-32 NAPK211-34 NAPK211 NAPK211-35	PK211	NA211-32 NA211-34 NA211 NA211-35
	2 3/16	61.9	232	60	181	18	24	25	124	66	71.4	27.8				
60	2 1/4 2 3/8 2 7/16	2 11/16	9 1/2	2 17/32	7 17/32	23/32	15/16	13/32	5 11/32	2 9/16	3.063	1.22	5/8	NAPK212-36 NAPK212 NAPK212-38 NAPK212-39	PK212	NA212-36 NA212 NA212-38 NA212-39
	2 3/8	68.3	241	64	191	18	24	28	136	65	77.8	31				
75	2 15/16	3 5/16	11 31/32	3 7/32	9 1/2	7/8	1/4	1 1/2	6 1/2	3 7/16	3.626	1.469	3/4	NAPK215-47 NAPK215	PK215	NA215-47 NA215
	2 7/16	84.1	304	82	241	22	32	38	165	87	92.1	37.3				

Remarks 1. In Part No. of unit and units with covers, fitting codes follow bore diameter numbers. (See Table 10.5 in P.62.)  
2. Part No. of applicable grease fittings are shown below.  
A-1/4-28UNF ..... 201~210  
A-Rc1/8..... 211~215



# FYH

Variations of tolerance of distance from mounting bottom to center of spherical bore ( $\Delta H_s$ )

Unit: mm

Housing No.	$\Delta H_s$
PK204~PK210	$\pm 0.15$
PK211~PK215	$\pm 0.2$

	Basic Load Ratings kN		Factor	Mass
	$C_r$	$C_{0r}$	$f_0$	kg
	12.8	6.65	13.2	0.82
	14.0	7.85	13.9	1
	19.5	11.3	13.9	1.4
	25.7	15.4	13.9	2
	29.1	17.8	14.0	2.5
	34.1	21.3	14.0	2.7
	35.1	23.3	14.4	3.2
	43.4	29.4	14.4	4.6
	52.4	36.2	14.4	5.2
	67.4	48.3	14.5	9.6

3. For the dimensions and forms of applicable bearings, see the dimensional tables of ball bearing for unit.

4. Representative examples of the forms of housing are indicated.

5. Housings of nodular graphite cast iron are also available.



**Pillow Block Units**

**NCP  
Cylindrical bore  
(with concentric locking collar)**

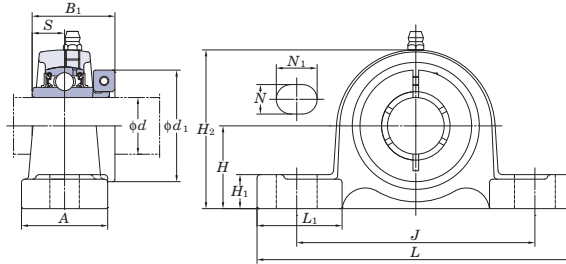

Shaft Dia. mm inch	Dimensions inch mm													Bolt Size inch mm	Unit No.	Housing No.	Bearing No.
	H	L	A	J	N	N <sub>1</sub>	H <sub>1</sub>	H <sub>2</sub>	L <sub>1</sub>	B <sub>1</sub>	S	d <sub>1</sub>					
20 3/4	1 5/16	5	1 1/2	3 3/4	1/2	23/32	5/8	2 9/16	1 13/32	1 9/32	0.500	1 3/4	3/8	NCP204-12 NCP204	P204	NC204-12 NC204	
	33.3	127	38	95	13	18	16	65	36	32.5	12.7	44.5	M10				
25 7/8 15/16	1 7/16	5 1/2	1 1/2	4 1/8	1/2	23/32	5/8	2 3/4	1 1/2	1 7/16	0.563	1 15/16	3/8	NCP205-14 NCP205-15 NCP205 NCP205-16	P205	NC205-14 NC205-15 NC205 NC205-16	
	36.5	140	38	105	13	18	16	70	38	36.5	14.3	49.2	M10				
30 1 1/8 1 3/16 1 1/4	1 11/16	6 1/2	1 7/8	4 3/4	21/32	13/16	21/32	3 5/16	1 7/8	1 9/16	0.626	2 3/16	1/2	NCP206-18 NCP206 NCP206-19 NCP206-20	P206	NC206-18 NC206 NC206-19 NC206-20	
	42.9	165	48	121	17	21	17	84	48	39.7	15.9	55.6	M14				
35 1 1/4 1 3/8	1 7/8	6 9/16	1 7/8	5	21/32	13/16	23/32	3 3/4	1 27/32	1 3/4	0.689	2 7/16	1/2	NCP207-20 NCP207-22 NCP207 NCP207-23	P207	NC207-20 NC207-22 NC207 NC207-23	
	47.6	167	48	127	17	21	18	95	47	44.5	17.5	61.9	M14				
40 1 7/16	1 7/8	6 9/16	1 7/8	5	21/32	13/16	23/32	3 3/4	1 27/32	1 3/4	0.689	2 9/16	1/2	NCP207-22 NCP207 NCP207-23	P207	NC207-22 NC207 NC207-23	
	47.6	167	48	127	17	21	18	95	47	44.5	17.5	65.1	M14				
40 1 1/2	1 15/16	7 1/4	2 1/8	5 13/32	21/32	13/16	23/32	3 27/32	2 3/32	2	0.748	2 11/16	1/2	NCP208-24 NCP208 NCP208	P208	NC208-24 NC208 NC208	
	49.2	184	54	137	17	21	18	98	53	50.8	19	68.3	M14				
45 1 5/8 1 11/16 1 3/4	2 1/8	7 15/32	2 1/8	5 3/4	21/32	13/16	25/32	4 3/16	2 5/32	2	0.748	2 13/16	1/2	NCP209-26 NCP209-27 NCP209-28 NCP209	P209	NC209-26 NC209-27 NC209-28 NC209	
	54	190	54	146	17	21	20	106	55	50.8	19	71.4	M14				
50 1 15/16 2	2 1/4	8 1/8	2 3/8	6 1/4	25/32	7/8	13/16	4 7/16	2 3/8	2 3/32	0.748	3 3/8	5/8	NCP210-31 NCP210 NCP210-32	P210	NC210-31 NC210 NC210-32	
	57.2	206	60	159	20	22	21	113	60	53.1	19	85.7	M16				
55 2 2 3/16	2 1/2	8 5/8	2 3/8	6 23/32	25/32	7/8	29/32	4 29/32	2 9/16	2 1/4	0.874	3 1/2	5/8	NCP211-32 NCP211 NCP211-35	P211	NC211-32 NC211 NC211-35	
	63.5	219	60	171	20	22	23	125	65	57.1	22.2	88.9	M16				
60 2 1/4 2 3/8 2 7/16	2 1/2	8 5/8	2 3/8	6 23/32	25/32	7/8	29/32	4 29/32	2 9/16	2 1/4	0.874	3 5/8	5/8	NCP211 NCP211-35	P211	NC211 NC211-35	
	63.5	219	60	171	20	22	23	125	65	57.1	22.2	92.1	M16				
60 2 3/8 2 7/16	2 3/4	9 1/2	2 3/4	7 1/4	25/32	31/32	31/32	5 7/16	2 7/8	2 5/8	1.000	4 1/16	5/8	NCP212-36 NCP212	P212	NC212-36 NC212	
	69.8	241	70	184	20	25	25	138	73	66.7	25.4	103.2	M16				
60 2 3/8 2 7/16	2 3/4	9 1/2	2 3/4	7 1/4	25/32	31/32	31/32	5 7/16	2 7/8	2 5/8	1.000	4 1/8	5/8	NCP212 NCP212-39	P212	NC212 NC212-39	
	69.8	241	70	184	20	25	25	138	73	66.7	25.4	104.8	M16				

Remarks 1. In Part No. of unit, fitting codes follow bore diameter codes. (See Table 10.5 in P.62.)  
2. Part No. of applicable grease fittings are shown below.  
A-1/4-28UNF ..... 204-210  
A-R1/8..... 211-212





# FYH

Variations of tolerance of distance from mounting bottom to center of spherical bore ( $\Delta H_b$ )

Unit: mm

Housing No.	$\Delta H_b$
P204~P210	$\pm 0.15$
P211~P212	$\pm 0.2$

	Basic Load Ratings kN		Factor	Mass
	$C_r$	$C_{0r}$	$f_0$	kg
	12.8	6.65	13.2	0.8
	14.0	7.85	13.9	1.0
	19.5	11.3	13.9	1.5
	25.7	15.4	13.9	1.9
	25.7	15.4	13.9	1.9
	29.1	17.8	14.0	2.4
	34.1	21.3	14.0	2.6
	34.1	21.3	14.0	2.6
	35.1	23.3	14.4	3.5
	43.4	29.4	14.4	4.0
	43.4	29.4	14.4	4.0
	52.4	36.2	14.4	5.6
	52.4	36.2	14.4	5.6

3. For the dimensions and forms of applicable bearings, see the dimensional tables of ball bearing for unit.  
4. Representative examples of the forms of housing are indicated.



**Pillow Block Units**

**UKP  
Tapered bore (with adapter)**  
 $d_1$  20 ~ (50) mm

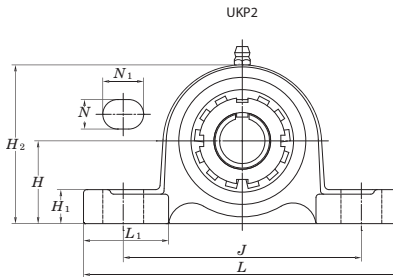
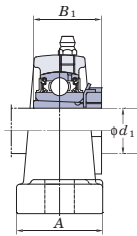

Shaft Dia. mm inch	Dimensions inch mm											Bolt Size inch mm	Standard		
	$H$	$L$	$A$	$J$	$N$	$N_1$	$H_1$	$H_2$	$L_1$	$B_1$	Unit No.		Housing No.	Bearing No.	
20 $d_1$	$3/4$	$1\ 7/16$	$5\ 1/2$	$1\ 1/2$	$4\ 1/8$	$1/2$	$23/32$	$5/8$	$2\ 3/4$	$1\ 1/2$	$1\ 3/8$	$3/8$	UKP205	P205	UK205
	$3/4$	$1\ 3/4$	$6\ 1/4$	$2$	$4\ 11/16$	$21/32$	$31/32$	$5/8$	$3\ 3/8$	$1\ 27/32$	$1\ 3/8$	$1/2$	UKPX05	PX05	UKX05
	$3/4$	$1\ 49/64$	$6\ 7/8$	$1\ 3/4$	$5\ 3/16$	$21/32$	$25/32$	$5/8$	$3\ 11/32$	$2\ 5/32$	$1\ 3/8$	$1/2$	UKP305	P305	UK305
25	1	$1\ 11/16$	$6\ 1/2$	$1\ 7/8$	$4\ 3/4$	$21/32$	$13/16$	$21/32$	$3\ 5/16$	$1\ 7/8$	$1\ 1/2$	$1/2$	UKP206	P206	UK206
	1	$1\ 7/8$	$6\ 7/8$	$2\ 1/4$	$5$	$21/32$	$31/32$	$21/32$	$3\ 21/32$	$2\ 5/32$	$1\ 1/2$	$1/2$	UKPX06	PX06	UKX06
	1	$1\ 31/32$	$7\ 3/32$	$1\ 31/32$	$5\ 1/2$	$21/32$	$25/32$	$21/32$	$3\ 3/4$	$2\ 3/32$	$1\ 1/2$	$1/2$	UKP306	P306	UK306
30	$1\ 1/8$	$1\ 7/8$	$6\ 9/16$	$1\ 7/8$	$5$	$21/32$	$13/16$	$23/32$	$3\ 3/4$	$1\ 27/32$	$1\ 11/16$	$1/2$	UKP207	P207	UK207
	$1\ 1/8$	$1\ 7/8$	$6\ 9/16$	$1\ 7/8$	$5$	$21/32$	$13/16$	$23/32$	$3\ 3/4$	$1\ 27/32$	$1\ 11/16$	$1/2$	UKPX07	PX07	UKX07
	$1\ 1/8$	$1\ 7/8$	$6\ 9/16$	$1\ 7/8$	$5$	$21/32$	$13/16$	$23/32$	$3\ 3/4$	$1\ 27/32$	$1\ 11/16$	$1/2$	UKP307	P307	UK307
35	$1\ 1/4$	$1\ 15/16$	$7\ 1/4$	$2\ 1/8$	$5\ 13/32$	$21/32$	$13/16$	$23/32$	$3\ 27/32$	$2\ 3/32$	$1\ 13/16$	$1/2$	UKP208	P208	UK208
	$1\ 3/8$	$1\ 15/16$	$7\ 1/4$	$2\ 1/8$	$5\ 13/32$	$21/32$	$13/16$	$23/32$	$3\ 27/32$	$2\ 3/32$	$1\ 13/16$	$1/2$	UKPX08	PX08	UKX08
	$1\ 3/8$	$2\ 5/16$	$8\ 3/4$	$2\ 5/8$	$6\ 5/32$	$25/32$	$1\ 1/4$	$13/16$	$4\ 1/2$	$2\ 25/32$	$1\ 13/16$	$5/8$	UKP308	P308	UK308
40	$1\ 1/2$	$2\ 1/8$	$7\ 15/32$	$2\ 1/8$	$5\ 3/4$	$21/32$	$13/16$	$25/32$	$4\ 3/16$	$2\ 5/32$	$1\ 31/32$	$1/2$	UKP209	P209	UK209
	$1\ 1/2$	$2\ 1/8$	$7\ 15/32$	$2\ 1/8$	$5\ 3/4$	$21/32$	$13/16$	$25/32$	$4\ 3/16$	$2\ 5/32$	$1\ 31/32$	$1/2$	UKPX09	PX09	UKX09
	$1\ 1/2$	$2\ 5/16$	$8\ 3/4$	$2\ 5/8$	$6\ 5/32$	$25/32$	$1\ 5/16$	$13/16$	$4\ 9/16$	$2\ 25/32$	$1\ 31/32$	$5/8$	UKP309	P309	UK309
45	$1\ 3/4$	$2\ 41/64$	$9\ 21/32$	$2\ 5/8$	$7\ 15/32$	$25/32$	$1\ 3/16$	$13/16$	$5\ 3/16$	$2\ 15/16$	$1\ 31/32$	$5/8$	UKP210	P210	UK210
	$1\ 3/4$	$2\ 41/64$	$9\ 21/32$	$2\ 5/8$	$7\ 15/32$	$25/32$	$1\ 3/16$	$13/16$	$5\ 3/16$	$2\ 15/16$	$1\ 31/32$	$5/8$	UKPX10	PX10	UKX10
	$1\ 3/4$	$2\ 1/4$	$8\ 1/8$	$2\ 3/8$	$6\ 1/4$	$25/32$	$7/8$	$13/16$	$4\ 7/16$	$2\ 3/8$	$2\ 5/32$	$5/8$	UKP310	P310	UK310
50	$1\ 7/8$	$2\ 1/2$	$9\ 1/2$	$2\ 7/8$	$6\ 23/32$	$25/32$	$1\ 13/32$	$7/8$	$4\ 31/32$	$3$	$2\ 5/32$	$5/8$	UKP211	P211	UK211
	2	$2\ 1/2$	$9\ 1/2$	$2\ 7/8$	$6\ 23/32$	$25/32$	$1\ 13/32$	$7/8$	$4\ 31/32$	$3$	$2\ 5/32$	$5/8$	UKPX11	PX11	UKX11
	2	$2\ 3/4$	$10\ 1/4$	$3\ 1/8$	$7\ 1/4$	$31/32$	$1\ 13/32$	$1\ 3/32$	$5\ 15/32$	$3\ 9/32$	$2\ 5/16$	$3/4$	UKP311	P311	UK311

Remarks  
 1. In Part No. of unit and units with covers, fitting codes follow bore diameter numbers. (See Table 10.5 in P.62.)  
 2. Part No. of applicable grease fittings are shown below.  
 A-1/4-28UNF ..... 205~210, X05~X09, 305~308  
 A-R1/8..... 211~218, X10~X20, 309~328

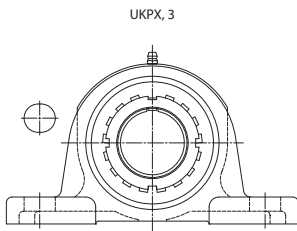

With Pressed Steel Cover

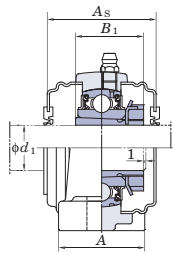

With Cast Iron Cover

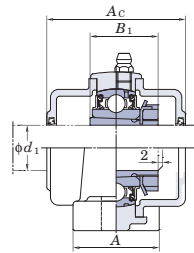

Variations of tolerance of distance from mounting bottom to center of spherical bore ( $\Delta H_{2c}$ )

Housing No.		Unit: mm
P205~P210	PX05~PX10	$\pm 0.15$
P211~P218	PX11~PX18	$\pm 0.2$
	PX20	$\pm 0.3$
	P319~P328	$\pm 0.3$

Forms and dimensions of  $H_{2c}$  of P205/E3 (housing with cast iron cover) are shown below.

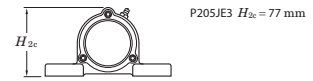

P205/E3  $H_{2c} = 77$  mm

Adapter No.	Mass kg	Basic Load Ratings kN		Factor $f_0$	With Pressed Steel Cover				With Cast Iron Cover						
		$C_r$	$C_{Or}$		Unit No.		Dimension mm inch		Mass kg	Unit No.		Dimension mm inch		Mass kg	
					Open Type	One Side Closed Type	$A_s$			Open Type	One Side Closed Type	$A_c$			
HE2305X	0.84														
H2305X	0.84	14.0	7.85	13.9											
HE2305X	1.5														
H2305X	1.5	19.5	11.3	13.9	UKPX05C	UKPX05CD	53	2 3/32	1.5						
HE2305X	1.7														
H2305X	1.7	21.2	10.9	12.6						UKP305C	UKP305CD	76	3	2.3	
H2306X	1.4				UKP206C	UKP206CD	53	2 3/32	1.4	UKP206FC	UKP206FCD	70	2 3/4	1.9	
HE2306X	1.4	19.5	11.3	13.9											
H2306X	2.1				UKPX06C	UKPX06CD	60	2 3/8	2.1						
HE2306X	2.1	25.7	15.4	13.9											
H2306X	2.3									UKP306C	UKP306CD	82	3 7/32	2.9	
HE2306X	2.3	26.7	15.0	13.3											
HS2307X	1.7														
H2307X	1.7	25.7	15.4	13.9	UKP207C	UKP207CD	60	2 3/8	1.7	UKP207FC	UKP207FCD	78	3 1/16	2.5	
HS2307X	2.7														
H2307X	2.7	29.1	17.8	14.0	UKPX07C	UKPX07CD	69	2 23/32	2.7						
HS2307X	3.0														
H2307X	3.0	33.4	19.3	13.2						UKP307C	UKP307CD	88	3 15/32	3.9	
HE2308X	2.0														
HS2308X	2.0	29.1	17.8	14.0											
H2308X	2.0				UKP208C	UKP208CD	69	2 23/32	2.0	UKP208FC	UKP208FCD	86	3 3/8	2.9	
HE2308X	3.5														
HS2308X	3.5	34.1	21.3	14.0											
H2308X	3.5				UKPX08C	UKPX08CD	69	2 23/32	3.5						
HE2308X	3.8														
HS2308X	3.8	40.7	24.0	13.2						UKP308C	UKP308CD	96	3 25/32	5.2	
H2308X	3.8														
HE2309X	2.3														
H2309X	2.3	34.1	21.3	14.0	UKP209C	UKP209CD	69	2 23/32	2.3	UKP209FC	UKP209FCD	88	3 15/32	3.2	
HE2309X	3.7														
H2309X	3.7	35.1	23.3	14.4	UKPX09C	UKPX09CD	74	2 29/32	3.7						
HE2309X	5.0														
H2309X	5.0	48.9	29.5	13.3						UKP309C	UKP309CD	102	4 1/32	6.3	
HE2310X	3.0														
H2310X	3.0	35.1	23.3	14.4	UKP210C	UKP210CD	74	2 29/32	3.0	UKP210FC	UKP210FCD	97	3 13/16	4.1	
HE2310X	4.6														
H2310X	4.6	43.4	29.4	14.4	UKPX10C	UKPX10CD	76	3	4.6						
HE2310X	6.7														
H2310X	6.7	62.0	38.3	13.2						UKP310C	UKP310CD	110	4 11/32	8.4	
HE2311X	3.7														
H2311X	3.7	43.4	29.4	14.4	UKP211C	UKP211CD	76	3	3.7	UKP211FC	UKP211FCD	99	3 29/32	5.0	
HE2311X	3.7														
HS2311X	6.2														
H2311X	6.2	52.4	36.2	14.4	UKPX11C	UKPX11CD	89	3 1/2	6.2						
HE2311X	6.2														

- In Part No. of unit with adapters and bearing with adapters, Part No. of applicable adapter follow the Part No. shown in the dimensional tables. (Example of Part No. : UKP206J + H2306X, UK206 + H2306X)
- As for the triple seal type product (205 is the double seal type product), suffix code L3 (or L2) follows the Part No. of unit or bearing.
- For the dimensions and forms of applicable bearings and adapters, see the dimensional tables of ball bearing for unit and adapter.
- Representative examples of the forms of housing are indicated.
- Housings of nodular graphite cast iron are also available.



**Pillow Block Units**

**UKP**

**Tapered bore (with adapter)**  
 $d_1$  (50) ~ (90) mm

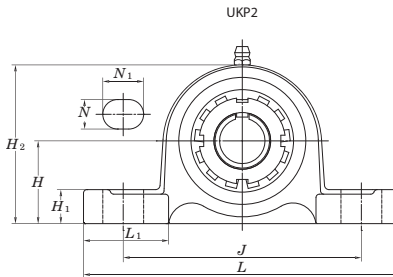
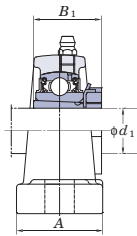

Shaft Dia. mm	inch	Dimensions inch mm										Bolt Size inch mm	Standard				
		H	L	A	J	N	N <sub>1</sub>	H <sub>1</sub>	H <sub>2</sub>	L <sub>1</sub>	B <sub>1</sub>		Unit No.	Housing No.	Bearing No.		
$d_1$																	
50	1 7/8	3 5/32	12 7/32	3 5/32	9 9/32	25/32	1 1/2	1 1/16	6 7/32	3 17/32	2 5/16	5/8	UKP311	P311	UK311		
	2	80	310	80	236	20	38	27	158	90	59	M16					
55	2 1/8	2 3/4	9 1/2	2 3/4	7 1/4	25/32	3 1/32	3 1/32	5 7/16	2 7/8	2 7/16	5/8	UKP212	P212	UK212		
	2 1/8	69.8	241	70	184	20	25	25	138	73	62	M16					
	2 1/8	3	11 1/4	3 1/4	8	3 1/32	1 9/16	1 3/32	5 31/32	3 15/32	2 7/16	3/4	UKPX12	PX12	UKX12		
	2 1/8	76.2	286	83	203	25	40	28	152	88	62	M20					
60	2 1/4	3 11/32	13	3 11/32	9 27/32	3 1/32	1 1/2	1 5/32	6 9/16	4 1/16	2 7/16	3/4	UKP312	P312	UK312		
	2 1/4	85	330	85	250	25	38	29	167	103	62	M20					
	2 3/8	3	10 7/16	2 3/4	8	3 1/32	1 3/16	1 1/16	5 29/32	3 1/16	2 9/16	3/4	UKP213	P213	UK213		
	2 3/8	76.2	265	70	203	25	30	27	150	78	65	M20					
65	2 1/4	3	11 1/4	3 1/4	8	3 1/32	1 9/16	1 3/32	6 3/32	3 15/32	2 9/16	3/4	UKPX13	PX13	UKX13		
	2 3/8	76.2	286	83	203	25	40	28	155	88	65	M20					
	2 1/4	3 35/64	13 3/8	3 17/32	10 1/4	3 1/32	1 1/2	1 1/4	6 15/16	4 11/32	2 9/16	3/4	UKP313	P313	UK313		
	2 3/8	90	340	90	260	25	38	32	176	110	65	M20					
70	2 1/2	3 1/4	10 13/16	2 29/32	8 17/32	3 1/32	1 3/16	1 3/32	6 3/8	3 1/16	2 7/8	3/4	UKP215	P215	UK215		
	2 1/2	82.6	275	74	217	25	30	28	162	78	73	M20					
	2 1/2	3 1/2	13	3 1/2	9	1 1/16	1 31/32	1 1/4	6 7/8	3 29/32	2 7/8	7/8	UKPX15	PX15	UKX15		
	2 1/2	88.9	330	89	229	27	50	32	175	99	73	M22					
75	2 1/2	3 15/16	14 31/32	3 15/16	11 13/32	1 1/16	1 9/16	1 3/8	7 25/32	4 7/32	2 7/8	7/8	UKP315	P315	UK315		
	2 1/2	100	380	100	290	27	40	35	198	107	73	M22					
	2 3/4	3 1/2	11 1/2	3 1/16	9 1/8	3 1/32	1 3/8	1 3/16	6 27/32	3 9/32	3 1/16	3/4	UKP216	P216	UK216		
	2 3/4	88.9	292	78	232	25	35	30	174	83	78	M20					
80	2 3/4	4	15	4	11 1/8	1 1/16	1 1/16	2 9/32	7 11/16	4 9/16	3 1/16	7/8	UKPX16	PX16	UKX16		
	2 3/4	101.6	381	102	283	27	58	34	195	116	78	M22					
	2 3/4	4 11/64	15 3/4	4 11/32	11 13/16	1 1/16	1 9/16	1 3/8	8 7/32	4 23/32	3 1/16	7/8	UKP316	P316	UK316		
	2 3/4	106	400	110	300	27	40	35	209	120	78	M22					
85	3	3 3/4	12 7/32	3 9/32	9 23/32	3 1/32	1 3/8	1 1/4	7 9/32	3 7/16	3 7/32	3/4	UKP217	P217	UK217		
	3	95.2	310	83	247	25	35	32	185	87	82	M20					
	3	4	15	4	11 1/8	1 1/16	2 3/8	1 11/32	7 7/8	4 9/16	3 7/32	7/8	UKPX17	PX17	UKX17		
	3	101.6	381	102	283	27	60	34	200	116	82	M22					
90	3	4 13/32	16 17/32	4 11/32	12 19/32	1 5/16	1 25/32	1 9/16	8 21/32	4 23/32	3 7/32	1	UKP317	P317	UK317		
	3	112	420	110	320	33	45	40	220	120	82	M27					
	3	4	12 7/8	3 15/32	10 5/16	1 1/16	1 9/16	1 5/16	7 25/32	3 11/16	3 3/8	7/8	UKP218	P218	UK218		
	3	101.6	327	88	262	27	40	33	198	94	86	M22					
95	3	4	15	4 3/8	11 1/8	1 1/16	2 3/8	1 1/2	8 1/32	4 9/16	3 3/8	7/8	UKPX18	PX18	UKX18		
	3	101.6	381	111	283	27	60	38	204	116	86	M22					
	3	4 41/64	16 15/16	4 11/32	13	1 5/16	1 25/32	1 9/16	9 7/32	4 23/32	3 3/8	1	UKP318	P318	UK318		
	3	118	430	110	330	33	45	40	234	120	86	M27					
95	3 1/4	4 59/64	18 1/2	4 23/32	14 3/16	1 13/32	1 31/32	1 13/16	9 3/4	4 29/32	3 17/32	1 1/8	UKP319	P319	UK319		
	3 1/4	125	470	120	360	36	50	46	248	125	90	M30					
95	3 1/2	5	17	4 3/4	13 1/4	1 5/16	2 9/16	1 25/32	9 21/32	4 31/32	3 13/16	1	UKPX20	PX20	UKX20		
	3 1/2	127	432	121	337	33	65	45	245	126	97	M27					

Remarks 1. In Part No. of unit and units with covers, fitting codes follow bore diameter numbers. (See Table 10.5 in P62.)  
2. Part No. of applicable grease fittings are shown below.  
A-1/4-28UNF ..... 205~210, X05~X09, 305~308  
A-R1/8..... 211~218, X10~X20, 309~328





**Pillow Block Units**

**UKP**  
**Tapered bore (with adapter)**  
 $d_1$  (90) ~ 125 mm

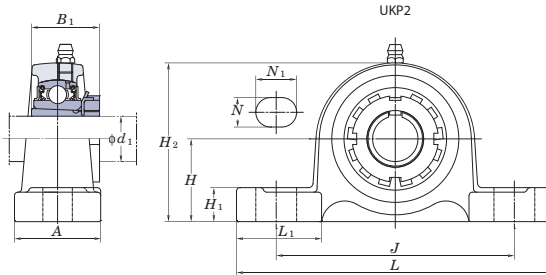

Shaft Dia.		Dimensions										Bolt Size	Standard		
mm	inch	inch mm											Unit No.	Housing No.	Bearing No.
$d_1$		H	L	A	J	N	N <sub>1</sub>	H <sub>1</sub>	H <sub>2</sub>	L <sub>1</sub>	B <sub>1</sub>	inch mm			
90	3 1/2	5 33/64	19 9/32	4 23/32	14 31/32	1 13/32	1 31/32	1 13/16	10 3/4	5 1/2	3 13/16	1 1/8	UKP320	P320	UK320
		140	490	120	380	36	50	46	273	140	97	M30			
100	4	5 29/32	20 15/32	5 1/2	15 3/4	1 9/16	2 5/32	1 31/32	11 21/32	5 29/32	4 1/8	1 1/4	UKP322	P322	UK322
		150	520	140	400	40	55	50	296	150	105	M33			
110	—	6 19/64	22 7/16	5 1/2	17 23/32	1 9/16	2 5/32	1 31/32	12 7/16	6 5/16	4 13/32	1 1/4	UKP324	P324	UK324
		160	570	140	450	40	55	50	316	160	112	M33			
115	4 1/2	7 3/32	23 5/8	5 1/2	18 29/32	1 9/16	2 5/32	1 31/32	13 21/32	7 11/16	4 3/4	1 1/4	UKP326	P326	UK326
		180	600	140	480	40	55	50	355	195	121	M33			
125	—	7 7/8	24 13/32	5 1/2	19 11/16	1 9/16	2 5/32	2 3/8	15 15/32	7 9/32	5 5/32	1 1/4	UKP328	P328	UK328
		200	620	140	500	40	55	60	393	185	131	M33			

Remarks 1. In Part No. of unit and units with covers, fitting codes follow bore diameter numbers. (See Table 10.5 in P.62.)  
 2. Part No. of applicable grease fittings are shown below.  
 A-1/4-28UNF ..... 205~210, X05~X09, 305~308  
 A-R1/8..... 211~218, X10~X20, 309~328

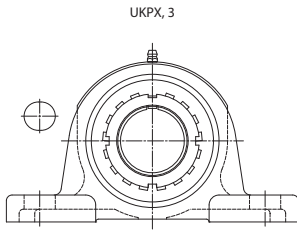

With Pressed Steel Cover

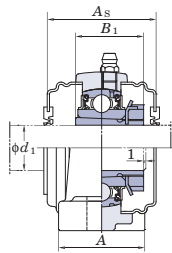

With Cast Iron Cover

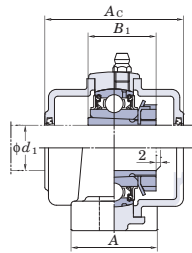

Variations of tolerance of distance from mounting bottom to center of spherical bore ( $\Delta H_s$ )

Housing No.			Unit: mm
P205~P210	PX05~PX10	P305~P310	$\pm 0.15$
P211~P218	PX11~PX18	P311~P318	$\pm 0.2$
	PX20	P319~P328	$\pm 0.3$

Forms and dimensions of  $H_{2c}$  of P205/E3 (housing with cast iron cover) are shown below.

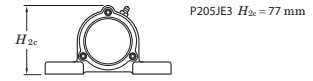

Adapter No.	Mass kg	Basic Load Ratings kN		Factor $f_0$	With Pressed Steel Cover				With Cast Iron Cover					
		$C_r$	$C_{0r}$		Unit No.		Dimension mm inch		Mass kg	Unit No.		Dimension mm inch		Mass kg
					Open Type	One Side Closed Type	$A_s$			Open Type	One Side Closed Type	$A_c$		
HE2320X	34.8	173	141	13.2	—	—	—	—	—	—	—	—	—	—
H2320X	34.8				UKP320C	UKP320CD	174	6 <sup>27</sup> / <sub>32</sub>	41.0					
H2322X	43.9				UKP322C	UKP322CD	188	7 <sup>13</sup> / <sub>32</sub>	50.8					
HE2322X	43.9	205	180	13.2	—	—	—	—	—	—	—	—	—	
H2324	55.7	207	185	13.5	—	—	—	—	UKP324C	UKP324CD	196	7 <sup>23</sup> / <sub>32</sub>	66.0	
HE2326	71.9	229	214	13.6	—	—	—	—	—	—	—	—	—	—
H2326	71.9				UKP326C	UKP326CD	214	8 <sup>7</sup> / <sub>16</sub>	85.2					
H2328	92.5				UKP328C	UKP328CD	222	8 <sup>3</sup> / <sub>4</sub>	109					

- In Part No. of unit with adapters and bearing with adapters, Part No. of applicable adapter follow the Part No. shown in the dimensional tables.  
(Example of Part No. : UKP206J + H2306X, UK206 + H2306X)
- As for the triple seal type product (205 is the double seal type product), suffix code L3 (or L2) follows the Part No. of unit or bearing.
- For the dimensions and forms of applicable bearings and adapters, see the dimensional tables of ball bearing for unit and adapter.
- Representative examples of the forms of housing are indicated.
- Housings of nodular graphite cast iron are also available.



**Thick Pillow Block Units**

**UCIP**  
**Cylindrical bore (with set screws)**  
**d 40 ~ 140 mm**

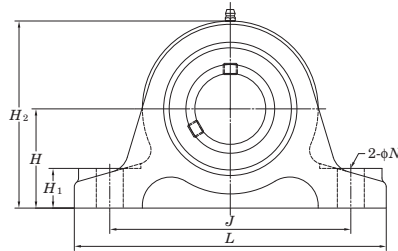
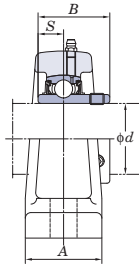
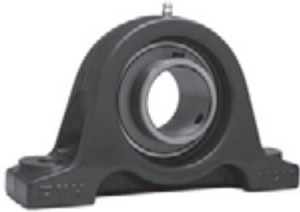

Shaft Dia. mm inch	Dimensions										Bolt Size inch mm	Standard		
			inch		mm							Unit No.	Housing No.	Bearing No.
<i>d</i>	<i>H</i>	<i>L</i>	<i>A</i>	<i>J</i>	<i>N</i>	<i>H</i> <sub>1</sub>	<i>H</i> <sub>2</sub>	<i>B</i>	<i>S</i>					
40	1 1/2	2 23/64	7 7/8	2 3/8	5 29/32	3/4	31/32	4 17/32	1.937	0.748	5/8 M16	UCIP208-24 UCIP208-25 UCIP208	IP208	UC208-24 UC208-25 UC208
	1 9/16	60	200	60	150	19	25	115	49.2	19				
45	1 5/8	2 3/4	8 9/32	2 3/8	6 19/64	3/4	31/32	5 1/32	1.937	0.748	5/8 M16	UCIP209-26 UCIP209-27 UCIP209-28 UCIP209	IP209	UC209-26 UC209-27 UC209-28 UC209
	1 11/16 1 3/4	70	210	60	160	19	25	128	49.2	19				
50	1 7/8	2 3/4	8 21/32	2 3/8	6 11/16	3/4	1 3/32	5 3/16	2.031	0.748	5/8 M16	UCIP210-30 UCIP210-31 UCIP210 UCIP210-32	IP210	UC210-30 UC210-31 UC210 UC210-32
	1 15/16 2	70	220	60	170	19	28	132	51.6	19				
55	2	3 5/32	9 1/16	2 3/8	7 3/32	3/4	1 3/32	5 13/16	2.189	0.874	5/8 M16	UCIP211-32 UCIP211-34 UCIP211 UCIP211-35	IP211	UC211-32 UC211-34 UC211 UC211-35
	2 1/8 2 3/16	80	230	60	180	19	28	148	55.6	22.2				
60	2 1/4	3 5/32	10 1/4	2 3/4	7 7/8	7/8	1 3/16	6 3/32	2.563	1.000	3/4 M20	UCIP212-36 UCIP212 UCIP212-38 UCIP212-39	IP212	UC212-36 UC212 UC212-38 UC212-39
	2 3/8 2 7/16	80	260	70	200	22	30	155	65.1	25.4				
65	2 1/2	3 35/64	11 1/32	2 3/4	8 21/32	7/8	1 3/16	6 25/32	2.563	1.000	3/4 M20	UCIP213-40 UCIP213	IP213	UC213-40 UC213
	2 1/2	90	280	70	220	22	30	172	65.1	25.4				
70	2 3/4	4 21/64	12 7/32	2 3/4	9 27/32	7/8	1 3/16	8 3/16	2.953	1.181	3/4 M20	UCIP313-40 UCIP313	IP313	UC313-40 UC313
	2 3/4	110	310	70	250	22	30	208	75	30				
75	2 3/4	4 21/64	13	2 15/16	10 5/8	31/32	1 3/8	8 15/32	3.071	1.299	7/8 M22	UCIP314-44 UCIP314	IP314	UC314-44 UC314
	2 15/16 3	110	330	75	270	25	35	215	78	33				
80	3	4 23/32	13 3/8	2 15/16	11 1/32	31/32	1 3/8	9 1/16	3.228	1.260	7/8 M22	UCIP315-47 UCIP315 UCIP315-48	IP315	UC315-47 UC315 UC315-48
	3	120	340	75	280	25	35	230	82	32				
85	3 1/8	4 23/32	13 25/32	3 11/32	11 27/64	31/32	1 9/16	9 1/4	3.386	1.339	7/8 M22	UCIP316	IP316	UC316
	3 1/8	120	350	85	290	25	40	235	86	34				
90	3 1/2	5 1/8	14 9/16	3 11/32	12 13/64	31/32	1 9/16	10 1/32	3.780	1.575	7/8 M22	UCIP317	IP317	UC317
	3 1/2	130	370	85	310	25	40	255	96	40				
95	3 3/4	5 1/8	15 3/4	3 11/32	13	1 5/32	1 25/32	10 1/4	3.780	1.575	1 M27	UCIP318-56 UCIP318	IP318	UC318-56 UC318
	3 3/4	130	400	85	330	29	45	260	96	40				
100	4	5 29/32	16 5/32	3 11/32	13 25/64	1 5/32	1 25/32	11 7/32	4.055	1.614	1 M27	UCIP319	IP319	UC319
	4	150	410	85	340	29	45	285	103	41				
110	4 1/2	5 29/32	16 15/16	3 11/32	14 11/64	1 5/32	1 25/32	11 5/8	4.252	1.654	1 M33	UCIP320 UCIP320-63 UCIP320-64	IP320	UC320 UC320-63 UC320-64
	4 1/2	150	430	85	360	29	45	295	108	42				
120	5	6 11/16	19 9/32	3 15/16	16 9/64	1 1/4	1 31/32	13 3/16	4.606	1.811	1 1/8 M30	UCIP322	IP322	UC322
	5	170	490	100	410	32	50	335	117	46				
130	5 1/2	6 11/16	20 3/32	3 15/16	16 59/64	1 1/4	1 31/32	13 19/32	4.961	2.008	1 1/8 M30	UCIP324	IP324	UC324
	5 1/2	170	510	100	430	32	50	345	126	51				
140	6	7 7/8	21 21/32	4 11/32	18 1/2	1 1/4	1 31/32	15 11/32	5.315	2.126	1 1/8 M30	UCIP326	IP326	UC326
	6	200	550	110	470	32	50	390	135	54				
140	6 1/2	7 7/8	23 7/32	4 11/32	19 11/16	1 3/8	2 5/32	15 3/4	5.709	2.323	1 1/4 M33	UCIP328	IP328	UC328
	6 1/2	200	590	110	500	35	55	400	145	59				

Remarks 1. In Part No. of unit and units with covers, fitting codes follow bore diameter numbers. (See Table 10.5 in P.62.)  
2. Part No. of applicable grease fittings are shown below.  
A-1/4-28UNF ..... 208~210  
A-R1/8..... 211~213, 313~328



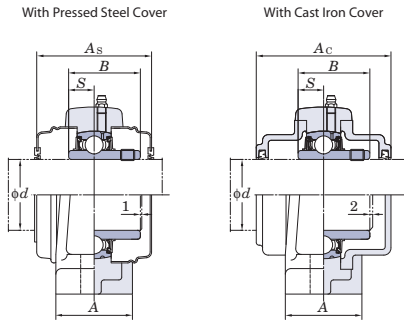

Variations of tolerance of distance from mounting bottom to center of spherical bore ( $\Delta H_s$ ), variations of tolerance of distance between centers of bolt holes ( $\Delta H_b$ ) and variations of tolerance of bolt hole diameter ( $\Delta H_v$ )

Housing No.		$\Delta H_s$	$\Delta H_b$	$\Delta H_v$
IP208~IP210		$\pm 0.15$	$\pm 0.5$	$\pm 0.2$
IP211~IP213	IP313~IP318	$\pm 0.2$	$\pm 0.7$	$\pm 0.2$
	IP319~IP328	$\pm 0.3$		$\pm 0.3$

Unit: mm

Mass	Basic Load Ratings		Factor	With Pressed Steel Cover			Mass	With Cast Iron Cover			Mass		
	kg	$C_r$		$C_{0r}$	Unit No.	Dimension		mm	inch	Unit No.		Dimension	mm
3.4	29.1	17.8	14.0	UCIP208C	UCIP208CD	69	2 23/32	3.4	UCIP208FC	UCIP208FCD	86	3 3/8	4.2
3.9	34.1	21.3	14.0	UCIP209C	UCIP209CD	69	2 23/32	3.9	UCIP209FC	UCIP209FCD	88	3 15/32	4.7
4.8	35.1	23.3	14.4	UCIP210C	UCIP210CD	74	2 29/32	4.8	UCIP210FC	UCIP210FCD	97	3 13/16	5.8
5.3	43.4	29.4	14.4	UCIP211C	UCIP211CD	76	3	5.3	UCIP211FC	UCIP211FCD	99	3 29/32	6.3
7.2	52.4	36.2	14.4	UCIP212C	UCIP212CD	89	3 1/2	7.2	UCIP212FC	UCIP212FCD	114	4 1/2	8.7
8.8	57.2	40.1	14.4	UCIP213C	UCIP213CD	89	3 1/2	8.8	UCIP213FC	UCIP213FCD	114	4 1/2	10.5
13.4	92.7	59.9	13.2						UCIP313C	UCIP313CD	122	4 13/16	15.5
15.3	104	68.2	13.2						UCIP314C	UCIP314CD	124	4 7/8	17.6
17.6	113	77.2	13.2						UCIP315C	UCIP315CD	134	5 9/32	20.1
20.3	123	86.7	13.3						UCIP316C	UCIP316CD	138	5 7/16	23.2
25.9	133	96.8	13.3						UCIP317C	UCIP317CD	146	5 3/4	29.2
28.6	143	107	13.3						UCIP318C	UCIP318CD	150	5 29/32	32.4
31.7	153	119	13.3						UCIP319C	UCIP319CD	162	6 3/8	36.0
36.9	173	141	13.2						UCIP320C	UCIP320CD	174	6 27/32	42.5
52.4	205	180	13.2						UCIP322C	UCIP322CD	188	7 13/32	59.2
58.7	207	185	13.5						UCIP324C	UCIP324CD	196	7 23/32	68.2
76.2	229	214	13.6						UCIP326C	UCIP326CD	214	8 7/16	88.3
87.0	253	246	13.6						UCIP328C	UCIP328CD	222	8 3/4	102

- As for the triple seal type product, suffix code L3 follows the Part No. of unit or bearing. (Example of Part No. : UCIP208JL3, UC208L3)
- As for the dimensions and forms of applicable bearings, see the dimensional tables of ball bearing for unit.
- Housings of nodular graphite cast iron are also available.



**Thick Pillow Block Units**

**UKIP**

Tapered bore (with adapter)

$d_1$  35 ~ 125 mm

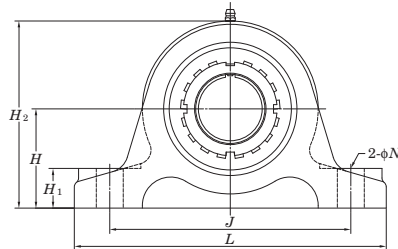
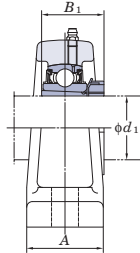

Shaft Dia. mm inch	$d_1$	Dimensions inch mm								Bolt Size inch mm	Standard			
		H	L	A	J	N	H <sub>1</sub>	H <sub>2</sub>	B <sub>1</sub>		Unit No.	Housing No.	Bearing No.	Adapter No.
35	1 1/4	2 23/64	7 7/8	2 3/8	5 29/32	3/4	3 1/32	4 17/32	1 13/16	5/8	UKIP208	IP208	UK208	HE2308X HS2308X H2308X
	1 3/8	60	200	60	150	19	25	115	46	M16				
40	1 1/2	2 3/4	8 9/32	2 3/8	6 19/64	3/4	3 1/32	5 1/32	1 31/32	5/8	UKIP209	IP209	UK209	HE2309X H2309X
	70	210	60	160	19	25	128	50	M16					
45	1 3/4	2 3/4	8 21/32	2 3/8	6 11/16	3/4	1 3/32	5 3/16	2 5/32	5/8	UKIP210	IP210	UK210	HE2310X H2310X
	70	220	60	170	19	28	132	55	M16					
50	1 7/8	3 5/32	9 1/16	2 3/8	7 3/32	3/4	1 3/32	5 13/16	2 5/16	5/8	UKIP211	IP211	UK211	HS2311X H2311X H2311X
	2	80	230	60	180	19	28	148	59	M16				
55	2 1/8	3 5/32	10 1/4	2 3/4	7 7/8	7/8	1 3/16	6 3/32	2 7/16	3/4	UKIP212	IP212	UK212	HE2312X H2312X
	80	260	70	200	22	30	155	62	M20					
60	2 1/4	3 35/64	11 1/32	2 3/4	8 21/32	7/8	1 3/16	6 25/32	2 9/16	3/4	UKIP213	IP213	UK213	HE2313X H2313X HS2313X
	2 3/8	90	280	70	220	22	30	172	65	M20				
	2 1/4	4 21/64	12 7/32	2 3/4	9 27/32	7/8	1 3/16	8 3/16	2 9/16	3/4				
65	2 1/2	4 23/32	13 3/8	2 15/16	11 1/32	3 1/32	1 3/8	9 1/16	2 7/8	7/8	UKIP315	IP315	UK315	HE2315X H2315X
	120	340	75	280	25	35	230	73	M22					
70	2 3/4	4 23/32	13 25/32	3 11/32	11 27/64	3 1/32	1 9/16	9 1/4	3 1/16	7/8	UKIP316	IP316	UK316	HE2316X H2316X
	120	350	85	290	25	40	235	78	M22					
75	3	5 1/8	14 9/16	3 11/32	12 13/64	3 1/32	1 9/16	10 1/32	3 7/32	7/8	UKIP317	IP317	UK317	H2317X HE2317X
	130	370	85	310	25	40	255	82	M22					
80	—	5 1/8	15 3/4	3 11/32	13	1 5/32	1 25/32	10 1/4	3 3/8	1	UKIP318	IP318	UK318	H2318X
	130	400	85	330	29	45	260	86	M27					
85	3 1/4	5 29/32	16 5/32	3 11/32	13 25/64	1 5/32	1 25/32	11 7/32	3 17/32	1	UKIP319	IP319	UK319	HE2319X H2319X
	150	410	85	340	29	45	285	90	M27					
90	3 1/2	5 29/32	16 15/16	3 11/32	14 11/64	1 5/32	1 25/32	11 5/8	3 13/16	1	UKIP320	IP320	UK320	HE2320X H2320X
	150	430	85	360	29	45	295	97	M27					
100	4	6 11/16	19 9/32	3 15/16	16 9/64	1 1/4	1 31/32	13 3/16	4 1/8	1 1/8	UKIP322	IP322	UK322	H2322X HE2322X
	170	490	100	410	32	50	335	105	M30					
110	—	6 11/16	20 3/32	3 15/16	16 59/64	1 1/4	1 31/32	13 19/32	4 13/32	1 1/8	UKIP324	IP324	UK324	H2324
	170	510	100	430	32	50	345	112	M30					
115	4 1/2	7 7/8	21 21/32	4 11/32	18 1/2	1 1/4	1 31/32	15 11/32	4 3/4	1 1/8	UKIP326	IP326	UK326	HE2326 H2326
	200	550	110	470	32	50	390	121	M30					
125	—	7 7/8	23 7/32	4 11/32	19 11/16	1 3/8	2 5/32	15 3/4	4 5/32	1 1/4	UKIP328	IP328	UK328	H2328
	200	590	110	500	35	55	400	131	M33					

Remarks 1. In Part No. of unit and units with covers, fitting codes follow bore diameter numbers. (See Table 10.5 in P.62.)

2. Part No. of applicable grease fittings are shown below.

A-1/4-28UNF ..... 208~210

A-R1/8 ..... 211~213, 313~328

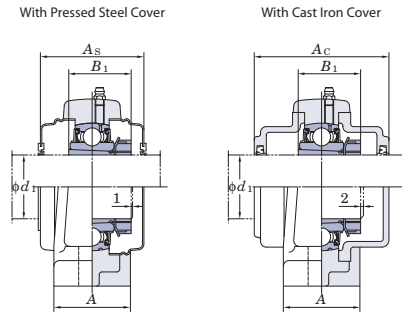

Variations of tolerance of distance from mounting bottom to center of spherical bore ( $\Delta H_s$ ), variations of tolerance of distance between centers of bolt holes ( $\Delta H_b$ ) and variations of tolerance of bolt hole diameter ( $\Delta H_v$ )

Housing No.		$\Delta H_s$	$\Delta H_b$	$\Delta H_v$
IP208~IP210	IP313~IP318	$\pm 0.15$	$\pm 0.5$	$\pm 0.2$
IP211~IP213	IP319~IP328	$\pm 0.2$	$\pm 0.7$	$\pm 0.3$

Unit: mm

Mass	Basic Load Ratings		Factor	With Pressed Steel Cover			Mass	With Cast Iron Cover			Mass		
	kN			Unit No.	Dimension	mm		inch	Unit No.	Dimension		mm	inch
kg	$C_r$	$C_{0r}$	$f_0$	Open Type	One Side Closed Type	$A_s$	kg	Open Type	One Side Closed Type	$A_c$	kg		
3.5				-	-	-	-	-	-	-	-		
3.5	29.1	17.8	14.0	-	-	-	-	-	-	-	-		
3.5				UKIP208C	UKIP208CD	69	2 <sup>23/32</sup>	3.5	UKIP208FC	UKIP208FCD	86	3 <sup>3/8</sup>	4.4
4.0				-	-	-	-	-	-	-	-		
4.0	34.1	21.3	14.0	UKIP209C	UKIP209CD	69	2 <sup>23/32</sup>	4.0	UKIP209FC	UKIP209FCD	88	3 <sup>15/32</sup>	4.9
4.8				-	-	-	-	-	-	-	-		
4.8	35.1	23.3	14.4	UKIP210C	UKIP210CD	74	2 <sup>29/32</sup>	4.8	UKIP210FC	UKIP210FCD	97	3 <sup>13/16</sup>	5.8
5.3				-	-	-	-	-	-	-	-		
5.3	43.4	29.4	14.4	UKIP211C	UKIP211CD	76	3	5.3	UKIP211FC	UKIP211FCD	99	3 <sup>29/32</sup>	5.9
5.3				-	-	-	-	-	-	-	-		
7.1				-	-	-	-	-	-	-	-		
7.1	52.4	36.2	14.4	UKIP212C	UKIP212CD	89	3 <sup>1/2</sup>	7.1	UKIP212FC	UKIP212FCD	114	4 <sup>1/2</sup>	8.6
8.7				-	-	-	-	-	-	-	-		
8.7	57.2	40.1	14.4	UKIP213C	UKIP213CD	89	3 <sup>1/2</sup>	8.7	UKIP213FC	UKIP213FCD	114	4 <sup>1/2</sup>	10.4
8.7				-	-	-	-	-	-	-	-		
13.5				-	-	-	-	-	-	-	-		
13.5	92.7	59.9	13.2	-	-	-	-	-	UKIP313C	UKIP313CD	122	4 <sup>13/16</sup>	15.7
13.5				-	-	-	-	-	-	-	-		
17.7				-	-	-	-	-	-	-	-		
17.7	113	77.2	13.2	-	-	-	-	-	UKIP315C	UKIP315CD	134	5 <sup>9/32</sup>	20.5
20.4				-	-	-	-	-	-	-	-		
20.4	123	86.7	13.3	-	-	-	-	-	UKIP316C	UKIP316CD	138	5 <sup>7/16</sup>	23.5
25.7				-	-	-	-	-	-	-	-		
25.7	133	96.8	13.3	-	-	-	-	-	UKIP317C	UKIP317CD	146	5 <sup>3/4</sup>	29.2
				-	-	-	-	-	-	-	-		
28.7	143	107	13.3	-	-	-	-	-	UKIP318C	UKIP318CD	150	5 <sup>29/32</sup>	32.9
32.0				-	-	-	-	-	-	-	-		
32.0	153	119	13.3	-	-	-	-	-	UKIP319C	UKIP319CD	162	6 <sup>3/8</sup>	36.7
36.6				-	-	-	-	-	-	-	-		
36.6	173	141	13.2	-	-	-	-	-	UKIP320C	UKIP320CD	174	6 <sup>27/32</sup>	42.8
52.2				-	-	-	-	-	-	-	-		
52.2	205	180	13.2	-	-	-	-	-	UKIP322C	UKIP322CD	188	7 <sup>13/32</sup>	59.1
				-	-	-	-	-	-	-	-		
59.0	207	185	13.5	-	-	-	-	-	UKIP324C	UKIP324CD	196	7 <sup>23/32</sup>	69.3
76.0				-	-	-	-	-	-	-	-		
76.0	229	214	13.6	-	-	-	-	-	UKIP326C	UKIP326CD	214	8 <sup>7/16</sup>	89.3
87.0				-	-	-	-	-	-	-	-		
87.0	253	246	13.6	-	-	-	-	-	UKIP328C	UKIP328CD	222	8 <sup>3/4</sup>	104

- In Part No. of unit with adapters and bearing with adapters, Part No. of applicable adapter follow the Part No. shown in the dimensional tables.  
(Example of Part No. : UKIP208J + H2308X, UK208 + H2308X)
- As for the triple seal type product, suffix code L3 follows the Part No. of unit or bearing.  
(Example of Part No. : UKIP208JL3 + H2308X, UK208L3 + H2308X)
- For the dimensions and forms of applicable bearings and adapters, see the dimensional tables of ball bearing for unit and adapter.
- Housings of nodular graphite cast iron are also available.



**Tapped-Base Pillow Block Units**

**UCPA**  
**Cylindrical bore (with set screws)**  
*d* 12 ~ 50 mm

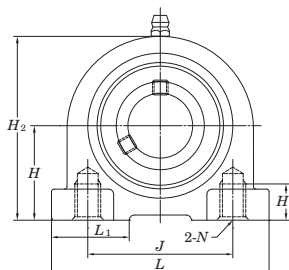
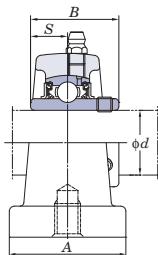

Shaft Dia. mm inch	Dimensions										Unit No.	Housing No.	Bearing No.	
	inch mm													
<i>d</i>	<i>H</i>	<i>L</i>	<i>A</i>	<i>J</i>	<i>N</i>	<i>H</i> <sub>2</sub>	<i>H</i> <sub>3</sub>	<i>L</i> <sub>1</sub>	<i>B</i>	<i>S</i>				
12	1/2										UCPA201	PA204	UC201	
15	5/8	1 3/16	3	1 9/16	2 3/64		2 3/8	1/2	1 1/16	1.220	0.500		UCPA201-8	UC201-8
17	3/4	30.2	76	40	52	M10x1.5	60	13	27	31	12.7		UCPA202	UC202
20													UCPA203	UC203
												UCPA204-12	UC204-12	
												UCPA204	UC204	
25	7/8	1 7/16	3 5/16	1 25/32	2 13/64		2 25/32	1/2	1 3/16	1.343	0.563	UCPA205-14	UC205-14	
	15/16	36.5	84	45	56	M10x1.5	71	13	30	34.1	14.3	UCPA205-15	UC205-15	
	1											UCPA205	UC205	
												UCPA205-16	UC205-16	
30	1 1/8	1 11/16	3 11/16	1 31/32	2 19/32		3 5/16	23/32	1 13/32	1.500	0.626	UCPA206-18	UC206-18	
	1 3/16	42.9	94	50	66	M14x2	84	18	36	38.1	15.9	UCPA206	UC206	
	1 1/4											UCPA206-19	UC206-19	
												UCPA206-20	UC206-20	
35	1 1/4	1 7/8	4 11/32	2 5/32	3 5/32		3 21/32	25/32	1 5/8	1.689	0.689	UCPA207-20	UC207-20	
	1 5/16	47.6	110	55	80	M14x2	93	20	41	42.9	17.5	UCPA207-21	UC207-21	
	1 3/8											UCPA207-22	UC207-22	
												UCPA207	UC207	
	1 7/16											UCPA207-23	UC207-23	
40	1 1/2	1 15/16	4 9/16	2 9/32	3 5/16		3 27/32	25/32	1 5/8	1.937	0.748	UCPA208-24	UC208-24	
	1 9/16	49.2	116	58	84	M14x2	98	20	41	49.2	19	UCPA208-25	UC208-25	
												UCPA208	UC208	
45	1 5/8	2 9/64	4 23/32	2 3/8	3 35/64		4 3/16	31/32	1 21/32	1.937	0.748	UCPA209-26	UC209-26	
	1 11/16	54.2	120	60	90	M14x2	106	25	42	49.2	19	UCPA209-27	UC209-27	
	1 3/4											UCPA209-28	UC209-28	
												UCPA209	UC209	
50	1 7/8	2 1/4	5 1/8	2 17/32	3 45/64		4 7/16	31/32	1 27/32	2.031	0.748	UCPA210-30	UC210-30	
	1 15/16	57.2	130	64	94	M16x2	113	25	47	51.6	19	UCPA210-31	UC210-31	
	2											UCPA210	UC210	
												UCPA210-32	UC210-32	

Remarks 1. In Part No. of unit, fitting codes follow bore diameter codes. (See Table 10.5 in P.62.)  
 2. Part No. of the applicable grease fitting is A-1/4-28UNF.  
 3. As for the triple seal type product (from 201 to 205 are the double seal type products), suffix code L3 (or L2) follows Part No. of unit or bearing.  
 (Example of Part No. : UCPA206JL3, UC206L3)



# FYH

Variations of tolerance of distance from mounting bottom to center of spherical bore ( $\Delta_{Hs}$ ) and variations of tolerance of distance between centers of bolt holes ( $\Delta_{J_s}$ )

Unit: mm

Housing No.	$\Delta_{Hs}$	$\Delta_{J_s}$
PA204-PA210	±0.15	±0.5

	Basic Load Ratings kN		Factor	Mass
	$C_r$	$C_{0r}$	$f_0$	kg
				0.64
	12.8	6.65	13.2	0.62
				0.61
				0.59
	14.0	7.85	13.9	0.83
	19.5	11.3	13.9	1.2
	25.7	15.4	13.9	1.7
	29.1	17.8	14.0	2.0
	34.1	21.3	14.0	2.2
	35.1	23.3	14.4	2.8

- 4. As for the dimensions and forms of applicable bearings, see the dimensional tables of ball bearing for unit.
- 5. Tapered bore (with adapter) type products are also available. (Example of Part No. : UKPA205J + H2305X, UK205 + H2305X)
- 6. Housings of nodular graphite cast iron are also available.



**Tapped-Base Pillow Block Units**

**UCPAN**

**Cylindrical bore (with set screws)**

*d* 20 ~ 35 mm

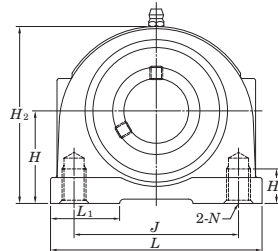
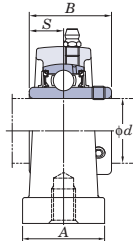

Shaft Dia.		Dimensions										Unit No.	Housing No.	Bearing No.
mm	inch	inch mm												
<i>d</i>		<i>H</i>	<i>L</i>	<i>A</i>	<i>J</i>	<i>N</i>	<i>H</i> <sub>2</sub>	<i>H</i> <sub>3</sub>	<i>L</i> <sub>1</sub>	<i>B</i>	<i>S</i>			
20	3/4	1 5/16	2 9/16	1 1/4	2	3/8-16UNC	2 17/32	1/2	7/8	1.220	0.500	UCPAN204-12 UCPAN204	PAN204	UC204-12 UC204
		33.3	65	32	50.8		64	12.7	22	31	12.7			
25	7/8	1 7/16	2 3/4	1 13/32	2	3/8-16UNC	2 3/4	1/2	15/16	1.343	0.563	UCPAN205-14 UCPAN205-15 UCPAN205 UCPAN205-16	PAN205	UC205-14 UC205-15 UC205 UC205-16
		15/16	36.5	70	36	50.8		70	13	24	34.1			
30	1 1/8	1 11/16	3 27/32	1 1/2	3	7/16-14UNC	3 7/32	5/8	1 11/32	1.500	0.626	UCPAN206-18 UCPAN206 UCPAN206-19 UCPAN206-20	PAN206	UC206-18 UC206 UC206-19 UC206-20
	1 3/16	42.9	98	38	76.2		82	16	34	38.1	15.9			
	1 1/4													
35	1 1/4	1 7/8	4 11/32	1 7/8	3 1/4	1/2-13UNC	3 21/32	3/4	1 3/32	1.689	0.689	UCPAN207-20 UCPAN207-21 UCPAN207-22 UCPAN207 UCPAN207-23	PAN207	UC207-20 UC207-21 UC207-22 UC207 UC207-23
	1 5/16	47.6	110	48	82.6		93	19	28	42.9	17.5			
	1 3/8													
	1 7/16													

- Remarks
1. In Part No. of unit, fitting codes follow bore diameter codes. (See Table 10.5 in P.62.)
  2. Part No. of the applicable grease fitting is A-1/4-28UNF.
  3. As for the triple seal type product (from 201 to 205 are the double seal type products), suffix code L3 (or L2) follows Part No. of unit or bearing. (Example of Part No. : UCPAN206L3, UC206L3)



# FYH

Variations of tolerance of distance from mounting bottom to center of spherical bore ( $\Delta H_s$ ) and variations of tolerance of distance between centers of bolt holes ( $\Delta J_s$ )

Unit: mm

Housing No.	$\Delta H_s$	$\Delta J_s$
PAN204-PAN207	±0.15	±0.5

	Basic Load Ratings kN		Factor	Mass
	$C_r$	$C_{0r}$	$f_0$	kg
	12.8	6.65	13.2	0.55
	14.0	7.85	13.9	0.65
	19.5	11.3	13.9	1.3
	25.7	15.4	13.9	1.8

4. As for the dimensions and forms of applicable bearings, see the dimensional tables of ball bearing for unit.
5. Tapered bore (with adapter) type products are also available. (Example of Part No. : UKPAN205J + H2305X, UK205 + H2305X)
6. Housings of nodular graphite cast iron are also available.



**Tapped-Base Pillow Block Units**

**NCPA**  
**Cylindrical bore**  
**(with concentric locking collar)**  
**d 20 ~ 50 mm**

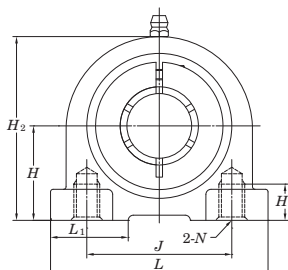
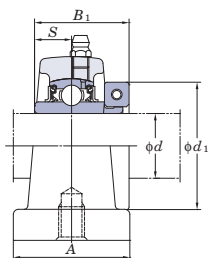

Shaft Dia. mm inch	Dimensions inch mm											Unit No.	Housing No.	Bearing No.
	d	H	L	A	J	N	H <sub>2</sub>	H <sub>3</sub>	L <sub>1</sub>	B <sub>1</sub>	S			
20 3/4	1 3/16	3	1 9/16	2 3/64		2 3/8	1/2	1 1/16	1 9/32	0.500	1 3/4	<b>NCPA204-12</b>	PA204	NC204-12 NC204
	30.2	76	40	52	M10x1.5	60	13	27	32.5	12.7	44.5	<b>NCPA204</b>		
25 7/8 1 5/16 1	1 7/16	3 5/16	1 25/32	2 13/64		2 25/32	1/2	1 3/16	1 7/16	0.563	1 15/16	<b>NCPA205-14</b>	PA205	NC205-14 NC205-15 NC205 NC205-16
	36.5	84	45	56	M10x1.5	71	13	30	36.5	14.3	49.2	<b>NCPA205-15</b>		
30 1 1/8 1 3/16 1 1/4	1 11/16	3 11/16	1 31/32	2 19/32		3 5/16	23/32	1 13/32	1 9/16	0.626	2 3/16	<b>NCPA206-18</b>	PA206	NC206-18 NC206 NC206-19 NC206-20
	42.9	94	50	66	M14x2	84	18	36	39.7	15.9	55.6	<b>NCPA206-19</b>		
35 1 1/4 1 3/8 1 7/16	1 7/8	4 11/32	2 5/32	3 5/32		3 21/32	25/32	1 5/8	1 3/4	0.689	2 7/16	<b>NCPA207-20</b>	PA207	NC207-20
	47.6	110	55	80	M14x2	93	20	41	44.5	17.5	61.9	<b>NCPA207-22</b>		
40 1 1/2 1 5/8	1 15/16	4 9/16	2 9/32	3 5/16		3 27/32	25/32	1 5/8	2	0.748	2 11/16	<b>NCPA208-24</b>	PA208	NC208-24 NC208
	49.2	116	58	84	M14x2	98	20	41	50.8	19	68.3	<b>NCPA208</b>		
45 1 11/16 1 3/4	2 9/64	4 23/32	2 3/8	3 35/64		4 3/16	31/32	1 21/32	2	0.748	2 13/16	<b>NCPA209-26</b>	PA209	NC209-26
	54.2	120	60	90	M14x2	106	25	42	50.8	19	71.4	<b>NCPA209-27</b>		
50 1 15/16 2	2 1/4	5 1/8	2 17/32	3 45/64		4 7/16	31/32	1 27/32	2 3/32	0.748	3 3/8	<b>NCPA210-31</b>	PA210	NC210-31 NC210 NC210-32
	57.2	130	64	94	M16x2	113	25	47	53.1	19	85.7	<b>NCPA210</b>		

Remarks 1. In Part No. of unit, fitting codes follow bore diameter codes. (See **Table 10.5** in P62.)  
2. Part No. of the applicable grease fitting is A-1/4-28UNF.  
3. As for the dimensions and forms of applicable bearings, see the dimensional tables of ball bearing for unit.





# FYH

Variations of tolerance of distance from mounting bottom to center of spherical bore ( $\Delta_{Hs}$ ) and variations of tolerance of distance between centers of bolt holes ( $\Delta_{J_s}$ )

Unit: mm

Housing No.	$\Delta_{Hs}$	$\Delta_{J_s}$
PA204-PA210	±0.15	±0.5

	Basic Load Ratings kN		Factor	Mass
	$C_r$	$C_{0r}$	$f_0$	kg
	12.8	6.65	13.2	0.73
	14.0	7.85	13.9	1.0
	19.5	11.3	13.9	1.4
	25.7	15.4	13.9	2.0
	25.7	15.4	13.9	2.0
	29.1	17.8	14.0	2.4
	34.1	21.3	14.0	2.6
	34.1	21.3	14.0	2.6
	35.1	23.3	14.4	3.4



**Tapped-Base Pillow Block Units**

**NCPAN**  
**Cylindrical bore**  
**(with concentric locking collar)**  
*d* 20 ~ 35 mm

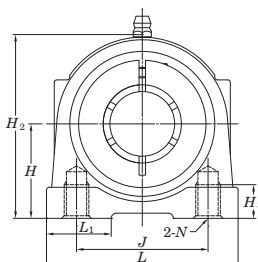
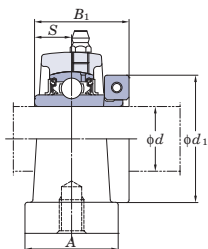

Shaft Dia.		Dimensions											Unit No.	Housing No.	Bearing No.
mm	inch	inch mm													
<i>d</i>		<i>H</i>	<i>L</i>	<i>A</i>	<i>J</i>	<i>N</i>	<i>H</i> <sub>2</sub>	<i>H</i> <sub>3</sub>	<i>L</i> <sub>1</sub>	<i>B</i> <sub>1</sub>	<i>S</i>	<i>d</i> <sub>1</sub>			
20	3/4	1 5/16	2 9/16	1 1/4	2	3/8-16UNC	2 17/32	1/2	7/8	1 9/32	0.500	1 3/4	NCPAN204-12	PAN204	NC204-12 NC204
		33.3	65	32	50.8		64	12.7	22	32.5	12.7	44.5	NCPAN204		
25	7/8	1 7/16	2 3/4	1 13/32	2	3/8-16UNC	2 3/4	1/2	15/16	1 7/16	0.563	1 15/16	NCPAN205-14	PAN205	NC205-14 NC205-15 NC205
	15/16	36.5	70	36	50.8		70	13	24	36.5	14.3	49.2	NCPAN205		
	1												NCPAN205-16		
30	1 1/8	1 11/16	3 27/32	1 1/2	3	7/16-14UNC	3 7/32	5/8	1 11/32	1 9/16	0.626	2 3/16	NCPAN206-18	PAN206	NC206-18 NC206
	1 3/16	42.9	98	38	76.2		82	16	34	39.7	15.9	55.6	NCPAN206		
	1 1/4												NCPAN206-19		
35	1 1/4	1 7/8	4 11/32	1 7/8	3 1/4	1/2-13UNC	3 21/32	3/4	1 3/32	1 3/4	0.689	2 7/16	NCPAN206-20	PAN207	NC206-20
		47.6	110	48	82.6		93	19	28	44.5	17.5	61.9	NCPAN207-20		
	1 3/8	1 7/8	4 11/32	1 7/8	3 1/4	1/2-13UNC	3 21/32	3/4	1 3/32	1 3/4	0.689	2 9/16	NCPAN207-22		
	1 7/16	47.6	110	48	82.6		93	19	28	44.5	17.5	65.1	NCPAN207	PAN207	NC207-22 NC207 NC207-23

Remarks 1. In Part No. of unit, fitting codes follow bore diameter codes. (See **Table 10.5** in P.62.)  
 2. Part No. of the applicable grease fitting is A-1/4-28UNF.  
 3. As for the dimensions and forms of applicable bearings, see the dimensional tables of ball bearing for unit.



# FYH

Variations of tolerance of distance from mounting bottom to center of spherical bore ( $\Delta H_s$ ) and variations of tolerance of distance between centers of bolt holes ( $\Delta J_s$ )

Unit: mm

Housing No.	$\Delta H_s$	$\Delta J_s$
PAN204-PAN207	±0.15	±0.5

	Basic Load Ratings kN		Factor	Mass
	$C_r$	$C_{0r}$	$f_0$	kg
	12.8	6.65	13.2	0.7
	14.0	7.85	13.9	0.85
	19.5	11.3	13.9	1.5
	25.7	15.4	13.9	2.1
	25.7	15.4	13.9	2.1



**High-Base Pillow Block Units**

**UCPH**  
Cylindrical bore (with set screws)  
*d* 12 ~ 50 mm

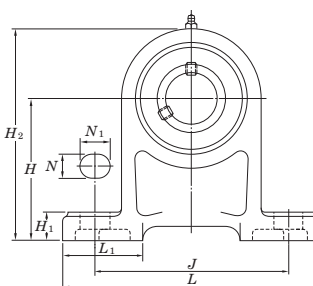
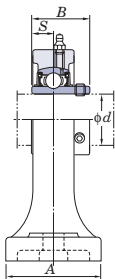

Shaft Dia.		Dimensions											Bolt Size	Unit No.	Housing No.	Bearing No.
mm	inch	inch mm														
<i>d</i>		<i>H</i>	<i>L</i>	<i>A</i>	<i>J</i>	<i>N</i>	<i>N</i> <sub>1</sub>	<i>H</i> <sub>1</sub>	<i>H</i> <sub>2</sub>	<i>L</i> <sub>1</sub>	<i>B</i>	<i>S</i>	inch mm			
12	1/2													M10	PH204	UC201 UC201-8 UC202 UC202-10 UC203 UC204-12 UC204
	15	2 3/4	5	1 9/16	3 3/4	1/2	3/4	19/32	3 31/32	1 13/16	1.220	0.500				
	17	70	127	40	95	13	19	15	101	46	31	12.7				
20	3/4													M10	PH205	UC205-14 UC205-15 UC205 UC205-16
	25	3 5/32	5 1/2	1 31/32	4 1/8	1/2	3/4	5/8	4 1/2	1 15/16	1.343	0.563				
30	7/8													M14	PH206	UC206-18 UC206 UC206-19 UC206-20
	15/16	3 5/32	5 1/2	1 31/32	4 1/8	1/2	3/4	5/8	4 1/2	1 15/16	1.343	0.563				
	1	80	140	50	105	13	19	16	114	49	34.1	14.3				
35	1 1/8													M14	PH207	UC207-20 UC207-21 UC207-22 UC207 UC207-23
	1 3/16	3 5/16	6 1/2	1 31/32	4 3/4	21/32	13/16	23/32	5 1/8	2 7/32	1.500	0.626				
	1 1/4	90	165	50	121	17	21	18	130	56	38.1	15.9				
40	1 1/4													M14	PH208	UC208-24 UC208-25 UC208
	1 5/16	3 7/16	6 9/16	2 3/8	5	21/32	13/16	23/32	5 1/2	2 1/8	1.689	0.689				
	1 3/8	95	167	60	127	17	21	18	140	54	42.9	17.5				
45	1 7/16													M14	PH209	UC209-26 UC209-27 UC209-28 UC209
	1 1/2	3 15/16	7 1/4	2 3/4	5 13/32	21/32	13/16	25/32	5 29/32	2 1/4	1.937	0.748				
	1 9/16	100	184	70	137	17	21	20	150	57	49.2	19				
50	1 5/8													M16	PH210	UC210-30 UC210-31 UC210 UC210-32
	1 11/16	4 9/16	7 15/32	2 3/4	5 3/4	21/32	13/16	25/32	6 7/32	2 9/32	1.937	0.748				
	1 3/4	105	190	70	146	17	21	20	158	58	49.2	19				
50	1 7/8													M16	PH210	UC210-30 UC210-31 UC210 UC210-32
	1 15/16	4 21/64	8 1/8	2 3/4	6 1/4	25/32	7/8	7/8	6 1/2	2 9/16	2.031	0.748				
2		110	206	70	159	20	22	22	165	65	51.6	19				

Remarks 1. In Part No. of unit, fitting codes follow bore diameter codes. (See **Table 10.5** in P.62.)  
 2. Part No. of the applicable grease fitting is A-1/4-28UNF.  
 3. As for the triple seal type product (from 201 to 205 are the double seal type products), suffix code L3 (or L2) follows Part No. of unit or bearing.  
 (Example of Part No. : UCPH206L3, UC206L3)



# FYH

Variations of tolerance of distance from mounting bottom to center of spherical bore ( $\Delta H_s$ )

Unit: mm

Housing No.	$\Delta H_s$
PH204-PH210	$\pm 0.15$

	Basic Load Ratings kN		Factor	Mass
	$C_r$	$C_{0r}$	$f_0$	kg
				0.96
	12.8	6.65	13.2	0.94
				0.93
				0.91
	14.0	7.85	13.9	1.2
	19.5	11.3	13.9	1.6
	25.7	15.4	13.9	2.0
	29.1	17.8	14.0	2.7
	34.1	21.3	14.0	3.0
	35.1	23.3	14.4	3.5

4. As for the dimensions and forms of applicable bearings, see the dimensional tables of ball bearing for unit.

5. Tapered bore (with adapter) type products are also available. (Example of Part No. : UKPH205J + H2305X, UK205 + H2305X)



**Narrow Inner Ring Bearing Pillow Block Units**

**SBP-RKP8**  
Cylindrical bore  
(with set screws)  
*d* 20 ~ 55 mm

**SAP-FP9**  
Cylindrical bore  
(with eccentric locking collar)



SBP-RKP8



SAP-FP9

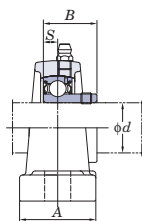

SBP-RKP8

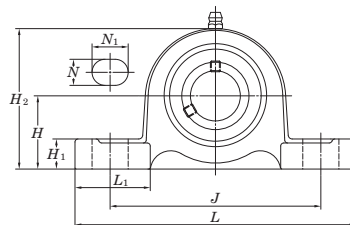

Shaft Dia. mm inch	Dimensions inch mm												SBP-RKP8 S	SAP-FP9 S	Bolt Size inch mm
	<i>d</i>	<i>H</i>	<i>L</i>	<i>A</i>	<i>J</i>	<i>N</i>	<i>N</i> <sub>1</sub>	<i>H</i> <sub>1</sub>	<i>H</i> <sub>2</sub>	<i>L</i> <sub>1</sub>	<i>B</i>	<i>B</i> <sub>1</sub>			
20	3/4	1 5/16	5	1 1/2	3 3/4	1/2	23/32	5/8	2 9/16	1 13/32	0.984	1.220	0.276	0.295	3/8
		33.3	127	38	95	13	18	16	65	36	25	31.0	7	7.5	M10
25	7/8	1 7/16	5 1/2	1 1/2	4 1/8	1/2	23/32	5/8	2 3/4	1 1/2	1.063	1.220	0.295	0.295	3/8
	1	36.5	140	38	105	13	18	16	70	38	27	31.0	7.5	7.5	M10
30	1 1/8	1 11/16	6 1/2	1 7/8	4 3/4	21/32	13/16	21/32	3 5/16	1 7/8	1.181	1.906	0.315	0.354	1/2
	1 3/16	42.9	165	48	121	17	21	17	84	48	30	35.7	8	9.0	M14
35	1 1/4	1 7/8	6 9/16	1 7/8	5	21/32	13/16	23/32	3 3/4	1 27/32	1.260	1.531	0.335	0.374	1/2
	1 5/16	47.6	167	48	127	17	21	18	95	47	32	38.9	8.5	9.5	M14
40	1 1/2	1 15/16	7 1/4	2 1/8	5 13/32	21/32	13/16	23/32	3 27/32	2 3/32	1.339	1.720	0.354	0.433	1/2
	1 9/16	49.2	184	54	137	17	21	18	98	53	34	43.7	9	11.0	M14
45	1 5/8	2 1/8	7 15/32	2 1/8	5 3/4	21/32	13/16	25/32	4 3/16	2 5/32	—	1.720	—	0.433	1/2
	1 11/16	54	190	54	146	17	21	20	106	55	—	43.7	—	11.0	M14
50	1 7/8	2 1/4	8 1/8	2 3/8	6 1/4	25/32	7/8	13/16	4 7/16	2 3/8	—	1.720	—	0.433	5/8
	1 15/16	57.2	206	60	159	20	22	21	113	60	—	43.7	—	11.0	M16
55	2	2 1/2	8 5/8	2 3/8	6 23/32	25/32	7/8	29/32	4 29/32	2 3/4	—	1.906	—	0.472	5/8
	2 3/16	63.5	219	60	171	20	22	23	125	70	—	48.4	—	12.0	M16

Remarks 1. In Part No. of unit, fitting codes follow bore diameter numbers. (See Table 10.5 in P.62)  
2. Part No. of applicable grease fittings are shown below.  
A-1/4-28UNF ..... 204~210  
A-R1/8..... 211



Variations of tolerance of distance from mounting bottom to center of spherical bore ( $\Delta H_b$ )

Unit: mm

Housing No.	$\Delta H_b$
P204-P210	$\pm 0.15$
P211	$\pm 0.2$

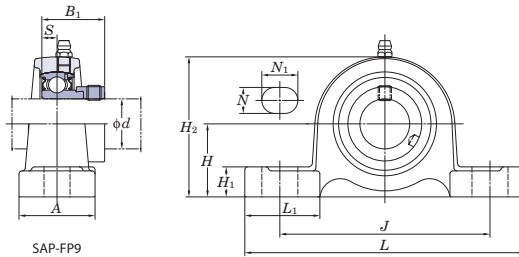

SAP-FP9

Unit No.	Bearing No.	Unit No.	Bearing No.	Housing No.	Basic Load Ratings kN		Factor $f_0$	Mass kg					
					$C_r$	$C_{0r}$		SBP-RKP8	SAP-FP9				
SBP204-12RKP8	SB204-12RKP8	SAP204-12FP9	SA204-12FP9	P204	12.8	6.65	13.2	0.65	0.69				
SBP204RKP8	SB204RKP8	SAP204FP9	SA204FP9					0.66	0.7				
SBP205-14RKP8	SB205-14RKP8	SAP205-14FP9	SA205-14FP9	P205	14.0	7.85	13.9	0.78	0.82				
SBP205-15RKP8	SB205-15RKP8	SAP205-15FP9	SA205-15FP9					0.76	0.81				
SBP205-16RKP8	SB205-16RKP8	SAP205-16FP9	SA205-16FP9					0.8	0.85				
SBP205RKP8	SB205RKP8	SAP205FP9	SA205FP9					0.8	0.85				
SBP206-18RKP8	SB206-18RKP8	SAP206-18FP9	SA206-18FP9					P206	19.5	11.3	13.9	1.24	1.31
SBP206-19RKP8	SB206-19RKP8	SAP206-19FP9	SA206-19FP9	1.26	1.33								
SBP206-20RKP8	SB206-20RKP8	SAP206-20FP9	SA206-20FP9	1.29	1.36								
SBP206RKP8	SB206RKP8	SAP206FP9	SA206FP9	1.26	1.33								
SBP207-20RKP8	SB207-20RKP8	SAP207-20FP9	SA207-20FP9	P207	25.7	15.4	13.9					1.69	1.76
SBP207-22RKP8	SB207-22RKP8	SAP207-22FP9	SA207-22FP9					1.61	1.76				
SBP207-23RKP8	SB207-23RKP8	SAP207-23FP9	SA207-23FP9					1.64	1.79				
SBP207RKP8	SB207RKP8	SAP207FP9	SA207FP9					1.61	1.76				
SBP208-24RKP8	SB208-24RKP8	SAP208-24FP9	SA208-24FP9					P208	29.1	17.8	14.0	1.87	2.02
SBP208RKP8	SB208RKP8	SAP208FP9	SA208FP9	1.92	2.07								
—	—	SAP209-26FP9	SA209-26FP9	P209	34.1	21.3	14.0					—	2.26
—	—	SAP209-27FP9	SA209-27FP9									—	2.31
—	—	SAP209-28FP9	SA209-28FP9									—	2.35
—	—	SAP209FP9	SA209FP9					—	2.37				
—	—	SAP210-30FP9	SA210-30FP9	P210	35.1	23.3	14.4	—	2.87				
—	—	SAP210-31FP9	SA210-31FP9					—	2.91				
—	—	SAP210FP9	SA210FP9					—	2.94				
—	—	SAP211-32FP9	SA211-32FP9	P211	43.4	29.4	14.4	—	3.52				
—	—	SAP211-34FP9	SA211-34FP9					—	3.61				
—	—	SAP211-35FP9	SA211-35FP9					—	3.74				
—	—	SAP211FP9	SA211FP9					—	3.71				

- For the dimensions and forms of applicable bearings, see the dimensional tables of ball bearing for unit.
- Representative examples of the forms of housing are indicated.
- Housings of nodular graphite cast iron are also available.



**Narrow Inner Ring Bearing Pillow Block Units**

**SBPAN-RKP8**  
Cylindrical bore  
(with set screws)

**SAPAN-FP9**  
Cylindrical bore  
(with eccentric locking collar)



SBPAN-RKP8



SAPAN-FP9

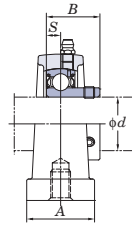

SBPAN-RKP8

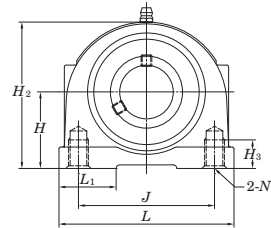

Shaft Dia.		Dimensions												
mm	inch	inch											SBPAN-RKP8	SAPAN-FP9
<i>d</i>		<i>H</i>	<i>L</i>	<i>A</i>	<i>J</i>	<i>N</i>	<i>H</i> <sub>2</sub>	<i>H</i> <sub>3</sub>	<i>L</i> <sub>1</sub>	<i>B</i>	<i>B</i> <sub>1</sub>	<i>S</i>	<i>S</i>	
		mm												
<b>20</b>	3/4	1 5/16	2 9/16	1 1/4	2	3/8-16UNC	2 17/32	1/2	7/8	0.984	1.220	0.276	0.295	
		33.3	65	32	50.8		64	12.7	22	25	31	7	7.5	
<b>25</b>	7/8	1 7/16	2 3/4	1 13/32	2	3/8-16UNC	2 3/4	1/2	15/16	1.063	1.220	0.295	0.295	
	15/16	36.5	70	36	50.8		70	13	24	27	31	7.5	7.5	
<b>30</b>	1 1/8	1 11/16	3 27/32	1 1/2	3	7/16-14UNC	3 7/32	5/8	1 11/32	1.181	1.906	0.315	0.354	
	1 3/16	42.9	98	38	76.2		82	16	34	30	35.7	8	9	
<b>35</b>	1 1/4	1 7/8	4 11/32	1 7/8	3 1/4	1/2-13UNC	3 21/32	3/4	1 3/32	1.260	1.531	0.335	0.374	
	1 5/16	47.6	110	48	82.6		93	19	28	32	38.9	8.5	9.5	

Remarks 1. In Part No. of unit, fitting codes follow bore diameter codes. (See Table 10.5 in P62.)  
2. Part No. of the applicable grease fitting is A-1/4-28UNF.





Variations of tolerance of distance from mounting bottom to center of spherical bore ( $\Delta H_2$ ) and variations of tolerance of distance between centers of bolt holes ( $\Delta L_1$ )

Unit: mm

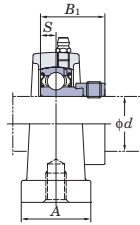

SAPAN-FP9

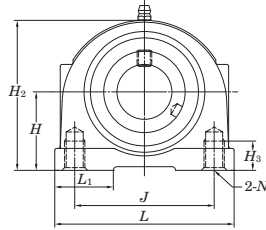

Housing No.	$\Delta H_2$	$\Delta L_1$
PAN204-PAN207	$\pm 0.15$	$\pm 0.5$

Unit No.	Bearing No.	Unit No.	Bearing No.	Housing No.	Basic Load Ratings kN		Factor $f_0$	Mass kg	
					$C_r$	$C_{0r}$		SBPAN-RKP8	SAPAN-FP9
<b>SBPAN204-12RKP8</b>	SB204-12RKP8	<b>SAPAN204-12FP9</b>	SA204-12FP9	PAN204	12.8	6.65	13.2	0.56	0.56
<b>SBPAN204RKP8</b>	SB204RKP8	<b>SAPAN204FP9</b>	SA204FP9					0.56	0.56
<b>SBPAN205-14RKP8</b>	SB205-14RKP8	<b>SAPAN205-14FP9</b>	SA205-14FP9	PAN205	14.0	7.85	13.9	0.63	0.63
<b>SBPAN205-15RKP8</b>	SB205-15RKP8	<b>SAPAN205-15FP9</b>	SA205-15FP9					0.66	0.66
<b>SBPAN205-16RKP8</b>	SB205-16RKP8	<b>SAPAN205-16FP9</b>	SA205-16FP9	PAN205	14.0	7.85	13.9	0.64	0.64
<b>SBPAN205RKP8</b>	SB205RKP8	<b>SAPAN205FP9</b>	SA205FP9					0.63	0.63
<b>SBPAN206-18RKP8</b>	SB206-18RKP8	<b>SAPAN206-18FP9</b>	SA206-18FP9	PAN206	19.5	11.3	13.9	1.32	1.32
<b>SBPAN206-19RKP8</b>	SB206-19RKP8	<b>SAPAN206-19FP9</b>	SA206-19FP9					1.34	1.34
<b>SBPAN206-20RKP8</b>	SB206-20RKP8	<b>SAPAN206-20FP9</b>	SA206-20FP9	PAN206	19.5	11.3	13.9	1.32	1.32
<b>SBPAN206RKP8</b>	SB206RKP8	<b>SAPAN206FP9</b>	SA206FP9					1.3	1.3
<b>SBPAN207-20RKP8</b>	SB207-20RKP8	<b>SAPAN207-20FP9</b>	SA207-20FP9	PAN207	25.7	15.4	13.9	1.78	1.78
-	-	<b>SAPAN207-21FP9</b>	SA207-21FP9					-	1.84
<b>SBPAN207-22RKP8</b>	SB207-22RKP8	<b>SAPAN207-22FP9</b>	SA207-22FP9	PAN207	25.7	15.4	13.9	1.81	1.81
<b>SBPAN207-23RKP8</b>	SB207-23RKP8	<b>SAPAN207-23FP9</b>	SA207-23FP9					1.78	1.78
<b>SBPAN207RKP8</b>	SB207RKP8	<b>SAPAN207FP9</b>	SA207FP9					1.75	1.75

- As for the dimensions and forms of applicable bearings, see the dimensional tables of ball bearing for unit.
- Housings of nodular graphite cast iron are also available.



**Light Pillow Block Units**

**BLP**  
Cylindrical bore  
(with set screws)  
 $d$  12 ~ 40 mm

**ALP**  
Cylindrical bore  
(with eccentric locking collar)



BLP

ALP

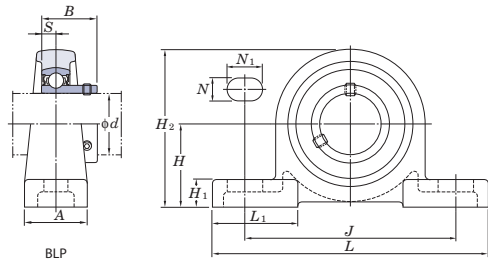

Shaft Dia.		Dimensions										Bolt Size		Unit No.	Bearing No.	
mm	inch	inch mm										inch	mm			
$d$		$H$	$L$	$A$	$J$	$N$	$N_1$	$H_1$	$H_2$	$L_1$	$S$	BLP $B$	ALP $B_1$			
12	1/2	1 3/16	4 1/2	3 1/32	3 7/16	7/16	5/8	15/32	2 1/4	1 3/8	0.236	0.866	1.122	3/8	BLP201	SB201
		30.2	114	25	87	11	16	12	57	35	6	22	28.5	M10	BLP201-8	SB201-8
15	5/8	1 7/16	4 29/32	1 1/16	3 13/16	7/16	5/8	1/2	2 9/16	1 1/2	0.276	0.984	1.161	3/8	BLP202	SB202
		33.3	125	27	97	11	16	13	65	38	7	25	29.5	M10	BLP202-10	SB202-10
17	3/4	1 7/16	5 1/8	1 5/32	3 15/16	7/16	5/8	1/2	2 25/32	1 17/32	0.295	1.063	1.201	3/8	BLP203	SB203
		36.5	130	29	100	11	16	13	71	39	7.5	27	30.5	M10	BLP203	SB203
20	7/8	1 11/16	6 5/32	1 5/16	4 23/32	9/16	13/16	9/16	3 9/32	1 27/32	0.315	1.181	1.335	1/2	BLP204-12	SB204-12
		42.9	156	33	120	14	21	14	83	47	8	30	33.9	M12	BLP204	SB204
25	1 1/8	1 7/8	6 1/2	1 3/8	5	9/16	13/16	5/8	3 21/32	1 31/32	0.335	1.260	1.437	1/2	BLP205-14	SB205-14
		47.6	165	35	127	14	21	16	93	50	8.5	32	36.5	M12	BLP205	SB205
30	1 3/8	1 7/8	6 1/2	1 3/8	5	9/16	13/16	5/8	3 21/32	1 31/32	0.335	1.260	1.437	1/2	BLP205-16	SB205-16
		47.6	165	35	127	14	21	16	93	50	8.5	32	36.5	M12	BLP205-16	SB205-16
35	1 1/4	1 7/8	6 1/2	1 3/8	5	9/16	13/16	5/8	3 21/32	1 31/32	0.335	1.260	1.437	1/2	BLP206-18	SB206-18
		47.6	165	35	127	14	21	16	93	50	8.5	32	36.5	M12	BLP206	SB206
40	1 1/2	1 7/8	6 1/2	1 3/8	5	9/16	13/16	5/8	3 21/32	1 31/32	0.335	1.260	1.437	1/2	BLP206-19	SB206-19
		47.6	165	35	127	14	21	16	93	50	8.5	32	36.5	M12	BLP206-19	SB206-19
40	1 9/16	2	7 1/4	1 15/32	5 1/2	9/16	7/8	23/32	4 1/32	2 5/32	0.354	1.339	1.595	1/2	BLP206-20	SB206-20
		50.8	184	37	140	14	22	18	102	55	9	34	40.5	M12	BLP207-20	SB207-20
40	1 9/16	2	7 1/4	1 15/32	5 1/2	9/16	7/8	23/32	4 1/32	2 5/32	0.354	1.339	1.595	1/2	BLP207-22	SB207-22
		50.8	184	37	140	14	22	18	102	55	9	34	40.5	M12	BLP207	SB207
40	1 9/16	2	7 1/4	1 15/32	5 1/2	9/16	7/8	23/32	4 1/32	2 5/32	0.354	1.339	1.595	1/2	BLP207-23	SB207-23
		50.8	184	37	140	14	22	18	102	55	9	34	40.5	M12	BLP207-23	SB207-23
40	1 9/16	2	7 1/4	1 15/32	5 1/2	9/16	7/8	23/32	4 1/32	2 5/32	0.354	1.339	1.595	1/2	BLP208-24	SB208-24
		50.8	184	37	140	14	22	18	102	55	9	34	40.5	M12	BLP208	SB208

- Remarks
1. In Part No. of unit, fitting codes follow bore diameter codes. (See Table 10.5 in P.62.)
  2. Allowable load to housing in radial direction is approximately half of basic load rating of bearing,  $C_r$  (when safety factor is 4).
  3. For the dimensions and forms of applicable bearings, see the dimensional tables of ball bearing for unit.



# FYH

Variations of tolerance of distance from mounting bottom to center of spherical bore ( $\Delta H_s$ )

Unit: mm

Housing No.	$\Delta H_s$
LP203-LP208	$\pm 0.15$

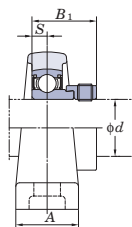

ALP

	Unit No.	Bearing No.	Housing No.	Basic Load Ratings		Factor	Mass	
				kN			kg	
				$C_r$	$C_{0r}$		BLP	ALP
	ALP201	SA201	LP203	9.55	4.80	13.2	0.36	0.39
	ALP201-8	SA201-8						
	ALP202	SA202						
	ALP202-10	SA202-10						
	ALP203	SA203						
	ALP204-12	SA204-12	LP204	12.8	6.65	13.2	0.51	0.51
	ALP204	SA204						
	ALP205-14	SA205-14	LP205	14.0	7.85	13.9	0.57	0.61
	ALP205-15	SA205-15						
	ALP205	SA205						
	ALP205-16	SA205-16						
	ALP206-18	SA206-18	LP206	19.5	11.3	13.9	0.69	0.72
	ALP206	SA206						
	ALP206-19	SA206-19						
	ALP206-20	SA206-20						
	ALP207-20	SA207-20	LP207	25.7	15.4	13.9	0.94	1.0
	ALP207-21	SA207-21						
	ALP207-22	SA207-22						
	ALP207	SA207						
	ALP207-23	SA207-23						
	ALP208-24	SA208-24	LP208	29.1	17.8	14.0	1.8	1.9
	ALP208-25	SA208-25						
	ALP208	SA208						



**Compact Pillow Block Units**

**UP**  
Cylindrical bore (with set screws)  
 $d$  10 ~ 30 mm

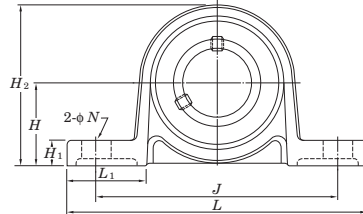
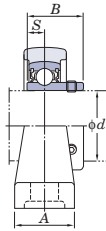

Shaft Dia. mm	Dimensions										Bolt Size inch mm	Standard		
	$H$	$L$	$A$	$J$	$N$	$H_1$	$H_2$	$L_1$	$B$	$S$		Unit No.	Housing No.	Bearing No.
10	$45/64$	$2 5/8$	$5/8$	$2 3/32$	$9/32$	$1/4$	$1 3/8$	$23/32$	0.591	0.197	$1/4$	UP000	P000	SU000
	18	67	16	53	7	6	35	18	15	5	M6			
12	$3/4$	$2 25/32$	$5/8$	$2 13/64$	$9/32$	$1/4$	$1 1/2$	$3/4$	0.591	0.197	$1/4$	UP001	P001	SU001
	19	71	16	56	7	6	38	19	15	5	M6			
15	$55/64$	$3 5/32$	$5/8$	$2 31/64$	$9/32$	$9/32$	$1 11/16$	$13/16$	0.650	0.217	$1/4$	UP002	P002	SU002
	22	80	16	63	7	7	43	21	16.5	5.5	M6			
17	$15/16$	$3 11/32$	$23/32$	$2 41/64$	$9/32$	$9/32$	$1 27/32$	$13/16$	0.689	0.236	$1/4$	UP003	P003	SU003
	24	85	18	67	7	7	47	21	17.5	6	M6			
20	$1 7/64$	$3 15/16$	$25/32$	$3 5/32$	$13/32$	$11/32$	$2 5/32$	$31/32$	0.827	0.276	$5/16$	UP004	P004	SU004
	28	100	20	80	10	9	55	25	21	7	M8			
25	$1 17/64$	$4 13/32$	$25/32$	$3 35/64$	$13/32$	$13/32$	$2 7/16$	$1 3/32$	0.866	0.276	$5/16$	UP005	P005	SU005
	32	112	20	90	10	10	62	28	22	7	M8			
30	$1 27/64$	$5 3/16$	$1 1/32$	$4 11/64$	$1/2$	$7/16$	$2 3/4$	$1 11/32$	0.965	0.295	$3/8$	UP006	P006	SU006
	36	132	26	106	13	11	70	34	24.5	7.5	M10			

Remarks 1. In Part No. of unit and units with covers, fitting codes follow bore diameter codes. (See Table 10.5 in P62.)  
2. For the dimensions and forms of applicable bearings, see the dimensional tables of ball bearing for unit.



With Through Type Cover

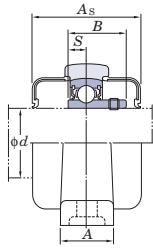

With One Side Sealed Cover

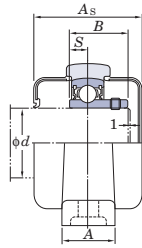

Variations of tolerance of distance from mounting bottom to center of spherical bore ( $\Delta H_s$ ) and variations of tolerance of distance between centers of bolt holes ( $\Delta J_s$ )

Unit: mm		
Housing No.	$\Delta H_s$	$\Delta J_s$
P000-P006	±0.15	±0.3

Mass kg	Basic Load Ratings kN		Factor $f_0$	With Rubber Coated Cover				Mass kg
	$C_r$	$C_{0r}$		Unit No.		Dimension		
				Open Type	One Side Closed Type	mm	inch	
0.070	4.55	1.95	12.3	UP000C	UP000CD	29	1 5/32	0.07
0.090	5.10	2.40	13.2	UP001C	UP001CD	29	1 5/32	0.09
0.11	5.60	2.85	13.9	UP002C	UP002CD	31	1 7/32	0.11
0.15	6.00	3.25	14.4	UP003C	UP003CD	33	1 5/16	0.15
0.23	9.40	5.05	13.9	UP004C	UP004CD	38	1 1/2	0.23
0.28	10.1	5.85	14.5	UP005C	UP005CD	40	1 9/16	0.28
0.42	13.2	8.25	14.7	UP006C	UP006CD	44	1 23/32	0.42



**Corrosion Resistant Series Pillow Block Units**

**UCSP-H1S6**

**Cylindrical bore (with set screws)**

*d* 12 ~ 60 mm

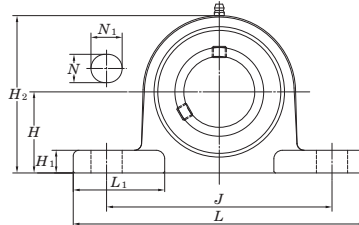
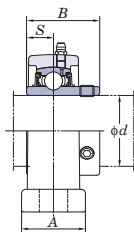

Shaft Dia.		Dimensions											Bolt Size	Standard		
mm	inch	inch mm												inch mm	Unit No.	Housing No.
<i>d</i>		<i>H</i>	<i>L</i>	<i>A</i>	<i>J</i>	<i>N</i>	<i>N</i> <sub>1</sub>	<i>H</i> <sub>1</sub>	<i>H</i> <sub>2</sub>	<i>L</i> <sub>1</sub>	<i>B</i>	<i>S</i>				
12	1/2	1 3/16	5	1 3/16	3 3/4	1/2	23/32	7/16	2 7/32	1 21/32	1.079	0.453	3/8 M10	UCSP201XH1S6 UCSP201-8XH1S6 UCSP202XH1S6 UCSP202-10XH1S6 UCSP203XH1S6	SP203H1	UC201XS6 UC201-8XS6 UC202XS6 UC202-10XS6 UC203XS6
		30.2	127	30	95	13	18	11	56	42	27.4	11.5				
15	5/8	1 5/16	5	1 3/16	3 3/4	1/2	23/32	7/16	2 15/32	1 21/32	1.220	0.500	3/8 M10	UCSP204-12H1S6 UCSP204H1S6	SP204H1	UC204-12S6 UC204S6
		33.3	127	30	95	13	18	11	63	42	31	12.7				
20	3/4	1 7/16	5 1/2	1 3/16	4 1/8	1/2	3/4	15/32	2 23/32	1 13/16	1.343	0.563	3/8 M10	UCSP205-14H1S6 UCSP205-15H1S6 UCSP205H1S6 UCSP205-16H1S6	SP205H1	UC205-14S6 UC205-15S6 UC205S6 UC205-16S6
		36.5	140	30	105	13	19	12	69	46	34.1	14.3				
25	7/8	1 11/16	6 1/2	1 13/32	4 3/4	21/32	13/16	1/2	3 3/16	2 1/8	1.500	0.626	1/2 M14	UCSP206-18H1S6 UCSP206H1S6 UCSP206-19H1S6 UCSP206-20H1S6	SP206H1	UC206-18S6 UC206S6 UC206-19S6 UC206-20S6
		42.9	165	36	121	17	21	13	81	54	38.1	15.9				
30	1 1/8	1 7/8	6 9/16	1 1/2	5	21/32	13/16	9/16	3 19/32	2	1.689	0.689	1/2 M14	UCSP207-20H1S6 UCSP207-21H1S6 UCSP207-22H1S6 UCSP207H1S6 UCSP207-23H1S6	SP207H1	UC207-20S6 UC207-21S6 UC207-22S6 UC207S6 UC207-23S6
		47.6	167	38	127	17	21	14	91	51	42.9	17.5				
35	1 1/4	1 15/16	7 1/4	1 9/16	5 13/32	21/32	13/16	9/16	3 13/16	2 3/8	1.937	0.748	1/2 M14	UCSP208-24H1S6 UCSP208-25H1S6 UCSP208H1S6	SP208H1	UC208-24S6 UC208-25S6 UC208S6
		49.2	184	40	137	17	21	14	97	60	49.2	19				
40	1 1/2	2 1/8	7 15/32	1 9/16	5 3/4	21/32	13/16	19/32	4 3/32	2 13/32	1.937	0.748	1/2 M14	UCSP209-26H1S6 UCSP209-27H1S6 UCSP209-28H1S6 UCSP209H1S6	SP209H1	UC209-26S6 UC209-27S6 UC209-28S6 UC209S6
		54	190	40	146	17	21	15	104	61	49.2	19				
45	1 5/8	2 1/4	8 1/8	1 25/32	6 1/4	25/32	7/8	5/8	4 3/8	2 9/16	2.031	0.748	5/8 M16	UCSP210-30H1S6 UCSP210-31H1S6 UCSP210H1S6 UCSP210-32H1S6	SP210H1	UC210-30S6 UC210-31S6 UC210S6 UC210-32S6
		57.2	206	45	159	20	22	16	111	65	51.6	19				
50	1 15/16	2 1/2	8 5/8	1 7/8	6 23/32	25/32	7/8	5/8	4 29/32	2 3/4	2.189	0.874	5/8 M16	UCSP211-32H1S6 UCSP211-34H1S6 UCSP211H1S6 UCSP211-35H1S6	SP211H1	UC211-32S6 UC211-34S6 UC211S6 UC211-35S6
		63.5	219	48	171	20	22	16	125	70	55.6	22.2				
55	2 1/8	2 3/4	9 1/2	2 5/32	7 1/4	25/32	31/32	7/8	5 7/16	3	2.563	1.000	5/8 M16	UCSP212-36H1S6 UCSP212H1S6 UCSP212-38H1S6 UCSP212-39H1S6	SP212H1	UC212-36S6 UC212S6 UC212-38S6 UC212-39S6
		69.8	241	55	184	20	25	17	138	76	65.1	25.4				
60	2 3/8	3 1/4	10 1/2	2 9/32	7 3/4	25/32	31/32	7/8	5 7/16	3	2.563	1.000	5/8 M16	UCSP212-36H1S6 UCSP212H1S6 UCSP212-38H1S6 UCSP212-39H1S6	SP212H1	UC212-36S6 UC212S6 UC212-38S6 UC212-39S6
		69.8	241	55	184	20	25	17	138	76	65.1	25.4				

- Remarks
1. In Part No. of unit and units with covers, fitting codes follow bore diameter codes. (See Table 10.5 in P.62.)
  2. Part No. of the applicable grease fitting is shown below.  
A-1/4-28UNFN12 .....201X~210  
A-R1/8N12 .....211~212
  3. For the dimensions and forms of applicable bearings, see the dimensional tables of ball bearing for unit.



With Pressed Stainless Steel Cover

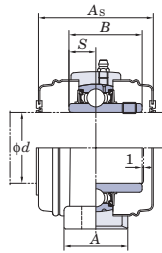

Variations of tolerance of distance from mounting bottom to center of spherical bore ( $\Delta H_s$ )

Unit: mm

Housing No.	$\Delta H_s$
SP203H1~SP210H1	$\pm 0.15$
SP211H1~SP212H1	$\pm 0.2$

Mass kg	Basic Load Ratings kN		Factor $f_0$	Unit No.		Dimension mm inch		Mass kg
	$C_r$	$C_{0r}$		Open Type	One Side Closed Type	$A_s$		
0.47	8.15	3.85	13.2	-	-	-	-	-
0.6	10.9	5.35	13.2	UCSP204H1CS6	UCSP204H1CDS6	45	1 25/32	0.6
0.7	11.9	6.3	13.9	UCSP205H1CS6	UCSP205H1CDS6	49	1 15/16	0.7
1.1	16.5	9.05	13.9	UCSP206H1CS6	UCSP206H1CDS6	53	2 3/32	1.1
1.4	21.8	12.3	13.9	UCSP207H1CS6	UCSP207H1CDS6	60	2 3/8	1.4
1.7	24.8	14.3	14.0	UCSP208H1CS6	UCSP208H1CDS6	69	2 23/32	1.7
2	27.8	16.2	14.0	UCSP209H1CS6	UCSP209H1CDS6	69	2 23/32	2.0
2.5	29.8	18.6	14.4	UCSP210H1CS6	UCSP210H1CDS6	74	2 29/32	2.5
3.4	36.8	23.5	14.4	UCSP211H1CS6	UCSP211H1CDS6	76	3	3.4
4.5	44.5	29	14.4	UCSP212H1CS6	UCSP212H1CDS6	89	3 1/2	4.5



**Corrosion Resistant Series Pillow Block Units**

**UCSPA-H1S6**  
Cylindrical bore (with set screws)  
 $d$  12 ~ 40 mm

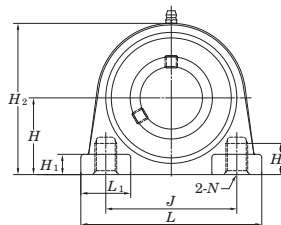
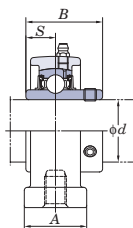

Shaft Dia.		Dimensions											Standard		
mm	inch	inch mm											Unit No.	Housing No.	Bearing No.
$d$		$H$	$L$	$A$	$J$	$N$	$H_1$	$H_2$	$H_3$	$L_1$	$B$	$S$			
12	1/2	1 3/16	3	1 3/16	2 3/64		13/32	2 1/4	33/64	7/8	1.079	0.453	UCSPA201XH1S6 UCSPA201-8XH1S6 UCSPA202XH1S6 UCSPA202-10XH1S6 UCSPA203XH1S6	SPA203H1	UC201XS6 UC201-8XS6 UC202XS6 UC202-10XS6 UC203XS6
		30.2	76	30	52	M10x1.5	10	57	13	22	27.4	11.5			
15	5/8	1 3/16	3	1 3/16	2 3/64		13/32	2 3/8	33/64	7/8	1.220	0.500	UCSPA204-12H1S6 UCSPA204H1S6	SPA204H1	UC204-12S6 UC204S6
		30.2	76	30	52	M10x1.5	10	60	13	22	31	12.7			
17	3/4	1 7/16	3 5/16	1 3/16	2 13/64		15/32	2 23/32	33/64	15/16	1.343	0.563	UCSPA205-14H1S6 UCSPA205-15H1S6 UCSPA205H1S6 UCSPA205-16H1S6	SPA205H1	UC205-14S6 UC205-15S6 UC205S6 UC205-16S6
		36.5	84	30	56	M10x1.5	12	69	13	24	34.1	14.3			
20	7/8	1 11/16	3 11/16	1 13/32	2 19/32		15/32	3 3/16	45/64	1 3/32	1.500	0.626	UCSPA206-18H1S6 UCSPA206H1S6 UCSPA206-19H1S6 UCSPA206-20H1S6	SPA206H1	UC206-18S6 UC206S6 UC206-19S6 UC206-20S6
		42.9	94	36	66	M14x2	12	81	18	28	38.1	15.9			
25	15/16	1 7/8	4 11/32	1 1/2	3 5/32		1/2	3 19/32	25/32	1 3/16	1.689	0.689	UCSPA207-20H1S6 UCSPA207-21H1S6 UCSPA207-22H1S6 UCSPA207H1S6 UCSPA207-23H1S6	SPA207H1	UC207-20S6 UC207-21S6 UC207-22S6 UC207S6 UC207-23S6
		47.6	110	38	80	M14x2	13	91	20	30	42.9	17.5			
30	1 1/8	1 15/16	4 9/16	1 9/16	3 5/16		1/2	3 13/16	25/32	1 1/4	1.937	0.748	UCSPA208-24H1S6 UCSPA208-25H1S6 UCSPA208H1S6	SPA208H1	UC208-24S6 UC208-25S6 UC208S6
		49.2	116	40	84	M14x2	13	97	20	32	49.2	19			

- Remarks
1. In Part No. of unit and units with covers, fitting codes follow bore diameter codes. (See Table 10.5 in P.62.)
  2. Part No. of the applicable grease fitting is A-1/4-28UNFN12.
  3. For the dimensions and forms of applicable bearings, see the dimensional tables of ball bearing for unit.





With Pressed Stainless Steel Cover

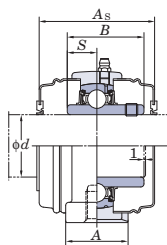

Variations of tolerance of distance from mounting bottom to center of spherical bore ( $\Delta H_s$ ) and variations of tolerance of distance between centers of bolt holes ( $\Delta J_s$ )

Housing No.	$\Delta H_s$	$\Delta J_s$
SPA203H1~SPA208H1	$\pm 0.15$	$\pm 0.5$

Unit: mm

Mass kg	Basic Load Ratings kN		Factor $f_0$	With Pressed Stainless Steel Cover Unit No.		Dimension mm    inch		Mass kg
	$C_r$	$C_{0r}$		Open Type	One Side Closed Type	$A_s$		
0.43	8.15	3.85	13.2	-	-	-	-	-
				-	-	-	-	-
				-	-	-	-	-
				-	-	-	-	-
				-	-	-	-	-
0.47	10.9	5.35	13.2	UCSPA204H1CS6	UCSPA204H1CDS6	45	1 25/32	0.46
0.63	11.9	6.3	13.9	-	-	-	-	-
				UCSPA205H1CS6	UCSPA205H1CDS6	49	1 15/16	0.63
				-	-	-	-	-
0.91	16.5	9.05	13.9	UCSPA206H1CS6	UCSPA206H1CDS6	53	2 3/32	0.91
				-	-	-	-	-
				-	-	-	-	-
1.3	21.8	12.3	13.9	-	-	-	-	-
				UCSPA207H1CS6	UCSPA207H1CDS6	60	2 3/8	1.3
				-	-	-	-	-
1.6	24.8	14.3	14.0	-	-	-	-	-
				UCSPA208H1CS6	UCSPA208H1CDS6	69	2 23/32	1.5



**Corrosion Resistant Series Pillow Block Units**

**USP-S6**

**Cylindrical bore (with set screws)**

*d* 10 ~ 30 mm

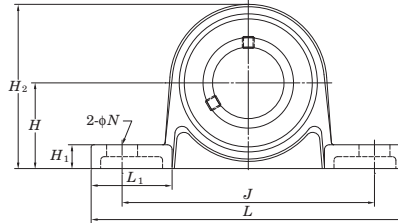
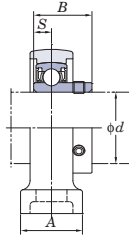

Shaft Dia. mm	Dimensions										Bolt Size inch mm	Standard		
	inch mm											Unit No.	Housing No.	Bearing No.
<i>d</i>	<i>H</i>	<i>L</i>	<i>A</i>	<i>J</i>	<i>N</i>	<i>H</i> <sub>1</sub>	<i>H</i> <sub>2</sub>	<i>L</i> <sub>1</sub>	<i>B</i>	<i>S</i>				
10	45/64	2 5/8	5/8	2 3/32	9/32	3/16	1 3/8	23/32	0.591	0.197	1/4	USP000S6	SP000	SU000S6
	18	67	16	53	7	5	35	18	15	5	M6			
12	3/4	2 25/32	5/8	2 7/32	9/32	3/16	1 15/32	23/32	0.591	0.197	1/4	USP001S6	SP001	SU001S6
	19	71	16	56	7	5	37	18.5	15	5	M6			
15	55/64	3 5/32	5/8	2 15/32	9/32	1/4	1 11/16	13/16	0.650	0.217	1/4	USP002S6	SP002	SU002S6
	22	80	16	63	7	6	42.5	20.5	16.5	5.5	M6			
17	15/16	3 11/32	23/32	2 5/8	9/32	1/4	1 13/16	13/16	0.689	0.236	1/4	USP003S6	SP003	SU003S6
	24	85	18	67	7	6	46	21	17.5	6	M6			
20	1 7/64	3 15/16	25/32	3 5/32	13/32	5/16	2 3/32	31/32	0.827	0.276	5/16	USP004S6	SP004	SU004S6
	28	100	20	80	10	8	54.5	25	21	7	M8			
25	1 17/64	4 13/32	25/32	3 17/32	13/32	11/32	2 13/32	1 3/32	0.866	0.276	5/16	USP005S6	SP005	SU005S6
	32	112	20	90	10	9	61	27.5	22	7	M8			
30	1 27/64	5 3/16	1 1/32	4 3/16	1/2	13/32	2 23/32	1 11/32	0.965	0.295	3/8	USP006S6	SP006	SU006S6
	36	132	26	106	13	10	69	34	24.5	7.5	M10			

Remarks 1. In Part No. of unit and units with covers, fitting codes follow bore diameter codes. (See Table 10.5 in P62.)  
2. For the dimensions and forms of applicable bearings, see the dimensional tables of ball bearing for unit.



With Through Type Cover

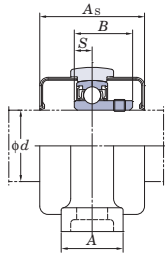

With One Side Sealed Cover

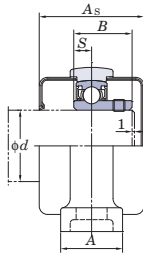

Variations of tolerance of distance from mounting bottom to center of spherical bore ( $\Delta H_s$ ) and variations of tolerance of distance between centers of bolt holes ( $\Delta J_s$ )

Housing No.	Unit: mm	
	$\Delta H_s$	$\Delta J_s$
SP000-SP006	±0.15	±0.3

Mass kg	Basic Load Ratings kN		Factor $f_0$	With Rubber Coated Cover				Mass kg
	$C_r$	$C_{0r}$		Unit No.		Dimension		
				Open Type	One Side Closed Type	mm	inch	
0.076	3.9	1.55	12.3	USP000CS6	USP000CDS6	29	1 5/32	0.08
0.08	4.3	1.9	13.2	USP001CS6	USP001CDS6	29	1 5/32	0.08
0.11	4.7	2.25	13.9	USP002CS6	USP002CDS6	31	1 7/32	0.11
0.14	5.1	2.6	14.4	USP003CS6	USP003CDS6	33	1 5/16	0.14
0.23	7.9	4	13.9	USP004CS6	USP004CDS6	38	1 1/2	0.23
0.28	8.5	4.65	14.5	USP005CS6	USP005CDS6	40	1 9/16	0.28
0.43	11.2	6.6	14.7	USP006CS6	USP006CDS6	44	1 23/32	0.43



**Corrosion Resistant Series Pillow Block Units**

**UCVP-S6**

Cylindrical bore (with set screws)

d 20 ~ 50 mm

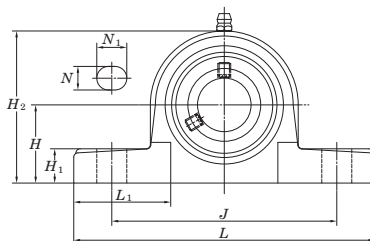
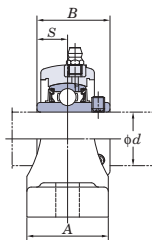

Shaft Dia.		Dimensions										Bolt Size	Standard		
mm	inch	inch / mm											Unit No.	Housing No.	Bearing No.
d		H	L	A	J	N	N <sub>1</sub>	H <sub>1</sub>	H <sub>2</sub>	B	S	inch / mm			
20	3/4	1 5/16	5	1 1/2	3 3/4	7/16	9/16	9/16	2 19/32	1.220	0.500	3/8 M10	UCVP204-12S6 UCVP204S6	VP204	UC204-12S6 UC204S6
	7/8	1 7/16	5 17/32	1 1/2	4 1/8	7/16	9/16	5/8	2 25/32	1.343	0.563	3/8 M10	UCVP205-14S6 UCVP205-15S6 UCVP205S6 UCVP205-16S6	VP205	UC205-14S6 UC205-15S6 UC205S6 UC205-16S6
25	1	1 7/16	5 17/32	1 1/2	4 1/8	7/16	9/16	5/8	2 25/32	1.343	0.563	3/8 M10	UCVP205-14S6 UCVP205-15S6 UCVP205S6 UCVP205-16S6	VP205	UC205-14S6 UC205-15S6 UC205S6 UC205-16S6
	1 1/8	1 11/16	6 13/32	1 13/16	4 11/16	9/16	23/32	11/16	3 5/16	1.500	0.626	1/2 M12	UCVP206-18S6 UCVP206S6 UCVP206-19S6 UCVP206-20S6	VP206	UC206-18S6 UC206S6 UC206-19S6 UC206-20S6
	1 1/4	1 7/8	6 5/8	1 7/8	5	9/16	23/32	23/32	3 23/32	1.689	0.689	1/2 M12	UCVP207-20S6 UCVP207-21S6 UCVP207-22S6 UCVP207S6 UCVP207-23S6	VP207	UC207-20S6 UC207-21S6 UC207-22S6 UC207S6 UC207-23S6
30	1 1/4	1 7/8	6 5/8	1 7/8	5	9/16	23/32	23/32	3 23/32	1.689	0.689	1/2 M12	UCVP207-20S6 UCVP207-21S6 UCVP207-22S6 UCVP207S6 UCVP207-23S6	VP207	UC207-20S6 UC207-21S6 UC207-22S6 UC207S6 UC207-23S6
	1 5/16	1 7/8	6 5/8	1 7/8	5	9/16	23/32	23/32	3 23/32	1.689	0.689	1/2 M12	UCVP207-20S6 UCVP207-21S6 UCVP207-22S6 UCVP207S6 UCVP207-23S6	VP207	UC207-20S6 UC207-21S6 UC207-22S6 UC207S6 UC207-23S6
35	1 3/8	1 7/8	6 5/8	1 7/8	5	9/16	23/32	23/32	3 23/32	1.689	0.689	1/2 M12	UCVP207-20S6 UCVP207-21S6 UCVP207-22S6 UCVP207S6 UCVP207-23S6	VP207	UC207-20S6 UC207-21S6 UC207-22S6 UC207S6 UC207-23S6
	1 7/16	1 7/8	6 5/8	1 7/8	5	9/16	23/32	23/32	3 23/32	1.689	0.689	1/2 M12	UCVP207-20S6 UCVP207-21S6 UCVP207-22S6 UCVP207S6 UCVP207-23S6	VP207	UC207-20S6 UC207-21S6 UC207-22S6 UC207S6 UC207-23S6
40	1 1/2	1 15/16	7 1/4	2 1/8	5 13/32	9/16	23/32	25/32	3 21/32	1.937	0.748	1/2 M12	UCVP208-24S6 UCVP208-25S6 UCVP208S6	VP208	UC208-24S6 UC208-25S6 UC208S6
	1 9/16	1 15/16	7 1/4	2 1/8	5 13/32	9/16	23/32	25/32	3 21/32	1.937	0.748	1/2 M12	UCVP208-24S6 UCVP208-25S6 UCVP208S6	VP208	UC208-24S6 UC208-25S6 UC208S6
45	1 5/8	2 1/8	7 9/16	2 1/8	5 3/4	21/32	25/32	29/32	4 3/16	1.937	0.748	5/8 M14	UCVP209-26S6 UCVP209-27S6 UCVP209-28S6 UCVP209S6	VP209	UC209-26S6 UC209-27S6 UC209-28S6 UC209S6
	1 11/16	2 1/8	7 9/16	2 1/8	5 3/4	21/32	25/32	29/32	4 3/16	1.937	0.748	5/8 M14	UCVP209-26S6 UCVP209-27S6 UCVP209-28S6 UCVP209S6	VP209	UC209-26S6 UC209-27S6 UC209-28S6 UC209S6
50	1 3/4	2 1/4	8 1/8	2 3/8	6 1/4	21/32	25/32	29/32	4 1/2	2.031	0.748	5/8 M14	UCVP210-30S6 UCVP210-31S6 UCVP210S6 UCVP210-32S6	VP210	UC210-30S6 UC210-31S6 UC210S6 UC210-32S6
	1 7/8	2 1/4	8 1/8	2 3/8	6 1/4	21/32	25/32	29/32	4 1/2	2.031	0.748	5/8 M14	UCVP210-30S6 UCVP210-31S6 UCVP210S6 UCVP210-32S6	VP210	UC210-30S6 UC210-31S6 UC210S6 UC210-32S6

- Remarks
1. In Part No. of unit and units with covers, fitting codes follow bore diameter numbers. (See Table 10.5 in P.62.)
  2. Part No. of the applicable grease fitting is A-1/4-28UNFN12.
  3. For the dimensions and forms of applicable bearings, see the dimensional tables of ball bearing for unit.

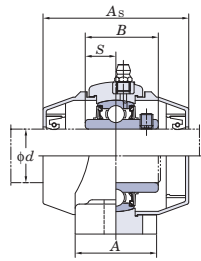

Variations of tolerance of distance from mounting bottom to center of spherical bore ( $\Delta H_s$ )

Unit: mm

Housing No.	$\Delta H_s$
VP204~VP208	$\pm 0.15$
VP209~VP210	$\pm 0.2$

Mass	Basic Load Ratings		Factor	Unit No.		Dimension		Mass
	$C_r$	$C_{0r}$		Open Type	One Side Closed Type	mm	inch	
kg			$f_0$			$A_s$		kg
0.29	10.9	5.35	13.2	UCVP204-12CS6 UCVP204CS6	UCVP204-12CDS6 UCVP204CDS6	63	2 <sup>15</sup> / <sub>32</sub>	0.31
0.41	11.9	6.3	13.9	UCVP205-14CS6 UCVP205-15CS6 UCVP205CS6 UCVP205-16CS6	UCVP205-14CDS6 UCVP205-15CDS6 UCVP205CDS6 UCVP205-16CDS6	68	2 <sup>11</sup> / <sub>16</sub>	0.43
0.6	16.5	9.05	13.9	UCVP206-18CS6 UCVP206CS6 UCVP206-19CS6 UCVP206-20CS6	UCVP206-18CDS6 UCVP206CDS6 UCVP206-19CDS6 UCVP206-20CDS6	79	3 <sup>1</sup> / <sub>8</sub>	0.63
0.84	21.8	12.3	13.9	UCVP207-20CS6 UCVP207-21CS6 UCVP207-22CS6 UCVP207CS6 UCVP207-23CS6	UCVP207-20CDS6 UCVP207-21CDS6 UCVP207-22CDS6 UCVP207CDS6 UCVP207-23CDS6	85	3 <sup>11</sup> / <sub>32</sub>	0.89
1.1	24.8	14.3	14.0	UCVP208-24CS6 UCVP208-25CS6 UCVP208CS6	UCVP208-24CDS6 UCVP208-25CDS6 UCVP208CDS6	96	3 <sup>25</sup> / <sub>32</sub>	1.16
1.2	27.8	16.2	14.0	UCVP209-26CS6 UCVP209-27CS6 UCVP209-28CS6 UCVP209CS6	UCVP209-26CDS6 UCVP209-27CDS6 UCVP209-28CDS6 UCVP209CDS6	107	4 <sup>7</sup> / <sub>32</sub>	1.26
1.4	29.8	18.6	14.4	UCVP210-30CS6 UCVP210-31CS6 UCVP210CS6 UCVP210-32CS6	UCVP210-30CDS6 UCVP210-31CDS6 UCVP210CDS6 UCVP210-32CDS6	120	4 <sup>23</sup> / <sub>32</sub>	1.46



**Corrosion Resistant Series Pillow Block Units**

**UCVP-ES7**

Cylindrical bore (with set screws)

d 20 ~ 50 mm

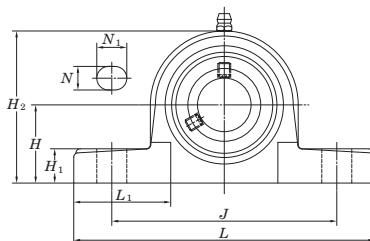
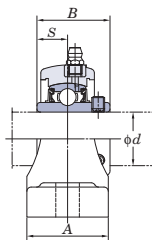

Shaft Dia. mm inch	Dimensions inch mm											Bolt Size inch mm	Standard			
	H	L	A	J	N	N <sub>1</sub>	H <sub>1</sub>	H <sub>2</sub>	B	S	Unit No.		Housing No.	Bearing No.		
d																
20	3/4	1 5/16	5	1 1/2	3 3/4	7/16	9/16	9/16	2 19/32	1.220	0.500	3/8	UCVP204-12ES7	VP204E	UC204-12S7	UC204S7
		33.3	127	38	95	11	14	14.2	65.5	31	12.7	M10	UCVP204ES7			
25	7/8	1 7/16	5 17/32	1 1/2	4 1/8	7/16	9/16	5/8	2 25/32	1.343	0.563	3/8	UCVP205-14ES7	VP205E	UC205-14S7	UC205-15S7
	15/16	36.5	140.5	38	105	11	14	16	71	34.1	14.3	M10	UCVP205-15ES7			
	1												UCVP205ES7			
30	1 1/8	1 11/16	6 13/32	1 13/16	4 11/16	9/16	23/32	11/16	3 5/16	1.500	0.626	1/2	UCVP206-18ES7	VP206E	UC206-18S7	UC206S7
	1 3/16	42.9	163	46	119	14	18	17.8	84	38.1	15.9	M12	UCVP206-19ES7			
	1 1/4												UCVP206-20ES7			
35	1 1/4	1 7/8	6 5/8	1 7/8	5	9/16	23/32	23/32	3 23/32	1.689	0.689	1/2	UCVP207-20ES7	VP207E	UC207-20S7	UC207-21S7
	1 5/16	47.6	168	48	127	14	18	18	94.5	42.9	17.5	M12	UCVP207-21ES7			
	1 3/8												UCVP207-22ES7			
40	1 7/16	1 15/16	7 1/4	2 1/8	5 13/32	9/16	23/32	25/32	3 21/32	1.937	0.748	1/2	UCVP207ES7	VP207E	UC207S7	UC207-23S7
	1 1/2	49.2	184	54	137	14	18	19.5	101	49.2	19	M12	UCVP208-24ES7			
	1 9/16												UCVP208-25ES7			
45	1 5/8	2 1/8	7 9/16	2 1/8	5 3/4	21/32	25/32	29/32	4 3/16	1.937	0.748	5/8	UCVP208ES7	VP208E	UC208-25S7	UC208S7
	1 11/16	54	192	54	146	17	20	23	106	49.2	19	M14	UCVP209-26ES7			
	1 3/4												UCVP209-27ES7			
50	1 7/8	2 1/4	8 1/8	2 3/8	6 1/4	21/32	25/32	29/32	4 1/2	2.031	0.748	5/8	UCVP209-28ES7	VP209E	UC209-28S7	UC209S7
	1 15/16	57.2	206	60	159	17	20	23	114	51.6	19	M14	UCVP209ES7			
	2												UCVP210-30ES7			
50	1 7/8	2 1/4	8 1/8	2 3/8	6 1/4	21/32	25/32	29/32	4 1/2	2.031	0.748	5/8	UCVP210-31ES7	VP210E	UC210-30S7	UC210-31S7
	1 15/16	57.2	206	60	159	17	20	23	114	51.6	19	M14	UCVP210ES7			
	2												UCVP210-32ES7			

- Remarks
1. In Part No. of unit and units with covers, fitting codes follow bore diameter numbers. (See Table 10.5 in P.62.)
  2. Part No. of the applicable grease fitting is A-1/4-28UNFN12.
  3. For the dimensions and forms of applicable bearings, see the dimensional tables of ball bearing for unit.

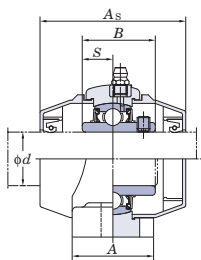

Variations of tolerance of distance from mounting bottom to center of spherical bore ( $\Delta H_s$ )

Unit: mm

Housing No.	$\Delta H_s$
VP204E~VP208E	$\pm 0.15$
VP209E~VP210E	$\pm 0.2$

Mass kg	Basic Load Ratings kN		Factor $f_0$	Unit No.		Dimension mm inch		Mass kg
	$C_r$	$C_{0r}$		Open Type	One Side Closed Type	$A_s$		
0.29	12.8	6.65	13.2	UCVP204-12ECS7	UCVP204-12ECDS7	63	2 <sup>15</sup> / <sub>32</sub>	0.31
				UCVP204ECS7	UCVP204ECDS7			
0.41	14.0	7.85	13.9	UCVP205-14ECS7	UCVP205-14ECDS7	68	2 <sup>11</sup> / <sub>16</sub>	0.43
				UCVP205-15ECS7	UCVP205-15ECDS7			
				UCVP205ECS7	UCVP205ECDS7			
				UCVP205-16ECS7	UCVP205-16ECDS7			
0.6	19.5	11.3	13.9	UCVP206-18ECS7	UCVP206-18ECDS7	79	3 <sup>1</sup> / <sub>8</sub>	0.63
				UCVP206ECS7	UCVP206CDS7			
				UCVP206-19ECS7	UCVP206-19ECDS7			
				UCVP206-20ECS7	UCVP206-20ECDS7			
0.84	25.7	15.4	13.9	UCVP207-20ECS7	UCVP207-20ECDS7	85	3 <sup>11</sup> / <sub>32</sub>	0.89
				UCVP207-21ECS7	UCVP207-21ECDS7			
				UCVP207-22ECS7	UCVP207-22ECDS7			
				UCVP207ECS7	UCVP207ECDS7			
				UCVP207-23ECS7	UCVP207-23ECDS7			
1.1	29.1	17.8	14.0	UCVP208-24ECS7	UCVP208-24ECDS7	96	3 <sup>25</sup> / <sub>32</sub>	1.16
				UCVP208-25ECS7	UCVP208-25ECDS7			
				UCVP208ECS7	UCVP208ECDS7			
				UCVP209-26ECS7	UCVP209-26ECDS7			
1.2	34.1	21.3	14.0	UCVP209-27ECS7	UCVP209-27ECDS7	107	4 <sup>7</sup> / <sub>32</sub>	1.26
				UCVP209-28ECS7	UCVP209-28ECDS7			
				UCVP209ECS7	UCVP209ECDS7			
				UCVP210-30ECS7	UCVP210-30ECDS7			
1.4	35.1	23.3	14.4	UCVP210-31ECS7	UCVP210-31ECDS7	120	4 <sup>23</sup> / <sub>32</sub>	1.46
				UCVP210ECS7	UCVP210ECDS7			
				UCVP210-32ECS7	UCVP210-32ECDS7			



**Corrosion Resistant Series Pillow Block Units**

**UCVPAN-ES7**  
Cylindrical bore (with set screws)  
*d* 20 ~ 35 mm

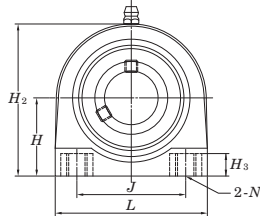
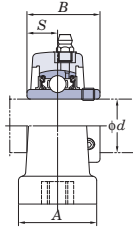

Shaft Dia.		Dimensions									Unit No.	Standard Housing No.	Bearing No.
mm	inch	inch mm											
<i>d</i>		<i>H</i>	<i>L</i>	<i>A</i>	<i>J</i>	<i>N</i>	<i>H</i> <sub>2</sub>	<i>H</i> <sub>3</sub>	<i>B</i>	<i>S</i>			
20	3/4	1 5/16	2 7/8	1 11/32	2	3/8-16UNC	2 19/32	13/32	1.220	0.500	UCVPAN204-12ES7 UCVPAN204ES7	VPAN204E	UC204-12S7 UC204S7
			33.3	73	34.5	50.8		66	10.5	31			
25	7/8	1 7/16	2 25/32	1 7/16	2	3/8-16UNC	2 25/32	13/32	1.343	0.563	UCVPAN205-14ES7 UCVPAN205-15ES7 UCVPAN205ES7 UCVPAN205-16ES7	VPAN205E	UC205-14S7 UC205-15S7 UC205S7 UC205-16S7
		15/16	36.5	71	36.5	50.8		71	10.5	34.1			
30	1 1/8	1 11/16	4	1 11/16	3	7/16-14UNC	3 5/16	15/32	1.500	0.626	UCVPAN206ES7 UCVPAN206-18ES7 UCVPAN206-19ES7 UCVPAN206-20ES7	VPAN206E	UC206-18S7 UC206S7 UC206-19S7 UC206-20S7
		1 3/16	42.9	101.6	42.5	76.2		84	12.1	38.1			
35	1 1/4	1 7/8	4 11/32	1 7/8	3 1/4	1/2-13UNC	3 3/4	17/32	1.689	0.689	UCVPAN207-20ES7 UCVPAN207-21ES7 UCVPAN207-22ES7 UCVPAN207ES7 UCVPAN207-23ES7	VPAN207E	UC207-20S7 UC207-21S7 UC207-22S7 UC207S7 UC207-23S7
		1 5/16	47.6	110	48	82.6		95	13.7	42.9			
	1 3/8												
	1 7/16												

- Remarks
1. In Part No. of unit and units with covers, fitting codes follow bore diameter numbers. (See Table 10.5 in P.62.)
  2. Part No. of the applicable grease fitting is A-1/4-28UNFN12.
  3. For the dimensions and forms of applicable bearings, see the dimensional tables of ball bearing for unit.



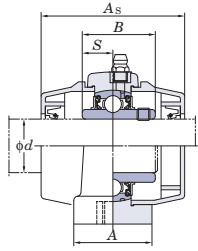

	Mass kg	Basic Load Ratings kN		Factor $f_0$	With Plastic Cover Unit No.		Dimension mm    inch		Mass kg
		$C_r$	$C_{0r}$		Open Type	One Side Closed Type	$A_s$		
	0.26	12.8	6.65	13.2	UCVPAN204-12ECS7 UCVPAN204ECS7	UCVPAN204-12ECDS7 UCVPAN204ECDS7	59.5	2 11/32	0.27
	0.36	14.0	7.85	13.9	UCVPAN205-14ECS7 UCVPAN205-15ECS7 UCVPAN205ECS7 UCVPAN205-16ECS7	UCVPAN205-14ECDS7 UCVPAN205-15ECDS7 UCVPAN205ECDS7 UCVPAN205-16ECDS7	66.5	2 5/8	0.37
	0.54	19.5	11.3	13.9	UCVPAN206-18ECS7 UCVPAN206ECS7 UCVPAN206-19ECS7 UCVPAN206-20ECS7	UCVPAN206-18ECDS7 UCVPAN206CDS7 UCVPAN206-19ECDS7 UCVPAN206-20ECDS7	75.5	2 31/32	0.55
	0.84	25.7	15.4	13.9	UCVPAN207-20ECS7 UCVPAN207-21ECS7 UCVPAN207-22ECS7 UCVPAN207ECS7 UCVPAN207-23ECS7	UCVPAN207-20ECDS7 UCVPAN207-21ECDS7 UCVPAN207-22ECDS7 UCVPAN207ECDS7 UCVPAN207-23ECDS7	85	3 11/32	0.86



**Stamped Steel Pillow Block Units**

**SBPP**  
Cylindrical bore  
(with set screws)  
 $d$  12 ~ 30 mm

**SAPP**  
Cylindrical bore  
(with eccentric locking collar)



SBPP



SAPP

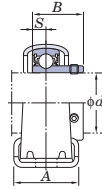

SBPP

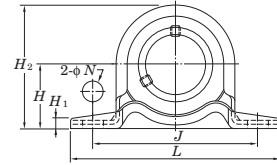

Shaft Dia		Dimensions								SBPP	SAPP	Bolt Size	Unit No.	Bearing No.
mm	inch	inch mm												
$d$		$H$	$L$	$A$	$J$	$N$	$H_1$	$H_2$	$S$	$B$	$B_1$	inch mm		
12	$1/2$	$7/8$	$3 3/8$	$3 1/32$	$2 43/64$	$3/8$	$1/8$	$1 23/32$	0.236	0.866	1.122	$5/16$	<b>SBPP201</b>	SB201
	$5/8$	22.2	86	25	68	9.5	3.2	43.8	6	22	28.5	M8	<b>SBPP201-8</b>	SB201-8
15	$5/8$	22.2	86	25	68	9.5	3.2	43.8	6	22	28.5	M8	<b>SBPP202</b>	SB202
													<b>SBPP202-10</b>	SB202-10
17													<b>SBPP203</b>	SB203
													<b>SBPP204-12</b>	SB204-12
20	$3/4$	1	$3 27/32$	$1 1/4$	$2 63/64$	$3/8$	$1/8$	2	0.276	0.984	1.161	$5/16$	<b>SBPP204-12</b>	SB204-12
		25.4	98	32	76	9.5	3.2	50.5	7	25	29.5	M8	<b>SBPP204</b>	SB204
25	$7/8$	$1 1/8$	$4 1/4$	$1 1/4$	$3 25/64$	$29/64$	$5/32$	$2 7/32$	0.295	1.063	1.201	$3/8$	<b>SBPP205-14</b>	SB205-14
	$15/16$	28.6	108	32	86	11.5	4	56.6	7.5	27	30.5	M10	<b>SBPP205-15</b>	SB205-15
30	1	$1 5/16$	$4 19/32$	$1 1/2$	$3 3/4$	$29/64$	$5/32$	$2 5/8$	0.315	1.181	1.335	$3/8$	<b>SBPP205</b>	SB205
	$1 3/16$	33.3	117	38	95	11.5	4	66.3	8	30	33.9	M10	<b>SBPP205-16</b>	SB205-16
30	$1 1/8$	$1 5/16$	$4 19/32$	$1 1/2$	$3 3/4$	$29/64$	$5/32$	$2 5/8$	0.315	1.181	1.335	$3/8$	<b>SBPP206-18</b>	SB206-18
	$1 3/16$	33.3	117	38	95	11.5	4	66.3	8	30	33.9	M10	<b>SBPP206</b>	SB206
	$1 1/4$												<b>SBPP206-19</b>	SB206-19
													<b>SBPP206-20</b>	SB206-20

Remark For the dimensions and forms of applicable bearings, see the dimensional tables of ball bearing for unit.



# FYH

Variations of tolerance of distance between centers of bolt holes ( $\Delta L_s$ ) and variations of tolerance of bolt hole diameter ( $\Delta L_{vs}$ )

Unit: mm

Housing No.	$\Delta L_s$	$\Delta L_{vs}$
PP203-PP206	$\pm 0.4$	$\pm 0.5$

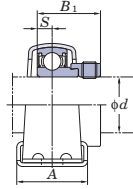

SAPP

Unit No.	Bearing No.	Housing No.	Basic Load Ratings kN		Factor $f_0$	Mass kg	
			$C_r$	$C_{0r}$		SBPP	SAPP
SAPP201	SA201	PP203	9.55	4.80	13.2	0.16	0.19
SAPP201-8	SA201-8						
SAPP202	SA202						
SAPP202-10	SA202-10						
SAPP203	SA203	PP204	12.8	6.65	13.2	0.23	0.23
SAPP204-12	SA204-12						
SAPP204	SA204	PP205	14.0	7.85	13.9	0.28	0.32
SAPP205-14	SA205-14						
SAPP205-15	SA205-15						
SAPP205	SA205						
SAPP205-16	SA205-16	PP206	19.5	11.3	13.9	0.47	0.50
SAPP206-18	SA206-18						
SAPP206	SA206						
SAPP206-19	SA206-19						
SAPP206-20	SA206-20						