

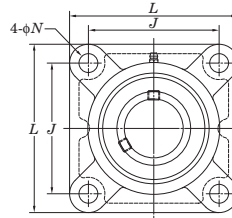

**4-Bolt Flange Units**

**UCF**  
**Cylindrical bore (with set screws)**  
**d 12 ~ (45) mm**

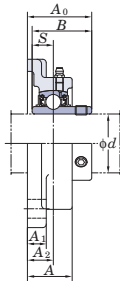

Shaft Dia. mm inch	Dimensions inch mm										Bolt Size inch mm	Standard					
	L	A	J	N	A <sub>1</sub>	A <sub>2</sub>	A <sub>0</sub>	B	S	Unit No.		Housing No.	Bearing No.				
12																	
15	1/2																
17	5/8	3 3/8	1	2 33/64	15/32	7/16	19/32	1 5/16	1.220	0.500	3/8						
20	3/4	86	25.5	64	12	11	15	33.3	31	12.7	M10		F204	UC201 UC201-8 UC202 UC202-10 UC203 UC204-12 UC204			
25	7/8																
	15/16	3 3/4	1 1/16	2 3/4	15/32	1/2	5/8	1 13/32	1.343	0.563	3/8						
	1	95	27	70	12	13	16	35.8	34.1	14.3	M10		F205	UC205-14 UC205-15 UC205 UC205-16			
30	1	4 1/4	1 3/16	3 17/64	15/32	1/2	45/64	1 19/32	1.500	0.626	3/8						
	1	108	30	83	12	13	18	40.2	38.1	15.9	M10		FX05	UCX05 UCX05-16			
	1	4 11/32	1 5/32	3 5/32	5/8	1/2	5/8	1 17/32	1.496	0.591	1/2		F305	UC305 UC305-16			
35	1 1/8																
	1 3/16	4 1/4	1 7/32	3 17/64	15/32	1/2	45/64	1 19/32	1.500	0.626	3/8						
	1 1/4	108	31	83	12	13	18	40.2	38.1	15.9	M10		F206	UC206-18 UC206 UC206-19 UC206-20			
40	1 3/16	4 19/32	1 11/32	3 5/8	5/8	9/16	3/4	1 3/4	1.689	0.689	1/2						
	1 1/4	117	34	92	16	14	19	44.4	42.9	17.5	M14		FX06	UCX06 UCX06-19 UCX06-20			
	—	4 29/32	1 1/4	3 47/64	5/8	19/32	45/64	1 23/32	1.693	0.669	1/2		F306	UC306			
45	1 1/4																
	1 5/16	4 19/32	1 11/32	3 5/8	35/64	19/32	3/4	1 3/4	1.689	0.689	7/16						
	1 3/8	117	34	92	14	15	19	44.4	42.9	17.5	M12		F207	UC207-20 UC207-21 UC207-22 UC207 UC207-23			
50	1 7/16																
	1 3/8	5 1/8	1 1/2	4 1/64	5/8	9/16	53/64	2 1/32	1.937	0.748	1/2						
	1 7/16	130	38	102	16	14	21	51.2	49.2	19	M14		FX07	UCX07-22 UCX07 UCX07-23			
55	—	5 5/16	1 13/32	3 15/16	3/4	5/8	25/32	1 15/16	1.890	0.748	5/8						
	1 1/2	135	36	100	19	16	20	49	48	19	M16		F307	UC307			
	1 9/16	5 1/8	1 13/32	4 1/64	5/8	19/32	53/64	2 1/32	1.937	0.748	1/2						
60	1 1/2	130	36	102	16	15	21	51.2	49.2	19	M14		F208	UC208-24 UC208-25 UC208			
	1 1/2	5 13/32	1 9/16	4 9/64	3/4	9/16	55/64	2 1/16	1.937	0.748	5/8		FX08	UCX08-24 UCX08			
	1 1/2	5 29/32	1 9/16	4 13/32	3/4	21/32	29/32	2 7/32	2.047	0.748	5/8		F308	UC308-24 UC308			
65	1 5/8																
	1 11/16	5 13/32	1 1/2	4 9/64	5/8	5/8	55/64	2 1/16	1.937	0.748	1/2						
	1 3/4	137	38	105	16	16	22	52.2	49.2	19	M14		F209	UC209-26 UC209-27 UC209-28 UC209			
70	1 11/16																
	1 3/4	5 5/8	1 9/16	4 3/8	3/4	9/16	29/32	2 3/16	2.031	0.748	5/8		FX09	UCX09-27 UCX09-28 UCX09			

Remarks 1. In Part No. of unit and units with covers, fitting codes follow bore diameter numbers. (See Table 10.5 in P.62.)  
2. Part No. of applicable grease fittings are shown below.  
A-1/4-28UNF ..... 201~210, X05~X09, 305~308  
A-R1/8..... 211~218, X10~X20, 309~328



With Pressed Steel Cover

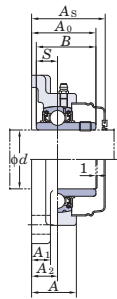

With Cast Iron Cover

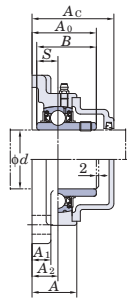

Variations of tolerance of distance from mounting surface to center of spherical bore ( $\Delta A_{2s}$ ) and tolerance of position of bolt hole (X)

Housing No.			$\Delta A_{2s}$	X
F204-F210	FX05-FX10	F305-F310	$\pm 0.5$	0.7
F211-F218	FX11-FX20	F311-F328	$\pm 0.8$	1

Unit: mm

Variations of tolerance of bolt hole diameter ( $\Delta D_h$ )

Housing No.			$\Delta D_h$
F204-F218	FX05-FX18	F305-F315	$\pm 0.2$
	FX20	F316-F328	$\pm 0.3$

Unit: mm

Mass	Basic Load Ratings		Factor	With Pressed Steel Cover				With Cast Iron Cover					
	kg	$C_r$		$C_{0r}$	Unit No.		Dimension		Mass	Unit No.		Mass	
					Open Type	Closed Type	mm	inch		Open Type	Closed Type		mm
0.64	12.8	6.65	13.2	UCF201C	UCF201D	37.5	1 15/32	0.64	-	-	-	-	
0.64	-	-	-	-	-	-	-	-	-	-	-	-	
0.62	-	-	-	UCF202C	UCF202D	37.5	1 15/32	0.62	-	-	-	-	
0.62	-	-	-	-	-	-	-	-	-	-	-	-	
0.61	-	-	-	UCF203C	UCF203D	37.5	1 15/32	0.61	-	-	-	-	
0.61	-	-	-	-	-	-	-	-	-	-	-	-	
0.59	-	-	-	UCF204C	UCF204D	37.5	1 15/32	0.59	UCF204FC	UCF204FD	46	1 13/16	0.74
0.83	-	-	-	-	-	-	-	-	-	-	-	-	
0.83	14.0	7.85	13.9	-	-	-	-	-	-	-	-	-	
0.83	-	-	-	UCF205C	UCF205D	40.5	1 19/32	0.83	UCF205FC	UCF205FD	49	1 15/16	1.0
0.83	-	-	-	-	-	-	-	-	-	-	-	-	
1.2	19.5	11.3	13.9	UCFX05C	UCFX05D	44.5	1 3/4	1.2	-	-	-	-	
1.2	-	-	-	-	-	-	-	-	-	-	-	-	
1.3	21.2	10.9	12.6	-	-	-	-	-	UCF305C	UCF305D	54	2 1/8	1.6
1.3	-	-	-	-	-	-	-	-	-	-	-	-	
1.1	19.5	11.3	13.9	UCF206C	UCF206D	44.5	1 3/4	1.1	UCF206FC	UCF206FD	53	2 3/32	1.4
1.1	-	-	-	-	-	-	-	-	-	-	-	-	
1.1	-	-	-	-	-	-	-	-	-	-	-	-	
1.1	-	-	-	-	-	-	-	-	-	-	-	-	
1.6	25.7	15.4	13.9	UCFX06C	UCFX06D	49	1 15/16	1.6	-	-	-	-	
1.6	-	-	-	-	-	-	-	-	-	-	-	-	
1.6	-	-	-	-	-	-	-	-	-	-	-	-	
1.9	26.7	15.0	13.3	-	-	-	-	-	UCF306C	UCF306D	59	2 5/16	2.2
1.5	25.7	15.4	13.9	-	-	-	-	-	-	-	-	-	
1.5	-	-	-	-	-	-	-	-	-	-	-	-	
1.5	-	-	-	-	-	-	-	-	-	-	-	-	
1.5	-	-	-	UCF207C	UCF207D	49	1 15/16	1.5	UCF207FC	UCF207FD	58	2 3/32	1.9
1.5	-	-	-	-	-	-	-	-	-	-	-	-	
2.0	29.1	17.8	14.0	UCFX07C	UCFX07D	55.5	2 3/16	2.0	-	-	-	-	
2.0	-	-	-	-	-	-	-	-	-	-	-	-	
2.0	-	-	-	-	-	-	-	-	-	-	-	-	
2.3	33.4	19.3	13.2	-	-	-	-	-	UCF307C	UCF307D	64	2 17/32	2.7
1.9	29.1	17.8	14.0	-	-	-	-	-	-	-	-	-	
1.9	-	-	-	-	-	-	-	-	-	-	-	-	
1.9	-	-	-	UCF208C	UCF208D	55.5	2 3/16	1.9	UCF208FC	UCF208FD	64	2 17/32	2.3
2.4	34.1	21.3	14.0	-	-	-	-	-	-	-	-	-	
2.4	-	-	-	UCFX08C	UCFX08D	56.5	2 7/32	2.4	-	-	-	-	
3.1	40.7	24.0	13.2	-	-	-	-	-	-	-	-	-	
3.1	-	-	-	-	-	-	-	-	UCF308C	UCF308D	71	2 25/32	3.6
2.2	34.1	21.3	14.0	-	-	-	-	-	-	-	-	-	
2.2	-	-	-	-	-	-	-	-	-	-	-	-	
2.2	-	-	-	-	-	-	-	-	-	-	-	-	
2.2	-	-	-	UCF209C	UCF209D	56.5	2 7/32	2.2	UCF209FC	UCF209FD	66	2 19/32	2.6
2.7	35.1	23.3	14.4	-	-	-	-	-	-	-	-	-	
2.7	-	-	-	-	-	-	-	-	-	-	-	-	
2.7	-	-	-	UCFX09C	UCFX09D	60	2 3/8	2.7	-	-	-	-	

3. As for the triple seal type product (from 201 to 205 are the double seal type products), suffix code L3 (L2) follows the Part No. of unit or bearing. (Example of Part No. : UCF206JL3, UC206L3)

4. For the dimensions and forms of applicable bearings, see the dimensional tables of ball bearing for unit.

5. Housings of nodular graphite cast iron are also available.



**4-Bolt Flange Units**

**UCF**  
**Cylindrical bore (with set screws)**  
**d (45) ~ (75) mm**

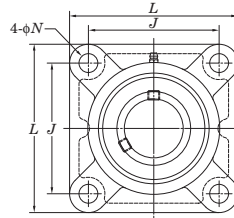
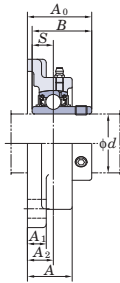

Shaft Dia. mm inch	d	Dimensions inch mm									Bolt Size inch mm	Standard		
		L	A	J	N	A <sub>1</sub>	A <sub>2</sub>	A <sub>0</sub>	B	S		Unit No.	Housing No.	Bearing No.
45	1 3/4	6 5/16 160	1 23/32 44	4 59/64 125	3/4 19	23/32 18	63/64 25	2 3/8 60	2.244 57	0.866 22	5/8 M16	UCF309-28 UCF309	F309	UC309-28 UC309
	1 7/8 1 15/16 2	5 5/8 143	1 9/16 40	4 3/8 111	5/8 16	5/8 16	55/64 22	2 5/32 54.6	2.031 51.6	0.748 19	1/2 M14	UCF210-30 UCF210-31 UCF210 UCF210-32	F210	UC210-30 UC210-31 UC210 UC210-32
50	1 15/16 2	6 3/8 162	1 23/32 44	5 1/8 130	3/4 19	25/32 20	1 1/32 26	2 11/32 59.4	2.189 55.6	0.874 22.2	5/8 M16	UCFX10-31 UCFX10 UCFX10-32	FX10	UCX10-31 UCX10 UCX10-32
	—	6 7/8 175	1 7/8 48	5 13/64 132	29/32 23	3/4 19	1 7/64 28	2 5/8 67	2.402 61	0.866 22	3/4 M20	UCF310	F310	UC310
55	2 2 1/8 2 3/16	6 3/8 162	1 11/16 43	5 1/8 130	3/4 19	23/32 18	63/64 25	2 5/16 58.4	2.189 55.6	0.874 22.2	5/8 M16	UCF211-32 UCF211-34 UCF211 UCF211-35	F211	UC211-32 UC211-34 UC211 UC211-35
	2 3/16 2 1/4	6 7/8 175	1 15/16 49	5 5/8 143	3/4 19	25/32 20	1 9/64 29	2 23/32 68.7	2.563 65.1	1.000 25.4	5/8 M16	UCFX11 UCFX11-35 UCFX11-36	FX11	UCX11 UCX11-35 UCX11-36
	2	7 9/32 185	2 1/16 52	5 33/64 140	29/32 23	25/32 20	1 3/16 30	2 25/32 71	2.598 66	0.984 25	3/4 M20	UCF311-32 UCF311 UCF311-35	F311	UC311-32 UC311 UC311-35
	2 3/16	6 7/8 175	1 7/8 48	5 5/8 143	3/4 19	23/32 18	1 9/64 29	2 23/32 68.7	2.563 65.1	1.000 25.4	5/8 M16	UCF212-36 UCF212 UCF212-38 UCF212-39	F212	UC212-36 UC212 UC212-38 UC212-39
60	2 1/4	7 3/8 187	2 5/16 59	5 55/64 149	3/4 19	13/16 21	1 11/32 34	2 29/32 73.7	2.563 65.1	1.000 25.4	5/8 M16	UCFX12 UCFX12-39	FX12	UCX12 UCX12-39
	2 7/16	7 11/16 195	2 7/32 56	5 29/32 150	29/32 23	7/8 22	1 19/64 33	3 1/16 78	2.795 71	1.024 26	3/4 M20	UCF312 UCF312-39	F312	UC312 UC312-39
	2 7/16	7 3/8 187	1 31/32 50	5 55/64 149	3/4 19	7/8 22	1 3/16 30	2 3/4 69.7	2.563 65.1	1.000 25.4	5/8 M16	UCF213-40 UCF213	F213	UC213-40 UC213
65	2 1/2	7 3/8 187	2 5/16 59	5 55/64 149	3/4 19	13/16 21	1 11/32 34	3 3/32 78.4	2.937 74.6	1.189 30.2	5/8 M16	UCFX13-40 UCFX13	FX13	UCX13-40 UCX13
	2 1/2	8 3/16 208	2 9/32 58	6 17/32 166	29/32 23	7/8 22	1 19/64 33	3 1/16 78	2.953 75	1.181 30	3/4 M20	UCF313-40 UCF313	F313	UC313-40 UC313
70	2 3/4	7 19/32 193	2 1/8 54	5 63/64 152	3/4 19	7/8 22	1 7/32 31	2 31/32 75.4	2.937 74.6	1.189 30.2	5/8 M16	UCF214-44 UCF214	F214	UC214-44 UC214
	2 3/4	7 3/4 197	2 3/8 60	5 63/64 152	29/32 23	7/8 22	1 29/64 37	3 7/32 81.5	3.063 77.8	1.331 33.3	3/4 M20	UCFX14-44 UCFX14	FX14	UCX14-44 UCX14
	2 3/4	8 29/32 226	2 13/32 61	7 1/64 178	63/64 25	31/32 25	1 27/64 36	3 3/16 81	3.071 78	1.299 33	7/8 M22	UCF314-44 UCF314	F314	UC314-44 UC314
75	2 15/16 3	7 7/8 200	2 7/32 56	6 17/64 159	3/4 19	7/8 22	1 11/32 34	3 3/32 78.5	3.063 77.8	1.311 33.3	5/8 M16	UCF215-47 UCF215 UCF215-48	F215	UC215-47 UC215 UC215-48
	2 15/16 3	7 3/4 197	2 11/16 68	5 63/64 152	29/32 23	15/16 24	1 9/16 40	3 17/32 89.3	3.252 82.6	1.311 33.3	3/4 M20	UCFX15-47 UCFX15 UCFX15-48	FX15	UCX15-47 UCX15 UCX15-48

Remarks 1. In Part No. of unit and units with covers, fitting codes follow bore diameter numbers. (See **Table 10.5** in P62.)  
2. Part No. of applicable grease fittings are shown below.  
A-1/4-28UNF ..... 201~210, X05~X09, 305~308  
A-R1/8..... 211~218, X10~X20, 309~328



With Pressed Steel Cover

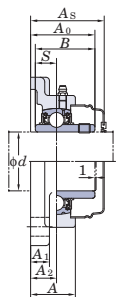

With Cast Iron Cover

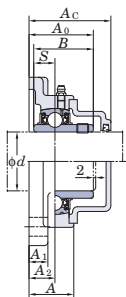

Variations of tolerance of distance from mounting surface to center of spherical bore ( $\Delta A_{2s}$ ) and tolerance of position of bolt hole ( $X$ )

Housing No.			$\Delta A_{2s}$	$X$
F204-F210	FX05-FX10	F305-F310	$\pm 0.5$	0.7
F211-F218	FX11-FX20	F311-F328	$\pm 0.8$	1

Unit: mm

Variations of tolerance of bolt hole diameter ( $\Delta N_b$ )

Housing No.			$\Delta N_b$
F204-F218	FX05-FX18	F305-F315	$\pm 0.2$
	FX20	F316-F328	$\pm 0.3$

Unit: mm

Mass	Basic Load Ratings		Factor	With Pressed Steel Cover				Mass	With Cast Iron Cover				Mass	
	kg	$C_r$		$C_{0r}$	Unit No.	Dimension			Unit No.	Dimension				
						mm	inch			mm	inch			
4.0	48.9	29.5	13.3	-	-	-	-	-	-	-	-	-	-	
4.0	48.9	29.5	13.3	-	-	-	-	UCF309C	UCF309D	76	3	4.6	-	
2.5	35.1	23.3	14.4	-	-	-	-	-	-	-	-	-	-	
2.5				-	-	-	-	-	-	-	-	-	-	-
2.5				UCF210C	UCF210D	59	2 5/16	2.5	UCF210FC	UCF210FD	70.5	2 25/32	3.0	-
2.5				-	-	-	-	-	-	-	-	-	-	-
3.7	43.4	29.4	14.4	-	-	-	-	-	-	-	-	-	-	
3.7				UCFX10C	UCFX10D	64	2 17/32	3.7	-	-	-	-	-	
3.7				-	-	-	-	-	-	-	-	-	-	
5.1	62.0	38.3	13.2	-	-	-	-	UCF310C	UCF310D	83	3 9/32	5.9	-	
3.4	43.4	29.4	14.4	-	-	-	-	-	-	-	-	-	-	
3.4				-	-	-	-	-	-	-	-	-	-	
3.4				UCF211C	UCF211D	63	2 15/32	3.4	UCF211FC	UCF211FD	74.5	2 15/16	4.0	
3.4				-	-	-	-	-	-	-	-	-	-	
4.9	52.4	36.2	14.4	UCFX11C	UCFX11D	73.5	2 29/32	4.9	-	-	-	-		
4.9				-	-	-	-	-	-	-	-	-		
4.9				-	-	-	-	-	-	-	-	-		
5.6	71.6	45.0	13.2	-	-	-	-	-	-	-	-	-		
5.6				-	-	-	-	-	UCF311C	UCF311D	87	3 7/16	6.5	
5.6				-	-	-	-	-	-	-	-	-		
4.2	52.4	36.2	14.4	UCF212C	UCF212D	73.5	2 29/32	4.2	UCF212FC	UCF212FD	86	3 3/8	5.0	
4.2				-	-	-	-	-	-	-	-	-		
4.2				-	-	-	-	-	-	-	-	-		
4.2				-	-	-	-	-	-	-	-	-		
5.7	57.2	40.1	14.4	UCFX12C	UCFX12D	78.5	3 3/32	5.7	-	-	-			
6.9	81.9	52.2	13.2	-	-	-	-	-	UCF312C	UCF312D	95	3 3/4	8.1	
6.9				-	-	-	-	-	-	-	-	-		
5.2	57.2	40.1	14.4	-	-	-	-	-	-	-	-	-		
5.2				UCF213C	UCF213D	74.5	2 15/16	5.2	UCF213FC	UCF213FD	87	3 7/16	6.0	
6.3	62.2	44.1	14.5	-	-	-	-	-	-	-	-	-		
6.3				UCFX13C	UCFX13D	83.5	3 9/32	6.3	-	-	-	-		
7.8	92.7	59.9	13.2	-	-	-	-	-	UCF313C	UCF313D	94	3 11/16	8.9	
7.8				-	-	-	-	-	-	-	-	-		
5.9	62.2	44.1	14.5	UCF214C	UCF214D	80.5	3 5/32	5.9	UCF214FC	UCF214FD	93	3 21/32	6.8	
5.9				-	-	-	-	-	-	-	-	-		
7.0	67.4	48.3	14.5	UCFX14C	UCFX14D	86.5	3 13/32	7.0	-	-	-	-		
7.0				-	-	-	-	-	-	-	-	-		
10.1	104	68.2	13.2	-	-	-	-	-	UCF314C	UCF314D	98	3 27/32	11.2	
10.1				-	-	-	-	-	-	-	-	-		
6.4	67.4	48.3	14.5	UCF215C	UCF215D	83.5	3 9/32	6.4	UCF215FC	UCF215FD	96	3 25/32	7.4	
6.4				-	-	-	-	-	-	-	-	-		
6.4				-	-	-	-	-	-	-	-	-		
8.4	72.7	53.0	14.6	UCFX15C	UCFX15D	94.5	3 23/32	8.4	-	-	-	-		
8.4				-	-	-	-	-	-	-	-			
8.4				-	-	-	-	-	-	-	-			

- As for the triple seal type product (from 201 to 205 are the double seal type products), suffix code L3 (L2) follows the Part No. of unit or bearing. (Example of Part No. : UCF206JL3, UC206L3)
- For the dimensions and forms of applicable bearings, see the dimensional tables of ball bearing for unit.
- Housings of nodular graphite cast iron are also available.



**4-Bolt Flange Units**

**UCF**  
**Cylindrical bore (with set screws)**  
**d (75) ~ 140 mm**

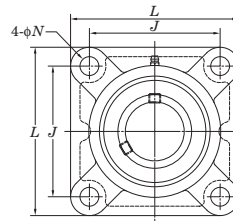
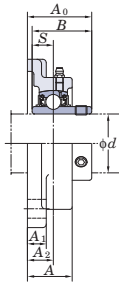

Shaft Dia. mm inch	Dimensions										Bolt Size inch mm	Standard		
	L	A	J	N	A <sub>1</sub>	A <sub>2</sub>	A <sub>0</sub>	B	S	Unit No.		Housing No.	Bearing No.	
75 3	2 <sup>15</sup> / <sub>16</sub> 9 9/32	2 <sup>19</sup> / <sub>32</sub> 66	7 1/4 184	63/64 25	31/32 25	1 17/32 39	3 1/2 89	3.228 82	1.260 32	7/8 M22	UCF315-47 UCF315 UCF315-48	F315	UC315-47 UC315 UC315-48	
	3 1/8 8 3/16	2 9/32 58	6 1/2 165	29/32 23	7/8 22	1 11/32 34	3 9/32 83.3	3.252 82.6	1.311 33.3	3/4 M20	UCF216-50 UCF216	F216	UC216-50 UC216	
80	8 7/16 214	2 3/4 70	6 47/64 171	29/32 23	15/16 23	1 9/16 40	3 19/32 91.6	3.374 85.7	1.343 34.1	3/4 M20	UCFX16	FX16	UCX16	
	9 27/32 250	2 11/16 68	7 23/32 196	1 7/32 31	1 1/16 27	1 1/2 38	3 17/32 90	3.386 86	1.339 34	1 M27	UCF316	F316	UC316	
85	3 1/4 8 1/4	2 15/32 63	6 57/64 175	29/32 23	15/16 24	1 13/32 36	3 7/16 87.6	3.374 85.7	1.343 34.1	3/4 M20	UCF217-52 UCF217	F217	UC217-52 UC217	
	8 7/16 214	2 3/4 70	6 47/64 171	29/32 23	15/16 24	1 9/16 40	3 25/32 96.3	3.780 96	1.563 39.7	3/4 M20	UCFX17 UCFX17-55	FX17	UCX17 UCX17-55	
90	10 1/4 260	2 29/32 74	8 1/32 204	1 7/32 31	1 1/16 27	1 47/64 44	3 15/16 100	3.780 96	1.575 40	1 M27	UCF317	F317	UC317	
	3 1/2 9 1/4	2 11/16 68	7 23/64 187	29/32 23	31/32 25	1 9/16 40	3 25/32 96.3	3.780 96	1.563 39.7	3/4 M20	UCF218-56 UCF218	F218	UC218-56 UC218	
95	8 7/16 214	3 76	6 47/64 171	29/32 23	15/16 24	1 49/64 45	4 3/16 106.1	4.094 104	1.689 42.9	3/4 M20	UCFX18	FX18	UCX18	
	3 1/2 11 1/32	3 8 1/2	8 1/2 216	1 3/8 35	1 3/16 30	1 47/64 44	3 15/16 100	3.780 96	1.575 40	1 1/8 M30	UCF318-56 UCF318	F318	UC318-56 UC318	
100	11 13/32 290	3 11/16 94	8 21/32 228	1 3/8 35	1 3/16 30	2 21/64 59	4 3/4 121	4.055 103	1.614 41	1 1/8 M30	UCF319	F319	UC319	
	3 15/16 4	10 9/16 268	3 13/16 97	8 5/16 211	1 7/32 31	1 3/32 28	2 21/64 59	5 127.3	4.626 117.5	1.937 49.2	1 M27	UCFX20 UCFX20-63 UCFX20-64	FX20	UCX20 UCX20-63 UCX20-64
105	12 7/32 310	3 11/16 94	9 17/32 242	1 1/2 38	1 1/4 32	2 21/64 59	4 29/32 125	4.252 108	1.654 42	1 1/4 M33	UCF320 UCF320-63 UCF320-64	F320	UC320 UC320-63 UC320-64	
	13 3/8 340	3 25/32 96	10 15/32 266	1 39/64 41	1 3/8 35	2 23/64 60	5 5/32 131	4.606 117	1.811 46	1 3/8 M36	UCF321	F321	UC321	
110	14 9/16 370	4 11/32 110	11 27/64 290	1 39/64 41	1 9/16 40	2 9/16 65	5 1/2 140	4.961 126	2.008 51	1 3/8 M36	UCF322	F322	UC322	
	16 5/32 410	4 17/32 115	12 19/32 320	1 39/64 41	1 25/32 45	2 9/16 65	5 3/4 146	5.315 135	2.126 54	1 3/8 M36	UCF323	F323	UC323	
120	17 23/32 450	4 29/32 125	13 25/32 350	1 39/64 41	2 5/32 55	2 61/64 75	6 11/32 161	5.709 145	2.323 59	1 3/8 M36	UCF324	F324	UC324	
	130	17 23/32 450	4 29/32 125	13 25/32 350	1 39/64 41	2 5/32 55	2 61/64 75	6 11/32 161	5.709 145	2.323 59	1 3/8 M36	UCF325	F325	UC325
130	17 23/32 450	4 29/32 125	13 25/32 350	1 39/64 41	2 5/32 55	2 61/64 75	6 11/32 161	5.709 145	2.323 59	1 3/8 M36	UCF326	F326	UC326	
	140	17 23/32 450	4 29/32 125	13 25/32 350	1 39/64 41	2 5/32 55	2 61/64 75	6 11/32 161	5.709 145	2.323 59	1 3/8 M36	UCF327	F327	UC327
140	17 23/32 450	4 29/32 125	13 25/32 350	1 39/64 41	2 5/32 55	2 61/64 75	6 11/32 161	5.709 145	2.323 59	1 3/8 M36	UCF328	F328	UC328	

Remarks 1. In Part No. of unit and units with covers, fitting codes follow bore diameter numbers. (See Table 10.5 in P62.)  
2. Part No. of applicable grease fittings are shown below.  
A-1/4-28UNF ..... 201~210, X05~X09, 305~308  
A-R1/8..... 211~218, X10~X20, 309~328



With Pressed Steel Cover

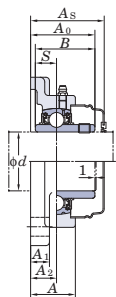

With Cast Iron Cover

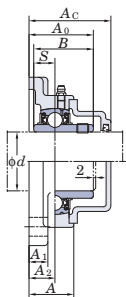

Variations of tolerance of distance from mounting surface to center of spherical bore ( $\Delta A_{2s}$ ) and tolerance of position of bolt hole ( $X$ )

Housing No.			$\Delta A_{2s}$	$X$
F204-F210	FX05-FX10	F305-F310	$\pm 0.5$	0.7
F211-F218	FX11-FX20	F311-F328	$\pm 0.8$	1

Unit: mm

Variations of tolerance of bolt hole diameter ( $\Delta N_h$ )

Housing No.			$\Delta N_h$
F204-F218	FX05-FX18	F305-F315	$\pm 0.2$
	FX20	F316-F328	$\pm 0.3$

Unit: mm

Mass	Basic Load Ratings		Factor	With Pressed Steel Cover				With Cast Iron Cover					
	kg	$C_r$		$C_{0r}$	Unit No.		Dimension		Mass	Unit No.		Mass	
					Open Type	Closed Type	mm	inch		Open Type	Closed Type		mm
11.6				-	-	-	-	-	-	-	-	-	-
11.6	113	77.2	13.2	-	-	-	-	UCF315C	UCF315D	106	4 <sup>3</sup> / <sub>16</sub>	12.9	
11.6				-	-	-	-	-	-	-	-	-	-
7.3				-	-	-	-	-	-	-	-	-	-
7.3	72.7	53.0	14.6	UCF216C	UCF216D	88.5	3 <sup>15</sup> / <sub>32</sub>	7.3	UCF216FC	UCF216FD	103	4 <sup>1</sup> / <sub>16</sub>	8.5
9.4	84.0	61.9	14.5	UCFX16C	UCFX16D	96.5	3 <sup>13</sup> / <sub>16</sub>	9.4	-	-	-	-	-
12.8	123	86.7	13.3	-	-	-	-	UCF316C	UCF316D	107	4 <sup>7</sup> / <sub>32</sub>	14.2	
8.9				-	-	-	-	-	-	-	-	-	-
8.9	84.0	61.9	14.5	UCF217C	UCF217D	92.5	3 <sup>21</sup> / <sub>32</sub>	8.9	UCF217FC	UCF217FD	107	4 <sup>7</sup> / <sub>32</sub>	10.3
10.8				-	-	-	-	-	-	-	-	-	-
10.8	96.1	71.5	14.5	UCFX17C	UCFX17D	101.5	4	10.8	-	-	-	-	-
15.3	133	96.8	13.3	-	-	-	-	UCF317C	UCF317D	117	4 <sup>19</sup> / <sub>32</sub>	16.9	
11.4				-	-	-	-	-	-	-	-	-	-
11.4	96.1	71.5	14.5	UCF218C	UCF218D	101.5	4	11.4	UCF218FC	UCF218FD	116	4 <sup>9</sup> / <sub>16</sub>	12.9
11.9	109	81.9	14.4	-	-	-	-	UCFX18C	UCFX18C	124	4 <sup>7</sup> / <sub>8</sub>	13.6	
18.9				-	-	-	-	-	-	-	-	-	-
18.9	143	107	13.3	-	-	-	-	UCF318C	UCF318D	119	4 <sup>11</sup> / <sub>16</sub>	20.8	
21.6	153	119	13.3	-	-	-	-	UCF319C	UCF319D	140	5 <sup>1</sup> / <sub>2</sub>	23.8	
19.4				-	-	-	-	UCFX20C	UCFX20D	152	5 <sup>31</sup> / <sub>32</sub>	21.6	
19.4	133	105	14.4	-	-	-	-	-	-	-	-	-	-
19.4				-	-	-	-	-	-	-	-	-	-
25.8				-	-	-	-	UCF320C	UCF320D	146	5 <sup>3</sup> / <sub>4</sub>	28.6	
25.8	173	141	13.2	-	-	-	-	-	-	-	-	-	-
25.8				-	-	-	-	-	-	-	-	-	-
30.2	184	153	13.2	-	-	-	-	UCF321C	UCF321D	148	5 <sup>13</sup> / <sub>16</sub>	33.2	
35.3	205	180	13.2	-	-	-	-	UCF322C	UCF322D	154	6 <sup>1</sup> / <sub>16</sub>	41.7	
47.3	207	185	13.5	-	-	-	-	UCF324C	UCF324D	163	6 <sup>13</sup> / <sub>32</sub>	52.1	
65.5	229	214	13.6	-	-	-	-	UCF326C	UCF326D	172	6 <sup>25</sup> / <sub>32</sub>	71.6	
80.4	253	246	13.6	-	-	-	-	UCF328C	UCF328D	186	7 <sup>5</sup> / <sub>16</sub>	89	

- As for the triple seal type product (from 201 to 205 are the double seal type products), suffix code L3 (L2) follows the Part No. of unit or bearing. (Example of Part No. : UCF206JL3, UC206L3)
- For the dimensions and forms of applicable bearings, see the dimensional tables of ball bearing for unit.
- Housings of nodular graphite cast iron are also available.



**4-Bolt Flange Units**

**UCF-E**  
**Cylindrical bore (with set screws)**  
*d* 12 ~ 50 mm

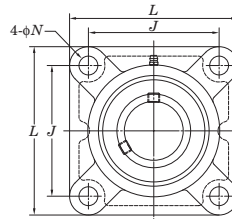
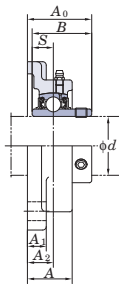

Shaft Dia. mm	inch	Dimensions									Bolt Size inch	Unit No.	Housing No.	Bearing No.
		<i>L</i>	<i>A</i>	<i>J</i>	<i>N</i>	<i>A</i> <sub>1</sub>	<i>A</i> <sub>2</sub>	<i>A</i> <sub>0</sub>	<i>B</i>	<i>S</i>				
12	1/2											UCF201E UCF201-8E UCF202E	F204E	UC201 UC201-8 UC202 UC202-10 UC203 UC204-12 UC204
15	5/8	3 3/8	1	2 33/64	7/16	7/16	19/32	1 5/16	1.220	0.500	3/8	UCF202-10E UCF203E UCF204-12E UCF204E		
17	3/4	86	25.5	64	11	11	15	33.3	31	12.7				
20												UCF205-14E UCF205-15E UCF205E UCF205-16E	F205E	UC205-14 UC205-15 UC205 UC205-16
25	7/8	3 3/4	1 1/16	2 3/4	15/32	1/2	5/8	1 13/32	1.343	0.563	3/8	UCF206-18E UCF206E UCF206-19E UCF206-20E		
	15/16	95	27	70	12	13	16	35.8	34.1	14.3		UCFX05E UCFX05-16E	FX05E	UCX05 UCX05-16
	1	4 1/4	1 3/16	3 17/64	15/32	1/2	45/64	1 19/32	1.500	0.626	3/8	UCFX06-19E UCFX06-20E		
	1 1/8	108	30	83	12	13	18	40.2	38.1	15.9		UCFX06E UCFX06-19E UCFX06-20E	FX06E	UCX06 UCX06-19 UCX06-20
30	3 1/16	4 1/4	1 7/32	3 17/64	33/64	1/2	45/64	1 19/32	1.500	0.626	7/16	UCF207-20E UCF207-21E UCF207-22E UCF207E UCF207-23E		
	1 1/4	117	34	92	13	14	19	44.4	42.9	17.5		UCFX07-22E UCFX07E UCFX07-23E	FX07E	UCX07 UCX07-23
	1 3/8	4 19/32	1 11/32	3 5/8	33/64	9/16	3/4	1 3/4	1.689	0.689	7/16	UCF208-24E UCF208-25E UCF208E		
	1 7/16	130	38	102	13	14	21	51.2	49.2	19		UCFX08-24E UCFX08E	FX08E	UCX08-24 UCX08
40	1 1/2	5 1/8	1 13/32	4 1/64	35/64	19/32	53/64	2 1/32	1.937	0.748	1/2	UCF209-26E UCF209-27E UCF209-28E UCF209E		
	1 9/16	130	36	102	14	15	21	51.2	49.2	19		UCFX09-27E UCFX09-28E UCFX09E	FX09E	UCX09-27 UCX09-28 UCX09
	1 1/2	5 13/32	1 9/16	4 9/64	5/8	5/8	55/64	2 1/16	1.937	0.748	1/2	UCF210-30E UCF210-31E UCF210E UCF210-32E		
	1 5/8	137	38	105	16	16	22	52.2	49.2	19		UCFX10-31E UCFX10E UCFX10-32E	FX10E	UCX10-31 UCX10 UCX10-32
45	1 11/16	5 5/8	1 9/16	4 3/8	19/32	9/16	29/32	2 3/16	2.031	0.748	1/2	UCF210-30E UCF210-31E UCF210E UCF210-32E		
	1 3/4	137	38	105	16	16	22	52.2	49.2	19		UCFX10-31E UCFX10E UCFX10-32E	FX10E	UCX10-31 UCX10 UCX10-32
	1 11/16	5 5/8	1 9/16	4 3/8	19/32	9/16	29/32	2 3/16	2.031	0.748	1/2	UCF210-30E UCF210-31E UCF210E UCF210-32E		
	1 7/8	143	40	111	15	14	23	55.6	51.6	19		UCFX10-31E UCFX10E UCFX10-32E	FX10E	UCX10-31 UCX10 UCX10-32
50	1 15/16	6 3/8	1 23/32	5 1/8	21/32	25/32	1 1/32	2 11/32	2.189	0.874	9/16	UCF210-30E UCF210-31E UCF210E UCF210-32E		
	2	162	44	130	16.5	20	26	59.4	55.6	22.2		UCFX10-31E UCFX10E UCFX10-32E	FX10E	UCX10-31 UCX10 UCX10-32
	2	6 3/8	1 23/32	5 1/8	21/32	25/32	1 1/32	2 11/32	2.189	0.874	9/16	UCF210-30E UCF210-31E UCF210E UCF210-32E		

Remarks 1. In Part No. of unit, fitting codes follow bore diameter numbers. (See **Table 10.5** in P.62.)  
 2. Part No. of applicable grease fittings are shown below.  
 A-1/4-28UNF ..... 201~210, X05~X09  
 A-R1/8..... 211~217, X10~X17



# FYH

Variations of tolerance of distance from mounting surface to center of spherical bore ( $\Delta_{A2s}$ ) and tolerance of position of bolt hole ( $X$ )

Housing No.		$\Delta_{A2s}$	$X$
F204E~F210E	FX05E~FX10E	$\pm 0.5$	0.7
F211E~F217E	FX11E~FX17E	$\pm 0.8$	1

Unit: mm

Variations of tolerance of bolt hole diameter ( $\Delta_{N6}$ )

Housing No.		$\Delta_{N6}$
F204E~F217E	FX05E~FX17E	$\pm 0.2$

Unit: mm

	Basic Load Ratings kN		Factor	Mass
	$C_r$	$C_{0r}$	$f_0$	kg
				0.64
	12.8	6.65	13.2	0.62
				0.61
				0.59
	14.0	7.85	13.9	0.83
	19.5	11.3	13.9	1.2
	19.5	11.3	13.9	1.1
	25.7	15.4	13.9	1.6
	25.7	15.4	13.9	1.5
	29.1	17.8	14.0	2.0
	29.1	17.8	14.0	1.9
	34.1	21.3	14.0	2.4
	34.1	21.3	14.0	2.2
	35.1	23.3	14.4	2.7
	35.1	23.3	14.4	2.5
	43.4	29.4	14.4	3.7

3. As for the triple seal type product (from 201 to 205 are the double seal type products), suffix code L3 (L2) follows the Part No. of unit or bearing. (Example of Part No. : UCF206EJL3, UCF206L3)

4. For the dimensions and forms of applicable bearings, see the dimensional tables of ball bearing for unit.

5. Housings of nodular graphite cast iron are also available.





**4-Bolt Flange Units**

**UCF-E**

**Cylindrical bore (with set screws)**

*d* 55 ~ 85 mm

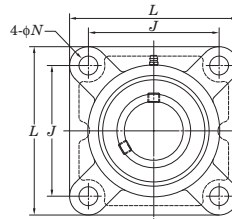
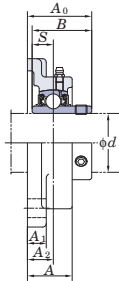

Shaft Dia. mm inch	Dimensions										Bolt Size inch	Unit No.	Housing No.	Bearing No.
	<i>L</i>	<i>A</i>	<i>J</i>	<i>N</i>	<i>A</i> <sub>1</sub>	<i>A</i> <sub>2</sub>	<i>A</i> <sub>0</sub>	<i>B</i>	<i>S</i>	inch mm				
55 <i>d</i> 2 1/8 2 3/16	6 3/8	1 11/16	5 1/8	43/64	23/32	63/64	2 5/16	2.189	0.874	0.874	5/8	UCF211-32E UCF211-34E UCF211E UCF211-35E	F211E	UC211-32 UC211-34 UC211 UC211-35
	6 7/8	1 15/16	5 5/8	21/32	25/32	1 9/64	2 23/32	2.563	1.000	1.000	9/16	UCFX11E UCFX11-35E UCFX11-36E	FX11E	UCX11 UCX11-35 UCX11-36
	6 7/8	1 7/8	5 5/8	43/64	23/32	1 9/64	2 23/32	2.563	1.000	1.000	5/8	UCF212-36E UCF212E UCF212-38E UCF212-39E	F212E	UC212-36 UC212 UC212-38 UC212-39
60 <i>d</i> 2 1/4 2 3/8 2 7/16	7 3/8	2 5/16	5 55/64	21/32	13/16	1 11/32	2 29/32	2.563	1.000	1.000	9/16	UCFX12E	FX12E	UCX12 UCX12-39
	187	59	149	16.5	21	34	73.7	65.1	25.4	25.4	5/8	UCF212-39E UCFX12-39E		
65 <i>d</i> 2 1/2 2 7/8	7 3/8	1 31/32	5 55/64	43/64	7/8	1 3/16	2 3/4	2.563	1.000	1.000	5/8	UCF213-40E UCFX13E	F213E	UC213-40 UC213
	187	50	149	17	22	30	69.7	65.1	25.4	25.4	9/16	UCF213E UCFX13E	FX13E	UC213 UCX13
70 <i>d</i> 2 3/4 2 7/8	7 19/32	2 1/8	5 63/64	3/4	7/8	1 7/32	2 31/32	2.937	1.189	1.189	5/8	UCF214-44E UCF214E	F214E	UC214-44 UC214
	193	54	152	19	22	31	75.4	74.6	30.2	30.2	11/16	UCFX14-44E UCFX14E	FX14E	UCX14-44 UCX14
75 <i>d</i> 2 15/16 3 3	7 7/8	2 7/32	6 17/64	3/4	7/8	1 11/32	3 3/32	3.063	1.311	1.311	5/8	UCF215-47E UCF215E UCF215-48E	F215E	UC215-47 UC215 UC215-48
	200	56	159	19	22	34	78.5	77.8	33.3	33.3	11/16	UCFX15-47E UCFX15E UCFX15-48E	FX15E	UCX15-47 UCX15 UCX15-48
80 <i>d</i> 3 1/8 3 1/2	8 3/16	2 9/32	6 1/2	3/4	7/8	1 11/32	3 9/32	3.252	1.311	1.311	11/16	UCF216-50E UCF216E	F216E	UC216-50 UC216
	208	58	165	19	22	34	83.3	82.6	33.3	33.3	11/16	UCFX16E	FX16E	UCX16
85 <i>d</i> 3 1/4 3 1/2 3 7/16	8 7/16	2 3/4	6 47/64	25/32	15/16	1 9/16	3 19/32	3.374	1.343	1.343	11/16	UCF216-50E UCF216E	F216E	UC216-50 UC216
	214	70	171	20	24	40	91.6	85.7	34.1	34.1	11/16	UCFX16E	FX16E	UCX16
	8 21/32	2 15/32	6 57/64	3/4	15/16	1 13/32	3 7/16	3.374	1.343	1.343	11/16	UCF217-52E UCF217E	F217E	UC217-52 UC217
220	63	175	19	24	36	87.6	85.7	34.1	34.1	11/16	UCF217E	F217E	UC217	
8 7/16	2 3/4	6 47/64	25/32	15/16	1 9/16	3 25/32	3.780	1.563	1.563	11/16	UCFX17E	FX17E	UCX17	
214	70	171	20	24	40	96.3	96	39.7	39.7	39.7	11/16	UCFX17-55E	FX17E	UCX17-55

Remarks 1. In Part No. of unit, fitting codes follow bore diameter numbers. (See Table 10.5 in P.62.)  
2. Part No. of applicable grease fittings are shown below.  
A-1/4-28UNF ..... 201~210, X05~X09  
A-R1/8..... 211~217, X10~X17



**FYH**

Variations of tolerance of distance from mounting surface to center of spherical bore ( $\Delta_{A2s}$ ) and tolerance of position of bolt hole ( $X$ )

Housing No.		$\Delta_{A2s}$	$X$
F204E~F210E	FX05E~FX10E	$\pm 0.5$	0.7
F211E~F217E	FX11E~FX17E	$\pm 0.8$	1

Unit: mm

Variations of tolerance of bolt hole diameter ( $\Delta_{N6}$ )

Housing No.		$\Delta_{N6}$
F204E~F217E	FX05E~FX17E	$\pm 0.2$

Unit: mm

	Basic Load Ratings kN		Factor	Mass
	$C_r$	$C_{0r}$	$f_0$	kg
	43.4	29.4	14.4	3.4
	52.4	36.2	14.4	4.9
	52.4	36.2	14.4	4.2
	57.2	40.1	14.4	5.7
	57.2	40.1	14.4	5.2
	62.2	44.1	14.5	6.3
	62.2	44.1	14.5	5.9
	67.4	48.3	14.5	7.0
	67.4	48.3	14.5	6.4
	72.7	53.0	14.6	8.4
	72.7	53.0	14.6	7.3
	84.0	61.9	14.5	9.4
	84.0	61.9	14.5	8.9
	96.1	71.5	14.5	10.8

- As for the triple seal type product (from 201 to 205 are the double seal type products), suffix code L3 (L2) follows the Part No. of unit or bearing. (Example of Part No. : UCF206EJL3, UC206L3)
- For the dimensions and forms of applicable bearings, see the dimensional tables of ball bearing for unit.
- Housings of nodular graphite cast iron are also available.



**4-Bolt Flange Units**

**NANF**  
**Cylindrical bore**  
**(with eccentric locking collar)**  
*d* 12 ~ 60 mm

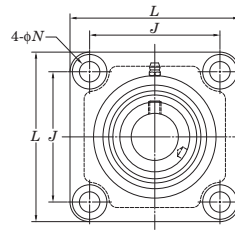
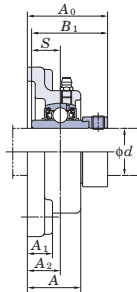

Shaft Dia		Dimensions									Bolt Size	Unit No.	Housing No.	Bearing No.
mm	inch	inch mm												
<i>d</i>		<i>L</i>	<i>A</i>	<i>J</i>	<i>N</i>	<i>A</i> <sub>1</sub>	<i>A</i> <sub>2</sub>	<i>A</i> <sub>0</sub>	<i>B</i> <sub>1</sub>	<i>S</i>				
12	1/2										3/8	NANF201	NF204	NA201
15	5/8	3 3/8	1 5/32	2 33/64	7/16	19/32	3/4	1 25/32	1.720	0.673		NANF201-8		NA201-8
17	3/4	86	29.5	64	11	15	19	45.6	43.7	17.1		NANF202		NA202
20												NANF202-10		NA202-10
												NANF203	NA203	
												NANF204-12	NA204-12	
												NANF204	NA204	
25	7/8	3 3/4	1 7/32	2 3/4	15/32	19/32	25/32	1 27/32	1.748	0.689	7/16	NANF205-14	NF205	NA205-14
	15/16	95	31	70	12	15	20	46.9	44.4	17.5		NANF205-15		NA205-15
												NANF205		NA205
	1											NANF205-16		NA205-16
30	1 1/8	4 1/4	1 11/32	3 17/64	33/64	5/8	53/64	2	1.906	0.720	7/16	NANF206-18	NF206	NA206-18
	1 3/16	108	34	83	13	16	21	51.1	48.4	18.3		NANF206		NA206
	1 1/4											NANF206-19		NA206-19
												NANF206-20		NA206-20
35	1 1/4	4 19/32	1 7/16	3 5/8	33/64	21/32	27/32	2 1/8	2.012	0.740	7/16	NANF207-20	NF207	NA207-20
	1 5/16	117	36.5	92	13	17	21.5	53.8	51.1	18.8		NANF207-21		NA207-21
	1 3/8											NANF207-22		NA207-22
	1 7/16											NANF207		NA207
												NANF207-23	NA207-23	
40	1 1/2	5 1/8	1 17/32	4 1/64	35/64	21/32	15/16	2 5/16	2.217	0.843	1/2	NANF208-24	NF208	NA208-24
	1 9/16	130	39	102	14	17	24	58.9	56.3	21.4		NANF208-25		NA208-25
												NANF208		NA208
45	1 5/8	5 13/32	1 9/16	4 9/64	5/8	23/32	15/16	2 5/16	2.217	0.843	9/16	NANF209-26	NF209	NA209-26
	1 11/16	137	40	105	16	18	24	58.9	56.3	21.4		NANF209-27		NA209-27
	1 3/4											NANF209-28		NA209-28
												NANF209	NA209	
50	1 7/8	5 5/8	1 27/32	4 3/8	43/64	25/32	1 1/8	2 5/8	2.469	0.969	9/16	NANF210-30	NF210	NA210-30
	1 15/16	143	46.5	111	17	20	28.5	66.6	62.7	24.6		NANF210-31		NA210-31
												NANF210		NA210
	2											NANF210-32	NA210-32	
55	2 1/8	6 3/8	1 31/32	5 1/8	43/64	13/16	1 17/64	2 31/32	2.811	1.094	5/8	NANF211-32	NF211	NA211-32
		162	50	130	17	21	32	75.6	71.4	27.8		NANF211-34		NA211-34
												NANF211		NA211
	2 3/16											NANF211-35	NA211-35	
60	2 1/4	6 7/8	2 5/32	5 5/8	43/64	13/16	1 27/64	3 1/4	3.063	1.220	5/8	NANF212-36	NF212	NA212-36
		175	55	143	17	21	36	82.8	77.8	31		NANF212		NA212
	2 3/8											NANF212-38		NA212-38
	2 7/16											NANF212-39	NA212-39	

Remarks 1. In Part No. of unit and units with covers, fitting codes follow bore diameter numbers. (See Table 10.5 in P.62.)  
2. Part No. of applicable grease fittings are shown below.  
A-1/4-28UNF .....201~210  
A-R1/8.....211~212



# FYH

Variations of tolerance of distance from mounting surface to center of spherical bore ( $\Delta_{A2s}$ ) and tolerance of position of bolt hole ( $X$ )

Unit: mm

Housing No.	$\Delta_{A2s}$	$X$
NF204~NF210	$\pm 0.5$	0.7
NF211~NF212	$\pm 0.8$	1

Variations of tolerance of bolt hole diameter ( $\Delta_{N_s}$ )

Unit: mm

Housing No.	$\Delta_{N_s}$
NF204~NF212	$\pm 0.2$

	Basic Load Ratings kN		Factor	Mass
	$C_r$	$C_{0r}$	$f_0$	kg
	12.8	6.65	13.2	0.73
	14.0	7.85	13.9	0.95
	19.5	11.3	13.9	1.4
	25.7	15.4	13.9	1.8
	29.1	17.8	14.0	2.2
	34.1	21.3	14.0	2.6
	35.1	23.3	14.4	3.0
	43.4	29.4	14.4	4.1
	52.4	36.2	14.4	4.9

- 3. For the dimensions and forms of applicable bearings, see the dimensional tables of ball bearing for unit.
- 4. Housings of nodular graphite cast iron are also available.



**4-Bolt Flange Units**

**NCF**  
**Cylindrical bore**  
**(with concentric locking collar)**  
**d 20 ~ 60 mm**

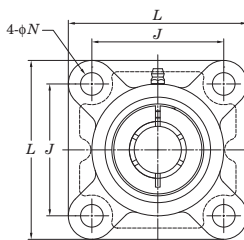
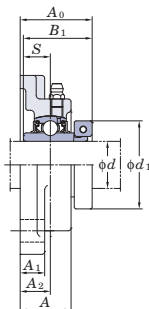

Shaft Dia.		Dimensions										Bolt Size	Unit No.	Housing No.	Bearing No.
mm	inch	inch mm										inch			
d		L	A	J	N	A <sub>1</sub>	A <sub>2</sub>	A <sub>0</sub>	B <sub>1</sub>	S	d <sub>1</sub>	inch			
20	3/4	3 3/8	1	2 33/64	15/32	7/16	19/32	1 3/8	1 9/32	0.500	1 3/4	3/8	NCF204-12	F204	NC204-12
		86	25.5	64	12	11	15	34.8	32.5	12.7	44.5	M10	NCF204		
25	7/8	3 3/4	1 1/16	2 3/4	15/32	1/2	5/8	1 1/2	1 7/16	0.563	1 15/16	3/8	NCF205-14	F205	NC205-14
	15/16												NCF205-15		
	1												NCF205		NC205
	1 1/8												NCF205-16		NC205-16
30	1 3/16	4 1/4	1 7/32	3 17/64	15/32	1/2	45/64	1 21/32	1 9/16	0.626	2 3/16	3/8	NCF206	F206	NC206
	1 1/4	108	31	83	12	13	18	41.8	39.7	15.9	55.6	M10	NCF206-19		
	1 1/4												NCF206-20		NC206-20
35	1 3/8	4 19/32	1 11/32	3 5/8	35/64	19/32	3/4	1 13/16	1 3/4	0.689	2 7/16	7/16	NCF207-20	F207	NC207-20
	1 7/16	117	34	92	14	15	19	46	44.5	17.5	61.9	M12	NCF207-22		
	1 3/8												NCF207		NC207
	1 7/16												NCF207-23		NC207-23
40	1 1/2	5 1/8	1 13/32	4 1/64	5/8	19/32	53/64	2 3/32	2	0.748	2 11/16	1/2	NCF208-24	F208	NC208-24
		130	36	102	16	15	21	52.8	50.8	19	68.3	M14	NCF208		
45	1 5/8	5 13/32	1 1/2	4 9/64	5/8	5/8	55/64	2 1/8	2	0.748	2 13/16	1/2	NCF209-26	F209	NC209-26
		137	38	105	16	16	22	53.8	50.8	19	71.4	M14			
	1 11/16												NCF209-27		NC209-27
	1 3/4												NCF209-28	F209	NC209-28
													NCF209		
50	1 15/16	5 5/8	1 9/16	4 3/8	5/8	5/8	55/64	2 7/32	2 3/32	0.748	3 3/8	1/2	NCF210-31	F210	NC210-31
	2	143	40	111	16	16	22	56.1	53.1	19	85.7	M14	NCF210		
													NCF210-32		NC210-32
55	2	6 3/8	1 11/16	5 1/8	3/4	23/32	63/64	2 11/32	2 1/4	0.874	3 1/2	5/8	NCF211-32	F211	NC211-32
		162	43	130	19	18	25	59.9	57.1	22.2	88.9	M16			
	2 3/16												NCF211		NC211
	2 1/4												NCF211-35	F211	NC211-35
60	2 1/4	6 7/8	1 7/8	5 5/8	3/4	23/32	1 9/64	2 25/32	2 5/8	1.000	4 1/16	5/8	NCF212-36	F212	NC212-36
		175	48	143	19	18	29	70.3	66.7	25.4	103.2	M16			
													NCF212		NC212
	2 7/16												NCF212-39	F212	NC212-39

Remarks 1. In Part No. of unit, fitting codes follow bore diameter codes. (See Table 10.5 in P.62.)  
2. Part No. of applicable grease fittings are shown below.  
A-1/4-28UNF ..... 204~210  
A-R1/8..... 211~212



# FYH

Variations of tolerance of distance from mounting surface to center of spherical bore ( $\Delta A_{2a}$ ) and tolerance of position of bolt hole ( $X$ )

Unit: mm

Housing No.	$\Delta A_{2a}$	$X$
F204-F210	$\pm 0.5$	0.7
F211-F212	$\pm 0.8$	1

Variations of tolerance of bolt hole diameter ( $\Delta N_s$ )

Unit: mm

Housing No.	$\Delta N_s$
F204-F212	$\pm 0.2$

	Basic Load Ratings kN		Factor	Mass
	$C_r$	$C_{0r}$	$f_0$	kg
	12.8	6.65	13.2	0.73
	14.0	7.85	13.9	1.0
	19.5	11.3	13.9	1.3
	25.7	15.4	13.9	1.8
	25.7	15.4	13.9	1.8
	29.1	17.8	14.0	2.3
	34.1	21.3	14.0	2.6
	34.1	21.3	14.0	2.6
	35.1	23.3	14.4	3.1
	43.4	29.4	14.4	3.8
	43.4	29.4	14.4	3.8
	52.4	36.2	14.4	4.9
	52.4	36.2	14.4	4.9

3. For the dimensions and forms of applicable bearings, see the dimensional tables of ball bearing for unit.  
4. Representative examples of the forms of housing are indicated.



**4-Bolt Flange Units**

**NCF-E**  
**Cylindrical bore**  
**(with concentric locking collar)**  
*d* 20 ~ 60 mm

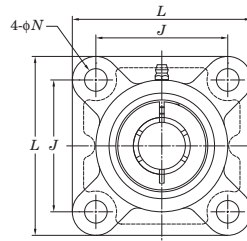
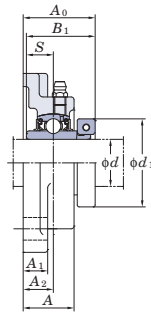

Shaft Dia.		Dimensions										Bolt Size	Unit No.	Housing No.	Bearing No.
mm	inch	inch mm													
<i>d</i>		<i>L</i>	<i>A</i>	<i>J</i>	<i>N</i>	<i>A</i> <sub>1</sub>	<i>A</i> <sub>2</sub>	<i>A</i> <sub>0</sub>	<i>B</i> <sub>1</sub>	<i>S</i>	<i>d</i> <sub>1</sub>				
20	3/4	3 3/8	1	2 33/64	7/16	7/16	19/32	1 3/8	1 9/32	0.500	1 3/4	3/8	NCF204-12E	F204E	NC204-12 NC204
		86	25.5	64	11	11	15	34.8	32.5	12.7	44.5				
25	7/8	3 3/4	1 1/16	2 3/4	15/32	1/2	5/8	1 1/2	1 7/16	0.563	1 15/16	3/8	NCF205-14E	F205E	NC205-14 NC205-15 NC205 NC205-16
	15/16														
	1	95	27	70	12	13	16	38.2	36.5	14.3	49.2		NCF205E		
30	1 1/8	4 1/4	1 7/32	3 17/64	33/64	1/2	45/64	1 21/32	1 9/16	0.626	2 3/16	7/16	NCF206-18E	F206E	NC206-18 NC206 NC206-19 NC206-20
	1 3/16														
	1 1/4	108	31	83	13	13	18	41.8	39.7	15.9	55.6		NCF206-19E		
35	1 1/4	4 19/32	1 11/32	3 5/8	33/64	19/32	3/4	1 13/16	1 3/4	0.689	2 7/16	7/16	NCF206-20E	F207E	NC206-20 NC207-20
	1 3/8														
	1 7/16	117	34	92	13	15	19	46	44.5	17.5	61.9		NCF207E		
40	1 1/2	4 19/32	1 11/32	3 5/8	33/64	19/32	3/4	1 13/16	1 3/4	0.689	2 9/16	7/16	NCF207-22E	F207E	NC207-22 NC207 NC207-23
	1 3/8														
	1 7/16	117	34	92	13	15	19	46	44.5	17.5	65.1		NCF207-23E		
45	1 1/2	5 1/8	1 13/32	4 1/64	35/64	19/32	53/64	2 3/32	2	0.748	2 11/16	1/2	NCF208-24E	F208E	NC208-24 NC208
	1 3/8														
	1 7/16	130	36	102	14	15	21	52.8	50.8	19	68.3		NCF209-26E		
50	1 5/8	5 13/32	1 1/2	4 9/64	5/8	5/8	55/64	2 1/8	2	0.748	2 13/16	1/2	NCF209-27E	F209E	NC209-27 NC209-28 NC209
	1 3/4														
	1 7/8	137	38	105	16	16	22	53.8	50.8	19	74.6		NCF209E		
55	1 15/16	5 5/8	1 9/16	4 3/8	5/8	5/8	55/64	2 7/32	2 3/32	0.748	3 3/8	1/2	NCF210-31E	F210E	NC210-31 NC210 NC210-32
	2														
	2 1/8	143	40	111	16	16	22	56.1	53.1	19	85.7		NCF210-32E		
60	2	6 3/8	1 11/16	5 1/8	43/64	23/32	63/64	2 11/32	2 1/4	0.874	3 1/2	5/8	NCF211-32E	F211E	NC211-32 NC211 NC211-35
	2 1/4														
	2 3/16	162	43	130	17	18	25	59.9	57.1	22.2	88.9		NCF211-35E		
60	2 1/4	6 7/8	1 7/8	5 5/8	43/64	23/32	1 9/64	2 25/32	2 5/8	1.000	4 1/16	5/8	NCF212-36E	F212E	NC212-36 NC212
	2 3/8														
	2 7/16	175	48	143	17	18	29	70.3	66.7	25.4	104.8		NCF212-39E		

Remarks 1. In Part No. of unit, fitting codes follow bore diameter codes. (See Table 10.5 in P.62.)  
2. Part No. of applicable grease fittings are shown below.  
A-1/4-28UNF ..... 204~208  
A-R1/8..... 211~212



# FYH

Variations of tolerance of distance from mounting surface to center of spherical bore ( $\Delta A_{2s}$ ) and tolerance of position of bolt hole ( $X$ )

Unit: mm

Housing No.	$\Delta A_{2s}$	$X$
F204E-F208E	$\pm 0.5$	0.7
F211E-F212E	$\pm 0.8$	1

Variations of tolerance of bolt hole diameter ( $\Delta N_s$ )

Unit: mm

Housing No.	$\Delta N_s$
F204E-F212E	$\pm 0.2$

	Basic Load Ratings kN		Factor	Mass
	$C_r$	$C_{0r}$	$f_0$	kg
	12.8	6.65	13.2	0.73
	14.0	7.85	13.9	1.0
	19.5	11.3	13.9	1.3
	25.7	15.4	13.9	1.8
	25.7	15.4	13.9	1.8
	29.1	17.8	14.0	2.3
	34.1	21.3	14.0	2.6
	34.1	21.3	14.0	2.6
	35.1	23.3	14.4	3.1
	43.4	29.4	14.4	3.8
	43.4	29.4	14.4	3.8
	52.4	36.2	14.4	4.9
	52.4	36.2	14.4	4.9

3. For the dimensions and forms of applicable bearings, see the dimensional tables of ball bearing for unit.  
 4. Representative examples of the forms of housing are indicated.





**4-Bolt Flange Units**

**UKF**

Tapered bore (with adapter)  
 $d_1$  20 ~ (50) mm

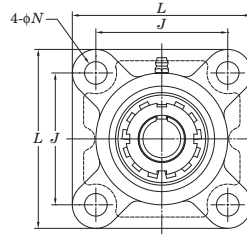
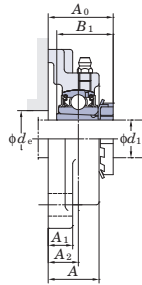

Shaft Dia. mm inch	Dimensions inch mm										Bolt Size inch mm	Standard		
	$L$	$A$	$J$	$N$	$A_1$	$A_2$	$A_0$	$B_1$	$d_e$ (min.)	Unit No.		Housing No.	Bearing No.	
20 $d_1$	$3/4$	3 3/4 95	1 1/16 27	2 3/4 70	15/32 12	1/2 13	5/8 16	1 13/32 36	1 3/8 35	1 3/16 30	3/8 M10	UKF205	F205	UK205
	$3/4$	4 1/4 108	1 3/16 83	3 17/64 83	15/32 12	1/2 13	45/64 18	1 9/16 39.5	1 3/8 35	1 3/16 30	3/8 M10	UKFX05	FX05	UKX05
	$3/4$	4 11/32 110	1 5/32 29	3 5/32 80	5/8 16	1/2 13	5/8 16	1 15/32 37.5	1 3/8 35	—	1/2 M14	UKF305	F305	UK305
25 $d_1$	1	4 1/4 108	1 7/32 31	3 17/64 83	15/32 12	1/2 13	45/64 18	1 9/16 39.5	1 1/2 38	1 13/32 36	3/8 M10	UKF206	F206	UK206
	1	4 19/32 117	1 11/32 34	3 5/8 92	5/8 16	9/16 14	3/4 19	1 21/32 42	1 1/2 38	1 13/32 36	1/2 M14	UKFX06	FX06	UKX06
	1	4 29/32 125	1 1/4 32	3 47/64 95	5/8 16	19/32 15	45/64 18	1 5/8 41	1 1/2 38	—	1/2 M14	UKF306	F306	UK306
30 $d_1$	1 1/8	4 19/32 117	1 11/32 34	3 5/8 92	35/64 14	19/32 15	3/4 19	1 11/16 43	1 11/16 43	1 5/8 41	7/16 M12	UKF207	F207	UK207
	1 1/8	5 1/8 130	1 1/2 38	4 1/64 102	5/8 16	9/16 14	53/64 21	1 27/32 47	1 11/16 43	1 5/8 41	1/2 M14	UKFX07	FX07	UKX07
	1 1/8	5 5/16 135	1 13/32 36	3 15/16 100	3/4 19	5/8 16	25/32 20	1 25/32 45.5	1 11/16 43	—	5/8 M16	UKF307	F307	UK307
35 $d_1$	1 1/4 1 3/8	5 1/8 130	1 13/32 36	4 1/64 102	5/8 16	19/32 15	53/64 21	1 7/8 48	1 13/16 46	1 13/16 46	1/2 M14	UKF208	F208	UK208
	1 1/4 1 3/8	5 13/32 137	1 9/16 40	4 9/64 105	3/4 19	9/16 14	55/64 22	1 31/32 50	1 13/16 46	1 13/16 46	5/8 M16	UKFX08	FX08	UKX08
	1 1/4 1 3/8	5 29/32 150	1 9/16 40	4 13/32 112	3/4 19	21/32 17	29/32 23	2 50.5	1 13/16 46	—	5/8 M16	UKF308	F308	UK308
40 $d_1$	1 1/2	5 13/32 137	1 1/2 38	4 9/64 105	5/8 16	5/8 16	55/64 22	2 51	1 31/32 50	2 1/16 52	1/2 M14	UKF209	F209	UK209
	1 1/2	5 5/8 143	1 9/16 40	4 3/8 111	3/4 19	9/16 14	29/32 23	2 1/16 52	1 31/32 50	2 1/16 52	5/8 M16	UKFX09	FX09	UKX09
	1 1/2	6 5/16 160	1 23/32 44	4 59/64 125	3/4 19	23/32 18	63/64 25	2 5/32 55	1 31/32 50	—	5/8 M16	UKF309	F309	UK309
45 $d_1$	1 3/4	5 5/8 143	1 9/16 40	4 3/8 111	5/8 16	5/8 16	55/64 22	2 1/16 52	2 5/32 55	2 9/32 58	1/2 M14	UKF210	F210	UK210
	1 3/4	6 3/8 162	1 23/32 44	5 1/8 130	3/4 19	25/32 20	1 1/32 26	2 9/32 58	2 5/32 55	2 9/32 58	5/8 M16	UKFX10	FX10	UKX10
	1 3/4	6 7/8 175	1 7/8 48	5 13/64 132	29/32 23	3/4 19	1 7/64 28	2 3/8 60	2 5/32 55	—	3/4 M20	UKF310	F310	UK310
50 $d_1$	1 7/8	6 3/8 162	1 11/16 43	5 1/8 130	3/4 19	23/32 18	63/64 25	2 1/4 57.5	2 5/16 59	2 17/32 64	5/8 M16	UKF211	F211	UK211
	2	6 7/8 175	1 15/16 49	5 5/8 143	3/4 19	25/32 20	1 9/64 29	2 17/32 64.5	2 5/16 59	2 17/32 64	5/8 M16	UKFX11	FX11	UKX11

Remarks  
 1. In Part No. of unit and units with covers, fitting codes follow bore diameter numbers. (See Table 10.5 in P.62.)  
 2. Part No. of applicable grease fittings are shown below.  
 A-1/4-28UNF ..... 205~210, X05~X09, 305~308  
 A-R1/8 ..... 211~218, X10~X20, 309~328

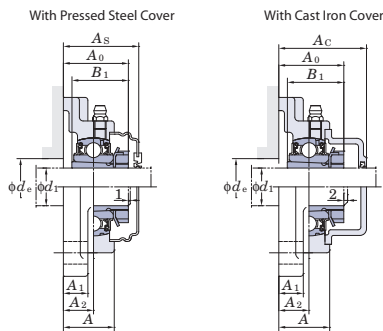

Variations of tolerance of distance from mounting surface to center of spherical bore ( $\Delta_{A2s}$ ) and tolerance of position of bolt hole (X)

Housing No.			$\Delta_{A2s}$	X
F205-F210	FX05-FX10	F305-F310	$\pm 0.5$	0.7
F211-F218	FX11-FX20	F311-F328	$\pm 0.8$	1

Variations of tolerance of bolt hole diameter ( $\Delta_{Ns}$ )

Housing No.			$\Delta_{Ns}$
F205-F218	FX05-FX18	F305-F315	$\pm 0.2$
	FX20	F316-F328	$\pm 0.3$

Adapter No.	Mass kg	Basic Load Ratings kN		Factor $f_0$	With Pressed Steel Cover				With Cast Iron Cover					
		$C_r$	$C_{Or}$		Unit No.		Dimension		Mass kg	Unit No.		Dimension		Mass kg
					Open Type	Closed Type	mm	inch		Open Type	Closed Type	mm	inch	
HE2305X	0.87	14.0	7.85	13.9	-	-	-	-	-	-	-	-	-	-
H2305X	0.87				UKF205C	UKF205D	40.5	1 19/32	0.87	UKF205FC	UKF205FD	49	1 15/16	1.1
HE2305X	1.2	19.5	11.3	13.9	-	-	-	-	-	-	-	-	-	-
H2305X	1.2				UKFX05C	UKFX05D	44.5	1 3/4	1.2	-	-	-	-	-
HE2305X	1.4	21.2	10.9	12.6	-	-	-	-	-	-	-	-	-	-
H2305X	1.4				-	-	-	-	-	UKF305C	UKF305D	54	2 1/8	1.7
H2306X	1.3	19.5	11.3	13.9	-	-	-	-	-	-	-	-	-	-
HE2306X	1.3				UKF206C	UKF206D	44.5	1 3/4	1.3	UKF206FC	UKF206FD	53	2 3/32	1.6
H2306X	1.6	25.7	15.4	13.9	-	-	-	-	-	-	-	-	-	-
HE2306X	1.6				UKFX06C	UKFX06D	49	1 15/16	1.6	-	-	-	-	-
H2306X	1.9	26.7	15.0	13.3	-	-	-	-	-	-	-	-	-	-
HE2306X	1.9				-	-	-	-	-	UKF306C	UKF306D	59	2 5/16	2.2
HS2307X	1.6	25.7	15.4	13.9	-	-	-	-	-	-	-	-	-	-
H2307X	1.6				UKF207C	UKF207D	49	1 15/16	1.6	UKF207FC	UKF207FD	58	2 9/32	2.0
HS2307X	2.0	29.1	17.8	14.0	-	-	-	-	-	-	-	-	-	-
H2307X	2.0				UKFX07C	UKFX07D	55.5	2 3/16	2.0	-	-	-	-	-
HS2307X	2.3	33.4	19.3	13.2	-	-	-	-	-	-	-	-	-	-
H2307X	2.3				-	-	-	-	-	UKF307C	UKF307D	64	2 17/32	2.8
HE2308X	1.9	29.1	17.8	14.0	-	-	-	-	-	-	-	-	-	-
HS2308X	1.9				-	-	-	-	-	-	-	-	-	-
H2308X	1.9	34.1	21.3	14.0	-	-	-	-	-	-	-	-	-	-
HE2308X	1.9				UKF208C	UKF208D	55.5	2 3/16	1.9	UKF208FC	UKF208FD	64	2 17/32	2.3
HE2308X	2.3	34.1	21.3	14.0	-	-	-	-	-	-	-	-	-	-
HS2308X	2.3				-	-	-	-	-	-	-	-	-	-
H2308X	2.3	40.7	24.0	13.2	-	-	-	-	-	-	-	-	-	-
HE2308X	2.3				UKFX08C	UKFX08D	56.5	2 7/32	2.3	-	-	-	-	-
HE2308X	3.1	34.1	21.3	14.0	-	-	-	-	-	-	-	-	-	-
HS2308X	3.1				-	-	-	-	-	-	-	-	-	-
H2308X	3.1	35.1	23.3	14.4	-	-	-	-	-	-	-	-	-	-
HE2308X	3.1				UKF308C	UKF308D	71	2 25/32	3.6	-	-	-	-	-
HE2309X	2.3	34.1	21.3	14.0	-	-	-	-	-	-	-	-	-	-
H2309X	2.3				UKF209C	UKF209D	56.5	2 7/32	2.3	UKF209FC	UKF209FD	66	2 19/32	2.8
HE2309X	2.7	35.1	23.3	14.4	-	-	-	-	-	-	-	-	-	-
H2309X	2.7				UKFX09C	UKFX09D	60	2 3/8	2.7	-	-	-	-	-
HE2309X	4.1	48.9	29.5	13.3	-	-	-	-	-	-	-	-	-	-
H2309X	4.1				-	-	-	-	-	UKF309C	UKF309D	76	3	4.7
HE2310X	2.6	35.1	23.3	14.4	-	-	-	-	-	-	-	-	-	-
H2310X	2.6				UKF210C	UKF210D	59	2 9/16	2.6	UKF210FC	UKF210FD	70.5	2 25/32	3.1
HE2310X	3.6	43.4	29.4	14.4	-	-	-	-	-	-	-	-	-	-
H2310X	3.6				UKFX10C	UKFX10D	64	2 17/32	3.6	-	-	-	-	-
HE2310X	5.1	62.0	38.3	13.2	-	-	-	-	-	-	-	-	-	-
H2310X	5.1				-	-	-	-	-	UKF310C	UKF310D	83	3 9/32	5.9
HS2311X	3.5	43.4	29.4	14.4	-	-	-	-	-	-	-	-	-	-
H2311X	3.5				UKF211C	UKF211D	63	2 15/32	3.5	UKF211FC	UKF211FD	74.5	2 15/16	4.1
HE2311X	3.5	52.4	36.2	14.4	-	-	-	-	-	-	-	-	-	-
HS2311X	3.5				-	-	-	-	-	-	-	-	-	-
H2311X	4.6	52.4	36.2	14.4	-	-	-	-	-	-	-	-	-	-
HE2311X	4.6				UKFX11C	UKFX11D	73.5	2 29/32	4.6	-	-	-	-	-

- In Part No. of unit with adapters and bearing with adapters, Part No. of applicable adapter follow the Part No. shown in the dimensional tables. (Example of Part No. : UKF206J + H2306X, UK206 + H2306X)
- As for the triple seal type product (205 is the double seal type product), suffix code L3 (L2) follows the Part No. of unit or bearing. (Example of Part No. : UKF206JL3 + H2306X, UK206L3 + H2306X)
- For the dimensions and forms of applicable bearings and adapters, see the dimensional tables of ball bearing for unit and adapter.
- Housings of nodular graphite cast iron are also available.



**4-Bolt Flange Units**

**UKF**

**Tapered bore (with adapter)**  
 $d_1$  (50) ~ (90) mm

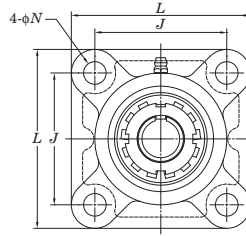
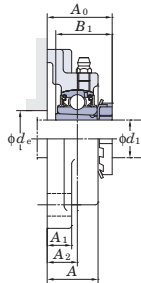

Shaft Dia. mm	inch	Dimensions									Bolt Size inch mm	Standard		
		$L$	$A$	$J$	$N$	$A_1$	$A_2$	$A_0$	$B_1$	$d_e$ (min.)		Unit No.	Housing No.	Bearing No.
50	1 7/8	7 9/32	2 1/16	5 33/64	29/32	25/32	1 3/16	2 17/32	2 5/16	—	3/4	UKF311	F311	UK311
	2	185	52	140	23	20	30	64	59	—	M20			
55	2 1/8	6 7/8	1 7/8	5 5/8	3/4	23/32	1 9/64	2 19/32	2 7/16	2 23/32	5/8	UKF212	F212	UK212
	2 1/8	7 3/8	2 5/16	5 55/64	3/4	13/16	1 11/32	2 9/16	2 7/16	2 23/32	5/8			
	2 1/8	187	59	149	19	21	34	65	62	69	M16	UKFX12	FX12	UKX12
	2 1/8	7 11/16	2 7/32	5 29/32	29/32	7/8	1 19/64	2 3/4	2 7/16	—	3/4			
60	2 3/8	195	56	150	23	22	33	69.5	62	—	M20	UKF312	F312	UK312
	2 1/4	7 3/8	1 31/32	5 55/64	3/4	7/8	1 3/16	2 21/32	2 9/16	2 29/32	5/8			
	2 3/8	187	50	149	19	22	30	67.5	65	74	M16	UKF213	F213	UK213
	2 1/4	7 3/8	2 5/16	5 55/64	3/4	13/16	1 11/32	2 11/16	2 9/16	2 29/32	5/8			
	2 3/8	187	59	149	19	21	34	68	65	74	M16	UKFX13	FX13	UKX13
	2 1/4	8 3/16	2 9/32	6 17/32	29/32	7/8	1 19/64	2 13/16	2 9/16	—	3/4			
2 3/8	208	58	166	23	22	33	71.5	65	—	M20	UKF313	F313	UK313	
65	2 1/2	7 7/8	2 7/32	6 17/64	3/4	7/8	1 11/32	2 15/16	2 7/8	3 11/32				5/8
	2 1/2	200	56	159	19	22	34	74.5	73	85	M16	UKF215	F215	UK215
	2 1/2	7 3/4	2 11/16	5 63/64	29/32	15/16	1 9/16	3	2 7/8	3 11/32	3/4			
	2 1/2	197	68	152	23	24	40	76	73	85	M20	UKFX15	FX15	UKX15
70	2 3/4	9 9/32	2 19/32	7 1/4	63/64	31/32	1 17/32	3 7/32	2 7/8	—	7/8			
	2 3/4	236	66	184	25	25	39	81.5	73	—	M22	UKF315	F315	UK315
	2 3/4	8 3/16	2 9/32	6 1/2	29/32	7/8	1 11/32	3 3/32	3 1/16	3 17/32	3/4			
70	2 3/4	208	58	165	23	22	34	78.5	78	90	M20	UKF216	F216	UK216
	2 3/4	214	70	171	23	24	40	79	78	90	M20			
	2 3/4	9 27/32	2 11/16	7 23/32	1 7/32	1 1/16	1 1/2	3 1/4	3 1/16	—	1			
75	2 3/4	250	68	196	31	27	38	82.5	78	—	M27	UKF316	F316	UK316
	3	8 21/32	2 15/32	6 57/64	29/32	15/16	1 13/32	3 1/4	3 7/32	3 25/32	3/4			
	3	220	63	175	23	24	36	82.5	82	96	M20	UKF217	F217	UK217
	3	8 7/16	2 3/4	6 47/64	29/32	15/16	1 9/16	3 7/32	3 7/32	3 25/32	3/4			
80	3	214	70	171	23	24	40	82	82	96	M20	UKFX17	FX17	UKX17
	3	10 1/4	2 29/32	8 1/32	1 7/32	1 1/16	1 47/64	3 5/8	3 7/32	—	1			
	—	260	74	204	31	27	44	92	82	—	M27	UKF317	F317	UK317
	—	9 1/4	2 11/16	7 23/64	29/32	31/32	1 9/16	3 17/32	3 3/8	4 1/32	3/4			
80	—	235	68	187	23	25	40	89.5	86	102	M20	UKF218	F218	UK218
	—	8 7/16	3	6 47/64	29/32	15/16	1 49/64	3 15/32	3 3/8	4 1/32	3/4			
	—	214	76	171	23	24	45	88	86	102	M20	UKFX18	FX18	UKX18
—	11 1/32	3	8 1/2	1 3/8	1 3/16	1 47/64	3 5/8	3 3/8	—	1 1/8				
85	3 1/4	280	76	216	35	30	44	92	86	—	M30	UKF318	F318	UK318
	3 1/4	11 13/32	3 11/16	8 31/32	1 3/8	1 3/16	2 21/64	4 3/8	3 17/32	—	1 1/8			
90	3 1/2	290	94	228	35	30	59	111	90	—	M30	UKF319	F319	UK319
	3 1/2	10 9/16	3 13/16	8 5/16	1 7/32	1 3/32	2 21/64	4 3/16	3 13/16	4 13/32	1			
		268	97	211	31	28	59	106	97	112	M27	UKFX20	FX20	UKX20

Remarks 1. In Part No. of unit and units with covers, fitting codes follow bore diameter numbers. (See Table 10.5 in P62.)  
2. Part No. of applicable grease fittings are shown below.  
A-1/4-28UNF ..... 205~210, X05~X09, 305~308  
A-R1/8..... 211~218, X10~X20, 309~328

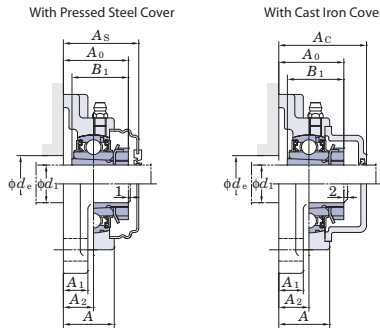

Variations of tolerance of distance from mounting surface to center of spherical bore ( $\Delta A_{2s}$ ) and tolerance of position of bolt hole (X)

Housing No.			$\Delta A_{2s}$	X
F205-F210	FX05-FX10	F305-F310	$\pm 0.5$	0.7
F211-F218	FX11-FX20	F311-F328	$\pm 0.8$	1

Variations of tolerance of bolt hole diameter ( $\Delta d_h$ )

Housing No.			$\Delta d_h$
F205-F218	FX05-FX18	F305-F315	$\pm 0.2$
	FX20	F316-F328	$\pm 0.3$

Adapter No.	Mass kg	Basic Load Ratings kN		Factor $f_0$	With Pressed Steel Cover				With Cast Iron Cover					
		$C_r$	$C_{Or}$		Unit No.		Dimension mm inch		Mass kg	Unit No.		Dimension mm inch		Mass kg
					Open Type	Closed Type	$A_s$			Open Type	Closed Type	$A_c$		
HS2311X	5.9				-	-	-	-	-	-	-	-	-	-
H2311X	5.9	71.6	45.0	13.2	-	-	-	-	UKF311C	UKF311D	87	3 7/16	6.8	
HE2311X	5.9				-	-	-	-	-	-	-	-	-	-
HS2312X	4.1				-	-	-	-	-	-	-	-	-	-
H2312X	4.1	52.4	36.2	14.4	UKF212C	UKF212D	73.5	2 29/32	4.1	UKF212FC	UKF212FD	86	3 3/8	4.9
HS2312X	5.5				-	-	-	-	-	-	-	-	-	-
H2312X	5.5	57.2	40.1	14.4	UKFX12C	UKFX12D	78.5	3 3/32	5.5	-	-	-	-	-
HS2312X	6.8				-	-	-	-	-	-	-	-	-	-
H2312X	6.8	81.9	52.2	13.2	-	-	-	-	UKF312C	UKF312D	95	3 3/4	8.0	
HE2313X	5.1				-	-	-	-	-	-	-	-	-	-
H2313X	5.1	57.2	40.1	14.4	UKF213C	UKF213D	74.5	2 15/16	5.1	UKF213FC	UKF213FD	87	3 7/16	6.0
HS2313X	5.1				-	-	-	-	-	-	-	-	-	-
HE2313X	6.0				-	-	-	-	-	-	-	-	-	-
H2313X	6.0	62.2	44.1	14.5	UKFX13C	UKFX13D	83.5	3 9/32	6.0	-	-	-	-	-
HS2313X	6.0				-	-	-	-	-	-	-	-	-	-
HE2313X	7.9				-	-	-	-	-	-	-	-	-	-
H2313X	7.9	92.7	59.9	13.2	-	-	-	-	UKF313C	UKF313D	94	3 11/16	9.0	
HS2313X	7.9				-	-	-	-	-	-	-	-	-	-
HE2315X	6.5				-	-	-	-	-	-	-	-	-	-
H2315X	6.5	67.4	48.3	14.5	UKF215C	UKF215D	83.5	3 9/32	6.5	UKF215FC	UKF215FD	96	3 25/32	7.5
HE2315X	8.1				-	-	-	-	-	-	-	-	-	-
H2315X	8.1	72.7	53.0	14.6	UKFX15C	UKFX15D	94.5	3 23/32	8.1	-	-	-	-	-
HE2315X	11.7				-	-	-	-	-	-	-	-	-	-
H2315X	11.7	113	77.2	13.2	-	-	-	-	UKF315C	UKF315D	106	4 3/16	13.1	
HE2316X	7.6				-	-	-	-	-	-	-	-	-	-
H2316X	7.6	72.7	53.0	14.6	UKF216C	UKF216D	88.5	3 15/32	7.6	UKF216FC	UKF216FD	103	4 1/16	8.9
HE2316X	9.5				-	-	-	-	-	-	-	-	-	-
H2316X	9.5	84.0	61.9	14.5	UKFX16C	UKFX16D	96.5	3 25/32	9.5	-	-	-	-	-
HE2316X	12.9				-	-	-	-	-	-	-	-	-	-
H2316X	12.9	123	86.7	13.3	-	-	-	-	UKF316C	UKF316D	107	4 7/32	14.5	
H2317X	9.0				UKF217C	UKF217D	92.5	3 21/32	9.0	UKF217FC	UKF217FD	107	4 7/32	10.4
HE2317X	9.0	84.0	61.9	14.5	-	-	-	-	-	-	-	-	-	-
H2317X	10.4				UKFX17C	UKFX17D	101.5	4	10.4	-	-	-	-	-
HE2317X	10.4	96.1	71.5	14.5	-	-	-	-	-	-	-	-	-	-
H2317X	15.2				-	-	-	-	UKF317C	UKF317D	117	4 19/32	17.0	
HE2317X	15.2	133	96.8	13.3	-	-	-	-	-	-	-	-	-	-
H2318X	11.4	96.1	71.5	14.5	UKF218C	UKF218D	101.5	4	11.4	UKF218FC	UKF218FD	116	4 9/16	13.0
H2318X	11.4	109	81.9	14.4	-	-	-	-	UKFX18C	UKFX18D	124	4 7/8	13.3	
H2318X	19.0	143	107	13.3	-	-	-	-	UKF318C	UKF318D	119	4 11/16	21.1	
HE2319X	21.9				-	-	-	-	-	-	-	-	-	-
H2319X	21.9	153	119	13.3	-	-	-	-	UKF319C	UKF319D	140	5 1/2	24.3	
HE2320X	18.4				-	-	-	-	-	-	-	-	-	-
H2320X	18.4	133	105	14.4	-	-	-	-	UKFX20C	UKFX20D	152	5 31/32	20.9	

- In Part No. of unit with adapters and bearing with adapters, Part No. of applicable adapter follow the Part No. shown in the dimensional tables. (Example of Part No. : UKF206J + H2306X, UK206 + H2306X)
- As for the triple seal type product (205 is the double seal type product), suffix code L3 (L2) follows the Part No. of unit or bearing. (Example of Part No. : UKF206JL3 + H2306X, UK206L3 + H2306X)
- For the dimensions and forms of applicable bearings and adapters, see the dimensional tables of ball bearing for unit and adapter.
- Housings of nodular graphite cast iron are also available.



**4-Bolt Flange Units**

**UKF**

**Tapered bore (with adapter)**  
 $d_1$  (90) ~ 125 mm

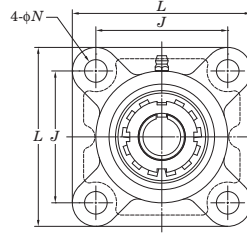
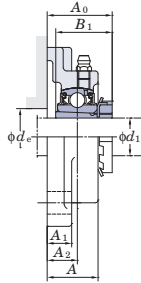

Shaft Dia. mm inch		Dimensions									Bolt Size inch mm	Standard		
		$L$	$A$	$J$	$N$	$A_1$	$A_2$	$A_0$	$B_1$	$d_e$ (min.)		Unit No.	Housing No.	Bearing No.
<b>90</b>	3 1/2	12 7/32	3 11/16	9 17/32	1 1/2	1 1/4	2 21/64	4 7/16	3 13/16	—	1 1/4	<b>UKF320</b>	F320	UK320
		310	94	242	38	32	59	113	97	—	M33			
<b>100</b>	4	13 3/8	3 25/32	10 15/32	1 39/64	1 3/8	2 23/64	4 23/32	4 1/8	—	1 3/8	<b>UKF322</b>	F322	UK322
		340	96	266	41	35	60	120	105	—	M36			
<b>110</b>	—	14 9/16	4 11/32	11 27/64	1 39/64	1 9/16	2 9/16	5 1/8	4 13/32	—	1 3/8	<b>UKF324</b>	F324	UK324
		370	110	290	41	40	65	130.5	112	—	M36			
<b>115</b>	4 1/2	16 5/32	4 17/32	12 19/32	1 39/64	1 25/32	2 9/16	5 3/16	4 3/4	—	1 3/8	<b>UKF326</b>	F326	UK326
		410	115	320	41	45	65	131.5	121	—	M36			
<b>125</b>	—	17 23/32	4 29/32	13 25/32	1 39/64	2 5/32	2 61/64	5 13/16	5 5/32	—	1 3/8	<b>UKF328</b>	F328	UK328
		450	125	350	41	55	75	147.5	131	—	M36			

Remarks 1. In Part No. of unit and units with covers, fitting codes follow bore diameter numbers. (See Table 10.5 in P.62.)  
2. Part No. of applicable grease fittings are shown below.  
A-1/4-28UNF ..... 205~210, X05~X09, 305~308  
A-R1/8..... 211~218, X10~X20, 309~328

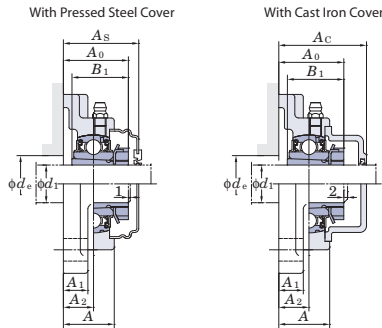

Variations of tolerance of distance from mounting surface to center of spherical bore ( $\Delta A_{2s}$ ) and tolerance of position of bolt hole (X)

Housing No.			$\Delta A_{2s}$	X
F205-F210	FX05-FX10	F305-F310	$\pm 0.5$	0.7
F211-F218	FX11-FX20	F311-F328	$\pm 0.8$	1

Variations of tolerance of bolt hole diameter ( $\Delta N_b$ )

Housing No.			$\Delta N_b$
F205-F218	FX05-FX18	F305-F315	$\pm 0.2$
	FX20	F316-F328	$\pm 0.3$

Adapter No.	Mass kg	Basic Load Ratings kN		Factor $f_0$	With Pressed Steel Cover				With Cast Iron Cover					
		$C_r$	$C_{Or}$		Unit No.		Dimension		Mass kg	Unit No.		Dimension		Mass kg
					Open Type	Closed Type	mm	inch		Open Type	Closed Type	mm	inch	
HE2320X	25.4	173	141	13.2	-	-	-	-	-	-	-	-	-	-
H2320X	25.4				-	-	-	-	UKF320C	UKF320D	146	5 3/4	28.5	
H2322X	35.2	205	180	13.2	-	-	-	-	UKF322C	UKF322D	154	6 1/16	38.7	
HE2322X	35.2				-	-	-	-	-	-	-	-	-	
H2324	47.6	207	185	13.5	-	-	-	-	UKF324C	UKF324D	163	6 13/32	52.7	
HE2326	65.3	229	214	13.6	-	-	-	-	-	-	-	-	-	
H2326	65.3				-	-	-	-	UKF326C	UKF326D	172	6 25/32	71.9	
H2328	74.9	253	246	13.6	-	-	-	-	UKF328C	UKF328D	186	7 5/16	83.5	

- In Part No. of unit with adapters and bearing with adapters, Part No. of applicable adapter follow the Part No. shown in the dimensional tables. (Example of Part No. : UKF206J + H2306X, UK206 + H2306X)
- As for the triple seal type product (205 is the double seal type product), suffix code L3 (L2) follows the Part No. of unit or bearing. (Example of Part No. : UKF206JL3 + H2306X, UK206L3 + H2306X)
- For the dimensions and forms of applicable bearings and adapters, see the dimensional tables of ball bearing for unit and adapter.
- Housings of nodular graphite cast iron are also available.



**Square Piloted 4-Bolt Flange Units**

**UCFS**  
**Cylindrical bore (with set screws)**  
**d 25 ~ 140 mm**

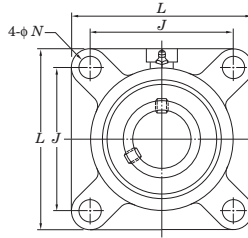
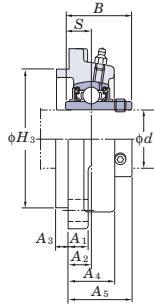

Shaft Dia.		Dimensions											Bolt Size	Standard			
mm	inch	inch mm												inch mm	Unit No.	Housing No.	Bearing No.
d		L	H <sub>3</sub>	J	N	A <sub>1</sub>	A <sub>2</sub>	A <sub>3</sub>	A <sub>4</sub>	A <sub>5</sub>	B	S					
25	1	4 11/32	3.1496	3 5/32	5/8	1/2	23/64	9/32	7/8	1 1/4	1.496	0.591	1/2	UCFS305 UCFS305-16	FS305	UC305 UC305-16	
		110	80	80	16	13	9	7	22	32	38	15	M14				
30	-	4 29/32	3.5433	3 47/64	5/8	19/32	25/64	5/16	15/16	1 13/32	1.693	0.669	1/2	UCFS306	FS306	UC306	
		125	90	95	16	15	10	8	24	36	43	17	M14				
35	-	5 5/16	3.9370	3 15/16	3/4	5/8	7/16	23/64	1 1/16	1 9/16	1.890	0.748	5/8	UCFS307	FS307	UC307	
		135	100	100	19	16	11	9	27	40	48	19	M16				
40	1 1/2	5 29/32	4.5276	4 13/32	3/4	21/32	33/64	25/64	1 3/16	1 13/16	2.047	0.748	5/8	UCFS308-24 UCFS308	FS308	UC308-24 UC308	
		150	115	112	19	17	13	10	30	46	52	19	M16				
45	1 3/4	6 5/16	4.9213	4 59/64	3/4	23/32	35/64	7/16	1 5/16	1 15/16	2.244	0.866	5/8	UCFS309-28 UCFS309	FS309	UC309-28 UC309	
		160	125	125	19	18	14	11	33	49	57	22	M16				
50	-	6 7/8	5.5118	5 13/64	29/32	3/4	5/8	15/32	1 13/32	2 5/32	2.402	0.866	3/4	UCFS310	FS310	UC310	
		175	140	132	23	19	16	12	36	55	61	22	M20				
55	2 2 3/16	7 9/32	5.9055	5 33/64	29/32	25/32	43/64	33/64	1 17/32	2 9/32	2.598	0.984	3/4	UCFS311-32 UCFS311 UCFS311-35	FS311	UC311-32 UC311 UC311-35	
		185	150	140	23	20	17	13	39	58	66	25	M20				
60	2 7/16	7 11/16	6.2992	5 29/32	29/32	7/8	3/4	35/64	1 21/32	2 17/32	2.795	1.024	3/4	UCFS312 UCFS312-39	FS312	UC312 UC312-39	
		195	160	150	23	22	19	14	42	64	71	26	M20				
65	2 1/2	8 3/16	6.8898	6 17/32	29/32	7/8	19/32	45/64	1 9/16	2 3/8	2.953	1.181	3/4	UCFS313-40 UCFS313	FS313	UC313-40 UC313	
		208	175	166	23	22	15	18	40	60	75	30	M20				
70	2 3/4	8 29/32	7.2835	7 1/64	63/64	31/32	45/64	45/64	1 11/16	2 15/32	3.071	1.299	7/8	UCFS314-44 UCFS314	FS314	UC314-44 UC314	
		226	185	178	25	25	18	18	43	63	78	33	M22				
75	2 15/16 3	9 9/32	7.8740	7 1/4	63/64	31/32	53/64	45/64	1 7/8	2 25/32	3.228	1.260	7/8	UCFS315-47 UCFS315 UCFS315-48	FS315	UC315-47 UC315 UC315-48	
		236	200	184	25	25	21	18	48	71	82	32	M22				
80	-	9 27/32	8.2677	7 23/32	1 7/32	1 1/16	45/64	25/32	1 7/8	2 3/4	3.386	1.339	1	UCFS316	FS316	UC316	
		250	210	196	31	27	18	20	48	70	86	34	M27				
85	-	10 1/4	8.6614	8 1/32	1 7/32	1 1/16	15/16	25/32	2 1/8	3 5/32	3.780	1.575	1	UCFS317	FS317	UC317	
		260	220	204	31	27	24	20	54	80	96	40	M27				
90	3 1/2	11 1/32	9.4488	8 1/2	1 3/8	1 3/16	15/16	25/32	2 7/32	3 5/32	3.780	1.575	1 1/8	UCFS318-56 UCFS318	FS318	UC318-56 UC318	
		280	240	216	35	30	24	20	56	80	96	40	M30				
95	-	11 13/32	9.8425	8 31/32	1 3/8	1 3/16	1 17/32	25/32	2 29/32	3 31/32	4.055	1.614	1 1/8	UCFS319	FS319	UC319	
		290	250	228	35	30	39	20	74	101	103	41	M30				
100	3 15/16 4	12 7/32	10.2362	9 17/32	1 1/2	1 1/4	1 17/32	25/32	2 29/32	4 1/8	4.252	1.654	1 1/4	UCFS320 UCFS320-63 UCFS320-64	FS320	UC320 UC320-63 UC320-64	
		310	260	242	38	32	39	20	74	105	108	42	M33				
105	-	12 7/32	10.2362	9 17/32	1 1/2	1 1/4	1 17/32	25/32	2 29/32	4 7/32	4.409	1.732	1 1/4	UCFS321	FS321	UC321	
		310	260	242	38	32	39	20	74	107	112	44	M33				
110	-	13 3/8	11.8110	10 15/32	1 39/64	1 3/8	1 3/8	63/64	2 25/32	4 3/16	4.606	1.811	1 3/8	UCFS322	FS322	UC322	
		340	300	266	41	35	35	25	71	106	117	46	M36				
120	-	14 9/16	12.9921	11 27/64	1 39/64	1 9/16	1 3/8	1 3/16	3 5/32	4 11/32	4.961	2.008	1 3/8	UCFS324	FS324	UC324	
		370	330	290	41	40	35	30	80	110	126	51	M36				
130	-	16 5/32	14.1732	12 19/32	1 39/64	1 25/32	1 3/8	1 3/16	3 11/32	4 9/16	5.315	2.126	1 3/8	UCFS326	FS326	UC326	
		410	360	320	41	45	35	30	85	116	135	54	M36				
140	-	17 23/32	15.7480	13 25/32	1 39/64	2 5/32	1 49/64	1 3/16	3 3/4	5 5/32	5.709	2.323	1 3/8	UCFS328	FS328	UC328	
		450	400	350	41	55	45	30	95	131	145	59	M36				

Remarks 1. In Part No. of unit and units with covers, fitting codes follow bore diameter numbers. (See Table 10.5 in P62.)  
2. Part No. of applicable grease fittings are shown below.  
A-1/4-28UNF ..... 305~308  
A-R1/8 ..... 309~328

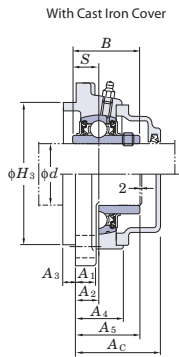

Variations of tolerance of spigot joint outside diameter ( $\Delta H_{35s}$ ), variations of tolerance of distance from mounting surface to center of spherical bore ( $\Delta A_{2s}$ ), tolerance of position of bolt hole (X), and tolerance of circumferential runout of spigot joint (Y)

Housing No.	$\Delta H_{35s}$	$\Delta A_{2s}$	Unit: mm	
			X	Y
FS305	0 -0.046	±0.5	0.7	0.2
FS306~FS308	0 -0.054			
FS309~FS310	0 -0.063			
FS311~FS313	0 -0.072	±0.8	1	0.3
FS314~FS319	0 -0.081			~FS318
FS320~FS322	0 -0.089			FS319~
FS324~FS328	0 -0.089			0.4

Variations of tolerance of bolt hole diameter ( $\Delta h_{5s}$ )

Housing No.	Unit: mm
FS305~315	±0.2
FS316~328	±0.3

Mass	Basic Load Ratings		Factor	With Cast Iron Cover		Dimension	Mass
	kN			Unit No.			
	$C_r$	$C_{0r}$		Open Type	Closed Type		
kg			$f_0$			mm inch	kg
						$A_c$	
1.4 1.4	21.2	10.9	12.6	UCFS305C	UCFS305D	47 1 27/32	1.7
1.9	26.7	15.0	13.3	UCFS306C	UCFS306D	51 2	2.2
2.3	33.4	19.3	13.2	UCFS307C	UCFS307D	55 2 5/32	2.7
3.4 3.4	40.7	24.0	13.2	UCFS308C	UCFS308D	61 2 13/32	3.9
4.4 4.4	48.9	29.5	13.3	UCFS309C	UCFS309D	65 2 9/16	5.0
5.3	62.0	38.3	13.2	UCFS310C	UCFS310D	71 2 25/32	6.1
6.1 6.1 6.1	71.6	45.0	13.2	UCFS311C	UCFS311D	74 2 29/32	7.0
7.4 7.4	81.9	52.2	13.2	UCFS312C	UCFS312D	81 3 3/16	8.6
8.8 8.8	92.7	59.9	13.2	UCFS313C	UCFS313D	76 3	9.9
11.2 11.2	104	68.2	13.2	UCFS314C	UCFS314D	80 3 5/32	12.3
13.7 13.7	113	77.2	13.2	UCFS315C	UCFS315D	88 3 15/32	15.0
15.1	123	86.7	13.3	UCFS316C	UCFS316D	87 3 7/16	16.5
17.3 21.3 21.3	133	96.8	13.3	UCFS317C	UCFS317D	97 3 13/16	18.9
21.3 21.3	143	107	13.3	UCFS318C	UCFS318D	99 3 29/32	23.2
24.5	153	119	13.3	UCFS319C	UCFS319D	120 4 23/32	26.7
29.5 29.5 29.5	173	141	13.2	UCFS320C	UCFS320D	126 4 31/32	32.3
32.7	184	153	13.2	UCFS321C	UCFS321D	128 5 1/32	35.7
39.0	205	180	13.2	UCFS322C	UCFS322D	129 5 3/32	42.4
50.6	207	185	13.5	UCFS324C	UCFS324D	133 5 1/4	55.4
67.7	229	214	13.6	UCFS326C	UCFS326D	142 5 29/32	73.8
94.0	253	246	13.6	UCFS328C	UCFS328D	156 6 5/32	102

- As for the triple seal type product, suffix code L3 follows the Part No. of unit or bearing. (Example of Part No. : UCFS307JL3, UC307L3)
- The dimensions and forms of applicable bearings, see the dimensional tables of ball bearing for unit.
- Housings of nodular graphite cast iron are also available.





**Square Piloted 4-Bolt Flange Units**

**UKFS**

Tapered bore (with adapter)  
d<sub>1</sub> 20 ~ 125 mm

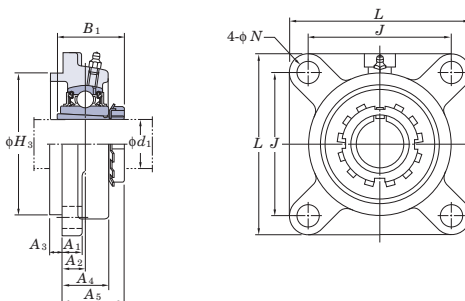

Shaft Dia.		Dimensions										Bolt Size	Standard			
mm	inch	inch mm											inch mm	Unit No.	Housing No.	Bearing No.
d <sub>1</sub>		L	H <sub>3</sub>	J	N	A <sub>1</sub>	A <sub>2</sub>	A <sub>3</sub>	A <sub>4</sub>	A <sub>5</sub>	B <sub>1</sub>					
20	3/4	4 11/32	3.1496	3 5/32	5/8	1/2	23/64	9/32	7/8	1 3/16	1 3/8	1/2	UKFS305	FS305	UK305	
		110	80	80	16	13	9	7	22	30.5	35	M14				
25	1	4 29/32	3.5433	3 47/64	5/8	19/32	25/64	5/16	15/16	1 5/16	1 1/2	1/2	UKFS306	FS306	UK306	
		125	90	95	16	15	10	8	24	33	38	M14				
30	1 1/8	5 5/16	3.9370	3 15/16	3/4	5/8	7/16	23/64	1 1/16	1 7/16	1 11/16	5/8	UKFS307	FS307	UK307	
		135	100	100	19	16	11	9	27	36.5	43	M16				
35	1 3/8	5 29/32	4.5276	4 13/32	3/4	21/32	33/64	25/64	1 3/16	1 19/32	1 13/16	5/8	UKFS308	FS308	UK308	
		150	115	112	19	17	13	10	30	40.5	46	M16				
40	1 1/2	6 5/16	4.9213	4 59/64	3/4	23/32	35/64	7/16	1 5/16	1 23/32	1 31/32	5/8	UKFS309	FS309	UK309	
		160	125	125	19	18	14	11	33	44	50	M16				
45	1 3/4	6 7/8	5.5118	5 13/64	29/32	3/4	5/8	15/32	1 13/32	1 7/8	2 5/32	3/4	UKFS310	FS310	UK310	
		175	140	132	23	19	16	12	36	48	55	M20				
50	1 7/8	7 9/32	5.9055	5 33/64	29/32	25/32	43/64	33/64	1 17/32	2	2 5/16	3/4	UKFS311	FS311	UK311	
		185	150	140	23	20	17	13	39	51	59	M20				
55	2 1/8	7 11/16	6.2992	5 29/32	29/32	7/8	3/4	35/64	1 21/32	2 3/16	2 7/16	3/4	UKFS312	FS312	UK312	
		195	160	150	23	22	19	14	42	55.5	62	M20				
60	2 1/4	8 3/16	6.8898	6 17/32	29/32	7/8	19/32	45/64	1 9/16	2 3/32	2 9/16	3/4	UKFS313	FS313	UK313	
		208	175	166	23	22	15	18	40	53.5	65	M20				
65	2 1/2	9 9/32	7.8740	7 1/4	63/64	31/32	53/64	45/64	1 7/8	2 1/2	2 7/8	7/8	UKFS315	FS315	UK315	
		236	200	184	25	25	21	18	48	63.5	73	M22				
70	2 3/4	9 27/32	8.2677	7 23/32	1 7/32	1 1/16	45/64	25/32	1 7/8	2 15/32	3 1/16	1	UKFS316	FS316	UK316	
		250	210	196	31	27	18	20	48	62.5	78	M27				
75	3	10 1/4	8.6614	8 1/32	1 7/32	1 1/16	15/16	25/32	2 1/8	2 27/32	3 7/32	1	UKFS317	FS317	UK317	
		260	220	204	31	27	24	20	54	72	82	M27				
80	-	11 1/32	9.4488	8 1/2	1 3/8	1 3/16	15/16	25/32	2 7/32	2 27/32	3 3/8	1 1/8	UKFS318	FS318	UK318	
		280	240	216	35	30	24	20	56	72	86	M30				
85	3 1/4	11 13/32	9.8425	8 31/32	1 3/8	1 3/16	1 17/32	25/32	2 29/32	2 19/32	3 17/32	1 1/8	UKFS319	FS319	UK319	
		290	250	228	35	30	39	20	74	91	90	M30				
90	3 1/2	12 7/32	10.2362	9 17/32	1 1/2	1 1/4	1 17/32	25/32	2 29/32	2 21/32	3 13/16	1 1/4	UKFS320	FS320	UK320	
		310	260	242	38	32	39	20	74	93	97	M33				
100	4	13 3/8	11.8110	10 15/32	1 39/64	1 3/8	1 3/8	63/64	2 25/32	2 3/4	4 1/8	1 3/8	UKFS322	FS322	UK322	
		340	300	266	41	35	35	25	71	95	105	M36				
110	-	14 9/16	12.9921	11 27/64	1 39/64	1 9/16	1 3/8	1 3/16	3 5/32	3 21/32	4 13/32	1 3/8	UKFS324	FS324	UK324	
		370	330	290	41	40	35	30	80	100.5	112	M36				
115	4 1/2	16 5/32	14.1732	12 19/32	1 39/64	1 25/32	1 3/8	1 3/16	3 11/32	4	4 3/4	1 3/8	UKFS326	FS326	UK326	
		410	360	320	41	45	35	30	85	101.5	121	M36				
125	-	17 23/32	15.7480	13 25/32	1 39/64	2 5/32	1 49/64	1 3/16	3 3/4	4 5/8	5 5/32	1 3/8	UKFS328	FS328	UK328	
		450	400	350	41	55	45	30	95	117.5	131	M36				

Remarks  
 1. In Part No. of unit and units with covers, fitting codes follow bore diameter numbers. (See Table 10.5 in P62.)  
 2. Part No. of applicable grease fittings are shown below.  
 A-1/4-28UNF ..... 305~308  
 A-R1/8..... 309~328

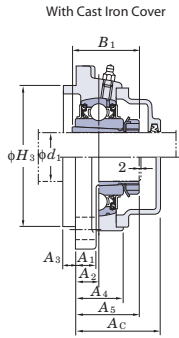

Variations of tolerance of spigot joint outside diameter ( $\Delta D_{30s}$ ), variations of tolerance of distance from mounting surface to center of spherical bore ( $\Delta A_{20s}$ ), tolerance of position of bolt hole (X), and tolerance of circumferential runout of spigot joint (Y)

Housing No.	$\Delta D_{30s}$	$\Delta A_{20s}$	Unit: mm	
			X	Y
FS305	0 -0.046	±0.5	0.7	0.2
FS306~FS308	0 -0.054			
FS309~FS310	0 -0.063			
FS311~FS313	0 -0.072	±0.8	1	0.3
FS315~FS319	0 -0.081			~FS318
FS320~FS322	0 -0.089			FS319~
FS324~FS328	0 -0.089			0.4

Variations of tolerance of bolt hole diameter ( $\Delta N_s$ )

Housing No.	Unit: mm
FS305~315	±0.2
FS316~328	±0.3

Adapter No.	Mass kg	Basic Load Ratings kN		Factor $f_0$	With Cast Iron Cover			Mass kg	
		$C_r$	$C_{0r}$		Unit No.		Dimension mm $A_c$		
					Open Type	Closed Type			
HE2305X H2305X	1.4 1.4	21.2	10.9	12.6	—	—	—	—	
H2306X HE2306X	1.9 1.9	26.7	15.0	13.3	UKFS305C	UKFS305D	47	1 27/32	1.7
—	—	—	—	—	—	—	51	2	2.2
—	—	—	—	—	—	—	—	—	—
HS2307X H2307X	2.4 2.4	33.4	19.3	13.2	—	—	—	—	—
—	—	—	—	—	UKFS307C	UKFS307D	55	2 5/32	2.9
HE2308X HS2308X	3.4 3.4	40.7	24.0	13.2	—	—	—	—	—
—	—	—	—	—	—	—	—	—	—
H2308X	3.4	—	—	—	UKFS308C	UKFS308D	61	2 13/32	3.9
HE2309X H2309X	4.4 4.4	48.9	29.5	13.3	—	—	—	—	—
—	—	—	—	—	UKFS309C	UKFS309D	65	2 9/16	5.0
HE2310X H2310X	5.3 5.3	62.0	38.3	13.2	—	—	—	—	—
—	—	—	—	—	UKFS310C	UKFS310D	71	2 25/32	6.1
HS2311X H2311X	6.3 6.3	71.6	45.0	13.2	—	—	—	—	—
—	—	—	—	—	UKFS311C	UKFS311D	74	2 29/32	7.2
HE2311X	6.3	—	—	—	—	—	—	—	—
—	—	—	—	—	—	—	—	—	—
HS2312X H2312X	7.3 7.3	81.9	52.2	13.2	—	—	—	—	—
—	—	—	—	—	UKFS312C	UKFS312D	81	3 3/16	8.5
HE2313X H2313X	8.9 8.9	92.7	59.9	13.2	—	—	—	—	—
—	—	—	—	—	UKFS313C	UKFS313D	76	3	10.0
HS2313X	8.9	—	—	—	—	—	—	—	—
—	—	—	—	—	—	—	—	—	—
HE2315X H2315X	13.4 13.4	113	77.2	13.2	—	—	—	—	—
—	—	—	—	—	UKFS315C	UKFS315D	88	3 15/32	14.8
HE2316X H2316X	15.1 15.1	123	86.7	13.3	—	—	—	—	—
—	—	—	—	—	UKFS316C	UKFS316D	87	3 7/16	16.7
H2317X HE2317X	17.1 17.1	133	96.8	13.3	—	—	—	—	—
—	—	—	—	—	UKFS317C	UKFS317D	97	3 13/16	18.9
—	—	—	—	—	—	—	—	—	—
—	—	—	—	—	—	—	—	—	—
H2318X	21.4	143	107	13.3	UKFS318C	UKFS318D	99	3 29/32	23.5
—	—	—	—	—	—	—	—	—	—
HE2319X H2319X	24.8 24.8	153	119	13.3	—	—	—	—	—
—	—	—	—	—	UKFS319C	UKFS319D	120	4 23/32	26.2
HE2320X H2320X	29.1 29.1	173	141	13.2	—	—	—	—	—
—	—	—	—	—	UKFS320C	UKFS320D	126	4 31/32	32.2
H2322X HE2322X	38.6 38.6	205	180	13.2	—	—	—	—	—
—	—	—	—	—	UKFS322C	UKFS322D	129	5 3/32	42.1
—	—	—	—	—	—	—	—	—	—
H2324	50.9	207	185	13.5	UKFS324C	UKFS324D	133	5 1/4	56.0
—	—	—	—	—	—	—	—	—	—
HE2326 H2326	67.5 67.5	229	214	13.6	—	—	—	—	—
—	—	—	—	—	UKFS326C	UKFS326D	142	5 29/32	74.1
H2328	94.0	253	246	13.6	UKFS328C	UKFS328D	156	6 5/32	102

- In Part No. of unit with adapters and bearing with adapters, Part No. of applicable adapter follow the Part No. shown in the dimensional tables. (Example of Part No.: UKFS307J + H2307X, UK307 + H2307X)
- As for the triple seal type product, suffix code L3 follows the Part No. of unit or bearing. (Example of Part No.: UKFS307JL3 + H2307X, UK307L3 + H2307X)
- For the dimensions and forms of applicable bearings and adapters, see the dimensional tables of ball bearing for unit and adapter.
- Housings of nodular graphite cast iron are also available.



**Narrow Inner Ring Bearing 4-Bolt Flange Units**

**SBF-RKP8**  
Cylindrical bore  
(with set screws)  
 $d$  20 ~ 55 mm

**SAF-FP9**  
Cylindrical bore  
(with eccentric locking collar)



SBF-RKP8



SAF-FP9

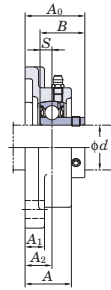

SBF-RKP8

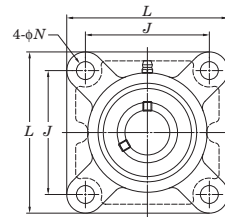

Shaft Dia.		Dimensions										Bolt Size		
mm	inch	inch mm										inch	mm	
$d$		$L$	$A$	$J$	$N$	$A_1$	$A_2$	$A_0$	$B$	$B_1$	SBF-RKP8 $S$	SAF-FP9 $S$	inch	mm
20	$3/4$	$3\ 3/8$	1	$2\ 33/64$	$15/32$	$7/16$	$19/32$	$1\ 17/32$	0.984	1.220	0.276	0.295	$3/8$	
		86	25.5	64	12	11	15	38.5	25	31	7	7.5	M10	
25	$7/8$	$3\ 3/4$	$1\ 1/16$	$2\ 3/4$	$15/32$	$1/2$	$5/8$	$1\ 9/16$	1.063	1.220	0.295	0.295	$3/8$	
	$1\ 15/16$	95	27	70	12	13	16	39.5	27	31	7.5	7.5	M10	
30	$1\ 1/8$	$4\ 1/4$	$1\ 7/32$	$3\ 17/64$	$15/32$	$1/2$	$45/64$	$1\ 3/4$	1.181	1.906	0.315	0.354	$3/8$	
	$1\ 3/16$ $1\ 1/4$	108	31	83	12	13	18	44.7	30	35.7	8	9	M10	
35	$1\ 1/4$	$4\ 19/32$	$1\ 11/32$	$3\ 5/8$	$35/64$	$19/32$	$3/4$	$1\ 29/32$	1.260	1.531	0.335	0.374	$7/16$	
	$1\ 5/16$ $1\ 3/8$ $1\ 7/16$	117	34	92	14	15	19	48.4	32	38.9	8.5	9.5	M12	
40	$1\ 1/2$	$5\ 1/8$	$1\ 13/32$	$4\ 1/64$	$5/8$	$19/32$	$53/64$	$2\ 1/8$	1.339	1.720	0.354	0.433	$1/2$	
	$1\ 9/16$	130	36	102	16	15	21	53.7	34	43.7	9	11	M14	
45	$1\ 5/8$	$5\ 13/32$	$1\ 1/2$	$4\ 9/64$	$5/8$	$5/8$	$55/64$	$2\ 5/32$	—	1.720	—	0.433	$1/2$	
	$1\ 11/16$ $1\ 3/4$	137	38	105	16	16	22	54.7	—	43.7	—	11	M14	
50	$1\ 7/8$	$5\ 5/8$	$1\ 9/16$	$4\ 3/8$	$5/8$	$5/8$	$55/64$	$2\ 5/32$	—	1.720	—	0.433	$1/2$	
	$1\ 15/16$	143	40	111	16	16	22	54.7	—	43.7	—	11	M14	
55	2	$6\ 3/8$	$1\ 11/16$	$5\ 1/8$	$3/4$	$23/32$	$63/64$	$2\ 13/32$	—	1.906	—	0.472	$5/8$	
	$2\ 1/8$ $2\ 3/16$	162	43	130	19	18	25	61.4	—	48.4	—	12	M16	

- Remarks
- In Part No. of unit, fitting codes follow bore diameter numbers. (See Table 10.5 in P.62)
  - Part No. of applicable grease fittings are shown below.  
A-1/4-28UNF ..... 204~210  
A-R1/8..... 211

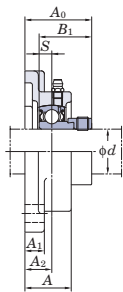

SAF-FP9

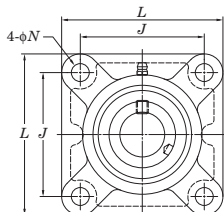

Variations of tolerance of distance from mounting surface to center of spherical bore ( $\Delta_{X2s}$ ) and tolerance of position of bolt hole ( $X$ )

Housing No.	$\Delta_{X2s}$	$X$
F204-F210	$\pm 0.5$	0.7
F211	$\pm 0.8$	1

Unit: mm

Variations of tolerance of bolt hole diameter ( $\Delta_{N6}$ )

Housing No.	$\Delta_{N6}$
F204-F211	$\pm 0.2$

Unit: mm

Unit No.	Bearing No.	Unit No.	Bearing No.	Housing No.	Basic Load Ratings kN		Factor $f_0$	Mass kg	
					$C_r$	$C_{Or}$		SBF-RKP8	SAF-FP9
SBF204-12RKP8	SB204-12RKP8	SAF204-12FP9	SA204-12FP9	F204	12.8	6.65	13.2	0.58	0.62
SBF204RKP8	SB204RKP8	SAF204FP9	SA204FP9						
SBF205-14RKP8	SB205-14RKP8	SAF205-14FP9	SA205-14FP9	F205	14.0	7.85	13.9	0.81	0.86
SBF205-15RKP8	SB205-15RKP8	SAF205-15FP9	SA205-15FP9						
SBF205-16RKP8	SB205-16RKP8	SAF205-16FP9	SA205-16FP9						
SBF205RKP8	SB205RKP8	SAF205FP9	SA205FP9						
SBF206-18RKP8	SB206-18RKP8	SAF206-18FP9	SA206-18FP9						
SBF206-19RKP8	SB206-19RKP8	SAF206-19FP9	SA206-19FP9	F206	19.5	11.3	13.9	1.05	1.12
SBF206-20RKP8	SB206-20RKP8	SAF206-20FP9	SA206-20FP9						
SBF206RKP8	SB206RKP8	SAF206FP9	SA206FP9	F207	25.7	15.4	13.9	1.44	1.59
SBF207-20RKP8	SB207-20RKP8	SAF207-20FP9	SA207-20FP9						
-	-	SAF207-21FP9	SA207-21FP9						
SBF207-22RKP8	SB207-22RKP8	SAF207-22FP9	SA207-22FP9						
SBF207-23RKP8	SB207-23RKP8	SAF207-23FP9	SA207-23FP9						
SBF207RKP8	SB207RKP8	SAF207FP9	SA207FP9	F208	29.1	17.8	14.0	1.86	2.01
SBF208-24RKP8	SB208-24RKP8	SAF208-24FP9	SA208-24FP9						
-	-	SAF208-25FP9	SA208-25FP9						
SBF208RKP8	SB208RKP8	SAF208FP9	SA208FP9						
-	-	SAF209-26FP9	SA209-26FP9						
-	-	SAF209-27FP9	SA209-27FP9	F209	34.1	21.3	14.0	-	2.34
-	-	SAF209-28FP9	SA209-28FP9						
-	-	SAF209FP9	SA209FP9						
-	-	SAF210-30FP9	SA210-30FP9	F210	35.1	23.3	14.4	-	2.55
-	-	SAF210-31FP9	SA210-31FP9						
-	-	SAF210FP9	SA210FP9						
-	-	SAF211-32FP9	SA211-32FP9	F211	43.4	29.4	14.4	-	3.49
-	-	SAF211-34FP9	SA211-34FP9						
-	-	SAF211-35FP9	SA211-35FP9						
-	-	SAF211FP9	SA211FP9						

- For the dimensions and forms of applicable bearings, see the dimensional tables of ball bearing for unit.
- Housings of nodular graphite cast iron are also available.



**Corrosion Resistant Series 4-Bolt Flange Units**

**UCSF-H1S6**

Cylindrical bore (with set screws)

d 20 ~ 60 mm

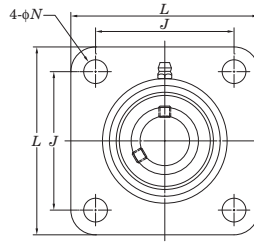
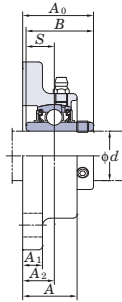

Shaft Dia. mm inch	Dimensions inch mm										Bolt Size inch mm	Standard		
	<i>d</i>	<i>L</i>	<i>A</i>	<i>J</i>	<i>N</i>	<i>A</i> <sub>1</sub>	<i>A</i> <sub>2</sub>	<i>A</i> <sub>0</sub>	<i>B</i>	<i>S</i>		Unit No.	Housing No.	Bearing No.
20 3/4	3 3/8	1 1/32	2 33/64	15/32	13/32	19/32	1 5/16	1.220	0.500	3/8	UCSF204-12H1S6 UCSF204H1S6	SF204H1	UC204-12S6 UC204S6	
	86	26	64	12	10	15	33.3	31	12.7	M10				
25 7/8 15/16 1	3 3/4	1 3/32	2 3/4	15/32	13/32	5/8	1 13/32	1.343	0.563	3/8	UCSF205-14H1S6 UCSF205-15H1S6 UCSF205H1S6 UCSF205-16H1S6	SF205H1	UC205-14S6 UC205-15S6 UC205S6 UC205-16S6	
	95	27.5	70	12	10	16	35.8	34.1	14.3	M10				
30 1 1/8 1 3/16 1 1/4	4 1/4	1 7/32	3 17/64	15/32	13/32	45/64	1 19/32	1.500	0.626	3/8	UCSF206-18H1S6 UCSF206H1S6 UCSF206-19H1S6 UCSF206-20H1S6	SF206H1	UC206-18S6 UC206S6 UC206-19S6 UC206-20S6	
	108	31	83	12	10	18	40.2	38.1	15.9	M10				
35 1 1/4 1 5/16 1 3/8 1 7/16	4 19/32	1 11/32	3 5/8	35/64	7/16	3/4	1 3/4	1.689	0.689	7/16	UCSF207-20H1S6 UCSF207-21H1S6 UCSF207-22H1S6 UCSF207H1S6 UCSF207-23H1S6	SF207H1	UC207-20S6 UC207-21S6 UC207-22S6 UC207S6 UC207-23S6	
	117	34	92	14	11	19	44.4	42.9	17.5	M12				
40 1 1/2 1 9/16	5 1/8	1 13/32	4 1/64	5/8	15/32	53/64	2 1/32	1.937	0.748	1/2	UCSF208-24H1S6 UCSF208-25H1S6 UCSF208H1S6	SF208H1	UC208-24S6 UC208-25S6 UC208S6	
	130	36	102	16	12	21	51.2	49.2	19	M14				
45 1 5/8 1 11/16 1 3/4	5 13/32	1 1/2	4 9/64	5/8	1/2	55/64	2 1/16	1.937	0.748	1/2	UCSF209-26H1S6 UCSF209-27H1S6 UCSF209-28H1S6 UCSF209H1S6	SF209H1	UC209-26S6 UC209-27S6 UC209-28S6 UC209S6	
	137	38	105	16	13	22	52.2	49.2	19	M14				
50 1 7/8 1 15/16 2	5 5/8	1 9/16	4 3/8	5/8	1/2	55/64	2 5/32	2.031	0.748	1/2	UCSF210-30H1S6 UCSF210-31H1S6 UCSF210H1S6 UCSF210-32H1S6	SF210H1	UC210-30S6 UC210-31S6 UC210S6 UC210-32S6	
	143	40	111	16	13	22	54.6	51.6	19	M14				
55 2 2 1/8 2 3/16	6 3/8	1 11/16	5 1/8	3/4	19/32	63/64	2 5/16	2.189	0.874	5/8	UCSF211-32H1S6 UCSF211-34H1S6 UCSF211H1S6 UCSF211-35H1S6	SF211H1	UC211-32S6 UC211-34S6 UC211S6 UC211-35S6	
	162	43	130	19	15	25	58.4	55.6	22.2	M16				
60 2 1/4 2 3/8 2 7/16	6 7/8	1 7/8	5 5/8	3/4	19/32	1 9/64	2 23/32	2.563	1.000	5/8	UCSF212-36H1S6 UCSF212H1S6 UCSF212-38H1S6 UCSF212-39H1S6	SF212H1	UC212-36S6 UC212S6 UC212-38S6 UC212-39S6	
	175	48	143	19	15	29	68.7	65.1	25.4	M16				

- Remarks
- In Part No. of unit and units with covers, fitting codes follow bore diameter codes. (See Table 10.5 in P.62.)
  - Part No. of the applicable grease fitting is shown below.  
A-1/4-28UNFN12 ..... 204~210  
A-R1/8N12 ..... 211~212
  - For the dimensions and forms of applicable bearings, see the dimensional tables of ball bearing for unit.



With Pressed Stainless Steel Cover

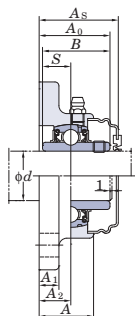

Variations of tolerance of distance from mounting surface to center of spherical bore ( $\Delta A_{2s}$ ) and tolerance of position of bolt hole (X)

Housing No.	$\Delta A_{2s}$	X
SF204H1~210H1	$\pm 0.5$	0.7
SF211H1~212H1	$\pm 0.8$	1

Unit: mm

Variations of tolerance of bolt hole diameter ( $\Delta D_{Vs}$ )

Housing No.	$\Delta D_{Vs}$
SF204H1~212H1	$\pm 0.2$

Unit: mm

Mass	Basic Load Ratings		Factor	With Pressed Stainless Steel Cover		Dimension	Mass	
	kg	$C_r$		$C_{0r}$	Open Type			Closed Type
0.66	10.9	5.35	13.2	UCSF204H1CS6	UCSF204H1DS6	37.5	1 15/32	0.66
0.85	11.9	6.3	13.9	UCSF205H1CS6	UCSF205H1DS6	40.5	1 19/32	0.85
1.2	16.5	9.05	13.9	UCSF206H1CS6	UCSF206H1DS6	44.5	1 3/4	1.2
1.5	21.8	12.3	13.9	UCSF207H1CS6	UCSF207H1DS6	49	1 15/16	1.5
2	24.8	14.3	14.0	UCSF208H1CS6	UCSF208H1DS6	55.5	2 3/16	2.0
2.3	27.8	16.2	14.0	UCSF209H1CS6	UCSF209H1DS6	56.5	2 7/32	2.3
2.6	29.8	18.6	14.4	UCSF210H1CS6	UCSF210H1DS6	59	2 5/16	2.6
4	36.8	23.5	14.4	UCSF211H1CS6	UCSF211H1DS6	63	2 15/32	4.0
4.7	44.5	29	14.4	UCSF212H1CS6	UCSF212H1DS6	73.5	2 29/32	4.7



**Corrosion Resistant Series 4-Bolt Flange Units**

**UCSF-EH1S6**  
Cylindrical bore (with set screws)  
d 20 ~ 60 mm

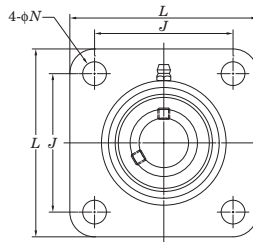
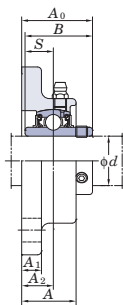

Shaft Dia. mm inch	Dimensions inch mm										Bolt Size inch	Standard		
	L	A	J	N	A <sub>1</sub>	A <sub>2</sub>	A <sub>0</sub>	B	S	Unit No.		Housing No.	Bearing No.	
20 3/4	3 3/8	1 1/32	2 33/64	7/16	13/32	19/32	1 5/16	1.220	0.500	3/8	UCSF204-12EH1S6 UCSF204EH1S6	SF204EH1	UC204-12S6 UC204S6	
	86	26	64	11	10	15	33.3	31	12.7					
25 7/8 15/16 1	3 3/4	1 3/32	2 3/4	15/32	13/32	5/8	1 13/32	1.343	0.563	3/8	UCSF205-14EH1S6 UCSF205-15EH1S6 UCSF205EH1S6 UCSF205-16EH1S6	SF205EH1	UC205-14S6 UC205-15S6 UC205S6 UC205-16S6	
	95	27.5	70	12	10	16	35.8	34.1	14.3					
30 1 1/8 1 3/16 1 1/4	4 1/4	1 7/32	3 17/64	33/64	13/32	45/64	1 19/32	1.500	0.626	7/16	UCSF206-18EH1S6 UCSF206EH1S6 UCSF206-19EH1S6 UCSF206-20EH1S6	SF206EH1	UC206-18S6 UC206S6 UC206-19S6 UC206-20S6	
	108	31	83	13	10	18	40.2	38.1	15.9					
35 1 1/4 1 5/16 1 3/8 1 7/16	4 19/32	1 11/32	3 5/8	33/64	7/16	3/4	1 3/4	1.689	0.689	7/16	UCSF207-20EH1S6 UCSF207-21EH1S6 UCSF207-22EH1S6 UCSF207EH1S6 UCSF207-23EH1S6	SF207EH1	UC207-20S6 UC207-21S6 UC207-22S6 UC207S6 UC207-23S6	
	117	34	92	13	11	19	44.4	42.9	17.5					
40 1 1/2 1 9/16	5 1/8	1 13/32	4 1/64	35/64	15/32	53/64	2 1/32	1.937	0.748	1/2	UCSF208-24EH1S6 UCSF208-25EH1S6 UCSF208EH1S6	SF208EH1	UC208-24S6 UC208-25S6 UC208S6	
	130	36	102	14	12	21	51.2	49.2	19					
45 1 5/8 1 11/16 1 3/4	5 13/32	1 1/2	4 9/64	5/8	1/2	55/64	2 1/16	1.937	0.748	1/2	UCSF209-26EH1S6 UCSF209-27EH1S6 UCSF209-28EH1S6 UCSF209EH1S6	SF209EH1	UC209-26S6 UC209-27S6 UC209-28S6 UC209S6	
	137	38	105	16	13	22	52.2	49.2	19					
50 1 7/8 1 15/16 2	5 5/8	1 9/16	4 3/8	5/8	1/2	55/64	2 5/32	2.031	0.748	1/2	UCSF210-30EH1S6 UCSF210-31EH1S6 UCSF210EH1S6 UCSF210-32EH1S6	SF210EH1	UC210-30S6 UC210-31S6 UC210S6 UC210-32S6	
	143	40	111	16	13	22	54.6	51.6	19					
55 2 2 1/8 2 3/16	6 3/8	1 11/16	5 1/8	43/64	19/32	63/64	2 5/16	2.189	0.874	5/8	UCSF211-32EH1S6 UCSF211-34EH1S6 UCSF211EH1S6 UCSF211-35EH1S6	SF211EH1	UC211-32S6 UC211-34S6 UC211S6 UC211-35S6	
	162	43	130	17	15	25	58.4	55.6	22.2					
60 2 1/4 2 3/8 2 7/16	6 7/8	1 7/8	5 5/8	43/64	19/32	1 9/64	2 23/32	2.563	1.000	5/8	UCSF212-36EH1S6 UCSF212EH1S6 UCSF212-38EH1S6 UCSF212-39EH1S6	SF212EH1	UC212-36S6 UC212S6 UC212-38S6 UC212-39S6	
	175	48	143	17	15	29	68.7	65.1	25.4					

- Remarks
- In Part No. of unit and units with covers, fitting codes follow bore diameter codes. (See **Table 10.5** in P.62.)
  - Part No. of the applicable grease fitting is shown below.  
A-1/4-28UNFN12 ..... 204~210  
A-R1/8N12 ..... 211~212
  - For the dimensions and forms of applicable bearings, see the dimensional tables of ball bearing for unit.



With Pressed Stainless Steel Cover

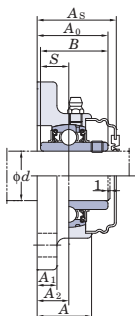

Variations of tolerance of distance from mounting surface to center of spherical bore ( $\Delta A_{2s}$ ) and tolerance of position of bolt hole (X)

Housing No.	$\Delta A_{2s}$	X
SF204EH1~208EH1	$\pm 0.5$	0.7
SF211EH1~212EH1	$\pm 0.8$	1

Unit: mm

Variations of tolerance of bolt hole diameter ( $\Delta d_{Vs}$ )

Housing No.	$\Delta d_{Vs}$
SF204EH1~212EH1	$\pm 0.2$

Unit: mm

Mass	Basic Load Ratings		Factor	With Pressed Stainless Steel Cover		Dimension	Mass	
	kg	$C_r$		$C_{0r}$	Open Type			Closed Type
0.66	10.9	5.35	13.2	UCSF204EH1CS6	UCSF204EH1DS6	37.5	1 15/32	0.66
0.85	11.9	6.3	13.9	UCSF205EH1CS6	UCSF205EH1DS6	40.5	1 19/32	0.85
1.2	16.5	9.05	13.9	UCSF206EH1CS6	UCSF206EH1DS6	44.5	1 3/4	1.2
1.5	21.8	12.3	13.9	UCSF207EH1CS6	UCSF207EH1DS6	49	1 15/16	1.5
2	24.8	14.3	14.0	UCSF208EH1CS6	UCSF208EH1DS6	55.5	2 3/16	2.0
2.3	27.8	16.2	14.0	UCSF209EH1CS6	UCSF209EH1DS6	56.5	2 7/32	2.3
2.6	29.8	18.6	14.4	UCSF210EH1CS6	UCSF210EH1DS6	59	2 5/16	2.6
4	30.7	23.5	14.4	UCSF211EH1CS6	UCSF211EH1DS6	63	2 15/32	4.0
4.7	31.6	29	14.4	UCSF212EH1CS6	UCSF212EH1DS6	73.5	2 29/32	4.7





**Corrosion Resistant Series 4-Bolt Flange Units**

**UCVF-S6**

Cylindrical bore (with set screws)

d 20 ~ 40 mm

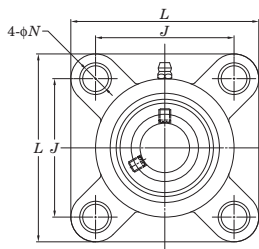
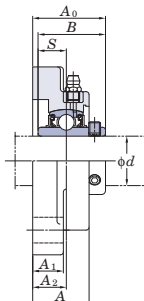

Shaft Dia.		Dimensions										Bolt Size	Standard		
mm	inch	L	A	J	N	inch			mm				Unit No.	Housing No.	Bearing No.
d		L	A	J	N	A <sub>1</sub>	A <sub>2</sub>	A <sub>0</sub>	B	S	inch	mm			
20	3/4	3 3/8	1 3/32	2 1/2	7/16	17/32	45/64	1 7/16	1.220	0.500	3/8		UCVF204-12S6	VF204	UC204-12S6
		86	27.8	63.5	11	13.4	18	36.3	31	12.7	M10		UCVF204S6		UC204S6
25	7/8	3 3/4	1 1/8	2 3/4	7/16	5/8	43/64	1 7/16	1.343	0.563	3/8		UCVF205-14S6	VF205	UC205-14S6
	15/16											UCVF205-15S6	UC205-15S6		
	1											UCVF205S6	UC205S6		
30	1 1/8	4 7/32	1 1/4	3 17/64	7/16	9/16	3/4	1 5/8	1.500	0.626	3/8		UCVF206-18S6	VF206	UC206-18S6
	1 3/16											UCVF206S6	UC206S6		
	1 1/4											UCVF206-19S6	UC206-19S6		
	1 1/2											UCVF206-20S6	UC206-20S6		
35	1 1/4	4 21/32	1 11/32	3 5/8	33/64	5/8	27/32	1 27/32	1.689	0.689	1/2		UCVF207-20S6	VF207	UC207-20S6
	1 5/16											UCVF207-21S6	UC207-21S6		
	1 3/8											UCVF207-22S6	UC207-22S6		
	1 7/16											UCVF207S6	UC207S6		
40	1 1/2	5 1/8	1 7/16	4 1/64	35/64	21/32	29/32	2 3/32	1.937	0.748	1/2		UCVF208-24S6	VF208	UC208-24S6
	1 5/8											UCVF208-25S6	UC208-25S6		
	1 9/16											UCVF208S6	UC208S6		

- Remarks
1. In Part No. of unit and units with covers, fitting codes follow bore diameter numbers. (See Table 10.5 in P.62.)
  2. Part No. of the applicable grease fitting is A-1/4-28UNFN12.
  3. For the dimensions and forms of applicable bearings, see the dimensional tables of ball bearing for unit.



# FYH

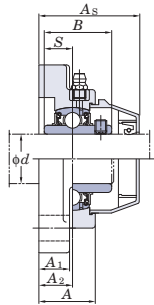

Variations of tolerance of distance from mounting surface to center of spherical bore ( $\Delta A_{2s}$ ) and tolerance of position of bolt hole ( $X$ )

Unit: mm		
Housing No.	$\Delta A_{2s}$	$X$
VF204-VF208	$\pm 0.5$	0.7

Mass kg	Basic Load Ratings kN		Factor $f_0$	With Plastic Cover		Dimension		Mass kg
	$C_r$	$C_{0r}$		Unit No. Open Type	Closed Type	mm	inch	
0.3	10.9	5.35	13.2	UCVF204-12CS6	UCVF204-12DS6	48	1 7/8	0.31
				UCVF204CS6	UCVF204DS6			
0.41	11.9	6.3	13.9	UCVF205-14CS6	UCVF205-14DS6	50.7	2	0.42
				UCVF205-15CS6	UCVF205-15DS6			
				UCVF205CS6	UCVF205DS6			
				UCVF205-16CS6	UCVF205-16DS6			
0.56	16.5	9.05	13.9	UCVF206-18CS6	UCVF206-18DS6	58.3	1 9/32	0.57
				UCVF206CS6	UCVF206DS6			
				UCVF206-19CS6	UCVF206-19DS6			
				UCVF206-20CS6	UCVF206-20DS6			
0.83	21.8	12.3	13.9	UCVF207-20CS6	UCVF207-20DS6	63.7	2 1/2	0.85
				UCVF207-21CS6	UCVF207-21DS6			
				UCVF207-22CS6	UCVF207-22DS6			
				UCVF207CS6	UCVF207DS6			
				UCVF207-23CS6	UCVF207-23DS6			
1.08	24.8	14.3	14.0	UCVF208-24CS6	UCVF208-24DS6	70.7	2 25/32	1.11
				UCVF208-25CS6	UCVF208-25DS6			
				UCVF208CS6	UCVF208DS6			



**Corrosion Resistant Series 4-Bolt Flange Units**

**UCVF-ES7**

Cylindrical bore (with set screws)

d 20 ~ 40 mm

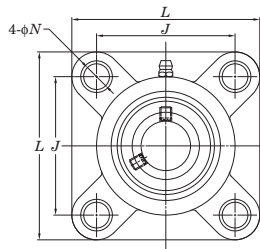
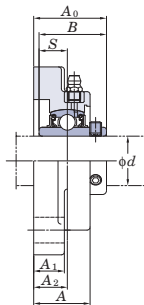

Shaft Dia.		Dimensions										Bolt Size	Standard		
mm	inch	inch mm											Unit No.	Housing No.	Bearing No.
d		L	A	J	N	A <sub>1</sub>	A <sub>2</sub>	A <sub>0</sub>	B	S	inch mm				
20	3/4	3 3/8	1 3/32	2 1/2	7/16	17/32	45/64	1 7/16	1.220	0.500	3/8	UCVF204-12ES7	VF204E	UC204-12S7 UC204S7	
		86	27.8	63.5	11	13.4	18	36.3	31	12.7	M8	UCVF204ES7			
25	7/8	3 3/4	1 1/8	2 3/4	7/16	5/8	43/64	1 7/16	1.343	0.563	7/16	UCVF205-14ES7	VF205E	UC205-14S7 UC205-15S7 UC205S7	
	15/16														UCVF205-15ES7
	1														UCVF205-16ES7
30	1 1/8	4 7/32	1 1/4	3 17/64	7/16	9/16	3/4	1 5/8	1.500	0.626	7/16	UCVF206-18ES7	VF206E	UC206-18S7 UC206S7	
	1 3/16														UCVF206-19ES7
	1 1/4														UCVF206-20ES7
35	1 1/4	4 21/32	1 11/32	3 5/8	33/64	5/8	27/32	1 27/32	1.689	0.689	1/2	UCVF207-21ES7	VF207E	UC207-20S7 UC207-21S7 UC207-22S7 UC207S7	
	1 5/16														UCVF207-22ES7
	1 3/8														UCVF207ES7
	1 7/16														UCVF207-23ES7
40	1 1/2	5 1/8	1 7/16	4 1/64	35/64	21/32	29/32	2 3/32	1.937	0.748	1/2	UCVF208-24ES7	VF208E	UC208-24S7 UC208-25S7 UC208S7	
	1 9/16														UCVF208-25ES7
		130	36.5	102	14	17	23	53.2	49.2	19	M12	UCVF208ES7			

- Remarks
1. In Part No. of unit and units with covers, fitting codes follow bore diameter numbers. (See Table 10.5 in P.62.)
  2. Part No. of the applicable grease fitting is A-1/4-28UNFN12.
  3. For the dimensions and forms of applicable bearings, see the dimensional tables of ball bearing for unit.



# FYH

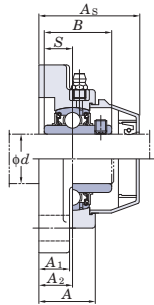

Variations of tolerance of distance from mounting surface to center of spherical bore ( $\Delta A_s$ ) and tolerance of position of bolt hole (X)

Housing No.	$\Delta A_s$	X
VF204E-VF208E	$\pm 0.5$	0.7

Unit: mm

Mass kg	Basic Load Ratings kN		Factor $f_0$	With Plastic Cover Unit No.		Dimension mm    inch		Mass kg
	$C_r$	$C_{0r}$		Open Type	Closed Type	$A_s$		
0.3	12.8	6.65	13.2	UCVF204-12ECS7	UCVF204-12EDS7	48	1 7/8	0.31
				UCVF204ECS7	UCVF204EDS7			
0.41	14.0	7.85	13.9	UCVF205-14ECS7	UCVF205-14EDS7	50.7	2	0.42
				UCVF205-15ECS7	UCVF205-15EDS7			
				UCVF205ECS7	UCVF205EDS7			
				UCVF205-16ECS7	UCVF205-16EDS7			
0.56	19.5	11.3	13.9	UCVF206-18ECS7	UCVF206-18EDS7	58.5	1 5/16	0.57
				UCVF206ECS7	UCVF206EDS7			
				UCVF206-19ECS7	UCVF206-19EDS7			
				UCVF206-20ECS7	UCVF206-20EDS7			
0.83	25.7	15.4	13.9	UCVF207-20ECS7	UCVF207-20EDS7	63.7	2 1/2	0.85
				UCVF207-21ECS7	UCVF207-21EDS7			
				UCVF207-22ECS7	UCVF207-22EDS7			
				UCVF207ECS7	UCVF207EDS7			
				UCVF207-23ECS7	UCVF207-23EDS7			
1.08	29.1	17.8	14.0	UCVF208-24ECS7	UCVF208-24EDS7	70.7	2 25/32	1.11
				UCVF208-25ECS7	UCVF208-25EDS7			
				UCVF208ECS7	UCVF208EDS7			