

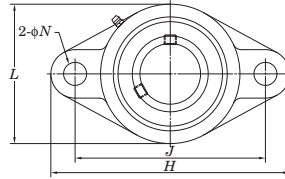

2-Bolt Flange Units

UCFL
Cylindrical bore (with set screws)
d 12 ~ (45) mm

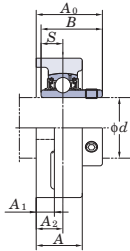

Shaft Dia.		Dimensions										Bolt Size	Standard		
mm	inch	inch mm											inch mm	Unit No.	Housing No.
d		H	L	A	J	N	A ₁	A ₂	A ₀	B	S				
12	1/2											3/8 M10	UCFL201 UCFL201-8 UCFL202 UCFL202-10 UCFL203 UCFL204-12 UCFL204	FL204	UC201 UC201-8 UC202 UC202-10 UC203 UC204-12 UC204
	15	4 7/16	2 3/8	1	3 35/64	1 5/32	7/16	1 9/32	1 5/16	1.220	0.500				
	17	113	60	25.5	90	12	11	15	33.3	31	12.7				
	20														
25	7/8											1/2 M14	UCFL205-14 UCFL205-15 UCFL205 UCFL205-16	FL205	UC205-14 UC205-15 UC205 UC205-16
	15/16	5 1/8	2 11/16	1 1/16	3 57/64	5/8	1/2	5/8	1 13/32	1.343	0.563				
	1	130	68	27	99	16	13	16	35.8	34.1	14.3				
30	1 1/8											1/2 M14	UCFL206-18 UCFL206 UCFL206-19 UCFL206-20	FL206	UC206-18 UC206 UC206-19 UC206-20
	1 3/16	5 9/16	3 3/32	1 3/16	4 39/64	1 5/32	1/2	4 5/64	1 19/32	1.500	0.626				
	1 1/4	141	83	30	117	12	13	18	40.2	38.1	15.9				
35	1 3/16											1/2 M14	UCFLX06 UCFLX06-19 UCFLX06-20	FLX06	UCX06 UCX06-19 UCX06-20
	1 1/4	5 29/32	3 5/32	1 5/32	4 29/64	3/4	1/2	5/8	1 17/32	1.496	0.591				
		150	80	29	113	19	13	16	39	38	15				
40	1 1/8											1/2 M14	UCFL207-20 UCFL207-21 UCFL207-22 UCFL207 UCFL207-23	FL207	UC207-20 UC207-21 UC207-22 UC207 UC207-23
	1 3/16	5 13/16	3 5/32	1 7/32	4 39/64	5/8	1/2	4 5/64	1 19/32	1.500	0.626				
	1 1/4	148	80	31	117	16	13	18	40.2	38.1	15.9				
45	1 3/16											1/2 M14	UCFLX07-22 UCFLX07 UCFLX07-23	FLX07	UCX07-22 UCX07 UCX07-23
	1 1/4	6 5/32	3 3/4	1 11/32	5 1/8	5/8	9/16	3/4	1 3/4	1.689	0.689				
		156	95	34	130	16	14	19	44.4	42.9	17.5				
50	1 1/2											1/2 M14	UCFL208-24 UCFL208-25 UCFL208	FL208	UC208-24 UC208-25 UC208
	1 9/16	6 7/8	3 15/16	1 13/32	5 43/64	5/8	9/16	53/64	2 1/32	1.937	0.748				
		175	100	36	144	16	14	21	51.2	49.2	19				
55	1 1/2											1/2 M14	UCFLX08-24 UCFLX08	FLX08	UCX08-24 UCX08
	1 9/16	7 1/16	4 3/8	1 9/16	5 53/64	5/8	9/16	55/64	2 1/16	1.937	0.748				
		179	111	40	148	16	14	22	52.2	49.2	19				
60	1 1/2											3/4 M20	UCFL308-24 UCFL308	FL308	UC308-24 UC308
	1 9/16	7 7/8	4 13/32	1 9/16	6 7/32	29/32	21/32	29/32	2 7/32	2.047	0.748				
		200	112	40	158	23	17	23	56	52	19				
65	1 5/8											5/8 M16	UCFL209-26 UCFL209-27 UCFL209-28 UCFL209	FL209	UC209-26 UC209-27 UC209-28 UC209
	1 11/16	7 13/32	4 1/4	1 1/2	5 53/64	3/4	19/32	55/64	2 1/16	1.937	0.748				
	1 3/4	188	108	38	148	19	15	22	52.2	49.2	19				
70	1 11/16											1/2 M14	UCFLX09-27 UCFLX09-28 UCFLX09	FLX09	UCX09-27 UCX09-28 UCX09
	1 3/4	7 7/16	4 9/16	1 9/16	6 3/16	5/8	9/16	29/32	2 3/16	2.031	0.748				

Remarks 1. In Part No. of unit and units with covers, fitting codes follow bore diameter numbers. (See Table 10.5 in P.62.)
2. Part No. of applicable grease fittings are shown below.
A-1/4-28UNF 201~210, X05~X09, 305~308
A-R1/8..... 211~218, X10, 309~324



With Pressed Steel Cover With Cast Iron Cover

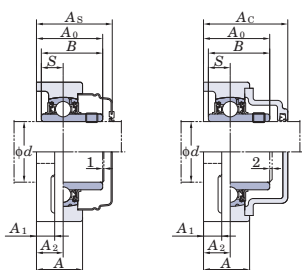

Variations of tolerance of distance from mounting surface to center of spherical bore (ΔA_{2s}) and tolerance of position of bolt hole (X)

Housing No.		ΔA_{2s}	X
FL204~FL210	FLX05~FLX10	±0.5	0.7
FL211~FL218	FL305~FL310	±0.8	1

Variations of tolerance of bolt hole diameter (ΔD_{Vs})

Housing No.		ΔD_{Vs}
FL204~FL218	FLX05~FLX10	±0.2
FL311~FL324	FL305~FL310	±0.3

Forms and dimensions of L_c of FL204JE3 and FL205JE3 (housing with cast iron cover) are shown below.

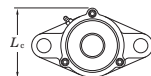

FL204JE3 $L_c = 65$ mm
FL205JE3 $L_c = 73$ mm

Mass	Basic Load Ratings		Factor	With Pressed Steel Cover				With Cast Iron Cover								
	C_r	C_{0r}		Unit No.	Open Type	Closed Type	Dimension mm	inch	Mass	Unit No.	Open Type	Closed Type	Dimension mm	inch	Mass	
kg	kN		f_0			A_s		kg			A_c		kg			
0.50	12.8	6.65	13.2	UCFL201C	UCFL201D	37.5	1 15/32	0.50	—	—	—	—	—	—		
0.50				—	—	—	—	—	—	—	—	—	—	—	—	
0.48				UCFL202C	UCFL202D	37.5	1 15/32	0.48	—	—	—	—	—	—	—	
0.48				—	—	—	—	—	—	—	—	—	—	—	—	—
0.47				UCFL203C	UCFL203D	37.5	1 15/32	0.47	—	—	—	—	—	—	—	—
0.47	—	—	—	—	—	—	—	—	—	—	—	—	—	—		
0.45	UCFL204C	UCFL204D	37.5	1 15/32	0.45	UCFL204FC	UCFL204FD	46	1 13/16	0.6	—	—	—			
0.64	14.0	7.85	13.9	—	—	—	—	—	—	—	—	—	—	—		
0.64				—	—	—	—	—	—	—	—	—	—	—	—	
0.64				UCFL205C	UCFL205D	40.5	1 19/32	0.64	UCFL205FC	UCFL205FD	49	1 15/16	0.83	—	—	
0.64				—	—	—	—	—	—	—	—	—	—	—	—	
1.1	19.5	11.3	13.9	UCFLX05C	UCFLX05D	44.5	1 3/4	1.1	—	—	—	—	—			
1.1				—	—	—	—	—	—	—	—	—	—	—		
1.1	21.2	10.9	12.6	—	—	—	—	—	UCFL305C	UCFL305D	54	2 1/8	1.4			
1.1				—	—	—	—	—	—	—	—	—	—	—		
0.93	19.5	11.3	13.9	—	—	—	—	—	—	—	—	—	—			
0.93				UCFL206C	UCFL206D	44.5	1 3/4	0.93	UCFL206FC	UCFL206FD	53	2 3/32	1.2	—		
0.93				—	—	—	—	—	—	—	—	—	—	—		
0.93	—	—	—	—	—	—	—	—	—	—	—	—	—			
1.5	25.7	15.4	13.9	UCFLX06C	UCFLX06D	49	1 15/16	1.5	—	—	—	—	—			
1.5				—	—	—	—	—	—	—	—	—	—	—		
1.5	—	—	—	—	—	—	—	—	—	—	—	—	—			
1.5	26.7	15.0	13.3	—	—	—	—	—	UCFL306C	UCFL306D	59	2 5/16	1.8			
1.2	25.7	15.4	13.9	—	—	—	—	—	—	—	—	—	—			
1.2				—	—	—	—	—	—	—	—	—	—	—		
1.2				—	—	—	—	—	—	—	—	—	—	—		
1.2				UCFL207C	UCFL207D	49	1 15/16	1.2	UCFL207FC	UCFL207FD	58	2 3/32	1.6	—		
1.2				—	—	—	—	—	—	—	—	—	—	—		
1.9	29.1	17.8	14.0	—	—	—	—	—	—	—	—	—	—			
1.9				UCFLX07C	UCFLX07D	55.5	2 3/16	1.9	—	—	—	—	—	—		
1.9				—	—	—	—	—	—	—	—	—	—	—		
1.8	33.4	19.3	13.2	—	—	—	—	—	UCFL307C	UCFL307D	64	2 17/32	2.2			
1.6	29.1	17.8	14.0	—	—	—	—	—	—	—	—	—	—			
1.6				—	—	—	—	—	—	—	—	—	—	—		
1.6	UCFL208C	UCFL208D	55.5	2 3/16	1.6	UCFL208FC	UCFL208FD	64	2 17/32	2.0	—					
2.1	34.1	21.3	14.0	—	—	—	—	—	—	—	—	—	—			
2.1				UCFLX08C	UCFLX08D	56.5	2 7/32	2.1	—	—	—	—	—	—		
2.5	40.7	24.0	13.2	—	—	—	—	—	—	—	—	—	—			
2.5				—	—	—	—	—	UCFL308C	UCFL308D	71	2 25/32	3.0			
1.9	34.1	21.3	14.0	—	—	—	—	—	—	—	—	—	—			
1.9				—	—	—	—	—	—	—	—	—	—	—		
1.9				—	—	—	—	—	—	—	—	—	—	—		
1.9				UCFL209C	UCFL209D	56.5	2 7/32	1.9	UCFL209FC	UCFL209FD	66	2 19/32	2.3			
2.4	35.1	23.3	14.4	—	—	—	—	—	—	—	—	—	—			
2.4				—	—	—	—	—	—	—	—	—	—	—		
2.4				UCFLX09C	UCFLX09D	60	2 3/8	2.4	—	—	—	—	—	—		

- As for the triple seal type product (from 201 to 205 are the double seal type products), suffix code L3 (or L2) follows the Part No. of unit or bearing. (Example of Part No. : UCFL206JL3, UC206L3)
- For the dimensions and forms of applicable bearings, see the dimensional tables of ball bearing for unit.
- Housings of nodular graphite cast iron are also available.



2-Bolt Flange Units

UCFL
Cylindrical bore (with set screws)
d (45) ~ (90) mm

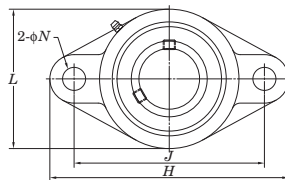
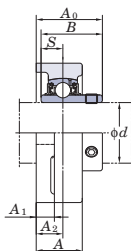

Shaft Dia. mm inch	Dimensions											Bolt Size inch mm	Standard		
	H	L	A	J	N	A ₁	A ₂	A ₀	B	S	Unit No.		Housing No.	Bearing No.	
45 1 3/4	9 1/16	4 29/32	1 23/32	6 31/32	63/64	23/32	63/64	2 3/8	2.244	0.866	7/8	UCFL309-28	FL309	UC309-28 UC309	
	230	125	44	177	25	18	25	60	57	22	M22	UCFL309			
50 1 7/8 1 15/16 2 1 15/16	7 3/4	4 17/32	1 9/16	6 3/16	3/4	19/32	55/64	2 5/32	2.031	0.748	5/8	UCFL210-30	FL210	UC210-30 UC210-31 UC210 UC210-32	
	197	115	40	157	19	15	22	54.6	51.6	19	M16	UCFL210-31			
	2	8 1/2	5 1/4	1 23/32	7 1/4	3/4	25/32	1 1/32	2 11/32	2.189	0.874	5/8			UCFLX10-31
	216	133	44	184	19	20	26	59.4	55.6	22.2	M16	UCFLX10			
—	9 7/16	5 1/2	1 7/8	7 23/64	63/64	3/4	1 7/64	2 5/8	2.402	0.866	7/8	UCFL310	FL310	UC310	
240	140	48	187	25	19	28	67	61	22	M22	UCFL310	FL310	UC310		
55 2 2 1/8 2 3/16 2	8 13/16	5 1/8	1 11/16	7 1/4	3/4	23/32	63/64	2 5/16	2.189	0.874	5/8	UCFL211-32	FL211	UC211-32 UC211-34 UC211 UC211-35	
	224	130	43	184	19	18	25	58.4	55.6	22.2	M16	UCFL211			
	2	9 27/32	5 29/32	2 1/16	7 51/64	63/64	25/32	1 3/16	2 25/32	2.598	0.984	7/8			UCFL311-32
	250	150	52	198	25	20	30	71	66	25	M22	UCFL311			
2 3/16	—	—	—	—	—	—	—	—	—	—	UCFL311-35	FL311	UC311 UC311-35		
60 2 1/4 2 3/8 2 7/16	9 27/32	5 1/2	1 7/8	7 61/64	29/32	23/32	1 9/64	2 23/32	2.563	1.000	3/4	UCFL212-36	FL212	UC212-36 UC212 UC212-38 UC212-39	
	250	140	48	202	23	18	29	68.7	65.1	25.4	M20	UCFL212			
	2 7/16	10 5/8	6 5/16	2 7/32	8 11/32	1 7/32	7/8	1 19/64	3 1/16	2.795	1.024	1			UCFL312
	270	160	56	212	31	22	33	78	71	26	M27	UCFL312-39			
65 2 1/2 2 1/2	10 5/32	6 3/32	1 31/32	8 17/64	29/32	25/32	1 3/16	2 3/4	2.563	1.000	3/4	UCFL213-40	FL213	UC213-40 UC213	
	258	155	50	210	23	20	30	69.7	65.1	25.4	M20	UCFL213			
	2 1/2	11 5/8	6 7/8	2 9/32	9 29/64	1 7/32	31/32	1 19/64	3 1/16	2.953	1.181	1			UCFL313-40
295	175	58	240	31	25	33	78	75	30	M27	UCFL313	FL313	UC313-40 UC313		
70 2 3/4 2 3/4	10 7/16	6 5/16	2 1/8	8 1/2	29/32	25/32	1 7/32	2 31/32	2.937	1.189	3/4	UCFL214-44	FL214	UC214-44 UC214	
	265	160	54	216	23	20	31	75.4	74.6	30.2	M20	UCFL214			
	2 3/4	12 13/32	7 9/32	2 13/32	9 27/32	1 3/8	1 3/32	1 27/64	3 3/16	3.071	1.299	1 1/8			UCFL314-44
315	185	61	250	35	28	36	81	78	33	M30	UCFL314	FL314	UC314-44 UC314		
75 2 15/16 3 2 15/16	10 13/16	6 1/2	2 7/32	8 55/64	29/32	25/32	1 11/32	3 3/32	3.063	1.311	3/4	UCFL215-47	FL215	UC215-47 UC215 UC215-48	
	275	165	56	225	23	20	34	78.5	77.8	33.3	M20	UCFL215			
	3	12 19/32	7 11/16	2 19/32	10 15/64	1 3/8	1 3/16	1 17/32	3 1/2	3.228	1.260	1 1/8			UCFL315-47
	320	195	66	260	35	30	39	89	82	32	M30	UCFL315			
—	—	—	—	—	—	—	—	—	—	—	UCFL315-48	FL315	UC315 UC315-48		
80 3 1/8 —	11 13/32	7 3/32	2 9/32	9 11/64	63/64	25/32	1 11/32	3 9/32	3.252	1.311	7/8	UCFL216-50	FL216	UC216-50 UC216	
	290	180	58	233	25	20	34	83.3	82.6	33.3	M22	UCFL216			
	—	13 31/32	8 9/32	2 11/16	11 7/32	1 1/2	1 1/4	1 1/2	3 17/32	3.386	1.339	1 1/4			UCFL316
355	210	68	285	38	32	38	90	86	34	M33	UCFL316	FL316	UC316		
85 3 1/4 —	12 7/16	7 15/32	2 15/32	9 49/64	63/64	7/8	1 27/64	3 7/16	3.374	1.343	7/8	UCFL217-52	FL217	UC217-52 UC217	
	305	190	63	248	25	22	36	87.6	85.7	34.1	M22	UCFL217			
	—	14 9/16	8 21/32	2 29/32	11 13/16	1 1/2	1 1/4	1 47/64	3 15/16	3.780	1.575	1 1/4			UCFL317
370	220	74	300	38	32	44	100	96	40	M33	UCFL317	FL317	UC317		
90 3 1/2	12 19/32	8 1/16	2 11/16	10 7/16	63/64	29/32	1 37/64	3 25/32	3.780	1.563	7/8	UCFL218-56	FL218	UC218-56 UC218	
	320	205	68	265	25	23	40	96.3	96	39.7	M22	UCFL218			

Remarks
 1. In Part No. of unit and units with covers, fitting codes follow bore diameter numbers. (See Table 10.5 in P.62.)
 2. Part No. of applicable grease fittings are shown below.
 A-1/4-28UNF 201~210, X05~X09, 305~308
 A-R1/8..... 211~218, X10, 309~324



With Pressed Steel Cover With Cast Iron Cover

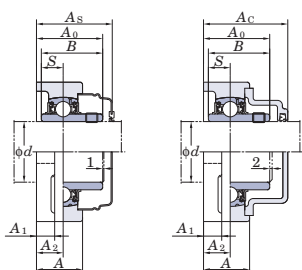

Variations of tolerance of distance from mounting surface to center of spherical bore (ΔA_{2a}) and tolerance of position of bolt hole (X)

Housing No.		ΔA_{2a}	X
FL204~FL210	FLX05~FLX10	± 0.5	0.7
FL211~FL218	FL305~FL310	± 0.8	1

Variations of tolerance of bolt hole diameter (ΔD_h)

Housing No.		ΔD_h
FL204~FL218	FLX05~FLX10	± 0.2
	FL305~FL311	± 0.3

Forms and dimensions of L_c of FL204JE3 and FL205JE3 (housing with cast iron cover) are shown below.



Mass	Basic Load Ratings		Factor	With Pressed Steel Cover			Mass	With Cast Iron Cover			Mass		
	C_r	C_{0r}		Unit No.	Open Type	Closed Type		Dimension mm	Dimension inch	Unit No.		Open Type	Closed Type
kg	kN		f_0				kg				kg		
3.5	48.9	29.5	13.3	-	-	-	-	-	-	-	-	-	
3.5	48.9	29.5	13.3	-	-	-	-	UCFL309C	UCFL309D	76	3	4.1	
2.2	-	-	-	-	-	-	-	-	-	-	-	-	
2.2	35.1	23.3	14.4	-	-	-	-	-	-	-	-	-	
2.2	35.1	23.3	14.4	UCFL210C	UCFL210D	59	2 5/16	2.2	UCFL210FC	UCFL210FD	70.5	2 25/32	2.7
2.2	-	-	-	-	-	-	-	-	-	-	-	-	
3.8	-	-	-	-	-	-	-	-	-	-	-	-	
3.8	43.4	29.4	14.4	UCFLX10C	UCFLX10D	64	2 17/32	3.8	-	-	-	-	
3.8	-	-	-	-	-	-	-	-	-	-	-	-	
4.4	62.0	38.3	13.2	-	-	-	-	-	UCFL310C	UCFL310D	83	3 9/32	5.2
3.3	-	-	-	-	-	-	-	-	-	-	-	-	
3.3	43.4	29.4	14.4	-	-	-	-	-	-	-	-	-	
3.3	43.4	29.4	14.4	UCFL211C	UCFL211D	63	2 15/32	3.3	UCFL211FC	UCFL211FD	74.5	2 15/16	3.9
3.3	-	-	-	-	-	-	-	-	-	-	-	-	
5.3	-	-	-	-	-	-	-	-	-	-	-	-	
5.3	71.6	45.0	13.2	-	-	-	-	-	UCFL311C	UCFL311D	87	3 7/16	6.2
5.3	-	-	-	-	-	-	-	-	-	-	-	-	
4.2	-	-	-	-	-	-	-	-	-	-	-	-	
4.2	52.4	36.2	14.4	UCFL212C	UCFL212D	73.5	2 29/32	4.2	UCFL212FC	UCFL212FD	86	3 3/8	5.0
4.2	-	-	-	-	-	-	-	-	-	-	-	-	
4.2	-	-	-	-	-	-	-	-	-	-	-	-	
6.5	81.9	52.2	13.2	-	-	-	-	-	UCFL312C	UCFL312D	95	3 7/4	7.7
6.5	-	-	-	-	-	-	-	-	-	-	-	-	
5.1	-	-	-	-	-	-	-	-	-	-	-	-	
5.1	57.2	40.1	14.4	UCFL213C	UCFL213D	74.5	2 15/16	5.1	UCFL213FC	UCFL213FD	87	3 7/16	5.9
8.5	-	-	-	-	-	-	-	-	-	-	-	-	
8.5	92.7	59.9	13.2	-	-	-	-	-	UCFL313C	UCFL313D	94	3 11/16	9.6
5.7	-	-	-	-	-	-	-	-	-	-	-	-	
5.7	62.2	44.1	14.5	UCFL214C	UCFL214D	80.5	3 5/32	5.7	UCFL214FC	UCFL214FD	93	3 21/32	6.6
9.7	-	-	-	-	-	-	-	-	-	-	-	-	
9.7	104	68.2	13.2	-	-	-	-	-	UCFL314C	UCFL314D	98	3 27/32	10.8
6.4	-	-	-	-	-	-	-	-	-	-	-	-	
6.4	67.4	48.3	14.5	UCFL215C	UCFL215D	83.5	3 9/32	6.4	UCFL215FC	UCFL215FD	96	3 25/32	7.4
6.4	-	-	-	-	-	-	-	-	-	-	-	-	
11.3	-	-	-	-	-	-	-	-	-	-	-	-	
11.3	113	77.2	13.2	-	-	-	-	-	UCFL315C	UCFL315D	106	4 3/16	12.6
11.3	-	-	-	-	-	-	-	-	-	-	-	-	
7.8	-	-	-	-	-	-	-	-	-	-	-	-	
7.8	72.7	53.0	14.6	UCFL216C	UCFL216D	88.5	3 15/32	7.8	UCFL216FC	UCFL216FD	103	4 1/16	9.0
14.4	123	86.7	13.3	-	-	-	-	-	UCFL316C	UCFL316D	107	4 7/32	15.8
9.8	-	-	-	-	-	-	-	-	-	-	-	-	
9.8	84.0	61.9	14.5	UCFL217C	UCFL217D	92.5	3 21/32	9.8	UCFL217FC	UCFL217FD	107	4 7/32	11.2
16.0	133	96.8	13.3	-	-	-	-	-	UCFL317C	UCFL317D	117	4 19/32	17.6
12.3	-	-	-	-	-	-	-	-	-	-	-	-	
12.3	96.1	71.5	14.5	UCFL218C	UCFL218D	101.5	4	12.3	UCFL218FC	UCFL218FD	116	4 9/16	13.8

3. As for the triple seal type product (from 201 to 205 are the double seal type products), suffix code L3 (or L2) follows the Part No. of unit or bearing. (Example of Part No.: UCFL206JL3, UC206L3)
 4. For the dimensions and forms of applicable bearings, see the dimensional tables of ball bearing for unit.
 5. Housings of nodular graphite cast iron are also available.



2-Bolt Flange Units

UCFL

Cylindrical bore (with set screws)

d (90) ~ 120 mm

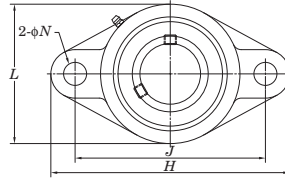
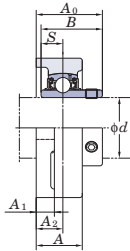

Shaft Dia. mm inch		Dimensions inch mm										Bolt Size inch mm	Standard				
		H	L	A	J	N	A ₁	A ₂	A ₀	B	S		Unit No.	Housing No.	Bearing No.		
d																	
90	3 1/2	15 5/32	9 1/4	3	12 13/32	1 1/2	1 13/32	1 47/64	3 15/16	3.780	1.575	1 1/4	UCFL318-56 UCFL318	FL318	UC318-56 UC318		
		385	235	76	315	38	36	44	100	96	40	M33					
95	-	15 15/16	9 27/32	3 11/16	13	1 39/64	1 9/16	2 21/64	4 3/4	4.055	1.614	1 3/8	UCFL319	FL319	UC319		
		405	250	94	330	41	40	59	121	103	41	M36					
100	3 15/16 4	17 5/16	10 5/8	3 11/16	14 11/64	1 47/64	1 9/16	2 21/64	4 29/32	4.252	1.654	1 1/2	UCFL320 UCFL320-63 UCFL320-64	FL320	UC320 UC320-63 UC320-64		
		440	270	94	360	44	40	59	125	108	42	M39					
110	-	18 1/2	11 13/16	3 25/32	15 23/64	1 47/64	1 21/32	2 23/64	5 5/32	4.606	1.811	1 1/2	UCFL322	FL322	UC322		
		470	300	96	390	44	42	60	131	117	46	M39					
120	-	20 15/32	13	4 11/32	16 59/64	1 27/32	1 7/8	2 9/16	5 1/2	4.961	2.008	1 5/8	UCFL324	FL324	UC324		
		520	330	110	430	47	48	65	140	126	51	M42					

Remarks 1. In Part No. of unit and units with covers, fitting codes follow bore diameter numbers. (See Table 10.5 in P.62.)

2. Part No. of applicable grease fittings are shown below.

A-1/4-28UNF 201~210, X05~X09, 305~308

A-R1/8 211~218, X10, 309~324



With Pressed Steel Cover With Cast Iron Cover

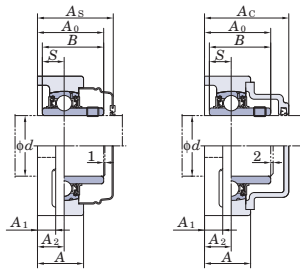

Variations of tolerance of distance from mounting surface to center of spherical bore (ΔA_{2s}) and tolerance of position of bolt hole (X)

Housing No.		ΔA_{2s}	X
FL204~FL210	FLX05~FLX10	± 0.5	0.7
FL211~FL218	FL305~FL310	± 0.8	1

Variations of tolerance of bolt hole diameter (ΔD_h)

Housing No.		ΔD_h
FL204~FL218	FLX05~FLX10	± 0.2
	FL312~FL324	± 0.3

Forms and dimensions of L_c of FL204JE3 and FL205JE3 (housing with cast iron cover) are shown below.

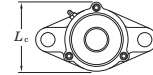

FL204JE3 $L_c = 65$ mm
FL205JE3 $L_c = 73$ mm

Mass	Basic Load Ratings		Factor	With Pressed Steel Cover			Mass	With Cast Iron Cover			Mass
	C_r	C_{0r}		Unit No.	Open Type	Closed Type		Dimension	Open Type	Closed Type	
kg	kN		f_0			mm inch	kg			mm inch	kg
						A_s				A_c	
19.0	143	107	13.3	-	-	- -	-	-	-	- -	-
19.0	143	107	13.3	-	-	- -	-	UCFL318C	UCFL318D	119 4 11/16	20.9
24.6	153	119	13.3	-	-	- -	-	UCFL319C	UCFL319D	140 5 1/2	26.8
29.4	173	141	13.2	-	-	- -	-	UCFL320C	UCFL320D	146 5 3/4	32.2
29.4	173	141	13.2	-	-	- -	-	-	-	- -	-
29.4	173	141	13.2	-	-	- -	-	-	-	- -	-
36.2	205	180	13.2	-	-	- -	-	UCFL322C	UCFL322D	154 6 1/16	39.6
51.6	207	185	13.5	-	-	- -	-	UCFL324C	UCFL324D	163 6 13/32	56.4

- As for the triple seal type product (from 201 to 205 are the double seal type products), suffix code L3 (or L2) follows the Part No. of unit or bearing. (Example of Part No. : UCFL206JL3, UC206L3)
- For the dimensions and forms of applicable bearings, see the dimensional tables of ball bearing for unit.
- Housings of nodular graphite cast iron are also available.



2-Bolt Flange Units

UCFL-E
Cylindrical bore (with set screws)
d 12 ~ 75 mm

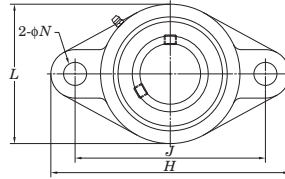
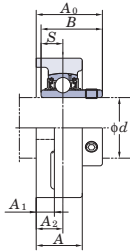

Shaft Dia. mm inch	Dimensions										Bolt Size inch	Unit No.	Housing No.	Bearing No.	
	H	L	A	J	N	A ₁	A ₂	A ₀	B	S					inch
12	1/2	3 27/32	2 7/32	1	3	25/64	7/16	19/32	1 5/16	1.220	0.500	5/16	UCFL201E UCFL201-8E UCFL202E UCFL202-10E UCFL203E	FL203E	UC201 UC201-8 UC202 UC202-10 UC203
15	5/8	98	56	25.5	76.2	10	11	15	33.3	31	12.7				
17															
20	3/4	4 7/16	2 3/8	1	3 17/32	25/64	7/16	19/32	1 5/16	1.220	0.500	5/16	UCFL204-12E UCFL204E	FL204E	UC204-12 UC204
		113	60	25.5	89.7	10	11	15	33.3	31	12.7				
25	7/8 15/16 1	5 1/8	2 11/16	1 1/16	3 57/64	15/32	1/2	5/8	1 13/32	1.343	0.563	3/8	UCFL205-14E UCFL205-15E UCFL205E UCFL205-16E	FL205E	UC205-14 UC205-15 UC205 UC205-16
		130	68	27	98.8	12	13	16	35.8	34.1	14.3				
30	1 1/8 1 3/16 1 1/4	5 13/16	3 5/32	1 7/32	4 19/32	15/32	1/2	45/64	1 19/32	1.500	0.626	3/8	UCFL206-18E UCFL206E UCFL206-19E UCFL206-20E	FL206E	UC206-18 UC206 UC206-19 UC206-20
		148	80	31	116.7	12	13	18	40.2	38.1	15.9				
35	1 1/4 1 5/16 1 3/8 1 7/16	6 11/32	3 17/32	1 11/32	5 1/8	33/64	9/16	3/4	1 3/4	1.689	0.689	7/16	UCFL207-20E UCFL207-21E UCFL207-22E UCFL207E UCFL207-23E	FL207E	UC207-20 UC207-21 UC207-22 UC207 UC207-23
		161	90	34	130.2	13	14	19	44.4	42.9	17.5				
40	1 1/2 1 9/16	6 7/8	3 15/16	1 13/32	5 21/32	33/64	9/16	53/64	2 1/32	1.937	0.748	7/16	UCFL208-24E UCFL208-25E UCFL208E	FL208E	UC208-24 UC208-25 UC208
		175	100	36	143.7	13	14	21	51.2	49.2	19				
45	1 5/8 1 11/16 1 3/4	7 13/32	4 1/4	1 1/2	5 27/32	19/32	19/32	55/64	2 1/16	1.937	0.748	1/2	UCFL209-26E UCFL209-27E UCFL209-28E UCFL209E	FL209E	UC209-26 UC209-27 UC209-28 UC209
		188	108	38	148.4	15	15	22	52.2	49.2	19				
50	1 7/8 1 15/16 2	7 3/4	4 17/32	1 9/16	6 3/16	19/32	19/32	55/64	2 5/32	2.031	0.748	1/2	UCFL210-30E UCFL210-31E UCFL210E UCFL210-32E	FL210E	UC210-30 UC210-31 UC210 UC210-32
		197	115	40	157	15	15	22	54.6	51.6	19				
55	2 2 1/8 2 3/16 2 1/4	8 13/16	5 1/8	1 11/16	7 1/4	21/32	23/32	63/64	2 5/16	2.189	0.874	9/16	UCFL211-32E UCFL211-34E UCFL211E UCFL211-35E	FL211E	UC211-32 UC211-34 UC211 UC211-35
		224	130	43	184	16.5	18	25	58.4	55.6	22.2				
60	2 1/4 2 3/8 2 7/16	9 27/32	5 1/2	1 7/8	7 61/64	21/32	23/32	1 9/64	2 23/32	2.563	1.000	9/16	UCFL212-36E UCFL212E UCFL212-38E UCFL212-39E	FL212E	UC212-36 UC212 UC212-38 UC212-39
		250	140	48	202	16.5	18	29	68.7	65.1	25.4				
65	2 1/2	10 5/32	6 3/32	1 31/32	8 17/64	21/32	25/32	1 3/16	2 3/4	2.563	1.000	9/16	UCFL213-40E UCFL213E	FL213E	UC213-40 UC213
		258	155	50	210	16.5	20	30	69.7	65.1	25.4				
70	2 3/4	10 7/16	6 5/16	2 1/8	8 1/2	21/32	25/32	1 7/32	2 31/32	2.937	1.189	9/16	UCFL214-44E UCFL214E	FL214E	UC214-44 UC214
		265	160	54	216	16.5	20	31	75.4	74.6	30.2				
75	2 15/16 3	10 13/16	6 1/2	2 7/32	8 55/64	3/4	25/32	1 11/32	3 3/32	3.063	1.311	11/16	UCFL215-47E UCFL215E UCFL215-48E	FL215E	UC215-47 UC215 UC215-48
		275	165	56	225	19	20	34	78.5	77.8	33.3				

Remarks 1. In Part No. of unit, fitting codes follow bore diameter numbers. (See Table 10.5 in P.62.)
2. Part No. of applicable grease fittings are shown below.
A-1/4-28UNF 201~210
A-R1/8..... 211~217



FYH

Variations of tolerance of distance from mounting surface to center of spherical bore (Δ_{A2s}) and tolerance of position of bolt hole (X)

Unit: mm		
Housing No.	Δ_{A2s}	X
FL203E~FL210E	± 0.5	0.7
FL211E~FL217E	± 0.8	1

Variations of tolerance of bolt hole diameter (Δ_{Dh})

Unit: mm	
Housing No.	Δ_{Dh}
FL203E~FL217E	± 0.2

	Basic Load Ratings kN		Factor	Mass
	C_r	C_{0r}	f_0	kg
				0.42
	12.8	6.65	13.2	0.4
				0.39
	12.8	6.65	13.2	0.48
	14.0	7.85	13.9	0.64
	19.5	11.3	13.9	0.93
	25.7	15.4	13.9	1.2
	29.1	17.8	14.0	1.6
	34.1	21.3	14.0	1.9
	35.1	23.3	14.4	2.2
	43.4	29.4	14.4	3.3
	52.4	36.2	14.4	4.2
	57.2	40.1	14.4	5.2
	62.2	44.1	14.5	5.7
	67.4	48.3	14.5	6.4

3. As for the triple seal type product (from 201 to 205 are the double seal type products), suffix code L3 (or L2) follows the Part No. of unit or bearing. (Example of Part No.: UCFL206EJL3, UC206L3)

4. For the dimensions and forms of applicable bearings, see the dimensional tables of ball bearing for unit.

5. Housings of nodular graphite cast iron are also available.



2-Bolt Flange Units

UCFL-E

Cylindrical bore (with set screws)

d 80 ~ 85 mm

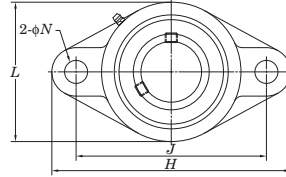
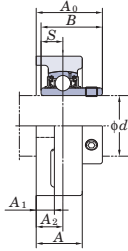

Shaft Dia.		Dimensions											Bolt Size	Unit No.	Housing No.	Bearing No.
mm	inch	inch mm														
<i>d</i>		<i>H</i>	<i>L</i>	<i>A</i>	<i>J</i>	<i>N</i>	<i>A</i> ₁	<i>A</i> ₂	<i>A</i> ₀	<i>B</i>	<i>S</i>					
80	3 1/8	11 13/32	7 3/32	2 9/32	9 11/64	3/4	25/32	1 11/32	3 9/32	3.252	1.311	11/16	UCFL216-50E UCFL216E	FL216E	UC216-50 UC216	
		290	180	58	233	19	20	34	83.3	82.6	33.3					
85	3 1/4	12	7 15/32	2 15/32	9 49/64	3/4	7/8	1 27/64	3 7/16	3.374	1.343	11/16	UCFL217-52E UCFL217E	FL217E	UC217-52 UC217	
		305	190	63	248	19	22	36	87.6	85.7	34.1					

- Remarks 1. In Part No. of unit, fitting codes follow bore diameter numbers. (See **Table 10.5** in P.62).
 2. Part No. of applicable grease fittings are shown below.
 A-1/4-28UNF 201~210
 A-R1/8..... 211~217



FYH

Variations of tolerance of distance from mounting surface to center of spherical bore (Δ_{A2s}) and tolerance of position of bolt hole (X)

Unit: mm

Housing No.	Δ_{A2s}	X
FL203E~FL210E	± 0.5	0.7
FL211E~FL217E	± 0.8	1

Variations of tolerance of bolt hole diameter (Δ_{N6})

Unit: mm

Housing No.	Δ_{N6}
FL203E~FL217E	± 0.2

	Basic Load Ratings kN		Factor	Mass
	C_r	C_{0r}	f_0	kg
	72.7	53.0	14.6	7.8
	84.0	61.9	14.5	9.8

- As for the triple seal type product (from 201 to 205 are the double seal type products), suffix code L3 (or L2) follows the Part No. of unit or bearing. (Example of Part No.: UCFL206EJL3, UC206L3)
- For the dimensions and forms of applicable bearings, see the dimensional tables of ball bearing for unit.
- Housings of nodular graphite cast iron are also available.



2-Bolt Flange Units

NANFL
Cylindrical bore
(with eccentric locking collar)
d 12 ~ 55 mm

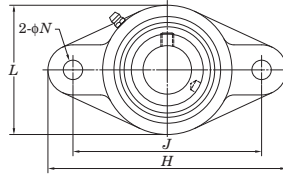
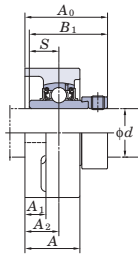

Shaft Dia		Dimensions										Bolt Size	Unit No.	Housing No.	Bearing No.
mm	inch	inch mm													
<i>d</i>		<i>H</i>	<i>L</i>	<i>A</i>	<i>J</i>	<i>N</i>	<i>A</i> ₁	<i>A</i> ₂	<i>A</i> ₀	<i>B</i> ₁	<i>S</i>	inch			
12	1/2											5/16	NANFL201		NA201
	15										NANFL201-8			NA201-8	
	17										NANFL202		NFL204	NA202	
15	5/8	47/16	2 3/8	1 5/32	3 17/32	25/64	7/16	3/4	1 25/32	1.720	0.673	5/16	NANFL202-10		NA202-10
	17	113	60	29.5	89.7	10	11	19	45.6	43.7	17.1		NANFL203		NA203
	20												NANFL204-12		NA204-12
20	3/4											3/8	NANFL204		NA204
	25												NANFL205-14	NFL205	NA205-14
	25												NANFL205-15		NA205-15
25	15/16	5 1/8	2 11/16	1 7/32	3 57/64	15/32	1/2	25/32	1 27/32	1.748	0.689	3/8	NANFL205		NA205
	1	130	68	31	98.8	12	13	20	46.9	44.4	17.5		NANFL205-16		NA205-16
	30												NANFL206-18	NFL206	NA206-18
30	1 1/8	5 13/16	3 5/32	1 11/32	4 19/32	15/32	1/2	53/64	2	1.906	0.720	3/8	NANFL206		NA206
	1 3/16	148	80	34	116.7	12	13	21	51.1	48.4	18.3		NANFL206-19		NA206-19
	1 1/4												NANFL206-20		NA206-20
35	1 1/4											7/16	NANFL207-20		NA207-20
	1 5/16	6 11/32	3 17/32	1 7/16	5 1/8	33/64	9/16	27/32	2 1/8	2.012	0.740		NANFL207-21	NFL207	NA207-21
	1 3/8	161	90	36.5	130.2	13	14	21.5	53.8	51.1	18.8		NANFL207-22		NA207-22
40	1 7/16											7/16	NANFL207		NA207
	40												NANFL207-23	NFL208	NA207-23
	40												NANFL208-24		NA208-24
40	1 1/2	6 7/8	3 15/16	1 17/32	5 21/32	33/64	9/16	15/16	2 5/16	2.217	0.843	7/16	NANFL208-24	NFL208	NA208-24
	1 9/16	175	100	39	143.7	13	14	24	58.9	56.3	21.4		NANFL208-25		NA208-25
	45												NANFL208		NA208
45	1 5/8											1/2	NANFL209-26	NFL209	NA209-26
	1 11/16	7 13/32	4 1/4	1 9/16	5 27/32	19/32	9/16	15/16	2 5/16	2.217	0.843		NANFL209-27		NA209-27
	1 3/4	188	108	40	148.4	15	14	24	58.9	56.3	21.4		NANFL209-28		NA209-28
50	1 3/4											1/2	NANFL209		NA209
	50												NANFL210-30	NFL210	NA210-30
	50												NANFL210-31		NA210-31
50	1 7/8	7 3/4	4 17/32	1 27/32	6 3/16	19/32	9/16	1 1/8	2 5/8	2.469	0.969	1/2	NANFL210		NA210
	1 15/16	197	115	46.5	157	15	14	28.5	66.6	62.7	24.6		NANFL210-32		NA210-32
	2												NANFL211-32	NFL211	NA211-32
55	2 1/8	8 13/16	5 1/8	1 31/32	7 1/4	21/32	25/32	1 17/64	2 31/32	2.811	1.094	9/16	NANFL211-34		NA211-34
	2	224	130	50	184	16.5	20	32	75.6	71.4	27.8		NANFL211		NA211
	2 3/16												NANFL211-35		NA211-35

Remarks 1. In Part No. of unit and units with covers, fitting codes follow bore diameter numbers. (See Table 10.5 in P62.)
2. Part No. of applicable grease fittings are shown below.
A-1/4-28UNF 201~210
A-R1/8..... 211



Variations of tolerance of distance from mounting surface to center of spherical bore (Δ_{A2s}) and tolerance of position of bolt hole (X)

Unit: mm

Housing No.	Δ_{A2s}	X
NFL204~NFL210	± 0.5	0.7
NFL211	± 0.8	1

Variations of tolerance of bolt hole diameter (Δ_{Dh})

Unit: mm

Housing No.	Δ_{Dh}
NFL204~NFL211	± 0.2

	Basic Load Ratings kN		Factor	Mass
	C_r	C_{0r}	f_0	kg
	12.8	6.65	13.2	0.59
	14.0	7.85	13.9	0.9
	19.5	11.3	13.9	1.1
	25.7	15.4	13.9	1.6
	29.1	17.8	14.0	2.0
	34.1	21.3	14.0	2.3
	35.1	23.3	14.4	2.7
	43.4	29.4	14.4	4.1

- 3. For the dimensions and forms of applicable bearings, see the dimensional tables of ball bearing for unit.
- 4. Housings of nodular graphite cast iron are also available.



2-Bolt Flange Units

NCFL
Cylindrical bore
(with concentric locking collar)
d 20 ~ 60 mm

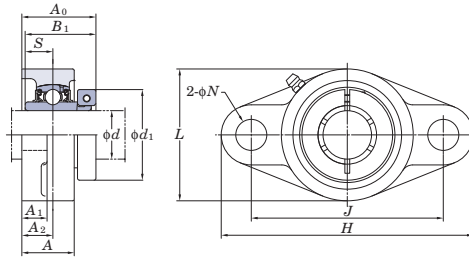

Shaft Dia. mm inch	Dimensions												Bolt Size inch mm	Unit No.	Housing No.	Bearing No.
	inch mm															
<i>d</i>	<i>H</i>	<i>L</i>	<i>A</i>	<i>J</i>	<i>N</i>	<i>A</i> ₁	<i>A</i> ₂	<i>A</i> ₀	<i>B</i> ₁	<i>S</i>	<i>d</i> ₁					
20 ^{3/4}	4 7/16	2 3/8	1	3 35/64	15/32	7/16	19/32	1 3/8	1 9/32	0.500	1 3/4	3/8	NCFL204-12 NCFL204	FL204	NC204-12 NC204	
	113	60	25.5	90	12	11	15	34.8	32.5	12.7	44.5	M10				
25 ^{7/8} ^{15/16}	5 1/8	2 11/16	1 1/16	3 57/64	5/8	1/2	5/8	1 1/2	1 7/16	0.563	1 15/16	1/2	NCFL205-14 NCFL205-15 NCFL205 NCFL205-16	FL205	NC205-14 NC205-15 NC205 NC205-16	
	130	68	27	99	16	13	16	38.2	36.5	14.3	49.2	M14				
30 ^{1 1/8} ^{1 3/16}	5 13/16	3 5/32	1 7/32	4 39/64	5/8	1/2	45/64	1 21/32	1 9/16	0.626	2 3/16	1/2	NCFL206-18 NCFL206 NCFL206-19 NCFL206-20	FL206	NC206-18 NC206 NC206-19 NC206-20	
	148	80	31	117	16	13	18	41.8	39.7	15.9	55.6	M14				
35 ^{1 1/4} ^{1 3/8}	6 11/32	3 17/32	1 11/32	5 1/8	5/8	9/16	3/4	1 13/16	1 3/4	0.689	2 7/16	1/2	NCFL207-20 NCFL207-22 NCFL207 NCFL207-23	FL207	NC207-20 NC207-22 NC207 NC207-23	
	161	90	34	130	16	14	19	46	44.5	17.5	61.9	M14				
40 ^{1 7/16}	6 7/8	3 15/16	1 13/32	5 43/64	5/8	9/16	53/64	2 3/32	2	0.748	2 11/16	1/2	NCFL208-24 NCFL208	FL208	NC208-24 NC208	
	175	100	36	144	16	14	21	52.8	50.8	19	68.3	M14				
45 ^{1 5/8} ^{1 11/16}	7 13/32	4 1/4	1 1/2	5 53/64	3/4	19/32	55/64	2 1/8	2	0.748	2 13/16	5/8	NCFL209-26 NCFL209-27 NCFL209-28 NCFL209	FL209	NC209-26 NC209-27 NC209-28 NC209	
	188	108	38	148	19	15	22	53.8	50.8	19	71.4	M16				
50 ^{1 3/4} ²	7 3/4	4 17/32	1 9/16	6 3/16	3/4	19/32	55/64	2 7/32	2 3/32	0.748	3 3/8	5/8	NCFL210-31 NCFL210 NCFL210-32	FL210	NC210-31 NC210 NC210-32	
	197	115	40	157	19	15	22	56.1	53.1	19	85.7	M16				
55 ^{2 3/16} ^{2 1/4}	8 13/16	5 1/8	1 11/16	7 1/4	3/4	23/32	63/64	2 11/32	2 1/4	0.874	3 1/2	5/8	NCFL211-32 NCFL211 NCFL211-35	FL211	NC211-32 NC211 NC211-35	
	224	130	43	184	19	18	25	59.9	57.1	22.2	88.9	M16				
60 ^{2 1/2} ^{2 7/16}	8 13/16	5 1/8	1 11/16	7 1/4	3/4	23/32	63/64	2 11/32	2 1/4	0.874	3 5/8	5/8	NCFL212-36 NCFL212 NCFL212-39	FL212	NC212-36 NC212 NC212-39	
	224	130	43	184	19	18	25	59.9	57.1	22.2	92.1	M16				
60 ^{2 1/4} ^{2 7/16}	9 27/32	5 1/2	1 7/8	7 61/64	29/32	23/32	1 9/64	2 25/32	2 5/8	1.000	4 1/16	3/4	NCFL212-36 NCFL212 NCFL212-39	FL212	NC212-36 NC212 NC212-39	
	250	140	48	202	23	18	29	70.3	66.7	25.4	103.2	M20				
60 ^{2 1/4} ^{2 7/16}	9 27/32	5 1/2	1 7/8	7 61/64	29/32	23/32	1 9/64	2 25/32	2 5/8	1.000	4 1/8	3/4	NCFL212 NCFL212-39	FL212	NC212 NC212-39	
	250	140	48	202	23	18	29	70.3	66.7	25.4	104.8	M20				

Remarks 1. In Part No. of unit, fitting codes follow bore diameter codes. (See **Table 10.5** in P.62.)
2. Part No. of applicable grease fittings are shown below.
A-1/4-28UNF 204~210
A-R1/8..... 211~212



FYH

Variations of tolerance of distance from mounting surface to center of spherical bore (Δ_{A2s}) and tolerance of position of bolt hole (X)

Unit: mm

Housing No.	Δ_{A2s}	X
FL204~FL210	± 0.5	0.7
FL211~FL212	± 0.8	1

Variations of tolerance of bolt hole diameter (Δ_{N6})

Unit: mm

Housing No.	Δ_{N6}
FL204~FL212	± 0.2

	Basic Load Ratings kN		Factor	Mass
	C_r	C_{0r}	f_0	kg
	12.8	6.65	13.2	0.62
	14.0	7.85	13.9	0.84
	19.5	11.3	13.9	1.1
	25.7	15.4	13.9	1.5
	25.7	15.4	13.9	1.5
	29.1	17.8	14.0	2.0
	34.1	21.3	14.0	2.3
	34.1	21.3	14.0	2.3
	35.1	23.3	14.4	2.8
	43.4	29.4	14.4	3.7
	43.4	29.4	14.4	3.7
	52.4	36.2	14.4	4.9
	52.4	36.2	14.4	4.9

- 3. For the dimensions and forms of applicable bearings, see the dimensional tables of ball bearing for unit.
- 4. Representative examples of the forms of housing are indicated.



2-Bolt Flange Units

NCFL-E
Cylindrical bore
(with concentric locking collar)
d 20 ~ 60 mm

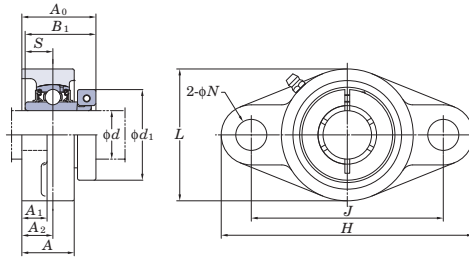

Shaft Dia.		Dimensions											Bolt Size	Unit No.	Housing No.	Bearing No.
mm	inch	inch mm														
d		H	L	A	J	N	A ₁	A ₂	A ₀	B ₁	S	d ₁	inch			
20	3/4	4 7/16	2 3/8	1	3 17/32	25/64	7/16	19/32	1 3/8	1 9/32	0.500	1 3/4	5/16	NCFL204-12E	FL204E	NC204-12 NC204
		113	60	25.5	89.7	10	11	15	34.8	32.5	12.7	44.5		NCFL204E		
25	7/8	5 1/8	2 11/16	1 1/16	3 57/64	15/32	1/2	5/8	1 1/2	1 7/16	0.563	1 15/16	3/8	NCFL205-14E	FL205E	NC205-14 NC205-15 NC205 NC205-16
		130	68	27	98.8	12	13	16	38.2	36.5	14.3	49.2				
30	1 1/8	5 13/16	3 5/32	1 7/32	4 19/32	15/32	1/2	45/64	1 21/32	1 9/16	0.626	2 3/16	3/8	NCFL206-18E	FL206E	NC206-18 NC206 NC206-19 NC206-20
		148	80	31	116.7	12	13	18	41.8	39.7	15.9	55.6				
35	1 1/4	6 11/32	3 17/32	1 11/32	5 1/8	33/64	9/16	3/4	1 13/16	1 3/4	0.689	2 7/16	7/16	NCFL207-20E	FL207E	NC207-20
		161	90	34	130.2	13	14	19	46	44.5	17.5	61.9				
35	1 3/8	6 11/32	3 17/32	1 11/32	5 1/8	33/64	9/16	3/4	1 13/16	1 3/4	0.689	2 9/16	7/16	NCFL207-22E	FL207E	NC207-22 NC207 NC207-23
		161	90	34	130.2	13	14	19	46	44.5	17.5	65.1				
40	1 1/2	6 7/8	3 15/16	1 13/32	5 21/32	33/64	9/16	53/64	2 3/32	2	0.748	2 11/16	7/16	NCFL208-24E	FL208E	NC208-24 NC208
		175	100	36	143.7	13	14	21	52.8	50.8	19	68.3				
45	1 5/8	7 13/32	4 1/4	1 1/2	5 27/32	19/32	19/32	55/64	2 1/8	2	0.748	2 13/16	1/2	NCFL209-26E	FL209E	NC209-26
		188	108	38	148.4	15	15	22	53.8	50.8	19	71.4				
45	1 11/16	7 13/32	4 1/4	1 1/2	5 27/32	19/32	19/32	55/64	2 1/8	2	0.748	2 15/16	1/2	NCFL209-27E	FL209E	NC209-27 NC209-28 NC209
		188	108	38	148.4	15	15	22	53.8	50.8	19	74.6				
50	1 15/16	7 3/4	4 17/32	1 9/16	6 3/16	19/32	19/32	55/64	2 7/32	2 3/32	0.748	3 3/8	1/2	NCFL210-31E	FL210E	NC210-31 NC210 NC210-32
		197	115	40	157	15	15	22	56.1	53.1	19	85.7				
55	2	8 13/16	5 1/8	1 11/16	7 1/4	21/32	23/32	63/64	2 11/32	2 1/4	0.874	3 1/2	9/16	NCFL211-32E	FL211E	NC211-32 NC211
		224	130	43	184	16.5	18	25	59.9	57.1	22.2	88.9				
60	2 3/16	8 13/16	5 1/8	1 11/16	7 1/4	21/32	23/32	63/64	2 11/32	2 1/4	0.874	3 5/8	9/16	NCFL211-35E	FL211E	NC211-35
		224	130	43	184	16.5	18	25	59.9	57.1	22.2	92.1				
60	2 1/4	9 27/32	5 1/2	1 7/8	7 61/64	21/32	23/32	1 9/64	2 25/32	2 5/8	1.000	4 1/16	9/16	NCFL212-36E	FL212E	NC212-36
		250	140	48	202	16.5	18	29	70.3	66.7	25.4	103.2				
60	2 7/16	9 27/32	5 1/2	1 7/8	7 61/64	21/32	23/32	1 9/64	2 25/32	2 5/8	1.000	4 1/8	9/16	NCFL212-39E	FL212E	NC212 NC212-39
		250	140	48	202	16.5	18	29	70.3	66.7	25.4	104.8				

Remarks 1. In Part No. of unit, fitting codes follow bore diameter codes. (See **Table 10.5** in P.62.)
2. Part No. of applicable grease fittings are shown below.
A-1/4-28UNF 204~210
A-R1/8..... 211~212



FYH

Variations of tolerance of distance from mounting surface to center of spherical bore (Δ_{A2s}) and tolerance of position of bolt hole (X)

Unit: mm		
Housing No.	Δ_{A2s}	X
FL204E~FL210E	± 0.5	0.7
FL211E~FL212E	± 0.8	1

Variations of tolerance of bolt hole diameter (Δ_{N6})

Unit: mm	
Housing No.	Δ_{N6}
FL204E~FL212E	± 0.2

	Basic Load Ratings kN		Factor	Mass
	C_r	C_{0r}	f_0	kg
	12.8	6.65	13.2	0.62
	14.0	7.85	13.9	0.84
	19.5	11.3	13.9	1.1
	25.7	15.4	13.9	1.5
	25.7	15.4	13.9	1.5
	29.1	17.8	14.0	2.0
	34.1	21.3	14.0	2.3
	34.1	21.3	14.0	2.3
	35.1	23.3	14.4	2.8
	43.4	29.4	14.4	3.7
	43.4	29.4	14.4	3.7
	52.4	36.2	14.4	4.9
	52.4	36.2	14.4	4.9

- 3. For the dimensions and forms of applicable bearings, see the dimensional tables of ball bearing for unit.
- 4. Representative examples of the forms of housing are indicated.



2-Bolt Flange Units

UKFL

Tapered bore (with adapter)

d_1 20 ~ 50 mm

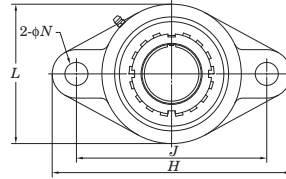
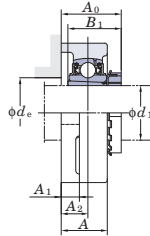

Shaft Dia. mm inch	d_1	Dimensions inch mm										Bolt Size inch mm	Standard		
		H	L	A	J	N	A ₁	A ₂	A ₀	B ₁	d_e (min.)		Unit No.	Housing No.	Bearing No.
20	3/4	5 1/8	2 11/16	1 1/16	3 57/64	5/8	1/2	5/8	1 13/32	1 3/8	1 3/16	1/2	UKFL205	FL205	UK205
		130	68	27	99	16	13	16	36	35	30	M14	UKFLX05	FLX05	UKX05
	3/4	5 9/16	3 3/32	1 3/16	4 39/64	15/32	1/2	45/64	1 9/16	1 3/8	1 3/16	3/8	UKFL305	FL305	UK305
25	1	5 29/32	3 5/32	1 5/32	4 29/64	3/4	1/2	5/8	1 15/32	1 3/8	—	5/8	UKFL206	FL206	UK206
		150	80	29	113	19	13	16	37.5	35	—	M16	UKFLX06	FLX06	UKX06
	1	5 13/16	3 5/32	1 7/32	4 39/64	5/8	1/2	45/64	1 9/16	1 1/2	1 13/32	3/8	UKFL306	FL306	UK306
30	1 1/8	6 11/32	3 17/32	1 11/32	5 1/8	5/8	9/16	3/4	1 11/16	1 5/8	1 5/8	3/8	UKFL207	FL207	UK207
		161	90	34	130	16	14	19	43	43	41	M14	UKFLX07	FLX07	UKX07
	1 1/8	6 23/32	4 1/8	1 1/2	5 3/64	5/8	9/16	53/64	1 27/32	1 11/16	1 5/8	3/8	UKFL307	FL307	UK307
35	1 1/4	7 9/32	3 15/16	1 13/32	5 3/64	5/8	9/16	25/32	1 25/32	1 11/16	—	3/4	UKFL208	FL208	UK208
		175	100	36	144	16	14	21	48	46	46	M14	UKFLX08	FLX08	UKX08
	1 3/8	7 1/16	4 3/8	1 9/16	5 53/64	5/8	9/16	55/64	1 31/32	1 13/16	1 13/16	3/8	UKFL308	FL308	UK308
40	1 1/2	7 7/8	4 13/32	1 9/16	6 7/32	29/32	21/32	29/32	2	1 13/16	—	3/4	UKFL209	FL209	UK209
		188	108	38	148	19	15	22	51	50	52	M16	UKFLX09	FLX09	UKX09
	1 1/2	7 7/16	4 9/16	1 9/16	6 3/16	5/8	9/16	29/32	2 1/16	1 31/32	2 1/16	3/8	UKFL309	FL309	UK309
45	1 3/4	9 1/16	4 29/32	1 23/32	6 31/32	63/64	23/32	63/64	2 5/32	1 31/32	—	7/8	UKFL210	FL210	UK210
		230	125	44	177	25	18	25	55	50	—	M22	UKFLX10	FLX10	UKX10
	1 3/4	7 3/4	4 17/32	1 9/16	6 3/16	3/4	19/32	55/64	2 1/16	2 5/32	2 9/32	5/8	UKFL310	FL310	UK310
50	2	8 1/2	5 1/4	1 23/32	7 1/4	3/4	25/32	1 1/32	2 9/32	2 5/32	2 9/32	5/8	UKFL211	FL211	UK211
		216	133	44	184	19	20	26	58	55	58	M16	UKFLX11	FLX11	UKX11
	1 7/8	9 27/32	5 29/32	2 1/16	7 51/64	63/64	25/32	1 3/16	2 17/32	2 5/16	—	7/8	UKFL311	FL311	UK311

Remarks
 1. In Part No. of unit and units with covers, fitting codes follow bore diameter numbers. (See Table 10.5 in P.62.)
 2. Part No. of applicable grease fittings are shown below.
 A-1/4-28UNF 205~210, X05~X09, 305~308
 A-R1/8..... 211~218, X10, 309~324

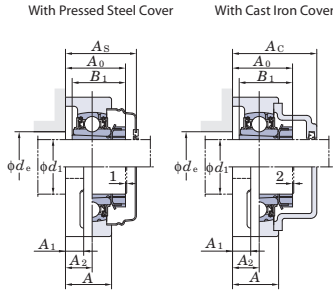

Variations of tolerance of distance from mounting surface to center of spherical bore (ΔA_{2a}) and tolerance of position of bolt hole (X)

Housing No.		ΔA_{2a}	X
FL205~FL210	FLX05~FLX10	±0.5	0.7
FL211~FL218	FL305~FL310	±0.8	1

Housing No.		ΔV_b
FL205~FL218	FLX05~FLX10	±0.2
	FL312~FL324	±0.3

Forms and dimensions of L_c of FL205JE3 (housing with cast iron cover) are shown below.

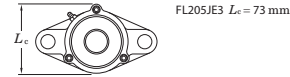

Adapter No.	Mass kg	Basic Load Ratings kN		Factor f_0	With Pressed Steel Cover				With Cast Iron Cover					
		C_r	C_{0r}		Unit No.		Dimension mm	Mass kg	Unit No.		Dimension mm	Mass kg		
					Open Type	Closed Type			Open Type	Closed Type				
HE2305X	0.68	14.0	7.85	13.9	—	—	—	—	—	—	—	—	—	
H2305X	0.68				UKFL205C	UKFL205D	40.5	1 19/32	0.68	UKFL205FC	UKFL205FD	49	1 15/16	0.89
HE2305X	1.0	19.5	11.3	13.9	—	—	—	—	—	—	—	—	—	
H2305X	1.0				UKFLX05C	UKFLX05D	44.5	1 3/4	1.0	—	—	—	—	—
HE2305X	1.1	21.2	10.9	12.6	—	—	—	—	—	—	—	—	—	
H2305X	1.1				—	—	—	—	—	UKFL305C	UKFL305D	54	2 1/8	1.4
H2306X	0.97	19.5	11.3	13.9	UKFL206C	UKFL206D	44.5	1 3/4	0.97	UKFL206FC	UKFL206FD	53	2 3/32	1.2
HE2306X	0.97				—	—	—	—	—	—	—	—	—	—
H2306X	1.5	25.7	15.4	13.9	UKFLX06C	UKFLX06D	49	1 15/16	1.5	—	—	—	—	—
HE2306X	1.5				—	—	—	—	—	—	—	—	—	—
H2306X	1.5	26.7	15.0	13.3	—	—	—	—	—	UKFL306C	UKFL306D	59	2 5/16	1.8
HE2306X	1.5				—	—	—	—	—	—	—	—	—	—
HS2307X	1.3	25.7	15.4	13.9	—	—	—	—	—	—	—	—	—	—
H2307X	1.3				UKFL207C	UKFL207D	49	1 15/16	1.3	UKFL207FC	UKFL207FD	58	2 9/32	1.7
HS2307X	1.8	29.1	17.8	14.0	—	—	—	—	—	—	—	—	—	—
H2307X	1.8				UKFLX07C	UKFLX07D	55.5	2 3/16	1.8	—	—	—	—	—
HS2307X	1.9	33.4	19.3	13.2	—	—	—	—	—	—	—	—	—	—
H2307X	1.9				—	—	—	—	—	UKFL307C	UKFL307D	64	2 17/32	2.4
HE2308X	1.6	29.1	17.8	14.0	—	—	—	—	—	—	—	—	—	—
HS2308X	1.6				—	—	—	—	—	—	—	—	—	—
H2308X	1.6	34.1	21.3	14.0	UKFL208C	UKFL208D	55.5	2 3/16	1.6	UKFL208FC	UKFL208FD	64	2 17/32	2.0
HE2308X	2.1				—	—	—	—	—	—	—	—	—	—
HS2308X	2.1	40.7	24.0	13.2	—	—	—	—	—	—	—	—	—	—
H2308X	2.1				UKFLX08C	UKFLX08D	56.5	2 7/32	2.1	—	—	—	—	—
HE2308X	2.5	40.7	24.0	13.2	—	—	—	—	—	—	—	—	—	—
HS2308X	2.5				—	—	—	—	—	UKFL308C	UKFL308D	71	2 25/32	3.0
H2308X	2.5	—	—	—	—	—	—	—	—	—	—	—	—	
HE2309X	2.0	34.1	21.3	14.0	—	—	—	—	—	—	—	—	—	—
H2309X	2.0				UKFL209C	UKFL209D	56.5	2 7/32	2.0	UKFL209FC	UKFL209FD	66	2 19/32	2.5
HE2309X	2.5	35.1	23.3	14.4	—	—	—	—	—	—	—	—	—	—
H2309X	2.5				UKFLX09C	UKFLX09D	60	2 3/8	2.5	—	—	—	—	—
HE2309X	3.6	48.9	29.5	13.3	—	—	—	—	—	—	—	—	—	—
H2309X	3.6				—	—	—	—	—	UKFL309C	UKFL309D	76	3	4.2
HE2310X	2.3	35.1	23.3	14.4	—	—	—	—	—	—	—	—	—	—
H2310X	2.3				UKFL210C	UKFL210D	59	2 3/16	2.3	UKFL210FC	UKFL210FD	70.5	2 25/32	2.8
HE2310X	3.7	43.4	29.4	14.4	—	—	—	—	—	—	—	—	—	—
H2310X	3.7				UKFLX10C	UKFLX10D	64	2 17/32	3.7	—	—	—	—	—
HE2310X	4.4	62.0	38.3	13.2	—	—	—	—	—	—	—	—	—	—
H2310X	4.4				—	—	—	—	—	UKFL310C	UKFL310D	83	3 9/32	5.2
HS2311X	3.3	43.4	29.4	14.4	—	—	—	—	—	—	—	—	—	—
H2311X	3.3				UKFL211C	UKFL211D	63	2 15/32	3.3	UKFL211FC	UKFL211FD	74.5	2 15/16	3.9
HE2311X	3.3	71.6	45.0	13.2	—	—	—	—	—	—	—	—	—	—
HS2311X	5.6				—	—	—	—	—	—	—	—	—	—
H2311X	5.6	—	—	—	—	—	—	—	—	—	—	—	—	
HE2311X	5.6	—	—	—	—	—	—	—	—	—	—	—	—	

- In Part No. of unit with adapters and bearing with adapters, Part No. of applicable adapter follow the Part No. shown in the dimensional tables. (Example of Part No. : UKFL206J + H2306X, UK206 + H2306X)
- As for the triple seal type product (205 is the double seal type product), suffix code L3 (or L2) follows the Part No. of unit or bearing. (Example of Part No. : UKFL206JL3 + H2306X, UK206L3 + H2306X)
- For the dimensions and forms of applicable bearings and adapters, see the dimensional tables of ball bearing for unit and adapter.
- Housings of nodular graphite cast iron are also available.



2-Bolt Flange Units

UKFL

Tapered bore (with adapter)

d_1 55 ~ 110 mm

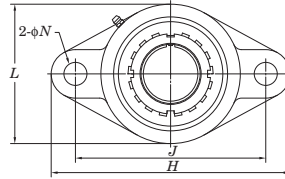
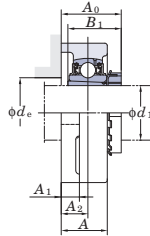

Shaft Dia. mm inch	d_1	Dimensions inch mm										Bolt Size inch mm	Standard		
		H	L	A	J	N	A ₁	A ₂	A ₀	B ₁	d_e (min.)		Unit No.	Housing No.	Bearing No.
55	2 1/8	9 27/32	5 1/2	1 7/8	7 61/64	29/32	23/32	1 9/64	2 19/32	2 7/16	2 23/32	3/4	UKFL212	FL212	UK212
	2 1/8	10 3/8	6 5/16	2 7/32	8 11/32	1 7/32	7/8	1 19/64	2 3/4	2 7/16	-	1	UKFL312	FL312	UK312
60	2 1/4	10 5/32	6 3/32	1 31/32	8 17/64	29/32	25/32	1 3/16	2 21/32	2 9/16	2 29/32	3/4	UKFL213	FL213	UK213
	2 3/8	258	155	50	210	23	20	30	67.5	65	74	M20			
	2 1/4	11 5/8	6 7/8	2 9/32	9 29/64	1 7/32	31/32	1 19/64	2 13/16	2 9/16	-	1	UKFL313	FL313	UK313
65	2 3/8	295	175	58	240	31	25	33	71.5	65	-	M27			
	2 1/2	10 13/16	6 1/2	2 7/32	8 55/64	29/32	25/32	1 11/32	2 15/16	2 7/8	3 11/32	3/4	UKFL215	FL215	UK215
70	2 1/2	12 19/32	7 11/16	2 19/32	10 15/64	1 3/8	1 3/16	1 17/32	2 7/32	2 7/8	-	1 1/8	UKFL315	FL315	UK315
	2 3/4	320	195	66	260	35	30	39	81.5	73	-	M30			
75	2 3/4	11 13/32	7 3/32	2 9/32	9 11/64	63/64	25/32	1 11/32	3 3/32	3 1/16	3 17/32	7/8	UKFL216	FL216	UK216
	2 3/4	290	180	58	233	25	20	34	78.5	78	90	M22			
	2 3/4	13 31/32	8 9/32	2 11/16	11 7/32	1 1/2	1 1/4	1 1/2	3 1/4	3 1/16	-	1 1/4	UKFL316	FL316	UK316
80	3	355	210	68	285	38	32	38	82.5	78	-	M33			
	3	12	7 15/32	2 15/32	9 49/64	63/64	7/8	1 27/64	3 1/4	3 7/32	3 29/32	7/8	UKFL217	FL217	UK217
	3	305	190	63	248	25	22	36	82.5	82	96	M22			
85	3	14 9/16	8 21/32	2 29/32	11 13/16	1 1/2	1 1/4	1 47/64	3 5/8	3 7/32	-	1 1/4	UKFL317	FL317	UK317
	3	370	220	74	300	38	32	44	92	82	-	M33			
	3	12 19/32	8 1/16	2 11/16	10 7/16	63/64	29/32	1 37/64	3 17/32	3 3/8	4 1/32	7/8	UKFL218	FL218	UK218
90	3 1/8	320	205	68	265	25	23	40	89.5	86	102	M22			
	3 1/2	15 5/32	9 1/4	3	12 13/32	1 1/2	1 13/32	1 47/64	3 5/8	3 3/8	-	1 1/4	UKFL318	FL318	UK318
95	3 1/4	385	235	76	315	38	36	44	92	86	-	M33			
	3 1/4	15 15/16	9 27/32	3 11/16	13	1 39/64	1 9/16	2 21/64	4 3/8	3 17/32	-	1 3/8	UKFL319	FL319	UK319
100	3 1/2	405	250	94	330	41	40	59	111	90	-	M36			
	3 1/2	17 5/16	10 5/8	3 11/16	14 11/64	1 47/64	1 9/16	2 21/64	4 7/16	3 13/16	-	1 1/2	UKFL320	FL320	UK320
105	4	440	270	94	360	44	40	59	113	97	-	M39			
	4	18 1/2	11 13/16	3 25/32	15 23/64	1 47/64	1 21/32	2 23/64	4 23/32	4 1/8	-	1 1/2	UKFL322	FL322	UK322
110	4	470	300	96	390	44	42	60	120	105	-	M39			
	4	20 15/32	13	4 11/32	16 59/64	1 27/32	1 7/8	2 9/16	5 1/8	4 13/32	-	1 5/8	UKFL324	FL324	UK324

- Remarks
- In Part No. of unit and units with covers, fitting codes follow bore diameter numbers. (See Table 10.5 in P.62)
 - Part No. of applicable grease fittings are shown below.
A-1/4-28UNF 205~210, X05~X09, 305~308
A-R1/8 211~218, X10, 309~324

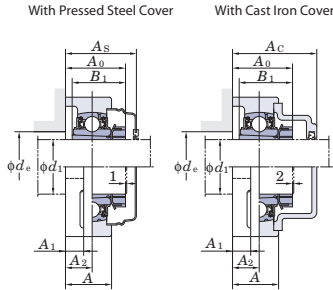

Variations of tolerance of distance from mounting surface to center of spherical bore (ΔA_{2s}) and tolerance of position of bolt hole (X)

Housing No.		ΔA_{2s}	X
FL205~FL210	FLX05~FLX10	±0.5	0.7
FL211~FL218	FL305~FL310	±0.8	1

Housing No.		ΔV_b
FL205~FL218	FLX05~FLX10	±0.2
	FL312~FL324	±0.3

Forms and dimensions of L_c of FL205JE3 (housing with cast iron cover) are shown below.

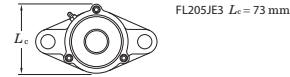

Adapter No.	Mass kg	Basic Load Ratings kN		Factor f_0	With Pressed Steel Cover				With Cast Iron Cover						
		C_r	C_{Or}		Unit No.		Dimension mm inch		Mass kg	Unit No.		Dimension mm inch		Mass kg	
					Open Type	Closed Type	A_s			Open Type	Closed Type	A_c			
HS2312X	4.1	52.4	36.2	14.4	-	-	-	-	-	-	-	-	-	-	-
H2312X	4.1	81.9	52.2	13.2	UKFL212C	UKFL212D	73.5	2 ^{29/32}	4.1	UKFL212FC	UKFL212FD	86	3 ^{3/8}	4.9	-
HS2312X	6.9	-	-	-	-	-	-	-	-	-	-	-	-	-	-
H2312X	6.9	-	-	-	-	-	-	-	-	UKFL312C	UKFL312D	95	3 ^{3/8}	8.1	-
HE2313X	5.0	57.2	40.1	14.4	UKFL213C	UKFL213D	74.5	2 ^{15/16}	5.0	UKFL213FC	UKFL213FD	87	3 ^{7/16}	5.9	-
H2313X	5.0	-	-	-	-	-	-	-	-	-	-	-	-	-	-
HS2313X	5.0	-	-	-	-	-	-	-	-	-	-	-	-	-	-
HE2313X	8.6	92.7	59.9	13.2	-	-	-	-	-	UKFL313C	UKFL313D	94	3 ^{11/16}	9.7	-
H2313X	8.6	-	-	-	-	-	-	-	-	-	-	-	-	-	-
HS2313X	8.6	-	-	-	-	-	-	-	-	-	-	-	-	-	-
HE2315X	6.6	67.4	48.3	14.5	UKFL215C	UKFL215D	83.5	3 ^{9/32}	6.6	UKFL215FC	UKFL215FD	96	3 ^{25/32}	7.6	-
H2315X	6.6	-	-	-	-	-	-	-	-	-	-	-	-	-	-
HE2315X	11.4	113	77.2	13.2	-	-	-	-	-	UKFL315C	UKFL315D	106	4 ^{3/16}	12.8	-
H2315X	11.4	-	-	-	-	-	-	-	-	-	-	-	-	-	-
HE2316X	8.1	72.7	53.0	14.6	UKFL216C	UKFL216D	88.5	3 ^{15/32}	8.1	UKFL216FC	UKFL216FD	103	4 ^{1/16}	9.4	-
H2316X	8.1	-	-	-	-	-	-	-	-	-	-	-	-	-	-
HE2316X	13.9	123	86.7	13.3	-	-	-	-	-	UKFL316C	UKFL316D	107	4 ^{7/32}	15.5	-
H2316X	13.9	-	-	-	-	-	-	-	-	UKFL217FC	UKFL217FD	107	4 ^{7/32}	11.3	-
H2317X	9.9	84.0	61.9	14.5	UKFL217C	UKFL217D	92.5	3 ^{21/32}	9.9	-	-	-	-	-	-
HE2317X	9.9	-	-	-	-	-	-	-	-	-	-	-	-	-	-
H2317X	15.8	133	96.8	13.3	-	-	-	-	-	UKFL317C	UKFL317D	117	4 ^{19/32}	17.6	-
HE2317X	15.8	-	-	-	-	-	-	-	-	-	-	-	-	-	-
H2318X	12.2	96.1	71.5	14.5	UKFL218C	UKFL218D	101.5	4	12.2	UKFL218FC	UKFL218FD	116	4 ^{9/16}	13.8	-
H2318X	19.1	143	107	13.3	-	-	-	-	-	UKFL318C	UKFL318D	119	4 ^{11/16}	21.2	-
HE2319X	24.9	153	119	13.3	-	-	-	-	-	-	-	-	-	-	-
H2319X	24.9	-	-	-	-	-	-	-	-	UKFL319C	UKFL319D	140	5 ^{1/2}	27.3	-
HE2320X	29.0	173	141	13.2	-	-	-	-	-	-	-	-	-	-	-
H2320X	29.0	-	-	-	-	-	-	-	-	UKFL320C	UKFL320D	146	5 ^{3/4}	32.1	-
H2322X	36.1	205	180	13.2	-	-	-	-	-	UKFL322C	UKFL322D	154	6 ^{1/16}	39.6	-
HE2322X	36.1	-	-	-	-	-	-	-	-	-	-	-	-	-	-
H2324	51.9	207	185	13.5	-	-	-	-	-	UKFL324C	UKFL324D	163	6 ^{13/32}	57.0	-

- In Part No. of unit with adapters and bearing with adapters, Part No. of applicable adapter follow the Part No. shown in the dimensional tables. (Example of Part No. : UKFL206J + H2306X, UK206 + H2306X)
- As for the triple seal type product (205 is the double seal type product), suffix code L3 (or L2) follows the Part No. of unit or bearing. (Example of Part No. : UKFL206JL3 + H2306X, UK206L3 + H2306X)
- For the dimensions and forms of applicable bearings and adapters, see the dimensional tables of ball bearing for unit and adapter.
- Housings of nodular graphite cast iron are also available.



Adjustable 2-Bolt Flange Units

UCFA
Cylindrical bore (with set screws)
d 12 ~ 55 mm

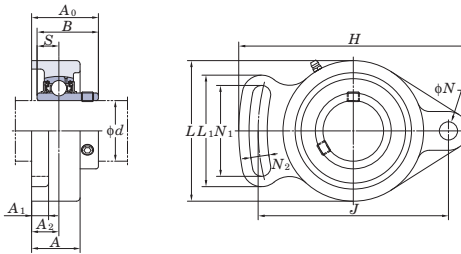

Shaft Dia. mm inch	Dimensions														Bolt Size inch mm	Unit No.	Housing No.	Bearing No.		
	H	L	A	J	N	N ₁	N ₂	L ₁	A ₁	A ₂	A ₀	B	S	inch mm						
12																				
15	1/2																			
17	5/8	3 27/32	2 5/16	1 5/16	3 5/64	2 5/64	1 9/16	1 3/32	1 31/32	7/16	3 5/64	1 1/4	1.220	0.500	5/16		FA204	UC201	UC201-8	
20	3/4	98	59	24	78	10	40	10	50	11	13.8	32.1	31	12.7	M8			UC202	UC202-10	
																			UC203	UC204-12
																			UC204	UC204
25	7/8																			
	1 5/16	4 7/8	2 3/4	1 1/16	3 55/64	7/16	1 15/16	7/16	2 17/32	1/2	5/8	1 13/32	1.343	0.563	3/8		FA205	UC205-14	UC205-14	
	1	124	70	27	98	11	49	11	64	13	16	35.8	34.1	14.3	M10			UC205-15	UC205-15	
																			UC205	UC205-16
30	1 1/8																			
	1 3/16	5 9/16	3 9/32	1 3/16	4 39/64	7/16	2 7/32	1 5/32	2 11/16	1/2	4 5/64	1 9/16	1.500	0.626	3/8		FA206	UC206-18	UC206-18	
	1 1/4	141	83	30	117	11	56	12	68	13	17.8	40	38.1	15.9	M10			UC206	UC206-19	
																			UC206-19	UC206-20
35	1 1/4																			
	1 5/16	6 3/32	3 25/32	1 11/32	5 1/8	3 3/64	2 15/32	1/2	2 15/16	9/16	4 7/64	1 23/32	1.689	0.689	7/16		FA207	UC207-20	UC207-20	
	1 3/8	155	96	34	130	13	63	13	75	14	18.6	44	42.9	17.5	M12			UC207-21	UC207-21	
																			UC207-22	UC207-22
																			UC207	UC207-23
40	1 1/2																			
	1 9/16	6 23/32	4 1/8	1 1/2	5 43/64	3 3/64	2 3/4	1/2	3 5/16	9/16	1 3/16	2	1.937	0.748	7/16		FA208	UC208-24	UC208-24	
		171	105	38	144	13	70	13	84	14	20.8	51	49.2	19	M12			UC208-25	UC208-25	
																			UC208	UC208
45	1 5/8																			
	1 11/16	7 1/16	4 3/8	1 9/16	5 53/64	1 9/32	2 27/32	1 9/32	3 15/32	9/16	5 5/64	2 1/16	1.937	0.748	1/2		FA209	UC209-26	UC209-26	
	1 3/4	179	111	40	148	15	72	15	88	14	21.8	52	49.2	19	M14			UC209-27	UC209-27	
																			UC209-28	UC209-28
																			UC209	UC209
50	1 7/8																			
	1 15/16	7 7/16	4 9/16	1 9/16	6 3/16	1 9/32	2 15/16	1 9/32	3 5/8	9/16	5 7/64	2 5/32	2.031	0.748	1/2		FA210	UC210-30	UC210-30	
		189	116	40	157	15	75	15	92	14	22.5	55.1	51.6	19	M14			UC210-31	UC210-31	
																			UC210	UC210-32
55	2																			
	2 1/8	8 1/2	5 1/4	1 23/32	7 1/4	5/8	3 3/8	5/8	4 1/32	2 5/32	1 1/64	2 5/16	2.189	0.874	1/2		FA211	UC211-32	UC211-32	
		216	133	44	184	16	86	16	102	20	25.7	59.1	55.6	22.2	M14			UC211-34	UC211-34	
																			UC211	UC211-35

Remarks 1. In Part No. of unit and units with covers, fitting codes follow bore diameter numbers. (See Table 10.5 in P.62.)
2. Part No. of applicable grease fittings are shown below.
A-1/4-28UNF 201~210
A-R1/8..... 211



FYH

Variations of tolerance of distance from mounting surface to center of spherical bore (ΔA_{2s})

Unit: mm

Housing No.	ΔA_{2s}
FA204~FA210	± 0.5
FA211	± 0.8

Variations of tolerance of bolt hole diameter (ΔD_h)

Unit: mm

Housing No.	ΔD_h
FA204~FA211	± 0.2

	Basic Load Ratings kN		Factor	Mass
	C_r	C_{0r}	f_0	kg
				0.47
	12.8	6.65	13.2	0.45
				0.44
				0.42
	14.0	7.85	13.9	0.68
	19.5	11.3	13.9	1.0
	25.7	15.4	13.9	1.5
	29.1	17.8	14	1.9
	34.1	21.3	14	1.7
	35.1	23.3	14.4	2.0
	43.4	29.4	14.4	3.6

3. As for triple seal type product (from 201 to 205 are the double seal type products), suffix code L3 (or L2) follows Part No. of unit or bearing. (Example of Part No. : UCFA206JL3, UC206L3)

4. For the dimensions and forms of applicable bearings, see the dimensional tables of ball bearing for unit.

5. Tapered bore (with adapter) type products are also available. (Example of Part No. : UKFA205J + H2305X, UK205 + H2305X)



3-Bolt Flange Units

UCFB
Cylindrical bore (with set screws)
d 12 ~ 50 mm

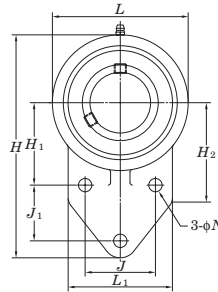
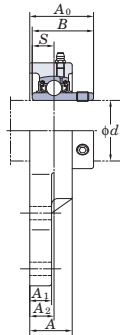

Shaft Dia.		Dimensions															Bolt Size	Unit No.	Housing No.
mm	inch	inch mm																	
<i>d</i>		<i>H</i>	<i>L</i>	<i>A</i>	<i>J</i>	<i>J</i> ₁	<i>N</i>	<i>H</i> ₁	<i>H</i> ₂	<i>L</i> ₁	<i>A</i> ₁	<i>A</i> ₂	<i>A</i> ₀	<i>B</i>	<i>S</i>	inch			
12	1/2																5/16 M8	UCFB201 UCFB201-8 UCFB202 UCFB202-10 UCFB203 UCFB204-12 UCFB204	FB204
	15	4 11/32	2 7/16	15/16	1 17/64	1 1/16	3/8	1 21/32	2 1/16	2 1/16	1/2	17/32	1 1/4	1.220	0.500				
	17	110	62	24.5	32	27	9.5	42	52	52	13	13.5	31.8	31	12.7				
20	3/4															5/16 M8	UCFB205-14 UCFB205-15 UCFB205 UCFB205-16	FB205	
	25	4 9/16	2 11/16	1 1/16	1 11/32	1 1/16	3/8	1 49/64	2 1/16	2 7/32	1/2	19/32	1 3/8	1.343	0.563				
	7/8	116	68	27	34	27	9.5	45	52	56	13	15	34.8	34.1	14.3				
30	1 1/8															5/16 M8	UCFB206-18 UCFB206 UCFB206-19 UCFB206-20	FB206	
	1 3/16	5 1/8	3 1/16	1 3/16	1 37/64	1 9/64	3/8	1 31/32	2 5/32	2 9/16	1/2	43/64	1 17/32	1.500	0.626				
	1 1/4	130	78	30	40	29	9.5	50	55	65	13	17	39.2	38.1	15.9				
35	1 1/4															5/16 M8	UCFB207-20 UCFB207-21 UCFB207-22 UCFB207 UCFB207-23	FB207	
	1 5/16	5 21/32	3 17/32	1 5/16	1 13/16	1 17/64	3/8	2 11/64	2 7/16	2 3/4	19/32	3/4	1 3/4	1.689	0.689				
	1 3/8	144	90	33.5	46	32	9.5	55	62	70	15	19	44.4	42.9	17.5				
	1 7/16															3/8 M10	UCFB208-24 UCFB208-25 UCFB208	FB208	
40	6 15/32	3 15/16	1 3/8	1 31/32	1 39/64	7/16	2 23/64	2 27/32	3 1/16	5/8	25/32	1 31/32	1.937	0.748					
	1 1/2	164	100	35	50	41	11	60	72	78	16	20	50.2	49.2	19				
45	1 5/8															3/8 M10	UCFB209-26 UCFB209-27 UCFB209-28 UCFB209	FB209	
	1 11/16	6 27/32	4 3/16	1 3/8	2 1/8	1 11/16	7/16	2 9/16	3	3 5/32	23/32	25/32	1 31/32	1.937	0.748				
	1 3/4	174	106	35.5	54	43	11	65	76	80	18	20	50.2	49.2	19				
50	1 7/8															3/8 M10	UCFB210-30 UCFB210-31 UCFB210 UCFB210-32	FB210	
	1 15/16	7 1/4	4 13/32	1 7/16	2 9/32	1 13/16	7/16	2 43/64	3 7/32	3 3/8	23/32	25/32	2 1/16	2.031	0.748				
	2	184	112	36	58	46	11	68	82	86	18	20	52.6	51.6	19				

Remarks 1. In Part No. of unit and units with covers, fitting codes follow bore diameter codes. (See Table 10.5 in P62.)
 2. Part No. of applicable grease fitting is A-1/4-28UNF.
 3. As for the triple seal type product (from 201 to 205 are the double seal type products), suffix code L3 (or L2) follows Part No. of unit or bearing.
 (Example of Part No. : UCFB206JL3, UC206L3)



FYH

Variations of tolerance of distance from mounting surface to center of spherical bore (ΔA_{2s}), variations of tolerance of distance between centers of bolt holes ($\Delta J_s, \Delta J_{1s}$), variations of tolerance of distance between both grooves (ΔH_{1s})

Unit: mm

Housing No.	ΔA_{2s}	ΔJ_s	ΔJ_{1s}	ΔH_{1s}
FB204-FB210				± 0.5

Variations of tolerance of bolt hole diameter (ΔN_s)

Unit: mm

Housing No.	ΔN_s
FB204-FB210	± 0.2

Bearing No.	Basic Load Ratings kN		Factor f_0	Mass kg
	C_r	C_{0r}		
UC201				0.64
UC201-8				
UC202				0.62
UC202-10	12.8	6.65	13.2	
UC203				0.61
UC204-12				
UC204				0.59
UC205-14				
UC205-15	14.0	7.85	13.9	0.68
UC205				
UC205-16				
UC206-18				
UC206	19.5	11.3	13.9	0.92
UC206-19				
UC206-20				
UC207-20				
UC207-21				
UC207-22	25.7	15.4	13.9	1.3
UC207				
UC207-23				
UC208-24				
UC208-25	29.1	17.8	14.0	1.8
UC208				
UC209-26				
UC209-27	34.1	21.3	14.0	2.0
UC209-28				
UC209				
UC210-30				
UC210-31	35.1	23.3	14.4	2.3
UC210				
UC210-32				

4. For the dimensions and forms of applicable bearings, see the dimensional tables of ball bearing for unit.

5. Tapered bore (with adapter) type products are also available. (Example of Part No. : UKFB205J + H2305X, UK205 + H2305X)



Narrow Inner Ring Bearing 2-Bolt Flange Units

SBFL-RKP8
Cylindrical bore
(with set screws)
d 20 ~ 55 mm

SAFL-FP9
Cylindrical bore
(with eccentric locking collar)



SBFL-RKP8



SAFL-FP9

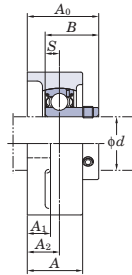

SBFL-RKP8

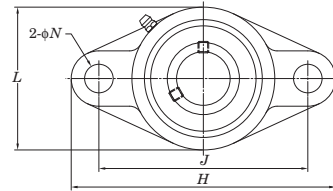

Shaft Dia. mm inch	Dimensions inch mm											SBFL-RKP8 S	SAFL-FP9 S	Bolt Size inch mm
	<i>d</i>	<i>H</i>	<i>L</i>	<i>A</i>	<i>J</i>	<i>N</i>	<i>A</i> ₁	<i>A</i> ₂	<i>A</i> ₀	<i>B</i>	<i>B</i> ₁			
20 3/4	4 7/16	2 3/8	1	3 35/64	15/32	7/16	19/32	1 17/32	0.984	1.220	0.276	0.295	3/8	
	113	60	25.5	90	12	11	15	38.5	25	31	7	7.5	M10	
25 7/8 1 15/16	5 1/8	2 11/16	1 1/16	3 57/64	5/8	1/2	5/8	1 18/32	1.063	1.220	0.295	0.295	1/2	
	130	68	27	99	16	13	16	39.5	27	31	7.5	7.5	M14	
30 1 1/8 1 3/16 1 1/4	5 13/16	3 5/32	1 7/32	4 39/64	5/8	1/2	45/64	1 24/32	1.181	1.906	0.315	0.354	1/2	
	148	80	31	117	16	13	18	44.7	30	35.7	8	9	M14	
35 1 1/4 1 5/16 1 3/8 1 7/16	6 11/32	3 17/32	1 11/32	5 1/8	5/8	9/16	3/4	1 29/32	1.260	1.531	0.335	0.374	1/2	
	161	90	34	117	16	14	19	48.4	32	38.9	8.5	9.5	M14	
40 1 1/2 1 9/16	6 7/8	3 15/16	1 13/32	5 43/64	5/8	9/16	53/64	2 4/32	1.339	1.720	0.354	0.433	1/2	
	175	100	36	117	16	14	21	53.7	34	43.7	9	11	M14	
45 1 5/8 1 11/16 1 3/4	7 13/32	4 1/4	1 1/2	5 53/64	3/4	19/32	55/64	2 5/32	—	1.720	—	0.433	5/8	
	188	108	38	117	19	15	22	54.7	—	43.7	—	11	M16	
50 1 7/8 1 15/16	7 3/4	4 17/32	1 9/16	6 3/16	3/4	19/32	55/64	2 5/32	—	1.720	—	0.433	5/8	
	197	115	40	117	19	15	22	54.7	—	43.7	—	11	M16	
55 2 2 1/8 2 3/16	8 13/16	5 1/8	1 11/16	7 1/4	3/4	23/32	63/64	2 13/32	—	1.906	—	0.472	5/8	
	224	130	43	117	19	18	25	61.4	—	48.4	—	12	M16	

Remarks 1. In Part No. of unit and units with covers, fitting codes follow bore diameter numbers. (See **Table 10.5** in P62.)
2. Part No. of applicable grease fittings are shown below.
A-1/4-28UNF 204~210
A-R1/8..... 211



Light 3-Bolt Flange Units

SBTFD-H4RKP8
Cylindrical bore
(with set screws)
d 12 ~ 35 mm

SATFD-FH4P9
Cylindrical bore
(with eccentric locking collar)



SBTFD-H4RKP8



SATFD-FH4P9

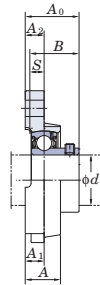

SBTFD-H4RKP8

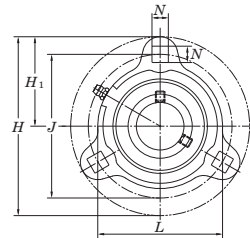

Shaft Dia.		Dimensions														Bolt Size
mm	inch	inch							mm							
<i>d</i>		<i>H</i>	<i>L</i>	<i>A</i>	<i>J</i>	<i>N</i>	<i>H</i> ₁	SBTFD <i>A</i> ₀	SATFD <i>A</i> ₀	<i>A</i> ₁	<i>A</i> ₂	<i>B</i>	<i>B</i> ₁	SBTFD <i>S</i>	SATFD <i>S</i>	mm
12	1/2	3 3/16	2 3/32	1 1/16	2 1/2	9/32	1 19/32	1	1 1/4	3/8	3/8	0.866	1.126	0.236	0.256	1/4
15	5/8	81	53.2	17.5	63.5	7.1	40.5	25.5	31.6	9.5	9.5	22	28.6	6	6.5	
17																
20	3/4	3 9/16	2 3/8	25/32	2 13/16	1 11/32	1 25/32	1 1/8	1 11/32	27/64	27/64	0.984	1.220	0.276	0.295	5/16
		90.5	60.3	19.8	71.4	8.7	45.2	28.7	34.2	10.7	10.7	25	31	7	7.5	
25	7/8	3 3/4	2 5/8	25/32	3	1 11/32	1 7/8	1 3/16	1 11/32	27/64	27/64	1.063	1.220	0.295	0.295	5/16
	15/16	95.2	66.7	19.8	76.2	8.7	47.6	30.2	34.2	10.7	10.7	27	31	7.5	7.5	
30	1 1/8	4 7/16	3 3/32	7/8	3 9/16	1 3/32	2 7/32	1 11/32	1 17/32	15/32	15/32	1.181	1.406	0.315	0.354	3/8
	1 3/16	112.7	78.6	22.2	90.5	10.3	56.4	33.9	38.6	11.9	11.9	30	35.7	8	9	
	1 1/4															
35	1 5/16	4 13/16	3 1/2	15/16	3 15/16	1 3/32	2 13/32	1 7/16	1 21/32	1/2	1/2	1.260	1.531	0.335	0.374	3/8
	1 3/8	122.2	88.9	23.8	100	10.3	61.1	36.2	42.1	12.7	12.7	32	38.9	8.5	9.5	
	1 7/16															

- Remarks
1. In Part No. of unit and units with covers, fitting codes follow bore diameter codes. (See Table 10.5 in P62.)
 2. Part No. of applicable grease fitting is A-1/4-28UNF.
 3. For the dimensions and forms of applicable bearings, see the dimensional tables of ball bearing for unit.

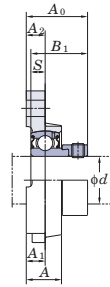

SATFD-FH4P9

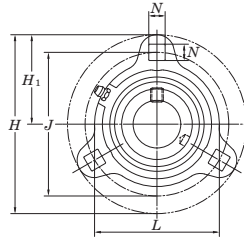

Unit No.	Bearing No.	Unit No.	Bearing No.	Housing No.	Basic Load Ratings kN		Factor f_0	Mass kg	
					C_r	C_{0r}		SBTFD	SATFD
SBTFD201H4RKP8	SB201RKP8	SATFD201FH4P9	SA201FP9	TFD203H4	9.55	4.80	13.2	0.23	0.26
SBTFD201-8H4RKP8	SB201-8RKP8	SATFD201-8FH4P9	SA201-8FP9						
SBTFD202H4RKP8	SB202RKP8	SATFD202FH4P9	SA202FP9						
SBTFD202-10H4RKP8	SB202-10RKP8	SATFD202-10FH4P9	SA202-10FP9						
SBTFD203H4RKP8	SB203RKP8	SATFD203FH4P9	SA203FP9	TFD204H4	12.8	6.65	13.2	0.30	0.34
SBTFD204-12H4RKP8	SB204-12RKP8	SATFD204-12FH4P9	SA204-12FP9						
SBTFD204H4RKP8	SB204RKP8	SATFD204FH4P9	SA204FP9	TFD205H4	14.0	7.85	13.9	0.35	0.39
SBTFD205-14H4RKP8	SB205-14RKP8	SATFD205-14FH4P9	SA205-14FP9						
SBTFD205-15H4RKP8	SB205-15RKP8	SATFD205-15FH4P9	SA205-15FP9						
SBTFD205H4RKP8	SB205RKP8	SATFD205FH4P9	SA205FP9						
SBTFD205-16H4RKP8	SB205-16RKP8	SATFD205-16FH4P9	SA205-16FP9	TFD206H4	19.5	11.3	13.9	0.54	0.61
SBTFD206-18H4RKP8	SB206-18RKP8	SATFD206-18FH4P9	SA206-18FP9						
SBTFD206H4RKP8	SB206RKP8	SATFD206FH4P9	SA206FP9						
SBTFD206-19H4RKP8	SB206-19RKP8	SATFD206-19FH4P9	SA206-19FP9						
SBTFD206-20H4RKP8	SB206-20RKP8	SATFD206-20FH4P9	SA206-20FP9	TFD207H4	25.7	15.4	13.9	0.67	0.82
SBTFD207-20H4RKP8	SB207-20RKP8	SATFD207-20FH4P9	SA207-20FP9						
-	-	SATFD207-21FH4P9	SA207-21FP9						
SBTFD207-22H4RKP8	SB207-22RKP8	SATFD207-22FH4P9	SA207-22FP9						
SBTFD207H4RKP8	SB207RKP8	SATFD207FH4P9	SA207FP9	TFD207H4	25.7	15.4	13.9	0.67	0.82
SBTFD207-23H4RKP8	SB207-23RKP8	SATFD207-23FH4P9	SA207-23FP9						



Light 2-Bolt Flange Units

BLF
Cylindrical bore
(with set screws)

ALF
Cylindrical bore
(with eccentric locking collar)



BLF



ALF

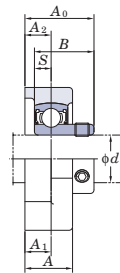

BLF

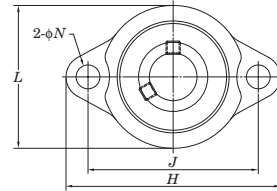

Shaft Dia. mm	inch	Dimensions											Bolt Size inch	Unit No.	Bearing No.	
		mm									inch					
<i>d</i>		<i>H</i>	<i>L</i>	<i>A</i>	<i>J</i>	<i>N</i>	<i>A</i> ₁	<i>A</i> ₂	<i>S</i>	BLF		ALF				
										<i>A</i> ₀	<i>B</i>	<i>A</i> ₀₁	<i>B</i> ₁			
12	1/2	3 3/16	2 1/16	23/32	2 1/2	5/16	3/8	3/8	0.236	1	0.866	1 1/4	1.122	1/4	BLF201 BLF201-8	SB201 SB201-8
15	5/8	81	52	18	63.5	8	9.5	9.5	6	25.5	22	32	28.5	M6	BLF202 BLF202-10	SB202 SB202-10
17															BLF203	SB203
20	3/4	3 17/32	2 3/8	25/32	2 13/16	25/64	7/16	7/16	0.276	1 5/32	0.984	1 5/16	1.161	5/16	BLF204-12 BLF204	SB204-12 SB204
25	7/8	3 3/4	2 17/32	25/32	2 63/64	25/64	7/16	7/16	0.295	1 3/16	1.063	1 11/32	1.201	5/16	BLF205-14 BLF205-15 BLF205	SB205-14 SB205-15 SB205
	1	95	64	20	76	10	11	11	7.5	30.5	27	34	30.5	M8	BLF205-16	SB205-16
30	1 1/8	4 7/16	3	7/8	3 9/16	15/32	15/32	15/32	0.315	1 11/32	1.181	1 1/2	1.335	3/8	BLF206-18 BLF206	SB206-18 SB206
	1 3/16	113	76	22.5	90.5	12	12	12	8	34	30	37.9	33.9	M10	BLF206-19 BLF206-20	SB206-19 SB206-20
	1 1/4														BLF207-20	SB207-20
35	1 5/16	4 13/16	3 1/2	15/16	3 15/16	15/32	1/2	33/64	0.335	1 7/16	1.260	1 5/8	1.437	3/8	BLF207-22 BLF207	SB207-22 SB207
	1 3/8	122	89	24	100	12	13	13	8.5	36.5	32	41	36.5	M10	BLF207-23	SB207-23
	1 7/16															

- Remarks
1. In Part No. of unit and units with covers, fitting codes follow bore diameter codes. (See Table 10.5 in P62.)
 2. Allowable load to housing in radial direction is approximately half of basic load rating of bearing, *C*, (when safety factor is 4).
 3. For the dimensions and forms of applicable bearings, see the dimensional tables of ball bearing for unit.



FYH

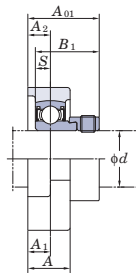

ALF

Variations of tolerance of distance from mounting surface to center of spherical bore (ΔA_{2s}) and variations of tolerance of distance between centers of bolt holes (ΔJ_s)

Housing No.	Unit: mm	
	ΔA_{2s}	ΔJ_s
LF203-LF207	± 0.5	± 0.7

Variations of tolerance of bolt hole diameter (ΔJ_{Vs})

Housing No.	Unit: mm
	ΔJ_{Vs}
LF203-LF207	± 0.2

	Unit No.	Bearing No.	Housing No.	Basic Load Ratings kN		Factor f_0	Mass kg	
				C_r	C_{0r}		BLF	ALF
	ALF201	SA201	LF203	9.55	4.80	13.2	0.25	0.28
	ALF201-8	SA201-8						
	ALF202	SA202						
	ALF202-10	SA202-10						
	ALF203	SA203						
	ALF204-12	SA204-12	LF204	12.8	6.65	13.2	0.33	0.33
	ALF204	SA204						
	ALF205-14	SA205-14	LF205	14.0	7.85	13.9	0.38	0.42
	ALF205-15	SA205-15						
	ALF205	SA205						
	ALF205-16	SA205-16						
	ALF206-18	SA206-18	LF206	19.5	11.3	13.9	0.57	0.60
	ALF206	SA206						
	ALF206-19	SA206-19						
	ALF206-20	SA206-20						
	ALF207-20	SA207-20	LF207	25.7	15.4	13.9	0.77	0.85
	ALF207-21	SA207-21						
	ALF207-22	SA207-22						
	ALF207	SA207						
	ALF207-23	SA207-23						



Compact 2-Bolt Flange Units

UFL

Cylindrical bore (with set screws)

d 8 ~ 30 mm

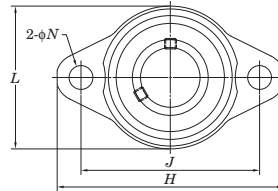
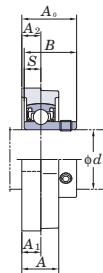

Shaft Dia. mm	Dimensions										Bolt Size inch mm	Standard		
	inch mm											Unit No.	Housing No.	Bearing No.
<i>d</i>	<i>H</i>	<i>L</i>	<i>A</i>	<i>J</i>	<i>N</i>	<i>A</i> ₁	<i>A</i> ₂	<i>A</i> ₀	<i>B</i>	<i>S</i>				
8	1 7/8	1 1/16	11/32	1 29/64	3/16	5/32	5/32	1/2	0.472	0.1378	No.8	UFL08	FL08	SU08
	48	27	8.5	37	4.8	4	4	12.5	12	3.5	M4			
10	2 3/8	1 13/32	15/32	1 49/64	9/32	1/4	15/64	5/8	0.591	0.197	1/4	UFL000	FL000	SU000
	60	36	12	45	7	6	6	16	15	5	M6			
12	2 15/32	1 1/2	15/32	1 57/64	9/32	1/4	15/64	5/8	0.591	0.197	1/4	UFL001	FL001	SU001
	63	38	12	48	7	6	6	16	15	5	M6			
15	2 5/8	1 21/32	1/2	2 3/32	9/32	1/4	1/4	11/16	0.650	0.217	1/4	UFL002	FL002	SU002
	67	42	13	53	7	6.5	6.5	17.5	16.5	5.5	M6			
17	2 25/32	1 13/16	9/16	2 13/64	9/32	9/32	9/32	23/32	0.689	0.236	1/4	UFL003	FL003	SU003
	71	46	14	56	7	7	7	18.5	17.5	6	M6			
20	3 17/32	2 5/32	5/8	2 51/64	13/32	5/16	5/16	7/8	0.827	0.276	5/16	UFL004	FL004	SU004
	90	55	16	71	10	8	8	22	21	7	M8			
25	3 3/4	2 3/8	5/8	2 61/64	13/32	5/16	5/16	29/32	0.866	0.276	5/16	UFL005	FL005	SU005
	95	60	16	75	10	8	8	23	22	7	M8			
30	4 13/32	2 3/4	23/32	3 11/32	1/2	11/32	23/64	1 1/32	0.965	0.295	3/8	UFL006	FL006	SU006
	112	70	18	85	13	9	9	26	24.5	7.5	M10			

Remarks 1. In Part No. of unit and units with covers, fitting codes follow bore diameter codes. (See **Table 10.5** in P.62.)
2. For the dimensions and forms of applicable bearings, see the dimensional tables of ball bearing for unit.



With Through Type Cover

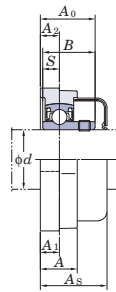

With One Side Sealed Cover

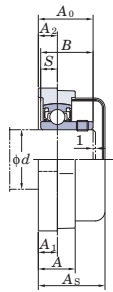

Variations of tolerance of distance from mounting surface to center of spherical bore (Δ_{A2s}) and variations of tolerance of distance between centers of bolt holes (Δ_{A1s})

Housing No.	Δ_{A2s}	Δ_{A1s}
FL08	±0.5	±0.3
FL000-FL006		

Unit: mm

Variations of tolerance of bolt hole diameter (Δ_{N1s})

Housing No.	Δ_{N1s}
FL08	±0.2
FL000-FL006	

Unit: mm

	Mass kg	Basic Load Ratings kN		Factor f_0	With Rubber Coated Cover				Mass kg
		C_r	C_{0r}		Unit No.		Dimension		
					Open Type	Closed Type	mm	inch	
							A_s		
	0.030	3.27	1.37	12.4	-	-	-	-	-
	0.050	4.55	1.95	12.3	UFL000C	UFL000D	20.5	$13/16$	0.05
	0.065	5.10	2.40	13.2	UFL001C	UFL001D	20.5	$13/16$	0.07
	0.085	5.60	2.85	13.9	UFL002C	UFL002D	22	$7/8$	0.09
	0.11	6.00	3.25	14.4	UFL003C	UFL003D	23.5	$15/16$	0.11
	0.18	9.40	5.05	13.9	UFL004C	UFL004D	27	$1 1/16$	0.18
	0.23	10.1	5.85	14.5	UFL005C	UFL005D	28	$1 3/32$	0.23
	0.31	13.2	8.25	14.7	UFL006C	UFL006D	31	$1 7/32$	0.31



Corrosion Resistant Series 2-Bolt Flange Units

UCSFL-H1S6
Cylindrical bore (with set screws)
 d 12 ~ 50 mm

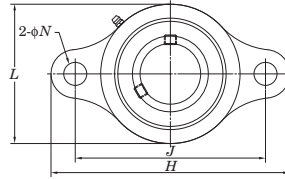
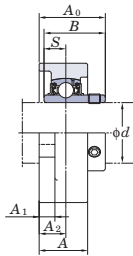

Shaft Dia.		Dimensions										Bolt Size	Standard	Housing No.
mm	inch	inch mm										inch mm	Unit No.	
d		H	L	A	J	N	A_1	A_2	A_0	B	S			
12	1/2	3 27/32	2 1/16	15/16	3	15/32	13/32	9/16	1 3/16	1.079	0.453	3/8 M10	UCSFL201XH1S6 UCSFL201-8XH1S6 UCSFL202XH1S6 UCSFL202-10XH1S6 UCSFL203XH1S6	SFL203H1
		98	52	24	76.5	12	10	14	29.9	27.4	11.5			
15	5/8	4 7/16	2 3/8	1 1/32	3 35/64	15/32	13/32	19/32	1 5/16	1.220	0.500	3/8 M10	UCSFL204-12H1S6 UCSFL204H1S6	SFL204H1
		113	60	26	90	12	10	15	33.3	31	12.7			
17	3/4	5 1/8	2 11/16	1 3/32	3 57/64	5/8	13/32	5/8	1 13/32	1.343	0.563	3/8 M10	UCSFL205-14H1S6 UCSFL205-15H1S6 UCSFL205H1S6 UCSFL205-16H1S6	SFL205H1
		130	68	27.5	99	16	10	16	35.8	34.1	14.3			
20	7/8	5 13/16	3 5/32	1 7/32	4 39/64	5/8	13/32	45/64	1 19/32	1.500	0.626	1/2 M14	UCSFL206-18H1S6 UCSFL206H1S6 UCSFL206-19H1S6 UCSFL206-20H1S6	SFL206H1
		148	80	31	117	16	10	18	40.2	38.1	15.9			
25	1 1/8	6 11/32	3 11/32	1 11/32	5 1/8	5/8	7/16	3/4	1 3/4	1.689	0.689	1/2 M14	UCSFL207-20H1S6 UCSFL207-21H1S6 UCSFL207-22H1S6 UCSFL207H1S6 UCSFL207-23H1S6	SFL207H1
		161	85	34	130	16	11	19	44.4	42.9	17.5			
30	1 3/16	6 7/8	3 11/16	1 13/32	5 43/64	5/8	15/32	53/64	2 1/32	1.937	0.748	1/2 M14	UCSFL208-24H1S6 UCSFL208-25H1S6 UCSFL208H1S6	SFL208H1
		175	94	36	144	16	12	21	51.2	49.2	19			
35	1 1/4	7 13/32	3 15/16	1 1/2	5 53/64	3/4	1/2	55/64	2 1/16	1.937	0.748	5/8 M16	UCSFL209-26H1S6 UCSFL209-27H1S6 UCSFL209-28H1S6 UCSFL209H1S6	SFL209H1
		188	100	38	148	19	13	22	52.2	49.2	19			
40	1 1/2	7 3/4	4 3/16	1 9/16	6 3/16	3/4	1/2	55/64	2 5/32	2.031	0.748	5/8 M16	UCSFL210-30H1S6 UCSFL210-31H1S6 UCSFL210H1S6 UCSFL210-32H1S6	SFL210H1
		197	106	40	157	19	13	22	54.6	51.6	19			

Remarks 1. In Part No. of unit and units with covers, fitting codes follow bore diameter codes. (See Table 10.5 in P.62.)
2. Part No. of applicable grease fitting is A-1/4-28UNFN12.
3. For the dimensions and forms of applicable bearings, see the dimensional tables of ball bearing for unit.



With Pressed Stainless Steel Cover

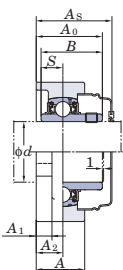

Variations of tolerance of distance from mounting surface to center of spherical bore (ΔA_{2s}) and variations of tolerance of distance between centers of bolt holes (ΔA_s)

Housing No.	ΔA_{2s}	ΔA_s
SFL203H1-SFL210H1	± 0.5	± 0.5

Unit: mm

Variations of tolerance of bolt hole diameter (ΔD_{Vs})

Housing No.	ΔD_{Vs}
SFL203H1-SFL210H1	± 0.2

Unit: mm

Bearing No.	Mass kg	Basic Load Ratings kN		Factor f_0	With Pressed Stainless Steel Cover		Dimension		Mass kg
		C_r	C_{0r}		Unit No.		mm	inch	
					Open Type	Closed Type			
UC201XS6 UC201-8XS6 UC202XS6 UC202-10XS6 UC203XS6	0.33	8.15	3.85	13.2	-	-	-	-	-
UC204-12S6 UC204S6	0.47	10.9	5.35	13.2	UCSFL204H1CS6	UCSFL204H1DS6	38	1 1/2	0.47
UC205-14S6 UC205-15S6 UC205S6 UC205-16S6	0.61	11.9	6.30	13.9	UCSFL205H1CS6	UCSFL205H1DS6	40	1 9/16	0.61
UC206-18S6 UC206S6 UC206-19S6 UC206-20S6	0.9	16.5	9.05	13.9	UCSFL206H1CS6	UCSFL206H1DS6	45	1 15/32	0.9
UC207-20S6 UC207-21S6 UC207-22S6 UC207S6 UC207-23S6	1.1	21.8	12.3	13.9	UCSFL207H1CS6	UCSFL207H1DS6	49	1 15/16	1.1
UC208-24S6 UC208-25S6 UC208S6	1.4	24.8	14.3	14.0	UCSFL208H1CS6	UCSFL208H1DS6	56	2 7/32	1.4
UC209-26S6 UC209-27S6 UC209-28S6 UC209S6	1.6	27.8	16.2	14.0	UCSFL209H1CS6	UCSFL209H1DS6	57	2 7/32	1.6
UC210-30S6 UC210-31S6 UC210S6 UC210-32S6	1.9	29.8	18.6	14.4	UCSFL210H1CS6	UCSFL210H1DS6	59	2 5/16	1.9



Corrosion Resistant Series 2-Bolt Flange Units

UCSFL-EH1S6

Cylindrical bore (with set screws)

d 12 ~ 50 mm

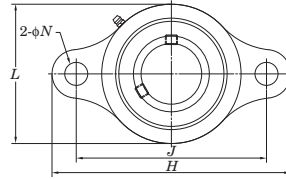
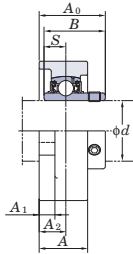

Shaft Dia.		Dimensions										Bolt Size	Standard	
mm	inch	inch mm											inch mm	Unit No.
d		H	L	A	J	N	A_1	A_2	A_0	B	S			
12	1/2	3 27/32	2 1/16	15/16	3	25/64	13/32	9/16	1 3/16	1.079	0.453	5/16	UCSFL201XEH1S6 UCSFL201-8XEH1S6 UCSFL202XEH1S6 UCSFL202-10XEH1S6 UCSFL203XEH1S6	SFL203EH1
		98	52	24	76.2	10	10	14	29.9	27.4	11.5			
15	5/8	4 7/16	2 3/8	1 1/32	3 17/32	25/64	13/32	19/32	1 5/16	1.220	0.500	5/16	UCSFL204-12EH1S6 UCSFL204EH1S6	SFL204EH1
		113	60	26	89.7	10	10	15	33.3	31	12.7			
17	3/4	5 1/8	2 11/16	1 3/32	3 57/64	15/32	13/32	5/8	1 13/32	1.343	0.563	3/8	UCSFL205-14EH1S6 UCSFL205-15EH1S6 UCSFL205EH1S6 UCSFL205-16EH1S6	SFL205EH1
		130	68	27.5	98.8	12	10	16	35.8	34.1	14.3			
20	7/8	5 13/16	3 5/32	1 7/32	4 39/64	15/32	13/32	45/64	1 19/32	1.500	0.626	3/8	UCSFL206-18EH1S6 UCSFL206EH1S6 UCSFL206-19EH1S6 UCSFL206-20EH1S6	SFL206EH1
		148	80	31	116.7	12	10	18	40.2	38.1	15.9			
25	1 1/8	6 11/32	3 11/32	1 11/32	5 1/8	33/64	7/16	3/4	1 3/4	1.689	0.689	7/16	UCSFL207-20EH1S6 UCSFL207-21EH1S6 UCSFL207-22EH1S6 UCSFL207EH1S6 UCSFL207-23EH1S6	SFL207EH1
		161	85	34	130.2	13	11	19	44.4	42.9	17.5			
30	1 3/16	6 7/8	3 11/16	1 13/32	5 21/32	33/64	15/32	53/64	2 1/32	1.937	0.748	7/16	UCSFL208-24EH1S6 UCSFL208-25EH1S6 UCSFL208EH1S6	SFL208EH1
		175	94	36	143.7	13	12	21	51.2	49.2	19			
35	1 1/4	7 13/32	3 15/16	1 1/2	5 27/32	19/32	1/2	55/64	2 1/16	1.937	0.748	1/2	UCSFL209-26EH1S6 UCSFL209-27EH1S6 UCSFL209-28EH1S6 UCSFL209EH1S6	SFL209EH1
		188	100	38	148.4	15	13	22	52.2	49.2	19			
40	1 5/8	7 3/4	4 3/16	1 9/16	6 3/16	19/32	1/2	55/64	2 5/32	2.031	0.748	1/2	UCSFL210-30EH1S6 UCSFL210-31EH1S6 UCSFL210EH1S6 UCSFL210-32EH1S6	SFL210EH1
		197	106	40	157	15	13	22	54.6	51.6	19			

Remarks 1. In Part No. of unit and units with covers, fitting codes follow bore diameter codes. (See Table 10.5 in P.62.)
2. Part No. of applicable grease fitting is A-1/4-28UNFN12.
3. For the dimensions and forms of applicable bearings, see the dimensional tables of ball bearing for unit.



With Pressed Stainless Steel Cover

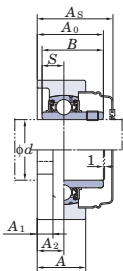

Variations of tolerance of distance from mounting surface to center of spherical bore (ΔA_{2s}) and variations of tolerance of distance between centers of bolt holes (ΔJ_s)

Housing No.	ΔA_{2s}	ΔJ_s
SFL203EH1-SFL210EH1	± 0.5	± 0.5

Variations of tolerance of bolt hole diameter (ΔJ_{Vs})

Housing No.	ΔJ_{Vs}
SFL203EH1-SFL210EH1	± 0.2

Bearing No.	Mass kg	Basic Load Ratings kN		Factor f_0	With Pressed Stainless Steel Cover		Dimension		Mass kg
		C_r	C_{0r}		Unit No.		mm	inch	
					Open Type	Closed Type			
UC201XS6 UC201-8XS6 UC202XS6 UC202-10XS6 UC203XS6	0.33	8.15	3.85	13.2	-	-	-	-	-
UC204-12S6 UC204S6	0.47	10.9	5.35	13.2	UCSFL204EH1CS6	UCSFL204EH1DS6	38	1 1/2	0.47
UC205-14S6 UC205-15S6 UC205S6 UC205-16S6	0.61	11.9	6.30	13.9	UCSFL205EH1CS6	UCSFL205EH1DS6	40	1 9/16	0.61
UC206-18S6 UC206S6 UC206-19S6 UC206-20S6	0.9	16.5	9.05	13.9	UCSFL206EH1CS6	UCSFL206EH1DS6	45	1 15/32	0.9
UC207-20S6 UC207-21S6 UC207-22S6 UC207S6 UC207-23S6	1.1	21.8	12.3	13.9	UCSFL207EH1CS6	UCSFL207EH1DS6	49	1 15/16	1.1
UC208-24S6 UC208-25S6 UC208S6	1.4	24.8	14.3	14.0	UCSFL208EH1CS6	UCSFL208EH1DS6	56	2 7/32	1.4
UC209-26S6 UC209-27S6 UC209-28S6 UC209S6	1.6	27.8	16.2	14.0	UCSFL209EH1CS6	UCSFL209EH1DS6	57	2 1/4	1.6
UC210-30S6 UC210-31S6 UC210S6 UC210-32S6	1.9	29.8	18.6	14.4	UCSFL210EH1CS6	UCSFL210EH1DS6	59	2 5/16	1.9



Corrosion Resistant Series 2-Bolt Flange Units

USFL-S6

Cylindrical bore (with set screws)

d 10 ~ 30 mm

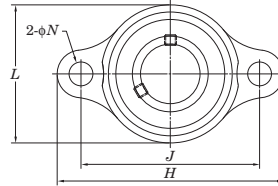
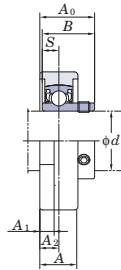

Shaft Dia. mm	Dimensions										Bolt Size inch mm	Standard		
	inch mm											Unit No.	Housing No.	Bearing No.
<i>d</i>	<i>H</i>	<i>L</i>	<i>A</i>	<i>J</i>	<i>N</i>	<i>A</i> ₁	<i>A</i> ₂	<i>A</i> ₀	<i>B</i>	<i>S</i>				
10	2 3/8	1 11/32	15/32	1 49/64	9/32	3/16	15/64	5/8	0.591	0.197	1/4	USFL000S6	SFL000	SU000S6
	60	34	12	45	7	5	6	16	15	5	M6			
12	2 15/32	1 13/32	15/32	1 57/64	9/32	3/16	15/64	5/8	0.591	0.197	1/4	USFL001S6	SFL001	SU001S6
	63	36	12	48	7	5	6	16	15	5	M6			
15	2 5/8	1 5/8	1/2	2 3/32	9/32	1/4	1/4	11/16	0.650	0.217	1/4	USFL002S6	SFL002	SU002S6
	67	41	13	53	7	6	6.5	17.5	16.5	5.5	M6			
17	2 25/32	1 23/32	9/16	2 13/64	9/32	1/4	9/32	23/32	0.689	0.236	1/4	USFL003S6	SFL003	SU003S6
	71	44	14	56	7	6	7	18.5	17.5	6	M6			
20	3 19/32	2 3/32	5/8	2 51/64	13/32	1/4	5/16	7/8	0.827	0.276	5/16	USFL004S6	SFL004	SU004S6
	91	53	16	71	10	6	8	22	21	7	M8			
25	3 3/4	2 9/32	5/8	2 61/64	13/32	1/4	5/16	29/32	0.866	0.276	5/16	USFL005S6	SFL005	SU005S6
	95	58	16	75	10	6	8	23	22	7	M8			
30	4 11/32	2 19/32	23/32	3 11/32	1/2	9/32	23/64	1 1/32	0.965	0.295	3/8	USFL006S6	SFL006	SU006S6
	110	66	18	85	13	7	9	26	24.5	7.5	M10			

Remarks 1. In Part No. of unit and units with covers, fitting codes follow bore diameter codes. (See Table 10.5 in P62.)
2. For the dimensions and forms of applicable bearings, see the dimensional tables of ball bearing for unit.



With Through Type Cover

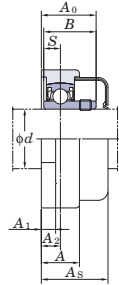

With One Side Sealed Cover

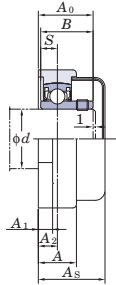

Variations of tolerance of distance from mounting surface to center of spherical bore (ΔA_{2s}) and variations of tolerance of distance between centers of bolt holes (ΔA_s)

Housing No.	ΔA_{2s}	ΔA_s
SFL000-SFL006	± 0.5	± 0.3

Unit: mm

Variations of tolerance of bolt hole diameter (ΔD_h)

Housing No.	ΔD_h
SFL000-SFL006	± 0.2

Unit: mm

Mass	Basic Load Ratings		Factor	Unit No.		Dimension		Mass
	C_r	C_{0r}		Open Type	Closed Type	mm	inch	
kg	kN		f_0			A_s		kg
0.076	3.9	1.55	12.3	USFL000CS6	USFL000DS6	20.5	$13/16$	0.08
0.080	4.3	1.9	13.2	USFL001CS6	USFL001DS6	20.5	$13/16$	0.08
0.1	4.7	2.25	13.9	USFL002CS6	USFL002DS6	22	$7/8$	0.1
0.13	5.1	2.6	14.4	USFL003CS6	USFL003DS6	23.5	$15/16$	0.13
0.21	7.9	4	13.9	USFL004CS6	USFL004DS6	27	$1 1/16$	0.21
0.23	8.5	4.65	14.5	USFL005CS6	USFL005DS6	28	$1 3/32$	0.23
0.33	11.2	6.6	14.7	USFL006CS6	USFL006DS6	31	$1 7/32$	0.33



Corrosion Resistant Series 2-Bolt Flange Units

UCVFL-S6

Cylindrical bore (with set screws)

d 20 ~ 40 mm

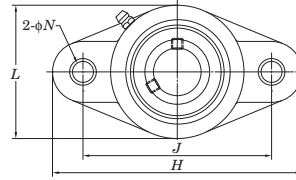
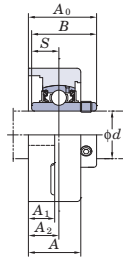

Shaft Dia.		Dimensions											Bolt Size	Standard					
mm	inch	inch mm												inch mm	Unit No.	Housing No.	Bearing No.		
d		H	L	A	J	N	A_1	A_2	A_0	B	S								
20	3/4	4 7/16	2 9/16	1 1/32	3 35/64	7/16	17/32	19/32	1 5/16	1.220	0.500	3/8	UCVFL204-12S6	VFL204	UC204-12S6	UC204S6			
			113	65	26.5	90	11	13.4	15	33.3	31	12.7	M8					UCVFL204S6	
25	7/8	5 5/32	2 3/4	1 3/32	3 57/64	7/16	17/32	5/8	1 13/32	1.343	0.563	3/8	UCVFL205-14S6	VFL205	UC205-14S6	UC205-15S6	UC205S6		
	1 5/16		131	70	27.5	99	11	13.8	16	35.8	34.1	14.3	M8					UCVFL205-15S6	
																			UCVFL205S6
30	1	5 13/16	3 5/32	1 3/16	4 39/64	7/16	9/16	45/64	1 19/32	1.500	0.626	3/8	UCVFL206-18S6	VFL206	UC206-18S6	UC206S6			
	1 3/16		148	80	30.5	117	11	14.3	18	40.2	38.1	15.9	M8					UCVFL206-19S6	
																			UCVFL206-20S6
35	1 1/4	6 15/32	3 17/32	1 1/4	5 1/8	33/64	5/8	3/4	1 3/4	1.689	0.689	7/16	UCVFL207-20S6	VFL207	UC207-20S6	UC207-21S6	UC207-22S6		
	1 5/16		164	90	32	130	13	15.5	19	44.4	42.9	17.5	M10					UCVFL207-21S6	
																			UCVFL207-22S6
40	1 3/8	6 15/32	3 17/32	1 1/4	5 1/8	33/64	5/8	3/4	1 3/4	1.689	0.689	7/16	UCVFL207-23S6	VFL207	UC207-23S6	UC207S6			
	1 7/16																		UCVFL207S6
																			UCVFL207-25S6
40	1 1/2	6 15/16	3 15/16	1 11/32	5 43/64	35/64	21/32	53/64	2 1/32	1.937	0.748	1/2	UCVFL208-24S6	VFL208	UC208-24S6	UC208-25S6	UC208S6		
	1 9/16		176	100	34.5	144	14	16.5	21	51.2	49.2	19	M12					UCVFL208-25S6	
																			UCVFL208S6

- Remarks
1. In Part No. of unit and units with covers, fitting codes follow bore diameter numbers. (See Table 10.5 in P.62.)
 2. Part No. of the applicable grease fitting is A-1/4-28UNFN12.
 3. For the dimensions and forms of applicable bearings, see the dimensional tables of ball bearing for unit.



FYH

Variations of tolerance of distance from mounting surface to center of spherical bore (ΔA_{2s}) and tolerance of position of bolt hole (X)

Unit: mm

Housing No.	ΔA_{2s}	X
VFL204-VFL208	± 0.5	0.7

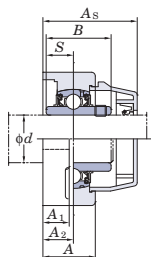

Mass kg	Basic Load Ratings kN		Factor f_0	Unit No.		Dimension		Mass kg
	C_r	C_{0r}		Open Type	Closed Type	mm	inch	
0.25	10.9	5.35	13.2	UCVFL204-12CS6	UCVFL204-12DS6	46.5	1 27/32	0.26
				UCVFL204CS6	UCVFL204DS6			
0.35	11.9	6.3	13.9	UCVFL205-14CS6	UCVFL205-14DS6	50.2	1 31/32	0.36
				UCVFL205-15CS6	UCVFL205-15DS6			
				UCVFL205CS6	UCVFL205DS6			
0.49	16.5	9.05	13.9	UCVFL205-16CS6	UCVFL205-16DS6	57.5	2 1/4	0.50
				UCVFL206-18CS6	UCVFL206-18DS6			
				UCVFL206CS6	UCVFL206DS6			
				UCVFL206-19CS6	UCVFL206-19DS6			
0.73	21.8	12.3	13.9	UCVFL206-20CS6	UCVFL206-20DS6	61.2	2 13/32	0.75
				UCVFL207-20CS6	UCVFL207-20DS6			
				UCVFL207-21CS6	UCVFL207-21DS6			
				UCVFL207-22CS6	UCVFL207-22DS6			
				UCVFL207CS6	UCVFL207DS6			
0.92	24.8	13.3	14.0	UCVFL207-23CS6	UCVFL207-23DS6	69.2	2 23/32	0.95
				UCVFL208-24CS6	UCVFL208-24DS6			
				UCVFL208-25CS6	UCVFL208-25DS6			
				UCVFL208CS6	UCVFL208DS6			



Corrosion Resistant Series 2-Bolt Flange Units

UCVFL-ES7

Cylindrical bore (with set screws)

d 20 ~ 40 mm

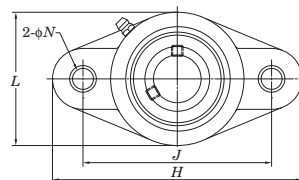
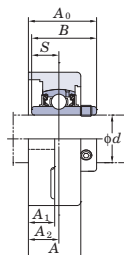

Shaft Dia.		Dimensions										Bolt Size	Standard		
mm	inch	inch mm											Unit No.	Housing No.	Bearing No.
d		H	L	A	J	N	A ₁	A ₂	A ₀	B	S				
20	3/4	4 7/16	2 9/16	1 1/32	3 35/64	7/16	17/32	19/32	1 5/16	1.220	0.500	3/8 M8	UCVFL204-12ES7	VFL204E	UC204-12S7
		113	65	26.5	90	11	13.4	15	33.3	31	12.7		UCVFL204ES7		UC204S7
25	7/8	5 5/32	2 3/4	1 3/32	3 57/64	7/16	17/32	5/8	1 13/32	1.343	0.563	7/16 M10	UCVFL205-14ES7	VFL205E	UC205-14S7
	15/16												UCVFL205-15ES7		UC205-15S7
	1												UCVFL205ES7		UC205S7
30	1 1/8	5 13/16	3 5/32	1 3/16	4 39/64	7/16	9/16	45/64	1 19/32	1.500	0.626	7/16 M10	UCVFL206-18ES7	VFL206E	UC206-18S7
	1 3/16												UCVFL206ES7		UC206S7
	1 1/4												UCVFL206-19ES7		UC206-19S7
													UCVFL206-20ES7		UC206-20S7
35	1 1/4	6 15/32	3 17/32	1 1/4	5 1/8	33/64	5/8	3/4	1 3/4	1.689	0.689	1/2 M12	UCVFL207-20ES7	VFL207E	UC207-20S7
	1 5/16												UCVFL207-21ES7		UC207-21S7
	1 3/8												UCVFL207-22ES7		UC207-22S7
													UCVFL207ES7		UC207S7
40	1 7/16	6 15/16	3 15/16	1 11/32	5 43/64	35/64	21/32	53/64	2 1/32	1.937	0.748	1/2 M12	UCVFL207-23ES7	VFL208E	UC207-23S7
	1 1/2												UCVFL208-24ES7		UC208-24S7
	1 9/16												UCVFL208-25ES7		UC208-25S7
		176	100	34.5	144	14	16.5	21	51.2	49.2	19	UCVFL208ES7		UC208S7	

- Remarks
1. In Part No. of unit and units with covers, fitting codes follow bore diameter numbers. (See Table 10.5 in P.62.)
 2. Part No. of the applicable grease fitting is A-1/4-28UNFN12.
 3. For the dimensions and forms of applicable bearings, see the dimensional tables of ball bearing for unit.



FYH

Variations of tolerance of distance from mounting surface to center of spherical bore (ΔA_{2s}) and tolerance of position of bolt hole (X)

Unit: mm

Housing No.	ΔA_{2s}	X
VFL204E-VFL208E	± 0.5	0.7

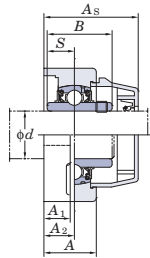

	Mass kg	Basic Load Ratings kN		Factor f_0	With Plastic Cover Unit No.		Dimension		Mass kg
		C_r	C_{0r}		Open Type	Closed Type	mm	inch	
	0.25	12.8	6.65	13.2	UCVFL204-12ECS7 UCVFL204ECS7	UCVFL204-12EDS7 UCVFL204EDS7	46.5	1 27/32	0.26
	0.35	14.0	7.85	13.9	UCVFL205-14ECS7 UCVFL205-15ECS7 UCVFL205ECS7 UCVFL205-16ECS7	UCVFL205-14EDS7 UCVFL205-15EDS7 UCVFL205EDS7 UCVFL205-16EDS7	50.2	1 31/32	0.36
	0.49	19.5	11.3	13.9	UCVFL206-18ECS7 UCVFL206ECS7 UCVFL206-19ECS7 UCVFL206-20ECS7	UCVFL206-18EDS7 UCVFL206EDS7 UCVFL206-19EDS7 UCVFL206-20EDS7	57.5	2 1/4	0.50
	0.73	25.7	15.4	13.9	UCVFL207-20ECS7 UCVFL207-21ECS7 UCVFL207-22ECS7 UCVFL207ECS7 UCVFL207-23ECS7	UCVFL207-20EDS7 UCVFL207-21EDS7 UCVFL207-22EDS7 UCVFL207EDS7 UCVFL207-23EDS7	61.2	2 13/32	0.75
	0.92	29.1	17.8	14.0	UCVFL208-24ECS7 UCVFL208-25ECS7 UCVFL208ECS7	UCVFL208-24EDS7 UCVFL208-25EDS7 UCVFL208EDS7	69.2	2 23/32	0.95



Corrosion Resistant Series 3-Bolt Flange Units

UCVFB-ES7

Cylindrical bore (with set screws)

d 20 ~ 35 mm

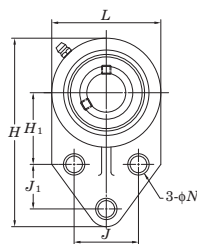
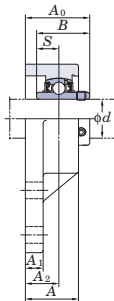

Shaft Dia.		Dimensions													Bolt Size	Unit No.	Standard Housing No.	Bearing No.
mm	inch	inch mm																
<i>d</i>		<i>H</i>	<i>L</i>	<i>A</i>	<i>J</i>	<i>J</i> ₁	<i>N</i>	<i>H</i> ₁	<i>A</i> ₁	<i>A</i> ₂	<i>A</i> ₀	<i>B</i>	<i>S</i>	inch mm				
20	3/4	4 1/4	2 1/2	1	1 1/2	7/8	27/64	1 11/16	7/16	39/64	1 5/16	1.220	0.500	3/8	UCVFB204-12ES7	VFB204E	UC204-12S7 UC204S7	
			108	63.5	25.4	38.1	22.2	10.7	42.9	11.4	15.4	33.7	31	12.7	M10			UCVFB204ES7
25	7/8	4 3/4	2 3/4	1 11/32	1 5/8	1 1/8	27/64	1 13/16	7/16	27/32	1 5/8	1.343	0.563	3/8	UCVFB205-14ES7	VFB205E	UC205-14S7 UC205-15S7 UC205S7	
		15/16	121	70	34.1	41.3	28.6	10.7	46	11.4	21.5	41.3	34.1	14.3	M10			UCVFB205-15ES7 UCVFB205ES7 UCVFB205-16ES7
30	1 1/8	5 15/32	3 1/4	1 1/4	1 7/8	1 1/4	27/64	2 1/16	17/32	49/64	1 5/8	1.500	0.626	3/8	UCVFB206-18ES7	VFB206E	UC206-18S7 UC206S7	
		1 3/16	139	83	32	47.6	31.8	10.7	52.4	13.3	19.3	41.5	38.1	15.9	M10			UCVFB206-19ES7 UCVFB206-20ES7
35	1 1/4	6 3/16	3 3/4	1 7/16	2	1 1/4	17/32	2 3/8	5/8	27/32	1 27/32	1.689	0.689	1/2	UCVFB207-20ES7	VFB207E	UC207-20S7 UC207-21S7 UC207-22S7 UC207S7	
		1 5/16	157	95	36.6	50.8	31.8	13.1	60.3	16.1	21.7	47.1	42.9	17.5	M12			UCVFB207-21ES7 UCVFB207-22ES7 UCVFB207ES7 UCVFB207-23ES7
	1 7/16																UC207-23S7	

- Remarks
1. In Part No. of unit and units with covers, fitting codes follow bore diameter numbers. (See Table 10.5 in P.62.)
 2. Part No. of the applicable grease fitting is A-1/4-28UNFN12.
 3. For the dimensions and forms of applicable bearings, see the dimensional tables of ball bearing for unit.

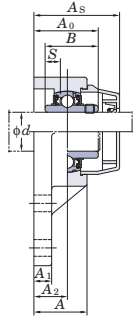

	Mass kg	Basic Load Ratings kN		Factor f_0	Unit No.		With Plastic Cover		Mass kg
		C_r	C_{0r}		Open Type	Closed Type	Dimension mm inch	A_s	
	0.25	12.8	6.65	13.2	UCVFB204-12ECS7 UCVFB204ECS7	UCVFB204-12EDS7 UCVFB204EDS7	45.4	1 ²⁵ / ₃₂	0.26
	0.31	14.0	7.85	13.9	UCVFB205-14ECS7 UCVFB205-15ECS7 UCVFB205ECS7 UCVFB205-16ECS7	UCVFB205-14EDS7 UCVFB205-15EDS7 UCVFB205EDS7 UCVFB205-16EDS7	56.8	2 ¹ / ₄	0.32
	0.47	19.5	11.3	13.9	UCVFB206-18ECS7 UCVFB206ECS7 UCVFB206-19ECS7 UCVFB206-20ECS7	UCVFB206-18EDS7 UCVFB206CDS7 UCVFB206-19EDS7 UCVFB206-20EDS7	59	2 ⁵ / ₁₆	0.48
	0.66	25.7	15.4	13.9	UCVFB207-20ECS7 UCVFB207-21ECS7 UCVFB207-22ECS7 UCVFB207ECS7 UCVFB207-23ECS7	UCVFB207-20EDS7 UCVFB207-21EDS7 UCVFB207-22EDS7 UCVFB207EDS7 UCVFB207-23EDS7	65.8	2 ¹⁹ / ₃₂	0.68