

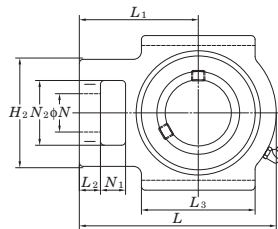

Take-Up Units

UCT
Cylindrical bore (with set screws)
d 12 ~ (45) mm

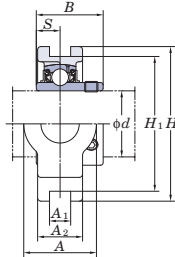

Shaft Dia. mm inch	Dimensions															Standard		
	inch mm															Unit No.	Housing No.	
d	A	A ₁	A ₂	H	H ₁	H ₂	L	L ₁	L ₂	L ₃	N	N ₁	N ₂	B	S			
12 15 17 20	1/2																UCT201 UCT201-8 UCT202 UCT202-10 UCT203 UCT204-12 UCT204	T204
	5/8	1 1/4	15/32	13/16	3 1/2	2 63/64	2	3 11/16	2 13/32	13/32	2	3/4	5/8	1 1/4	1.220	0.500		
	3/4	32	12	21	89	76	51	94	61	10	51	19	16	32	31	12.7		
	7/8																UCT205-14 UCT205-15 UCT205 UCT205-16	T205
25	15/16	1 1/4	15/32	15/16	3 1/2	2 63/64	2	3 13/16	2 7/16	13/32	2	3/4	5/8	1 1/4	1.343	0.563		
	1	32	12	24	89	76	51	97	62	10	51	19	16	32	34.1	14.3		
	1 15/32	15/32	1 3/32	4 1/32	3 1/2	2 7/32	4 7/16	2 3/4	13/32	2 1/4	7/8	5/8	1 15/32	1.500	0.626	UCTX05 UCTX05-16	TX05	
	1 13/32	15/32	1 1/32	3 1/2	3 5/32	2 7/16	4 13/16	3	15/32	2 9/16	1 1/32	5/8	1 13/32	1.496	0.591	UCT305 UCT305-16	T305	
30	1 1/8	1 15/32	15/32	1 3/32	4 1/32	3 1/2	2 7/32	4 7/16	2 3/4	13/32	2 1/4	7/8	5/8	1 15/32	1.500	0.626	UCT206-18 UCT206 UCT206-19 UCT206-20	T206
	1 3/16	37	12	28	102	89	56	113	70	10	57	22	16	37	38.1	15.9		
	1 1/4	1 15/32	15/32	1 3/16	4 1/32	3 1/2	2 17/32	5 3/32	3 1/16	1/2	2 17/32	7/8	5/8	1 15/32	1.689	0.689	UCTX06 UCTX06-19 UCTX06-20	TX06
	—	1 5/8	5/8	1 3/32	3 15/16	3 35/64	2 3/4	5 13/32	3 11/32	9/16	2 29/32	1 3/32	23/32	1 5/8	1.693	0.669	UCT306	T306
35	1 1/4	1 15/32	15/32	1 3/16	4 1/32	3 1/2	2 17/32	5 3/32	3 1/16	1/2	2 17/32	7/8	5/8	1 15/32	1.689	0.689	UCT207-20 UCT207-21 UCT207-22 UCT207 UCT207-23	T207
	1 5/16	37	12	30	102	89	64	129	78	13	64	22	16	37	42.9	17.5		
	1 3/8	1 15/16	5/8	1 13/32	4 1/2	4 1/64	3 9/32	5 21/32	3 15/32	19/32	3 9/32	1 5/32	3/4	1 15/16	1.937	0.748	UCTX07-22 UCTX07 UCTX07-23	TX07
	1 7/16	49	16	36	114	102	83	144	88	15	83	29	19	49	49.2	19		
40	1 1/2	1 25/32	5/8	1 1/4	4 3/8	3 15/16	2 15/16	5 29/32	3 11/16	19/32	3 5/32	1 3/16	25/32	1 25/32	1.890	0.748	UCT307	T307
	1 9/16	45	16	32	111	100	75	150	94	15	80	30	20	45	48	19		
	1 15/16	1 15/16	5/8	1 5/16	4 1/2	4 1/64	3 9/32	5 21/32	3 15/32	5/8	3 9/32	1 5/32	3/4	1 15/16	1.937	0.748	UCT208-24 UCT208-25 UCT208	T208
	1 1/2	49	16	33	114	102	83	144	88	16	83	29	19	49	49.2	19		
45	1 1/2	1 15/16	5/8	1 13/32	4 19/32	4 1/64	3 9/32	5 21/32	3 7/16	19/32	3 9/32	1 5/32	3/4	1 15/16	1.937	0.748	UCTX08-24 UCTX08	TX08
	1 3/4	49	16	36	117	102	83	144	87	15	83	29	19	49	49.2	19		
	1 1/2	1 21/32	45/64	1 11/32	4 7/8	4 13/32	3 9/32	6 3/8	3 15/16	21/32	3 1/2	1 1/4	7/8	1 31/32	2.047	0.748	UCT308-24 UCT308	T308
	1 5/8	50	18	34	124	112	83	162	100	17	89	32	22	50	52	19		
45	1 11/16	1 15/16	5/8	1 3/8	4 19/32	4 1/64	3 9/32	5 21/32	3 7/16	5/8	3 9/32	1 5/32	3/4	1 15/16	1.937	0.748	UCT209-26 UCT209-27 UCT209-28 UCT209	T209
	1 3/4	49	16	35	117	102	83	144	87	16	83	29	19	49	49.2	19		
	1 11/16	1 15/16	5/8	1 1/2	4 19/32	4 1/64	3 9/32	5 7/8	3 17/32	5/8	3 3/8	1 5/32	3/4	1 15/16	2.031	0.748	UCTX09-27 UCTX09-28 UCTX09	TX09
	1 3/4	49	16	38	117	102	83	149	90	16	86	29	19	49	51.6	19		

Remarks 1. In Part No. of unit and units with covers, fitting codes follow bore diameter numbers. (See Table 10.5 in P.62.)
2. Part No. of applicable grease fittings are shown below.
B-1/4-28UNF 201~210, X05~X09, 305~308
B-R1/8 211~217, X10~X17, 309~328



With Pressed Steel Cover

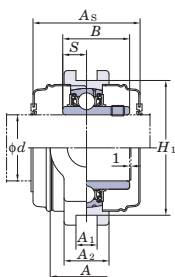

With Cast Iron Cover

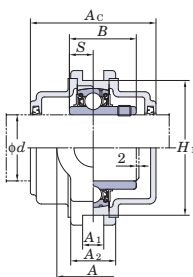

Variations of tolerance of groove width (ΔA_{1s}), variations of tolerance of distance between both grooves (ΔH_{1s}), and tolerance of symmetry of both groove sides (X)

Housing No.		ΔA_{1s}	ΔH_{1s}	X
T204~T210	TX05~TX10	+0.2 0	0 -0.5	0.5
T211~T217	TX11~TX17	+0.3 0	0 -0.8	0.6 0.7 0.8

Unit: mm

Form and dimensions of L_c of T204JE3 and T205JE3 (housing with cast iron cover) are shown below.



T204JE3 $L_c = 97$ mm
T205JE3 $L_c = 102$ mm

Bearing No.	Mass kg	Basic Load Ratings kN		Factor f_0	With Pressed Steel Cover				With Cast Iron Cover								
		C_r	C_{0r}		Unit No.		Dimension mm inch		Mass kg	Unit No.		Dimension mm inch		Mass kg			
					Open Type	One Side Closed Type	A_s			Open Type	One Side Closed Type	A_c					
UC201	0.81	12.8	6.65	13.2	UCT201C	UCT201CD	45	1 25/32	0.81	-	-	-	-	-			
UC201-8	0.81				-	-	-	-	-	-	-	-	-	-	-	-	
UC202	0.79				-	-	-	UCT202C	UCT202CD	45	1 25/32	0.79	-	-	-	-	-
UC202-10	0.79				-	-	-	-	-	-	-	-	-	-	-	-	-
UC203	0.78				-	-	-	UCT203C	UCT203CD	45	1 25/32	0.78	-	-	-	-	-
UC204-12	0.78				-	-	-	-	-	-	-	-	-	-	-	-	-
UC204	0.76	-	-	-	UCT204C	UCT204CD	45	1 25/32	0.76	UCT204FC	UCT204FCD	62	2 7/16	1.1			
UC205-14	0.84	14.0	7.85	13.9	-	-	-	-	-	-	-	-	-	-			
UC205-15	0.84				-	-	-	-	-	-	-	-	-	-	-	-	
UC205	0.84				-	-	-	UCT205C	UCT205CD	49	1 15/16	0.84	UCT205FC	UCT205FCD	66	2 19/32	1.2
UC205-16	0.84				-	-	-	-	-	-	-	-	-	-	-	-	-
UCX05	1.4	19.5	11.3	13.9	UCTX05C	UCTX05CD	53	2 3/32	1.4	-	-	-	-	-			
UCX05-16	1.4				-	-	-	-	-	-	-	-	-	-	-	-	
UC305	1.4	21.2	10.9	12.6	-	-	-	-	-	UCT305C	UCT305CD	76	3	2.0			
UC305-16	1.4				-	-	-	-	-	-	-	-	-	-	-	-	
UC206-18	1.3				-	-	-	-	-	-	-	-	-	-	-	-	-
UC206	1.3	19.5	11.3	13.9	UCT206C	UCT206CD	53	2 3/32	1.3	UCT206FC	UCT206FCD	70	2 3/4	1.8			
UC206-19	1.3				-	-	-	-	-	-	-	-	-	-	-	-	-
UC206-20	1.3				-	-	-	-	-	-	-	-	-	-	-	-	-
UCX06	1.7				-	-	-	UCTX06C	UCTX06CD	60	2 3/8	1.7	-	-	-	-	-
UCX06-19	1.7	25.7	15.4	13.9	-	-	-	-	-	-	-	-	-	-	-		
UCX06-20	1.7				-	-	-	-	-	-	-	-	-	-	-	-	-
UC306	1.8	26.7	15.0	13.3	-	-	-	-	-	UCT306C	UCT306CD	82	3 7/32	2.4			
UC207-20	1.6	25.7	15.4	13.9	-	-	-	-	-	-	-	-	-	-	-		
UC207-21	1.6				-	-	-	-	-	-	-	-	-	-	-	-	-
UC207-22	1.6				-	-	-	-	-	-	-	-	-	-	-	-	-
UC207	1.6				-	-	-	UCT207C	UCT207CD	60	2 3/8	1.6	UCT207FC	UCT207FCD	78	3 1/16	2.3
UC207-23	1.6				-	-	-	-	-	-	-	-	-	-	-	-	-
UCX07-22	2.7	29.1	17.8	14.0	-	-	-	-	-	-	-	-	-	-	-		
UCX07	2.7				-	-	-	UCTX07C	UCTX07CD	69	2 23/32	2.7	-	-	-	-	-
UCX07-23	2.7				-	-	-	-	-	-	-	-	-	-	-	-	-
UC307	2.3	33.4	19.3	13.2	-	-	-	-	-	UCT307C	UCT307CD	88	3 15/32	3.1			
UC208-24	2.5	29.1	17.8	14.0	-	-	-	-	-	-	-	-	-	-	-		
UC208-25	2.5				-	-	-	-	-	-	-	-	-	-	-	-	-
UC208	2.5				-	-	-	UCT208C	UCT208CD	69	2 23/32	2.5	UCT208FC	UCT208FCD	86	3 3/8	3.3
UCX08-24	2.6	34.1	21.3	14.0	-	-	-	-	-	-	-	-	-	-	-		
UCX08	2.6				-	-	-	UCTX08C	UCTX08CD	69	2 23/32	2.6	-	-	-	-	-
UC308-24	3.0	40.7	24.0	13.2	-	-	-	-	-	-	-	-	-	-	-		
UC308	3.0				-	-	-	-	-	-	-	UCT308C	UCT308CD	96	3 25/32	4.0	
UC209-26	2.4	34.1	21.3	14.0	-	-	-	-	-	-	-	-	-	-	-		
UC209-27	2.4				-	-	-	-	-	-	-	-	-	-	-	-	-
UC209-28	2.4				-	-	-	-	-	-	-	-	-	-	-	-	-
UC209	2.4				-	-	-	UCT209C	UCT209CD	69	2 23/32	2.4	UCT209FC	UCT209FCD	88	3 15/32	3.2
UCX09-27	2.9				-	-	-	-	-	-	-	-	-	-	-	-	-
UCX09-28	2.9	35.1	23.3	14.4	-	-	-	-	-	-	-	-	-	-	-		
UCX09	2.9				-	-	-	UCTX09C	UCTX09CD	74	2 29/32	2.9	-	-	-	-	-

- As for the triple seal type product (from 201 to 205 are the double seal type products), suffix code L3 (L2) follows the Part No. of unit or bearing. (Example of Part No. : UCT206JL3, UC206L3)
- As for the dimensions and forms of applicable bearings, see the dimensional tables of ball bearing for unit.
- Housings of nodular graphite cast iron are also available.



Take-Up Units

**UCT
Cylindrical bore (with set screws)**
d (45) ~ (75) mm

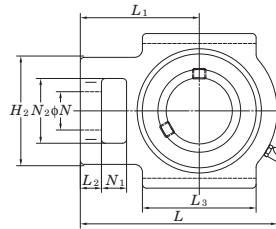
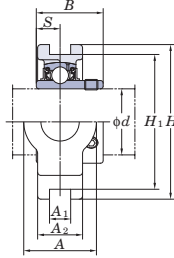

Shaft Dia. mm inch	Dimensions																Standard	
	inch mm																Unit No.	Housing No.
<i>d</i>	A	A ₁	A ₂	H	H ₁	H ₂	L	L ₁	L ₂	L ₃	N	N ₁	N ₂	B	S			
45 1 3/4	2 5/32	45/64	1 1/2	5 7/16	4 59/64	3 17/32	7	4 11/32	23/32	3 13/16	1 11/32	15/16	2 5/32	2.244	0.866	UCT309-28	T309	
	55	18	38	138	125	90	178	110	18	97	34	24	55	57	22	UCT309		
50 1 15/16	1 15/16	5/8	1 15/32	4 19/32	4 1/64	3 9/32	5 7/8	3 17/32	5/8	3 3/8	1 5/32	3/4	1 15/16	2.031	0.748	UCT210-30	T210	
	49	16	37	117	102	83	149	90	16	86	29	19	49	51.6	19	UCT210-31		
	2	17/32	55/64	1 21/32	5 3/4	5 1/8	4 1/32	6 23/32	4 3/16	3/4	3 3/4	1 3/8	31/32	2 17/32	2.189	0.874		UCTX10-31
	64	22	42	146	130	102	171	106	19	95	35	25	64	55.6	22.2	UCTX10-32		
2	17/32	25/32	1 9/16	5 15/16	5 33/64	3 27/32	7 17/32	4 19/32	25/32	4 3/16	1 15/32	1 1/16	2 13/32	2.402	0.866	UCT310	T310	
2	2 17/32	55/64	1 1/2	5 3/4	5 1/8	4 1/32	6 23/32	4 3/16	3/4	3 3/4	1 3/8	31/32	2 17/32	2.189	0.874	UCT211-32	T211	
2 1/8	64	22	38	146	130	102	171	106	19	95	35	25	64	55.6	22.2	UCT211-34		
2 3/16																UCT211-35		
2 3/16	2 17/32	55/64	1 23/32	5 3/4	5 1/8	4 1/32	7 5/8	4 11/16	3/4	4 1/32	1 3/8	1 1/4	2 17/32	2.563	1.000	UCTX11	TX11	
2 1/4	64	22	44	146	130	102	194	119	19	102	35	32	64	65.1	25.4	UCTX11-35		
2	2 19/32	55/64	1 23/32	6 13/32	5 29/32	4 1/8	8 5/32	5	13/16	4 17/32	1 17/32	1 5/32	2 19/32	2.598	0.984	UCT311-32		
2 3/16	66	22	44	163	150	105	207	127	21	115	39	29	66	66	25	UCT311	T311	
2 1/4	2 17/32	55/64	1 21/32	5 3/4	5 1/8	4 1/32	7 5/8	4 11/16	3/4	4 1/32	1 3/8	1 1/4	2 17/32	2.563	1.000	UCT212-36	T212	
2 3/8	64	22	42	146	130	102	194	119	19	102	35	32	64	65.1	25.4	UCT212		
2 7/16	2 3/4	1 1/32	1 7/8	6 9/16	5 15/16	4 3/8	8 13/16	5 13/32	13/16	4 3/4	1 5/8	1 1/4	2 3/4	2.563	1.000	UCTX12		
70	26	48	167	151	111	224	137	21	121	41	32	70	65.1	25.4	UCTX12-39			
2 7/16	2 25/32	55/64	1 13/16	7	6 19/64	4 7/16	8 21/32	5 3/16	29/32	4 27/32	1 5/8	1 7/32	2 25/32	2.795	1.024	UCT312	T312	
71	22	46	178	160	113	220	135	23	123	41	31	71	71	26		UCT312-39		
2 1/2	2 3/4	1 1/32	1 23/32	6 9/16	5 15/16	4 3/8	8 13/16	5 13/32	13/16	4 3/4	1 5/8	1 1/4	2 3/4	2.563	1.000	UCT213-40	T213	
70	26	44	167	151	111	224	137	21	121	41	32	70	65.1	25.4	UCT213			
2 1/2	2 3/4	1 1/32	1 7/8	6 9/16	5 15/16	4 3/8	8 13/16	5 13/32	13/16	4 3/4	1 5/8	1 1/4	2 3/4	2.937	1.189	UCTX13-40		
70	26	48	167	151	111	224	137	21	121	41	32	70	74.6	30.2		UCTX13		
2 1/2	3 5/32	1 1/32	1 31/32	7 15/32	6 11/16	4 9/16	9 3/8	5 3/4	31/32	5 9/32	1 11/16	1 1/4	2 3/4	2.953	1.181	UCT313-40	T313	
80	26	50	190	170	116	238	146	25	134	43	32	70	75	30		UCT313		
2 3/4	2 3/4	1 1/32	1 13/16	6 9/16	5 15/16	4 3/8	8 13/16	5 13/32	13/16	4 3/4	1 5/8	1 1/4	2 3/4	2.937	1.189	UCT214-44		
70	26	46	167	151	111	224	137	21	121	41	32	70	74.6	30.2		UCT214		
2 3/4	2 3/4	1 1/32	1 7/8	6 9/16	5 15/16	4 3/8	9 1/8	5 1/2	13/16	4 3/4	1 5/8	1 1/4	2 3/4	3.063	1.331	UCTX14-44	TX14	
70	26	48	167	151	111	232	140	21	121	41	32	70	77.8	33.3		UCTX14		
2 3/4	3 17/32	1 1/32	2 1/16	7 15/16	7 3/32	5 1/8	9 29/32	6 3/32	31/32	5 1/2	1 13/16	1 13/32	3 11/32	3.071	1.299	UCT314-44		
90	26	52	202	180	130	252	155	25	140	46	36	85	78	33		UCT314		
2 15/16	2 3/4	1 1/32	1 7/8	6 9/16	5 15/16	4 3/8	9 1/8	5 1/2	13/16	4 3/4	1 5/8	1 1/4	2 3/4	3.063	1.331	UCT215-47	T215	
3	70	26	48	167	151	111	232	140	21	121	41	32	70	77.8	33.3			UCT215
2 15/16	2 3/4	1 7/64	1 7/8	7 1/4	6 1/2	4 3/8	9 1/4	5 1/2	13/16	4 3/4	1 5/8	1 1/4	2 3/4	3.252	1.311	UCTX15-47		
3	70	28	48	184	165	111	235	140	21	121	41	32	70	82.6	33.3		UCTX15	
3																	UCTX15-48	

Remarks 1. In Part No. of unit and units with covers, fitting codes follow bore diameter numbers. (See Table 10.5 in P62.)
 2. Part No. of applicable grease fittings are shown below.
 B-1/4-28UNF 201~210, X05~X09, 305~308
 B-R1/8 211~217, X10~X17, 309~328



With Pressed Steel Cover

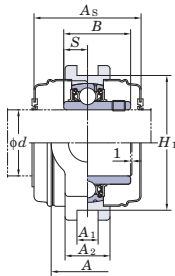

With Cast Iron Cover

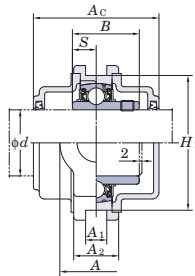

Variations of tolerance of groove width (ΔA_{1s}), variations of tolerance of distance between both grooves (ΔH_{1s}), and tolerance of symmetry of both groove sides (X)

Housing No.		ΔA_{1s}	ΔH_{1s}	X
T204~T210	TX05~TX10	+0.2 0	0 -0.5	0.5
T211~T217	TX11~TX17	+0.3 0	0 -0.8	0.6 0.7 0.8

Unit: mm

Form and dimensions of L_c of T204/E3 and T205/E3 (housing with cast iron cover) are shown below.



T204/E3 $L_c = 97$ mm
T205/E3 $L_c = 102$ mm

Bearing No.	Mass kg	Basic Load Ratings kN		Factor f_0	With Pressed Steel Cover				With Cast Iron Cover							
		C_r	C_{0r}		Unit No.		Dimension mm inch		Mass kg	Unit No.		Dimension mm inch		Mass kg		
					Open Type	One Side Closed Type	A_s			Open Type	One Side Closed Type	A_c				
UC309-28	4.1	48.9	29.5	13.3	-	-	-	-	-	-	-	-	-	-		
UC309	4.1				UCT309C	UCT309CD	102	4 1/32	5.4							
UC210-30	2.6	35.1	23.3	14.4	-	-	-	-	-	-	-	-	-	-		
UC210-31	2.6				-	-	-	-	-	-	-	-	-	-	-	-
UC210	2.6				UCT210C	UCT210CD	74	2 29/32	2.6	UCT210FC	UCT210FCD	97	3 13/16	3.6		
UC210-32	2.6				-	-	-	-	-	-	-	-	-	-	-	-
UCX10-31	4.4	43.4	29.4	14.4	-	-	-	-	-	-	-	-	-	-		
UCX10	4.4				UCTX10C	UCTX10CD	76	3	4.4	-	-	-	-	-	-	-
UCX10-32	4.4				-	-	-	-	-	-	-	-	-	-	-	-
UC310	4.9	62.0	38.3	13.2	-	-	-	-	UCT310C	UCT310CD	110	4 11/32	6.5			
UC211-32	4.0	43.4	29.4	14.4	-	-	-	-	-	-	-	-	-	-		
UC211-34	4.0				-	-	-	-	-	-	-	-	-	-	-	-
UC211	4.0				UCT211C	UCT211CD	76	3	4.0	UCT211FC	UCT211FCD	99	3 29/32	5.2		
UC211-35	4.0				-	-	-	-	-	-	-	-	-	-	-	-
UCX11	5.3	52.4	36.2	14.4	UCTX11C	UCTX11CD	89	3 1/2	5.3	-	-	-	-	-		
UCX11-35	5.3				-	-	-	-	-	-	-	-	-	-	-	-
UCX11-36	5.3				-	-	-	-	-	-	-	-	-	-	-	-
UC311-32	6.1	71.6	45.0	13.2	-	-	-	-	-	-	-	-	-	-		
UC311	6.1				-	-	-	-	-	UCT311C	UCT311CD	114	4 1/2	7.9		
UC311-35	6.1				-	-	-	-	-	-	-	-	-	-	-	-
UC212-36	4.9	52.4	36.2	14.4	UCT212C	UCT212CD	89	3 1/2	4.9	UCT212FC	UCT212FCD	114	4 1/2	6.4		
UC212	4.9				-	-	-	-	-	-	-	-	-	-	-	-
UC212-38	4.9				-	-	-	-	-	-	-	-	-	-	-	-
UC212-39	4.9				-	-	-	-	-	-	-	-	-	-	-	-
UCX12	7.4	57.2	40.1	14.4	UCTX12C	UCTX12CD	89	3 1/2	7.4	-	-	-	-	-		
UCX12-39	7.4				-	-	-	-	-	-	-	-	-	-	-	-
UC312	7.6	81.9	52.2	13.2	-	-	-	-	UCT312C	UCT312CD	124	4 7/8	9.9			
UC312-39	7.6				-	-	-	-	-	-	-	-	-	-	-	-
UC213-40	6.9	57.2	40.1	14.4	-	-	-	-	-	-	-	-	-	-		
UC213	6.9				UCT213C	UCT213CD	89	3 1/2	6.9	UCT213FC	UCT213FCD	114	4 1/2	8.6		
UCX13-40	7.6	62.2	44.1	14.5	-	-	-	-	-	-	-	-	-	-		
UCX13	7.6				UCTX13C	UCTX13CD	99	3 29/32	7.6	-	-	-	-	-	-	-
UC313-40	9.3	92.7	59.9	13.2	-	-	-	-	-	-	-	-	-	-		
UC313	9.3				-	-	-	-	-	UCT313C	UCT313CD	122	4 13/16	11.4		
UC214-44	7.0				-	-	-	-	-	-	-	-	-	-	-	-
UC214	7.0	62.2	44.1	14.5	UCT214C	UCT214CD	99	3 29/32	7.0	UCT214FC	UCT214FCD	124	4 7/8	8.9		
UCX14-44	7.9	67.4	48.3	14.5	-	-	-	-	-	-	-	-	-	-		
UCX14	7.9				UCTX14C	UCTX14CD	99	3 29/32	7.9	-	-	-	-	-	-	-
UC314-44	11.1	104	68.2	13.2	-	-	-	-	-	-	-	-	-	-		
UC314	11.1				-	-	-	-	-	UCT314C	UCT314CD	124	4 7/8	13.4		
UC215-47	7.3	67.4	48.3	14.5	UCT215C	UCT215CD	99	3 29/32	7.3	UCT215FC	UCT215FCD	124	4 7/8	9.2		
UC215	7.3				-	-	-	-	-	-	-	-	-	-	-	-
UC215-48	7.3				-	-	-	-	-	-	-	-	-	-	-	-
UCX15-47	8.7	72.7	53.0	14.6	-	-	-	-	-	-	-	-	-	-		
UCX15	8.7				UCTX15C	UCTX15CD	109	4 9/32	8.7	-	-	-	-	-	-	-
UCX15-48	8.7				-	-	-	-	-	-	-	-	-	-	-	-

- As for the triple seal type product (from 201 to 205 are the double seal type products), suffix code L3 (L2) follows the Part No. of unit or bearing. (Example of Part No. : UCT206JL3, UCT206L3)
- As for the dimensions and forms of applicable bearings, see the dimensional tables of ball bearing for unit.
- Housings of nodular graphite cast iron are also available.



Take-Up Units

UCT
Cylindrical bore (with set screws)
d (75) ~ 140 mm

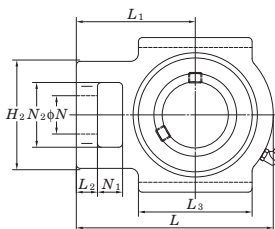
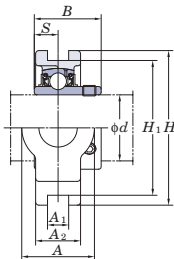

Shaft Dia. mm inch	Dimensions																Standard	
	inch mm																Unit No.	Housing No.
d	A	A ₁	A ₂	H	H ₁	H ₂	L	L ₁	L ₂	L ₃	N	N ₁	N ₂	B	S			
75 3	2 ¹⁵ / ₁₆	3 ¹⁷ / ₃₂	1 ¹ / ₃₂	2 ⁵ / ₃₂	8 ¹ / ₂	7 ⁹ / ₁₆	5 ³ / ₁₆	10 ⁵ / ₁₆	6 ⁵ / ₁₆	3 ¹ / ₃₂	5 ²⁹ / ₃₂	1 ¹³ / ₁₆	1 ¹³ / ₃₂	3 ¹¹ / ₃₂	3.228	1.260	UCT315-47 UCT315 UCT315-48	T315
	3 ¹ / ₈	2 ³ / ₄	1 ¹ / ₃₂	2	7 ¹ / ₄	6 ¹ / ₂	4 ³ / ₈	9 ¹ / ₄	5 ¹ / ₂	1 ³ / ₁₆	4 ³ / ₄	1 ⁵ / ₈	1 ¹ / ₄	2 ³ / ₄	3.252	1.311	UCT216-50 UCT216	T216
	—	2 ⁷ / ₈	1 ⁷ / ₆₄	2 ¹ / ₈	7 ²⁵ / ₃₂	6 ¹³ / ₁₆	4 ⁷ / ₈	10 ¹ / ₄	6 ³ / ₈	1 ³ / ₃₂	6 ³ / ₁₆	1 ⁷ / ₈	1 ¹ / ₂	2 ⁷ / ₈	3.374	1.343	UCTX16	TX16
80	—	73	28	54	198	173	124	260	162	28	157	48	38	73	85.7	34.1		
	—	4 ¹ / ₃₂	3 ¹ / ₁₆	2 ³ / ₈	9 ¹ / ₁₆	8 ¹ / ₃₂	5 ²⁹ / ₃₂	11 ³ / ₃₂	6 ²⁷ / ₃₂	1 ³ / ₃₂	6 ⁵ / ₁₆	2 ³ / ₃₂	1 ²¹ / ₃₂	3 ²⁷ / ₃₂	3.386	1.339	UCT316	T316
	—	102	30	60	230	204	150	282	174	28	160	53	42	98	86	34		
85	3 ¹ / ₄	2 ⁷ / ₈	3 ¹ / ₁₆	2 ¹ / ₈	7 ²⁵ / ₃₂	6 ¹³ / ₁₆	4 ⁷ / ₈	10 ¹ / ₄	6 ³ / ₈	1 ⁵ / ₃₂	6 ³ / ₁₆	1 ⁷ / ₈	1 ¹ / ₂	2 ⁷ / ₈	3.374	1.343	UCT217-52 UCT217	T217
	—	73	30	54	198	173	124	260	162	29	157	48	38	73	85.7	34.1		
	—	2 ⁷ / ₈	1 ⁷ / ₆₄	2 ¹ / ₈	7 ²⁵ / ₃₂	6 ¹³ / ₁₆	4 ⁷ / ₈	10 ¹ / ₄	6 ³ / ₈	1 ³ / ₃₂	6 ³ / ₁₆	1 ⁷ / ₈	1 ¹ / ₂	2 ⁷ / ₈	3.780	1.563	UCTX17 UCTX17-55	TX17
90	—	73	28	54	198	173	124	260	162	28	157	48	38	73	96	39.7		
	—	4 ¹ / ₃₂	1 ¹⁷ / ₆₄	2 ¹⁷ / ₃₂	9 ⁷ / ₁₆	8 ²⁷ / ₆₄	5 ³¹ / ₃₂	11 ²³ / ₃₂	7 ⁷ / ₃₂	1 ³ / ₁₆	6 ¹¹ / ₁₆	2 ³ / ₃₂	1 ²¹ / ₃₂	3 ²⁷ / ₃₂	3.780	1.575	UCT317	T317
	—	102	32	64	240	214	152	298	183	30	170	53	42	98	96	40		
95	3 ¹ / ₂	4 ¹¹ / ₃₂	1 ¹⁷ / ₆₄	2 ¹⁹ / ₃₂	10 ¹ / ₃₂	8 ³¹ / ₃₂	6 ⁵ / ₁₆	12 ⁹ / ₃₂	7 ⁹ / ₁₆	1 ³ / ₁₆	6 ⁷ / ₈	2 ¹ / ₄	1 ¹³ / ₁₆	4 ³ / ₁₆	3.780	1.575	UCT318-56 UCT318	T318
	—	110	32	66	255	228	160	312	192	30	175	57	46	106	96	40		
100	—	4 ¹¹ / ₃₂	1 ³ / ₈	2 ²⁷ / ₃₂	10 ⁵ / ₈	9 ²⁹ / ₆₄	6 ¹ / ₂	12 ¹¹ / ₁₆	7 ³ / ₄	1 ⁷ / ₃₂	7 ³ / ₃₂	2 ¹ / ₄	1 ¹³ / ₁₆	4 ³ / ₁₆	4.055	1.614	UCT319	T319
	—	110	35	72	270	240	165	322	197	31	180	57	46	106	103	41		
105	3 ¹⁵ / ₁₆	4 ²³ / ₃₂	1 ³ / ₈	2 ¹⁵ / ₁₆	11 ¹³ / ₃₂	10 ¹⁵ / ₆₄	6 ⁷ / ₈	13 ¹⁹ / ₃₂	8 ⁹ / ₃₂	1 ¹ / ₄	7 ⁷ / ₈	2 ⁵ / ₁₆	1 ⁷ / ₈	4 ¹⁷ / ₃₂	4.252	1.654	UCT320 UCT320-63 UCT320-64	T320
	—	120	35	75	290	260	175	345	210	32	200	59	48	115	108	42		
110	—	4 ²³ / ₃₂	1 ³ / ₈	2 ¹⁵ / ₁₆	11 ¹³ / ₃₂	10 ¹⁵ / ₆₄	6 ⁷ / ₈	13 ¹⁹ / ₃₂	8 ⁹ / ₃₂	1 ¹ / ₄	7 ⁷ / ₈	2 ⁵ / ₁₆	1 ⁷ / ₈	4 ¹⁷ / ₃₂	4.409	1.732	UCT321	T321
	—	120	35	75	290	260	175	345	210	32	200	59	48	115	112	44		
120	—	5 ¹ / ₈	1 ¹ / ₂	3 ⁵ / ₃₂	12 ¹⁹ / ₃₂	11 ⁷ / ₃₂	7 ⁹ / ₃₂	15 ⁵ / ₃₂	9 ¹ / ₄	1 ¹ / ₂	8 ¹⁵ / ₃₂	2 ⁹ / ₁₆	2 ¹ / ₁₆	4 ²⁹ / ₃₂	4.606	1.811	UCT322	T322
	—	130	38	80	320	285	185	385	235	38	215	65	52	125	117	46		
130	—	5 ¹ / ₂	1 ⁴⁹ / ₆₄	3 ¹⁷ / ₃₂	13 ³¹ / ₃₂	12 ⁹ / ₃₂	8 ⁹ / ₃₂	17	10 ¹ / ₂	1 ²¹ / ₃₂	9 ¹ / ₁₆	2 ³ / ₄	2 ³ / ₈	5 ¹ / ₂	4.961	2.008	UCT324	T324
	—	140	45	90	355	320	210	432	267	42	230	70	60	140	126	51		
140	—	5 ²⁹ / ₃₂	1 ³¹ / ₃₂	3 ¹⁵ / ₁₆	15 ⁵ / ₃₂	13 ²⁵ / ₃₂	8 ²¹ / ₃₂	18 ⁵ / ₁₆	11 ⁷ / ₃₂	1 ²⁵ / ₃₂	9 ⁷ / ₁₆	2 ¹⁵ / ₁₆	2 ⁹ / ₁₆	5 ²⁹ / ₃₂	5.315	2.126	UCT326	T326
	—	150	50	100	385	350	220	465	285	45	240	75	65	150	135	54		
140	—	6 ³ / ₃₂	1 ³¹ / ₃₂	3 ¹⁵ / ₁₆	16 ¹¹ / ₃₂	14 ⁶¹ / ₆₄	9 ¹ / ₁₆	20 ⁹ / ₃₂	12 ¹³ / ₃₂	1 ³¹ / ₃₂	10 ¹ / ₃₂	3 ⁵ / ₃₂	2 ³ / ₄	6 ⁵ / ₁₆	5.709	2.323	UCT328	T328
	—	155	50	100	415	380	230	515	315	50	255	80	70	160	145	59		

Remarks 1. In Part No. of unit and units with covers, fitting codes follow bore diameter numbers. (See Table 10.5 in P.62)
2. Part No. of applicable grease fittings are shown below.
B-1/4-28UNF..... 201~210, X05~X09, 305~308
B-R1/8..... 211~217, X10~X17, 309~328



With Pressed Steel Cover

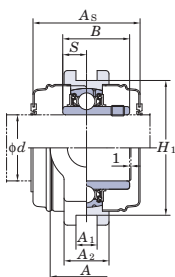

With Cast Iron Cover

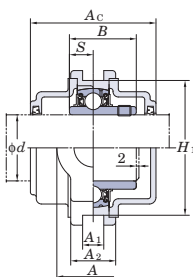

Variations of tolerance of groove width (ΔA_{1s}), variations of tolerance of distance between both grooves (ΔH_{1s}), and tolerance of symmetry of both groove sides (X)

Housing No.		ΔA_{1s}	ΔH_{1s}	X
T204~T210	TX05~TX10	+0.2 0	0 -0.5	0.5
T211~T217	TX11~TX17	+0.3 0	0 -0.8	0.6 0.7 0.8

Unit: mm

Form and dimensions of L_c of T204JE3 and T205JE3 (housing with cast iron cover) are shown below.



T204JE3 $L_c = 97$ mm
T205JE3 $L_c = 102$ mm

Bearing No.	Mass kg	Basic Load Ratings kN		Factor f_0	With Pressed Steel Cover				With Cast Iron Cover					
		C_r	C_{0r}		Unit No.		Dimension mm inch		Mass kg	Unit No.		Dimension mm inch		Mass kg
					Open Type	One Side Closed Type	A_s			Open Type	One Side Closed Type	A_c		
UC315-47	13.0				-	-	-	-	-	-	-	-	-	
UC315	13.0	113	77.2	13.2	-	-	-	-	UCT315C	UCT315CD	134	5 ⁹ / ₃₂	15.5	
UC315-48	13.0				-	-	-	-	-	-	-	-	-	
UC216-50	8.2				-	-	-	-	-	-	-	-	-	
UC216	8.2	72.7	53.0	14.6	UCT216C	UCT216CD	109	4 ⁹ / ₃₂	8.2	UCT216FC	UCT216FCD	138	5 ⁷ / ₁₆	10.6
UCX16	11.7	84.0	61.9	14.5	UCTX16C	UCTX16CD	113	4 ⁷ / ₁₆	11.7	-	-	-	-	-
UC316	16.2	123	86.7	13.3	-	-	-	-	UCT316C	UCT316CD	138	5 ⁷ / ₁₆	19.1	
UC217-52	11.0				-	-	-	-	-	-	-	-	-	
UC217	11.0	84.0	61.9	14.5	UCT217C	UCT217CD	113	4 ⁷ / ₁₆	11.0	UCT217FC	UCT217FCD	142	5 ¹⁹ / ₃₂	13.7
UCX17	11.7	96.1	71.5	14.5	UCTX17C	UCTX17CD	123	4 ²⁷ / ₃₂	11.7	-	-	-	-	-
UCX17-55	11.7				-	-	-	-	-	-	-	-	-	-
UC317	19.0	133	96.8	13.3	-	-	-	-	UCT317C	UCT317CD	146	5 ³ / ₄	22.3	
UC318-56	21.6				-	-	-	-	-	-	-	-	-	-
UC318	21.6	143	107	13.3	-	-	-	-	UCT318C	UCT318CD	150	5 ²⁹ / ₃₂	25.4	
UC319	24.9	153	119	13.3	-	-	-	-	UCT319C	UCT319CD	162	6 ³ / ₈	29.2	
UC320	30.7				-	-	-	-	UCT320C	UCT320CD	174	6 ²⁷ / ₃₂	36.3	
UC320-63	30.7	173	141	13.2	-	-	-	-	-	-	-	-	-	-
UC320-64	30.7				-	-	-	-	-	-	-	-	-	-
UC321	36.7	184	153	13.2	-	-	-	-	UCT321C	UCT321CD	178	7	42.7	
UC322	39.7	205	180	13.2	-	-	-	-	UCT322C	UCT322CD	188	7 ¹³ / ₃₂	46.5	
UC324	54.4	207	185	13.5	-	-	-	-	UCT324C	UCT324CD	196	7 ²³ / ₃₂	63.9	
UC326	69.3	229	214	13.6	-	-	-	-	UCT326C	UCT326CD	214	8 ⁷ / ₁₆	81.4	
UC328	85.1	253	246	13.6	-	-	-	-	UCT328C	UCT328CD	222	8 ³ / ₄	101	

- As for the triple seal type product (from 201 to 205 are the double seal type products), suffix code L3 (L2) follows the Part No. of unit or bearing. (Example of Part No.: UCT206JL3, UC206L3)
- As for the dimensions and forms of applicable bearings, see the dimensional tables of ball bearing for unit.
- Housings of nodular graphite cast iron are also available.



Take-Up Units

UCT-E

Cylindrical bore (with set screws)

d 12 ~ 50 mm

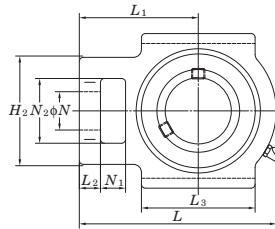
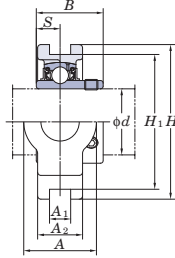

Shaft Dia. mm inch	Dimensions															Unit No.	
	inch mm																
<i>d</i>	A	A ₁	A ₂	H	H ₁	H ₂	L	L ₁	L ₂	L ₃	N	N ₁	N ₂	B	S		
12																UCT201E UCT201-8E	
15	1 1/4	17/32	13/16	3 1/2	3	2	3 11/16	2 13/32	13/32	2	3/4	5/8	1 1/4	1.220	0.500	UCT202E UCT202-10E	
17	32	13.5	21	89	76.2	51	94	61	10	51	19	16	32	31	12.7	UCT203E UCT204-12E UCT204E	
20																UCT205-14E UCT205-15E UCT205E UCT205-16E	
25	1 7/8	17/32	15/16	3 1/2	3	2	3 13/16	2 7/16	13/32	2	3/4	5/8	1 1/4	1.343	0.563	UCT205-14E UCT205-15E UCT205E UCT205-16E	
	1 15/16	17/32	1 3/32	4 1/32	3 1/2	2 7/32	4 7/16	2 3/4	13/32	2 1/4	7/8	5/8	1 15/32	1.500	0.626	UCTX05E UCTX05-16E	
30	1	37	13.5	28	102	88.9	56	113	70	10	57	22	16	37	15.9	UCT206-18E UCT206E UCT206-19E UCT206-20E	
	1 1/8	17/32	1 3/32	4 1/32	3 1/2	2 7/32	4 7/16	2 3/4	13/32	2 1/4	7/8	5/8	1 15/32	1.500	0.626	UCT206-18E UCT206E UCT206-19E UCT206-20E	
	1 3/16	37	13.5	28	102	88.9	56	113	70	10	57	22	16	37	15.9	UCT206-18E UCT206E UCT206-19E UCT206-20E	
35	1 1/4	17/32	1 3/16	4 1/32	3 1/2	2 17/32	5 3/32	3 1/16	1/2	2 17/32	7/8	5/8	1 15/32	1.689	0.689	UCTX06E UCTX06-19E UCTX06-20E	
	1 5/16	17/32	1 3/16	4 1/32	3 1/2	2 17/32	5 3/32	3 1/16	1/2	2 17/32	7/8	5/8	1 15/32	1.689	0.689	UCT207-20E UCT207-21E UCT207-22E UCT207E UCT207-23E	
	1 3/8	17/32	1 3/16	4 1/32	3 1/2	2 17/32	5 3/32	3 1/16	1/2	2 17/32	7/8	5/8	1 15/32	1.689	0.689	UCT207-20E UCT207-21E UCT207-22E UCT207E UCT207-23E	
	1 7/16	1 15/16	11/16	1 13/32	4 1/2	4	3 9/32	5 21/32	3 15/32	19/32	3 9/32	1 5/32	3/4	1 15/16	1.937	0.748	UCTX07-22E UCTX07E UCTX07-23E
40	1 7/16	49	17.5	36	114	101.6	83	144	88	15	83	29	19	49	19	UCT208-24E UCT208-25E UCT208E	
	1 1/2	1 15/16	11/16	1 5/16	4 1/2	4	3 9/32	5 21/32	3 15/32	19/32	3 9/32	1 5/32	3/4	1 15/16	1.937	0.748	UCT208-24E UCT208-25E UCT208E
	1 9/16	49	17.5	33	114	101.6	83	144	88	16	83	29	19	49	19	UCT208-24E UCT208-25E UCT208E	
45	1 1/2	1 15/16	11/16	1 13/32	4 19/32	4	3 9/32	5 21/32	3 7/16	19/32	3 9/32	1 5/32	3/4	1 15/16	1.937	0.748	UCTX08-24E UCTX08E
	1 5/8	1 15/16	11/16	1 3/8	4 19/32	4	3 9/32	5 21/32	3 7/16	5/8	3 9/32	1 5/32	3/4	1 15/16	1.937	0.748	UCT209-26E UCT209-27E UCT209-28E UCT209E
	1 11/16	49	17.5	35	117	101.6	83	144	87	16	83	29	19	49	19	UCT209-26E UCT209-27E UCT209-28E UCT209E	
	1 3/4	49	17.5	35	117	101.6	83	144	87	16	83	29	19	49	19	UCT209-26E UCT209-27E UCT209-28E UCT209E	
50	1 11/16	1 15/16	11/16	1 1/2	4 19/32	4	3 9/32	5 7/8	3 17/32	5/8	3 3/8	1 5/32	3/4	1 15/16	2.031	0.748	UCTX09-27E UCTX09-28E UCTX09E
	1 3/4	49	17.5	38	117	101.6	83	149	90	16	86	29	19	49	19	UCTX09-27E UCTX09-28E UCTX09E	
	1 7/8	1 15/16	11/16	1 15/32	4 19/32	4	3 9/32	5 7/8	3 17/32	5/8	3 3/8	1 5/32	3/4	1 15/16	2.031	0.748	UCT210-30E UCT210-31E UCT210E UCT210-32E
	1 15/16	49	17.5	37	117	101.6	83	149	90	16	86	29	19	49	19	UCT210-30E UCT210-31E UCT210E UCT210-32E	
50	2	2 17/32	1 1/16	1 21/32	5 3/4	5 1/8	4 1/64	6 23/32	4 3/16	3/4	3 3/4	1 3/8	31/32	2 17/32	2.189	0.874	UCTX10-31E UCTX10E UCTX10-32E
	2	64	27	42	146	130.17	102	171	106	19	95	35	25	64	22.2	UCTX10-31E UCTX10E UCTX10-32E	

Remarks 1. In Part No. of unit and units with covers, fitting codes follow bore diameter numbers. (See Table 10.5 in P62.)
2. Part No. of applicable grease fittings are shown below.
B-1/4-28UNF 201~210, X05~X09, 305~308
B-R1/8 211~217, X10~X17, 309~328



Variations of tolerance of groove width (Δ_{A1s}), variations of tolerance of distance between both grooves (Δ_{H1s}), and tolerance of symmetry of both groove sides (X)

Unit: mm

Housing No.		Δ_{A1s}	Δ_{H1s}	X
T204E~T210E	TX05E~TX10E	+0.2 0	0 -0.5	0.5
T211E~T217E	TX11E~TX17E	+0.3 0	0 -0.8	0.6

	Housing No.	Bearing No.	Basic Load Ratings kN		Factor f_0	Mass kg
			C_r	C_{0r}		
	T204E	UC201	12.8	6.65	13.2	0.81
		UC201-8				0.79
		UC202				0.78
		UC202-10				0.76
		UC203				0.76
	T205E	UC204-12	14.0	7.85	13.9	0.84
		UC204				0.84
		UC205-14				0.84
		UC205-15				0.84
		UC205				0.84
	TX05E	UC205-16	19.5	11.3	13.9	1.4
		UCX05				1.4
	T206E	UCX05-16	19.5	11.3	13.9	1.3
		UC206-18				1.3
		UC206				1.3
		UC206-19				1.3
	TX06E	UC206-20	25.7	15.4	13.9	1.7
		UCX06				1.7
		UCX06-19				1.7
	T207E	UCX06-20	25.7	15.4	13.9	1.6
		UC207-20				1.6
		UC207-21				1.6
		UC207-22				1.6
		UC207				1.6
	TX07E	UC207-23	29.1	17.8	14.0	2.7
		UCX07-22				2.7
		UCX07				2.7
	T208E	UCX07-23	29.1	17.8	14.0	2.5
		UC208-24				2.5
		UC208-25				2.5
	TX08E	UC208	34.1	21.3	14.0	2.6
		UCX08-24				2.6
	T209E	UCX08	34.1	21.3	14.0	2.4
		UC209-26				2.4
		UC209-27				2.4
		UC209-28				2.4
	TX09E	UC209	35.1	23.3	14.4	2.9
		UCX09-27				2.9
		UCX09-28				2.9
	T210E	UCX09	35.1	23.3	14.4	2.6
		UC210-30				2.6
		UC210-31				2.6
		UC210				2.6
	TX10E	UC210-32	43.4	29.4	14.4	4.4
		UCX10-31				4.4
		UCX10				4.4
		UCX10-32				

3. As for the triple seal type product (from 201 to 205 are the double seal type products), suffix code L3 (L2) follows the Part No. of unit or bearing. (Example of Part No. : UCT206EL3, UC206L3)
4. As for the dimensions and forms of applicable bearings, see the dimensional tables of ball bearing for unit.
5. Housings of nodular graphite cast iron are also available.



Take-Up Units

UCT-E

Cylindrical bore (with set screws)

d 55 ~ 85 mm

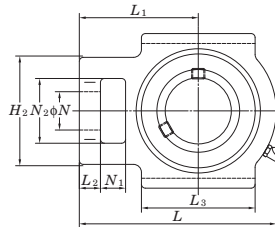
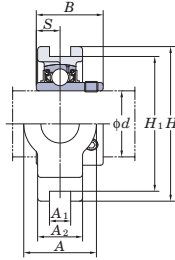

Shaft Dia. mm inch	Dimensions															Unit No.
	inch mm															
<i>d</i>	A	A ₁	A ₂	H	H ₁	H ₂	L	L ₁	L ₂	L ₃	N	N ₁	N ₂	B	S	
55 2 1/8 2 3/16	2 17/32	1 1/16	1 1/2	5 3/4	5 1/8	4 1/64	6 23/32	4 3/16	3/4	3 3/4	1 3/8	3 1/32	2 17/32	2.189	0.874	
	64	27	38	146	130.17	102	171	106	19	95	35	25	64	55.6	22.2	
	2 17/32	1 1/16	1 23/32	5 3/4	5 1/8	4 1/64	7 5/8	4 11/16	3/4	4 1/32	1 3/8	1 1/4	2 17/32	2.563	1.000	
60 2 1/4 2 3/8 2 7/16	2 17/32	1 1/16	1 21/32	5 3/4	5 1/8	4 1/64	7 5/8	4 11/16	3/4	4 1/32	1 3/8	1 1/4	2 17/32	2.563	1.000	
	64	27	42	146	130.17	102	194	119	19	102	35	32	64	65.1	25.4	
	2 3/4	1 1/16	1 7/8	6 9/16	5 15/16	4 3/8	8 13/16	5 13/32	13/16	4 3/4	1 5/8	1 1/4	2 3/4	2.563	1.000	
65 2 1/2 2 7/16	2 3/4	1 1/16	1 23/32	6 9/16	5 15/16	4 3/8	8 13/16	5 13/32	13/16	4 3/4	1 5/8	1 1/4	2 3/4	2.563	1.000	
	70	27	44	167	150.8	111	224	137	21	121	41	32	70	65.1	25.4	
	2 1/2	2 3/4	1 1/16	1 7/8	6 9/16	5 15/16	4 3/8	8 13/16	5 13/32	13/16	4 3/4	1 5/8	1 1/4	2 3/4	2.937	1.189
70 2 3/4 2 7/16	2 3/4	1 1/16	1 7/8	6 9/16	5 15/16	4 3/8	8 13/16	5 13/32	13/16	4 3/4	1 5/8	1 1/4	2 3/4	2.937	1.189	
	70	27	46	167	150.8	111	224	137	21	121	41	32	70	74.6	30.2	
	2 3/4	1 1/16	1 7/8	6 9/16	5 15/16	4 3/8	9 1/8	5 1/2	13/16	4 3/4	1 5/8	1 1/4	2 3/4	3.063	1.331	
75 2 15/16 3 2 15/16	2 3/4	1 1/16	1 7/8	6 9/16	5 15/16	4 3/8	9 1/8	5 1/2	13/16	4 3/4	1 5/8	1 1/4	2 3/4	3.063	1.331	
	70	27	48	167	150.8	111	232	140	21	121	41	32	70	77.8	33.3	
	2 3/4	1 1/16	1 7/8	7 1/4	6 1/2	4 3/8	9 1/4	5 1/2	13/16	4 3/4	1 5/8	1 1/4	2 3/4	3.252	1.311	
80 3 1/8 3 1/2	2 3/4	1 1/16	2	7 1/4	6 1/2	4 3/8	9 1/4	5 1/2	13/16	4 3/4	1 5/8	1 1/4	2 3/4	3.252	1.311	
	70	27	51	184	165	111	235	140	21	121	41	32	70	82.6	33.3	
	3 1/2	1 13/16	2 11/16	7 25/32	6 13/16	4 7/8	10 1/4	6 3/8	1 3/32	6 3/16	1 7/8	1 1/2	2 7/8	3.374	1.343	
85 3 1/4 3 7/16	3 1/2	1 13/16	2 11/16	7 25/32	6 13/16	4 7/8	10 1/4	6 3/8	1 3/32	6 3/16	1 7/8	1 1/2	2 7/8	3.374	1.343	
	89	46	68	198	173	124	260	162	29	157	48	38	73	85.7	34.1	
	3 1/2	1 13/16	2 11/16	7 25/32	6 13/16	4 7/8	10 1/4	6 3/8	1 3/32	6 3/16	1 7/8	1 1/2	2 7/8	3.780	1.563	
	89	46	68	198	173	124	260	162	28	157	48	38	73	96	39.7	

Remarks 1. In Part No. of unit and units with covers, fitting codes follow bore diameter numbers. (See Table 10.5 in P.62)
2. Part No. of applicable grease fittings are shown below.
B-1/4-28UNF 201~210, X05~X09, 305~308
B-R1/8 211~217, X10~X17, 309~328



Variations of tolerance of groove width (Δ_{A1s}), variations of tolerance of distance between both grooves (Δ_{H1s}), and tolerance of symmetry of both groove sides (X)

Housing No.		Δ_{A1s}	Δ_{H1s}	X
T204E~T210E	TX05E~TX10E	+0.2 0	0 -0.5	0.5
T211E~T217E	TX11E~TX17E	+0.3 0	0 -0.8	0.6

Unit: mm

	Housing No.	Bearing No.	Basic Load Ratings kN		Factor f_0	Mass kg
			C_r	C_{0r}		
	T211E	UC211-32 UC211-34 UC211 UC211-35	43.4	29.4	14.4	4.0
	TX11E	UCX11 UCX11-35 UCX11-36	52.4	36.2	14.4	5.3
	T212E	UC212-36 UC212 UC212-38 UC212-39	52.4	36.2	14.4	4.9
	TX12E	UCX12 UCX12-39	57.2	40.1	14.4	7.4
	T213E	UC213-40 UC213	57.2	40.1	14.4	6.9
	TX13E	UCX13-40 UCX13	62.2	44.1	14.5	7.6
	T214E	UC214-44 UC214	62.2	44.1	14.5	7.0
	TX14E	UCX14-44 UCX14	67.4	48.3	14.5	7.9
	T215E	UC215-47 UC215 UC215-48	67.4	48.3	14.5	7.3
	TX15E	UCX15-47 UCX15 UCX15-48	72.7	53.0	14.6	8.7
	T216E	UC216-50 UC216	72.7	53.0	14.6	8.2
	TX16E	UCX16	84.0	61.9	14.5	12.4
	T217E	UC217-52 UC217	84.0	61.9	14.5	12.1
	TX17E	UCX17 UCX17-55	96.1	71.5	14.5	13.3

- As for the triple seal type product (from 201 to 205 are the double seal type products), suffix code L3 (L2) follows the Part No. of unit or bearing. (Example of Part No.: UCT206EL3, UC206L3)
- As for the dimensions and forms of applicable bearings, see the dimensional tables of ball bearing for unit.
- Housings of nodular graphite cast iron are also available.



Take-Up Units

NAT-E
Cylindrical bore
(with eccentric locking collar)
d 12 ~ 75 mm

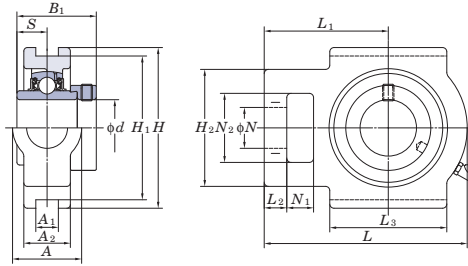

Shaft Dia. mm	inch	Dimensions														Unit No.	
		inch mm															
d		A	A ₁	A ₂	H	H ₁	H ₂	L	L ₁	L ₂	L ₃	N	N ₁	N ₂	B ₁	S	
12	1/2																NAT201E NAT201-8E
15	5/8	1 1/4	17/32	13/16	3 1/2	3	2	3 11/16	2 13/32	13/32	2	3/4	5/8	1 1/4	1.720	0.673	NAT202E NAT202-10E
17	3/4	32	13.5	21	89	76.2	51	94	61	10	51	19	16	32	43.7	17.1	NAT203E NAT204-12E NAT204E
20	7/8																NAT205-14E NAT205-15E
25	15/16	1 1/4	17/32	15/16	3 1/2	3	2	3 13/16	2 7/16	13/32	2	3/4	5/8	1 1/4	1.748	0.689	NAT205E NAT205-16E
	1	32	13.5	24	89	76.2	51	97	62	10	51	19	16	32	44.4	17.5	
30	1 1/8	1 15/32	17/32	1 3/32	4 1/32	3 1/2	2 7/32	4 7/16	2 3/4	13/32	2 1/4	7/8	5/8	1 15/32	1.906	0.720	NAT206-18E NAT206E
	1 3/16	37	13.5	28	102	88.9	56	113	70	10	57	22	16	37	48.4	18.3	NAT206-19E NAT206-20E
	1 1/4																NAT207-20E
35	1 5/16	1 15/32	17/32	1 3/16	4 1/32	3 1/2	2 17/32	5 3/32	3 1/16	1/2	2 17/32	7/8	5/8	1 15/32	2.012	0.740	NAT207-21E NAT207-22E
	1 3/8	37	13.5	30	102	88.9	64	129	78	13	64	22	16	37	51.1	18.8	NAT207E NAT207-23E
	1 7/16																
40	1 1/2	1 15/16	11/16	1 5/16	4 1/2	4	3 9/32	5 21/32	3 15/32	5/8	3 9/32	1 15/32	3/4	1 15/16	2.217	0.843	NAT208-24E NAT208-25E
	1 9/16	49	17.5	33	114	101.6	83	144	88	16	83	29	19	49	56.3	21.4	NAT208E
45	1 5/8	1 15/16	11/16	1 3/8	4 19/32	4	3 9/32	5 21/32	3 7/16	5/8	3 9/32	1 5/32	3/4	1 15/16	2.217	0.843	NAT209-26E NAT209-27E
	1 11/16	49	17.5	35	117	101.6	83	144	87	16	83	29	19	49	56.3	21.4	NAT209-28E NAT209E
	1 3/4																
50	1 7/8	1 15/16	11/16	1 15/32	4 19/32	4	3 9/32	5 7/8	3 17/32	5/8	3 3/8	1 5/32	3/4	1 15/16	2.469	0.969	NAT210-30E NAT210-31E
	1 15/16	49	17.5	37	117	101.6	83	149	90	16	86	29	19	49	62.7	24.6	NAT210E NAT210-32E
	2																
55	2 1/8	2 17/32	1 1/16	1 1/2	5 3/4	5 1/8	4 1/32	6 23/32	4 3/16	3/4	3 3/4	1 3/8	31/32	2 17/32	2.811	1.094	NAT211-32E NAT211-34E
	2 3/16	64	27	38	146	130.17	102	171	106	19	95	35	25	64	71.4	27.8	NAT211E NAT211-35E
	2 1/4																NAT212-36E
60	2 17/32	2 17/32	1 1/16	1 21/32	5 3/4	5 1/8	4 1/32	7 5/8	4 11/16	3/4	4 1/32	1 3/8	1 1/4	2 17/32	3.063	1.220	NAT212E NAT212-38E
	2 3/8	64	27	42	146	130.17	102	194	119	19	102	35	32	64	77.8	31	NAT212-39E
	2 1/4																
65	2 1/2	2 3/4	1 1/16	1 23/32	6 9/16	5 15/16	4 3/8	8 13/16	5 13/32	13/16	4 3/4	1 5/8	1 1/4	2 3/4	3.374	1.343	NAT213-40E NAT213E
	2 3/4	70	27	44	167	150.8	111	224	137	21	121	41	32	70	85.7	34.1	
70	2 3/4	2 3/4	1 1/16	1 13/16	6 9/16	5 15/16	4 3/8	8 13/16	5 13/32	13/16	4 3/4	1 5/8	1 1/4	2 3/4	3.374	1.343	NAT214-44E NAT214E
	2 3/4	70	27	46	167	150.8	111	224	137	21	121	41	32	70	85.7	34.1	
75	2 15/16	2 3/4	1 1/16	1 7/8	6 9/16	5 15/16	4 3/8	9 1/8	5 1/2	13/16	4 3/4	1 5/8	1 1/4	2 3/4	3.626	1.469	NAT215-47E NAT215E
	2 3/4	70	27	48	167	150.8	111	232	140	21	121	41	32	70	92.1	37.3	

Remarks 1. In Part No. of unit, fitting codes follow bore diameter codes. (See **Table 10.5** in P.62.)
2. Part No. of applicable grease fittings are shown below.
B-1/4-28UNF.....204~210
B-R1/8.....211~215



Variations of tolerance of groove width (Δ_{A1s}), variations of tolerance of distance between both grooves (Δ_{H1s}), and tolerance of symmetry of both groove sides (X)

Unit: mm

Housing No.	Δ_{A1s}	Δ_{H1s}	X
T204E~T210E	+0.2 0	0 -0.5	0.5
T211E~T215E	+0.3 0	0 -0.8	0.6

Housing No.	Bearing No.	Basic Load Ratings kN		Factor f_0	Mass kg
		C_r	C_{0r}		
T204E	NA201	12.8	6.65	13.2	0.83
	NA201-8				0.81
	NA202				0.8
	NA202-10				0.84
	NA203				0.84
T205E	NA204-12	14.0	7.85	13.9	0.89
	NA204				0.89
	NA205-14				0.89
	NA205-15				0.89
T206E	NA205	19.5	11.3	13.9	1.39
	NA205-16				1.39
	NA206-18				1.39
	NA206				1.39
T207E	NA206-19	25.7	15.4	13.9	1.73
	NA206-20				1.73
	NA207-20				1.73
	NA207-21				1.73
	NA207-22				1.73
T208E	NA207	29.1	17.8	14.0	2.74
	NA207-23				2.74
	NA208-24				2.74
T209E	NA208-25	34.1	21.3	14.0	2.57
	NA208				2.57
	NA209-26				2.57
	NA209-27				2.57
T210E	NA209-28	35.1	23.3	14.4	2.81
	NA209				2.81
	NA210-30				2.81
	NA210-31				2.81
T211E	NA210	43.4	29.4	14.4	4.28
	NA210-32				4.28
	NA211-32				4.28
	NA211-34				4.28
T212E	NA211	52.4	36.2	14.4	5.23
	NA211-35				5.23
	NA212-36				5.23
	NA212				5.23
T213E	NA212-38	57.2	40.1	14.4	7.49
	NA212-39				7.49
	NA213-40				7.49
T214E	NA213	62.2	44.1	14.5	7.87
	NA214				7.87
T215E	NA214-44	67.4	48.3	14.5	7.83
	NA215-47				7.83
	NA215				

3. For the dimensions and forms of applicable bearings, see the dimensional tables of ball bearing for unit.
4. Representative examples of the forms of housing are indicated.



Take-Up Units

NCT
Cylindrical bore
(with concentric locking collar)
d 20 ~ 60 mm

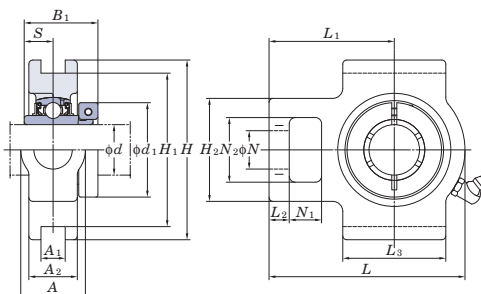

Shaft Dia. mm inch	Dimensions															
	inch mm															
<i>d</i>	A	A ₁	A ₂	H	H ₁	H ₂	L	L ₁	L ₂	L ₃	N	N ₁	N ₂	B ₁	S	d ₁
20 3/4	1 1/4	15/32	13/16	3 1/2	2 63/64	2	3 11/16	2 13/32	13/32	2	3/4	5/8	1 1/4	1 9/32	0.500	1 3/4
	32	12	21	89	76	51	94	61	10	51	19	16	32	32.5	12.7	44.5
25 7/8 15/16 1	1 1/4	15/32	15/16	3 1/2	2 63/64	2	3 13/16	2 7/16	13/32	2	3/4	5/8	1 1/4	1 7/16	0.563	1 15/16
	32	12	24	89	76	51	97	62	10	51	19	16	32	36.5	14.3	49.2
30 1 1/8 1 3/16 1 1/4	1 15/32	15/32	1 3/32	4 1/32	3 1/2	2 7/32	4 7/16	2 3/4	13/32	2 1/4	7/8	5/8	1 15/32	1 9/16	0.626	2 3/16
	37	12	28	102	89	56	113	70	10	57	22	16	37	39.7	15.9	55.6
35 1 1/4 1 3/8 1 7/16	1 15/32	15/32	1 3/16	4 1/32	3 1/2	2 17/32	5 3/32	3 1/16	1/2	2 17/32	7/8	5/8	1 15/32	1 3/4	0.689	2 7/16
	37	12	30	102	89	64	129	78	13	64	22	16	37	44.5	17.5	61.9
40 1 1/2	1 15/32	5/8	1 5/16	4 1/2	4 1/64	3 9/32	5 21/32	3 15/32	5/8	3 9/32	1 5/32	3/4	1 15/16	2	0.748	2 11/16
	49	16	33	114	102	83	144	88	16	83	29	19	49	50.8	19	68.3
45 1 5/8 1 11/16 1 3/4	1 15/16	5/8	1 3/8	4 19/32	4 1/64	3 9/32	5 21/32	3 7/16	5/8	3 9/32	1 5/32	3/4	1 15/16	2	0.748	2 13/16
	49	16	35	117	102	83	144	87	16	83	29	19	49	50.8	19	71.4
50 1 15/16 2	1 15/16	5/8	1 15/32	4 19/32	4 1/64	3 9/32	5 7/8	3 17/32	5/8	3 3/8	1 5/32	3/4	1 15/16	2 3/32	0.748	3 3/8
	49	16	37	117	102	83	149	90	16	86	29	19	49	53.1	19	85.7
55 2 2 3/16	2 17/32	55/64	1 1/2	5 3/4	5 1/8	4 1/32	6 23/32	4 3/16	3/4	3 3/4	1 3/8	31/32	2 17/32	2 1/4	0.874	3 1/2
	64	22	38	146	130	102	171	106	19	95	35	25	64	57.1	22.2	88.9
60 2 1/4 2 7/16	2 17/32	55/64	1 21/32	5 3/4	5 1/8	4 1/32	7 5/8	4 11/16	3/4	4 1/32	1 3/8	1 1/4	2 17/32	2 5/8	1.000	4 1/16
	64	22	42	146	130	102	194	119	19	102	35	32	64	66.7	25.4	103.2
	2 17/32	55/64	1 21/32	5 3/4	5 1/8	4 1/32	7 5/8	4 11/16	3/4	4 1/32	1 3/8	1 1/4	2 17/32	2 5/8	1.000	4 1/8
	64	22	42	146	130	102	194	119	19	102	35	32	64	66.7	25.4	104.8

Remarks 1. In Part No. of unit, fitting codes follow bore diameter codes. (See **Table 10.5** in P.62.)
2. Part No. of applicable grease fittings are shown below.
B-1/4-28UNF 204~210
B-R1/8 211~212



FYH

Variations of tolerance of groove width (Δ_{A1s}), variations of tolerance of distance between both grooves (Δ_{H1s}), and tolerance of symmetry of both groove sides (X)

Housing No.	Δ_{A1s}	Δ_{H1s}	X
T204~T210	+0.2 0	0 -0.5	0.5
T211~T212	+0.3 0	0 -0.8	0.6

Unit: mm

Unit No.	Housing No.	Bearing No.	Basic Load Ratings kN		Factor f_0	Mass kg
			C_r	C_{0r}		
NCT204-12 NCT204	T204	NC204-12 NC204	12.8	6.65	13.2	0.9
NCT205-14 NCT205-15 NCT205 NCT205-16	T205	NC205-14 NC205-15 NC205 NC205-16	14.0	7.85	13.9	1.0
NCT206-18 NCT206 NCT206-19 NCT206-20	T206	NC206-18 NC206 NC206-19 NC206-20	19.5	11.3	13.9	1.5
NCT207-20	T207	NC207-20	25.7	15.4	13.9	1.9
NCT207-22 NCT207 NCT207-23	T207	NC207-22 NC207 NC207-23	25.7	15.4	13.9	1.9
NCT208-24 NCT208	T208	NC208-24 NC208	29.1	17.8	14.0	2.9
NCT209-26	T209	NC209-26	34.1	21.3	14.0	2.8
NCT209-27 NCT209-28 NCT209	T209	NC209-27 NC209-28 NC209	34.1	21.3	14.0	2.8
NCT210-31 NCT210 NCT210-32	T210	NC210-31 NC210 NC210-32	35.1	23.3	14.4	3.2
NCT211-32	T211	NC211-32	43.4	29.4	14.4	4.4
NCT211 NCT211-35	T211	NC211 NC211-35	43.4	29.4	14.4	4.4
NCT212-36	T212	NC212-36	52.4	36.2	14.4	5.6
NCT212 NCT212-39	T212	NC212 NC212-39	52.4	36.2	14.4	5.6

3. For the dimensions and forms of applicable bearings, see the dimensional tables of ball bearing for unit.
4. Representative examples of the forms of housing are indicated.



Take-Up Units

NCT-E
Cylindrical bore
(with concentric locking collar)
d 20 ~ 60 mm

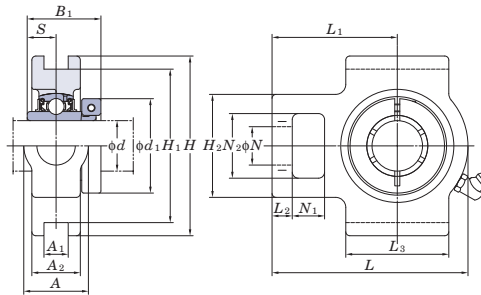

Shaft Dia. mm inch	Dimensions															
	inch mm															
<i>d</i>	A	A ₁	A ₂	H	H ₁	H ₂	L	L ₁	L ₂	L ₃	N	N ₁	N ₂	B ₁	S	<i>d</i> ₁
20 ^{3/4}	1 1/4	17/32	13/16	3 1/2	3	2	3 11/16	2 13/32	13/32	2	3/4	5/8	1 1/4	1 9/32	0.500	1 3/4
	32	13.5	21	89	76.2	51	94	61	10	51	19	16	32	32.5	12.7	44.5
25 ^{7/8} ^{15/16}	1 1/4	17/32	15/16	3 1/2	3	2	3 13/16	2 7/16	13/32	2	3/4	5/8	1 1/4	1 7/16	0.563	1 15/16
	32	13.5	24	89	76.2	51	97	62	10	51	19	16	32	36.5	14.3	49.2
30 ^{1 1/8} ^{1 3/16} ^{1 1/4}	1 15/32	17/32	1 3/32	4 1/32	3 1/2	2 7/32	4 7/16	2 3/4	13/32	2 1/4	7/8	5/8	1 15/32	1 9/16	0.626	2 3/16
	37	13.5	28	102	88.9	56	113	70	10	57	22	16	37	39.7	15.9	55.6
35 ^{1 1/4} ^{1 3/8} ^{1 7/16}	1 15/32	17/32	1 3/16	4 1/32	3 1/2	2 17/32	5 3/32	3 1/16	1/2	2 17/32	7/8	5/8	1 15/32	1 3/4	0.689	2 7/16
	37	13.5	30	102	88.9	64	129	78	13	64	22	16	37	44.5	17.5	61.9
40 ^{1 3/8} ^{1 7/16}	1 15/32	17/32	1 3/16	4 1/32	3 1/2	2 17/32	5 3/32	3 1/16	1/2	2 17/32	7/8	5/8	1 15/32	1 3/4	0.689	2 9/16
	37	13.5	30	102	88.9	64	129	78	13	64	22	16	37	44.5	17.5	65.1
45 ^{1 1/2} ^{1 5/8}	1 15/16	11/16	1 5/16	4 1/2	4	3 9/32	5 21/32	3 15/32	5/8	3 9/32	1 5/32	3/4	1 15/16	2	0.748	2 11/16
	49	17.5	33	114	101.6	83	144	88	16	83	29	19	49	50.8	19	68.3
50 ^{1 11/16} ^{1 3/4}	1 15/16	11/16	1 3/8	4 19/32	4	3 9/32	5 21/32	3 7/16	5/8	3 9/32	1 5/32	3/4	1 15/16	2	0.748	2 13/16
	49	17.5	35	117	101.6	83	144	87	16	83	29	19	49	50.8	19	71.4
55 ^{1 15/16} ²	1 15/16	11/16	1 15/32	4 19/32	4	3 9/32	5 7/8	3 17/32	5/8	3 3/8	1 5/32	3/4	1 15/16	2 3/32	0.748	3 3/8
	49	17.5	37	117	101.6	83	149	90	16	86	29	19	49	53.1	19	85.7
60 ² ^{2 3/16}	2 17/32	1 1/16	1 1/2	5 3/4	5 1/8	4 1/32	6 23/32	4 3/16	3/4	3 3/4	1 3/8	31/32	2 17/32	2 1/4	0.874	3 1/2
	64	27	38	146	130.17	102	171	106	19	95	35	25	64	57.1	22.2	88.9
60 ^{2 1/4} ^{2 3/16}	2 17/32	1 1/16	1 1/2	5 3/4	5 1/8	4 1/32	6 23/32	4 3/16	3/4	3 3/4	1 3/8	31/32	2 17/32	2 1/4	0.874	3 5/8
	64	27	38	146	130.17	102	171	106	19	95	35	25	64	57.1	22.2	92.1
60 ^{2 1/4} ^{2 7/16}	2 17/32	1 1/16	1 21/32	5 3/4	5 1/8	4 1/32	7 5/8	4 11/16	3/4	4 1/32	1 3/8	1 1/4	2 17/32	2 5/8	1.000	4 1/16
	64	27	42	146	130.17	102	194	119	19	102	35	32	64	66.7	25.4	103.2
60 ^{2 1/4} ^{2 7/16}	2 17/32	1 1/16	1 21/32	5 3/4	5 1/8	4 1/32	7 5/8	4 11/16	3/4	4 1/32	1 3/8	1 1/4	2 17/32	2 5/8	1.000	4 1/8
	64	27	42	146	130.17	102	194	119	19	102	35	32	64	66.7	25.4	104.8

Remarks 1. In Part No. of unit, fitting codes follow bore diameter codes. (See **Table 10.5** in P.62.)
2. Part No. of applicable grease fittings are shown below.
B-1/4-28UNF 204~210
B-R1/8 211~212



Variations of tolerance of groove width (Δ_{A1s}), variations of tolerance of distance between both grooves (Δ_{H1s}), and tolerance of symmetry of both groove sides (X)

Unit: mm

Housing No.	Δ_{A1s}	Δ_{H1s}	X
T204E~T210E	+0.2 0	0 -0.5	0.5
T211E~T212E	+0.3 0	0 -0.8	0.6

Unit No.	Housing No.	Bearing No.	Basic Load Ratings kN		Factor f_0	Mass kg
			C_r	C_{0r}		
NCT204-12E NCT204E	T204E	NC204-12 NC204	12.8	6.65	13.2	0.9
NCT205-14E NCT205-15E NCT205E NCT205-16E	T205E	NC205-14 NC205-15 NC205 NC205-16	14.0	7.85	13.9	1.0
NCT206-18E NCT206E NCT206-19E NCT206-20E	T206E	NC206-18 NC206 NC206-19 NC206-20	19.5	11.3	13.9	1.5
NCT207-20E	T207E	NC207-20	25.7	15.4	13.9	1.9
NCT207-22E NCT207E NCT207-23E	T207E	NC207-22 NC207 NC207-23	25.7	15.4	13.9	1.9
NCT208-24E NCT208E	T208E	NC208-24 NC208	29.1	17.8	14.0	2.9
NCT209-26E	T209E	NC209-26	34.1	21.3	14.0	2.8
NCT209-27E NCT209-28E NCT209E	T209E	NC209-27 NC209-28 NC209	34.1	21.3	14.0	2.8
NCT210-31E NCT210E NCT210-32E	T210E	NC210-31 NC210 NC210-32	35.1	23.3	14.4	3.2
NCT211-32E	T211E	NC211-32	43.4	29.4	14.4	4.4
NCT211E NCT211-35E	T211E	NC211 NC211-35	43.4	29.4	14.4	4.4
NCT212-36E	T212E	NC212-36	52.4	36.2	14.4	5.6
NCT212E NCT212-39E	T212E	NC212 NC212-39	52.4	36.2	14.4	5.6

3. For the dimensions and forms of applicable bearings, see the dimensional tables of ball bearing for unit.
4. Representative examples of the forms of housing are indicated.



Take-Up Units

UKT

Tapered bore (with adapter)

d_1 20 ~ 50 mm

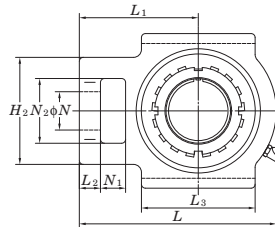
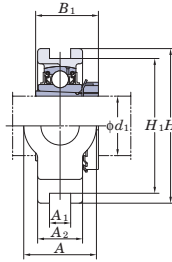

Shaft Dia. mm inch	Dimensions															Unit No.	Standard Housing No.	Bearing No.
	inch mm																	
d_1	A	A ₁	A ₂	H	H ₁	H ₂	L	L ₁	L ₂	L ₃	N	N ₁	N ₂	B ₁				
20	3/4	1 1/4	15/32	15/16	3 1/2	2 63/64	2	3 13/16	2 7/16	13/32	2	3/4	5/8	1 1/4	1 3/8	UKT205	T205	UK205
	3/4	1 15/32	15/32	1 3/32	4 1/32	3 1/2	2 7/32	4 7/16	2 3/4	13/32	2 1/4	7/8	5/8	1 15/32	1 3/8	UKTX05	TX05	UKX05
	3/4	1 13/32	15/32	1 1/32	3 1/2	3 5/32	2 7/16	4 13/16	3	15/32	2 9/16	1 1/32	5/8	1 13/32	1 3/8	UKT305	T305	UK305
25	1	1 15/32	15/32	1 3/16	4 1/32	3 1/2	2 7/32	4 7/16	2 3/4	13/32	2 1/4	7/8	5/8	1 15/32	1 1/2	UKT206	T206	UK206
	1	1 15/32	15/32	1 3/16	4 1/32	3 1/2	2 17/32	5 3/32	3 1/16	1/2	2 17/32	7/8	5/8	1 15/32	1 1/2	UKTX06	TX06	UKX06
	1	1 5/8	5/8	1 3/32	3 15/16	3 35/64	2 3/4	5 13/32	3 11/32	9/16	2 29/32	1 3/32	23/32	1 5/8	1 1/2	UKT306	T306	UK306
30	1 1/8	1 15/32	15/32	1 3/16	4 1/32	3 1/2	2 17/32	5 3/32	3 1/16	1/2	2 17/32	7/8	5/8	1 15/32	1 11/16	UKT207	T207	UK207
	1 1/8	1 15/16	5/8	1 13/32	4 1/2	4 1/64	3 9/32	5 21/32	3 15/32	19/32	3 9/32	1 5/32	3/4	1 15/16	1 11/16	UKTX07	TX07	UKX07
	1 1/8	1 25/32	5/8	1 1/4	4 3/8	3 15/16	2 15/16	5 29/32	3 11/16	19/32	3 5/32	1 3/16	25/32	1 25/32	1 11/16	UKT307	T307	UK307
35	1 1/4	1 15/16	5/8	1 5/16	4 1/2	4 1/64	3 9/32	5 21/32	3 15/32	5/8	3 9/32	1 5/32	3/4	1 15/16	1 13/16	UKT208	T208	UK208
	1 1/4	1 15/16	5/8	1 13/32	4 19/32	4 1/64	3 9/32	5 21/32	3 7/16	19/32	3 9/32	1 5/32	3/4	1 15/16	1 13/16	UKTX08	TX08	UKX08
	1 1/4	1 31/32	45/64	1 11/32	4 7/8	4 13/32	3 9/32	6 3/8	3 15/16	21/32	3 1/2	1 1/4	7/8	1 31/32	1 13/16	UKT308	T308	UK308
40	1 1/2	1 15/16	5/8	1 3/8	4 19/32	4 1/64	3 9/32	5 21/32	3 7/16	5/8	3 9/32	1 5/32	3/4	1 15/16	1 31/32	UKT209	T209	UK209
	1 1/2	1 15/16	5/8	1 1/2	4 19/32	4 1/64	3 9/32	5 7/8	3 17/32	5/8	3 3/8	1 5/32	3/4	1 15/16	1 31/32	UKTX09	TX09	UKX09
	1 1/2	2 5/32	45/64	1 1/2	5 7/16	4 59/64	3 17/32	7	4 11/32	23/32	3 13/16	1 11/32	15/16	2 5/32	1 31/32	UKT309	T309	UK309
45	1 3/4	1 15/16	5/8	1 15/32	4 19/32	4 1/64	3 9/32	5 7/8	3 17/32	5/8	3 3/8	1 5/32	3/4	1 15/16	2 5/32	UKT210	T210	UK210
	1 3/4	2 17/32	55/64	1 21/32	5 3/4	5 1/8	4 1/32	6 23/32	4 3/16	3/4	3 3/4	1 3/8	31/32	2 17/32	2 5/32	UKTX10	TX10	UKX10
	1 3/4	2 13/32	25/32	1 9/16	5 15/16	5 33/64	3 27/32	7 17/32	4 19/32	25/32	4 3/16	1 15/32	1 1/16	2 13/32	2 5/32	UKT310	T310	UK310
50	1 7/8	2 17/32	55/64	1 1/2	5 3/4	5 1/8	4 1/32	6 23/32	4 3/16	3/4	3 3/4	1 3/8	31/32	2 17/32	2 5/16	UKT211	T211	UK211
	2	2 17/32	55/64	1 23/32	5 3/4	5 1/8	4 1/32	7 5/8	4 11/16	3/4	4 1/32	1 3/8	1 1/4	2 17/32	2 5/16	UKTX11	TX11	UKX11
	2	2 19/32	55/64	1 23/32	6 13/32	5 29/32	4 1/8	8 5/32	5	13/16	4 17/32	1 17/32	1 5/32	2 19/32	2 5/16	UKT311	T311	UK311

Remarks 1. In Part No. of unit and units with covers, fitting codes follow bore diameter numbers. (See Table 10.5 in P.62)
 2. Part No. of applicable grease fittings are shown below.
 B-1/4-28UNF 205~210, X05~X09, 305~308
 B-R1/8 211~217, X10~X17, 309~328
 3. In Part No. of unit with adapters and bearing with adapters, Part No. of applicable adapter follow the Part No. shown in the dimensional tables.
 (Example of Part No. : UKT206J + H2306X, UK206 + H2306X)



With Pressed Steel Cover

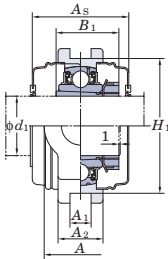

With Cast Iron Cover

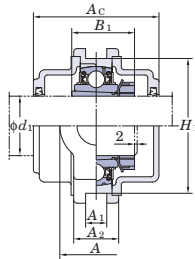

Variations of tolerance of groove width (ΔA_{1s}), variations of tolerance of distance between both grooves (ΔH_{1s}), and tolerance of symmetry of both groove sides (X)

Housing No.		ΔA_{1s}	ΔH_{1s}	X
T205~T210	TX05~TX10	+0.2 0	0 -0.5	0.5
T211~T217	TX11~TX17	+0.3 0	0 -0.8	0.6 0.7 0.8

Form and dimension of L_c of T205/E3 (housing with cast iron cover) are shown below.

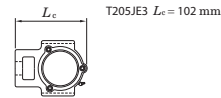

Adapter No.	Mass kg	Basic Load Ratings kN		Factor f_0	With Pressed Steel Cover			With Cast Iron Cover				
		C_r	C_{Or}		Unit No.		Dimension mm inch	Mass kg	Unit No.		Dimension mm inch	Mass kg
					Open Type	One Side Closed Type			Open Type	One Side Closed Type		
HE2305X H2305X	0.88 0.88	14.0	7.85	13.9	—	—	—	—	—	—	—	—
HE2305X H2305X	1.3 1.3	19.5	11.3	13.9	UKT205C	UKT205CD	49 1 15/16	0.88	UKT205FC	UKT205FCD	66 2 19/32	1.3
HE2305X H2305X	1.5 1.5	21.2	10.9	12.6	—	—	—	—	—	—	—	—
H2306X HE2306X	1.3 1.3	19.5	11.3	13.9	UKT206C	UKT206CD	53 2 3/32	1.3	UKT305C	UKT305CD	76 3	2.1
H2306X HE2306X	1.7 1.7	25.7	15.4	13.9	UKT206C	UKT206CD	53 2 3/32	1.3	UKT206FC	UKT206FCD	70 2 3/4	1.8
H2306X HE2306X	1.7 1.7	25.7	15.4	13.9	UKTX06C	UKTX06CD	60 2 3/8	1.7	—	—	—	—
H2306X HE2306X	1.9 1.9	26.7	15.0	13.3	—	—	—	—	—	—	—	—
H2306X HE2306X	1.9 1.9	26.7	15.0	13.3	—	—	—	—	—	—	—	—
HS2307X H2307X	1.7 1.7	25.7	15.4	13.9	—	—	—	—	—	—	—	—
HS2307X H2307X	2.6 2.6	29.1	17.8	14.0	UKT207C	UKT207CD	60 2 3/8	1.7	UKT207FC	UKT207FCD	78 3 1/16	2.5
HS2307X H2307X	2.4 2.4	33.4	19.3	13.2	—	—	—	—	—	—	—	—
HE2308X HS2308X	2.5 2.5	29.1	17.8	14.0	—	—	—	—	—	—	—	—
H2308X	2.5	—	—	—	UKT208C	UKT208CD	69 2 23/32	2.5	UKT208FC	UKT208FCD	86 3 3/8	3.4
HE2308X HS2308X	2.6 2.6	34.1	21.3	14.0	—	—	—	—	—	—	—	—
H2308X	2.6	—	—	—	UKTX08C	UKTX08CD	69 2 23/32	2.6	—	—	—	—
HE2308X HS2308X	3.0 3.0	40.7	24.0	13.2	—	—	—	—	—	—	—	—
H2308X	3.0	—	—	—	—	—	—	—	UKT308C	UKT308CD	96 3 25/32	4.0
HE2309X H2309X	2.5 2.5	34.1	21.3	14.0	—	—	—	—	—	—	—	—
HE2309X H2309X	2.9 2.9	35.1	23.3	14.4	UKT209C	UKT209CD	69 2 23/32	2.5	UKT209FC	UKT209FCD	88 3 15/32	3.4
HE2309X H2309X	4.2 4.2	48.9	29.5	13.3	—	—	—	—	—	—	—	—
HE2309X H2309X	4.2 4.2	48.9	29.5	13.3	—	—	—	—	UKT309C	UKT309CD	102 4 1/32	5.5
HE2310X H2310X	2.7 2.7	35.1	23.3	14.4	—	—	—	—	—	—	—	—
HE2310X H2310X	4.4 4.4	43.4	29.4	14.4	UKT210C	UKT210CD	74 2 29/32	2.7	UKT210FC	UKT210FCD	97 3 13/16	3.8
HE2310X H2310X	5.0 5.0	62.0	38.3	13.2	—	—	—	—	—	—	—	—
HE2310X H2310X	5.0 5.0	62.0	38.3	13.2	—	—	—	—	UKT310C	UKT310CD	110 4 11/32	6.7
HS2311X H2311X	4.1 4.1	43.4	29.4	14.4	—	—	—	—	—	—	—	—
HE2311X	4.1	—	—	—	UKT211C	UKT211CD	76 3	4.1	UKT211FC	UKT211FCD	99 3 29/32	5.4
HE2311X	4.1	—	—	—	—	—	—	—	—	—	—	—
HS2311X H2311X	5.1 5.1	52.4	36.2	14.4	—	—	—	—	—	—	—	—
HE2311X	5.1	—	—	—	UKTX11C	UKTX11CD	89 3 1/2	5.1	—	—	—	—
HE2311X	5.1	—	—	—	—	—	—	—	—	—	—	—
HE2311X	6.4	—	—	—	—	—	—	—	—	—	—	—
H2311X HE2311X	6.4 6.4	71.6	45.0	13.2	—	—	—	—	UKT311C	UKT311CD	114 4 1/2	8.3

- As for the triple seal type product (205 is the double seal type product), suffix code L3 (or L2) follows the Part No. of unit or bearing. (Example of Part No. : UKT206JL3 + H2306X, UK206L3 + H2306X)
- For the dimensions and forms of applicable bearings and adapters, see the dimensional tables of ball bearing for unit and adapter.
- Housings of nodular graphite cast iron are also available.



Take-Up Units

UKT

Tapered bore (with adapter)

d₁ 55 ~ 125 mm

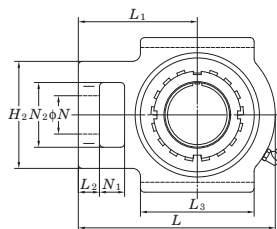
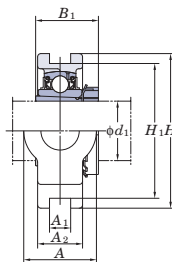

Shaft Dia. mm inch	Dimensions															Unit No.	Standard Housing No.	Bearing No.
	inch mm																	
d ₁	A	A ₁	A ₂	H	H ₁	H ₂	L	L ₁	L ₂	L ₃	N	N ₁	N ₂	B ₁				
55	2 1/8 64	2 17/32 55/64	1 21/32 42	5 3/4 146	5 1/8 130	4 1/32 102	7 5/8 194	4 11/16 119	3/4 19	4 1/32 102	1 3/8 35	1 1/4 32	2 17/32 64	2 7/16 62	UKT212	T212	UK212	
	2 3/4 70	1 1/32 26	1 7/8 48	6 9/16 167	5 15/16 151	4 3/8 111	8 13/16 224	5 13/32 137	13/16 21	4 3/4 121	1 5/8 41	1 1/4 32	2 3/4 70	2 7/16 62	UKTX12	TX12	UKX12	
	2 1/8 71	2 25/32 64	1 13/16 46	7 178	6 19/64 160	4 7/16 113	8 21/32 220	5 5/16 135	29/32 23	4 27/32 123	1 5/8 41	1 7/32 31	2 25/32 71	2 7/16 62	UKT312	T312	UK312	
60	2 3/4 70	1 1/32 26	1 23/32 44	6 9/16 167	5 15/16 151	4 3/8 111	8 13/16 224	5 13/32 137	13/16 21	4 3/4 121	1 5/8 41	1 1/4 32	2 3/4 70	2 9/16 65	UKT213	T213	UK213	
	2 3/8 70	1 1/32 26	1 7/8 48	6 9/16 167	5 15/16 151	4 3/8 111	8 13/16 224	5 13/32 137	13/16 21	4 3/4 121	1 5/8 41	1 1/4 32	2 3/4 70	2 9/16 65	UKTX13	TX13	UKX13	
	2 1/4 80	3 5/32 26	1 1/32 50	1 31/32 75	7 15/32 190	6 11/16 170	4 9/16 116	9 3/8 238	5 3/4 146	31/32 25	5 9/32 134	1 11/16 43	1 1/4 32	2 3/4 70	2 9/16 65	UKT313	T313	UK313
	2 3/8 80	3 5/32 26	1 1/32 50	1 31/32 75	7 15/32 190	6 11/16 170	4 9/16 116	9 3/8 238	5 3/4 146	31/32 25	5 9/32 134	1 11/16 43	1 1/4 32	2 3/4 70	2 9/16 65	UKTX13	TX13	UKX13
65	2 1/2 70	2 3/4 26	1 1/32 48	1 13/16 167	5 15/16 151	4 3/8 111	8 13/16 232	5 13/32 140	13/16 21	4 3/4 121	1 5/8 41	1 1/4 32	2 3/4 70	2 7/8 73	UKT215	T215	UK215	
	2 1/2 70	2 3/4 28	1 7/64 48	1 7/8 184	6 1/2 165	4 3/8 111	8 13/16 235	5 1/2 140	13/16 21	4 3/4 121	1 5/8 41	1 1/4 32	2 3/4 70	2 7/8 73	UKTX15	TX15	UKX15	
	2 1/2 90	3 17/32 26	1 1/32 55	2 5/32 216	8 1/2 192	7 9/16 132	10 5/16 262	6 5/16 160	31/32 25	5 29/32 150	1 13/16 46	1 13/32 36	3 11/32 85	2 7/8 73	UKT315	T315	UK315	
70	2 3/4 70	2 3/4 26	1 1/32 51	2 184	7 1/4 165	6 1/2 111	8 13/16 235	5 1/2 140	13/16 21	4 3/4 121	1 5/8 41	1 1/4 32	2 3/4 70	3 1/16 78	UKT216	T216	UK216	
	2 3/4 73	2 7/8 28	1 7/64 54	2 1/8 198	7 25/32 173	6 13/16 124	4 7/8 260	6 3/8 162	1 3/32 28	6 3/16 157	1 7/8 48	1 1/2 38	2 7/8 73	3 1/16 78	UKTX16	TX16	UKX16	
	2 3/4 102	4 1/32 30	1 3/16 60	2 3/8 230	9 1/16 204	8 1/32 150	11 3/32 282	6 27/32 174	1 3/32 28	6 5/16 160	2 3/32 53	2 3/32 42	3 27/32 98	2 7/8 78	UKT316	T316	UK316	
75	3 73	2 7/8 30	1 3/16 54	2 1/8 198	7 25/32 173	6 13/16 124	4 7/8 260	6 3/8 162	1 5/32 29	6 3/16 157	1 7/8 48	1 1/2 38	2 7/8 73	3 7/32 82	UKT217	T217	UK217	
	3 73	2 7/8 28	1 7/64 54	2 1/8 198	7 25/32 173	6 13/16 124	4 7/8 260	6 3/8 162	1 3/32 28	6 3/16 157	1 7/8 48	1 1/2 38	2 7/8 73	3 7/32 82	UKTX17	TX17	UKX17	
	3 102	4 1/32 32	1 17/64 64	2 17/32 240	9 7/16 214	8 27/64 152	11 23/32 298	7 7/32 183	1 3/16 30	6 11/16 170	2 3/32 53	1 21/32 42	3 27/32 98	3 7/32 82	UKT317	T317	UK317	
80	— 110	4 11/32 32	1 17/64 66	2 19/32 255	10 1/32 228	8 21/32 160	6 5/16 312	12 9/32 192	7 9/16 30	1 3/16 175	6 7/8 57	2 1/4 46	1 13/16 106	3 3/8 86	UKT318	T318	UK318	
85	3 1/4 110	4 11/32 35	1 3/8 72	2 27/32 270	10 5/8 240	9 29/64 165	6 1/2 322	12 11/16 197	7 3/4 31	1 7/32 180	7 3/32 57	2 1/4 46	1 13/16 106	3 17/32 90	UKT319	T319	UK319	
90	3 1/2 120	4 23/32 35	1 3/8 75	2 15/16 290	11 13/32 260	10 15/64 175	6 7/8 345	13 19/32 210	8 9/32 32	1 1/4 200	7 7/8 59	2 3/16 48	1 7/8 115	4 17/32 97	UKT320	T320	UK320	
100	4 130	5 1/8 38	1 1/2 80	3 5/32 320	12 19/32 285	11 7/32 185	7 9/32 385	15 5/32 235	9 1/4 38	1 1/2 215	8 15/32 65	2 9/16 52	2 1/16 125	4 29/32 105	UKT322	T322	UK322	
110	— 140	5 1/2 45	1 49/64 90	3 17/32 355	13 31/32 320	12 9/32 210	8 9/32 432	17 267	10 1/2 42	1 21/32 230	9 1/16 70	2 3/4 60	2 3/8 140	5 1/2 112	UKT324	T324	UK324	
115	4 1/2 150	5 29/32 50	1 31/32 100	3 15/16 385	15 5/32 350	13 25/32 220	8 21/32 465	18 5/16 285	11 7/32 45	1 25/32 240	9 7/16 75	2 15/16 65	2 9/16 150	4 3/4 121	UKT326	T326	UK326	
125	— 155	6 3/32 50	1 31/32 100	3 15/16 415	16 11/32 380	14 61/64 230	9 1/16 515	20 9/32 315	12 13/32 50	1 31/32 255	10 1/32 80	3 3/32 70	2 3/4 160	5 5/32 131	UKT328	T328	UK328	

Remarks 1. In Part No. of unit and units with covers, fitting codes follow bore diameter numbers. (See Table 10.5 in P62.)

2. Part No. of applicable grease fittings are shown below.

B-1/4-28UNF 205~210, X05~X09, 305~308

B-R1/8 211~217, X10~X17, 309~328

3. In Part No. of unit with adapters and bearing with adapters, Part No. of applicable adapter follow the Part No. shown in the dimensional tables.
(Example of Part No. : UKT206J + H2306X, UK206 + H2306X)



With Pressed Steel Cover

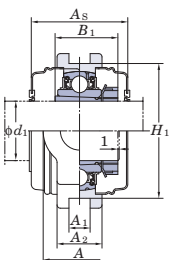

With Cast Iron Cover

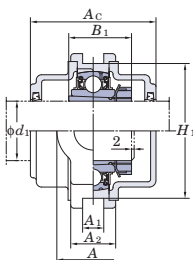

Variations of tolerance of groove width (ΔA_{1s}), variations of tolerance of distance between both grooves (ΔH_{1s}), and tolerance of symmetry of both groove sides (X)

Housing No.		ΔA_{1s}	ΔH_{1s}	X
T205~T210	TX05~TX10	+0.2 0	0 -0.5	0.5
T211~T217	TX11~TX17	+0.3 0	0 -0.8	0.6 0.7 0.8

Unit: mm

Form and dimension of L_c of T205/E3 (housing with cast iron cover) are shown below.

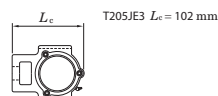

T205/E3 $L_c = 102$ mm

Adapter No.	Mass kg	Basic Load Ratings kN		Factor f_0	With Pressed Steel Cover			With Cast Iron Cover				
		C_r	C_{0r}		Unit No.		Dimension mm inch	Mass kg	Unit No.		Dimension mm inch	Mass kg
					Open Type	One Side Closed Type			Open Type	One Side Closed Type		
HS2312X	4.8											
H2312X	4.8	52.4	36.2	14.4	—	—	—	—	—	—	—	—
HS2312X	7.3				UKT212C	UKT212CD	89 3 1/2	4.8	UKT212FC	UKT212FCD	114 4 1/2	6.3
H2312X	7.3	57.2	40.1	14.4	—	—	—	—	—	—	—	—
HS2312X	7.5				UKTX12C	UKTX12CD	89 3 1/2	7.3	—	—	—	—
H2312X	7.5	81.9	52.2	13.2	—	—	—	—	UKT312C	UKT312CD	124 4 7/8	9.9
HE2313X	6.8				—	—	—	—	—	—	—	—
H2313X	6.8	57.2	40.1	14.4	UKT213C	UKT213CD	89 3 1/2	6.8	UKT213FC	UKT213FCD	114 4 1/2	8.5
HS2313X	6.8				—	—	—	—	—	—	—	—
HE2313X	7.2				UKTX13C	UKTX13CD	99 3 29/32	7.2	—	—	—	—
H2313X	7.2	62.2	44.1	14.5	—	—	—	—	—	—	—	—
HS2313X	7.2				—	—	—	—	—	—	—	—
HE2313X	9.4				—	—	—	—	—	—	—	—
H2313X	9.4	92.7	59.9	13.2	—	—	—	—	UKT313C	UKT313CD	122 4 13/16	11.6
HS2313X	9.4				—	—	—	—	—	—	—	—
HE2315X	7.4				—	—	—	—	—	—	—	—
H2315X	7.4	67.4	48.3	14.5	UKT215C	UKT215CD	99 3 29/32	7.4	UKT215FC	UKT215FCD	124 4 7/8	9.4
HE2315X	8.4				—	—	—	—	—	—	—	—
H2315X	8.4	72.7	53.0	14.6	UKTX15C	UKTX15CD	109 4 9/32	8.4	—	—	—	—
HE2315X	13.1				—	—	—	—	—	—	—	—
H2315X	13.1	113	77.2	13.2	—	—	—	—	UKT315C	UKT315CD	134 5 9/32	15.9
HE2316X	8.5				—	—	—	—	—	—	—	—
H2316X	8.5	72.7	53.0	14.6	UKT216C	UKT216CD	109 4 9/32	8.5	UKT216FC	UKT216FCD	138 5 7/16	11.0
HE2316X	11.8				—	—	—	—	—	—	—	—
H2316X	11.8	84.0	61.9	14.5	UKTX16C	UKTX16CD	113 4 7/16	11.8	—	—	—	—
HE2316X	16.3				—	—	—	—	—	—	—	—
H2316X	16.3	123	86.7	13.3	—	—	—	—	UKT316C	UKT316CD	138 5 7/16	19.4
H2317X	11.2				UKT217C	UKT217CD	113 4 7/16	11.2	UKT217FC	UKT217FCD	142 5 19/32	14.0
HE2317X	11.2	84.0	61.9	14.5	—	—	—	—	—	—	—	—
H2317X	11.4				UKTX17C	UKTX17CD	123 4 27/32	11.4	—	—	—	—
HE2317X	11.4	96.1	71.5	14.5	—	—	—	—	—	—	—	—
H2317X	18.9				—	—	—	—	UKT317C	UKT317CD	146 5 3/4	22.4
HE2317X	18.9	133	96.8	13.3	—	—	—	—	—	—	—	—
H2318X	21.7	143	107	13.3	—	—	—	—	UKT318C	UKT318CD	150 5 29/32	25.9
HE2319X	25.2				—	—	—	—	—	—	—	—
H2319X	25.2	153	119	13.3	—	—	—	—	UKT319C	UKT319CD	162 6 3/8	29.9
HE2320X	30.4				—	—	—	—	—	—	—	—
H2320X	30.4	173	141	13.2	—	—	—	—	UKT320C	UKT320CD	174 6 27/32	36.6
H2322X	39.5				—	—	—	—	UKT322C	UKT322CD	188 7 13/32	46.4
HE2322X	39.5	205	180	13.2	—	—	—	—	—	—	—	—
H2324	54.7	207	185	13.5	—	—	—	—	UKT324C	UKT324CD	196 7 23/32	65.0
HE2326	69.1				—	—	—	—	—	—	—	—
H2326	69.1	229	214	13.6	—	—	—	—	UKT326C	UKT326CD	214 8 7/16	82.4
H2328	85.1	253	246	13.6	—	—	—	—	UKT328C	UKT328CD	222 8 3/4	102

- As for the triple seal type product (205 is the double seal type product), suffix code L3 (or L2) follows the Part No. of unit or bearing. (Example of Part No. : UKT206JL3 + H2306X, UK206L3 + H2306X)
- For the dimensions and forms of applicable bearings and adapters, see the dimensional tables of ball bearing for unit and adapter.
- Housings of nodular graphite cast iron are also available.



Take-Up Units

UCTRS
Cylindrical bore (with set screws)
d 25 ~ 35 mm

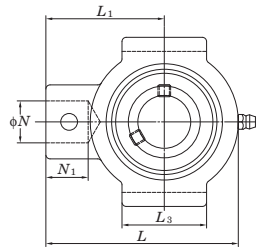
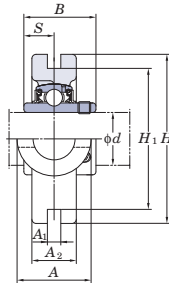

Shaft Dia.		Dimensions													Standard		
mm	inch	inch mm													Unit No.	Housing No.	Bearing No.
d		A	A ₁	A ₂	H	H ₁	L	L ₁	L ₃	N	N ₁	B	S				
25	7/8	1 3/8	1/4	13/16	3 5/32	2 5/8	3 19/32	2 7/32	1 9/16	25/32	25/32	1.343	0.563	UCTRS205-14 UCTRS205-15 UCTRS205 UCTRS205-16	TRS205	UC205-14 UC205-15 UC205 UC205-16	
	15/16	35	6.35	21	80	66.7	91	56	40	19.84	20	34.1	14.3				
30	1 1/8	1 3/8	1/4	15/16	4 1/8	3 1/2	4 11/32	2 11/16	2 17/32	3/4	15/16	1.500	0.626	UCTRS206-18 UCTRS206 UCTRS206-19 UCTRS206-20	TRS206	UC206-18 UC206 UC206-19 UC206-20	
	1 3/16	35	6.35	24	105	88.9	110	68	64	19.05	24	38.1	15.9				
	1 1/4																
35	1 1/4	1 3/8	1/4	31/32	4 1/8	3 1/2	4 1/2	2 11/16	2 17/32	3/4	15/16	1.689	0.689	UCTRS207-20 UCTRS207-21 UCTRS207-22 UCTRS207 UCTRS207-23	TRS207	UC207-20 UC207-21 UC207-22 UC207 UC207-23	
	1 5/16	35	6.35	25	105	88.9	114	68	64	19.05	24	42.9	17.5				
	1 3/8																
	1 7/16																

- Remarks
1. Part No. of applicable grease fittings are shown below.
A-1/4-28UNF205~207
 2. As for the triple seal type product (from 205 is the double seal type products), suffix code L3 (L2) follows the Part No. of unit or bearing.
(Example of Part No. : UCTRS206JL3, UC206L3)
 3. As for the dimensions and forms of applicable bearings, see the dimensional tables of ball bearing for unit.
 4. Housings of nodular graphite cast iron are also available.



FYH

Variations of tolerance of groove width (Δ_{A1s}), variations of tolerance of distance between both grooves (Δ_{H1s}), and tolerance of symmetry of both groove sides (X)

Unit: mm

Housing No.	Δ_{A1s}	Δ_{H1s}	X
TRS205~TRS207	+0.2 0	0 -0.5	0.5

	Basic Load Ratings kN		Factor	Mass
	C_r	C_{0r}	f_0	kg
	14.0	7.85	13.9	0.68 0.66 0.65 0.65
	19.5	11.3	13.9	1.25 1.23 1.23 1.21
	25.7	15.4	13.9	1.35 1.31 1.29 1.29 1.26



Corrosion Resistant Series Take-Up Units

UCST-H1S6

Cylindrical bore (with set screws)

d 20 ~ 50 mm

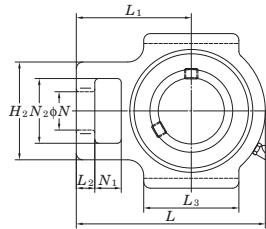
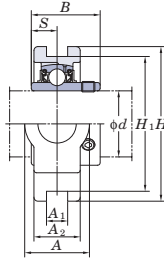

Shaft Dia. mm inch	Dimensions inch mm																Unit No.
	A	A ₁	A ₂	H	H ₁	H ₂	L	L ₁	L ₂	L ₃	N	N ₁	N ₂	B	S		
20 3/4	1 1/4	15/32	29/32	3 1/2	2 63/64	1 13/16	3 1/2	2 5/16	11/32	1 23/32	3/4	23/32	1 1/4	1.220	0.500	UCST204-12H1S6 UCST204H1S6	
	32	12	23	89	76	46	89	59	9	44	19	18	32	31	12.7		
25 7/8 15/16	1 1/4	15/32	31/32	3 1/2	2 63/64	1 13/16	3 21/32	2 3/8	11/32	1 23/32	3/4	23/32	1 1/4	1.343	0.563	UCST205-14H1S6 UCST205-15H1S6 UCST205H1S6 UCST205-16H1S6	
	32	12	25	89	76	46	93	60	9	44	19	18	32	34.1	14.3		
30 1 1/8	1 15/32	15/32	1 1/16	4 1/32	3 1/2	2 1/16	4 3/16	2 5/8	11/32	1 31/32	7/8	23/32	1 15/32	1.500	0.626	UCST206-18H1S6 UCST206H1S6 UCST206-19H1S6 UCST206-20H1S6	
	37	12	27	102	89	52	106	67	9	50	22	18	37	38.1	15.9		
35 1 1/4 1 5/16 3/8	1 15/32	15/32	1 7/32	4 1/32	3 1/2	2 7/32	4 11/16	2 15/16	7/16	2 7/32	7/8	23/32	1 15/32	1.689	0.689	UCST207-20H1S6 UCST207-21H1S6 UCST207-22H1S6 UCST207H1S6 UCST207-23H1S6	
	37	12	31	102	89	56	119	75	11	56	22	18	37	42.9	17.5		
40 1 1/2 9/16	1 15/16	5/8	1 1/4	4 1/2	4 1/64	2 29/32	5 5/16	3 11/32	9/16	2 17/32	1 5/32	25/32	1 15/16	1.937	0.748	UCST208-24H1S6 UCST208-25H1S6 UCST208H1S6	
	49	16	32	114	102	74	135	85	14	64	29	20	49	49.2	19		
45 1 5/8 1 11/16 3/4	1 15/16	5/8	1 11/32	4 19/32	4 1/64	2 29/32	5 13/32	3 11/32	9/16	2 19/32	1 5/32	25/32	1 15/16	1.937	0.748	UCST209-26H1S6 UCST209-27H1S6 UCST209-28H1S6 UCST209H1S6	
	49	16	34	117	102	74	137	85	14	66	29	20	49	49.2	19		
50 1 7/8 1 15/16	1 15/16	5/8	1 3/8	4 19/32	4 1/64	2 29/32	5 5/8	3 7/16	9/16	2 27/32	1 5/32	25/32	1 15/16	2.031	0.748	UCST210-30H1S6 UCST210-31H1S6 UCST210H1S6 UCST210-32H1S6	
	49	16	35	117	102	74	143	87	14	72	29	20	49	51.6	19		

- Remarks
1. In Part No. of unit and units with covers, fitting codes follow bore diameter codes. (See **Table 10.5** in P.62.)
 2. Part No. of the applicable grease fitting is B-1/4-28UNFN12.
 3. For the dimensions and forms of applicable bearings, see the dimensional tables of ball bearing for unit.



With Pressed Stainless Steel Cover

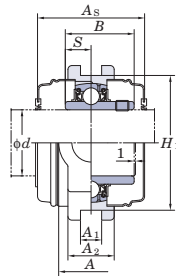

Variations of tolerance of groove width (ΔA_{1s}), variations of tolerance of distance between both grooves (ΔB_{1s}), and tolerance of symmetry of both groove sides (X)

Housing No.	Unit: mm		
	ΔA_{1s}	ΔB_{1s}	X
ST204H1~210H1	+0.2 0	0 -0.5	0.5

Housing No.	Bearing No.	Basic Load Ratings kN		Factor f_0	Mass kg	With Pressed Stainless Steel Cover			Mass kg	
						Unit No.		Dimension		
						Open Type	One Side Closed Type	mm		inch
ST204H1	UC204-12S6	10.9	5.35	13.2	0.73	-	-	-	-	
	UC204S6					UCST204H1CS6	UCST204H1CDS6	45	1 25/32	0.73
ST205H1	UC205-14S6	11.9	6.30	13.9	0.79	-	-	-	-	
	UC205-15S6					-	-	-	-	-
	UC205S6					UCST205H1CS6	UCST205H1CDS6	49	1 15/16	0.79
	UC205-16S6					-	-	-	-	-
ST206H1	UC206-18S6	16.5	9.05	13.9	1.1	-	-	-	-	
	UC206S6					UCST206H1CS6	UCST206H1CDS6	53	2 3/32	1.1
	UC206-19S6					-	-	-	-	-
	UC206-20S6					-	-	-	-	-
ST207H1	UC207-20S6	21.8	12.3	13.9	1.5	-	-	-	-	
	UC207-21S6					-	-	-	-	-
	UC207-22S6					UCST207H1CS6	UCST207H1CDS6	60	2 3/8	1.5
	UC207S6					-	-	-	-	-
ST208H1	UC208-24S6	24.8	14.3	14.0	2.0	-	-	-	-	
	UC208-25S6					UCST208H1CS6	UCST208H1CDS6	69	2 23/32	2.0
ST209H1	UC209-26S6	27.8	16.2	14.0	2.1	-	-	-	-	
	UC209-27S6					-	-	-	-	-
	UC209-28S6					UCST209H1CS6	UCST209H1CDS6	69	2 23/32	2.1
	UC209S6					-	-	-	-	-
ST210H1	UC210-30S6	29.8	18.6	14.4	2.3	-	-	-	-	
	UC210-31S6					-	-	-	-	-
	UC210S6					UCST210H1CS6	UCST210H1CDS6	74	2 29/32	2.3
	UC210-32S6					-	-	-	-	



Corrosion Resistant Series Take-Up Units

UCST-EH1S6
Cylindrical bore (with set screws)
d 20 ~ 50 mm

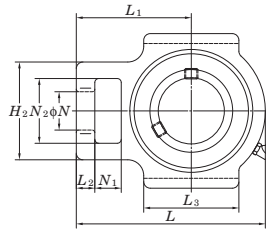
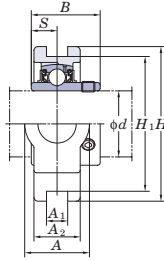

Shaft Dia. mm inch	Dimensions inch mm																Unit No.
	<i>d</i>	A	A ₁	A ₂	H	H ₁	H ₂	L	L ₁	L ₂	L ₃	N	N ₁	N ₂	B	S	
20 3/4	1 1/4	17/32	29/32	3 1/2	3	1 13/16	3 1/2	2 5/16	1 11/32	1 23/32	3/4	23/32	1 1/4	1.220	0.500	UCST204-12EH1S6	
	32	13.5	23	89	76.2	46	89	59	9	44	19	18	32	31	12.7	UCST204EH1S6	
25 7/8 15/16	1 1/4	17/32	31/32	3 1/2	3	1 13/16	3 21/32	2 3/8	1 11/32	1 23/32	3/4	23/32	1 1/4	1.343	0.563	UCST205-14EH1S6	
	32	13.5	25	89	76.2	46	93	60	9	44	19	18	32	34.1	14.3	UCST205-15EH1S6 UCST205EH1S6 UCST205-16EH1S6	
30 1 1/8	1 15/32	17/32	1 1/16	4 1/32	3 1/2	2 1/16	4 3/16	2 5/8	1 11/32	1 31/32	7/8	23/32	1 15/32	1.500	0.626	UCST206-18EH1S6	
	37	13.5	27	102	88.9	52	106	67	9	50	22	18	37	38.1	15.9	UCST206EH1S6 UCST206-19EH1S6 UCST206-20EH1S6	
35 1 1/4 1 5/16 3 3/8	1 15/32	17/32	1 7/32	4 1/32	3 1/2	2 7/32	4 11/16	2 15/16	7/16	2 7/32	7/8	23/32	1 15/32	1.689	0.689	UCST207-20EH1S6	
	37	13.5	31	102	88.9	56	119	75	11	56	22	18	37	42.9	17.5	UCST207-21EH1S6 UCST207-22EH1S6 UCST207EH1S6 UCST207-23EH1S6	
40 1 1/2 1 9/16	1 15/16	11/16	1 1/4	4 1/2	4	2 29/32	5 5/16	3 11/32	9/16	2 17/32	1 5/32	25/32	1 15/16	1.937	0.748	UCST208-24EH1S6	
	49	17.5	32	114	101.6	74	135	85	14	64	29	20	49	49.2	19	UCST208-25EH1S6 UCST208EH1S6	
45 1 5/8 1 11/16 1 3/4	1 15/16	11/16	1 11/32	4 19/32	4	2 29/32	5 13/32	3 11/32	9/16	2 19/32	1 5/32	25/32	1 15/16	1.937	0.748	UCST209-26EH1S6	
	49	17.5	34	117	101.6	74	137	85	14	66	29	20	49	49.2	19	UCST209-27EH1S6 UCST209-28EH1S6 UCST209EH1S6 UCST209EH1S6	
50 1 7/8 1 15/16	1 15/16	11/16	1 3/8	4 19/32	4	2 29/32	5 5/8	3 7/16	9/16	2 27/32	1 5/32	25/32	1 15/16	2.031	0.748	UCST210-30EH1S6	
	49	17.5	35	117	101.6	74	143	87	14	72	29	20	49	51.6	19	UCST210-31EH1S6 UCST210EH1S6 UCST210-32EH1S6	

Remarks 1. In Part No. of unit and units with covers, fitting codes follow bore diameter codes. (See Table 10.5 in P.62.)
2. Part No. of the applicable grease fitting is B-1/4-28UNFN12.
3. For the dimensions and forms of applicable bearings, see the dimensional tables of ball bearing for unit.



With Pressed Stainless Steel Cover

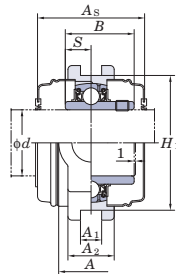

Variations of tolerance of groove width (ΔA_{1s}), variations of tolerance of distance between both grooves (ΔH_{1s}), and tolerance of symmetry of both groove sides (X)

Housing No.	ΔA_{1s}	ΔH_{1s}	X
ST204EH1~210EH1	+0.2 0	0 -0.5	0.5

Unit: mm

Housing No.	Bearing No.	Basic Load Ratings kN		Factor f_0	Mass kg	With Pressed Stainless Steel Cover				
						Unit No.		Dimension		Mass kg
						Open Type	One Side Closed Type	mm	inch	
C_r	C_{0r}			A_s						
ST204EH1	UC204-12S6	10.9	5.35	13.2	0.73	-	-	-	-	-
	UC204S6					UCST204EH1CS6	UCST204EH1CDS6	45	1 25/32	0.73
ST205EH1	UC205-14S6	11.9	6.30	13.9	0.79	-	-	-	-	-
	UC205-15S6					-	-	-	-	-
	UC205S6					UCST205EH1CS6	UCST205EH1CDS6	49	1 15/16	0.79
	UC205-16S6					-	-	-	-	-
ST206EH1	UC206-18S6	16.5	9.05	13.9	1.1	-	-	-	-	-
	UC206S6					UCST206EH1CS6	UCST206EH1CDS6	53	2 3/32	1.1
	UC206-19S6					-	-	-	-	-
	UC206-20S6					-	-	-	-	-
ST207EH1	UC207-20S6	21.8	12.3	13.9	1.5	-	-	-	-	-
	UC207-21S6					-	-	-	-	-
	UC207-22S6					UCST207EH1CS6	UCST207EH1CDS6	60	2 3/8	1.5
	UC207S6					-	-	-	-	-
ST208EH1	UC208-24S6	24.8	14.3	14.0	2.0	-	-	-	-	-
	UC208-25S6					UCST208EH1CS6	UCST208EH1CDS6	69	2 23/32	2.0
ST209EH1	UC209-26S6	27.8	16.2	14.0	2.1	-	-	-	-	-
	UC209-27S6					-	-	-	-	-
	UC209-28S6					-	-	-	-	-
	UC209S6					UCST209EH1CS6	UCST209EH1CDS6	69	2 23/32	2.1
ST210EH1	UC210-30S6	29.8	18.6	14.4	2.3	-	-	-	-	-
	UC210-31S6					-	-	-	-	-
	UC210S6					UCST210EH1CS6	UCST210EH1CDS6	74	2 29/32	2.3
	UC210-32S6					-	-	-	-	-



Section Steel Frame Take-Up Units

UCTH
Cylindrical bore (with set screws)
d 12 ~ 65 mm

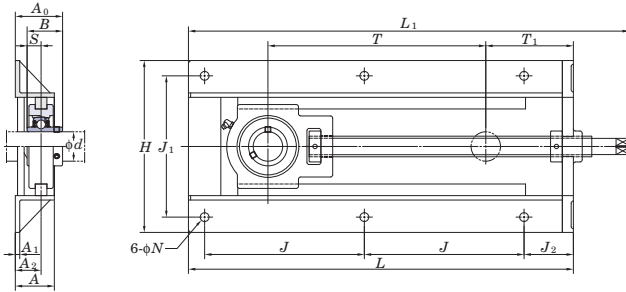

Shaft Dia. mm inch	Dimensions															Bolt Size inch mm	Standard Unit No.		
	<i>d</i>	<i>H</i>	<i>L</i>	<i>L</i> ₁	<i>A</i>	<i>J</i>	<i>J</i> ₁	<i>J</i> ₂	<i>N</i>	<i>T</i>	<i>T</i> ₁	<i>A</i> ₁	<i>A</i> ₂	<i>A</i> ₀	<i>B</i>			<i>S</i>	
12	1/2																	3/8	UCTH201-150 UCTH201-8-150
15	5/8	7 7/8	12 17/32	14 13/16	1 31/32	4 39/64	6 1/16	2 9/16	15/32	6 1/32	3 15/32	1/4	1 7/64	1 13/16	1.220	0.500	M10	UCTH202-150 UCTH202-10-150	
17	3/4	200	318	376	50	117	154	65	12	153	88	6	28	46.3	31	12.7		UCTH203-150 UCTH204-12-150 UCTH204-150	
20																			
25	7/8	7 7/8	12 17/32	14 27/32	1 31/32	4 39/64	6 1/16	2 9/16	15/32	5 31/32	3 15/32	1/4	1 7/64	1 7/8	1.343	0.563	M10	UCTH205-14-150 UCTH205-15-150 UCTH205-150	
	15/16	200	318	377	50	117	154	65	12	152	88	6	28	47.8	34.1	14.3		UCTH205-16-150	
	1																		
30	1 1/8	8 3/8	13 7/32	16 1/32	1 31/32	4 31/32	6 17/32	2 9/16	15/32	5 5/8	3 15/16	1/4	1 17/64	2 1/8	1.500	0.626	M10	UCTH206-18-150 UCTH206-150	
	1 3/16	213	336	407	50	126	166	65	12	143	100	6	32	54.2	38.1	15.9		UCTH206-19-150 UCTH206-20-150	
	1 1/4																		
35	1 5/16	8 3/8	16 15/16	19 11/16	1 31/32	6 13/16	6 17/32	2 9/16	15/32	8 5/8	4 7/32	1/4	1 17/64	2 1/4	1.689	0.689	M10	UCTH207-20-230 UCTH207-21-230 UCTH207-22-230 UCTH207-230	
	1 3/8	213	430	500	50	173	166	65	12	219	107	6	32	57.4	42.9	17.5		UCTH207-23-230	
	1 7/16																		
40	1 1/2	9 7/32	20 19/32	23 19/32	1 31/32	8 35/64	7 9/16	2 5/8	15/32	11 21/32	4 11/16	1/4	1 3/8	2 9/16	1.937	0.748	M10	UCTH208-24-300 UCTH208-25-300 UCTH208-300	
	1 9/16	234	523	599	50	217	192	67	12	296	119	6	35	65.2	49.2	19			
45	1 5/8	9 7/32	20 19/32	23 17/32	1 31/32	8 35/64	7 9/16	2 5/8	15/32	11 11/16	4 21/32	1/4	1 3/8	2 9/16	1.937	0.748	M10	UCTH209-26-300 UCTH209-27-300 UCTH209-28-300 UCTH209-300	
	1 11/16	234	523	598	50	217	192	67	12	297	118	6	35	65.2	49.2	19			
	1 3/4																		
50	1 7/8	9 7/32	20 3/4	23 3/4	1 31/32	8 5/8	7 9/16	2 5/8	19/32	11 21/32	4 3/4	1/4	1 3/8	2 21/32	2.031	0.748	7/16	UCTH210-30-300 UCTH210-31-300 UCTH210-300	
	1 15/16	234	527	603	50	219	192	67	15	296	121	6	35	67.6	51.6	19		UCTH210-32-300	
	2																		
55	2 1/8	11 31/32	21 15/32	24 3/4	2 9/16	9 1/16	9 7/16	2 15/32	19/32	11 15/32	5 9/16	1/4	1 1/2	2 13/16	2.189	0.874	7/16	UCTH211-32-300 UCTH211-34-300 UCTH211-300	
	2 3/16	304	545	629	65	230	240	63	15	291	141	6	38	71.4	55.6	22.2		UCTH211-35-300	
	2 3/16																		
60	2 1/4	11 31/32	22 15/32	25 5/8	2 9/16	9 9/16	9 7/16	2 15/32	19/32	11 11/32	6 1/16	1/4	1 1/2	3 1/16	2.563	1.000	7/16	UCTH212-36-300 UCTH212-300	
	2 3/8	304	571	651	65	243	240	63	15	288	154	6	38	77.7	65.1	25.4		UCTH212-38-300 UCTH212-39-300	
	2 7/16																		
65	2 1/2	13 1/16	23 31/32	28 1/16	2 9/16	10 15/64	10 15/64	2 5/8	19/32	11 13/16	7	1/4	1 11/16	3 1/4	2.563	1.000	7/16	UCTH213-40-300 UCTH213-300	
		332	609	713	65	260	260	67	15	300	178	6	43	82.7	65.1	25.4			

- Remarks
- In Part No. of unit and units with covers, fitting codes follow bore diameter numbers. (See **Table 10.5** in P.62.)
 - Part No. of applicable grease fittings are shown below.
B-1/4-28UNF 201~210
B-R1/8 211~213
 - As for the triple seal type product (from 201 to 205 are the double seal type products), suffix code L3 (or L2) follows the Part No. of unit or bearing. (Example of Part No. : UCTH206JL3-150, UC206L3)



With Pressed Steel Cover

With Cast Iron Cover

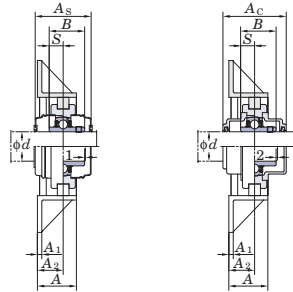

Variations of tolerance of distance between centers of bolt holes ($\Delta J_s, \Delta J_{1s}$)

Nominal unit code	Unit: mm	
	ΔJ_s	ΔJ_{1s}
UCTH201~UCTH213	± 0.5	± 0.5

Bearing No.	Mass kg	Basic Load Ratings kN		Factor f_0	With Pressed Steel Cover				With Cast Iron Cover					
		C_r	C_{0r}		Unit No.		Dimension		Mass kg	Unit No.		Dimension		Mass kg
					Open Type	One Side Closed Type	mm	inch		Open Type	One Side Closed Type	mm	inch	
UC201	6.7	12.8	6.65	13.2	UCTH201C-150	UCTH201CD-150	45	1 25/32	6.7	-	-	-	-	
UC201-8	6.7				-	-	-	-	-	-	-	-	-	-
UC202	6.7				-	-	-	-	-	-	-	-	-	-
UC202-10	6.7				-	-	-	-	-	-	-	-	-	-
UC203	6.7				-	-	-	-	-	-	-	-	-	-
UC204	6.7				-	-	-	UCTH204C-150	UCTH204CD-150	45	1 25/32	6.7	UCTH204FC-150	UCTH204FCD-150
UC205-14	6.7	14.0	7.85	13.9	-	-	-	-	-	-	-	-	-	
UC205-15	6.7				-	-	-	-	-	-	-	-	-	-
UC205	6.7				UCTH205C-150	UCTH205CD-150	49	1 15/16	6.7	UCTH205FC-150	UCTH205FCD-150	66	2 19/32	7.1
UC205-16	6.7				-	-	-	-	-	-	-	-	-	-
UC206-18	8.0	19.5	11.3	13.9	-	-	-	-	-	-	-	-	-	
UC206	8.0				UCTH206C-150	UCTH206CD-150	53	2 3/32	8.0	UCTH206FC-150	UCTH206FCD-150	70	2 3/4	8.5
UC206-19	8.0				-	-	-	-	-	-	-	-	-	-
UC206-20	8.0				-	-	-	-	-	-	-	-	-	-
UC207-20	10.5	25.7	15.4	13.9	-	-	-	-	-	-	-	-	-	
UC207-21	10.5				-	-	-	-	-	-	-	-	-	-
UC207-22	10.5				-	-	-	-	-	-	-	-	-	-
UC207	10.5				UCTH207C-230	UCTH207CD-230	60	2 3/8	10.5	UCTH207FC-230	UCTH207FCD-230	78	3 1/16	11.2
UC207-23	10.5				-	-	-	-	-	-	-	-	-	-
UC208-24	12.5	29.1	17.8	14.0	-	-	-	-	-	-	-	-	-	
UC208-25	12.5				-	-	-	-	-	-	-	-	-	-
UC208	12.5				UCTH208C-300	UCTH208CD-300	69	2 23/32	12.5	UCTH208FC-300	UCTH208FCD-300	86	3 3/8	13.3
UC209-26	12.4	34.1	21.3	14.0	-	-	-	-	-	-	-	-	-	
UC209-27	12.4				-	-	-	-	-	-	-	-	-	-
UC209-28	12.4				-	-	-	-	-	-	-	-	-	-
UC209	12.4				UCTH209C-300	UCTH209CD-300	69	2 23/32	12.4	UCTH209FC-300	UCTH209FCD-300	88	3 15/32	13.2
UC210-30	12.6	35.1	23.3	14.4	-	-	-	-	-	-	-	-	-	
UC210-31	12.6				-	-	-	-	-	-	-	-	-	-
UC210	12.6				UCTH210C-300	UCTH210CD-300	74	2 29/32	12.6	UCTH210FC-300	UCTH210FCD-300	97	3 13/16	13.6
UC210-32	12.6				-	-	-	-	-	-	-	-	-	-
UC211-32	20.1				43.4	29.4	14.4	-	-	-	-	-	-	-
UC211-34	20.1	-	-	-				-	-	-	-	-	-	-
UC211	20.1	UCTH211C-300	UCTH211CD-300	76				3	20.1	UCTH211FC-300	UCTH211FCD-300	99	3 29/32	21.3
UC211-35	20.1	-	-	-				-	-	-	-	-	-	-
UC212-36	21.4	52.4	36.2	14.4	-	-	-	-	-	-	-	-	-	
UC212	21.4				UCTH212C-300	UCTH212CD-300	89	3 1/2	21.4	UCTH212FC-300	UCTH212FCD-300	114	4 1/2	21.9
UC212-38	21.4				-	-	-	-	-	-	-	-	-	-
UC212-39	21.4				-	-	-	-	-	-	-	-	-	-
UC213-40	25.5	57.2	40.1	14.4	-	-	-	-	-	-	-	-	-	
UC213	25.5				UCTH213C-300	UCTH213CD-300	89	3 1/2	25.5	UCTH213FC-300	UCTH213FCD-300	114	4 1/2	27.2

- If heavy load ($P_r/C_r > 0.12$), vibration, or impact occurs, contact with FYH.
- For the dimensions and forms of applicable bearings, see the dimensional tables of ball bearing for unit.
- Tapered bore (with adapter) type products are also available.
(Example of Part No. : UKTH205J-150 + H2305X, UK205 + H2305X)



Channel Steel Frame Take-Up Units

UCTL

Cylindrical bore (with set screws)

d 20 ~ 45 mm

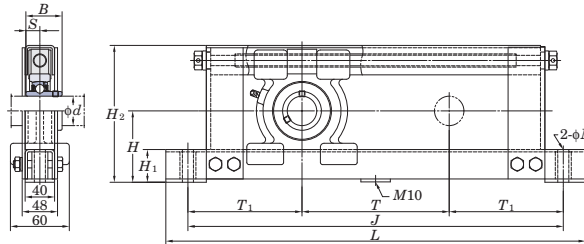

Shaft Dia. mm	Dimensions mm										Bolt Size mm	Standard		
	<i>H</i>	<i>H</i> ₁	<i>H</i> ₂	<i>L</i>	<i>J</i>	<i>N</i>	<i>T</i>	<i>T</i> ₁	<i>B</i>	<i>S</i>		Unit No.	Bearing No.	Mass kg
20	77	44	146	430	370	15	100	135	31	12.7	M12	UCTL204-100	UC204	6.0
	77	44	146	530	470	15	200	135	31	12.7	M12	UCTL204-200	UC204	7.0
	77	44	146	630	570	15	300	135	31	12.7	M12	UCTL204-300	UC204	7.5
	77	44	146	730	670	15	400	135	31	12.7	M12	UCTL204-400	UC204	8.0
25	82	44	156	440	380	15	100	140	34.1	14.3	M12	UCTL205-100	UC205	7.0
	82	44	156	540	480	15	200	140	34.1	14.3	M12	UCTL205-200	UC205	7.5
	82	44	156	640	580	15	300	140	34.1	14.3	M12	UCTL205-300	UC205	8.0
	82	44	156	740	680	15	400	140	34.1	14.3	M12	UCTL205-400	UC205	9.0
30	87	44	166	450	390	15	100	145	38.1	15.9	M12	UCTL206-100	UC206	7.0
	87	44	166	550	490	15	200	145	38.1	15.9	M12	UCTL206-200	UC206	8.0
	87	44	166	650	590	15	300	145	38.1	15.9	M12	UCTL206-300	UC206	9.0
	87	44	166	750	690	15	400	145	38.1	15.9	M12	UCTL206-400	UC206	9.5
35	92	44	176	460	400	15	100	150	42.9	17.5	M12	UCTL207-100	UC207	8.0
	92	44	176	560	500	15	200	150	42.9	17.5	M12	UCTL207-200	UC207	8.5
	92	44	176	660	600	15	300	150	42.9	17.5	M12	UCTL207-300	UC207	9.0
	92	44	176	760	700	15	400	150	42.9	17.5	M12	UCTL207-400	UC207	10
40	97	44	186	470	410	15	100	155	49.2	19	M12	UCTL208-100	UC208	8.5
	97	44	186	570	510	15	200	155	49.2	19	M12	UCTL208-200	UC208	9.0
	97	44	186	670	610	15	300	155	49.2	19	M12	UCTL208-300	UC208	10
	97	44	186	770	710	15	400	155	49.2	19	M12	UCTL208-400	UC208	10.5
45	100	44	192	480	420	15	100	160	49.2	19	M12	UCTL209-100	UC209	9.0
	100	44	192	580	520	15	200	160	49.2	19	M12	UCTL209-200	UC209	9.5
	100	44	192	680	620	15	300	160	49.2	19	M12	UCTL209-300	UC209	10.5
	100	44	192	780	720	15	400	160	49.2	19	M12	UCTL209-400	UC209	11

- Remarks
1. In Part No. of unit and units with covers, fitting codes follow bore diameter codes. (See **Table 10.5** in P.62.)
 2. Part No. of applicable grease fittings is C-1/4-28UNF.
 3. As for the triple seal type product (204 and 205 are the double seal type products), suffix code L3 (or L2) follows the Part No. of unit or bearing. (Example of Part No. : UCTL206JL3-100, UC206L3)
 4. The unit should be mounted so that load is applied to the frame mounting surface vertically and downward.



With Pressed Steel Cover

With Cast Iron Cover

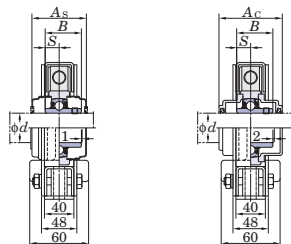

Variations of tolerance of distance from mounting bottom to center of spherical bore (ΔH_s) and variations of tolerance of distance between centers of bolt holes (ΔJ_s)

Nominal unit code	Unit: mm	
	ΔH_s	ΔJ_s
UCTL204~207	±2	±0.5
UCTL208, 209		±0.8

Basic Load Ratings kN	Factor	With Pressed Steel Cover					With Cast Iron Cover			
		Unit No.		Dimension mm	Mass kg	Unit No.		Dimension mm	Mass kg	
		Open Type	One Side Closed Type			Open Type	One Side Closed Type			
C_r	C_{0r}	f_0			A_s				A_c	
12.8	6.65	13.2	UCTL204C-100	UCTL204CD-100	45	6.0	—	—	—	—
12.8	6.65	13.2	UCTL204C-200	UCTL204CD-200	45	7.0	—	—	—	—
12.8	6.65	13.2	UCTL204C-300	UCTL204CD-300	45	7.5	—	—	—	—
12.8	6.65	13.2	UCTL204C-400	UCTL204CD-400	45	8.0	—	—	—	—
14.0	7.85	13.9	UCTL205C-100	UCTL205CD-100	49	7.0	—	—	—	—
14.0	7.85	13.9	UCTL205C-200	UCTL205CD-200	49	7.5	—	—	—	—
14.0	7.85	13.9	UCTL205C-300	UCTL205CD-300	49	8.0	—	—	—	—
14.0	7.85	13.9	UCTL205C-400	UCTL205CD-400	49	9.0	—	—	—	—
19.5	11.3	13.9	UCTL206C-100	UCTL206CD-100	53	7.0	UCTL206FC-100	UCTL206FCD-100	70	7.5
19.5	11.3	13.9	UCTL206C-200	UCTL206CD-200	53	8.0	UCTL206FC-200	UCTL206FCD-200	70	8.5
19.5	11.3	13.9	UCTL206C-300	UCTL206CD-300	53	9.0	UCTL206FC-300	UCTL206FCD-300	70	9.5
19.5	11.3	13.9	UCTL206C-400	UCTL206CD-400	53	9.5	UCTL206FC-400	UCTL206FCD-400	70	10
25.7	15.4	13.9	UCTL207C-100	UCTL207CD-100	60	8.0	UCTL207FC-100	UCTL207FCD-100	78	9.0
25.7	15.4	13.9	UCTL207C-200	UCTL207CD-200	60	8.5	UCTL207FC-200	UCTL207FCD-200	78	9.5
25.7	15.4	13.9	UCTL207C-300	UCTL207CD-300	60	9.0	UCTL207FC-300	UCTL207FCD-300	78	10
25.7	15.4	13.9	UCTL207C-400	UCTL207CD-400	60	10	UCTL207FC-400	UCTL207FCD-400	78	11
29.1	17.8	14.0	UCTL208C-100	UCTL208CD-100	69	8.5	UCTL208FC-100	UCTL208FCD-100	86	9.5
29.1	17.8	14.0	UCTL208C-200	UCTL208CD-200	69	9.0	UCTL208FC-200	UCTL208FCD-200	86	10
29.1	17.8	14.0	UCTL208C-300	UCTL208CD-300	69	10	UCTL208FC-300	UCTL208FCD-300	86	11
29.1	17.8	14.0	UCTL208C-400	UCTL208CD-400	69	10.5	UCTL208FC-400	UCTL208FCD-400	86	11.5
34.1	21.3	14.0	UCTL209C-100	UCTL209CD-100	69	9.0	UCTL209FC-100	UCTL209FCD-100	88	10
34.1	21.3	14.0	UCTL209C-200	UCTL209CD-200	69	9.5	UCTL209FC-200	UCTL209FCD-200	88	10.5
34.1	21.3	14.0	UCTL209C-300	UCTL209CD-300	69	10.5	UCTL209FC-300	UCTL209FCD-300	88	11.5
34.1	21.3	14.0	UCTL209C-400	UCTL209CD-400	69	11	UCTL209FC-400	UCTL209FCD-400	88	12

- If heavy load ($P_r/C_r > 0.12$), vibration, or impact occurs, contact with FYH.
- Tapered bore (with adapter) type bearing units are also available. (Example of Part No. : UKTL206J-100 + H2306X, UK206 + H2306X)
- If frame parts need to be corrosion resistant, contact with FYH.
- For the dimensions and forms of applicable bearings, see the dimensional tables of ball bearing for unit.



Channel Steel Frame Take-Up Units

UCTU
Cylindrical bore (with set screws)
d 40 ~ 80 mm

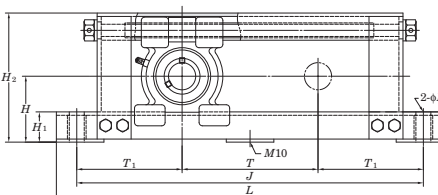
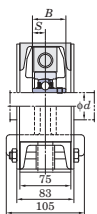

UCTU200

With Pressed Steel Cover With Cast Iron Cover

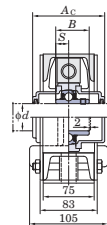
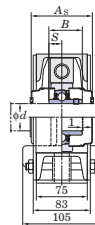

Shaft Dia. mm	Dimensions mm										Bolt Size mm	Standard		
	<i>d</i>	<i>H</i>	<i>H</i> ₁	<i>H</i> ₂	<i>L</i>	<i>J</i>	<i>N</i>	<i>T</i>	<i>T</i> ₁	<i>B</i>		<i>S</i>	Unit No.	Bearing No.
40	97	44	190	870	810	22	500	155	49.2	19	M18	UCTU208-500	UC208	21
	97	44	190	970	910	22	600	155	49.2	19	M18	UCTU208-600	UC208	22
	97	44	190	1,070	1,010	22	700	155	49.2	19	M18	UCTU208-700	UC208	24
	97	44	190	1,170	1,110	22	800	155	49.2	19	M18	UCTU208-800	UC208	26
	97	44	190	1,270	1,210	22	900	155	49.2	19	M18	UCTU208-900	UC208	28
45	102	44	200	880	820	22	500	160	49.2	19	M18	UCTU209-500	UC209	22
	102	44	200	980	920	22	600	160	49.2	19	M18	UCTU209-600	UC209	24
	102	44	200	1,080	1,020	22	700	160	49.2	19	M18	UCTU209-700	UC209	25
	102	44	200	1,180	1,120	22	800	160	49.2	19	M18	UCTU209-800	UC209	27
	102	44	200	1,280	1,220	22	900	160	49.2	19	M18	UCTU209-900	UC209	29
50	107	44	210	890	830	22	500	165	51.6	19	M18	UCTU210-500	UC210	23
	107	44	210	990	930	22	600	165	51.6	19	M18	UCTU210-600	UC210	25
	107	44	210	1,090	1,030	22	700	165	51.6	19	M18	UCTU210-700	UC210	27
	107	44	210	1,190	1,130	22	800	165	51.6	19	M18	UCTU210-800	UC210	28
	107	44	210	1,290	1,230	22	900	165	51.6	19	M18	UCTU210-900	UC210	30
55	115	44	230	910	850	22	500	175	55.6	22.2	M18	UCTU211-500	UC211	25
	115	44	230	1,010	950	22	600	175	55.6	22.2	M18	UCTU211-600	UC211	27
	115	44	230	1,110	1,050	22	700	175	55.6	22.2	M18	UCTU211-700	UC211	28
	115	44	230	1,210	1,150	22	800	175	55.6	22.2	M18	UCTU211-800	UC211	30
	115	44	230	1,310	1,250	22	900	175	55.6	22.2	M18	UCTU211-900	UC211	32
60	120	44	240	920	860	22	500	180	65.1	25.4	M18	UCTU212-500	UC212	26
	120	44	240	1,020	960	22	600	180	65.1	25.4	M18	UCTU212-600	UC212	28
	120	44	240	1,120	1,060	22	700	180	65.1	25.4	M18	UCTU212-700	UC212	30
	120	44	240	1,220	1,160	22	800	180	65.1	25.4	M18	UCTU212-800	UC212	31
	120	44	240	1,320	1,260	22	900	180	65.1	25.4	M18	UCTU212-900	UC212	33
65	145	55	285	940	880	22	500	190	75	30	M18	UCTU313-500	UC313	40
	145	55	285	1,040	980	22	600	190	75	30	M18	UCTU313-600	UC313	43
	145	55	285	1,140	1,080	22	700	190	75	30	M18	UCTU313-700	UC313	46
	145	55	285	1,240	1,180	22	800	190	75	30	M18	UCTU313-800	UC313	49
	145	55	285	1,340	1,280	22	900	190	75	30	M18	UCTU313-900	UC313	51
70	150	55	295	960	900	22	500	200	78	33	M18	UCTU314-500	UC314	44
	150	55	295	1,060	1,000	22	600	200	78	33	M18	UCTU314-600	UC314	46
	150	55	295	1,160	1,100	22	700	200	78	33	M18	UCTU314-700	UC314	48
	150	55	295	1,260	1,200	22	800	200	78	33	M18	UCTU314-800	UC314	51
	150	55	295	1,360	1,300	22	900	200	78	33	M18	UCTU314-900	UC314	53
75	155	55	305	980	920	22	500	210	82	32	M18	UCTU315-500	UC315	54
	155	55	305	1,080	1,020	22	600	210	82	32	M18	UCTU315-600	UC315	57
	155	55	305	1,180	1,120	22	700	210	82	32	M18	UCTU315-700	UC315	59
	155	55	305	1,280	1,220	22	800	210	82	32	M18	UCTU315-800	UC315	61
	155	55	305	1,380	1,320	22	900	210	82	32	M18	UCTU315-900	UC315	64
80	160	55	315	1,000	940	22	500	220	86	34	M18	UCTU316-500	UC316	57
	160	55	315	1,100	1,040	22	600	220	86	34	M18	UCTU316-600	UC316	60
	160	55	315	1,200	1,140	22	700	220	86	34	M18	UCTU316-700	UC316	62
	160	55	315	1,300	1,240	22	800	220	86	34	M18	UCTU316-800	UC316	64
	160	55	315	1,400	1,340	22	900	220	86	34	M18	UCTU316-900	UC316	67

- Remarks
- In Part No. of unit and units with covers, fitting codes follow bore diameter numbers. (See Table 10.5 in P.62.)
 - Part No. of applicable grease fittings are shown below.
C-1/4-28UNF.....208~210
C-R1/8.....211, 212, 313~318
 - As for the triple seal type product, suffix code L3 follows the Part No. of unit or bearing.
(Example of Part No. : UCTU208JL3-500, UC208L3)



With Cast Iron Cover

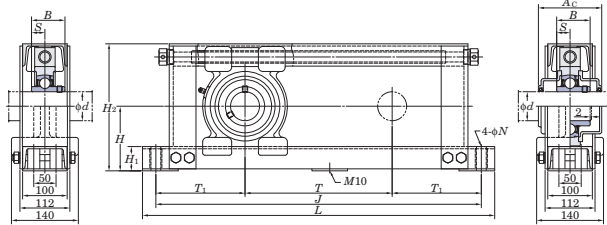

UCTU300

Variations of tolerance of distance from mounting bottom to center of spherical bore (ΔH_s) and variations of tolerance of distance between centers of bolt holes (ΔL_s)

Nominal unit code	ΔH_s	Unit: mm
		ΔL_s
UCTU208~212	±2	±0.8
UCTU313~315		±1.2
UCTU316~318		±1.2

Basic Load Ratings kN	Factor	With Pressed Steel Cover					With Cast Iron Cover			
		Open Type	One Side Closed Type	Dimension mm	Mass	Unit No.		Dimension mm	Mass	
						Open Type	One Side Closed Type			Dimension mm
C_r	C_{or}	f_0			A_s	kg			A_c	kg
29.1	17.8	14.0	UCTU208C-500	UCTU208CD-500	69	21	UCTU208FC-500	UCTU208FCD-500	86	22
29.1	17.8	14.0	UCTU208C-600	UCTU208CD-600	69	22	UCTU208FC-600	UCTU208FCD-600	86	23
29.1	17.8	14.0	UCTU208C-700	UCTU208CD-700	69	24	UCTU208FC-700	UCTU208FCD-700	86	25
29.1	17.8	14.0	UCTU208C-800	UCTU208CD-800	69	26	UCTU208FC-800	UCTU208FCD-800	86	27
29.1	17.8	14.0	UCTU208C-900	UCTU208CD-900	69	28	UCTU208FC-900	UCTU208FCD-900	86	29
34.1	21.3	14.0	UCTU209C-500	UCTU209CD-500	69	22	UCTU209FC-500	UCTU209FCD-500	88	23
34.1	21.3	14.0	UCTU209C-600	UCTU209CD-600	69	24	UCTU209FC-600	UCTU209FCD-600	88	25
34.1	21.3	14.0	UCTU209C-700	UCTU209CD-700	69	25	UCTU209FC-700	UCTU209FCD-700	88	26
34.1	21.3	14.0	UCTU209C-800	UCTU209CD-800	69	27	UCTU209FC-800	UCTU209FCD-800	88	28
34.1	21.3	14.0	UCTU209C-900	UCTU209CD-900	69	29	UCTU209FC-900	UCTU209FCD-900	88	30
35.1	23.3	14.4	UCTU210C-500	UCTU210CD-500	74	23	UCTU210FC-500	UCTU210FCD-500	97	24
35.1	23.3	14.4	UCTU210C-600	UCTU210CD-600	74	25	UCTU210FC-600	UCTU210FCD-600	97	26
35.1	23.3	14.4	UCTU210C-700	UCTU210CD-700	74	27	UCTU210FC-700	UCTU210FCD-700	97	28
35.1	23.3	14.4	UCTU210C-800	UCTU210CD-800	74	28	UCTU210FC-800	UCTU210FCD-800	97	29
35.1	23.3	14.4	UCTU210C-900	UCTU210CD-900	74	30	UCTU210FC-900	UCTU210FCD-900	97	31
43.4	29.4	14.4	UCTU211C-500	UCTU211CD-500	76	25	UCTU211FC-500	UCTU211FCD-500	99	26
43.4	29.4	14.4	UCTU211C-600	UCTU211CD-600	76	27	UCTU211FC-600	UCTU211FCD-600	99	28
43.4	29.4	14.4	UCTU211C-700	UCTU211CD-700	76	28	UCTU211FC-700	UCTU211FCD-700	99	29
43.4	29.4	14.4	UCTU211C-800	UCTU211CD-800	76	30	UCTU211FC-800	UCTU211FCD-800	99	31
43.4	29.4	14.4	UCTU211C-900	UCTU211CD-900	76	32	UCTU211FC-900	UCTU211FCD-900	99	33
52.4	36.2	14.4	UCTU212C-500	UCTU212CD-500	89	26	UCTU212FC-500	UCTU212FCD-500	114	28
52.4	36.2	14.4	UCTU212C-600	UCTU212CD-600	89	28	UCTU212FC-600	UCTU212FCD-600	114	30
52.4	36.2	14.4	UCTU212C-700	UCTU212CD-700	89	30	UCTU212FC-700	UCTU212FCD-700	114	32
52.4	36.2	14.4	UCTU212C-800	UCTU212CD-800	89	31	UCTU212FC-800	UCTU212FCD-800	114	33
52.4	36.2	14.4	UCTU212C-900	UCTU212CD-900	89	33	UCTU212FC-900	UCTU212FCD-900	114	35
92.7	59.9	13.2	-	-	-	-	UCTU313C-500	UCTU313CD-500	122	42
92.7	59.9	13.2	-	-	-	-	UCTU313C-600	UCTU313CD-600	122	45
92.7	59.9	13.2	-	-	-	-	UCTU313C-700	UCTU313CD-700	122	48
92.7	59.9	13.2	-	-	-	-	UCTU313C-800	UCTU313CD-800	122	51
92.7	59.9	13.2	-	-	-	-	UCTU313C-900	UCTU313CD-900	122	53
104	68.2	13.2	-	-	-	-	UCTU314C-500	UCTU314CD-500	124	46
104	68.2	13.2	-	-	-	-	UCTU314C-600	UCTU314CD-600	124	48
104	68.2	13.2	-	-	-	-	UCTU314C-700	UCTU314CD-700	124	50
104	68.2	13.2	-	-	-	-	UCTU314C-800	UCTU314CD-800	124	53
104	68.2	13.2	-	-	-	-	UCTU314C-900	UCTU314CD-900	124	55
113	77.2	13.2	-	-	-	-	UCTU315C-500	UCTU315CD-500	134	57
113	77.2	13.2	-	-	-	-	UCTU315C-600	UCTU315CD-600	134	60
113	77.2	13.2	-	-	-	-	UCTU315C-700	UCTU315CD-700	134	62
113	77.2	13.2	-	-	-	-	UCTU315C-800	UCTU315CD-800	134	64
113	77.2	13.2	-	-	-	-	UCTU315C-900	UCTU315CD-900	134	67
123	86.7	13.3	-	-	-	-	UCTU316C-500	UCTU316CD-500	138	60
123	86.7	13.3	-	-	-	-	UCTU316C-600	UCTU316CD-600	138	63
123	86.7	13.3	-	-	-	-	UCTU316C-700	UCTU316CD-700	138	65
123	86.7	13.3	-	-	-	-	UCTU316C-800	UCTU316CD-800	138	67
123	86.7	13.3	-	-	-	-	UCTU316C-900	UCTU316CD-900	138	70

- The unit should be mounted so that load is applied to the frame mounting surface vertically and downward.
- If heavy load ($P_r/C_r > 0.12$), vibration, or impact occurs, contact with FYH.
- Tapered bore (with adapter) type bearing units are also available. (Example of Part No. : UKTU208J-500 + H2308X, UK208 + H2308X)
- If frame parts need to be corrosion resistant, contact with FYH.
- For the dimensions and forms of applicable bearings, see the dimensional tables of ball bearing for unit.



Channel Steel Frame Take-Up Units

UCTU
Cylindrical bore (with set screws)
d 85 ~ 90 mm

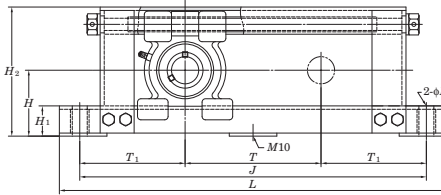
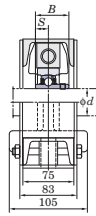

UCTU200

With Pressed Steel Cover

With Cast Iron Cover

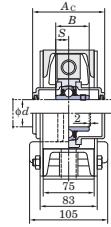
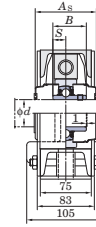

Shaft Dia. mm	Dimensions mm										Bolt Size mm	Standard		
	<i>H</i>	<i>H</i> ₁	<i>H</i> ₂	<i>L</i>	<i>J</i>	<i>N</i>	<i>T</i>	<i>T</i> ₁	<i>B</i>	<i>S</i>		Unit No.	Bearing No.	Mass kg
85	165	55	325	1,020	960	22	500	230	96	40	M18	UCTU317-500	UC317	62
	165	55	325	1,120	1,060	22	600	230	96	40	M18	UCTU317-600	UC317	64
	165	55	325	1,220	1,160	22	700	230	96	40	M18	UCTU317-700	UC317	67
	165	55	325	1,320	1,260	22	800	230	96	40	M18	UCTU317-800	UC317	69
	165	55	325	1,420	1,360	22	900	230	96	40	M18	UCTU317-900	UC317	71
90	170	55	335	1,050	990	22	500	245	96	40	M18	UCTU318-500	UC318	65
	170	55	335	1,150	1,090	22	600	245	96	40	M18	UCTU318-600	UC318	67
	170	55	335	1,250	1,190	22	700	245	96	40	M18	UCTU318-700	UC318	70
	170	55	335	1,350	1,290	22	800	245	96	40	M18	UCTU318-800	UC318	72
	170	55	335	1,450	1,390	22	900	245	96	40	M18	UCTU318-900	UC318	74

- Remarks
- In Part No. of unit and units with covers, fitting codes follow bore diameter numbers. (See **Table 10.5** in P.62.)
 - Part No. of applicable grease fittings are shown below.
C-1/4-28UNF..... 208~210
C-R1/8..... 211, 212, 313~318
 - As for the triple seal type product, suffix code L3 follows the Part No. of unit or bearing.
(Example of Part No. : UCTU208JL3-500, UC208L3)

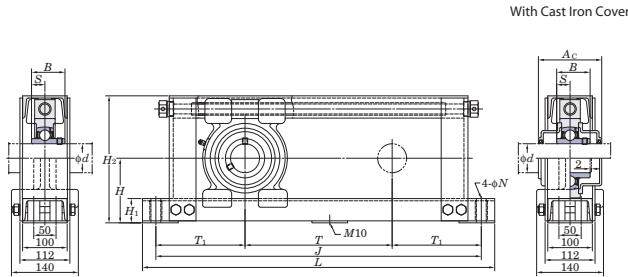

UCTU300

With Cast Iron Cover

Variations of tolerance of distance from mounting bottom to center of spherical bore (ΔH_s) and variations of tolerance of distance between centers of bolt holes (ΔJ_s)

Nominal unit code	ΔH_s	Unit: mm	
		ΔJ_s	
UCTU208~212	±2		±0.8
UCTU313~315			
UCTU316~318			±1.2

Basic Load Ratings kN		Factor f_0	With Pressed Steel Cover				With Cast Iron Cover			
C_r	C_{0r}		Unit No.		Dimension mm	Mass kg	Unit No.		Dimension mm	Mass kg
			Open Type	One Side Closed Type	A_s		Open Type	One Side Closed Type	A_c	
133	96.8	13.3	—	—	—	—	UCTU317C-500	UCTU317CD-500	146	65
133	96.8	13.3	—	—	—	—	UCTU317C-600	UCTU317CD-600	146	67
133	96.8	13.3	—	—	—	—	UCTU317C-700	UCTU317CD-700	146	70
133	96.8	13.3	—	—	—	—	UCTU317C-800	UCTU317CD-800	146	72
133	96.8	13.3	—	—	—	—	UCTU317C-900	UCTU317CD-900	146	74
143	107	13.3	—	—	—	—	UCTU318C-500	UCTU318CD-500	150	68
143	107	13.3	—	—	—	—	UCTU318C-600	UCTU318CD-600	150	70
143	107	13.3	—	—	—	—	UCTU318C-700	UCTU318CD-700	150	73
143	107	13.3	—	—	—	—	UCTU318C-800	UCTU318CD-800	150	75
143	107	13.3	—	—	—	—	UCTU318C-900	UCTU318CD-900	150	77

- The unit should be mounted so that load is applied to the frame mounting surface vertically and downward.
- If heavy load ($P_r/C_r > 0.12$), vibration, or impact occurs, contact with FYH.
- Tapered bore (with adapter) type bearing units are also available. (Example of Part No. : UKTU208J-500 + H2308X, UK208 + H2308X)
- If frame parts need to be corrosion resistant, contact with FYH.
- For the dimensions and forms of applicable bearings, see the dimensional tables of ball bearing for unit.



Steel Plate Frame Take-Up Units

SBPTH
Cylindrical bore (with set screws)
 d 12 ~ 25 mm

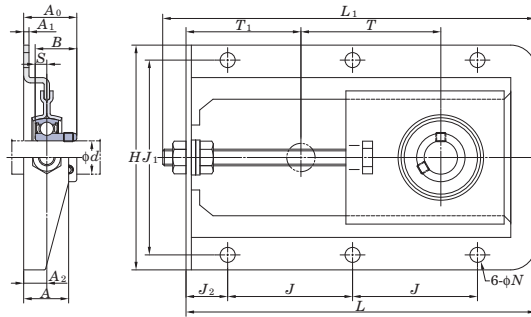

Shaft Dia. mm	Dimensions																Bolt Size	Unit No.
	H	L	L_1	A	J	J_1	J_2	N	T	T_1	A_1	A_2	A_0	B	S	inch mm		
12	5 ⁵ / ₁₆	8 ⁹ / ₃₂	8 ²¹ / ₃₂	1 ¹ / ₁₆	2 ⁶¹ / ₆₄	4 ³⁹ / ₆₄	3 ¹ / ₃₂	1 ¹ / ₃₂	3 ¹⁵ / ₃₂	2 ²³ / ₃₂	1/8	3 ⁵ / ₆₄	1 ³ / ₁₆	0.866	0.236	5/16 M8	SBPTH201-90	
	135	210	220	27	75	117	25	9	88	69	3.2	13.9	29.9	22	6			
15	5 ⁵ / ₁₆	8 ⁹ / ₃₂	8 ²¹ / ₃₂	1 ¹ / ₁₆	2 ⁶¹ / ₆₄	4 ³⁹ / ₆₄	3 ¹ / ₃₂	1 ¹ / ₃₂	3 ¹⁵ / ₃₂	2 ²³ / ₃₂	1/8	3 ⁵ / ₆₄	1 ³ / ₁₆	0.866	0.236	5/16 M8	SBPTH202-90	
	135	210	220	27	75	117	25	9	88	69	3.2	13.9	29.9	22	6			
17	5 ⁵ / ₁₆	8 ⁹ / ₃₂	8 ²¹ / ₃₂	1 ¹ / ₁₆	2 ⁶¹ / ₆₄	4 ³⁹ / ₆₄	3 ¹ / ₃₂	1 ¹ / ₃₂	3 ¹⁵ / ₃₂	2 ²³ / ₃₂	1/8	3 ⁵ / ₆₄	1 ³ / ₁₆	0.866	0.236	5/16 M8	SBPTH203-90	
	135	210	220	27	75	117	25	9	88	69	3.2	13.9	29.9	22	6			
20	5 ⁵ / ₁₆	8 ⁹ / ₃₂	8 ²¹ / ₃₂	1 ¹ / ₁₆	2 ⁶¹ / ₆₄	4 ³⁹ / ₆₄	3 ¹ / ₃₂	1 ¹ / ₃₂	3 ¹⁵ / ₃₂	2 ²³ / ₃₂	1/8	3 ⁵ / ₆₄	1 ¹ / ₄	0.984	0.276	5/16 M8	SBPTH204-90	
	135	210	220	27	75	117	25	9	88	69	3.2	13.9	31.9	25	7			
25	5 ⁵ / ₁₆	8 ⁹ / ₃₂	8 ²¹ / ₃₂	1 ¹ / ₁₆	2 ⁶¹ / ₆₄	4 ³⁹ / ₆₄	3 ¹ / ₃₂	1 ¹ / ₃₂	3 ¹⁵ / ₃₂	2 ²³ / ₃₂	1/8	3 ⁵ / ₆₄	1 ⁵ / ₁₆	1.063	0.295	5/16 M8	SBPTH205-90	
	135	210	220	27	75	117	25	9	88	69	3.2	13.9	33.4	27	7.5			

Remarks 1. For the dimensions and forms of applicable bearings, see the dimensional tables of ball bearing for unit.
2. If heavy load ($P_r / C_r > 0.12$), vibration, or impact occurs, contact with FYH.



FYH

Variations of tolerance of distance between centers of bolt holes (ΔJ_s , ΔJ_{1s})

Unit: mm

Nominal unit code	ΔJ_s	ΔJ_{1s}
SBPTH201-SBPTH205	±0.7	±0.7

Bearing No.	Basic Load Ratings kN		Factor f_0	Mass kg
	C_r	C_{0r}		
SB201	9.55	4.80	13.2	0.91
SB202	9.55	4.80	13.2	0.91
SB203	9.55	4.80	13.2	0.91
SB204	12.8	6.65	13.2	0.91
SB205	14.0	7.85	13.9	0.91



Steel Plate Frame Take-Up Units

SBNPTH

Cylindrical bore (with set screws)
d 12 ~ 25 mm

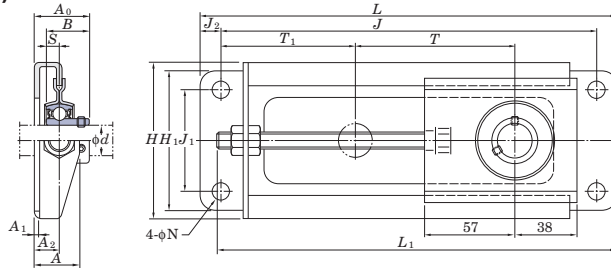

Shaft Dia. mm	Dimensions																	Bolt Size	Unit No.
	<i>H</i>	<i>H</i> ₁	<i>L</i>	<i>L</i> ₁	<i>A</i>	<i>J</i>	<i>J</i> ₁	<i>J</i> ₂	<i>N</i>	<i>T</i>	<i>T</i> ₁	<i>A</i> ₁	<i>A</i> ₂	<i>A</i> ₀	<i>B</i>	<i>S</i>	inch mm		
12	3 15/16	3 17/32	10 1/4	9 11/16	1 1/16	9 1/4	2 9/16	1/2	7/16	3 15/16	3 9/32	1/8	19/32	1 7/32	0.866	0.236	5/16	SBNPTH201-100	
	100	90	260	246	27	235	65	12.5	11	100	83.5	3.2	15	31	22	6	M8		
15	3 15/16	3 17/32	10 1/4	9 11/16	1 1/16	9 1/4	2 9/16	1/2	7/16	3 15/16	3 9/32	1/8	19/32	1 7/32	0.866	0.236	5/16	SBNPTH202-100	
	100	90	260	246	27	235	65	12.5	11	100	83.5	3.2	15	31	22	6	M8		
17	3 15/16	3 17/32	10 1/4	9 11/16	1 1/16	9 1/4	2 9/16	1/2	7/16	3 15/16	3 9/32	1/8	19/32	1 7/32	0.866	0.236	5/16	SBNPTH203-100	
	100	90	260	246	27	235	65	12.5	11	100	83.5	3.2	15	31	22	6	M8		
20	3 15/16	3 17/32	10 1/4	9 11/16	1 1/16	9 1/4	2 9/16	1/2	7/16	3 15/16	3 9/32	1/8	19/32	1 5/16	0.984	0.276	5/16	SBNPTH204-100	
	100	90	260	246	27	235	65	12.5	11	100	83.5	3.2	15	33	25	7	M8		
25	3 15/16	3 17/32	10 1/4	9 11/16	1 1/16	9 1/4	2 9/16	1/2	7/16	3 15/16	3 9/32	1/8	19/32	1 11/32	1.063	0.295	5/16	SBNPTH205-100	
	100	90	260	246	27	235	65	12.5	11	100	83.5	3.2	15	34.5	27	7.5	M8		

Remarks 1. For the dimensions and forms of applicable bearings, see the dimensional tables of ball bearing for unit.
2. If heavy load ($P_r/C_r > 0.12$), vibration, or impact occurs, contact with FYH.



FYH

Variations of tolerance of distance between centers of bolt holes (ΔL_s , ΔL_{1s})

Unit: mm

Nominal unit code	ΔL_s	ΔL_{1s}
SBNPTH201~SBNPTH205	±0.7	±0.7

	Bearing No.	Basic Load Ratings kN		Factor f_0	Mass kg
		C_r	C_{0r}		
	SB201	9.55	4.80	13.2	0.93
	SB202	9.55	4.80	13.2	0.93
	SB203	9.55	4.80	13.2	0.93
	SB204	12.8	6.65	13.2	0.93
	SB205	14.0	7.85	13.9	0.93