

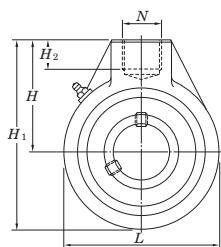

**Hanger Units**

**UCHA**  
Cylindrical bore (with set screws)  
 $d$  12 ~ 75 mm

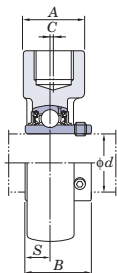

Shaft Dia. mm inch	Dimensions									Unit No.	Housing No.	Bearing No.	
	$d$	$H$	$A$	$L$	$H_1$	$H_2$	$N^{(1)}$	$C$	$B$				$S$
12	1/2										UCHA201 UCHA201-8	HA204	UC201 UC201-8
15	5/8	2 17/32	1 9/16	2 17/32	3 25/32	3/4	–	1.220	0.500	UCHA202 UCHA202-10	UC202 UC202-10		
17	3/4	64	40	64	96	Rp 3/4	–	31	12.7	UCHA203 UCHA204-12	UC203 UC204-12		
20										UCHA204	UC204		
25	7/8	2 17/32	1 9/16	3 1/16	4 1/16	3/4	–	1.343	0.563	UCHA205-14 UCHA205-15	HA205	UC205-14 UC205-15	
	15/16	64	40	78	103	Rp 3/4	–	34.1	14.3	UCHA205 UCHA205-16		UC205 UC205-16	
30	1 1/8	2 17/32	1 9/16	3 1/16	4 1/16	3/4	–	1.500	0.626	UCHA206-18 UCHA206	HA206	UC206-18 UC206	
	1 3/16	64	40	78	103	Rp 3/4	–	38.1	15.9	UCHA206-19 UCHA206-20		UC206-19 UC206-20	
	1 1/4												
35	1 5/16	2 3/4	1 9/16	3 5/8	4 9/16	3/4	–	1.689	0.689	UCHA207-21 UCHA207-22	HA207	UC207-21 UC207-22	
	1 3/8	70	40	92	116	Rp 3/4	–	42.9	17.5	UCHA207 UCHA207-23		UC207 UC207-23	
40	1 1/2	2 7/8	1 9/16	3 25/32	4 3/4	3/4	5/64	1.937	0.748	UCHA208-24 UCHA208-25	HA208	UC208-24 UC208-25	
	1 9/16	73	40	96	121	Rp 3/4	2	49.2	19	UCHA208		UC208	
45	1 5/8	3 7/32	1 7/8	4 1/4	5 11/32	13/16	13/64	1.937	0.748	UCHA209-26 UCHA209-27	HA209	UC209-26 UC209-27	
	1 11/16	82	48	108	136	Rp 1	5	49.2	19	UCHA209-28 UCHA209		UC209-28 UC209	
50	1 7/8	3 9/32	1 7/8	4 21/32	5 19/32	13/16	13/64	2.031	0.748	UCHA210-30 UCHA210-31	HA210	UC210-30 UC210-31	
	1 15/16	83	48	118	142	Rp 1	5	51.6	19	UCHA210 UCHA210-32		UC210 UC210-32	
55	2	3 7/16	2 3/8	4 31/32	5 29/32	31/32	9/32	2.189	0.874	UCHA211-32 UCHA211-34	HA211	UC211-32 UC211-34	
	2 1/8	87	60	126	150	Rp 1 1/4	7	55.6	22.2	UCHA211 UCHA211-35		UC211 UC211-35	
60	2 3/16	4 1/32	2 3/8	5 19/32	6 13/16	1 3/32	23/64	2.563	1.000	UCHA212-36 UCHA212	HA212	UC212-36 UC212	
	2 1/4	102	60	142	173	Rp 1 1/4	9	65.1	25.4	UCHA212-38 UCHA212-39		UC212-38 UC212-39	
65	2 3/8	4 19/32	2 3/4	6 17/32	7 7/8	1 1/4	3/8	2.563	1.000	UCHA213-40 UCHA213	HA213	UC213-40 UC213	
	2 1/2	117	70	166	200	Rp 1 1/2	9.5	65.1	25.4				
70	2 7/16	4 19/32	2 3/4	6 17/32	7 7/8	1 1/4	3/8	2.937	1.189	UCHA214-44 UCHA214	HA214	UC214-44 UC214	
	2 3/4	117	70	166	200	Rp 1 1/2	9.5	74.6	30.2				
75	2 15/16	4 19/32	2 3/4	6 17/32	7 7/8	1 1/4	3/8	3.063	1.311	UCHA215-47 UCHA215	HA215	UC215-47 UC215	
	3	117	70	166	200	Rp 1 1/2	9.5	77.8	33.3	UCHA215-48		UC215-48	

Remarks 1. In Part No. of unit and units with covers, fitting codes follow bore diameter numbers. (See Table 10.5 in P.62.)  
2. Part No. of applicable grease fittings are shown below.  
A-1/4-28UNF ..... 201-210  
A-R1/8..... 211-215



Note 1) Dimensions N screw hole is apply JIS B0203 (Taper Pipe Threads) standards.  
It can not apply to the Parallel Pipe Male Thread.  
Also, below shown the dimensions of Parallel Pipe Female Thread.

Unit: mm

Nominal of Thread	Female Thread			Thread	Apply Male Thread
	Major Diameter	Pitch Diameter	Minor Diameter	Number of Threads (in 25.4 mm)	
	$D$	$D_2$	$D_1$	$n$	
Rp 3/4	26.441	25.279	24.117	14	R 3/4
Rp 1	33.249	31.770	30.291	11	R 1
Rp 1 1/2	41.910	40.431	38.952	11	R 1 1/2
Rp 1 1/4	47.803	46.324	44.845	11	R 1 1/4

	Basic Load Ratings kN		Factor	Mass
	$C_r$	$C_{0r}$	$f_0$	kg
				0.77
	12.8	6.65	13.2	0.75 0.74 0.72
	14.0	7.85	13.9	0.87
	19.5	11.3	13.9	0.83
	25.7	15.4	13.9	1.2
	29.1	17.8	14.0	1.3
	34.1	21.3	14.0	1.7
	35.1	23.3	14.4	2.1
	43.4	29.4	14.4	2.8
	52.4	36.2	14.4	3.9
	57.2	40.1	14.4	5.8
	62.2	44.1	14.5	5.9
	67.4	48.3	14.5	5.6

3. As for the triple seal type product (from 201 to 205 are the double seal type products), suffix code L3 (or L2) follows the Part No. of unit or bearing. (Example of Part No. : UCHA206JL3, UC206L3)

4. For the dimensions and forms of applicable bearings and adapters, see the dimensional tables of ball bearing for unit and adapter.

5. Tapered bore (with adapter) type products are also available. (Example of Part No. : UKHA205J + H2305X, UK205 + H2305X)



**Ball Bearing Inserts**

**UC, SB, SB-RKP8, SU**  
Cylindrical bore (with set screws)  
 $d \sim 8 \sim 25 \text{ mm}$

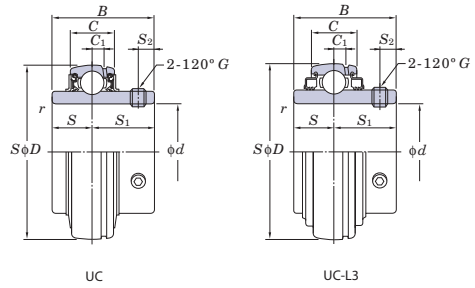
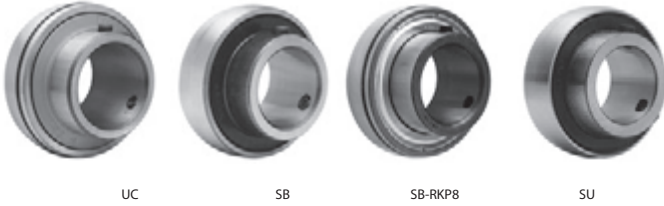

Shaft Dia.		Dimensions							Basic Load Ratings		Factor	Bearing No.		
mm	inch	D		B		C		r (min.)		$C_r$	$C_{0r}$	$f_0$	Standard	L3 Type
$d$		mm	inch	mm	inch	mm	inch	mm	inch					
8	—	22	0.866	12	0.472	7	0.276	0.3	0.012	3.27	1.37	12.4	SU08	—
10	—	26	1.024	15	0.591	8	0.315	0.3	0.012	4.55	1.95	12.3	SU000	—
12	—	28	1.102	15	0.591	8	0.315	0.3	0.012	5.10	2.40	13.2	SU001	—
		40	1.575	22	0.866	12	0.472	0.6	0.024	9.55	4.80	13.2	SB201	—
		40	1.575	22	0.866	13	0.512	0.6	0.024	9.55	4.80	13.2	SB201RKP8	—
		47	1.850	31	1.220	16	0.630	0.6	0.024	12.8	6.65	13.2	UC201	UC201L2
—	1/2	40	1.575	22	0.866	12	0.472	0.6	0.024	9.55	4.80	13.2	SB201-8	—
		40	1.575	22	0.866	13	0.512	0.6	0.024	9.55	4.80	13.2	SB201-8RKP8	—
		47	1.850	31	1.220	16	0.630	0.6	0.024	12.8	6.65	13.2	UC201-8	UC201-8L2
15	—	32	1.260	16.5	0.650	9	0.354	0.3	0.012	5.60	2.85	13.9	SU002	—
		40	1.575	22	0.866	12	0.472	0.6	0.024	9.55	4.80	13.2	SB202	—
		40	1.575	22	0.866	13	0.512	0.6	0.024	9.55	4.80	13.2	SB202RKP8	—
		47	1.850	31	1.220	16	0.630	0.6	0.024	12.8	6.65	13.2	UC202	UC202L2
—	5/8	40	1.575	22	0.866	12	0.472	0.6	0.024	9.55	4.80	13.2	SB202-10	—
		40	1.575	22	0.866	13	0.512	0.6	0.024	9.55	4.80	13.2	SB202-10RKP8	—
		47	1.850	31	1.220	16	0.630	0.6	0.024	12.8	6.65	13.2	UC202-10	UC202-10L2
17	—	35	1.378	17.5	0.689	10	0.394	0.3	0.012	6.00	3.25	14.4	SU003	—
		40	1.575	22	0.866	12	0.472	0.6	0.024	9.55	4.80	13.2	SB203	—
		40	1.575	22	0.866	13	0.512	0.6	0.024	9.55	4.80	13.2	SB203RKP8	—
		47	1.850	31	1.220	16	0.630	0.6	0.024	12.8	6.65	13.2	UC203	UC203L2
—	3/4	47	1.850	25	0.984	14	0.551	1	0.039	12.8	6.65	13.2	SB204-12	—
		47	1.850	25	0.984	15	0.591	1	0.039	12.8	6.65	13.2	SB204-12RKP8	—
		47	1.850	31	1.220	16	0.630	1	0.039	12.8	6.65	13.2	UC204-12	UC204-12L2
20	—	42	1.654	21	0.827	12	0.472	0.6	0.024	9.40	5.05	13.9	SU004	—
		47	1.850	25	0.984	14	0.551	1	0.039	12.8	6.65	13.2	SB204	—
		47	1.850	25	0.984	15	0.591	1	0.039	12.8	6.65	13.2	SB204RKP8	—
		47	1.850	31	1.220	16	0.630	1	0.039	12.8	6.65	13.2	UC204	UC204L2
—	7/8	52	2.047	27	1.063	15	0.591	1	0.039	14.0	7.85	13.9	SB205-14	—
		52	2.047	27	1.063	15	0.591	1	0.039	14.0	7.85	13.9	SB205-14RKP8	—
		52	2.047	34.1	1.343	17	0.669	1	0.039	14.0	7.85	13.9	UC205-14	UC205-14L2
—	15/16	52	2.047	27	1.063	15	0.591	1	0.039	14.0	7.85	13.9	SB205-15	—
		52	2.047	27	1.063	15	0.591	1	0.039	14.0	7.85	13.9	SB205-15RKP8	—
		52	2.047	34.1	1.343	17	0.669	1	0.039	14.0	7.85	13.9	UC205-15	UC205-15L2
25	—	47	1.850	22	0.866	12	0.472	0.6	0.024	10.1	5.85	14.5	SU005	—
		52	2.047	27	1.063	15	0.591	1	0.039	14.0	7.85	13.9	SB205	—
		52	2.047	27	1.063	15	0.591	1	0.039	14.0	7.85	13.9	SB205RKP8	—
		52	2.047	34.1	1.343	17	0.669	1	0.039	14.0	7.85	13.9	UC205	UC205L2
		62	2.441	38	1.496	22	0.866	1.1	0.043	21.2	10.9	12.6	UC305	—
		62	2.441	38.1	1.500	19	0.748	1	0.039	19.5	11.3	13.9	UCX05	UCX05L3
—	1	52	2.047	27	1.063	15	0.591	1	0.039	14.0	7.85	13.9	SB205-16	—
		52	2.047	27	1.063	15	0.591	1	0.039	14.0	7.85	13.9	SB205-16RKP8	—
		52	2.047	34.1	1.343	17	0.669	1	0.039	14.0	7.85	13.9	UC205-16	UC205-16L2
		62	2.441	38	1.496	22	0.866	1.1	0.043	21.2	10.9	12.6	UC305-16	—
		62	2.441	38.1	1.500	19	0.748	1	0.039	19.5	11.3	13.9	UCX05-16	UCX05-16L3
		62	2.441	30	1.181	16	0.630	1	0.039	19.5	11.3	13.9	SB206-18	—
—	1 1/8	62	2.441	30	1.181	18	0.709	1	0.039	19.5	11.3	13.9	SB206-18RKP8	—
		62	2.441	38.1	1.500	19	0.748	1	0.039	19.5	11.3	13.9	UC206-18	UC206-18L2

Remarks 1. SU type product is the clean series ball bearing for unit.  
2. From UC201 to 205 are the double seal type products (L2).

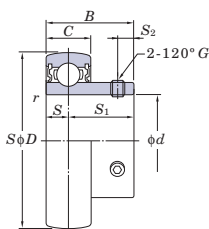

SB

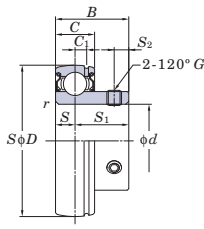

SB-RKP8

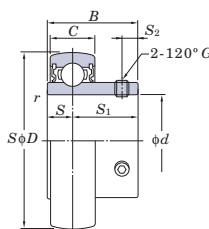

SU

Dimensions								Set Screw Brg. Bore G		Mass
C <sub>1</sub>		S		S <sub>1</sub>		S <sub>2</sub>		mm	inch	kg
mm	inch	mm	inch	mm	inch	mm	inch			
-	-	3.5	0.138	8.5	0.335	2.8	0.110	M3x0.35	-	0.012
-	-	5	0.197	10	0.394	3	0.118	M3x0.35	-	0.024
-	-	5	0.197	10	0.394	3	0.118	M3x0.35	-	0.026
-	-	6	0.236	16	0.630	4	0.157	M5x0.5	-	0.10
3.4	0.134	6	0.236	16	0.630	4	0.157	M5x0.5	-	0.10
4	0.157	12.7	0.500	18.3	0.720	5	0.197	M6x0.75	-	0.21
-	-	6	0.236	16	0.630	4	0.157	-	No.10-32UNF	0.10
3.4	0.134	6	0.236	16	0.630	4	0.157	-	No.10-32UNF	0.10
4	0.157	12.7	0.500	18.3	0.720	5	0.197	-	1/4-28UNF	0.21
-	-	5.5	0.217	11	0.433	3.3	0.130	M4x0.5	-	0.038
-	-	6	0.236	16	0.630	4	0.157	M5x0.5	-	0.10
3.4	0.134	6	0.236	16	0.630	4	0.157	M5x0.5	-	0.10
4	0.157	12.7	0.500	18.3	0.720	5	0.197	M6x0.75	-	0.19
-	-	6	0.236	16	0.630	4	0.157	-	No.10-32UNF	0.10
3.4	0.134	6	0.236	16	0.630	4	0.157	-	No.10-32UNF	0.10
4	0.157	12.7	0.500	18.3	0.720	5	0.197	-	1/4-28UNF	0.19
-	-	6	0.236	11.5	0.453	3.3	0.130	M4x0.5	-	0.050
-	-	6	0.236	16	0.630	4	0.157	M5x0.5	-	0.10
3.4	0.134	6	0.236	16	0.630	4	0.157	M5x0.5	-	0.10
4	0.157	12.7	0.500	18.3	0.720	5	0.197	M6x0.75	-	0.18
-	-	7	0.276	18	0.709	5	0.197	-	1/4-28UNF	0.15
3.7	0.146	7	0.276	18	0.709	5	0.197	-	1/4-28UNF	0.19
4	0.157	12.7	0.500	18.3	0.720	5	0.197	-	1/4-28UNF	0.16
-	-	7	0.276	14	0.551	4	0.157	M5x0.5	-	0.080
-	-	7	0.276	18	0.709	5	0.197	M6x0.75	-	0.15
3.7	0.146	7	0.276	18	0.709	5	0.197	M6x0.75	-	0.19
4	0.157	12.7	0.500	18.3	0.720	5	0.197	M6x0.75	-	0.16
-	-	7.5	0.295	19.5	0.768	5.5	0.217	-	1/4-28UNF	0.18
3.7	0.146	7.5	0.295	19.5	0.768	5.5	0.217	-	1/4-28UNF	0.19
5	0.197	14.3	0.563	19.8	0.780	5.5	0.217	-	1/4-28UNF	0.23
-	-	7.5	0.295	19.5	0.768	5.5	0.217	-	1/4-28UNF	0.18
3.7	0.146	7.5	0.295	19.5	0.768	5.5	0.217	-	1/4-28UNF	0.19
5	0.197	14.3	0.563	19.8	0.780	5.5	0.217	-	1/4-28UNF	0.21
-	-	7	0.276	15	0.591	4.5	0.177	M5x0.5	-	0.10
-	-	7.5	0.295	19.5	0.768	5.5	0.217	M6x0.75	-	0.18
3.7	0.146	7.5	0.295	19.5	0.768	5.5	0.217	M6x0.75	-	0.19
5	0.197	14.3	0.563	19.8	0.780	5.5	0.217	M6x0.75	-	0.20
6	0.236	15	0.591	23	0.906	6	0.236	M6x0.75	-	0.45
5	0.197	15.9	0.626	22.2	0.874	6	0.236	M6x0.75	-	0.39
-	-	7.5	0.295	19.5	0.768	5.5	0.217	-	1/4-28UNF	0.18
3.7	0.146	7.5	0.295	19.5	0.768	5.5	0.217	-	1/4-28UNF	0.19
5	0.197	14.3	0.563	19.8	0.780	5.5	0.217	-	1/4-28UNF	0.20
6	0.236	15	0.591	23	0.906	6	0.236	M6x0.75	-	0.44
5	0.197	15.9	0.626	22.2	0.874	6	0.236	-	1/4-28UNF	0.38
-	-	8	0.315	22	0.866	6	0.236	-	1/4-28UNF	0.27
4.7	0.185	8	0.315	22	0.866	6	0.236	-	1/4-28UNF	0.31
5	0.197	15.9	0.626	22.2	0.874	6	0.236	-	1/4-28UNF	0.34



**Ball Bearing Inserts**

**UC, SB, SB-RKP8, SU**  
Cylindrical bore (with set screws)  
*d* 30 ~ 40 mm

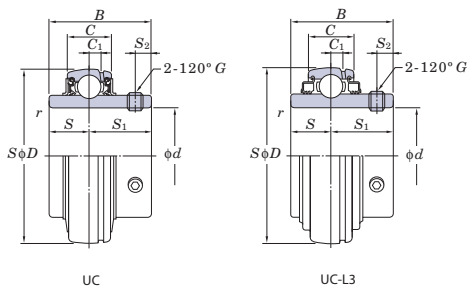
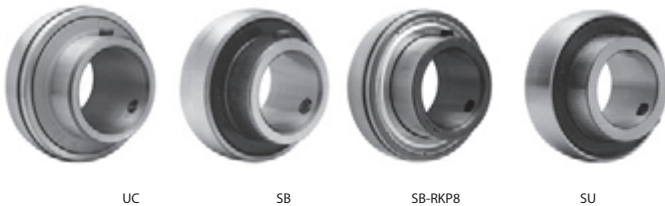

Shaft Dia.		Dimensions						Basic Load Ratings		Factor	Bearing No.			
mm	inch	<i>D</i>		<i>B</i>		<i>C</i>		<i>C<sub>r</sub></i>	<i>C<sub>0r</sub></i>	<i>f<sub>0</sub></i>	Standard	L3 Type		
<i>d</i>		mm	inch	mm	inch	mm	inch	<i>r</i> (min.)						
30	-	55	2.165	24.5	0.965	13	0.512	1	0.039	13.2	8.25	14.7	SU006	-
		62	2.441	30	1.181	16	0.630	1	0.039	19.5	11.3	13.9	SB206	-
		62	2.441	30	1.181	18	0.709	1	0.039	19.5	11.3	13.9	SB206RKP8	-
		62	2.441	38.1	1.500	19	0.748	1	0.039	19.5	11.3	13.9	UC206	UC206L3
		72	2.835	42.9	1.689	20	0.787	1	0.039	25.7	15.4	13.9	UCX06	UCX06L3
		72	2.835	43	1.693	24	0.945	1.1	0.043	26.7	15.0	13.3	UC306	-
-	1 3/16	62	2.441	30	1.181	16	0.630	1	0.039	19.5	11.3	13.9	SB206-19	-
		62	2.441	30	1.181	18	0.709	1	0.039	19.5	11.3	13.9	SB206-19RKP8	-
		62	2.441	38.1	1.500	19	0.748	1	0.039	19.5	11.3	13.9	UC206-19	UC206-19L2
		72	2.835	42.9	1.689	20	0.787	1	0.039	25.7	15.4	13.9	UCX06-19	UCX06-19L3
-	1 1/4	62	2.441	30	1.181	16	0.630	1	0.039	19.5	11.3	13.9	SB206-20	-
		62	2.441	30	1.181	18	0.709	1	0.039	19.5	11.3	13.9	SB206-20RKP8	-
		62	2.441	38.1	1.500	19	0.748	1	0.039	19.5	11.3	13.9	UC206-20	UC206-20L2
		72	2.835	42.9	1.689	20	0.787	1	0.039	25.7	15.4	13.9	UCX06-20	UCX06-20L3
-	1 1/4	72	2.835	32	1.260	17	0.669	1.1	0.043	25.7	15.4	13.9	SB207-20	-
		72	2.835	32	1.260	19	0.748	1.1	0.043	25.7	15.4	13.9	SB207-20RKP8	-
		72	2.835	42.9	1.689	20	0.787	1.1	0.043	25.7	15.4	13.9	UC207-20	UC207-20L3
-	1 5/16	72	2.835	42.9	1.689	20	0.787	1.1	0.043	25.7	15.4	13.9	UC207-21	UC207-21L3
		72	2.835	32	1.260	17	0.669	1.1	0.043	25.7	15.4	13.9	SB207-22	-
-	1 3/8	72	2.835	32	1.260	19	0.748	1.1	0.043	25.7	15.4	13.9	SB207-22RKP8	-
		72	2.835	42.9	1.689	20	0.787	1.1	0.043	25.7	15.4	13.9	UC207-22	UC207-22L3
		72	2.835	42.9	1.689	20	0.787	1.1	0.043	25.7	15.4	13.9	UCX07-22	UCX07-22L3
		80	3.150	49.2	1.937	21	0.827	1.1	0.043	29.1	17.8	14.0	UCX07-22	UCX07-22L3
35	-	72	2.835	32	1.260	17	0.669	1.1	0.043	25.7	15.4	13.9	SB207	-
		72	2.835	32	1.260	19	0.748	1.1	0.043	25.7	15.4	13.9	SB207RKP8	-
		72	2.835	42.9	1.689	20	0.787	1.1	0.043	25.7	15.4	13.9	UC207	UC207L3
		80	3.150	49.2	1.937	21	0.827	1.1	0.043	29.1	17.8	14.0	UCX07	UCX07L3
		80	3.150	48	1.890	26	1.024	1.5	0.059	33.4	19.3	13.2	UC307	UC307L3
		72	2.835	32	1.260	17	0.669	1.1	0.043	25.7	15.4	13.9	SB207-23	-
-	1 7/16	72	2.835	32	1.260	19	0.748	1.1	0.043	25.7	15.4	13.9	SB207-23RKP8	-
		72	2.835	42.9	1.689	20	0.787	1.1	0.043	25.7	15.4	13.9	UC207-23	UC207-23L3
		80	3.150	49.2	1.937	21	0.827	1.1	0.043	29.1	17.8	14.0	UCX07-23	UCX07-23L3
		80	3.150	34	1.339	18	0.709	1.1	0.043	29.1	17.8	14.0	SB208-24	-
-	1 1/2	80	3.150	34	1.339	22	0.866	1.1	0.043	29.1	17.8	14.0	SB208-24RKP8	-
		80	3.150	49.2	1.937	21	0.827	1.1	0.043	29.1	17.8	14.0	UC208-24	UC208-24L3
		85	3.346	49.2	1.937	22	0.866	1.1	0.043	34.1	21.3	14.0	UCX08-24	UCX08-24L3
		90	3.543	52	2.047	28	1.102	1.5	0.059	40.7	24.0	13.2	UC308-24	UC308-24L3
		80	3.150	49.2	1.937	21	0.827	1.1	0.043	29.1	17.8	14.0	UC208-25	UC208-25L3
40	-	80	3.150	34	1.339	18	0.709	1.1	0.043	29.1	17.8	14.0	SB208	-
		80	3.150	34	1.339	22	0.866	1.1	0.043	29.1	17.8	14.0	SB208RKP8	-
		80	3.150	49.2	1.937	21	0.827	1.1	0.043	29.1	17.8	14.0	UC208	UC208L3
		85	3.346	49.2	1.937	22	0.866	1.1	0.043	34.1	21.3	14.0	UCX08	UCX08L3
		90	3.543	52	2.047	28	1.102	1.5	0.059	40.7	24.0	13.2	UC308	UC308L3
		85	3.346	49.2	1.937	22	0.866	1.1	0.043	34.1	21.3	14.0	UC209-26	UC209-26L3
-	1 5/8	85	3.346	49.2	1.937	22	0.866	1.1	0.043	34.1	21.3	14.0	UC209-27	UC209-27L3
		90	3.543	51.6	2.031	24	0.945	1.1	0.043	35.1	23.3	14.4	UCX09-27	UCX09-27L3
-	1 11/16	85	3.346	49.2	1.937	22	0.866	1.1	0.043	34.1	21.3	14.0	UC209-28	UC209-28L3
		90	3.543	51.6	2.031	24	0.945	1.1	0.043	35.1	23.3	14.4	UCX09-28	UCX09-28L3
		100	3.937	57	2.244	30	1.181	1.5	0.059	48.9	29.5	13.3	UC309-28	UC309-28L3

Remarks 1. SU type product is the clean series ball bearing for unit.  
2. From UC201 to 205 are the double seal type products (L2).

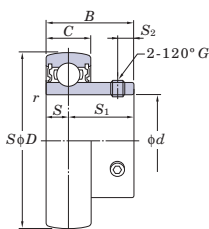

SB

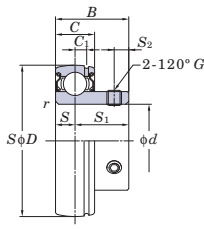

SB-RKP8

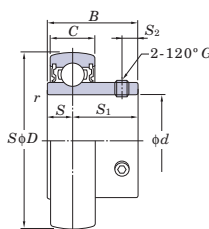

SU

Dimensions								Set Screw Brg. Bore G		Mass
C <sub>1</sub>		S		S <sub>1</sub>		S <sub>2</sub>		mm	inch	kg
mm	inch	mm	inch	mm	inch	mm	inch			
-	-	7.5	0.295	17	0.669	5.5	0.217	M5x0.5	-	0.15
-	-	8	0.315	22	0.866	6	0.236	M6x0.75	-	0.27
4.7	0.185	8	0.315	22	0.866	6	0.236	M6x0.75	-	0.31
5	0.197	15.9	0.626	22.2	0.874	6	0.236	M6x0.75	-	0.32
5.5	0.217	17.5	0.689	25.4	1.000	6.5	0.256	M8x1	-	0.58
6.5	0.256	17	0.669	26	1.024	6	0.236	M6x0.75	-	0.56
-	-	8	0.315	22	0.866	6	0.236	-	1/4-28UNF	0.27
4.7	0.185	8	0.315	22	0.866	6	0.236	-	1/4-28UNF	0.31
5	0.197	15.9	0.626	22.2	0.874	6	0.236	-	1/4-28UNF	0.32
5.5	0.217	17.5	0.689	25.4	1.000	6.5	0.256	-	5/16-24UNF	0.58
-	-	8	0.315	22	0.866	6	0.236	-	1/4-28UNF	0.27
4.7	0.185	8	0.315	22	0.866	6	0.236	-	1/4-28UNF	0.31
5	0.197	15.9	0.626	22.2	0.874	6	0.236	-	1/4-28UNF	0.30
5.5	0.217	17.5	0.689	25.4	1.000	6.5	0.256	-	5/16-24UNF	0.55
-	-	8.5	0.335	23.5	0.925	6	0.236	-	1/4-28UNF	0.42
5	0.197	8.5	0.335	23.5	0.925	6	0.236	-	1/4-28UNF	0.51
5.5	0.217	17.5	0.689	25.4	1.000	6.5	0.256	-	5/16-24UNF	0.54
5.5	0.217	17.5	0.689	25.4	1.000	6.5	0.256	-	5/16-24UNF	0.51
-	-	8.5	0.335	23.5	0.925	6	0.236	-	1/4-28UNF	0.42
5	0.197	8.5	0.335	23.5	0.925	6	0.236	-	1/4-28UNF	0.51
5.5	0.217	17.5	0.689	25.4	1.000	6.5	0.256	-	5/16-24UNF	0.48
6	0.236	19	0.748	30.2	1.189	8	0.315	-	5/16-24UNF	0.75
-	-	8.5	0.335	23.5	0.925	6	0.236	M6x0.75	-	0.42
5	0.197	8.5	0.335	23.5	0.925	6	0.236	M6x0.75	-	0.51
5.5	0.217	17.5	0.689	25.4	1.000	6.5	0.256	M8x1	-	0.48
6	0.236	19	0.748	30.2	1.189	8	0.315	M8x1	-	0.75
7.5	0.295	19	0.748	29	1.142	8	0.315	M8x1	-	0.71
-	-	8.5	0.335	23.5	0.925	6	0.236	-	1/4-28UNF	0.42
5	0.197	8.5	0.335	23.5	0.925	6	0.236	-	1/4-28UNF	0.51
5.5	0.217	17.5	0.689	25.4	1.000	6.5	0.256	-	5/16-24UNF	0.45
6	0.236	19	0.748	30.2	1.189	8	0.315	-	5/16-24UNF	0.72
-	-	9	0.354	25	0.984	8	0.315	-	5/16-24UNF	0.60
5.2	0.205	9	0.354	25	0.984	8	0.315	-	5/16-24UNF	0.65
6	0.236	19	0.748	30.2	1.189	8	0.315	-	5/16-24UNF	0.68
6	0.236	19	0.748	30.2	1.189	8	0.315	-	5/16-24UNF	0.87
8	0.315	19	0.748	33	1.299	10	0.394	M10x1.25	-	1.05
6	0.236	19	0.748	30.2	1.189	8	0.315	-	5/16-24UNF	0.60
-	-	9	0.354	25	0.984	8	0.315	M8x1	-	0.60
5.2	0.205	9	0.354	25	0.984	8	0.315	M8x1	-	0.65
6	0.236	19	0.748	30.2	1.189	8	0.315	M8x1	-	0.64
6	0.236	19	0.748	30.2	1.189	8	0.315	M8x1	-	0.83
8	0.315	19	0.748	33	1.299	10	0.394	M10x1.25	-	1.00
6	0.236	19	0.748	30.2	1.189	8	0.315	-	5/16-24UNF	0.78
6	0.236	19	0.748	30.2	1.189	8	0.315	-	5/16-24UNF	0.74
6	0.236	19	0.748	32.6	1.283	9	0.354	-	3/8-24UNF	0.93
6	0.236	19	0.748	30.2	1.189	8	0.315	-	5/16-24UNF	0.70
6	0.236	19	0.748	32.6	1.283	9	0.354	-	3/8-24UNF	0.97
8.5	0.335	22	0.866	35	1.378	10	0.394	M10x1.25	-	1.35





**Ball Bearing Inserts**

**UC, SB, SB-RKP8, SU**  
**Cylindrical bore (with set screws)**  
**d 45 ~ (75) mm**

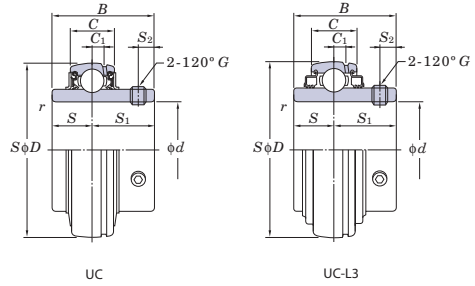
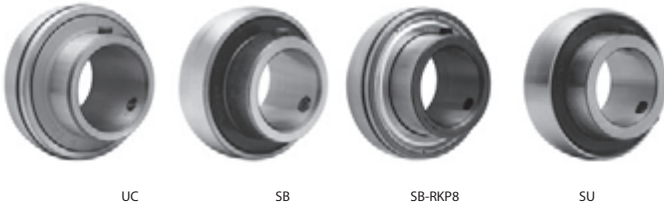

Shaft Dia.		Dimensions							Basic Load Ratings		Factor	Bearing No.		
mm	inch	D		B		C		r (min.)		C <sub>r</sub>	C <sub>0r</sub>	f <sub>0</sub>	Standard	L3 Type
d		mm	inch	mm	inch	mm	inch	mm	inch					
45	-	85	3.346	49.2	1.937	22	0.866	1.1	0.043	34.1	21.3	14.0	UC209	UC209L3
		90	3.543	51.6	2.031	24	0.945	1.1	0.043	35.1	23.3	14.4	UCX09	UCX09L3
		100	3.937	57	2.244	30	1.181	1.5	0.059	48.9	29.5	13.3	UC309	UC309L3
-	1 7/8	90	3.543	51.6	2.031	24	0.945	1.1	0.043	35.1	23.3	14.4	UC210-30	UC210-30L3
		100	3.937	55.6	2.189	25	0.984	1.1	0.043	43.4	29.4	14.4	UCX10-31	UC210-31L3
50	-	90	3.543	51.6	2.031	24	0.945	1.1	0.043	35.1	23.3	14.4	UC210	UC210L3
		100	3.937	55.6	2.189	25	0.984	1.1	0.043	43.4	29.4	14.4	UCX10	UCX10L3
		110	4.331	61	2.402	32	1.260	2	0.079	62.0	38.3	13.2	UC310	UC310L3
-	2	90	3.543	51.6	2.031	24	0.945	1.1	0.043	35.1	23.3	14.4	UC210-32	UC210-32L3
		100	3.937	55.6	2.189	25	0.984	1.1	0.043	43.4	29.4	14.4	UCX10-32	UC210-32L3
-	2	100	3.937	55.6	2.189	25	0.984	1.5	0.059	43.4	29.4	14.4	UC211-32	UC211-32L3
		120	4.724	66	2.598	34	1.339	2	0.079	71.6	45.0	13.2	UC311-32	UC311-32L3
55	-	100	3.937	55.6	2.189	25	0.984	1.5	0.059	43.4	29.4	14.4	UC211-34	UC211-34L3
		110	4.331	65.1	2.563	27	1.063	1.5	0.059	52.4	36.2	14.4	UC211	UC211L3
		120	4.724	66	2.598	34	1.339	2	0.079	71.6	45.0	13.2	UCX11	UCX11L3
-	2 3/16	100	3.937	55.6	2.189	25	0.984	1.5	0.059	43.4	29.4	14.4	UC311	UC311L3
		110	4.331	65.1	2.563	27	1.063	1.5	0.059	52.4	36.2	14.4	UC211-35	UC211-35L3
		120	4.724	66	2.598	34	1.339	2	0.079	71.6	45.0	13.2	UCX11-35	UCX11-35L3
-	2 1/4	110	4.331	65.1	2.563	27	1.063	1.5	0.059	52.4	36.2	14.4	UC311-35	UC311-35L3
		110	4.331	65.1	2.563	27	1.063	1.5	0.059	52.4	36.2	14.4	UCX11-36	UCX11-36L3
		110	4.331	65.1	2.563	27	1.063	1.5	0.059	52.4	36.2	14.4	UC212-36	UC212-36L3
60	-	110	4.331	65.1	2.563	27	1.063	1.5	0.059	52.4	36.2	14.4	UC212	UC212L3
		120	4.724	65.1	2.563	28	1.102	1.5	0.059	57.2	40.1	14.4	UCX12	UCX12L3
		130	5.118	71	2.795	36	1.417	2.1	0.083	81.9	52.2	13.2	UC312	UC312L3
-	2 3/8	110	4.331	65.1	2.563	27	1.063	1.5	0.059	52.4	36.2	14.4	UC212-38	UC212-38L3
		110	4.331	65.1	2.563	27	1.063	1.5	0.059	52.4	36.2	14.4	UC212-39	UC212-39L3
		120	4.724	65.1	2.563	28	1.102	1.5	0.059	57.2	40.1	14.4	UCX12-39	UCX12-39L3
-	2 7/16	130	5.118	71	2.795	36	1.417	2.1	0.083	81.9	52.2	13.2	UC312-39	UC312-39L3
		120	4.724	65.1	2.563	28	1.102	1.5	0.059	57.2	40.1	14.4	UC213-40	UC213-40L3
		140	5.512	75	2.953	38	1.496	2.1	0.083	92.7	59.9	13.2	UCX13-40	UCX13-40L3
65	-	120	4.724	65.1	2.563	28	1.102	1.5	0.059	62.2	44.1	14.5	UC313-40	UC313-40L3
		125	4.921	74.6	2.937	30	1.181	1.5	0.059	62.2	44.1	14.5	UC213	UC213L3
		140	5.512	75	2.953	38	1.496	2.1	0.083	92.7	59.9	13.2	UCX13	UCX13L3
-	2 3/4	125	4.921	74.6	2.937	30	1.181	1.5	0.059	62.2	44.1	14.5	UC313	UC313L3
		130	5.118	77.8	3.063	32	1.260	1.5	0.059	67.4	48.3	14.5	UC214-44	UC214-44L3
		150	5.906	78	3.071	40	1.575	2.1	0.083	104	68.2	13.2	UCX14-44	UCX14-44L3
70	-	125	4.921	74.6	2.937	30	1.181	1.5	0.059	62.2	44.1	14.5	UC314-44	UC314-44L3
		130	5.118	77.8	3.063	32	1.260	1.5	0.059	67.4	48.3	14.5	UC214	UC214L3
		150	5.906	78	3.071	40	1.575	2.1	0.083	104	68.2	13.2	UCX14	UCX14L3
-	2 15/16	130	5.118	77.8	3.063	32	1.260	1.5	0.059	67.4	48.3	14.5	UC314	UC314L3
		140	5.512	82.6	3.252	33	1.299	1.5	0.059	67.4	48.3	14.5	UC215-47	UC215-47L3
		160	6.299	82	3.228	42	1.654	2.1	0.083	113	77.2	13.2	UCX15-47	UCX15-47L3
75	-	130	5.118	77.8	3.063	32	1.260	1.5	0.059	67.4	48.3	14.5	UC315-47	UC315-47L3
		140	5.512	82.6	3.252	33	1.299	1.5	0.059	67.4	48.3	14.5	UC215	UC215L3
		160	6.299	82	3.228	42	1.654	2.1	0.083	113	77.2	13.2	UCX15	UCX15L3
-	3	130	5.118	77.8	3.063	32	1.260	1.5	0.059	67.4	48.3	14.5	UC315	UC315L3
		140	5.512	82.6	3.252	33	1.299	1.5	0.059	72.7	53.0	14.6	UC215-48	UC215-48L3
		160	6.299	82	3.228	42	1.654	2.1	0.083	113	77.2	13.2	UCX15-48	UCX15-48L3

Remarks 1. SU type product is the clean series ball bearing for unit.  
2. From UC201 to 205 are the double seal type products (L2).

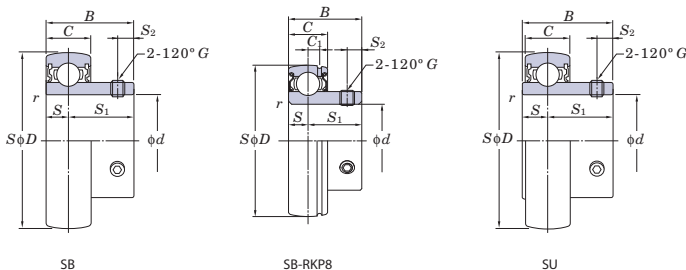

	Dimensions								Set Screw Brg. Bore G		Mass kg
	C <sub>1</sub>		S		S <sub>1</sub>		S <sub>2</sub>		mm	inch	
	mm	inch	mm	inch	mm	inch	mm	inch			
6	0.236	19	0.748	30.2	1.189	8	0.315	M8x1	-	0.68	
6	0.236	19	0.748	32.6	1.283	9	0.354	M10x1.25	-	0.95	
8.5	0.335	22	0.866	35	1.378	10	0.394	M10x1.25	-	1.33	
6	0.236	19	0.748	32.6	1.283	9	0.354	-	3/8-24UNF	0.87	
6	0.236	19	0.748	32.6	1.283	9	0.354	-	3/8-24UNF	0.82	
7	0.276	22.2	0.874	33.4	1.315	9	0.354	-	3/8-24UNF	1.32	
6	0.236	19	0.748	32.6	1.283	9	0.354	M10x1.25	-	0.80	
7	0.276	22.2	0.874	33.4	1.315	9	0.354	M10x1.25	-	1.29	
9	0.354	22	0.866	39	1.535	12	0.472	M12x1.5	-	1.69	
6	0.236	19	0.748	32.6	1.283	9	0.354	-	3/8-24UNF	0.78	
7	0.276	22.2	0.874	33.4	1.315	9	0.354	-	3/8-24UNF	1.26	
7	0.276	22.2	0.874	33.4	1.315	9	0.354	-	3/8-24UNF	1.26	
10	0.394	25	0.984	41	1.614	12	0.472	M12x1.5	-	2.08	
7	0.276	22.2	0.874	33.4	1.315	9	0.354	-	3/8-24UNF	1.15	
7	0.276	22.2	0.874	33.4	1.315	9	0.354	M10x1.25	-	1.11	
7.5	0.295	25.4	1.000	39.7	1.563	10.5	0.413	M10x1.25	-	1.80	
10	0.394	25	0.984	41	1.614	12	0.472	M12x1.5	-	1.90	
7	0.276	22.2	0.874	33.4	1.315	9	0.354	-	3/8-24UNF	1.09	
7.5	0.295	25.4	1.000	39.7	1.563	10.5	0.413	-	3/8-24UNF	1.78	
10	0.394	25	0.984	41	1.614	12	0.472	M12x1.5	-	1.67	
7.5	0.295	25.4	1.000	39.7	1.563	10.5	0.413	-	3/8-24UNF	1.7	
7.5	0.295	25.4	1.000	39.7	1.563	10.5	0.413	-	3/8-24UNF	1.67	
7.5	0.295	25.4	1.000	39.7	1.563	10.5	0.413	M10x1.25	-	1.54	
7.5	0.295	25.4	1.000	39.7	1.563	12	0.472	M12x1.5	-	2.05	
11.5	0.453	26	1.024	45	1.772	12	0.472	M12x1.5	-	2.60	
7.5	0.295	25.4	1.000	39.7	1.563	10.5	0.413	-	3/8-24UNF	1.52	
7.5	0.295	25.4	1.000	39.7	1.563	10.5	0.413	-	3/8-24UNF	1.45	
7.5	0.295	25.4	1.000	39.7	1.563	12	0.472	-	1/2-20UNF	1.95	
11.5	0.453	26	1.024	45	1.772	12	0.472	M12x1.5	-	2.50	
7.5	0.295	25.4	1.000	39.7	1.563	12	0.472	-	1/2-20UNF	1.94	
9	0.354	30.2	1.189	44.4	1.748	12	0.472	-	1/2-20UNF	2.61	
12	0.472	30	1.181	45	1.772	12	0.472	M12x1.5	-	3.24	
7.5	0.295	25.4	1.000	39.7	1.563	12	0.472	M12x1.5	-	1.86	
9	0.354	30.2	1.189	44.4	1.748	12	0.472	M12x1.5	-	2.52	
12	0.472	30	1.181	45	1.772	12	0.472	M12x1.5	-	3.16	
9	0.354	30.2	1.189	44.4	1.748	12	0.472	-	1/2-20UNF	2.06	
9	0.354	33.3	1.311	44.5	1.752	12	0.472	-	1/2-20UNF	2.75	
12.5	0.492	33	1.299	45	1.772	12	0.472	M12x1.5	-	3.91	
9	0.354	30.2	1.189	44.4	1.748	12	0.472	M12x1.5	-	2.05	
9	0.354	33.3	1.311	44.5	1.752	12	0.472	M12x1.5	-	2.74	
12.5	0.492	33	1.299	45	1.772	12	0.472	M12x1.5	-	3.90	
9	0.354	33.3	1.311	44.5	1.752	12	0.472	-	1/2-20UNF	2.23	
9	0.354	33.3	1.311	49.3	1.941	14	0.551	-	1/2-20UNF	3.43	
14.5	0.571	32	1.260	50	1.969	14	0.551	M14x1.5	-	4.72	
9	0.354	33.3	1.311	44.5	1.752	12	0.472	M12x1.5	-	2.21	
9	0.354	33.3	1.311	49.3	1.941	14	0.551	M12x1.5	-	3.41	
14.5	0.571	32	1.260	50	1.969	14	0.551	M14x1.5	-	4.70	
9	0.354	33.3	1.311	44.5	1.752	12	0.472	-	1/2-20UNF	2.12	
9	0.354	33.3	1.311	49.3	1.941	14	0.551	-	1/2-20UNF	3.32	
14.5	0.571	32	1.260	50	1.969	14	0.551	M14x1.5	-	4.61	





**Ball Bearing Inserts**

**UC, SB, SB-RKP8, SU**  
**Cylindrical bore (with set screws)**  
*d* (75) ~ 140 mm

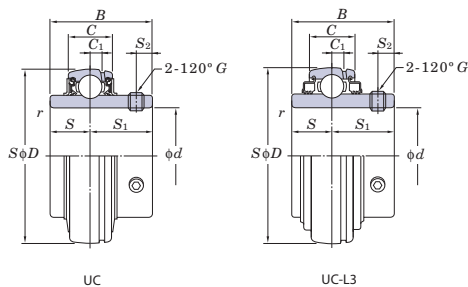
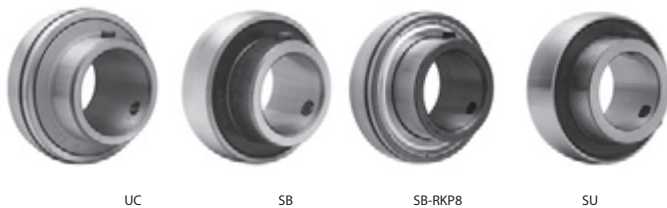

Shaft Dia. mm inch		Dimensions						Basic Load Ratings kN		Factor <i>f</i> <sub>0</sub>	Bearing No.			
		<i>D</i>		<i>B</i>		<i>C</i>		<i>r</i> (min.)			Standard	L3 Type		
<i>d</i>		mm	inch	mm	inch	mm	inch	mm	inch	<i>C</i> <sub>r</sub>	<i>C</i> <sub>0r</sub>			
80	-	140	5.512	82.6	3.252	33	1.299	2	0.079	72.7	53.0	14.6	UC216-50	UC216-50L3
		140	5.512	82.6	3.252	33	1.299	2	0.079	72.7	53.0	14.6	UC216	UC216L3
		150	5.906	85.7	3.374	35	1.378	2	0.079	84.0	61.9	14.5	UCX16	UCX16L3
		170	6.693	86	3.386	44	1.732	2.1	0.083	123	86.7	13.3	UC316	UC316L3
85	-	150	5.906	85.7	3.374	35	1.378	2	0.079	84.0	61.9	14.5	UC217-52	UC217-52L3
		150	5.906	85.7	3.374	35	1.378	2	0.079	84.0	61.9	14.5	UC217	UC217L3
		160	6.299	96	3.780	38	1.496	2	0.079	96.1	71.5	14.5	UCX17	UCX17L3
		180	7.087	96	3.780	46	1.811	3	0.118	133	96.8	13.3	UC317	UC317L3
90	-	160	6.299	96	3.780	38	1.496	2	0.079	96.1	71.5	14.5	UCX17-55	UCX17-55L3
		160	6.299	96	3.780	38	1.496	2	0.079	96.1	71.5	14.5	UC218-56	UC218-56L3
95	-	190	7.480	96	3.780	48	1.890	3	0.118	143	107	13.3	UC318-56	UC318-56L3
		160	6.299	96	3.780	38	1.496	2	0.079	96.1	71.5	14.5	UC218	UC218L3
		170	6.693	104	4.094	40	1.575	2	0.079	109	81.9	14.4	UCX18	-
100	-	190	7.480	96	3.780	48	1.890	3	0.118	143	107	13.3	UC318	UC318L3
		200	7.874	103	4.055	50	1.969	3	0.118	153	119	13.3	UC319	UC319L3
105	-	190	7.480	117.5	4.626	43	1.693	2.1	0.083	133	105	14.4	UCX20	-
		215	8.465	108	4.252	54	2.126	3	0.118	173	141	13.2	UC320	UC320L3
110	-	190	7.480	117.5	4.626	43	1.693	2.1	0.083	133	105	14.4	UCX20-63	-
		215	8.465	108	4.252	54	2.126	3	0.118	173	141	13.2	UC320-63	UC320-63L3
120	-	190	7.480	117.5	4.626	43	1.693	2.1	0.083	133	105	14.4	UCX20-64	-
		215	8.465	108	4.252	54	2.126	3	0.118	173	141	13.2	UC320-64	UC320-64L3
130	-	225	8.858	112	4.409	56	2.205	3	0.118	184	153	13.2	UC321	-
		240	9.449	117	4.606	60	2.362	3	0.118	205	180	13.2	UC322	UC322L3
140	-	260	10.236	126	4.961	64	2.520	3	0.118	207	185	13.5	UC324	UC324L3
		280	11.024	135	5.315	68	2.677	4	0.157	229	214	13.6	UC326	UC326L3
140	-	300	11.811	145	5.709	72	2.835	4	0.157	253	246	13.6	UC328	UC328L3

Remarks 1. SU type product is the clean series ball bearing for unit.  
2. From UC201 to 205 are the double seal type products (L2).

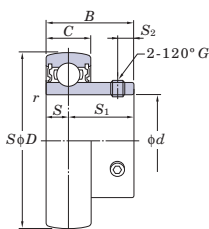

SB

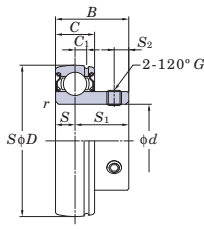

SB-RKP8

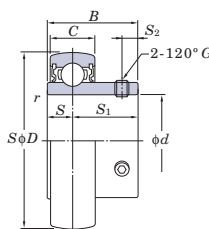

SU

	Dimensions								Set Screw Brg. Bore G		Mass kg
	C <sub>1</sub>		S		S <sub>1</sub>		S <sub>2</sub>		mm	inch	
	mm	inch	mm	inch	mm	inch	mm	inch			
9	0.354	33.3	1.311	49.3	1.941	14	0.551	-	1/2-20UNF	2.84	
9	0.354	33.3	1.311	49.3	1.941	14	0.551	M12×1.5	-	2.79	
10	0.394	34.1	1.343	51.6	2.031	14	0.551	M12×1.5	-	3.87	
15	0.591	34	1.339	52	2.047	14	0.551	M14×1.5	-	5.60	
10	0.394	34.1	1.343	51.6	2.031	14	0.551	-	1/2-20UNF	3.66	
10	0.394	34.1	1.343	51.6	2.031	14	0.551	M12×1.5	-	3.45	
11	0.433	39.7	1.563	56.3	2.217	15	0.591	M12×1.5	-	5.05	
15	0.591	40	1.575	56	2.205	16	0.630	M16×1.5	-	6.90	
11	0.433	39.7	1.563	56.3	2.217	15	0.591	-	1/2-20UNF	4.80	
11	0.433	39.7	1.563	56.3	2.217	15	0.591	-	1/2-20UNF	4.46	
15.5	0.610	40	1.575	56	2.205	16	0.630	M16×1.5	-	8.03	
11	0.433	39.7	1.563	56.3	2.217	15	0.591	M12×1.5	-	4.35	
11.5	0.453	42.9	1.689	61.1	2.406	16	0.630	M14×1.5	-	6.00	
15.5	0.610	40	1.575	56	2.205	16	0.630	M16×1.5	-	7.87	
16.5	0.650	41	1.614	62	2.441	18	0.709	M16×1.5	-	8.91	
13	0.512	49.2	1.937	68.3	2.689	18	0.709	M16×1.5	-	8.56	
18	0.709	42	1.654	66	2.598	20	0.787	M18×1.5	-	11.2	
13	0.512	49.2	1.937	68.3	2.689	18	0.709	-	5/8-18UNF	8.56	
18	0.709	42	1.654	66	2.598	20	0.787	M18×1.5	-	11.2	
13	0.512	49.2	1.937	68.3	2.689	18	0.709	-	5/8-18UNF	8.33	
18	0.709	42	1.654	66	2.598	20	0.787	M18×1.5	-	11.0	
19	0.748	44	1.732	68	2.677	20	0.787	M18×1.5	-	12.7	
20	0.787	46	1.811	71	2.795	20	0.787	M18×1.5	-	15.1	
21	0.827	51	2.008	75	2.953	20	0.787	M18×1.5	-	19.0	
22	0.866	54	2.126	81	3.189	20	0.787	M20×1.5	-	23.6	
23	0.906	59	2.323	86	3.386	20	0.787	M20×1.5	-	29.4	



**Ball Bearing Inserts**

**UC-S6, SU-S6 (Stainless steel series)  
Cylindrical bore (with set screws)**

d 10 ~ 60 mm



UC-S6



SU-S6

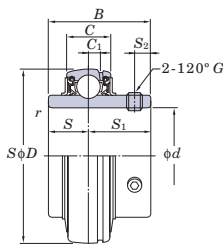

UC-S6

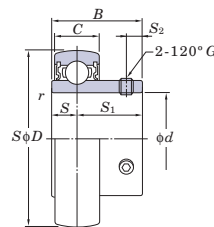

SU-S6

Shaft Dia. mm inch	Dimensions								Basic Load Ratings kN		Factor	Bearing No.	Standard	
	D		B		C		r (min.)		C <sub>r</sub>	C <sub>0r</sub>	f <sub>0</sub>			
d	mm	inch	mm	inch	mm	inch	mm	inch						
10	—	26	1.024	15	0.591	8	0.315	0.3	0.012	3.9	1.55	12.3	SU000S6	
		28	1.102	15	0.591	8	0.315	0.3	0.012	4.3	1.9	13.2	SU001S6	
12	1/2	40	1.575	27.4	1.079	13	0.512	0.6	0.024	8.15	3.85	13.2	UC201XS6	
		40	1.575	27.4	1.079	13	0.512	0.6	0.024	8.15	3.85	13.2	UC201-8XS6	
15	5/8	32	1.260	16.5	0.650	9	0.354	0.3	0.012	4.7	2.25	13.9	SU002S6	
		40	1.575	27.4	1.079	13	0.512	0.6	0.024	8.15	3.85	13.2	UC202XS6	
17	—	35	1.378	17.5	0.689	10	0.394	0.3	0.012	5.1	2.6	14.4	SU003S6	
		40	1.575	27.4	1.079	13	0.512	0.6	0.024	8.15	3.85	13.2	UC203XS6	
20	3/4	47	1.850	31	1.220	16	0.630	1	0.039	10.9	5.35	13.2	UC204-12S6	
		42	1.654	21	0.827	12	0.472	0.6	0.024	7.9	4	13.9	SU004S6	
		47	1.850	31	1.220	16	0.630	1	0.039	10.9	5.35	13.2	UC204S6	
25	1 1/16	52	2.047	34.1	1.343	17	0.669	1	0.039	11.9	6.3	13.9	UC205-14S6	
		52	2.047	34.1	1.343	17	0.669	1	0.039	11.9	6.3	13.9	UC205-15S6	
		47	1.850	22	0.866	12	0.472	0.6	0.024	8.5	4.65	14.5	SU005S6	
		52	2.047	34.1	1.343	17	0.669	1	0.039	11.9	6.3	13.9	UC205S6	
30	1 1/8	52	2.047	34.1	1.343	17	0.669	1	0.039	11.9	6.3	13.9	UC205-16S6	
		62	2.441	38.1	1.500	19	0.748	1	0.039	16.5	9.05	13.9	UC206-18S6	
35	1 3/16	55	2.165	24.5	0.965	13	0.512	1	0.039	11.2	6.6	14.7	SU006S6	
		62	2.441	38.1	1.500	19	0.748	1	0.039	16.5	9.05	13.9	UC206S6	
		62	2.441	38.1	1.500	19	0.748	1	0.039	16.5	9.05	13.9	UC206-19S6	
		1 1/4	62	2.441	38.1	1.500	19	0.748	1	0.039	16.5	9.05	13.9	UC206-20S6
		72	2.835	42.9	1.689	20	0.787	1.1	0.043	21.8	12.3	13.9	UC207-20S6	
40	1 1/2	72	2.835	42.9	1.689	20	0.787	1.1	0.043	21.8	12.3	13.9	UC207-21S6	
		72	2.835	42.9	1.689	20	0.787	1.1	0.043	21.8	12.3	13.9	UC207-22S6	
		72	2.835	42.9	1.689	20	0.787	1.1	0.043	21.8	12.3	13.9	UC207S6	
		72	2.835	42.9	1.689	20	0.787	1.1	0.043	21.8	12.3	13.9	UC207-23S6	
45	1 5/8	80	3.150	49.2	1.937	21	0.827	1.1	0.043	24.8	14.3	14.0	UC208-24S6	
		80	3.150	49.2	1.937	21	0.827	1.1	0.043	24.8	14.3	14.0	UC208-25S6	
		80	3.150	49.2	1.937	21	0.827	1.1	0.043	24.8	14.3	14.0	UC208S6	
		85	3.346	49.2	1.937	22	0.866	1.1	0.043	27.8	16.2	14.0	UC209-26S6	
50	1 7/8	85	3.346	49.2	1.937	22	0.866	1.1	0.043	27.8	16.2	14.0	UC209-27S6	
		85	3.346	49.2	1.937	22	0.866	1.1	0.043	27.8	16.2	14.0	UC209-28S6	
		85	3.346	49.2	1.937	22	0.866	1.1	0.043	27.8	16.2	14.0	UC209S6	
		90	3.543	51.6	2.031	24	0.945	1.1	0.043	29.8	18.6	14.4	UC210-30S6	
55	2	90	3.543	51.6	2.031	24	0.945	1.1	0.043	29.8	18.6	14.4	UC210-31S6	
		90	3.543	51.6	2.031	24	0.945	1.1	0.043	29.8	18.6	14.4	UC210S6	
		90	3.543	51.6	2.031	24	0.945	1.1	0.043	29.8	18.6	14.4	UC210-32S6	
		100	3.937	55.6	2.189	25	0.984	1.5	0.059	36.8	23.5	14.4	UC211-32S6	
60	2 1/4	100	3.937	55.6	2.189	25	0.984	1.5	0.059	36.8	23.5	14.4	UC211-34S6	
		100	3.937	55.6	2.189	25	0.984	1.5	0.059	36.8	23.5	14.4	UC211S6	
		100	3.937	55.6	2.189	25	0.984	1.5	0.059	36.8	23.5	14.4	UC211-35S6	
60	2 3/8	110	4.331	65.1	2.563	27	1.063	1.5	0.059	44.5	29	14.4	UC212-36S6	
		110	4.331	65.1	2.563	27	1.063	1.5	0.059	44.5	29	14.4	UC212S6	
		110	4.331	65.1	2.563	27	1.063	1.5	0.059	44.5	29	14.4	UC212-38S6	
		110	4.331	65.1	2.563	27	1.063	1.5	0.059	44.5	29	14.4	UC212-39S6	

Remark S6 series product is the stainless steel series ball bearing for unit.



	Dimensions								Set Screw Brg. Bore G mm	Mass kg
	C <sub>1</sub>		S		S <sub>1</sub>		S <sub>2</sub>			
	mm	inch	mm	inch	mm	inch	mm	inch		
-	-	5	0.197	10	0.394	3	0.118	M3×0.35	0.024	
-	-	5	0.197	10	0.394	3	0.118	M3×0.35	0.026	
3.5	0.138	11.5	0.453	15.9	0.626	4	0.158	M5×0.5	0.10	
3.5	0.138	11.5	0.453	15.9	0.626	4	0.158	M5×0.5	0.10	
-	-	5.5	0.217	11	0.433	3.3	0.130	M4×0.5	0.038	
3.5	0.138	11.5	0.453	15.9	0.626	4	0.158	M5×0.5	0.10	
3.5	0.138	11.5	0.453	15.9	0.626	4	0.158	M5×0.5	0.10	
-	-	6	0.236	11.5	0.453	3.3	0.130	M4×0.5	0.050	
3.5	0.138	11.5	0.453	15.9	0.626	4	0.158	M5×0.5	0.10	
4	0.157	12.7	0.500	18.3	0.720	5	0.197	M6×0.75	0.16	
-	-	7	0.276	14	0.551	4	0.157	M5×0.5	0.080	
4	0.157	12.7	0.500	18.3	0.720	5	0.197	M6×0.75	0.16	
5	0.197	14.3	0.563	19.8	0.780	5.5	0.217	M6×0.75	0.23	
5	0.197	14.3	0.563	19.8	0.780	5.5	0.217	M6×0.75	0.21	
-	-	7	0.276	15	0.591	4.5	0.177	M5×0.5	0.10	
5	0.197	14.3	0.563	19.8	0.780	5.5	0.217	M6×0.75	0.20	
5	0.197	14.3	0.563	19.8	0.780	5.5	0.217	M6×0.75	0.20	
5	0.197	15.9	0.626	22.2	0.874	6	0.236	M6×0.75	0.34	
-	-	7.5	0.295	17	0.669	5.5	0.217	M5×0.5	0.15	
5	0.197	15.9	0.626	22.2	0.874	6	0.236	M6×0.75	0.32	
5	0.197	15.9	0.626	22.2	0.874	6	0.236	M6×0.75	0.32	
5	0.197	15.9	0.626	22.2	0.874	6	0.236	M6×0.75	0.30	
5.5	0.217	17.5	0.689	25.4	1.000	6.5	0.256	M8×1	0.54	
5.5	0.217	17.5	0.689	25.4	1.000	6.5	0.256	M8×1	0.51	
5.5	0.217	17.5	0.689	25.4	1.000	6.5	0.256	M8×1	0.48	
5.5	0.217	17.5	0.689	25.4	1.000	6.5	0.256	M8×1	0.48	
5.5	0.217	17.5	0.689	25.4	1.000	6.5	0.256	M8×1	0.45	
6	0.236	19	0.748	30.2	1.189	8	0.315	M8×1	0.68	
6	0.236	19	0.748	30.2	1.189	8	0.315	M8×1	0.60	
6	0.236	19	0.748	30.2	1.189	8	0.315	M8×1	0.64	
6	0.236	19	0.748	30.2	1.189	8	0.315	M8×1	0.78	
6	0.236	19	0.748	30.2	1.189	8	0.315	M8×1	0.74	
6	0.236	19	0.748	30.2	1.189	8	0.315	M8×1	0.70	
6	0.236	19	0.748	30.2	1.189	8	0.315	M8×1	0.68	
6	0.236	19	0.748	32.6	1.283	9	0.354	M8×1	0.87	
6	0.236	19	0.748	32.6	1.283	9	0.354	M8×1	0.82	
6	0.236	19	0.748	32.6	1.283	9	0.354	M8×1	0.80	
6	0.236	19	0.748	32.6	1.283	9	0.354	M8×1	0.78	
7	0.276	22.2	0.874	33.4	1.315	9	0.354	M10×1.25	1.26	
7	0.276	22.2	0.874	33.4	1.315	9	0.354	M10×1.25	1.15	
7	0.276	22.2	0.874	33.4	1.315	9	0.354	M10×1.25	1.11	
7	0.276	22.2	0.874	33.4	1.315	9	0.354	M10×1.25	1.09	
7.5	0.295	25.4	1.000	39.7	1.563	10.5	0.413	M10×1.25	1.67	
7.5	0.295	25.4	1.000	39.7	1.563	10.5	0.413	M10×1.25	1.54	
7.5	0.295	25.4	1.000	39.7	1.563	10.5	0.413	M10×1.25	1.52	
7.5	0.295	25.4	1.000	39.7	1.563	10.5	0.413	M10×1.25	1.45	



**Ball Bearing Inserts**

**SA, SA-F, NA**  
**Cylindrical bore**  
**(with eccentric locking collar)**



SA



SA-F



NA

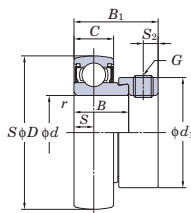

SA

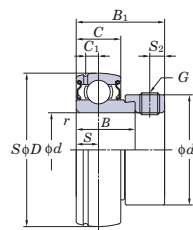

SA-F

Shaft Dia		Dimensions									Basic Load Ratings		Factor	Bearing No.	
mm	inch	D		B		B <sub>1</sub>		C		r (min.)		C <sub>r</sub>	C <sub>0r</sub>	f <sub>0</sub>	
d		mm	inch	mm	inch	mm	inch	mm	inch	mm	inch	kN			
12	-	40	1.575	19	0.784	28.5	1.122	12	0.472	0.6	0.024	9.55	4.80	13.2	SA201
		40	1.575	19.1	0.752	28.6	1.126	13	0.512	0.6	0.024	9.55	4.80	13.2	SA201F
		47	1.850	34.2	1.346	43.7	1.720	16	0.630	1	0.039	12.8	6.65	13.2	NA201
-	1/2	40	1.575	19	0.784	28.5	1.122	12	0.472	0.6	0.024	9.55	4.80	13.2	SA201-8
		40	1.575	19.1	0.752	28.6	1.126	13	0.512	0.6	0.024	9.55	4.80	13.2	SA201-8F
		47	1.850	34.2	1.346	43.7	1.720	16	0.630	1	0.039	12.8	6.65	13.2	NA201-8
15	-	40	1.575	19	0.784	28.5	1.122	12	0.472	0.6	0.024	9.55	4.80	13.2	SA202
		40	1.575	19.1	0.752	28.6	1.126	13	0.512	0.6	0.024	9.55	4.80	13.2	SA202F
		47	1.850	34.2	1.346	43.7	1.720	16	0.630	1	0.039	12.8	6.65	13.2	NA202
-	5/8	40	1.575	19	0.784	28.5	1.122	12	0.472	0.6	0.024	9.55	4.80	13.2	SA202-10
		47	1.850	34.2	1.346	43.7	1.720	16	0.630	1	0.039	12.8	6.65	13.2	NA202-10
		40	1.575	19	0.784	28.5	1.122	12	0.472	0.6	0.024	9.55	4.80	13.2	SA203
17	-	40	1.575	19.1	0.752	28.6	1.126	13	0.512	0.6	0.024	9.55	4.80	13.2	SA203F
		47	1.850	34.2	1.346	43.7	1.720	16	0.630	1	0.039	12.8	6.65	13.2	NA203
		47	1.850	20	0.787	29.5	1.161	14	0.551	1	0.039	12.8	6.65	13.2	SA204-12
-	3/4	47	1.850	21.5	0.846	31	1.220	15	0.591	1	0.039	12.8	6.65	13.2	SA204-12F
		47	1.850	34.2	1.346	43.7	1.720	16	0.630	1	0.039	12.8	6.65	13.2	NA204-12
		47	1.850	20	0.787	29.5	1.161	14	0.551	1	0.039	12.8	6.65	13.2	SA204
20	-	47	1.850	21.5	0.846	31	1.220	15	0.591	1	0.039	12.8	6.65	13.2	SA204F
		47	1.850	34.2	1.346	43.7	1.720	16	0.630	1	0.039	12.8	6.65	13.2	NA204
		52	2.047	21	0.827	30.5	1.201	15	0.591	1	0.039	14.0	7.85	13.9	SA205-14
-	7/8	52	2.047	34.9	1.374	44.4	1.748	17	0.669	1	0.039	14.0	7.85	13.9	NA205-14
		52	2.047	21	0.827	30.5	1.201	15	0.591	1	0.039	14.0	7.85	13.9	SA205-15
		52	2.047	21.5	0.846	31	1.220	15	0.591	1	0.039	14.0	7.85	13.9	SA205-15F
-	15/16	52	2.047	34.9	1.374	44.4	1.748	17	0.669	1	0.039	14.0	7.85	13.9	NA205-15
		52	2.047	21	0.827	30.5	1.201	15	0.591	1	0.039	14.0	7.85	13.9	SA205
		52	2.047	21.5	0.846	31	1.220	15	0.591	1	0.039	14.0	7.85	13.9	SA205F
25	-	52	2.047	34.9	1.374	44.4	1.748	17	0.669	1	0.039	14.0	7.85	13.9	NA205
		52	2.047	21	0.827	30.5	1.201	15	0.591	1	0.039	14.0	7.85	13.9	SA205-16
		52	2.047	21.5	0.846	31	1.220	15	0.591	1	0.039	14.0	7.85	13.9	SA205-16F
-	1	52	2.047	34.9	1.374	44.4	1.748	17	0.669	1	0.039	14.0	7.85	13.9	NA205-16
		62	2.441	22	0.866	33.9	1.335	16	0.630	1	0.039	19.5	11.3	13.9	SA206-18
		62	2.441	23.8	0.937	35.7	1.406	18	0.709	1	0.039	19.5	11.3	13.9	SA206-18F
-	1 1/8	62	2.441	36.5	1.437	48.4	1.906	19	0.748	1	0.039	19.5	11.3	13.9	NA206-18
		62	2.441	22	0.866	33.9	1.335	16	0.630	1	0.039	19.5	11.3	13.9	SA206
		62	2.441	23.8	0.937	35.7	1.406	18	0.709	1	0.039	19.5	11.3	13.9	SA206F
30	-	62	2.441	36.5	1.437	48.4	1.906	19	0.748	1	0.039	19.5	11.3	13.9	NA206
		62	2.441	22	0.866	33.9	1.335	16	0.630	1	0.039	19.5	11.3	13.9	SA206-19
		62	2.441	23.8	0.937	35.7	1.406	18	0.709	1	0.039	19.5	11.3	13.9	SA206-19F
-	1 3/16	62	2.441	36.5	1.437	48.4	1.906	19	0.748	1	0.039	19.5	11.3	13.9	NA206-19
		72	2.835	36.5	1.437	50	1.969	24	0.945	1.1	0.043	26.7	15.0	13.3	SA206-19
		62	2.441	22	0.866	33.9	1.335	16	0.630	1	0.039	19.5	11.3	13.9	SA206-20
-	1 1/4	62	2.441	23.8	0.937	35.7	1.406	18	0.709	1	0.039	19.5	11.3	13.9	SA206-20F
		62	2.441	36.5	1.437	48.4	1.906	19	0.748	1	0.039	19.5	11.3	13.9	NA206-20
		72	2.835	23	0.906	36.5	1.437	17	0.669	1.1	0.043	25.7	15.4	13.9	SA207-20
-	1 1/4	72	2.835	25.4	1.000	38.9	1.531	19	0.748	1.1	0.043	25.7	15.4	13.9	SA207-20F
		72	2.835	37.6	1.480	51.1	2.012	20	0.787	1.1	0.043	25.7	15.4	13.9	NA207-20
		72	2.835	23	0.906	36.5	1.437	17	0.669	1.1	0.043	25.7	15.4	13.9	SA207-21
-	1 5/16	72	2.835	25.4	1.000	38.9	1.531	19	0.748	1.1	0.043	25.7	15.4	13.9	SA207-21F
		72	2.835	37.6	1.480	51.1	2.012	20	0.787	1.1	0.043	25.7	15.4	13.9	NA207-21



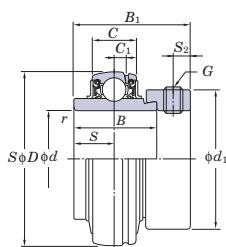

NA

Dimensions								Set Screw Brg.Bore		Mass
C <sub>1</sub>		S		S <sub>2</sub>		d <sub>1</sub>		mm	inch	kg
mm	inch	mm	inch	mm	inch	mm	inch			
-	-	6	0.236	4.8	0.189	28.6	1.126	M6x0.75	-	0.13
3.4	0.134	6.5	0.256	4.8	0.189	28.6	1.126	M6x0.75	-	0.13
4	0.157	17.1	0.673	4.8	0.189	33.3	1.311	M6x0.75	-	0.29
-	-	6	0.236	4.8	0.189	28.6	1.126	-	1/4-28UNF	0.13
3.4	0.134	6.5	0.256	4.8	0.189	28.6	1.126	-	1/4-28UNF	0.13
4	0.157	17.1	0.673	4.8	0.189	33.3	1.311	-	1/4-28UNF	0.29
-	-	6	0.236	4.8	0.189	28.6	1.126	M6x0.75	-	0.13
3.4	0.134	6.5	0.256	4.8	0.189	28.6	1.126	M6x0.75	-	0.13
4	0.157	17.1	0.673	4.8	0.189	33.3	1.311	M6x0.75	-	0.27
-	-	6	0.236	4.8	0.189	28.6	1.126	-	1/4-28UNF	0.13
4	0.157	17.1	0.673	4.8	0.189	33.3	1.311	-	1/4-28UNF	0.26
-	-	6	0.236	4.8	0.189	28.6	1.126	M6x0.75	-	0.13
3.4	0.134	6.5	0.256	4.8	0.189	28.6	1.126	M6x0.75	-	0.13
4	0.157	17.1	0.673	4.8	0.189	33.3	1.311	M6x0.75	-	0.25
-	-	7	0.276	4.8	0.189	33.3	1.311	-	1/4-28UNF	0.15
3.7	0.146	7.5	0.295	4.8	0.189	33.3	1.311	-	1/4-28UNF	0.19
4	0.157	17.1	0.673	4.8	0.189	33.3	1.311	-	1/4-28UNF	0.23
-	-	7	0.276	4.8	0.189	33.3	1.311	M6x0.75	-	0.15
3.7	0.146	7.5	0.295	4.8	0.189	33.3	1.311	M6x0.75	-	0.19
4	0.157	17.1	0.673	4.8	0.189	33.3	1.311	M6x0.75	-	0.22
-	-	7.5	0.295	4.8	0.189	38.1	1.500	-	1/4-28UNF	0.22
5	0.197	17.5	0.689	4.8	0.189	38.1	1.500	-	1/4-28UNF	0.27
-	-	7.5	0.295	4.8	0.189	38.1	1.500	-	1/4-28UNF	0.22
3.7	0.146	7.5	0.295	4.8	0.189	38.1	1.500	-	1/4-28UNF	0.23
5	0.197	17.5	0.689	4.8	0.189	38.1	1.500	-	1/4-28UNF	0.29
-	-	7.5	0.295	4.8	0.189	38.1	1.500	M6x0.75	-	0.22
3.7	0.146	7.5	0.295	4.8	0.189	38.1	1.500	M6x0.75	-	0.23
5	0.197	17.5	0.689	4.8	0.189	38.1	1.500	M6x0.75	-	0.25
-	-	7.5	0.295	4.8	0.189	38.1	1.500	-	1/4-28UNF	0.22
3.7	0.146	7.5	0.295	4.8	0.189	38.1	1.500	-	1/4-28UNF	0.23
5	0.197	17.5	0.689	4.8	0.189	38.1	1.500	-	1/4-28UNF	0.25
-	-	8	0.315	6	0.236	44.5	1.752	-	5/16-24UNF	0.3
4.7	0.185	9	0.354	6	0.236	44.5	1.752	-	5/16-24UNF	0.34
5	0.197	18.3	0.720	6	0.236	44.5	1.752	-	5/16-24UNF	0.43
-	-	8	0.315	6	0.236	44.5	1.752	M8x1	-	0.3
4.7	0.185	9	0.354	6	0.236	44.5	1.752	M8x1	-	0.34
5	0.197	18.3	0.720	6	0.236	44.5	1.752	M8x1	-	0.41
-	-	8	0.315	6	0.236	44.5	1.752	-	5/16-24UNF	0.3
4.7	0.185	9	0.354	6	0.236	44.5	1.752	-	5/16-24UNF	0.34
5	0.197	18.3	0.720	6	0.236	44.5	1.752	-	5/16-24UNF	0.41
6.5	0.256	17.5	0.689	6.8	0.268	49.2	1.937	-	5/16-24UNF	0.66
-	-	8	0.315	6	0.236	44.5	1.752	-	5/16-24UNF	0.3
4.7	0.185	9	0.354	6	0.236	44.5	1.752	-	5/16-24UNF	0.34
5	0.197	18.3	0.720	6	0.236	44.5	1.752	-	5/16-24UNF	0.38
-	-	8.5	0.335	6.8	0.268	55.6	2.189	-	5/16-24UNF	0.5
5.7	0.224	9.5	0.335	6.8	0.268	55.6	2.189	-	5/16-24UNF	0.57
5.5	0.217	18.8	0.740	6.8	0.268	55.6	2.189	-	5/16-24UNF	0.68
-	-	8.5	0.335	6.8	0.268	55.6	2.189	-	5/16-24UNF	0.5
5.7	0.224	9.5	0.335	6.8	0.268	55.6	2.189	-	5/16-24UNF	0.57
5.5	0.217	18.8	0.740	6.8	0.268	55.6	2.189	-	5/16-24UNF	0.65



**Ball Bearing Inserts**

**SA, SA-F, NA**  
**Cylindrical bore**  
**(with eccentric locking collar)**  
*d* (30) ~ 60 mm



SA

SA-F

NA

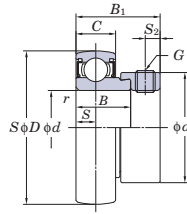

SA

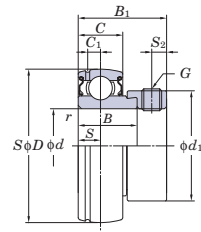

SA-F

Shaft Dia mm inch		Dimensions								Basic Load Ratings kN		Factor <i>f</i> <sub>0</sub>	Bearing No.		
		<i>D</i>		<i>B</i>		<i>B</i> <sub>1</sub>		<i>C</i>		<i>r</i> (min.) mm inch	<i>C</i> <sub>r</sub>			<i>C</i> <sub>0r</sub>	
<i>d</i>		mm	inch	mm	inch	mm	inch	mm	inch			mm	inch		<i>C</i> <sub>r</sub>
-	1 3/8	72	2.835	23	0.906	36.5	1.437	17	0.669	1.1	0.043	25.7	15.4	13.9	SA207-22
		72	2.835	25.4	1.000	38.9	1.531	19	0.748	1.1	0.043	25.7	15.4	13.9	SA207-22F
		72	2.835	37.6	1.480	51.1	2.012	20	0.787	1.1	0.043	25.7	15.4	13.9	NA207-22
35	-	72	2.835	23	0.906	36.5	1.437	17	0.669	1.1	0.043	25.7	15.4	13.9	SA207
		72	2.835	25.4	1.000	38.9	1.531	19	0.748	1.1	0.043	25.7	15.4	13.9	SA207F
		72	2.835	37.6	1.480	51.1	2.012	20	0.787	1.1	0.043	25.7	15.4	13.9	NA207
-	1 7/16	72	2.835	23	0.906	36.5	1.437	17	0.669	1.1	0.043	25.7	15.4	13.9	SA207-23
		72	2.835	25.4	1.000	38.9	1.531	19	0.748	1.1	0.043	25.7	15.4	13.9	SA207-23F
		72	2.835	37.6	1.480	51.1	2.012	20	0.787	1.1	0.043	25.7	15.4	13.9	NA207-23
-	1 1/2	80	3.150	27	1.063	40.5	1.595	18	0.709	1.1	0.043	29.1	17.8	14.0	SA208-24
		80	3.150	30.2	1.189	43.7	1.720	22	0.866	1.1	0.043	29.1	17.8	14.0	SA208-24F
		80	3.150	42.8	1.685	56.3	2.217	21	0.827	1.1	0.043	29.1	17.8	14.0	NA208-24
-	1 9/16	90	3.543	41.3	1.626	57.1	2.248	28	1.102	1.5	0.059	40.7	24.0	13.2	NA308-24
		80	3.150	27	1.063	40.5	1.595	18	0.709	1.1	0.043	29.1	17.8	14.0	SA208-25
		80	3.150	30.2	1.189	43.7	1.720	22	0.866	1.1	0.043	29.1	17.8	14.0	SA208-25F
40	-	80	3.150	42.8	1.685	56.3	2.217	21	0.827	1.1	0.043	29.1	17.8	14.0	NA208-25
		80	3.150	27	1.063	40.5	1.595	18	0.709	1.1	0.043	29.1	17.8	14.0	SA208
		80	3.150	30.2	1.189	43.7	1.720	22	0.866	1.1	0.043	29.1	17.8	14.0	SA208F
-	1 5/8	80	3.150	42.8	1.685	56.3	2.217	21	0.827	1.1	0.043	29.1	17.8	14.0	NA208
		85	3.346	30.2	1.189	43.7	1.720	22	0.866	1.1	0.043	34.1	21.3	14.0	SA209-26F
		85	3.346	42.8	1.685	56.3	2.217	22	0.866	1.1	0.043	34.1	21.3	14.0	NA209-26
-	1 11/16	85	3.346	30.2	1.189	43.7	1.720	22	0.866	1.1	0.043	34.1	21.3	14.0	SA209-27F
		85	3.346	42.8	1.685	56.3	2.217	22	0.866	1.1	0.043	34.1	21.3	14.0	NA209-27
		100	3.937	42.9	1.689	58.7	2.311	30	1.181	1.5	0.059	48.9	29.5	13.3	NA309-27
-	1 3/4	85	3.346	30.2	1.189	43.7	1.720	22	0.866	1.1	0.043	34.1	21.3	14.0	SA209-28F
		85	3.346	42.8	1.685	56.3	2.217	22	0.866	1.1	0.043	34.1	21.3	14.0	NA209-28
		85	3.346	30.2	1.189	43.7	1.720	22	0.866	1.1	0.043	34.1	21.3	14.0	SA209F
45	-	85	3.346	42.8	1.685	56.3	2.217	22	0.866	1.1	0.043	34.1	21.3	14.0	NA209
		90	3.543	30.2	1.189	43.7	1.720	22	0.866	1.1	0.043	35.1	23.3	14.4	SA210-30F
		90	3.543	49.2	1.937	62.7	2.469	24	0.945	1.1	0.043	35.1	23.3	14.4	NA210-30
-	1 7/8	90	3.543	30.2	1.189	43.7	1.720	22	0.866	1.1	0.043	35.1	23.3	14.4	SA210-31F
		90	3.543	49.2	1.937	62.7	2.469	24	0.945	1.1	0.043	35.1	23.3	14.4	NA210-31
		110	4.331	49.2	1.937	66.6	2.622	32	1.260	2	0.079	62.0	38.3	13.2	NA310-31
50	-	90	3.543	30.2	1.189	43.7	1.720	22	0.866	1.1	0.043	35.1	23.3	14.4	SA210F
		90	3.543	49.2	1.937	62.7	2.469	24	0.945	1.1	0.043	35.1	23.3	14.4	NA210
		90	3.543	49.2	1.937	62.7	2.469	24	0.945	1.1	0.043	35.1	23.3	14.4	NA210-32
-	2	100	3.937	32.4	1.276	48.4	1.906	24	0.945	1.5	0.059	43.4	29.4	14.4	SA211-32F
		100	3.937	55.5	2.185	71.4	2.811	25	0.984	1.5	0.059	43.4	29.4	14.4	NA211-32
		100	3.937	32.4	1.276	48.4	1.906	24	0.945	1.5	0.059	43.4	29.4	14.4	SA211-34F
55	-	100	3.937	55.5	2.185	71.4	2.811	25	0.984	1.5	0.059	43.4	29.4	14.4	NA211-34
		100	3.937	32.4	1.276	48.4	1.906	24	0.945	1.5	0.059	43.4	29.4	14.4	SA211F
		100	3.937	55.5	2.185	71.4	2.811	25	0.984	1.5	0.059	43.4	29.4	14.4	NA211
-	2 3/16	100	3.937	32.4	1.276	48.4	1.906	24	0.945	1.5	0.059	43.4	29.4	14.4	SA211-35F
		100	3.937	55.5	2.185	71.4	2.811	25	0.984	1.5	0.059	43.4	29.4	14.4	NA211-35
		120	4.724	55.6	2.189	73	2.874	34	1.339	2	0.079	71.6	45.0	13.2	NA311-35
60	2 1/4	110	4.331	61.9	2.437	77.8	3.063	27	1.063	1.5	0.059	52.4	36.2	14.4	NA212-36
		110	4.331	61.9	2.437	77.8	3.063	27	1.063	1.5	0.059	52.4	36.2	14.4	NA212
		130	5.118	61.9	2.437	79.4	3.126	36	1.417	2.1	0.083	81.9	52.2	13.2	NA312-39

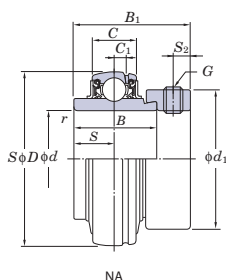

NA

	Dimensions								Set Screw Brg.Bore		Mass kg
	C <sub>1</sub>		S		S <sub>2</sub>		d <sub>1</sub>		mm	inch	
	mm	inch	mm	inch	mm	inch	mm	inch			
-	-	-	8.5	0.335	6.8	0.268	55.6	2.189	-	5/16-24UNF	0.5
5.7	0.224	9.5	0.335	6.8	0.268	55.6	2.189	-	5/16-24UNF	0.57	
5.5	0.217	18.8	0.740	6.8	0.268	55.6	2.189	-	5/16-24UNF	0.61	
-	-	8.5	0.335	6.8	0.268	55.6	2.189	M8x1	-	0.5	
5.7	0.224	9.5	0.335	6.8	0.268	55.6	2.189	M8x1	-	0.57	
5.5	0.217	18.8	0.740	6.8	0.268	55.6	2.189	M8x1	-	0.61	
-	-	8.5	0.335	6.8	0.268	55.6	2.189	-	5/16-24UNF	0.5	
5.7	0.224	9.5	0.335	6.8	0.268	55.6	2.189	-	5/16-24UNF	0.57	
5.5	0.217	18.8	0.740	6.8	0.268	55.6	2.189	-	5/16-24UNF	0.58	
7.5	0.295	18.3	0.720	6.8	0.268	55.5	2.185	-	5/16-24UNF	0.81	
-	-	9	0.354	6.8	0.268	60.3	2.374	-	5/16-24UNF	0.67	
6.4	0.252	11	0.433	6.8	0.268	60.3	2.374	-	5/16-24UNF	0.75	
6	0.236	21.4	0.843	6.8	0.268	60.3	2.374	-	5/16-24UNF	0.83	
8	0.315	19.8	0.780	8	0.315	63.5	2.500	-	3/8-24UNF	1.19	
-	-	9	0.354	6.8	0.268	60.3	2.374	-	5/16-24UNF	0.67	
6.4	0.252	11	0.433	6.8	0.268	60.3	2.374	-	5/16-24UNF	0.75	
6	0.236	21.4	0.843	6.8	0.268	60.3	2.374	-	5/16-24UNF	0.79	
-	-	9	0.354	6.8	0.268	60.3	2.374	M8x1	-	0.67	
6.4	0.252	11	0.433	6.8	0.268	60.3	2.374	M8x1	-	0.75	
6	0.236	21.4	0.843	6.8	0.268	60.3	2.374	M8x1	-	0.78	
6	0.236	11	0.433	6.8	0.268	63.5	2.500	-	5/16-24UNF	0.82	
6	0.236	21.4	0.843	6.8	0.268	63.5	2.500	-	5/16-24UNF	0.96	
6	0.236	11	0.433	6.8	0.268	63.5	2.500	-	5/16-24UNF	0.82	
6	0.236	21.4	0.843	6.8	0.268	63.5	2.500	-	5/16-24UNF	0.91	
8.5	0.335	19.8	0.780	8	0.315	69.8	2.748	-	3/8-24UNF	1.47	
6	0.236	11	0.433	6.8	0.268	63.5	2.500	-	5/16-24UNF	0.82	
6	0.236	21.4	0.843	6.8	0.268	63.5	2.500	-	5/16-24UNF	0.87	
6	0.236	11	0.433	6.8	0.268	63.5	2.500	M8x1	-	0.82	
6	0.236	21.4	0.843	6.8	0.268	63.5	2.500	M8x1	-	0.85	
6.6	0.260	11	0.433	6.8	0.268	69.9	2.752	-	5/16-24UNF	0.85	
6	0.236	24.6	0.969	6.8	0.268	69.9	2.752	-	5/16-24UNF	1.08	
6.6	0.260	11	0.433	6.8	0.268	69.9	2.752	-	5/16-24UNF	0.85	
6	0.236	24.6	0.969	6.8	0.268	69.9	2.752	-	5/16-24UNF	1.04	
9	0.354	24.6	0.969	8.7	0.343	76.2	3.000	-	3/8-24UNF	1.95	
6.6	0.260	11	0.433	6.8	0.268	69.9	2.752	M8x1	-	0.85	
6	0.236	24.6	0.969	6.8	0.268	69.9	2.752	M8x1	-	1.01	
6	0.236	24.6	0.969	6.8	0.268	69.9	2.752	-	5/16-24UNF	0.99	
7	0.276	12	0.472	8	0.315	76.2	3.000	-	3/8-24UNF	1.2	
7	0.276	27.8	1.094	8	0.315	76.2	3.000	-	3/8-24UNF	1.58	
7	0.276	12	0.472	8	0.315	76.2	3.000	-	3/8-24UNF	1.2	
7	0.276	27.8	1.094	8	0.315	76.2	3.000	-	3/8-24UNF	1.49	
7	0.276	12	0.472	8	0.315	76.2	3.000	M10x1.25	-	1.2	
7	0.276	27.8	1.094	8	0.315	76.2	3.000	M10x1.25	-	1.39	
7	0.276	12	0.472	8	0.315	76.2	3.000	-	3/8-24UNF	1.2	
7	0.276	27.8	1.094	8	0.315	76.2	3.000	-	3/8-24UNF	1.36	
10	0.394	27.8	1.094	8.7	0.343	82.5	3.248	-	3/8-24UNF	2.2	
7.5	0.295	31	1.220	8	0.315	84.2	3.315	-	3/8-24UNF	2.03	
7.5	0.295	31	1.220	8	0.315	84.2	3.315	M10x1.25	-	1.87	
11.5	0.453	31	1.220	8.7	0.343	88.9	3.500	-	3/8-24UNF	3	



**Ball Bearing Inserts**

**SA, SA-F, NA**  
**Cylindrical bore**  
**(with eccentric locking collar)**  
*d* 65 ~ 75 mm

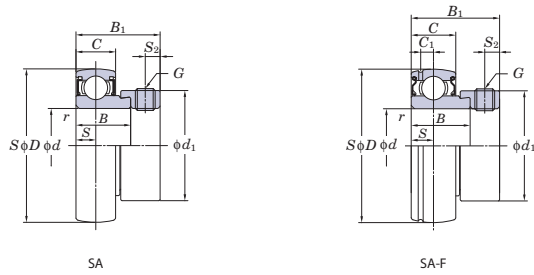

Shaft Dia		Dimensions									Basic Load Ratings		Factor	Bearing No.	
mm	inch	D		B		B <sub>1</sub>		C		r (min.)		C <sub>r</sub>	C <sub>0r</sub>	f <sub>0</sub>	
<i>d</i>		mm	inch	mm	inch	mm	inch	mm	inch	mm	inch				
65	2 1/2	120	4.724	68.2	2.685	85.7	3.374	28	1.102	1.5	0.059	57.2	40.1	14.4	NA213-40
		120	4.724	68.2	2.685	85.7	3.374	28	1.102	1.5	0.059	57.2	40.1	14.4	NA213
70	2 3/4	125	4.921	68.2	2.685	85.7	3.374	30	1.181	1.5	0.059	62.2	44.1	14.5	NA214-44
		125	4.921	68.2	2.685	85.7	3.374	30	1.181	1.5	0.059	62.2	44.1	14.5	NA214
75	2 11/16	150	5.906	68.3	2.689	92.1	3.626	40	1.575	2.1	0.083	104	68.2	13.2	NA314-43
		130	5.118	74.6	2.937	92.1	3.626	32	1.260	1.5	0.059	67.4	48.3	14.5	NA215
75	2 15/16	130	5.118	74.6	2.937	92.1	3.626	32	1.260	1.5	0.059	67.4	48.3	14.5	NA215-48
		160	6.299	74.6	2.937	100	3.937	42	1.654	2.1	0.083	113	77.2	13.2	NA315-47

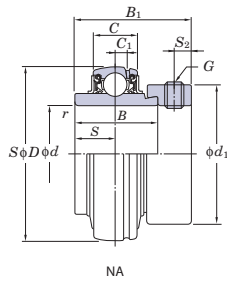

NA

	Dimensions								Set Screw Brg.Bore		Mass kg
	C <sub>1</sub>		S		S <sub>2</sub>		d <sub>1</sub>		mm	inch	
	mm	inch	mm	inch	mm	inch	mm	inch			
7.5	0.295	34.1	1.343	8.5	0.335	92	3.622	-	3/8-24UNF	2.51	
7.5	0.295	34.1	1.343	8.5	0.335	92	3.622	M10x1.25	-	2.45	
9	0.354	34.1	1.343	8.5	0.335	97	3.819	-	3/8-24UNF	2.94	
9	0.354	34.1	1.343	8.5	0.335	97	3.819	M10x1.25	-	2.92	
12.5	0.492	34.1	1.343	11.9	0.469	101.6	4.000	-	1/2-20UNF	4.7	
9	0.354	37.3	1.469	8.5	0.335	102	4.016	M10x1.25	-	2.74	
9	0.354	37.3	1.469	8.5	0.335	102	4.016	-	3/8-24UNF	2.72	
14.5	0.571	37.3	1.469	12.7	0.500	112.7	4.437	-	5/8-18UNF	5.8	



**Ball Bearing Inserts**

**NC2**  
**Cylindrical bore**  
**(with concentric locking collar)**  
*d* 20 ~ 60 mm

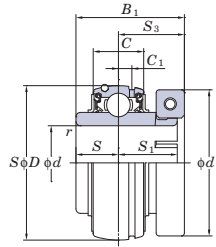

Shaft Dia.		Dimensions								Basic Load Ratings		Factor	Bearing No.	Collar No.
mm	inch	<i>D</i>		<i>B</i> <sub>1</sub>		<i>C</i>		<i>r</i>		<i>C</i> <sub>r</sub>	<i>C</i> <sub>0r</sub>	<i>f</i> <sub>0</sub>		
<i>d</i>		mm	inch	mm	inch	mm	inch	mm	inch	kN				
20	3/4	47	1.850	32.5	1.280	16	0.630	1	0.039	12.8	6.65	13.2	NC204-12	UCL204B
													NC204	UCL204BM
25	7/8	52	2.047	36.5	1.437	17	0.669	1	0.039	14.0	7.85	13.9	NC205-14	UCL205A
	15/16												NC205-15	UCL205A
30	1	62	2.441	39.7	1.563	19	0.748	1	0.039	19.5	11.3	13.9	NC205-16	UCL205AM
	1 1/8												NC205-16	UCL205A
35	1 1/4	72	2.835	44.5	1.752	20	0.787	1.1	0.043	25.7	15.4	13.9	NC206-18	UCL206A
	1 3/8												NC206-18	UCL206A
40	1 1/2	80	3.150	50.8	2.000	21	0.827	1.1	0.043	29.1	17.8	14.0	NC206-19	UCL206AM
													NC206-19	UCL206A
45	1 5/8	85	3.346	50.8	2.000	22	0.866	1.1	0.043	34.1	21.3	14.0	NC207-20	UCL207A
	1 7/16												NC207-20	UCL207A
50	1 3/4	90	3.543	53.1	2.091	24	0.945	1.1	0.043	35.1	23.3	14.4	NC207-22	UCL207B
	1 15/16												NC207-22	UCL207B
55	2	100	3.937	57.1	2.248	25	0.984	1.5	0.059	43.4	29.4	14.4	NC207	UCL207BM
	2 3/16												NC207-23	UCL207B
60	2 1/4	110	4.331	66.7	2.626	27	1.063	1.5	0.059	52.4	36.2	14.4	NC208-24	UCL208A
	2 7/16												NC208-24	UCL208AM
													NC208	UCL208AM
													NC209-26	UCL209A
													NC209-27	UCL209B
													NC209-28	UCL209B
													NC209	UCL209BM
													NC210-31	UCL210A
													NC210	UCL210AM
													NC210-32	UCL210A
													NC211-32	UCL211A
													NC211	UCL211BM
													NC211-35	UCL211B
													NC212-36	UCL212A
													NC212	UCL212BM
													NC212-39	UCL212B



	Dimensions										Cap Screw	Mass		
	C <sub>1</sub>		S		S <sub>1</sub>		S <sub>3</sub>		d <sub>1</sub>				inch mm	kg
	mm	inch	mm	inch	mm	inch	mm	inch	mm	inch				
4	0.157	12.7	0.500	18.3	0.720	19.8	0.780	44.5	1.752	No.8-32UNC M4x0.7	0.30			
5	0.197	14.3	0.563	19.8	0.780	22.2	0.874	49.2	1.937	No.8-32UNC No.8-32UNC M4x0.7 No.8-32UNC	0.40			
5	0.197	15.9	0.626	22.2	0.874	23.8	0.937	55.6	2.189	No.8-32UNC M4x0.7 No.8-32UNC No.8-32UNC	0.50			
5.5	0.217	17.5	0.689	25.4	1.000	27	1.063	61.9	2.437	No.10-24UNC	0.80			
5.5	0.217	17.5	0.689	25.4	1.000	27	1.063	65.1	2.563	No.10-24UNC M5x0.8 No.10-24UNC	0.80			
6	0.236	19	0.748	30.2	1.189	31.8	1.252	68.3	2.689	No.10-24UNC M5x0.8	1.0			
6	0.236	19	0.748	30.2	1.189	31.8	1.252	71.4	2.811	No.10-24UNC	1.1			
6	0.236	19	0.748	30.2	1.189	31.8	1.252	74.6	2.937	No.10-24UNC No.10-24UNC M5x0.8	1.1			
6	0.236	19	0.748	32.6	1.283	34.1	1.343	85.7	3.374	1/4-20UNC M6x1 1/4-20UNC	1.4			
7	0.276	22.2	0.874	33.4	1.315	34.9	1.374	88.9	3.500	1/4-20UNC	1.5			
7	0.276	22.2	0.874	33.4	1.315	34.9	1.374	92.1	3.626	M6x1 1/4-20UNC	1.5			
7.5	0.295	25.4	1.000	39.7	1.563	41.3	1.626	103.2	4.063	5/16-18UNC	2.2			
7.5	0.295	25.4	1.000	39.7	1.563	41.3	1.626	104.8	4.126	M8x1.25 5/16-18UNC	2.2			

**Ball Bearing Inserts**

**ERC**  
**Cylindrical bore**  
**(with concentric locking collar)**  
**Cylindrical O. D.**  
**d 20 ~ 60 mm**

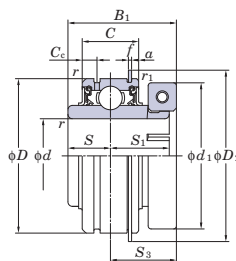

Shaft Dia. mm inch	Dimensions										Basic Load Ratings kN		Factor <i>f</i> <sub>0</sub>	Bearing No.	Collar No.	
	<i>D</i>		<i>B</i> <sub>1</sub>		<i>C</i>		<i>r</i>		<i>r</i> <sub>1</sub> (min.)		<i>C</i> <sub>r</sub>	<i>C</i> <sub>0r</sub>				
<i>d</i>	mm	inch	mm	inch	mm	inch	mm	inch	mm	inch						
20	3/4	47	1.850	32.5	1.280	16	0.630	1	0.039	0.5	0.020	12.8	6.65	13.2	ERC204-12 ERC204	UCL204B UCL204BM
25	7/8 15/16 1	52	2.047	36.5	1.437	19	0.748	1	0.039	0.5	0.020	14.0	7.85	13.9	ERC205-14 ERC205-15 ERC205 ERC205-16 ERC205-18	UCL205A UCL205A UCL205AM UCL205A UCL206A
30	1 1/8 1 3/16 1 1/4	62	2.441	39.7	1.563	22	0.866	1	0.039	0.5	0.020	19.5	11.3	13.9	ERC206-18 ERC206 ERC206-19 ERC206-20	UCL206A UCL206AM UCL206A UCL206A
35	1 1/4 1 3/8 1 7/16	72	2.835	44.5	1.752	24	0.945	1.1	0.043	0.5	0.020	25.7	15.4	13.9	ERC207-20 ERC207-22 ERC207 ERC207-23	UCL207A UCL207B UCL207BM UCL207B
40	1 1/2	80	3.150	50.8	2.000	28	1.102	1.1	0.043	0.5	0.020	29.1	17.8	14.0	ERC208-24 ERC208	UCL208A UCL208AM
45	1 5/8 1 11/16 1 3/4	85	3.346	50.8	2.000	28	1.102	1.1	0.043	0.5	0.020	34.1	21.3	14.0	ERC209-26 ERC209-27 ERC209-28 ERC209	UCL209A UCL209B UCL209B UCL209BM
50	1 15/16 2	90	3.543	53.1	2.091	28	1.102	1.1	0.043	0.5	0.020	35.1	23.3	14.4	ERC210-31 ERC210 ERC210-32	UCL210A UCL210AM UCL210A
55	2 2 3/16	100	3.937	57.1	2.248	30	1.181	1.5	0.059	0.5	0.020	43.4	29.4	14.4	ERC211-32 ERC211 ERC211-35	UCL211A UCL211BM UCL211B
60	2 1/4 2 7/16	110	4.331	66.7	2.626	32	1.260	1.5	0.059	0.5	0.020	52.4	36.2	14.4	ERC212-36 ERC212 ERC212-39	UCL212A UCL212BM UCL212B



	Dimensions																Cap Screw	Mass
	C <sub>c</sub>		S		S <sub>1</sub>		S <sub>3</sub>		a		f		d <sub>1</sub>		D <sub>2</sub>		inch	kg
	mm	inch	mm	inch	mm	inch	mm	inch	mm	inch	mm	inch	mm	inch	mm	inch	mm	
4	0.157	12.7	0.500	18.3	0.720	19.8	0.780	2.38	0.094	1.07	0.042	44.5	1.752	52.5	2.067	No.8-32UNC M4x0.7	0.36	
5	0.197	14.3	0.563	19.8	0.780	22.2	0.874	2.38	0.094	1.07	0.042	49.2	1.937	57.7	2.272	No.8-32UNC No.8-32UNC M4x0.7	0.47	
5.5	0.217	15.9	0.626	22.2	0.874	23.8	0.937	3.18	0.125	1.65	0.065	55.6	2.189	67.5	2.657	No.8-32UNC M4x0.7 No.8-32UNC No.8-32UNC	0.57	
5.5	0.217	17.5	0.689	25.4	1.000	27	1.063	3.18	0.125	1.65	0.065	61.9	2.437	78.4	3.087	No.10-24UNC	0.95	
5.5	0.217	17.5	0.689	25.4	1.000	27	1.063	3.18	0.125	1.65	0.065	65.1	2.563	78.4	3.087	No.10-24UNC M5x0.8 No.10-24UNC	0.95	
6	0.236	19	0.748	30.2	1.189	31.8	1.252	3.18	0.125	1.65	0.065	68.3	2.689	86.4	3.402	No.10-24UNC M5x0.8	1.2	
6	0.236	19	0.748	30.2	1.189	31.8	1.252	3.18	0.125	1.65	0.065	71.4	2.811	91.4	3.598	No.10-24UNC	1.3	
6	0.236	19	0.748	30.2	1.189	31.8	1.252	3.18	0.125	1.65	0.065	74.6	2.937	91.4	3.598	No.10-24UNC No.10-24UNC M5x0.8	1.3	
7.5	0.295	19	0.748	32.6	1.283	34.1	1.343	3.18	0.125	2.41	0.095	85.7	3.374	96.3	3.791	1/4-20UNC M6x1 1/4-20UNC	1.6	
7.5	0.295	22.2	0.874	33.4	1.315	34.9	1.374	3.18	0.125	2.41	0.095	88.9	3.500	106.3	4.185	1/4-20UNC	1.8	
7.5	0.295	22.2	0.874	33.4	1.315	34.9	1.374	3.18	0.125	2.41	0.095	92.1	3.626	106.3	4.185	M6x1 1/4-20UNC	1.8	
7.5	0.295	25.4	1.000	39.7	1.563	41.3	1.626	3.18	0.125	2.41	0.095	103.2	4.063	116.4	4.583	5/16-18UNC	2.5	
7.5	0.295	25.4	1.000	39.7	1.563	41.3	1.626	3.18	0.125	2.41	0.095	104.8	4.126	116.4	4.583	M8x1.25 5/16-18UNC	2.5	

**Ball Bearing Inserts**

**UK**  
**Tapered bore (with adapter)**  
 $d_1$  20 ~ (50) mm



UK



UK+H

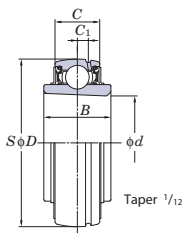

UK

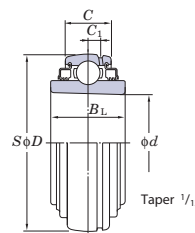

UK-L3

Shaft Dia. mm inch	Dimensions inch mm							Basic Load Ratings kN		Factor $f_0$	Bearing				
	$d_1$	$d$	$D$	$B$	$B_L$	$C$	$C_1$	$C_r$	$C_{0r}$		Standard	L3 Type	Standard	L3 Type	Mass kg
20	3/4	0.984 25	2.047 52	0.945 24	0.945 24	0.669 17	0.197 5	14.0	7.85	13.9	UK205	UK205L2	0.18	0.18	
	3/4	0.984 25	2.441 62	1.063 27	—	0.748 19	0.197 5	19.5	11.3	13.9	UKX05	—	0.27	—	
	3/4	0.984 25	2.441 62	1.063 27	—	0.866 22	0.236 6	21.2	10.9	12.6	UK305	—	0.40	—	
25	1	1.181 30	2.441 62	1.063 27	1.063 27	0.748 19	0.197 5	19.5	11.3	13.9	UK206	UK206L3	0.29	0.29	
	1	1.181 30	2.835 72	1.181 30	—	0.787 20	0.217 5.5	25.7	15.4	13.9	UKX06	—	0.43	—	
	1	1.181 30	2.835 72	1.181 30	—	0.945 24	0.256 6.5	26.7	15.0	13.3	UK306	—	0.47	—	
30	1 1/8	1.378 35	2.835 72	1.181 30	1.181 30	0.787 20	0.217 5.5	25.7	15.4	13.9	UK207	UK207L3	0.43	0.43	
	1 1/8	1.378 35	3.150 80	1.339 34	—	0.827 21	0.236 6	29.1	17.8	14.0	UKX07	—	0.53	—	
	1 1/8	1.378 35	3.150 80	1.299 33	1.299 33	1.024 26	0.295 7.5	33.4	19.3	13.2	UK307	UK307L3	0.60	0.60	
35	1 1/4	1.575 40	3.150 80	1.339 34	1.339 34	0.827 21	0.236 6	29.1	17.8	14.0	UK208	UK208L3	0.58	0.58	
	1 1/4	1.575 40	3.346 85	1.417 36	—	0.866 22	0.236 6	34.1	21.3	14.0	UKX08	—	0.58	—	
	1 1/4	1.575 40	3.543 90	1.378 35	1.378 35	1.102 28	0.315 8	40.7	24.0	13.2	UK308	UK308L3	0.80	0.80	
40	1 1/2	1.772 45	3.346 85	1.417 36	1.417 36	0.866 22	0.236 6	34.1	21.3	14.0	UK209	UK209L3	0.65	0.65	
	1 1/2	1.772 45	3.543 90	1.417 36	—	0.945 24	0.236 6	35.1	23.3	14.4	UKX09	—	0.67	—	
	1 1/2	1.772 45	3.937 100	1.496 38	1.496 38	1.181 30	0.335 8.5	48.9	29.5	13.3	UK309	UK309L3	1.08	1.08	
45	1 3/4	1.969 50	3.543 90	1.417 36	1.417 36	0.945 24	0.236 6	35.1	23.3	14.4	UK210	UK210L3	0.65	0.65	
	1 3/4	1.969 50	3.937 100	1.575 40	—	0.984 25	0.276 7	43.4	29.4	14.4	UKX10	—	0.89	—	
	1 3/4	1.969 50	4.331 110	1.575 40	1.575 40	1.260 32	0.354 9	62.0	38.3	13.2	UK310	UK310L3	1.38	1.38	
50	1 7/8	2.165 55	3.937 100	1.575 40	1.575 40	0.984 25	0.276 7	43.4	29.4	14.4	UK211	UK211L3	1.09	1.09	
	2	2.165 55	4.331 110	1.850 47	—	1.063 27	0.295 7.5	52.4	36.2	14.4	UKX11	—	1.15	—	

Remarks 1. In Part No. of unit with adapters, Part No. of applicable adapters follow the Part No. shown in the dimensional tables.  
(Example of Part No. : UK206 + H2306X, UK206L3 + H2306X)



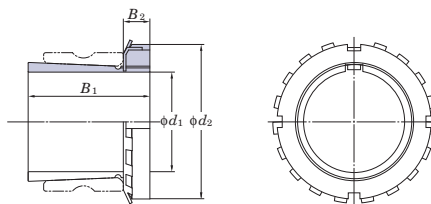

Adapter

	Adapter No.	H23 Series Adapter			Mass kg	Sleeve No.
		Dimensions				
		<i>B</i> <sub>1</sub>	<i>B</i> <sub>2</sub>	<i>d</i> <sub>2</sub>		
		inch	mm			
		<i>B</i> <sub>1</sub>	<i>B</i> <sub>2</sub>	<i>d</i> <sub>2</sub>		
	HE2305X	1.378	0.315	1.496	0.095	AE2305X
	H2305X	35	8	38		A2305X
	HE2305X	1.378	0.315	1.496	0.095	AE2305X
	H2305X	35	8	38		A2305X
	HE2305X	1.378	0.315	1.496	0.095	AE2305X
	H2305X	35	8	38		A2305X
	H2306X	1.496	0.315	1.772	0.13	A2306X
	HE2306X	38	8	45		HE2306X
	H2306X	1.496	0.315	1.772	0.13	A2306X
	HE2306X	38	8	45		HE2306X
	H2306X	1.496	0.315	1.772	0.13	A2306X
	HE2306X	38	8	45		HE2306X
	HS2307X	1.693	0.354	2.047	0.17	AS2307X
	H2307X	43	9	52		A2307X
	HS2307X	1.693	0.354	2.047	0.17	AS2307X
	H2307X	43	9	52		A2307X
	HS2307X	1.693	0.354	2.047	0.17	AS2307X
	H2307X	43	9	52		A2307X
	HE2308X	1.811	0.394	2.283	0.22	AE2308X
	HS2308X	46	10	58		AS2308X
	HE2308X	1.811	0.394	2.283	0.22	AE2308X
	HS2308X	46	10	58		AS2308X
	HE2308X	1.811	0.394	2.283	0.22	AE2308X
	HS2308X	46	10	58		AS2308X
	HE2308X	1.811	0.394	2.283	0.22	AE2308X
	HS2308X	46	10	58		AS2308X
	HE2309X	1.969	0.433	2.559	0.28	AE2309X
	H2309X	50	11	65		A2309X
	HE2309X	1.969	0.433	2.559	0.28	AE2309X
	H2309X	50	11	65		A2309X
	HE2309X	1.969	0.433	2.559	0.28	AE2309X
	H2309X	50	11	65		A2309X
	HE2310X	2.165	0.472	2.756	0.36	AE2310X
	H2310X	55	12	70		A2310X
	HE2310X	2.165	0.472	2.756	0.36	AE2310X
	H2310X	55	12	70		A2310X
	HE2310X	2.165	0.472	2.756	0.36	AE2310X
	H2310X	55	12	70		A2310X
	HS2311X	2.323	0.472	2.953	0.42	AS2311X
	H2311X	59	12	75		A2311X
	HS2311X	2.323	0.472	2.953	0.42	AS2311X
	H2311X	59	12	75		A2311X

2. Adapter series applicable to UK200 series  
UK200 ..... H2300X series  
UK200L3 (or L2)..... H2300X series
3. UK205 is the double seal type product (L2).
4. Inch bore diameter series adapters are also available (see the dimensional tables of adapters).



**Ball Bearing Inserts**

**UK**  
**Tapered bore (with adapter)**  
 $d_1$  (50) ~ (90) mm



UK



UK+H

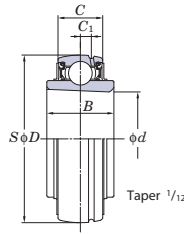

UK

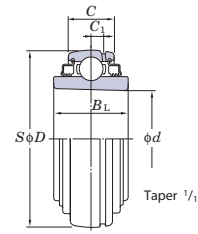

UK-L3

Shaft Dia. mm inch	Dimensions inch mm						Basic Load Ratings kN		Factor $f_0$	Bearing				
	$d_1$	$d$	$D$	$B$	$B_L$	$C$	$C_1$	$C_r$		$C_{0r}$	No.		Mass kg	
										Standard	L3 Type	Standard	L3 Type	
50	1 7/8	2.165 55	4.724 120	1.693 43	1.693 43	1.339 34	0.394 10	71.6	45.0	13.2	UK311	UK311L3	1.78	1.78
	2													
55	2 1/8	2.362 60	4.331 110	1.850 47	1.850 47	1.063 27	0.295 7.5	52.4	36.2	14.4	UK212	UK212L3	1.41	1.41
	2 1/8	2.362 60	4.724 120	1.417 36	–	1.102 28	0.295 7.5	57.2	40.1	14.4	UKX12	–	1.45	–
	2 1/8	2.362 60	5.118 130	1.850 47	1.850 47	1.417 36	0.453 11.5	81.9	52.2	13.2	UK312	UK312L3	2.06	2.06
60	2 1/4	2.559 65	4.724 120	1.417 36	1.850 47	1.102 28	0.295 7.5	57.2	40.1	14.4	UK213	UK213L3	1.34	1.67
	2 3/8													
	2 1/4	2.559 65	4.921 125	1.575 40	–	1.181 30	0.354 9	62.2	44.1	14.5	UKX13	–	1.62	–
	2 3/8	2.559 65	5.512 140	1.929 49	1.929 49	1.496 38	0.472 12	92.7	59.9	13.2	UK313	UK313L3	2.71	2.71
65	2 1/2	2.953 75	5.118 130	1.575 40	2.008 51	1.260 32	0.354 9	67.4	48.3	14.5	UK215	UK215L3	1.50	1.99
	2 1/2	2.953 75	5.512 140	1.654 42	–	1.299 33	0.354 9	72.7	53.0	14.6	UKX15	–	2.10	–
	2 1/2	2.953 75	6.299 160	2.165 55	2.165 55	1.654 42	0.571 14.5	113	77.2	13.2	UK315	UK315L3	3.80	3.80
70	2 3/4	3.150 80	5.512 140	1.654 42	2.165 55	1.299 33	0.354 9	72.7	53.0	14.6	UK216	UK216L3	1.96	2.56
	2 3/4	3.150 80	5.906 150	1.732 44	–	1.378 35	0.394 10	84.0	61.9	14.5	UKX16	–	2.64	–
	2 3/4	3.150 80	6.693 170	2.165 55	2.165 55	1.732 44	0.591 15	123	86.7	13.3	UK316	UK316L3	4.39	4.39
75	3	3.346 85	5.906 150	1.732 44	2.244 57	1.378 35	0.394 10	84.0	61.9	14.5	UK217	UK217L3	2.42	3.10
	3	3.346 85	6.299 160	1.890 48	–	1.496 38	0.433 11	96.1	71.5	14.5	UKX17	–	3.25	–
	3	3.346 85	7.087 180	2.362 60	2.362 60	1.811 46	0.591 15	133	96.8	13.3	UK317	UK317L3	5.30	5.30
80	–	3.543 90	6.299 160	1.890 48	2.480 63	1.496 38	0.433 11	96.1	71.5	14.5	UK218	UK218L3	2.90	3.77
	–	3.543 90	6.693 170	1.969 50	–	1.575 40	0.453 11.5	109	81.9	14.4	UKX18	–	3.80	–
	–	3.543 90	7.480 190	2.362 60	2.362 60	1.890 48	0.610 15.5	143	107	13.3	UK318	UK318L3	6.20	6.20
85	3 1/4	3.740 95	7.874 200	2.598 66	2.598 66	1.969 50	0.650 16.5	153	119	13.3	UK319	UK319L3	7.31	7.31
90	3 1/2	3.937 100	7.480 190	2.126 54	–	1.693 43	0.512 13	133	105	14.4	UKX20	–	5.36	–

Remarks 1. In Part No. of unit with adapters, Part No. of applicable adapters follow the Part No. shown in the dimensional tables.  
(Example of Part No. : UK206 + H2306X, UK206L3 + H2306X)

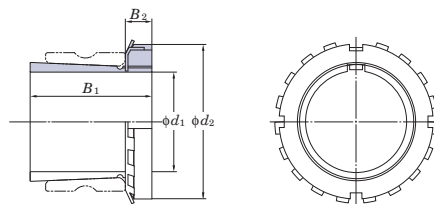

Adapter

	Adapter No.	H23 Series Adapter Dimensions			Mass kg	Sleeve No.
		inch				
		$B_1$	$B_2$	$d_2$		
	HS2311X H2311X HE2311X	2.323 59	0.472 12	2.953 75	0.42	AS2311X A2311X AE2311X
	HS2312X H2312X	2.441 62	0.512 13	3.150 80	0.48	AS2312X A2312X
	HS2312X H2312X	2.441 62	0.512 13	3.150 80	0.48	AS2312X A2312X
	HS2312X H2312X	2.441 62	0.512 13	3.150 80	0.48	AS2312X A2312X
	HE2313X H2313X HS2313X	2.559 65	0.551 14	3.346 85	0.56	AE2313X A2313X AS2313X
	HE2313X H2313X HS2313X	2.559 65	0.551 14	3.346 85	0.56	AE2313X A2313X AS2313X
	HE2313X H2313X HS2313X	2.559 65	0.551 14	3.346 85	0.56	AE2313X A2313X AS2313X
	HE2315X H2315X	2.874 73	0.591 15	3.858 98	1.05	AE2315X A2315X
	HE2315X H2315X	2.874 73	0.591 15	3.858 98	1.05	AE2315X A2315X
	HE2315X H2315X	2.874 73	0.591 15	3.858 98	1.05	AE2315X A2315X
	HE2316X H2316X	3.071 78	0.669 17	4.134 105	1.3	AE2316X A2316X
	HE2316X H2316X	3.071 78	0.669 17	4.134 105	1.3	AE2316X A2316X
	HE2316X H2316X	3.071 78	0.669 17	4.134 105	1.3	AE2316X A2316X
	H2317X HE2317X	3.228 82	0.709 18	4.331 110	1.45	A2317X AE2317X
	H2317X HE2317X	3.228 82	0.709 18	4.331 110	1.45	A2317X AE2317X
	H2317X HE2317X	3.228 82	0.709 18	4.331 110	1.45	A2317X AE2317X
	H2318X	3.386 86	0.709 18	4.724 120	1.7	A2318X
	H2318X	3.386 86	0.709 18	4.724 120	1.7	A2318X
	H2318X	3.386 86	0.709 18	4.724 120	1.7	A2318X
	H2319X	3.543 90	0.748 19	4.921 125	1.95	A2319X
	HE2320X H2320X	3.819 97	0.787 20	5.118 130	2.2	AE2320X A2320X

2. Adapter series applicable to UK200 series  
UK200 ..... H2300X series  
UK200L3 (or L2) ..... H2300X series
3. UK205 is the double seal type product (L2).
4. Inch bore diameter series adapters are also available (see the dimensional tables of adapters).



**Ball Bearing Inserts**

**UK**

**Tapered bore (with adapter)**  
 $d_1$  (90) ~ 125 mm



UK



UK+H

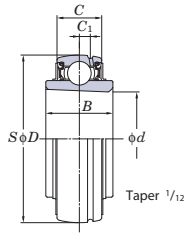

UK

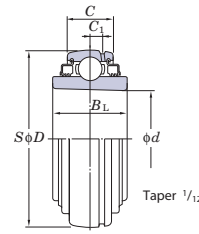

UK-L3

Shaft Dia. mm inch		Dimensions						Basic Load Ratings		Factor	Bearing			
		inch mm						kN			No.		Mass kg	
$d_1$		$d$	$D$	$B$	$B_L$	$C$	$C_1$	$C_r$	$C_{0r}$	$f_0$	Standard	L3 Type	Standard	L3 Type
90	3 1/2	3.937	8.465	2.677	2.677	2.126	0.709	173	141	13.2	UK320	UK320L3	8.70	8.70
		100	215	68	68	54	18							
100	4	4.331	9.449	3.071	3.071	2.362	0.787	205	180	13.2	UK322	UK322L3	12.2	12.2
		110	240	78	78	60	20							
110	-	4.724	10.236	3.425	3.425	2.520	0.827	207	185	13.5	UK324	UK324L3	16.1	16.1
		120	260	87	87	64	21							
115	4 1/2	5.118	11.024	3.425	3.425	2.677	0.866	229	214	13.6	UK326	UK326L3	18.8	18.8
		130	280	87	87	68	22							
125	-	5.512	11.811	3.819	3.819	2.835	0.906	253	246	13.6	UK328	UK328L3	23.9	23.9
		140	300	97	97	72	23							

Remarks 1. In Part No. of unit with adapters, Part No. of applicable adapters follow the Part No. shown in the dimensional tables.  
(Example of Part No. : UK206 + H2306X, UK206L3 + H2306X)

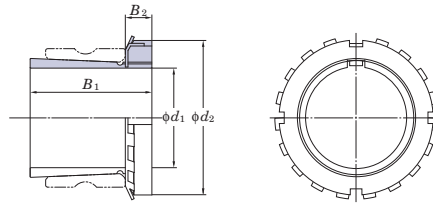

Adapter

Adapter No.	H23 Series Adapter Dimensions			Mass kg	Sleeve No.
	inch				
	$B_1$	$B_2$	$d_2$		
HE2320X	3.819	0.787	5.118	2.2	AE2320X
H2320X	97	20	130		A2320X
H2322X	4.134	0.827	5.709	2.75	A2322X
HE2322X	105	21	145		AE2322X
H2324	4.409	0.866	6.102	3.2	A2324
	112	22	155		
HE2326	4.764	0.906	6.496	4.6	AE2326
H2326	121	23	165		A2326
H2328	5.157	0.945	7.087	5.5	A2328
	131	24	180		

2. Adapter series applicable to UK200 series  
 UK200 ..... H2300X series  
 UK200L3 (or L2) ..... H2300X series
3. UK205 is the double seal type product (L2).
4. Inch bore diameter series adapters are also available (see the dimensional tables of adapters).



**Ball Bearing Inserts**

**ER, RB**  
Cylindrical bore (with set screws),  
Cylindrical O. D.

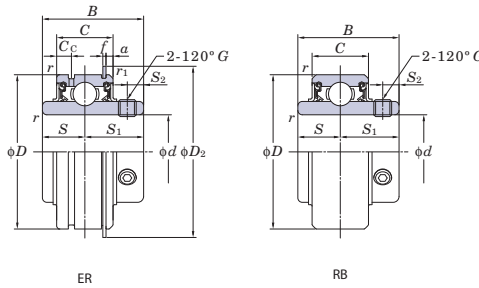
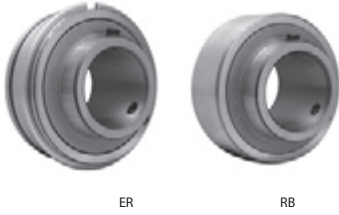

Shaft Dia.		Dimensions					Basic Load Ratings		Factor	Bearing No.	
mm	inch	inch mm					$C_r$	$C_{0r}$	$f_0$	(ER)	(RB)
$d$		$D$	$B$	$C$	$r$ (min.)	$r_1$ (min.)					
12	1/2	1.850	1.220	0.630	0.024	0.020	12.8	6.65	13.2	ER201	RB201
		47	31	16	0.6	0.5				ER201-8	RB201-8
15	5/8	2.047	1.343	0.748	0.039	0.020	14.0	7.85	13.9	ER202	RB202
		52	34.1	19	1	0.5				ER202-10	RB202-10
17	3/4	2.835	1.689	0.945	0.043	0.020	25.7	15.4	13.9	ER203	RB203
		72	42.9	24	1.1	0.5				ER203-10	RB203-10
20	3/4	3.150	1.937	1.102	0.043	0.020	29.1	17.8	14.0	ER204	RB204
		80	49.2	28	1.1	0.5				ER204-12	RB204-12
25	7/8	3.346	1.937	1.102	0.043	0.020	34.1	21.3	14.0	ER205	RB205
		85	49.2	28	1.1	0.5				ER205-14	RB205-14
25	1 5/16	3.543	2.031	1.102	0.043	0.020	35.1	23.3	14.4	ER206	RB206
		90	51.6	28	1.1	0.5				ER206-15	RB206-15
30	1 1/8	3.937	2.189	1.181	0.059	0.020	43.4	29.4	14.4	ER207	RB207
		100	55.6	30	1.5	0.5				ER207-18	RB207-18
30	1 3/16	4.331	2.563	1.260	0.059	0.020	52.4	36.2	14.4	ER208	RB208
		110	65.1	32	1.5	0.5				ER208-20	RB208-20
35	1 3/8	4.724	2.714	1.341	0.069	0.020	61.7	42.5	14.4	ER209	RB209
		120	71.1	34	1.7	0.5				ER209-22	RB209-22
40	1 1/2	5.117	2.865	1.420	0.079	0.020	71.0	48.6	14.4	ER210	RB210
		130	76.2	36	1.9	0.5				ER210-24	RB210-24
45	1 5/8	5.510	3.016	1.500	0.089	0.020	80.3	54.7	14.4	ER211	RB211
		140	81.3	38	2.1	0.5				ER211-26	RB211-26
50	1 7/8	5.903	3.167	1.580	0.099	0.020	90.6	60.8	14.4	ER212	RB212
		150	88.9	40	2.3	0.5				ER212-28	RB212-28
55	2 1/8	6.296	3.318	1.660	0.109	0.020	100.9	66.9	14.4	ER213	RB213
		160	95.0	42	2.5	0.5				ER213-30	RB213-30
60	2 3/8	6.689	3.469	1.740	0.119	0.020	110.2	73.0	14.4	ER214	RB214
		170	101.6	44	2.7	0.5				ER214-32	RB214-32





	Dimensions							Set Screw		Mass	
	S	S <sub>1</sub>	S <sub>2</sub>	C <sub>c</sub>	a	f	D <sub>2</sub>	Brg. Bore	G	(ER)	(RB)
	inch mm							mm	inch	kg	
								M6×0.75	–	0.27	0.27
	0.500	0.720	0.197	0.157	0.094	0.042	2.067	–	1/4-28UNF	0.27	0.27
	12.7	18.3	5	4	2.38	1.07	52.5	M6×0.75	–	0.25	0.25
								–	1/4-28UNF	0.25	0.25
								M6×0.75	–	0.24	0.24
	0.500	0.720	0.197	0.157	0.094	0.042	2.067	–	1/4-28UNF	0.22	0.22
	12.7	18.3	5	4	2.38	1.07	52.5	M6×0.75	–	0.22	0.22
								–	1/4-28UNF	0.3	0.29
	0.563	0.780	0.217	0.197	0.094	0.042	2.272	–	1/4-28UNF	0.28	0.27
	14.3	19.8	5.5	5	2.38	1.07	57.7	M6×0.75	–	0.27	0.26
								–	1/4-28UNF	0.27	0.26
								–	1/4-28UNF	0.41	0.4
	0.626	0.874	0.236	0.217	0.125	0.065	2.657	M6×0.75	–	0.39	0.38
	15.9	22.2	6	5.5	3.18	1.65	67.5	–	1/4-28UNF	0.39	0.38
								–	1/4-28UNF	0.37	0.36
								–	5/16-24UNF	0.69	0.68
	0.689	1.000	0.256	0.217	0.125	0.065	3.087	–	5/16-24UNF	0.66	0.65
	17.5	25.4	6.5	5.5	3.18	1.65	78.4	–	5/16-24UNF	0.64	0.63
								M8×1	–	0.63	0.62
								–	5/16-24UNF	0.61	0.6
	0.748	1.189	0.315	0.236	0.125	0.065	3.402	–	5/16-24UNF	0.85	0.84
	19	30.2	8	6	3.18	1.65	86.4	–	5/16-24UNF	0.82	0.81
								M8×1	–	0.81	0.78
	0.748	1.189	0.315	0.236	0.125	0.065	3.598	–	5/16-24UNF	1.0	–
	19	30.2	8	6	3.18	1.65	91.4	–	5/16-24UNF	0.96	–
								–	5/16-24UNF	0.92	–
								M8×1	–	0.90	–
	0.748	1.283	0.354	0.295	0.125	0.095	3.791	–	3/8-24UNF	1.05	–
	19	32.6	9	7.5	3.18	2.41	96.3	–	3/8-24UNF	1.0	–
								M10×1.25	–	0.98	–
								–	3/8-24UNF	0.96	–
	0.874	1.315	0.354	0.295	0.125	0.095	4.185	–	3/8-24UNF	1.56	–
	22.2	33.4	9	7.5	3.18	2.41	106.3	–	3/8-24UNF	1.45	–
								M10×1.25	–	1.41	–
								–	3/8-24UNF	1.39	–
								–	3/8-24UNF	2.02	–
	1.000	1.563	0.413	0.295	0.125	0.095	4.583	M10×1.25	–	1.89	–
	25.4	39.7	10.5	7.5	3.18	2.41	116.4	–	3/8-24UNF	1.87	–
								–	3/8-24UNF	1.8	–



**Ball Bearing Inserts**

**SBB-RK**  
Cylindrical bore  
(with set screws)  
Cylindrical O. D.  
*d* 12 ~ 55 mm

**SAA-FP7**  
Cylindrical bore  
(with eccentric locking collar)  
Cylindrical O. D.



SBB-RK

SAA-FP7

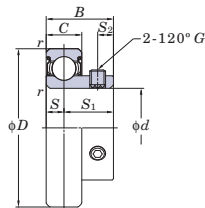

SBB-RK

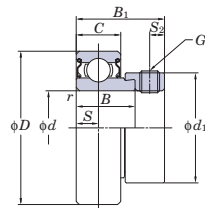

SAA-FP7

Shaft Dia.		Dimensions									Basic Load Ratings		Factor	Bearing No.	
mm	inch	D		B		B <sub>1</sub>		C		r (min.)		C <sub>0</sub>	C <sub>0r</sub>	f <sub>0</sub>	
<i>d</i>		mm	inch	mm	inch	mm	inch	mm	inch	mm	inch				
12	—	40	1.575	22	0.866	—	—	12	0.472	0.6	0.024	9.55	4.80	13.2	SBB201RK
	—	40	1.575	19.1	0.752	28.6	1.126	13	0.512	0.6	0.024	9.55	4.80	13.2	SAA201FP7
—	1/2	40	1.575	22	0.866	—	—	12	0.472	0.6	0.024	9.55	4.80	13.2	SBB201-8RK
	—	40	1.575	19.1	0.752	28.6	1.126	13	0.512	0.6	0.024	9.55	4.80	13.2	SAA201-8FP7
15	—	40	1.575	22	0.866	—	—	12	0.472	0.6	0.024	9.55	4.80	13.2	SBB202RK
	—	40	1.575	19.1	0.752	28.6	1.126	13	0.512	0.6	0.024	9.55	4.80	13.2	SAA202FP7
—	5/8	40	1.575	22	0.866	—	—	12	0.472	0.6	0.024	9.55	4.80	13.2	SBB202-10RK
17	—	40	1.575	22	0.866	—	—	12	0.472	0.6	0.024	9.55	4.80	13.2	SBB203RK
	—	40	1.575	19.1	0.752	28.6	1.126	13	0.512	0.6	0.024	9.55	4.80	13.2	SAA203FP7
—	3/4	47	1.850	25	0.984	—	—	14	0.551	1	0.039	12.8	6.65	13.2	SBB204-12RK
	—	47	1.850	21.5	0.846	31	1.220	15	0.591	1	0.039	12.8	6.65	13.2	SAA204-12FP7
20	—	47	1.850	25	0.984	—	—	14	0.551	1	0.039	12.8	6.65	13.2	SBB204RK
	—	47	1.850	21.5	0.846	31	1.220	15	0.591	1	0.039	12.8	6.65	13.2	SAA204FP7
—	7/8	52	2.047	27	1.063	—	—	15	0.591	1	0.039	14.0	7.85	13.9	SBB205-14RK
	—	52	2.047	27	1.063	—	—	15	0.591	1	0.039	14.0	7.85	13.9	SBB205-15RK
25	—	52	2.047	21.5	0.846	31	1.220	15	0.591	1	0.039	14.0	7.85	13.9	SAA205-15FP7
	—	52	2.047	27	1.063	—	—	15	0.591	1	0.039	14.0	7.85	13.9	SBB205RK
—	1	52	2.047	21.5	0.846	31	1.220	15	0.591	1	0.039	14.0	7.85	13.9	SAA205FP7
	—	52	2.047	27	1.063	—	—	15	0.591	1	0.039	14.0	7.85	13.9	SBB205-16RK
30	—	52	2.047	21.5	0.846	31	1.220	15	0.591	1	0.039	14.0	7.85	13.9	SAA205-16FP7
	—	62	2.441	30	1.181	—	—	16	0.630	1	0.039	19.5	11.3	13.9	SBB206-18RK
—	1 1/8	62	2.441	23.8	0.937	35.7	1.406	18	0.709	1	0.039	19.5	11.3	13.9	SAA206-18FP7
	—	62	2.441	30	1.181	—	—	16	0.630	1	0.039	19.5	11.3	13.9	SBB206RK
30	—	62	2.441	23.8	0.937	35.7	1.406	18	0.709	1	0.039	19.5	11.3	13.9	SAA206FP7
	—	62	2.441	30	1.181	—	—	16	0.630	1	0.039	19.5	11.3	13.9	SBB206-19RK
—	1 3/16	62	2.441	23.8	0.937	35.7	1.406	18	0.709	1	0.039	19.5	11.3	13.9	SAA206-19FP7
	—	62	2.441	30	1.181	—	—	16	0.630	1	0.039	19.5	11.3	13.9	SBB206-20RK
—	1 1/4	62	2.441	23.8	0.937	35.7	1.406	18	0.709	1	0.039	19.5	11.3	13.9	SAA206-20FP7
	—	72	2.835	32	1.260	—	—	17	0.669	1.1	0.043	25.7	15.4	13.9	SBB207-20RK
—	1 1/4	72	2.835	25.4	1.000	38.9	1.531	19	0.748	1.1	0.043	25.7	15.4	13.9	SAA207-20FP7
	—	72	2.835	25.4	1.000	38.9	1.531	19	0.748	1.1	0.043	25.7	15.4	13.9	SAA207-21FP7
—	1 5/16	72	2.835	32	1.260	—	—	17	0.669	1.1	0.043	25.7	15.4	13.9	SBB207-22RK
	—	72	2.835	25.4	1.000	38.9	1.531	19	0.748	1.1	0.043	25.7	15.4	13.9	SAA207-22FP7
35	—	72	2.835	32	1.260	—	—	17	0.669	1.1	0.043	25.7	15.4	13.9	SBB207RK
	—	72	2.835	25.4	1.000	38.9	1.531	19	0.748	1.1	0.043	25.7	15.4	13.9	SAA207FP7
—	1 7/16	72	2.835	32	1.260	—	—	17	0.669	1.1	0.043	25.7	15.4	13.9	SBB207-23RK
	—	72	2.835	25.4	1.000	38.9	1.531	19	0.748	1.1	0.043	25.7	15.4	13.9	SAA207-23FP7
—	1 1/2	80	3.150	34	1.339	—	—	18	0.709	1.1	0.043	29.1	17.8	14.0	SBB208-24RK
	—	80	3.150	30.2	1.189	43.7	1.720	22	0.866	1.1	0.043	29.1	17.8	14.0	SAA208-24FP7
—	1 9/16	80	3.150	30.2	1.189	43.7	1.720	22	0.866	1.1	0.043	29.1	17.8	14.0	SAA208-25FP7
	—	80	3.150	34	1.339	—	—	18	0.709	1.1	0.043	29.1	17.8	14.0	SBB208RK
40	—	80	3.150	30.2	1.189	43.7	1.720	22	0.866	1.1	0.043	29.1	17.8	14.0	SAA208FP7
	—	85	3.346	30.2	1.189	43.7	1.720	22	0.866	1.1	0.043	34.1	21.3	14.0	SAA209-26FP7
—	1 5/8	85	3.346	30.2	1.189	43.7	1.720	22	0.866	1.1	0.043	34.1	21.3	14.0	SAA209-27FP7
	—	85	3.346	30.2	1.189	43.7	1.720	22	0.866	1.1	0.043	34.1	21.3	14.0	SAA209-28FP7
45	—	85	3.346	30.2	1.189	43.7	1.720	22	0.866	1.1	0.043	34.1	21.3	14.0	SAA209FP7
	—	90	3.543	30.2	1.189	43.7	1.720	22	0.866	1.1	0.043	35.1	23.3	14.4	SAA210-30FP7
50	—	90	3.543	30.2	1.189	43.7	1.720	22	0.866	1.1	0.043	35.1	23.3	14.4	SAA210-31FP7
	—	90	3.543	30.2	1.189	43.7	1.720	22	0.866	1.1	0.043	35.1	23.3	14.4	SAA210FP7
—	2	100	3.937	32.4	1.276	48.4	1.906	24	0.945	1.5	0.059	43.4	29.4	14.4	SAA211-32FP7
	—	100	3.937	32.4	1.276	48.4	1.906	24	0.945	1.5	0.059	43.4	29.4	14.4	SAA211-34FP7
55	—	100	3.937	32.4	1.276	48.4	1.906	24	0.945	1.5	0.059	43.4	29.4	14.4	SAA211FP7
	—	100	3.937	32.4	1.276	48.4	1.906	24	0.945	1.5	0.059	43.4	29.4	14.4	SAA211-35FP7



	Dimensions								Set Screw Brg. Bore		Mass kg
	S		S <sub>1</sub>		S <sub>2</sub>		d <sub>1</sub>		mm	inch	
	mm	inch	mm	inch	mm	inch	mm	inch			
6	0.236				4	0.157	-	-	M5x0.5	-	0.10
6.5	0.256	16	0.630	4.8	0.189	28.6	1.126		M6x0.75	-	0.13
6	0.236			4	0.157	-	-		-	No.10-32UNF	0.10
6.5	0.256	16	0.630	4.8	0.189	28.6	1.126		-	1/4-28UNF	0.13
6	0.236	16	0.630	4	0.157	-	-		M5x0.5	-	0.10
6.5	0.256			4.8	0.189	28.6	1.126		M6x0.75	-	0.13
6	0.236	16	0.630	4	0.157	-	-		-	No.10-32UNF	0.10
6	0.236	16	0.630	4	0.157	-	-		M5x0.5	-	0.10
6.5	0.256			4.8	0.189	28.6	1.126		M6x0.75	-	0.13
7	0.276			5	0.197	-	-		-	1/4-28UNF	0.15
7.5	0.295	18	0.709	4.8	0.189	33.3	1.311		-	1/4-28UNF	0.19
7	0.276			5	0.197	-	-		M6x0.75	-	0.15
7.5	0.295	18	0.709	4.8	0.189	33.3	1.311		M6x0.75	-	0.19
7.5	0.295	19.5	0.768	5.5	0.217	-	-		-	1/4-28UNF	0.18
7.5	0.295			5.5	0.217	-	-		-	1/4-28UNF	0.18
7.5	0.295	19.5	0.768	4.8	0.189	38.1	1.500		-	1/4-28UNF	0.23
7.5	0.295			5.5	0.217	-	-		M6x0.75	-	0.18
7.5	0.295	19.5	0.768	4.8	0.189	38.1	1.500		M6x0.75	-	0.23
7.5	0.295			5.5	0.217	-	-		-	1/4-28UNF	0.18
7.5	0.295	19.5	0.768	4.8	0.189	38.1	1.500		-	1/4-28UNF	0.23
8	0.315	22	0.866	6	0.236	-	-		-	1/4-28UNF	0.27
9	0.354			6	0.236	44.5	1.752		-	5/16-24UNF	0.34
8	0.315			6	0.236	-	-		M6x0.75	-	0.27
9	0.354	22	0.866	6	0.236	44.5	1.752		M8x1	-	0.34
8	0.315			6	0.236	-	-		-	1/4-28UNF	0.27
9	0.354	22	0.866	6	0.236	44.5	1.752		-	5/16-24UNF	0.34
8	0.315	22	0.866	6	0.236	-	-		-	1/4-28UNF	0.27
9	0.354			6	0.236	44.5	1.752		-	5/16-24UNF	0.34
8.5	0.335			6	0.236	-	-		-	1/4-28UNF	0.42
9.5	0.374	23.5	0.925	6.8	0.268	55.6	2.189		-	5/16-24UNF	0.57
9.5	0.374			6.8	0.268	55.6	2.189		-	5/16-24UNF	0.57
8.5	0.335			6	0.236	-	-		-	1/4-28UNF	0.42
9.5	0.374	23.5	0.925	6.8	0.268	55.6	2.189		-	5/16-24UNF	0.57
8.5	0.335			6	0.236	-	-		M6x0.75	-	0.42
9.5	0.374	23.5	0.925	6.8	0.268	55.6	2.189		M8x1	-	0.57
8.5	0.335			6	0.236	-	-		-	1/4-28UNF	0.42
9.5	0.374	23.5	0.925	6.8	0.268	55.6	2.189		-	5/16-24UNF	0.57
9	0.354	25	0.984	8	0.315	-	-		-	5/16-24UNF	0.60
11	0.433			6.8	0.268	60.3	2.374		-	5/16-24UNF	0.75
11	0.433			6.8	0.268	60.3	2.374		-	5/16-24UNF	0.75
9	0.354			8	0.315	-	-		M8x1	-	0.60
11	0.433	25	0.984	6.8	0.268	60.3	2.374		M8x1	-	0.75
11	0.433			6.8	0.268	63.5	2.500		-	5/16-24UNF	0.82
11	0.433			6.8	0.268	63.5	2.500		-	5/16-24UNF	0.82
11	0.433			6.8	0.268	63.5	2.500		-	5/16-24UNF	0.82
11	0.433			6.8	0.268	63.5	2.500		M8x1	-	0.82
11	0.433			6.8	0.268	69.9	2.752		-	5/16-24UNF	0.85
11	0.433			6.8	0.268	69.9	2.752		-	5/16-24UNF	0.85
11	0.433			6.8	0.268	69.9	2.752		M8x1	-	0.85
12	0.472			8	0.315	76.2	3.000		-	3/8-24UNF	1.2
12	0.472			8	0.315	76.2	3.000		-	3/8-24UNF	1.2
12	0.472			8	0.315	76.2	3.000		M10x1.25	-	1.2
12	0.472			8	0.315	76.2	3.000		-	3/8-24UNF	1.2



**Ball Bearing Inserts**

**SC**  
Cylindrical bore  
 $d$  17 ~ 40 mm

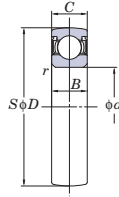

Shaft Dia. mm  $d$	Dimensions								Basic Load Ratings kN		Factor	Bearing No.	Mass kg
	$D$		$B$		$C$		$r$ (min.)		$C_0$	$C_{0r}$	$f_0$		
	mm	inch	mm	inch	mm	inch	mm	inch					
17	40	1.575	12	0.472	12	0.472	0.6	0.024	9.55	4.80	13.2	SC203	0.10
20	47	1.850	14	0.551	14	0.551	1	0.039	12.8	6.65	13.2	SC204	0.15
25	52	2.047	15	0.591	15	0.591	1	0.039	14.0	7.85	13.9	SC205	0.18
30	62	2.441	16	0.630	16	0.630	1	0.039	19.5	11.3	13.9	SC206	0.27
35	72	2.835	17	0.669	17	0.669	1.1	0.043	25.7	15.4	13.9	SC207	0.42
40	80	3.150	18	0.709	18	0.709	1.1	0.043	29.1	17.8	14.0	SC208	0.60



**RODAVIGO, S.A.**  
RODAMIENTOS VIGO, S.A.

[www.rodavigo.net](http://www.rodavigo.net)

**+34 986 288118**  
Servicio de Att. al Cliente

**FYH**