



**RODAVIGO, S.A.**  
RODAMIENTOS VIGO, S.A.

[www.rodavigo.net](http://www.rodavigo.net)

+34 986 288118  
Servicio de Att. al Cliente

**FYH**<sup>®</sup>

**NU-LOC**<sup>®</sup>

**NU Concentric-LOC  
BALL BEARING UNITS**



***EASY INSTALLATION  
360° SHAFT CONTACT  
TRUE CONCENTRIC LOCK***

CATALOG NO.3401



[fyhbearings.com](http://fyhbearings.com)



# FYH®

## Uniform LOC

The FYH NU-LOC bearing grips the shaft more uniformly, which allows 360 degrees of equalized locking contact. The roundness of the ball path on NU-LOC bearings results in better operation and longer life. NU-LOC concentric locking collars are designed to prevent shaft marring and burring. A single standard hex head cap screw can be tightened quickly and easily. NU-LOC bearings can replace either setscrew or eccentric locking collar inserts.

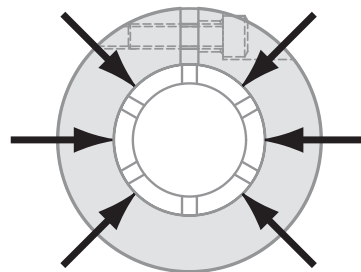

### 360° LOCKING

NU-LOC concentric locking collar with a single cap screw provides great holding power. The collar is installed over the slotted inner ring on the shaft concentrically.

### Ballpath Roundness

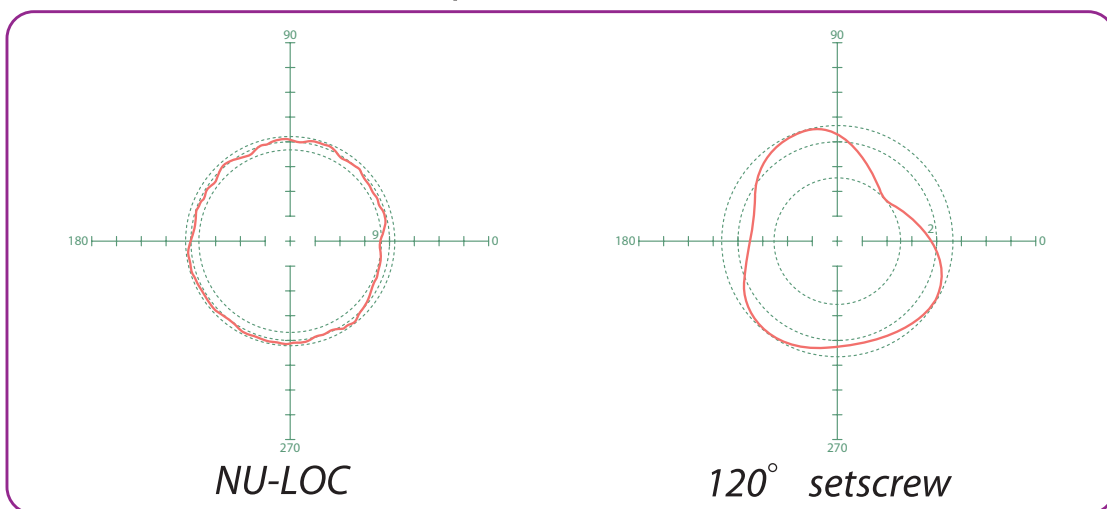

Quick & Easy Installation with a single hex cap screw.



### Cross-Section Detail

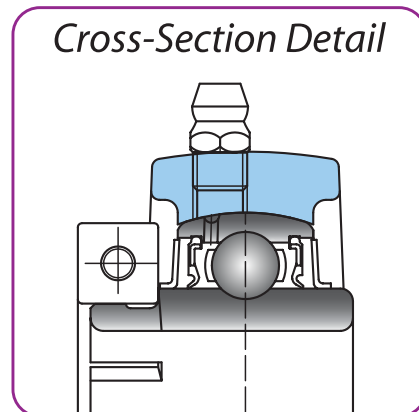

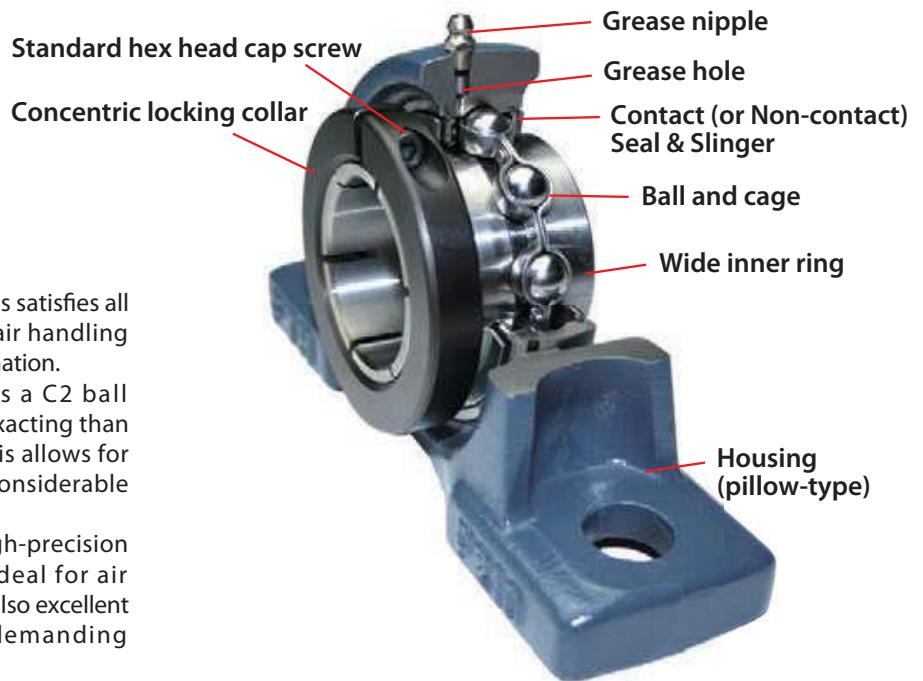

The standard NU-LOC series satisfies all the specifications of our air handling series under the "S3" designation.

This series incorporates a C2 ball clearance which is more exacting than the standard style, and this allows for quieter operation and a considerable reduction of vibration.

The NU-LOC series is a high-precision design and, while it is ideal for air handling applications, it is also excellent for many more highly demanding applications.

SUFFIX							
<b>S3</b>	<b>P18</b>	P18 is the suffix code that designates smaller bore tolerance which allows for a tighter fit with the shaft. This, in turn, reduces vibration and noise and dramatically increases bearing life.					
		<b>Tolerance and tolerance values of inner rings of P18 suffix (unit: <math>\mu\text{m}</math>)</b>					
		Nominal bearing bore dia. $d$ (mm)		Variation of tolerance of average bore dia. in plane $\Delta d_{mp}$		Unequal bore dia. in plane $V_{dp}$	Radial runout of inner ring $K_{ia}$
	<b>Over</b>	<b>Incl.</b>	<b>Max.</b>	<b>Min.</b>	<b>Max.</b>	<b>Max.</b>	
	-	10	+13	0	6	7	
	10	18	+13	0	6	8	
	18	31.75	+13	0	10	10	
	31.75	50.8	+15	0	10	10	
	50.8	80	+18	0	14	13	
		<b>Tolerance and tolerance values of inner rings of ISO standard (unit: <math>\mu\text{m}</math>)</b>					
	Nominal bearing bore dia. $d$ (mm)		Variation of tolerance of average bore dia. in plane $\Delta d_{mp}$		Unequal bore dia. in plane $V_{dp}$	Radial runout of inner ring $K_{ia}$	
	<b>Over</b>	<b>Incl.</b>	<b>Max.</b>	<b>Min.</b>	<b>Max.</b>	<b>Max.</b>	
	-	10	+15	0	10	10	
	10	18	+15	0	10	15	
	18	31.75	+18	0	12	18	
	31.75	50.8	+21	0	14	20	
	50.8	80	+24	0	16	25	
	<b>P11</b>	The anti-rotation pin, in conjunction with the standard "J" fit housing, means very secure housing fit in high speed applications.					
	<b>C2</b>	Internal bearing clearance is defined as the allowable space between the rolling elements and the raceways. C2 is smaller clearance than the standard, and it reduces the noise and vibration in high speed applications.					



# Pillow type units NU-LOC

NCP

Cylindrical bore (with concentric locking collar)

d 20 ~ 60 mm

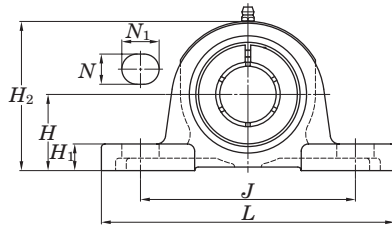
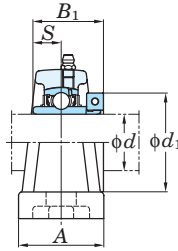

Shaft Dia mm inch	Dimensions inch mm											Bolt Size inch mm	Unit No.	Housing No.	Bearing No.	Mass kg
	d	H	L	A	J	N	N <sub>1</sub>	H <sub>1</sub>	H <sub>2</sub>	B <sub>1</sub>	S					
20 3/4	1 5/16	5	1 1/2	3 3/4	1/2	23/32	1/2	2 17/32	1 9/32	0.500	1 3/4	3/8	NCP204-12 NCP204	P204	NC204-12 NC204	0.80
	33.3	127	38	95	13	18	13	64	32.5	12.7	44.5	M10				
25 7/8 15/16	1 7/16	5 1/2	1 1/2	4 1/8	1/2	23/32	1/2	2 25/32	1 7/16	0.563	1 15/16	3/8	NCP205-14 NCP205-15 NCP205 NCP205-16	P205	NC205-14 NC205-15 NC205 NC205-16	1.0
	36.5	140	38	105	13	18	13	71	36.5	14.3	49.2	M10				
30 1 1/8 1 3/16	1 11/16	6 1/2	1 7/8	4 3/4	21/32	13/16	19/32	3 5/16	1 9/16	0.626	2 3/16	1/2	NCP206-18 NCP206 NCP206-19 NCP206-20	P206	NC206-18 NC206 NC206-19 NC206-20	1.5
	42.9	165	48	121	17	21	15	84	39.7	15.9	55.6	M14				
35 1 1/4 1 3/8	1 7/8	6 9/16	1 7/8	5	21/32	13/16	5/8	3 21/32	1 3/4	0.689	2 7/16	1/2	NCP207-20 NCP207-22 NCP207 NCP207-23	P207	NC207-20 NC207-22 NC207 NC207-23	1.9
	47.6	167	48	127	17	21	16	93	44.5	17.5	61.9	M14				
40 1 1/2	1 15/16	7 1/4	2 1/8	5 13/32	21/32	13/16	21/32	3 27/32	2	0.748	2 11/16	1/2	NCP208-24 NCP208	P208	NC208-24 NC208	2.4
	49.2	184	54	137	17	21	17	98	50.8	19	68.3	M14				
45 1 5/8 1 11/16	2 1/8	7 15/32	2 1/8	5 3/4	21/32	13/16	21/32	4 3/16	2	0.748	2 13/16	1/2	NCP209-26 NCP209-27 NCP209-28 NCP209	P209	NC209-26 NC209-27 NC209-28 NC209	2.6
	54	190	54	146	17	21	17	106	50.8	19	71.4	M14				
50 1 15/16 2	2 1/4	8 1/8	2 3/8	6 1/4	25/32	7/8	3/4	4 7/16	2 3/32	0.748	3 3/8	5/8	NCP210-31 NCP210 NCP210-32	P210	NC210-31 NC210 NC210-32	3.5
	57.2	206	60	159	20	22	19	113	53.1	19	85.7	M16				
55 2 2 3/16	2 1/2	8 5/8	2 3/8	6 23/32	25/32	7/8	3/4	4 29/32	2 1/4	0.874	3 1/2	5/8	NCP211-32 NCP211 NCP211-35	P211	NC211-32 NC211 NC211-35	4.0
	63.5	219	60	171	20	22	19	125	57.1	22.2	88.9	M16				
60 2 1/4 2 3/4	2 1/2	8 5/8	2 3/8	6 23/32	25/32	7/8	3/4	4 29/32	2 1/4	0.874	3 5/8	5/8	NCP212-36 NCP212 NCP212-39	P212	NC212-36 NC212 NC212-39	5.6
	63.5	219	60	171	20	22	19	125	57.1	22.2	92.1	M16				
60 2 1/4 2 3/4	2 3/4	9 1/2	2 3/4	7 1/4	25/32	31/32	7/8	5 7/16	2 5/8	1.000	4 1/16	5/8	NCP212-36 NCP212 NCP212-39	P212	NC212-36 NC212 NC212-39	5.6
	69.8	241	70	184	20	25	22	138	66.7	25.4	103.2	M16				
60 2 3/4 2 7/16	2 3/4	9 1/2	2 3/4	7 1/4	25/32	31/32	7/8	5 7/16	2 5/8	1.000	4 1/8	5/8	NCP212 NCP212-39	P212	NC212 NC212-39	5.6
	69.8	241	70	184	20	25	22	138	66.7	25.4	104.8	M16				

**Round flange cartridge type units NU-LOC  
NCFC  
Cylindrical bore (with concentric locking collar)  
d 20 ~ 60 mm**

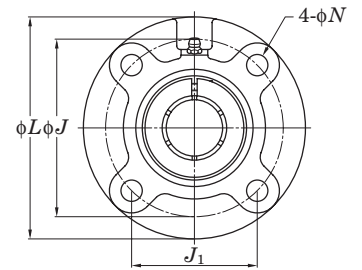
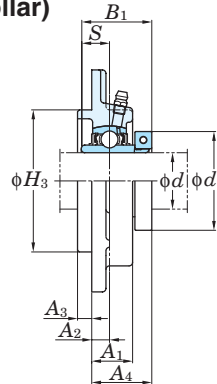

Shaft Dia mm inch	Dimensions inch mm													Bolt Size inch mm	Unit No.	Housing No.	Bearing No.	Mass kg
	L	H <sub>3</sub>	J	J <sub>1</sub>	N	A <sub>1</sub>	A <sub>2</sub>	A <sub>3</sub>	A <sub>4</sub>	B <sub>1</sub>	S	d <sub>1</sub>						
20 3/4	3 15/16	2.4409	3 5/64	2 11/64	15/32	13/16	25/64	13/64	1 3/16	1 9/32	0.500	1 3/4	3/8	NCFC204-12 NCFC204	FC204	NC204-12 NC204	0.87	
	100	62	78	55.1	12	20.5	10	5	29.8	32.5	12.7	44.5	M10					
25 7/8 15/16 1	4 17/32	2.7559	3 35/64	2 1/2	15/32	13/16	25/64	15/64	1 9/32	1 7/16	0.563	1 15/16	3/8	NCFC205-14 NCFC205-15 NCFC205	FC205	NC205-14 NC205-15 NC205 NC205-16	1.2	
	115	70	90	63.6	12	21	10	6	32.2	36.5	14.3	49.2	M10					
30 1 3/16 1 1/4	4 29/32	3.1496	3 15/16	2 25/32	15/32	29/32	25/64	5/16	1 11/32	1 9/16	0.626	2 3/16	3/8	NCFC206-18 NCFC206	FC206	NC206-18 NC206 NC206-19 NC206-20	1.5	
	125	80	100	70.7	12	23	10	8	33.8	39.7	15.9	55.6	M10					
35 1 1/4 1 3/8 1 7/16	5 5/16	3.5433	4 21/64	3 1/16	35/64	1 1/32	7/16	5/16	1 1/2	1 3/4	0.689	2 7/16	7/16	NCFC207-20	FC207	NC207-20	2.0	
	135	90	110	77.8	14	26	11	8	38	44.5	17.5	61.9	M12					
35 1 3/8 1 7/16	5 5/16	3.5433	4 21/64	3 1/16	35/64	1 1/32	7/16	5/16	1 1/2	1 3/4	0.689	2 9/16	7/16	NCFC207-22 NCFC207	FC207	NC207-22 NC207 NC207-23	2.0	
	135	90	110	77.8	14	26	11	8	38	44.5	17.5	65.1	M12					
40 1 1/2	5 23/32	3.9370	4 23/32	3 11/32	35/64	1 1/32	7/16	25/64	1 11/16	2	0.748	2 11/16	7/16	NCFC208-24 NCFC208	FC208	NC208-24 NC208	2.4	
	145	100	120	84.8	14	26	11	10	42.8	50.8	19	68.3	M12					
45 1 5/8 1 11/16 1 3/4	6 5/16	4.1339	5 13/64	3 43/64	5/8	1 1/32	25/64	15/32	1 21/32	2	0.748	2 13/16	1/2	NCFC209-26	FC209	NC209-26	3.0	
	160	105	132	93.3	16	26	10	12	41.8	50.8	19	71.4	M14					
45 1 11/16 1 3/4	6 5/16	4.1339	5 13/64	3 43/64	5/8	1 1/32	25/64	15/32	1 21/32	2	0.748	2 15/16	1/2	NCFC209-27 NCFC209-28 NCFC209	FC209	NC209-27 NC209-28 NC209	3.0	
	160	105	132	93.3	16	26	10	12	41.8	50.8	19	74.6	M14					
50 1 15/16 2	6 1/2	4.3307	5 7/16	3 27/32	5/8	1 3/32	25/64	15/32	1 3/4	2 3/32	0.748	3 3/8	1/2	NCFC210-31 NCFC210	FC210	NC210-31 NC210 NC210-32	3.5	
	165	110	138	97.6	16	28	10	12	44.1	53.1	19	85.7	M14					
55 2 2 3/16	7 9/32	4.9213	5 29/32	4 11/64	3/4	1 7/32	33/64	15/32	1 7/8	2 1/4	0.874	3 1/2	5/8	NCFC211-32	FC211	NC211-32	4.6	
	185	125	150	106.1	19	31	13	12	47.9	57.1	22.2	88.9	M16					
55 2 3/16	7 9/32	4.9213	5 29/32	4 11/64	3/4	1 7/32	33/64	15/32	1 7/8	2 1/4	0.874	3 5/8	5/8	NCFC211 NCFC211-35	FC211	NC211 NC211-35	4.6	
	185	125	150	106.1	19	31	13	12	47.9	57.1	22.2	92.1	M16					
60 2 1/4 2 7/16	7 11/16	5.3150	6 19/64	4 29/64	3/4	1 13/32	43/64	15/32	2 9/32	2 5/8	1.000	4 1/16	5/8	NCFC212-36	FC212	NC212-36	5.7	
	195	135	160	113.1	19	36	17	12	58.3	66.7	25.4	103.2	M16					
60 2 1/4 2 7/16	7 11/16	5.3150	6 19/64	4 29/64	3/4	1 13/32	43/64	15/32	2 9/32	2 5/8	1.000	4 1/8	5/8	NCFC212 NCFC212-39	FC212	NC212 NC212-39	5.7	
	195	135	160	113.1	19	36	17	12	58.3	66.7	25.4	104.8	M16					

NCFCF (For USA) is also available. Contact FYH for unit specifications.



[fyhbearings.com](http://fyhbearings.com)

**Tapped-base pillow type units NU-LOC**  
**NCPA**  
**Cylindrical bore (with concentric locking collar)**  
*d* 20 ~ 50 mm

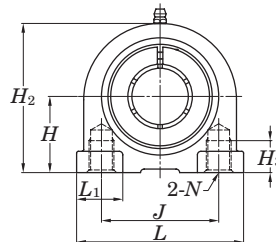
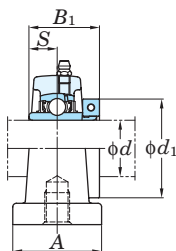

Shaft Dia mm inch	Dimensions inch mm											Unit No.	Housing No.	Bearing No.	Mass kg
	<i>d</i>	<i>H</i>	<i>L</i>	<i>A</i>	<i>J</i>	<i>N</i>	<i>H</i> <sub>2</sub>	<i>H</i> <sub>3</sub>	<i>L</i> <sub>1</sub>	<i>B</i> <sub>1</sub>	<i>S</i>				
20 3/4	1 3/16	3	1 9/16	2 3/64		2 3/8	1/2	1 1/16	1 9/32	0.500	1 3/4	NCPA204-12 NCPA204	PA204	NC204-12 NC204	0.73
	30.2	76	40	52	M10×1.5	60	13	27	32.5	12.7	44.5				
25 7/8 15/16 1	1 7/16	3 5/16	1 25/32	2 13/64		2 25/32	1/2	1 3/16	1 7/16	0.563	1 15/16	NCPA205-14 NCPA205-15 NCPA205 NCPA205-16	PA205	NC205-14 NC205-15 NC205 NC205-16	1.0
	36.5	84	45	56	M10×1.5	71	13	30	36.5	14.3	49.2				
	1 1/8	1 11/16	3 11/16	1 31/32	2 19/32		3 5/16	23/32	1 13/32	1 9/16	0.626				
30 1 3/16 1 1/4	42.9	94	50	66	M14×2	84	18	36	39.7	15.9	55.6	NCPA206-18 NCPA206 NCPA206-19 NCPA206-20	PA206	NC206-18 NC206 NC206-19 NC206-20	1.4
	1 1/4	1 7/8	3 11/32	2 5/32	3 5/32		3 21/32	25/32	1 5/8	1 3/4	0.689				
35 1 3/8 1 7/16	47.6	110	55	80	M14×2	93	20	41	44.5	17.5	61.9	NCPA207-20 NCPA207-22 NCPA207 NCPA207-23	PA207	NC207-20 NC207-22 NC207 NC207-23	2.0
	1 3/8	1 7/8	3 11/32	2 5/32	3 5/32		3 21/32	25/32	1 5/8	1 3/4	0.689				
40 1 1/2	49.2	116	58	84	M14×2	100	20	41	50.8	19	68.3	NCPA208-24 NCPA208	PA208	NC208-24 NC208	2.4
1 5/8	2 9/64	4 23/32	2 3/8	3 35/64		4 3/16	31/32	1 21/32	2	0.748	2 13/16				
45 1 11/16 1 3/4	54.2	120	60	90	M14×2	106	25	42	50.8	19	71.4	NCPA209-26 NCPA209-27 NCPA209-28 NCPA209	PA209	NC209-26 NC209-27 NC209-28 NC209	2.6
	1 11/16	2 9/64	4 23/32	2 3/8	3 35/64		4 3/16	31/32	1 21/32	2	0.748				
50 1 15/16 2	57.2	130	64	94	M16×2	113	25	47	53.1	19	85.7	NCPA210-31 NCPA210 NCPA210-32	PA210	NC210-31 NC210 NC210-32	3.4
	1 15/16	2 1/4	5 1/8	2 17/32	3 45/64		4 7/16	31/32	1 27/32	2 3/32	0.748				



**Tapped-base pillow type units NU-LOC  
NCPAN**  
Cylindrical bore (with concentric locking collar)  
 $d$  20 ~ 35 mm

**For USA**

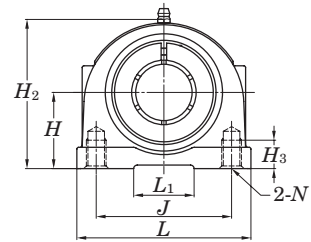
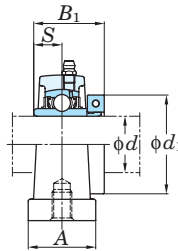

Shaft Dia mm inch	Dimensions inch mm											Unit No.	Housing No.	Bearing No.	Mass kg	
	$d$	$H$	$L$	$A$	$J$	$N$	$H_2$	$H_3$	$L_1$	$B_1$	$S$					$d_1$
20 $\frac{3}{4}$	$1 \frac{5}{16}$	$2 \frac{9}{16}$	$1 \frac{1}{4}$	2	$\frac{3}{8}$ -16UNC	$2 \frac{17}{32}$	$\frac{1}{2}$	$\frac{7}{8}$	$1 \frac{9}{32}$	0.500	$1 \frac{3}{4}$	<b>NCPAN204-12</b>	PAN204	NC204-12 NC204	0.80	
	33.3	65	32	50.8		64	12.7	22	32.5	12.7	44.5	<b>NCPAN204</b>				
25 $\frac{7}{8}$ $\frac{15}{16}$	$1 \frac{7}{16}$	$2 \frac{3}{4}$	$1 \frac{13}{32}$	2	$\frac{3}{8}$ -16UNC	$2 \frac{3}{4}$	$\frac{1}{2}$	$\frac{15}{16}$	$1 \frac{7}{16}$	0.563	$1 \frac{15}{16}$	<b>NCPAN205-14</b>	PAN205	NC205-14 NC205-15 NC205 NC205-16	1.4	
	36.5	70	36	50.8		70	13	24	36.5	14.3	49.2	<b>NCPAN205-15</b>				
	1															<b>NCPAN205-16</b>
30 $1 \frac{1}{8}$ $1 \frac{3}{16}$ $1 \frac{1}{4}$	$1 \frac{11}{16}$	$3 \frac{27}{32}$	$1 \frac{1}{2}$	3	$\frac{7}{16}$ -14UNC	$3 \frac{7}{32}$	$\frac{5}{8}$	$1 \frac{11}{32}$	$1 \frac{9}{16}$	0.626	$2 \frac{3}{16}$	<b>NCPAN206-18</b>	PAN206	NC206-18 NC206 NC206-19 NC206-20	1.9	
	42.9	98	38	76.2		82	16	34	39.7	15.9	55.6	<b>NCPAN206-19</b>				
																<b>NCPAN206-20</b>
35 $1 \frac{1}{4}$ $1 \frac{3}{8}$ $1 \frac{7}{16}$	$1 \frac{7}{8}$	$4 \frac{11}{32}$	$1 \frac{7}{8}$	$3 \frac{1}{4}$	$\frac{1}{2}$ -13UNC	$3 \frac{21}{32}$	$\frac{3}{4}$	$1 \frac{3}{32}$	$1 \frac{3}{4}$	0.689	$2 \frac{7}{16}$	<b>NCPAN207-20</b>	PAN207	NC207-20 NC207-22 NC207 NC207-23	2.3	
	47.6	110	48	82.6		93	19	28	44.5	17.5	61.9	<b>NCPAN207-22</b>				
																<b>NCPAN207-23</b>



**Square four-bolt flange type units NU-LOC  
NCF**  
Cylindrical bore (with concentric locking collar)  
 $d$  20 ~ 60 mm

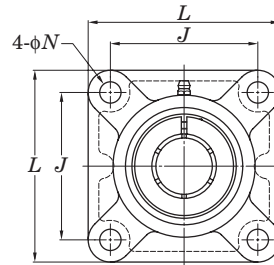
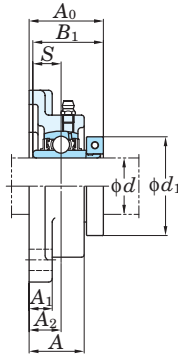

Shaft Dia mm inch	Dimensions inch mm											Bolt Size inch mm	Unit No.	Housing No.	Bearing No.	Mass kg
	$L$	$A$	$J$	$N$	$A_1$	$A_2$	$A_0$	$B_1$	$S$	$d_1$						
20 $\frac{3}{4}$	$3\frac{3}{8}$	1	$2\frac{33}{64}$	$\frac{15}{32}$	$\frac{7}{16}$	$\frac{19}{32}$	$1\frac{3}{8}$	$1\frac{9}{32}$	0.500	$1\frac{3}{4}$	$\frac{3}{8}$	NCF204-12 NCF204	F204	NC204-12 NC204	0.73	
	86	25.5	64	12	11	15	34.8	32.5	12.7	44.5	M10					
25 $\frac{7}{8}$ $\frac{15}{16}$	$3\frac{3}{4}$	$1\frac{1}{16}$	$2\frac{3}{4}$	$\frac{15}{32}$	$\frac{1}{2}$	$\frac{5}{8}$	$1\frac{1}{2}$	$1\frac{7}{16}$	0.563	$1\frac{15}{16}$	$\frac{3}{8}$	NCF205-14 NCF205-15 NCF205	F205	NC205-14 NC205-15 NC205 NC205-16	1.0	
	95	27	70	12	13	16	38.2	36.5	14.3	49.2	M10					
30 $1\frac{1}{8}$ $1\frac{3}{16}$ $1\frac{1}{4}$	$4\frac{1}{4}$	$1\frac{7}{32}$	$3\frac{17}{64}$	$\frac{15}{32}$	$\frac{1}{2}$	$\frac{45}{64}$	$1\frac{21}{32}$	$1\frac{9}{16}$	0.626	$2\frac{3}{16}$	$\frac{3}{8}$	NCF206-18 NCF206 NCF206-19 NCF206-20	F206	NC206-18 NC206 NC206-19 NC206-20	1.3	
	108	31	83	12	13	18	41.8	39.7	15.9	55.6	M10					
	$4\frac{19}{32}$	$1\frac{11}{32}$	$3\frac{5}{8}$	$\frac{35}{64}$	$\frac{19}{32}$	$\frac{3}{4}$	$1\frac{13}{16}$	$1\frac{3}{4}$	0.689	$2\frac{7}{16}$	$\frac{7}{16}$					
35 $1\frac{1}{4}$ $1\frac{3}{8}$ $1\frac{7}{16}$	117	34	92	14	15	19	46	44.5	17.5	61.9	M12	NCF207-20 NCF207-22 NCF207	F207	NC207-20 NC207-22 NC207 NC207-23	1.8	
	$4\frac{19}{32}$	$1\frac{11}{32}$	$3\frac{5}{8}$	$\frac{35}{64}$	$\frac{19}{32}$	$\frac{3}{4}$	$1\frac{13}{16}$	$1\frac{3}{4}$	0.689	$2\frac{9}{16}$	$\frac{7}{16}$					
40 $1\frac{1}{2}$ $1\frac{5}{8}$	117	34	92	14	15	19	46	44.5	17.5	65.1	M12	NCF207-23	F207	NC207-23	1.8	
	$4\frac{19}{32}$	$1\frac{11}{32}$	$3\frac{5}{8}$	$\frac{35}{64}$	$\frac{19}{32}$	$\frac{3}{4}$	$1\frac{13}{16}$	$1\frac{3}{4}$	0.689	$2\frac{9}{16}$	$\frac{7}{16}$					
45 $1\frac{1}{2}$ $1\frac{5}{8}$ $1\frac{3}{4}$	$5\frac{1}{8}$	$1\frac{13}{32}$	$4\frac{1}{64}$	$\frac{5}{8}$	$\frac{19}{32}$	$\frac{53}{64}$	$2\frac{3}{32}$	2	0.748	$2\frac{11}{16}$	$\frac{1}{2}$	NCF208-24 NCF208	F208	NC208-24 NC208	2.3	
	130	36	102	16	15	21	52.8	50.8	19	68.3	M14					
50 $1\frac{15}{16}$ 2	$5\frac{13}{32}$	$1\frac{1}{2}$	$4\frac{9}{64}$	$\frac{5}{8}$	$\frac{5}{8}$	$\frac{55}{64}$	$2\frac{1}{8}$	2	0.748	$2\frac{13}{16}$	$\frac{1}{2}$	NCF209-26 NCF209-27 NCF209-28 NCF209	F209	NC209-26 NC209-27 NC209-28 NC209	2.6	
	137	38	105	16	16	22	53.8	50.8	19	71.4	M14					
55 $1\frac{11}{16}$ $1\frac{3}{4}$	$5\frac{13}{32}$	$1\frac{1}{2}$	$4\frac{9}{64}$	$\frac{5}{8}$	$\frac{5}{8}$	$\frac{55}{64}$	$2\frac{1}{8}$	2	0.748	$2\frac{15}{16}$	$\frac{1}{2}$	NCF209-27 NCF209-28 NCF209	F209	NC209-27 NC209-28 NC209	2.6	
	137	38	105	16	16	22	53.8	50.8	19	74.6	M14					
60 $1\frac{15}{16}$ 2	$5\frac{5}{8}$	$1\frac{9}{16}$	$4\frac{3}{8}$	$\frac{5}{8}$	$\frac{5}{8}$	$\frac{55}{64}$	$2\frac{7}{32}$	$2\frac{3}{32}$	0.748	$3\frac{3}{8}$	$\frac{1}{2}$	NCF210-31 NCF210 NCF210-32	F210	NC210-31 NC210 NC210-32	3.1	
	143	40	111	16	16	22	56.1	53.1	19	85.7	M14					
	$6\frac{3}{8}$	$1\frac{11}{16}$	$5\frac{1}{8}$	$\frac{3}{4}$	$\frac{23}{32}$	$\frac{63}{64}$	$2\frac{11}{32}$	$2\frac{1}{4}$	0.874	$3\frac{1}{2}$	$\frac{5}{8}$					
60 $2\frac{3}{16}$	162	43	130	19	18	25	59.9	57.1	22.2	88.9	M16	NCF211-32 NCF211	F211	NC211-32 NC211	3.8	
	$6\frac{3}{8}$	$1\frac{11}{16}$	$5\frac{1}{8}$	$\frac{3}{4}$	$\frac{23}{32}$	$\frac{63}{64}$	$2\frac{11}{32}$	$2\frac{1}{4}$	0.874	$3\frac{5}{8}$	$\frac{5}{8}$					
60 $2\frac{1}{4}$ $2\frac{3}{8}$ $2\frac{7}{16}$	162	43	130	19	18	25	59.9	57.1	22.2	92.1	M16	NCF211-35	F211	NC211-35	3.8	
	$6\frac{7}{8}$	$1\frac{7}{8}$	$5\frac{5}{8}$	$\frac{3}{4}$	$\frac{23}{32}$	$1\frac{9}{64}$	$2\frac{25}{32}$	$2\frac{5}{8}$	1.000	$4\frac{1}{16}$	$\frac{5}{8}$					
	175	48	143	19	18	29	70.3	66.7	25.4	103.2	M16					NCF212-36 NCF212
$6\frac{7}{8}$	$1\frac{7}{8}$	$5\frac{5}{8}$	$\frac{3}{4}$	$\frac{23}{32}$	$1\frac{9}{64}$	$2\frac{25}{32}$	$2\frac{5}{8}$	1.000	$4\frac{1}{8}$	$\frac{5}{8}$						
175	48	143	19	18	29	70.3	66.7	25.4	104.8	M16	NCF212-39	F212	NC212-39	4.9		



**Square four-bolt flange type units NU-LOC  
NCF-E  
Cylindrical bore (with concentric locking collar)  
d 20 ~ 60 mm**

**For USA**

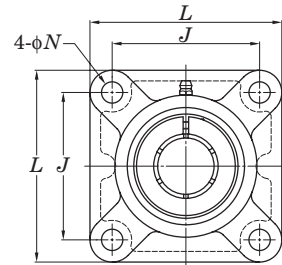
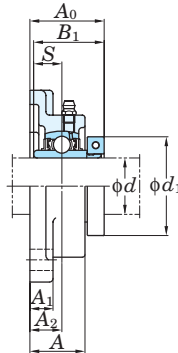

Shaft Dia mm inch	Dimensions inch mm										Bolt Size inch mm	Unit No.	Housing No.	Bearing No.	Mass kg
	L	A	J	N	A <sub>1</sub>	A <sub>2</sub>	A <sub>0</sub>	B <sub>1</sub>	S	d <sub>1</sub>					
20 3/4	3 3/8	1	2 33/64	7/16	7/16	19/32	1 3/8	1 9/32	0.500	1 3/4	3/8	NCF204-12E NCF204E	F204E	NC204-12 NC204	0.73
	86	25.5	64	11	11	15	34.8	32.5	12.7	44.5	-				
25 7/8 15/16 1	3 3/4	1 1/16	2 3/4	15/32	1/2	5/8	1 1/2	1 7/16	0.563	1 15/16	3/8	NCF205-14 NCF205-15 NCF205 NCF205-16	F205	NC205-14 NC205-15 NC205 NC205-16	1.0
	95	27	70	12	13	16	38.2	36.5	14.3	49.2	M10				
30 1 1/8 1 3/16 1 1/4	4 1/4	1 7/32	3 17/64	33/64	1/2	45/64	1 21/32	1 9/16	0.626	2 3/16	7/16	NCF206-18E NCF206E NCF206-19E NCF206-20E	F206E	NC206-18 NC206 NC206-19 NC206-20	1.3
	108	31	83	13	13	18	41.8	39.7	15.9	55.6	-				
35 1 1/4 1 3/8 1 7/16	4 19/32	1 11/32	3 5/8	33/64	19/32	3/4	1 13/16	1 3/4	0.689	2 7/16	7/16	NCF207-20E	F207E	NC207-20	1.8
	117	34	92	13	15	19	46	44.5	17.5	61.9	-				
40 1 1/2	4 19/32	1 11/32	3 5/8	33/64	19/32	3/4	1 13/16	1 3/4	0.689	2 9/16	7/16	NCF207-22E NCF207E NCF207-23E	F207E	NC207-22 NC207 NC207-23	1.8
	117	34	92	13	15	19	46	44.5	17.5	65.1	-				
45 1 5/8 1 11/16 1 3/4	5 1/8	1 13/32	4 1/64	35/64	19/32	53/64	2 3/32	2	0.748	2 11/16	1/2	NCF208-24E NCF208E	F208E	NC208-24 NC208	2.3
	130	36	102	14	15	21	52.8	50.8	19	68.3	-				
50 1 15/16 2	5 13/32	1 1/2	4 9/64	5/8	5/8	55/64	2 1/8	2	0.748	2 13/16	1/2	NCF209-26	F209	NC209-26	2.6
	137	38	105	16	16	22	53.8	50.8	19	71.4	M14				
55 2 2 3/16	5 13/32	1 1/2	4 9/64	5/8	5/8	55/64	2 1/8	2	0.748	2 15/16	1/2	NCF209-27 NCF209-28 NCF209	F209	NC209-27 NC209-28 NC209	2.6
	137	38	105	16	16	22	53.8	50.8	19	74.6	M14				
60 2 1/4 2 7/16	5 5/8	1 9/16	4 3/8	5/8	5/8	55/64	2 7/32	2 3/32	0.748	3 3/8	1/2	NCF210-31 NCF210 NCF210-32	F210	NC210-31 NC210 NC210-32	3.1
	143	40	111	16	16	22	56.1	53.1	19	85.7	M14				
65 2 3/8 2 7/8	6 3/8	1 11/16	5 1/8	43/64	23/32	63/64	2 11/32	2 1/4	0.874	3 1/2	5/8	NCF211-32E	F211E	NC211-32	3.8
	162	43	130	17	18	25	59.9	57.1	22.2	88.9	-				
70 2 7/8 3 1/8	6 3/8	1 11/16	5 1/8	43/64	23/32	63/64	2 11/32	2 1/4	0.874	3 5/8	5/8	NCF211E NCF211-35E	F211E	NC211 NC211-35	3.8
	162	43	130	17	18	25	59.9	57.1	22.2	92.1	-				
75 3 1/8 3 5/8	6 7/8	1 7/8	5 5/8	43/64	23/32	1 9/64	2 25/32	2 5/8	1.000	4 1/16	5/8	NCF212-36E	F212E	NC212-36	4.9
	175	48	143	17	18	29	70.3	66.7	25.4	103.2	-				
80 3 1/4 3 3/4	6 7/8	1 7/8	5 5/8	43/64	23/32	1 9/64	2 25/32	2 5/8	1.000	4 1/8	5/8	NCF212E NCF212-39E	F212E	NC212 NC212-39	4.9
	175	48	143	17	18	29	70.3	66.7	25.4	104.8	-				



**Oval tow-bolt flange type units NU-LOC  
NCFL**  
Cylindrical bore (with concentric locking collar)  
 $d$  20 ~ 60 mm

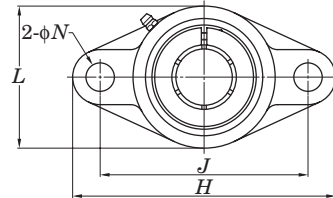
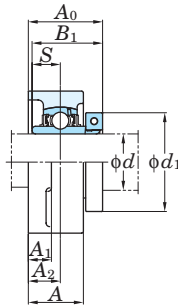

Shaft Dia mm inch	Dimensions inch mm												Bolt Size inch mm	Unit No.	Housing No.	Bearing No.	Mass kg
	$d$	$H$	$L$	$A$	$J$	$N$	$A_1$	$A_2$	$A_0$	$B_1$	$S$	$d_1$					
20	3/4	4 7/16	2 3/8	1	3 35/64	15/32	7/16	19/32	1 3/8	1 9/32	0.500	1 3/4	3/8	NCFL204-12 NCFL204	FL204	NC204-12 NC204	0.62
	7/8	5 1/8	2 11/16	1 1/16	3 57/64	5/8	1/2	5/8	1 1/2	1 7/16	0.563	1 15/16	1/2	NCFL205-14 NCFL205-15 NCFL205 NCFL205-16	FL205	NC205-14 NC205-15 NC205 NC205-16	0.84
25	15/16	130	68	27	99	16	13	16	38.2	36.5	14.3	49.2	M14				
	1																
30	1 1/8	5 13/16	3 5/32	1 7/32	4 39/64	5/8	1/2	45/64	1 21/32	1 9/16	0.626	2 3/16	1/2	NCFL206-18 NCFL206 NCFL206-19 NCFL206-20	FL206	NC206-18 NC206 NC206-19 NC206-20	1.1
	1 3/16	148	80	31	117	16	13	18	41.8	39.7	15.9	55.6	M14				
35	1 1/4	6 11/32	3 17/32	1 11/32	5 1/8	5/8	9/16	3/4	1 13/16	1 3/4	0.689	2 7/16	1/2	NCFL207-20	FL207	NC207-20	1.5
	1 3/8	161	90	34	130	16	14	19	46	44.5	17.5	61.9	M14				
40	1 3/8	6 11/32	3 17/32	1 11/32	5 1/8	5/8	9/16	3/4	1 13/16	1 3/4	0.689	2 9/16	1/2	NCFL207-22 NCFL207 NCFL207-23	FL207	NC207-22 NC207 NC207-23	1.5
	1 7/16	161	90	34	130	16	14	19	46	44.5	17.5	65.1	M14				
45	1 1/2	6 7/8	3 15/16	1 13/32	5 43/64	5/8	9/16	53/64	2 3/32	2	0.748	2 11/16	1/2	NCFL208-24 NCFL208	FL208	NC208-24 NC208	2.0
	1 5/8	175	100	36	144	16	14	21	52.8	50.8	19	68.3	M14				
50	1 5/8	7 13/32	4 1/4	1 1/2	5 53/64	3/4	19/32	55/64	2 1/8	2	0.748	2 13/16	5/8	NCFL209-26	FL209	NC209-26	2.3
	1 11/16	188	108	38	148	19	15	22	53.8	50.8	19	71.4	M16				
55	1 3/4	7 13/32	4 1/4	1 1/2	5 53/64	3/4	19/32	55/64	2 1/8	2	0.748	2 15/16	5/8	NCFL209-27 NCFL209-28 NCFL209	FL209	NC209-27 NC209-28 NC209	2.3
	1 7/16	188	108	38	148	19	15	22	53.8	50.8	19	74.6	M16				
60	1 15/16	7 3/4	4 17/32	1 9/16	6 3/16	3/4	19/32	55/64	2 7/32	2 3/32	0.748	3 3/8	5/8	NCFL210-31 NCFL210 NCFL210-32	FL210	NC210-31 NC210 NC210-32	2.8
	2	197	115	40	157	19	15	22	56.1	53.1	19	85.7	M16				
65	2	8 13/16	5 1/8	1 11/16	7 1/4	3/4	23/32	63/64	2 11/32	2 1/4	0.874	3 1/2	5/8	NCFL211-32	FL211	NC211-32	3.7
	2 3/16	224	130	43	184	19	18	25	59.9	57.1	22.2	88.9	M16				
70	2 3/16	8 13/16	5 1/8	1 11/16	7 1/4	3/4	23/32	63/64	2 11/32	2 1/4	0.874	3 5/8	5/8	NCFL211 NCFL211-35	FL211	NC211 NC211-35	3.7
	2 1/4	224	130	43	184	19	18	25	59.9	57.1	22.2	92.1	M16				
75	2 1/4	9 27/32	5 1/2	1 7/8	7 61/64	29/32	23/32	1 9/64	2 25/32	2 5/8	1.000	4 1/16	3/4	NCFL212-36	FL212	NC212-36	4.9
	250	140	48	202	23	18	29	70.3	66.7	25.4	103.2	M20					
80	2 1/4	9 27/32	5 1/2	1 7/8	7 61/64	29/32	23/32	1 9/64	2 25/32	2 5/8	1.000	4 1/8	3/4	NCFL212 NCFL212-39	FL212	NC212 NC212-39	4.9
	2 7/16	250	140	48	202	23	18	29	70.3	66.7	25.4	104.8	M20				

**Oval tow-bolt flange type units NU-LOC  
NCFL-E  
Cylindrical bore (with concentric locking collar)  
d 20 ~ 60 mm**

**For USA**

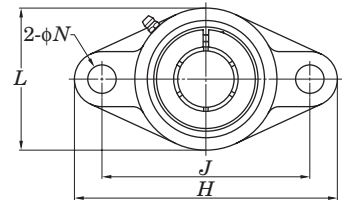
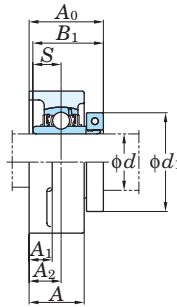

Shaft Dia mm inch	Dimensions inch mm											Bolt Size inch	Unit No.	Housing No.	Bearing No.	Mass kg
	H	L	A	J	N	A <sub>1</sub>	A <sub>2</sub>	A <sub>0</sub>	B <sub>1</sub>	S	d <sub>1</sub>					
20 3/4	4 7/16	2 3/8	1	3 17/32	25/64	7/16	19/32	1 3/8	1 9/32	0.500	1 3/4	5/16	NCFL204-12E NCFL204E	FL204E	NC204-12 NC204	0.62
	113	60	25.5	89.7	10	11	15	34.8	32.5	12.7	44.5					
25 7/8 15/16 1	5 1/8	2 11/16	1 1/16	3 57/64	15/32	1/2	5/8	1 1/2	1 7/16	0.563	1 15/16	3/8	NCFL205-14E NCFL205-15E NCFL205E NCFL205-16E	FL205E	NC205-14 NC205-15 NC205 NC205-16	0.84
	130	68	27	98.8	12	13	16	38.2	36.5	14.3	49.2					
	148	80	31	116.7	12	13	18	41.8	39.7	15.9	55.6					
30 1 3/16 1 1/4	5 13/16	3 5/32	1 7/32	4 19/32	15/32	1/2	45/64	1 21/32	1 9/16	0.626	2 3/16	3/8	NCFL206-18E NCFL206E NCFL206-19E NCFL206-20E	FL206E	NC206-18 NC206 NC206-19 NC206-20	1.1
	148	80	31	116.7	12	13	18	41.8	39.7	15.9	55.6					
	161	90	34	130.2	13	14	19	46	44.5	17.5	61.9					
	161	90	34	130.2	13	14	19	46	44.5	17.5	65.1					
35 1 1/4 1 3/8 1 7/16	6 11/32	3 17/32	1 11/32	5 1/8	33/64	9/16	3/4	1 13/16	1 3/4	0.689	2 7/16	7/16	NCFL207-20E	FL207E	NC207-20	1.5
	161	90	34	130.2	13	14	19	46	44.5	17.5	61.9					
40 1 1/2	6 7/8	3 15/16	1 13/32	5 21/32	33/64	9/16	53/64	2 3/32	2	0.748	2 11/16	7/16	NCFL208-24E NCFL208E	FL208E	NC208-24 NC208	2.0
	175	100	36	143.7	13	14	21	52.8	50.8	19	68.3					
45 1 5/8 1 11/16 1 3/4	7 13/32	4 1/4	1 1/2	5 27/32	19/32	19/32	55/64	2 1/8	2	0.748	2 13/16	1/2	NCFL209-26E	FL209E	NC209-26	2.3
	188	108	38	148.4	15	15	22	53.8	50.8	19	71.4					
	188	108	38	148.4	15	15	22	53.8	50.8	19	74.6					
50 1 15/16 2	7 3/4	4 17/32	1 9/16	6 3/16	19/32	19/32	55/64	2 7/32	2 3/32	0.748	3 3/8	1/2	NCFL210-31E NCFL210E NCFL210-32E	FL210E	NC210-31 NC210 NC210-32	2.8
	197	115	40	157	15	15	22	56.1	53.1	19	85.7					
	197	115	40	157	15	15	22	56.1	53.1	19	85.7					
55 2 2 3/16	8 13/16	5 1/8	1 11/16	7 1/4	21/32	23/32	63/64	2 11/32	2 1/4	0.874	3 1/2	9/16	NCFL211-32E	FL211E	NC211-32	3.7
	224	130	43	184	16.5	18	25	59.9	57.1	22.2	88.9					
	224	130	43	184	16.5	18	25	59.9	57.1	22.2	92.1					
60 2 1/4 2 1/2 2 7/16	9 27/32	5 1/2	1 7/8	7 61/64	21/32	23/32	1 9/64	2 25/32	2 5/8	1.000	4 1/16	9/16	NCFL212-36E	FL212E	NC212-36	4.9
	250	140	48	202	16.5	18	29	70.3	66.7	25.4	103.2					
	250	140	48	202	16.5	18	29	70.3	66.7	25.4	104.8					



# Take-up type units NU-LOC

NCT

Cylindrical bore (with concentric locking collar)

d 20 ~ 60 mm

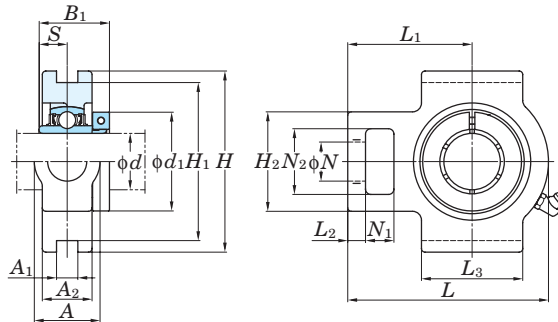

Shaft Dia mm inch	Dimensions inch mm																Unit No.	Housing No.	Bearing No.	Mass kg
	d	A	A <sub>1</sub>	A <sub>2</sub>	H	H <sub>1</sub>	H <sub>2</sub>	L	L <sub>1</sub>	L <sub>2</sub>	L <sub>3</sub>	N	N <sub>1</sub>	N <sub>2</sub>	B <sub>1</sub>	S				
20 3/4	1 1/4	15/32	13/16	3 1/2	2 63/64	2	3 11/16	2 13/32	13/32	2	3/4	5/8	1 1/4	1 9/32	0.500	1 3/4	NCT204-12 NCT204	T204	NC204-12 NC204	0.90
	32	12	21	89	76	51	94	61	10	51	19	16	32	32.5	12.7	44.5				
25 7/8 15/16	1 1/4	15/32	15/16	3 1/2	2 63/64	2	3 13/16	2 7/16	13/32	2	3/4	5/8	1 1/4	1 7/16	0.563	1 15/16	NCT205-14 NCT205-15 NCT205 NCT205-16	T205	NC205-14 NC205-15 NC205 NC205-16	1.0
	32	12	24	89	76	51	97	62	10	51	19	16	32	36.5	14.3	49.2				
30 1 1/8 1 3/16 1 1/4	1 15/32	15/32	1 3/32	4 1/32	3 1/2	2 7/32	4 7/16	2 3/4	13/32	2 1/4	7/8	5/8	1 15/32	1 9/16	0.626	2 3/16	NCT206-18 NCT206 NCT206-19 NCT206-20	T206	NC206-18 NC206 NC206-19 NC206-20	1.5
	37	12	28	102	89	56	113	70	10	57	22	16	37	39.7	15.9	55.6				
	1 1/4	1 15/32	15/32	1 3/16	4 1/32	3 1/2	2 17/32	5 3/32	3 1/16	1/2	2 17/32	7/8	5/8	1 15/32	1 3/4	0.689	2 7/16	NCT207-20	T207	NC207-20
35 1 3/8 1 7/16	1 15/32	15/32	1 3/16	4 1/32	3 1/2	2 17/32	5 3/32	3 1/16	1/2	2 17/32	7/8	5/8	1 15/32	1 3/4	0.689	2 9/16	NCT207-22 NCT207 NCT207-23	T207	NC207-22 NC207 NC207-23	1.9
	37	12	30	102	89	64	129	78	13	64	22	16	37	44.5	17.5	65.1				
40 1 1/2	1 15/16	5/8	1 5/16	4 1/2	4 1/64	3 9/32	5 21/32	3 15/32	19/32	3 9/32	1 3/32	3/4	1 15/16	2	0.748	2 11/16	NCT208-24 NCT208	T208	NC208-24 NC208	2.9
	49	16	33	114	102	83	144	88	16	83	29	19	49	50.8	19	68.3				
45 1 5/8 1 11/16 1 3/4	1 15/16	5/8	1 3/8	4 19/32	4 1/64	3 9/32	5 21/32	3 7/16	5/8	3 9/32	1 5/32	3/4	1 15/16	2	0.748	2 13/16	NCT209-26	T209	NC209-26	2.8
	49	16	35	117	102	83	144	87	16	83	29	19	49	50.8	19	71.4				
50 1 15/16 2	1 15/16	5/8	1 15/32	4 19/32	4 1/64	3 9/32	5 7/8	3 17/32	5/8	3 3/8	1 5/32	3/4	1 15/16	2 3/32	0.748	3 3/8	NCT210-31 NCT210 NCT210-32	T210	NC210-31 NC210 NC210-32	3.2
	49	16	37	117	102	83	149	90	16	86	29	19	49	53.1	19	85.7				
55 2 2 3/16	2 17/32	55/64	1 1/2	5 3/4	5 1/8	4 1/32	6 23/32	4 3/16	3/4	3 3/4	1 3/8	31/32	2 17/32	2 1/4	0.874	3 1/2	NCT211-32	T211	NC211-32	4.4
	64	22	38	146	130	102	171	106	19	95	35	25	64	57.1	22.2	88.9				
60 2 1/4 2 1/2	2 17/32	55/64	1 1/2	5 3/4	5 1/8	4 1/32	6 23/32	4 3/16	3/4	3 3/4	1 3/8	31/32	2 17/32	2 1/4	0.874	3 5/8	NCT211 NCT211-35	T211	NC211 NC211-35	4.4
	64	22	38	146	130	102	171	106	19	95	35	25	64	57.1	22.2	92.1				
60 2 1/4 2 7/16	2 17/32	55/64	1 21/32	5 3/4	5 1/8	4 1/32	7 5/8	4 11/16	3/4	4 1/32	1 3/8	1 1/4	2 17/32	2 5/8	1.000	4 1/16	NCT212-36	T212	NC212-36	5.6
	64	22	42	146	130	102	194	119	19	102	35	32	64	66.7	25.4	103.2				
60 2 1/2 2 7/16	2 17/32	55/64	1 21/32	5 3/4	5 1/8	4 1/32	7 5/8	4 11/16	3/4	4 1/32	1 3/8	1 1/4	2 17/32	2 5/8	1.000	4 1/8	NCT212 NCT212-39	T212	NC212 NC212-39	5.6
	64	22	42	146	130	102	194	119	19	102	35	32	64	66.7	25.4	104.8				

**Take-up type units NU-LOC  
NCT-E  
Cylindrical bore (with concentric locking collar)  
d 20 ~ 60 mm**

**For USA**

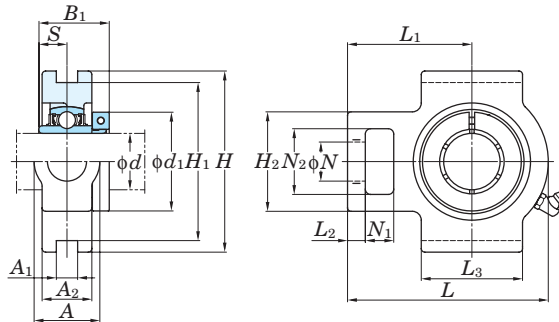

Shaft Dia mm inch	Dimensions inch mm																	Unit No.	Housing No.	Bearing No.	Mass kg
	d	A	A <sub>1</sub>	A <sub>2</sub>	H	H <sub>1</sub>	H <sub>2</sub>	L	L <sub>1</sub>	L <sub>2</sub>	L <sub>3</sub>	N	N <sub>1</sub>	N <sub>2</sub>	B <sub>1</sub>	S	d <sub>1</sub>				
20	3/4	1 1/4	17/32	13/16	3 1/2	3	2	3 11/16	2 13/32	13/32	2	3/4	5/8	1 1/4	1 9/32	0.500	1 3/4	NCT204-12E NCT204E	T204E	NC204-12 NC204	0.90
	7/8	1 1/4	17/32	15/16	3 1/2	3	2	3 13/16	2 7/16	13/32	2	3/4	5/8	1 1/4	1 7/16	0.563	1 15/16	NCT205-14E NCT205-15E NCT205E NCT205-16E	T205E	NC205-14 NC205-15 NC205 NC205-16	1.0
25	15/16	1 1/4	17/32	15/16	3 1/2	3	2	3 13/16	2 7/16	13/32	2	3/4	5/8	1 1/4	1 7/16	0.563	1 15/16	NCT205-14E NCT205-15E NCT205E NCT205-16E	T205E	NC205-14 NC205-15 NC205 NC205-16	1.0
	1	1 1/4	17/32	15/16	3 1/2	3	2	3 13/16	2 7/16	13/32	2	3/4	5/8	1 1/4	1 7/16	0.563	1 15/16	NCT205-14E NCT205-15E NCT205E NCT205-16E	T205E	NC205-14 NC205-15 NC205 NC205-16	1.0
30	1 1/8	1 15/32	17/32	1 3/16	4 1/32	3 1/2	2 7/32	4 7/16	2 3/4	13/32	2 1/4	7/8	5/8	1 15/32	1 9/16	0.626	2 3/16	NCT206-18E NCT206E NCT206-19E NCT206-20E	T206E	NC206-18 NC206 NC206-19 NC206-20	1.5
	1 3/16	1 15/32	17/32	1 3/16	4 1/32	3 1/2	2 7/32	4 7/16	2 3/4	13/32	2 1/4	7/8	5/8	1 15/32	1 9/16	0.626	2 3/16	NCT206-18E NCT206E NCT206-19E NCT206-20E	T206E	NC206-18 NC206 NC206-19 NC206-20	1.5
35	1 1/4	1 15/32	17/32	1 3/16	4 1/32	3 1/2	2 17/32	5 3/32	3 1/16	1/2	2 17/32	7/8	5/8	1 15/32	1 3/4	0.689	2 7/16	NCT207-20E	T207E	NC207-20	1.9
	1 3/8	1 15/32	17/32	1 3/16	4 1/32	3 1/2	2 17/32	5 3/32	3 1/16	1/2	2 17/32	7/8	5/8	1 15/32	1 3/4	0.689	2 9/16	NCT207-22E NCT207E NCT207-23E	T207E	NC207-22 NC207 NC207-23	1.9
40	1 1/2	1 15/16	11/16	1 5/16	4 1/2	4	3 9/32	5 21/32	3 15/32	5/8	3 9/32	1 5/32	3/4	1 15/16	2	0.748	2 11/16	NCT208-24E NCT208E	T208E	NC208-24 NC208	2.9
	1 5/8	1 15/16	11/16	1 3/8	4 19/32	4	3 9/32	5 21/32	3 7/16	5/8	3 9/32	1 5/32	3/4	1 15/16	2	0.748	2 13/16	NCT208-24E NCT208E	T208E	NC208-24 NC208	2.9
45	1 1/4	1 15/32	17/32	1 3/16	4 1/32	3 1/2	2 17/32	5 3/32	3 1/16	1/2	2 17/32	7/8	5/8	1 15/32	1 3/4	0.689	2 7/16	NCT207-20E	T207E	NC207-20	1.9
	1 3/8	1 15/32	17/32	1 3/16	4 1/32	3 1/2	2 17/32	5 3/32	3 1/16	1/2	2 17/32	7/8	5/8	1 15/32	1 3/4	0.689	2 9/16	NCT207-22E NCT207E NCT207-23E	T207E	NC207-22 NC207 NC207-23	1.9
50	1 1/2	1 15/16	11/16	1 5/16	4 1/2	4	3 9/32	5 21/32	3 15/32	5/8	3 9/32	1 5/32	3/4	1 15/16	2	0.748	2 11/16	NCT208-24E NCT208E	T208E	NC208-24 NC208	2.9
	1 5/8	1 15/16	11/16	1 3/8	4 19/32	4	3 9/32	5 21/32	3 7/16	5/8	3 9/32	1 5/32	3/4	1 15/16	2	0.748	2 13/16	NCT208-24E NCT208E	T208E	NC208-24 NC208	2.9
45	1 11/16	1 15/16	11/16	1 3/8	4 19/32	4	3 9/32	5 21/32	3 7/16	5/8	3 9/32	1 5/32	3/4	1 15/16	2	0.748	2 15/16	NCT209-26E	T209E	NC209-26	2.8
	1 3/4	1 15/16	11/16	1 3/8	4 19/32	4	3 9/32	5 21/32	3 7/16	5/8	3 9/32	1 5/32	3/4	1 15/16	2	0.748	2 15/16	NCT209-27E NCT209-28E NCT209E	T209E	NC209-27 NC209-28 NC209	2.8
50	1 15/16	1 15/16	11/16	1 5/16	4 19/32	4	3 9/32	5 7/8	3 17/32	5/8	3 3/8	1 5/32	3/4	1 15/16	2 3/32	0.748	3 3/8	NCT210-31E NCT210E NCT210-32E	T210E	NC210-31 NC210 NC210-32	3.2
	2	1 15/16	11/16	1 5/16	4 19/32	4	3 9/32	5 7/8	3 17/32	5/8	3 3/8	1 5/32	3/4	1 15/16	2 3/32	0.748	3 3/8	NCT210-31E NCT210E NCT210-32E	T210E	NC210-31 NC210 NC210-32	3.2
55	2	2 17/32	1 1/16	1 1/2	5 3/4	5 1/8	4 1/32	6 23/32	4 3/16	3/4	3 3/4	1 3/8	31/32	2 17/32	2 1/4	0.874	3 1/2	NCT211-32E	T211E	NC211-32	4.4
	2 3/16	2 17/32	1 1/16	1 1/2	5 3/4	5 1/8	4 1/32	6 23/32	4 3/16	3/4	3 3/4	1 3/8	31/32	2 17/32	2 1/4	0.874	3 5/8	NCT211E NCT211-35E	T211E	NC211 NC211-35	4.4
60	2 1/4	2 17/32	1 1/16	1 21/32	5 3/4	5 1/8	4 1/32	7 5/8	4 11/16	3/4	4 1/32	1 3/8	1 1/4	2 17/32	2 5/8	1.000	4 1/16	NCT212-36E	T212E	NC212-36	5.6
	2 7/16	2 17/32	1 1/16	1 21/32	5 3/4	5 1/8	4 1/32	7 5/8	4 11/16	3/4	4 1/32	1 3/8	1 1/4	2 17/32	2 5/8	1.000	4 1/8	NCT212E NCT212-39E	T212E	NC212 NC212-39	5.6



**Ball bearing inserts NU-LOC**  
**NC**  
**Cylindrical bore (with concentric locking collar)**  
*d* 20 ~ 60 mm

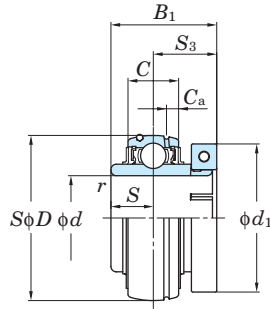

Shaft Dia mm inch	Dimensions inch mm				Basic Load Ratings kN		Factor <i>f</i> <sub>0</sub>	Bearing No.	Collar No.	Dimensions inch mm				Cap screw inch mm	Mass kg							
	<i>d</i>	<i>D</i>	<i>B</i> <sub>1</sub>	<i>C</i>	<i>r</i>	<i>C</i> <sub>r</sub>				<i>C</i> <sub>or</sub>	<i>C</i> <sub>a</sub>	<i>S</i>	<i>S</i> <sub>3</sub>			<i>d</i> <sub>1</sub>						
20 <sup>3/4</sup>	1.850	1.280	0.630	0.039	12.8	6.65	13.2	NC204-12 NC204	UCL204B UCL204B	0.157	0.500	0.780	1.752	No.8-32UNC M4×0.7	0.30							
	47	32.5	16	1						4	12.7	19.8	44.5									
25 <sup>7/8</sup> <sup>15/16</sup> 1	2.047	1.437	0.669	0.039	14.0	7.85	13.9	NC205-14 NC205-15 NC205 NC205-16	UCL205A UCL205A UCL205A UCL205A	0.197	0.563	0.874	1.937	No.8-32UNC No.8-32UNC M4×0.7 No.8-32UNC	0.40							
	52	36.5	17	1						5	14.3	22.2	49.2									
	2.441	1.563	0.748	0.039						19.5	11.3	13.9	NC206-18 NC206 NC206-19 NC206-20			UCL206A UCL206A UCL206A UCL206A	0.197	0.626	0.937	2.189	No.8-32UNC No.8-32UNC M4×0.7 No.8-32UNC	0.50
	62	39.7	19	1													5	15.9	23.8	55.6		
30 <sup>1 3/16</sup> <sup>1 1/4</sup>	2.835	1.752	0.787	0.043	25.7	15.4	13.9	NC207-20 NC207-22 NC207 NC207-23	UCL207A UCL207B UCL207B UCL207B	0.217	0.689	1.063	2.437	No.10-24UNC No.10-24UNC M5×0.8 No.10-24UNC	0.80							
	72	44.5	20	1.1						5.5	17.5	27	61.9									
	2.835	1.752	0.787	0.043						29.1	17.8	14.0	NC208-24 NC208			UCL208A UCL208A	0.236	0.748	1.252	2.689	No.10-24UNC M5×0.8	1.0
	72	44.5	20	1.1													5.5	17.5	27	65.1		
35 <sup>1 1/4</sup> <sup>1 3/8</sup> <sup>1 7/16</sup>	3.150	2.000	0.827	0.043	34.1	21.3	14.0	NC209-26 NC209-27 NC209-28 NC209	UCL209A UCL209B UCL209B UCL209B	0.236	0.748	1.252	2.811	No.10-24UNC No.10-24UNC M5×0.8 No.10-24UNC	1.1							
	85	50.8	22	1.1						6	19	31.8	71.4									
	3.346	2.000	0.866	0.043						35.1	23.3	14.4	NC210-31 NC210 NC210-32			UCL210A UCL210A UCL210A	0.236	0.748	1.343	3.374	1/4-20UNC M6×1 1/4-20UNC	1.4
	85	50.8	22	1.1													6	19	31.8	74.6		
40 <sup>1 5/8</sup> <sup>1 11/16</sup> <sup>1 3/4</sup>	3.543	2.091	0.945	0.043	43.4	29.4	14.4	NC211-32 NC211 NC211-35	UCL211A UCL211B UCL211B	0.276	0.874	1.374	3.500	1/4-20UNC M6×1 1/4-20UNC	1.5							
	90	53.1	24	1.1						7	22.2	34.9	88.9									
	3.937	2.248	0.984	0.059						52.4	36.2	14.4	NC212-36 NC212			UCL212A UCL212B	0.295	1.000	1.626	4.063	5/16-18UNC M8×1.25	2.2
	110	66.7	27	1.5													7.5	25.4	41.3	103.2		
50 <sup>1 15/16</sup> 2	3.937	2.248	0.984	0.059	52.4	36.2	14.4	NC212-39 NC212-39	UCL213B	0.295	1.000	1.626	4.126	5/16-18UNC	2.2							
	110	66.7	27	1.5						7.5	25.4	41.3	104.8									



**Ball bearing inserts NU-LOC**  
**ERC**  
**Cylindrical bore (with concentric locking collar)**  
*d* 20 ~ 60 mm

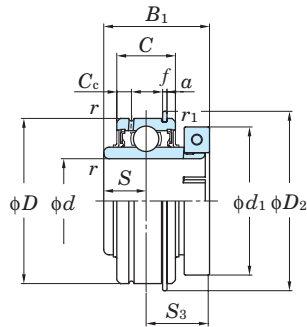

Shaft Dia mm inch <i>d</i>	Dimensions															Bearing No.	Mass kg	
	<i>D</i>		<i>C</i>		<i>r</i>	<i>r</i> <sub>1</sub> (min)		<i>C</i> <sub>c</sub>		<i>a</i>		<i>f</i>		<i>D</i> <sub>2</sub>				
	mm	inch	mm	inch	mm	inch	mm	inch	mm	inch	mm	inch	mm	inch	mm	inch		
20 <sup>3</sup> / <sub>4</sub>	47	1.850	16	0.630	1	0.039	0.5	0.020	4	0.157	2.38	0.094	1.07	0.042	52.5	2.067	ERC204-12 ERC204	0.36
25 <sup>7</sup> / <sub>8</sub> <sup>15</sup> / <sub>16</sub>	52	2.047	19	0.748	1	0.039	0.5	0.020	5	0.197	2.38	0.094	1.07	0.042	57.7	2.272	ERC205-14 ERC205-15 ERC205 ERC205-16	0.47
30 <sup>1</sup> / <sub>8</sub> <sup>1</sup> / <sub>16</sub> <sup>1</sup> / <sub>4</sub>	62	2.441	22	0.866	1	0.039	0.5	0.020	5.5	0.217	3.18	0.125	1.65	0.065	67.5	2.657	ERC206-18 ERC206 ERC206-19 ERC206-20	0.57
35 <sup>1</sup> / <sub>4</sub> <sup>1</sup> / <sub>8</sub> <sup>1</sup> / <sub>16</sub>	72	2.835	24	0.945	1.1	0.043	0.5	0.020	5.5	0.217	3.18	0.125	1.65	0.065	78.4	3.087	ERC207-20	0.95
	72	2.835	24	0.945	1.1	0.043	0.5	0.020	5.5	0.217	3.18	0.125	1.65	0.065	78.4	3.087	ERC207-22 ERC207 ERC207-23	0.95
	80	3.150	28	1.102	1.1	0.043	0.5	0.020	6	0.236	3.18	0.125	1.65	0.065	86.4	3.402	ERC208-24 ERC208	1.2
45 <sup>1</sup> / <sub>8</sub> <sup>1</sup> / <sub>16</sub> <sup>3</sup> / <sub>4</sub>	85	3.346	28	1.102	1.1	0.043	0.5	0.020	6	0.236	3.18	0.125	1.65	0.065	91.4	3.598	ERC209-26	1.3
	85	3.346	28	1.102	1.1	0.043	0.5	0.020	6	0.236	3.18	0.125	1.65	0.065	91.4	3.598	ERC209-27 ERC209-28 ERC209	1.3
	90	3.543	28	1.102	1.1	0.043	0.5	0.020	7.5	0.295	3.18	0.125	2.41	0.095	96.3	3.791	ERC210-31 ERC210 ERC210-32	1.6
55 2 <sup>2</sup> / <sub>16</sub>	100	3.937	30	1.181	1.5	0.059	0.5	0.020	7.5	0.295	3.18	0.125	2.41	0.095	106.3	4.185	ERC211-32	1.8
	100	3.937	30	1.181	1.5	0.059	0.5	0.020	7.5	0.295	3.18	0.125	2.41	0.095	106.3	4.185	ERC211 ERC211-35	1.8
60 <sup>2</sup> / <sub>4</sub> <sup>2</sup> / <sub>16</sub>	110	4.331	32	1.260	1.5	0.059	0.5	0.020	7.5	0.295	3.18	0.125	2.41	0.095	116.4	4.583	ERC212-36 ERC212	2.5
																	ERC212-39	

Note : See NC insert series for additional dimensions.

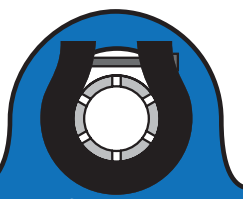



### NU Concentric Cap Screw Tightening Torque

Shaft Dia mm inch <i>d</i>	Bearing No.	Collar No.	Cap screw  inch mm	Recommended Torque		
				Foot · Lbs.	Inch · Lbs.	N · m
20	3/4 NU204-12 NU204	UCL204B UCL204B	No. 8-32UNC M4×0.7	5.5 – 6.0	66 – 73	7.4 – 8.2
25	7/8 15/16 1 NU205-14 NU205-15 NU205 NU205-16	UCL205A UCL205A UCL205A UCL205A	No. 8-32UNC No. 8-32UNC M4×0.7 No. 8-32UNC			
30	1 1/8 1 3/16 1 1/4 NU206-18 NU206 NU206-19 NU206-20	UCL206A UCL206A UCL206A UCL206A	No. 8-32UNC M4×0.7 No. 8-32UNC No. 8-32UNC			
35	1 1/4 1 3/8 1 7/16 NU207-20 NU207-22 NU207 NU207-23	UCL207A UCL207B UCL207B UCL207B	No. 10-24UNC No. 10-24UNC M5×0.8 No. 10-24UNC	7.5 – 8.3	90 – 99	10.2 – 11.2
40	1 1/2 NU208-24 NU208	UCL208A UCL208A	No. 10-24UNC M5×0.8			
45	1 5/8 1 11/16 1 3/4 NU209-26 NU209-27 NU209-28 NU209	UCL209A UCL209B UCL209B UCL209B	No. 10-24UNC No. 10-24UNC M5×0.8			
50	1 15/16 2 2 NU210-31 NU210 NU210-32 NU211-32	UCL210A UCL210A UCL210A UCL211A	1/4-20UNC M6×1 1/4-20UNC 1/4-20UNC	13.0 – 14.3	155 – 172	17.6 – 19.4
55	2 3/16 2 1/4 2 7/16 NU211 NU211-35 NU212-36 NU212 NU212-39	UCL211B UCL211B UCL212A UCL212B UCL213B	M6×1 1/4-20UNC 5/16-18UNC M8×1.25 5/16-18UNC			
60	2 1/4 2 7/16 NU212-36 NU212 NU212-39	UCL212A UCL212B UCL213B	5/16-18UNC M8×1.25 5/16-18UNC	30.7 – 33.9	368 – 407	41.6 – 46.0

## NIPPON PILLOW BLOCK CO., LTD.

### HEAD OFFICE/Main Plant

2306 Hirao Miharaku Sakai Osaka 587-0022 JAPAN  
 TEL: 072-361-3752 FAX: 072-361-4173 E-mail: info@fyhbearings.com

**SALES** E-mail: exports@fyh.co.jp

### FYH BEARING UNITS USA INC.

13201 FYH Drive Huntley, Illinois 60142, USA  
 TEL: 847-487-9111 FAX: 847-487-9222 E-mail: sales@fyhusa.com

