

IRIMO

4. Vasos

Vasos impacto 1"

VASOS 1" HEX

1"
25 mm

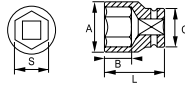

VASOS 1" HEX, SERIE LARGA

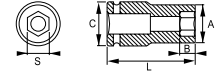

- UNE 16507
- ISO 2725
- DIN 3129

| R | Q | P | S mm | A mm | B mm | C mm | L mm | g |
|----------|---|----|------|------|------|------|------|---|
| 177-22-2 | 1 | 22 | 39 | 22 | 54 | 58 | 645 | |
| 177-24-2 | 1 | 24 | 41 | 22 | 54 | 58 | 650 | |
| 177-27-2 | 1 | 27 | 46 | 22 | 54 | 58 | 670 | |
| 177-30-2 | 1 | 30 | 49 | 24 | 54 | 62 | 680 | |
| 177-32-2 | 1 | 32 | 52 | 24 | 54 | 62 | 695 | |
| 177-33-2 | 1 | 33 | 54 | 24 | 54 | 62 | 695 | |
| 177-34-2 | 1 | 34 | 54 | 24 | 54 | 62 | 720 | |
| 177-36-2 | 1 | 36 | 56 | 29 | 54 | 65 | 800 | |
| 177-38-2 | 1 | 38 | 58 | 29 | 54 | 65 | 845 | |
| 177-41-2 | 1 | 41 | 61 | 34 | 54 | 70 | 920 | |
| 177-42-2 | 1 | 42 | 64 | 34 | 54 | 70 | 950 | |
| 177-46-2 | 1 | 46 | 68 | 36 | 54 | 75 | 1150 | |
| 177-50-2 | 1 | 50 | 73 | 36 | 54 | 75 | 1375 | |
| 177-55-2 | 1 | 55 | 79 | 44 | 54 | 83 | 1540 | |
| 177-60-2 | 1 | 60 | 86 | 47 | 54 | 87 | 1700 | |
| 177-65-2 | 1 | 65 | 92 | 47 | 54 | 90 | 1940 | |
| 177-70-2 | 1 | 70 | 97 | 47 | 54 | 93 | 2450 | |
| 177-75-2 | 1 | 75 | 104 | 47 | 86 | 95 | 2900 | |
| 177-80-2 | 1 | 80 | 110 | 39 | 86 | 100 | 3300 | |

| R | Q | P | S mm | A mm | B mm | C mm | L mm | g |
|----------|---|----|------|------|------|------|------|---|
| 178-22-2 | 1 | 22 | 39 | 23 | 54 | 90 | 975 | |
| 178-24-2 | 1 | 24 | 42 | 23 | 54 | 90 | 1016 | |
| 178-27-2 | 1 | 27 | 46 | 23 | 54 | 90 | 1134 | |
| 178-30-2 | 1 | 30 | 49 | 24 | 54 | 90 | 1256 | |
| 178-32-2 | 1 | 32 | 52 | 24 | 54 | 90 | 1297 | |
| 178-33-2 | 1 | 33 | 54 | 24 | 54 | 92 | 1311 | |
| 178-34-2 | 1 | 34 | 54 | 24 | 54 | 92 | 1350 | |
| 178-36-2 | 1 | 36 | 56 | 29 | 54 | 92 | 1474 | |
| 178-38-2 | 1 | 38 | 58 | 29 | 54 | 92 | 1479 | |
| 178-41-2 | 1 | 41 | 61 | 34 | 54 | 92 | 1533 | |
| 178-46-2 | 1 | 46 | 68 | 36 | 54 | 95 | 1710 | |
| 178-50-2 | 1 | 50 | 73 | 36 | 54 | 95 | 1896 | |
| 178-55-2 | 1 | 55 | 79 | 44 | 54 | 100 | 2155 | |
| 178-60-2 | 1 | 60 | 86 | 47 | 54 | 100 | 2372 | |

JUEGO EN CAJA METÁLICA
177-10-5



| R | Q | P | g |
|----------|---|---|-------------------------------|
| 177-10-5 | 1 | 7 | 24, 27, 30, 32, 33, 36, 38 mm |

4. Vasos



Accesorios 1"

ALARGADERAS

1"
25 mm

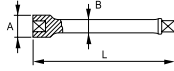

- DIN16503
- ISO1174

| Q | Icon | L mm | A mm | B mm | g |
|----------|------|------|------|------|------|
| 179-00-2 | 1 | 125 | 54 | 34 | 1085 |
| 179-01-2 | 1 | 175 | 54 | 34 | 1390 |
| 179-02-2 | 1 | 325 | 54 | 34 | 2395 |

ANILLAS DE SEGURIDAD



- Anillas de seguridad 1"

| Q | Icon | Q | Q | Q | g |
|--------|------|----|-------|-------|----|
| 179931 | 1 | 1" | 19-70 | 17-27 | 9 |
| 179941 | 1 | 1" | 75-80 | | 13 |

REDUCTOR

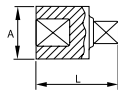

- Reductor de 1" a 3/4"
- DIN16503
- ISO1174
- Dadas las condiciones especiales de este producto, no está garantizado contra la rotura del cuadrado macho

| Q | Icon | A mm | L mm | g |
|----------|------|------|------|-----|
| 179-65-2 | 1 | 54 | 70 | 350 |

JUNTA CARDAN

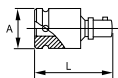

- DIN16503
- ISO1174

| Q | Icon | A mm | L mm | g |
|----------|------|------|------|-----|
| 179-52-2 | 1 | 54 | 120 | 650 |

