



JWTS[®] Sprockets

The form of the Sprockets is determined by the following factors: type of chain, the number of teeth, the torque to be transmitted and the application. A distinction is drawn between sprockets and chain plate wheels for roller chains according to Norm (e.g. DIN 8187/8188) and special versions. Sprockets with hub allow the transmission of a higher torque, whereas plate wheels may be used only for the transmission of small torques. For a detailed instruction regarding design and construction of sprockets and plate wheels, please view of our iwis chain engineering hand book.





iwis® sprockets and plate wheels

according to DIN 8187-1, ISO 606: 2004

DIN ISO no. Simplex roller chain Duplex roller chain Triplex roller chain

AVAILABLE SPROCKETS AND PLATE WHEELS

04	•	-	-
05 B	•	•	-
06 B	•	•	•
08 B	•	•	•
10 B	•	•	•
12 B	•	•	•
16 B	•	•	•
20 B	•	•	•
24 B	•	•	•
28 B	•	•	•
32 B	•	•	•

The iwis sprocket and plate wheel program will be supplied either directly from Munich or alternately from our sister company Flexon in Wilnsdorf.

For more detailed information about our complete sprocket program, please take note of the catalogue "Sprockets" of our sister company.



FURTHER AVAILABLE PRODUCTS:

- Taper bush for sprockets
- Chain tensioning wheel complete with ball bearing - ready for installing
- Sprockets for taper bush
- Sliding hub range, series DA
- Sliding hub range, series FT
- Elite sliding clutches, series FT
- Shaft coupling by chain coupling

ON REQUEST WE MANUFACTURE AND DELIVER:

- Special plate wheels according to customer drawings and specifications
- Complete mounted modules existing of chain sprockets, pulleys, bearings and shafts
- Not only prototypes, but also as series produced types in large quantities (project specific)

Attainable materials:

- Case hardened steels (hardened/not hardened)
- Tempering steels (hardened/not hardened)
- Stainless steels
- Plastic

Coating:

- all types possible

Please contact our qualified Technical Service Team for support in chain engineering and the design of chain drives. They will happily assist you.



Chain guides

Examples of plastic chain guides alternatively with steel C-profile

GL 1a

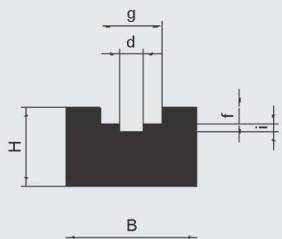

GL 1b 2-parts

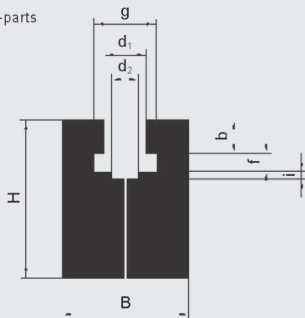

GR 1

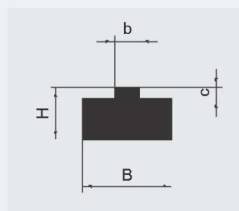

GR 2

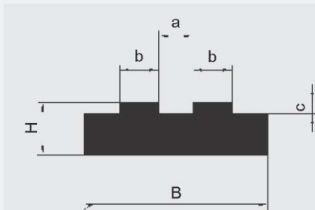

GR 3

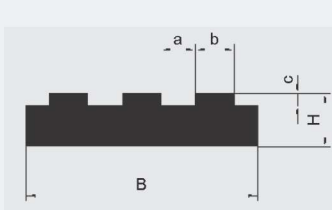

GL 1a-c

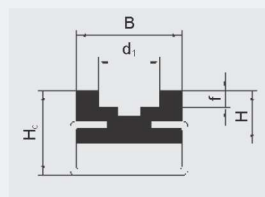

GL 1b-c 2-parts

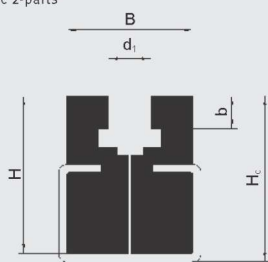

GL 1b-c covered

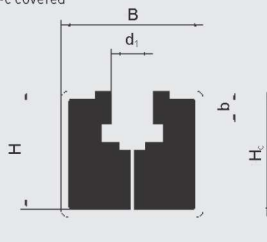

GR 1-c

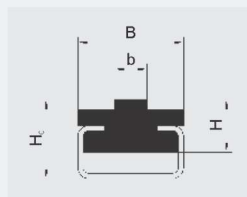

GR 2-c

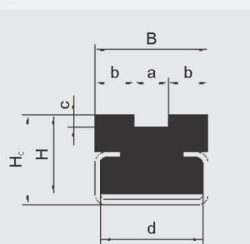

CF

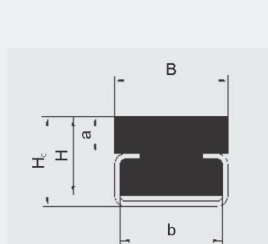

ETA

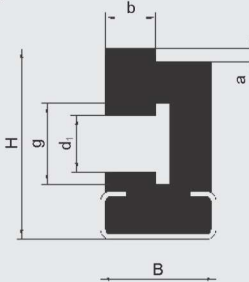

For the complete product range and technical measurements, please check the catalogue "Sprockets" of our sister company Flexon.