



HYDRAULIC HAND PUMPS



W Single acting

X Double acting

- ✓ W series pumps are for use with Single Acting cylinders.
- ✓ X series pumps are fitted with 4-way 3 position valve for use with Double Acting cylinders.
- ✓ The pump range includes single and two speed models. Two speed models provide rapid cylinder advance until contact is made with the load.
- ✓ Hydraulic port on all models is 3/8"-NPT female.
- ✓ W and X series pumps are fitted with internal safety valves to prevent overpressure.
- ✓ WP21007 and XP21007 models are foot pedal operated.
- ✓ All pumps except W00307 are fitted with handle clips for ease of carrying.

SINGLE ACTING

Model	Speeds	Usable oil	Handle effort	
LARZEP	No.	cm <sup>3</sup>	kg	
W00307	1	240	51	
W10707	1	660	49	
W20707	2	660	49	
WP21007	2	1.000	43	
W11207	1	1.200	49	
W21207	2	1.200	49	
W22307	2	2.400	49	
W24307	2	4.200	49	
W07807	2	7.500	41	

DOUBLE ACTING

Model	Speeds	Usable oil	Handle effort	
LARZEP	No.	cm <sup>3</sup>	kg	
XP21007	2	1.000	43	
X22307	2	2.400	49	
X24307	2	4.200	49	
X07807	2	7.500	41	



Performance under Pressure

HYDRAULIC HAND PUMPS



Type **W - X**

Capacity **0,24 - 7,5 litres**

Max. pressure **700 bar**

SINGLE ACTING W

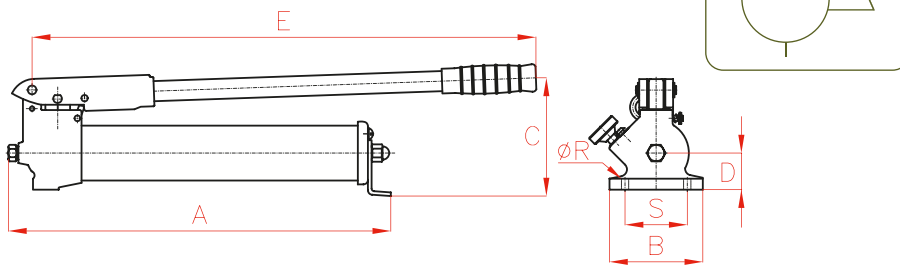

DOUBLE ACTING X

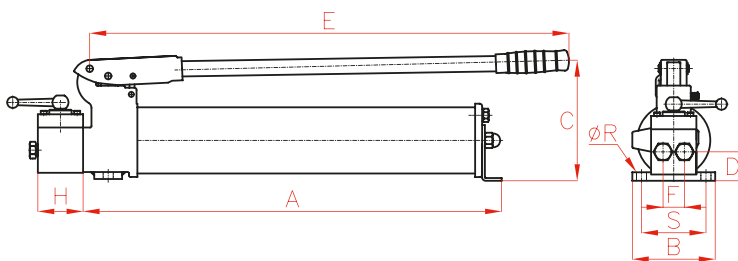

W07807 / X07807

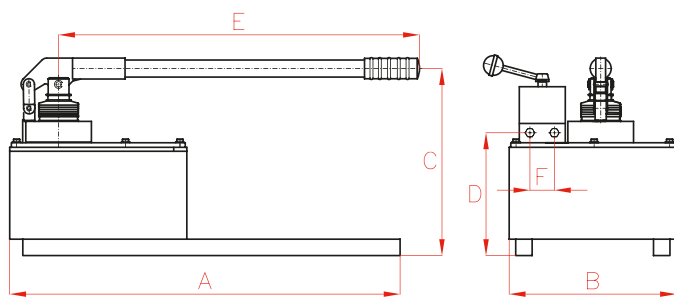

WP21007 pump, foot pedal operated.



W07807, X07807 pumps.

W - X PUMPS

Oil displacement per stroke (cm <sup>3</sup> )		Pressure rating (bar)		A	B	C	D	E	R	S	Weight	Model
1 <sup>st</sup> Stage	2 <sup>nd</sup> Stage	1 <sup>st</sup> Stage	2 <sup>nd</sup> Stage	mm	mm	mm	mm	mm	mm	mm	kg	LARZEP
-	2,2	-	700	350	100	110	25	380	-	-	2,7	W00307
-	2,6	-	700	500	100	150	40	560	-	-	5,5	W10707
8,1	2,0	20	700	500	100	150	40	560	-	-	5,5	W20707
12,0	2,0	50	700	582	189	445*	52	540	9	185	9,0	WP21007
-	2,6	-	700	545	100	175	40	560	-	-	6,5	W11207
8,1	2,0	20	700	545	100	175	40	560	-	-	6,5	W21207
13,2	2,2	20	700	560	108	210	55	560	8,5	86	12,0	W22307
16,5	2,8	20	700	570	108	210	75	560	8,5	86	20,0	W24307
120,0	4,6	10	700	610	242	250	232	643	-	-	30,0	W07807

\* with the pedal completely open

Oil displacement per stroke (cm <sup>3</sup> )		Pressure rating (bar)		A	B	C	D	E	F	H	R	S	Weight	Model
1 <sup>st</sup> Stage	2 <sup>nd</sup> Stage	1 <sup>st</sup> Stage	2 <sup>nd</sup> Stage	mm	mm	mm	mm	mm	mm	mm	mm	mm	kg	LARZEP
12,0	2,0	50	700	550	197	445*	52	540	-	-	9	185	9,0	XP21007
13,2	2,2	20	700	560	108	210	55	560	40	50	8,5	86	14	X22307
16,5	2,8	20	700	570	108	210	75	560	40	50	8,5	86	23	X24307
120,0	4,6	10	700	610	242	250	232	643	30	-	-	-	32	X07807