

Guide Rollers PK

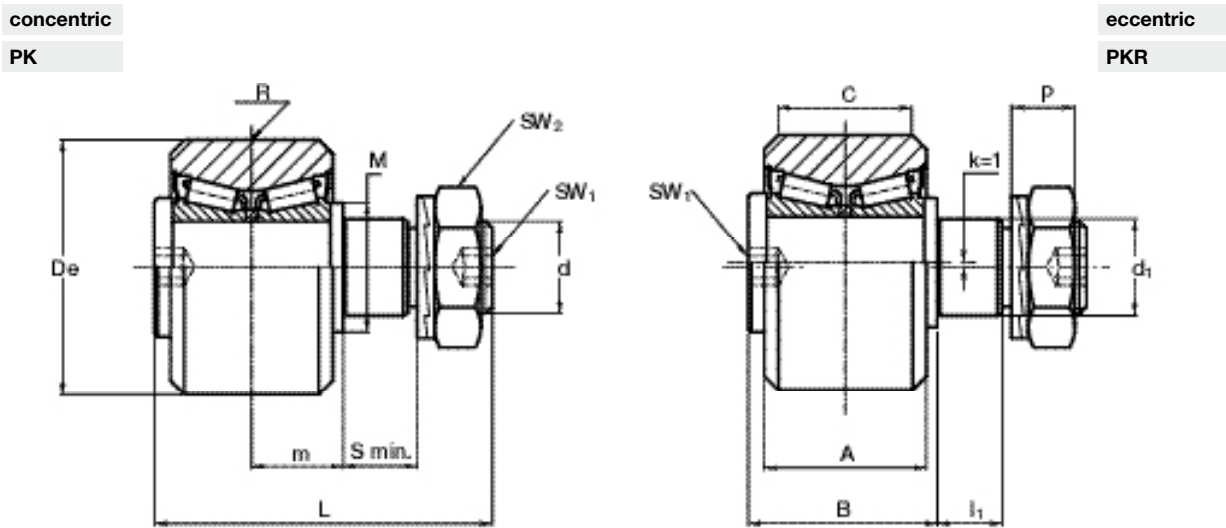

Type								Dimensions (mm)										
concentric	eccentric	De	d ₁ ⁽¹⁾	d	m	S min.	P	L	A	B	C	R	I ₁	M	SW ₁	SW ₂	k	
PK 52C	PKR 52C	52	21	M 20 x 1.5	19.8	15	13.4	73	35	41	29	800	14	28	8	ch. 30	1	
PK 62C	PKR 62C	62	27	M 24 x 1.5	20.8	19	15.4	83	37	44	29	800	18	35	10	ch. 36	1	
PK 72C	PKR 72C	72	36	M 30 x 1.5	27	19	21.6	100	45	55	33	1 200	18	44	12	ch. 46	1	
PK 90C	PKR 90C	90	38	M 36 x 1.5	30	24	24.6	115	53	56 ⁽⁵⁾	62	45	1 200	23	50	14	ch. 55	1
PK 110C	PKR 110C	110	42	M 36 x 1.5	34	33	24.6	135	60	63 ⁽⁵⁾	70	48	1 200	32	56	14	ch. 55	1

Type		Bearing rating (N)		Limit loads (N)	Torque ⁽²⁾ wrench setting (Nm)	Weight (Kg)
		Dynamic C	Static C ₀			
PK 52C	PKR 52C	36 360	44 000	11 900	80	0.6
PK 62C	PKR 62C	39 100	50 400	22 100	160	0.9
PK 72C	PKR 72C	52 820	72 000	31 300	300	1.6
PK 90C	PKR 90C	86 440	136 000	43 700	450	2.8
PK 110C	PKR 110C	127 600	195 000	55 600	450	4.9

- 1) Housing bore tolerance: H7
- 2) The torque wrench settings are given for non-lubricated threads; for lubricated threads, multiply figure by 0.8
- 3) Standard seals: material NBR, RS type
- 4) On request, the guide rollers can be supplied in AISI 440 stainless steel (suffix **NX**) and with Viton seals for operating temperatures up to 120 °C (suffix **V**, up to dimension PK 90 C included)
- 5) Dimensions relating to the stainless-steel rollers (suffix **NX**)
- 6) The guide rollers are complete with self-locking washers and hexagonal nut for fitting

Guide Wheels FK

FK

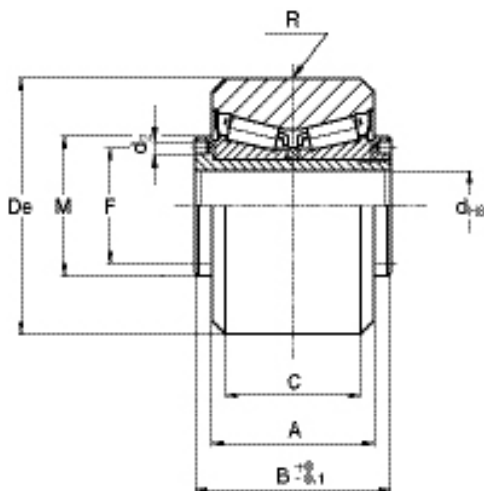

Type	Dimensions (mm)								
	De	d	A	B	C	R	F	d ₂	M
FK 52C	52	15	35	42	29	800	25	2.5	30
FK 62C	62	20	37	45	29	800	29	3	35
FK 72C	72	25	45	56	33	1 200	37	4.0	44
FK 90C	90	28	56 ⁽³⁾	64	45	1 200	42	4	49
FK 110C	110	35	63 ⁽³⁾	72	48	1 200	52	4.0	59

Type	Bearing rating (N)		Weight (kg)
	Dynamic C	Static radial C ₀	
FK 52C	36 360	44 000	0.5
FK 62C	39 100	50 400	0.6
FK 72C	52 820	72 000	1.2
FK 90C	86 440	136 000	2.3
FK 110C	127 600	195 200	3.9

- 1) Standard seals: material NBR, RS type
- 2) On request, the guide rollers can be supplied in AISI 440 stainless steel (suffix **NX**) and with Viton seals for operating temperatures up to 120 °C (suffix **V**, up to dimension FK 90 C included)
- 3) Dimensions relating to the stainless-steel rollers (suffix **NX**)
- 4) To prevent rotation between roller and shaft a pin can be fitted in one of the holes “d₂” positioned in the side flange