

Special options

CYLINDERS

SPECIAL OPTIONS TABLE FOR CYLINDERS

| | C | U | AU | P | AP | X-XT | XL | AX | CX-CXL | CPU | BX | ABX | BU | B | BG | CPA | WR | Z | HB |
|------|---|-------------|-------------|-------------|-------------|-------------|-------------|-------------|-------------|-------------|-------------|-------------|-------------|-------------|----|-------------|-------------|---|-------------|
| S | | | | | | | | | | | | | | | | | | | |
| S0 | | | | | | | | | | | | | | | | | | | |
| S2 | | | | | | | | | | | | | | | | | | | |
| S3 | | | | | | | | | | | As standard | As standard | As standard | As standard | | | | | |
| S4 | | | | | | | | As standard | | | As standard | | | | | | | | |
| S5 | | | | | | As standard | As standard | As standard | | As standard | | | | | | As standard | As standard | | |
| S6 | | | | | | | | | | | | | | | | | | | |
| S8 | | | | | | | | | | | | | | | | | | | |
| S9 | | As standard | As standard | As standard | As standard | As standard | As standard | As standard | As standard | As standard | As standard | As standard | As standard | As standard | | | | | |
| S10 | | As standard | As standard | As standard | As standard | | | | | | As standard | As standard | As standard | As standard | | | | | As standard |
| S10A | | | | | | | | | | | | | | | | | | | |
| S10B | | | | | | | | | | | | | | | | | | | |
| S12 | | | | | | | | | | | | | | | | | | | |
| S14 | | | | | | | | | As standard | As standard | | | | | | | | | |
| S15A | | | | | | | | | As standard | | | | | | | | | | |
| S15B | | | | | | | | | As standard | | | | | | | | | | |

Feasible Not feasible

- S - WAIRCOM M.B.S. drawing
- S0 - Metallic scraper
- S2 - Scraper ring for high temperatures (for U series supplied from Ø 12 to Ø 25)
- S3 - Female threaded piston rod (AF=1,5KF)
- S4 - End caps screws, nuts and tie rods made of stainless steel
- S5 - Female threaded tie rods
- S6 - Completed threaded and galvanized tie rods
- S8 - Through rod with different piston rod for side "B" and/or "C"
- S9 - Piston rod with plane working for key
- S10 - Without cushioning (aluminium piston only)
- S10A - With front cushioning (aluminium piston only)
- S10B - With rear cushioning (aluminium piston only)
- S12 - Single acting with bidirectional piston seal
- S14 - Round tube with external tie rods to mount XT/CT Ø and XT/CPU/CT Ø
- S15A - Front protruding tie rods (for option S14)
- S15B - Rear protruding tie rods (for option S14)

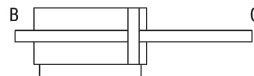
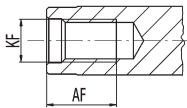

| Ø Piston rod | 10 | 12 | 16 | 20 | 25 | 32 | 40 | 50 | 63 |
|--------------|----|----|-----|-----|-----|-----|-----|-----|-----|
| KF | M6 | M8 | M10 | M12 | M16 | M16 | M20 | M24 | M30 |

Example: Cylinder to ISO 15552 standards Ø 63, through rod, 150 mm stroke, magnetic piston type with different piston rod on side "B" with dimensions: KK=M20x1,5 AM=45 and WH=60: 63R150 XT/M S8 B KK=M20x1,5 AM=45 WH=60