

## HCBB-W

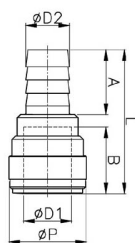

RACOR PARA TUBO A ESPIGA ACANALADA  
- Barb connector

REFERENCIA	ØD1	ØD2	ØP	L	A	B	Peso Weight(g)
HCBB1210W	12	10	23	46,9	20	24,7	8,5
HCBB15-1/2W	15	1/2	28	54,2	22,3	29,4	14

## HCP

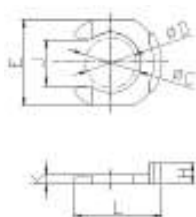

CLIP DE BLOQUEO  
- Locking clip

REFERENCIA	ØD	ØC	E	L	H	J	K	Peso Weight(g)
HCP04-5/32BK	04-5/32	6,2	10,2	11,0	2,8	4,3	1,1	0,09
HCP05-3/16BK	05-3/16	6,2	10,2	11,0	2,8	4,3	1,1	0,09
HCP06-1/4BK	06-1/4	8,0	11,6	11,6	3,1	6,4	1,3	0,12
HCP08-5/16BK	08-5/16	9,6	13,5	13,9	3,3	7,3	1,4	0,16
HCP10-3/8BK	010-3/8	11,8	16,0	16,4	3,4	9,2	1,4	0,23
HCP12-1/2BK	012-1/2	14,4	19,0	19,0	3,6	11,1	1,4	0,3
HCP15BL	15	17,0	22,5	22,6	3,6	13,1	1,4	0,45

\* GR= Gris, BK= Negro, RO= Rojo, BL=Azul.

## HUFF

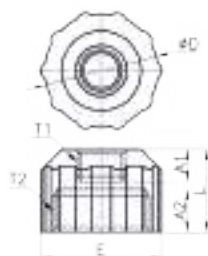

REDUCCIÓN CON ROSCA CILÍNDRICA BSPP CON JUNTA PLANA  
- Threaded reducer BSPP with internal oring

REFERENCIA	T1	T2	ØD	A1	A2	L	E	Peso Weight(g)
HUFF-G02-G06G	1/4	3/4	31,5	9,5	12,0	23,0	33,5	15,6
HUFF-G03-G06G	3/8	3/4	31,5	9,5	12,0	23,0	33,5	14,5

## HCVU

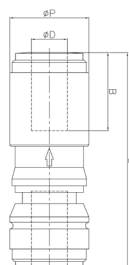
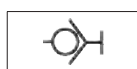

VÁLVULA ANTIRRETORNO  
- Check valve

REFERENCIA	ØD	ØP	E	L	Peso Weight(g)
HCVU0606B	6	15,5	16,1	45,5	7,5
HCVU0808B	8	17,6	48,6	17,5	10,0
HCVU1010B	10	20,0	57,6	19,4	14,5
HCVU1212B	12	23,6	67,5	23,9	22,1

## HBVU

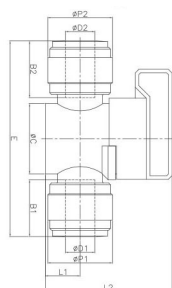

VÁLVULA MANUAL DE 2 VÍAS  
- 2 ways manual hand valve

REFERENCIA	ØD1	ØD2	B1	B2	ØP1	ØP2	L1	L2	E	C	Peso Weight(g)
HBVU0606B	6	6	16,1	16,1	15,5	15,5	9,5	34,5	51,7	19,2	16,0
HBVU0808B	8	8	17,5	17,5	17,6	17,6	9,5	34,5	53,5	19,2	17,4
HBVU1010B	10	10	20,1	20,1	20,0	20,0	12,5	42,3	63,0	24,2	29,0
HBVU1212B	12	12	23,7	23,7	23,0	23,0	12,5	42,3	70,4	24,2	35,4