

THRUST BEARINGS

double direction ball, cylindrical and tapered rollers

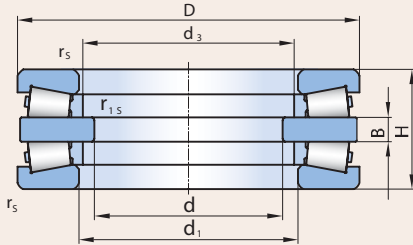

Pict. 1

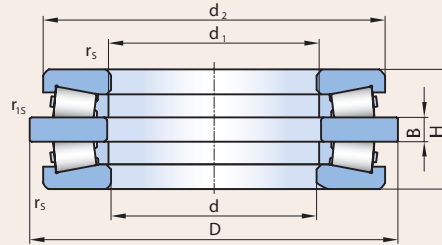

Pict. 2

Dimensions									Basic Load Ratings		Limited Speed for Lubrication		Bearing Designation	Weight	Pict.
d	D	H	d ₁	d ₂	d ₃	B	r _s	r _{1s}	C _r dyn.	C _{or} stat.	with		PSL	[kg]	
[mm]									[kN]		grease	oil			
260	360	92	285		276	20	2.1	2.1	607	2600	280	710	PSL 911-2	30	1
385	649.91	240	443.5		436	66	5	3	3220	15800	320	450	PSL 912-302	330	1
390	540	150	440		438	50	3.5	3.5	1210	7360	380	530	PSL 912-11	94	1
630	850	264	675.8		690	70	8	5	4060	18100	110	160	PSL 912-17	385	3
852	1080	230	852	1000		70	5	5	3350	21000	120	170	PSL 912-14	419	2
864	1028	110	951.2	1015.5	895	28			540	4290	120	170	PSL 212-27	104	4

double direction angular contact ball

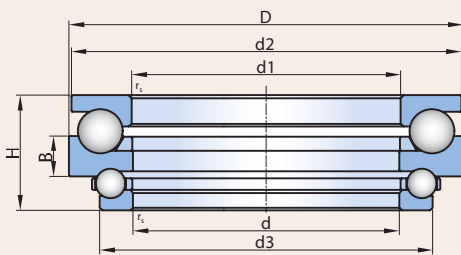

Pict. 1

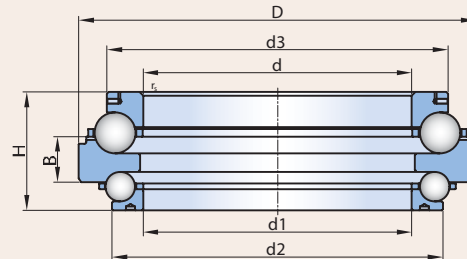

Pict. 2

Dimensions								Basic Load Ratings		Bearing Designation	Weight	Pict.
d	D	H	d ₁	d ₂	d ₃	B	r _s	C _r dyn.	C _{or} stat.	PSL	[kg]	
[mm]								[kN]				
507.949	742.95	170.3	507.949	679.45	587.38	63.5	6x45°	841/447	5110/2200	PSL 212-310	192	2
786.917	1006.22	197.74	792	999.24	901.7	69.85	5x45°	804/1166	5550/8230	PSL 212-302	320	1
808.02	1066.67	193.08	822.32	944.56	908.05	88.95	4x45°	742/1303	4890/9367	PSL 212-303	310	1
1041.02	1260.348	200	1046.1	1254	1155.7	70	5.5x45°	823/1222	6536/9471	PSL 212-304	340	1
1049.35	1269.873	202.677	1050.087	1155.7	1173.16	77.8	6.35x45°	586/1233	3873/10024	PSL 212-305	372	2
1371.6	1597.025	247.65	1374.775	1536.7	1489.075	104.775	5x45°	871/1526	7928/14945	PSL 212-317	610	1

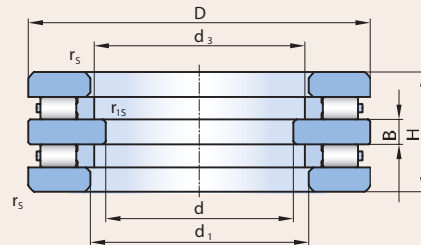

Pict. 3

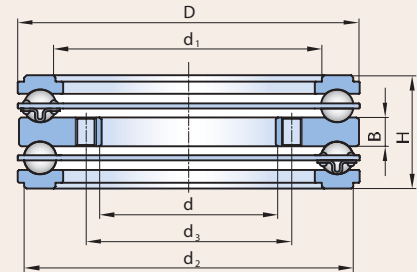

Pict. 4

Double direction cylindrical roller thrust bearings, double direction tapered roller thrust bearings and thrust ball bearings are suitable for accommodating high axial forces (e.g. rolling mill arrangements), as well as also in arrangements where high rigidity in the axial direction is required (e. g. vertical lathe tables).

Axial equivalent load

- dynamic: $P_a = F_a$ [kN]
- static: $P_{0a} = F_a$ [kN]