

RACCORDS BICÔNES TOUT LAITON SÉRIE R.M.P.
BRASS COMPRESSION FITTINGS SERIE R.M.P.

BFL

BOUCHON SIX PANS CREUX GAZ CONIQUE

Plug with hexagon embedded (BSPT)

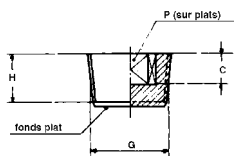

L : Laiton
brass

Conforme à la norme DIN 906
According to standard DIN 906

| Référence | C | H | P | G | Sachet |
|-----------|---|----|----|-----|--------|
| BFL 00 10 | 4 | 8 | 5 | 1/8 | 10 |
| BFL 00 13 | 5 | 10 | 7 | 1/4 | 10 |
| BFL 00 17 | 5 | 10 | 8 | 3/8 | 10 |
| BFL 00 21 | 5 | 10 | 10 | 1/2 | 10 |
| BFL 00 27 | 6 | 12 | 12 | 3/4 | 10 |

BFL

BOUCHON SIX PANS CREUX NPT

Plug with hexagon embedded NPT

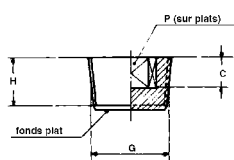

L : Laiton
brass

| Référence | C | H | P | B | Sachet |
|------------|---|----|----|-----|--------|
| BFL 79 10* | 4 | 8 | 5 | 1/8 | 10 |
| BFL 79 13* | 5 | 10 | 7 | 1/4 | 10 |
| BFL 79 17* | 5 | 10 | 8 | 3/8 | 10 |
| BFL 79 21* | 5 | 10 | 10 | 1/2 | 10 |
| BFL 79 27* | 6 | 12 | 12 | 3/4 | 10 |

JCU

JOINT CUIVRE

Copper seal

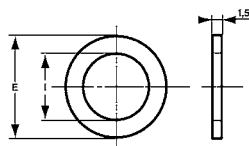

| Référence | I | E | Sachet |
|-----------|------|------|--------|
| JCU 00 08 | 8,2 | 11,2 | 20 |
| JCU 00 10 | 10,2 | 13,5 | 20 |
| JCU 00 12 | 12,2 | 17 | 20 |
| JCU 00 13 | 13,4 | 17 | 20 |
| JCU 00 14 | 14,2 | 18,5 | 20 |
| JCU 00 16 | 16,2 | 21 | 20 |
| JCU 00 17 | 17 | 21 | 20 |
| JCU 00 18 | 18,2 | 23 | 20 |
| JCU 00 20 | 20,2 | 25 | 20 |
| JCU 00 21 | 21,2 | 27 | 20 |
| JCU 00 22 | 22,2 | 27 | 20 |
| JCU 00 27 | 27,2 | 32 | 20 |
| JCU 00 33 | 33,2 | 38,8 | 20 |

009

JOINT NYLON

Nylon seal

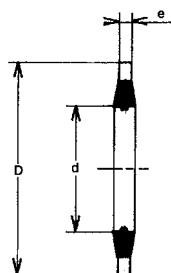

| Référence | D | d | e | Sachet |
|-----------|----|-----|-----|--------|
| 009 01 10 | 14 | 1/8 | 1 | 50 |
| 009 01 13 | 17 | 1/4 | 1 | 50 |
| 009 15 10 | 14 | 1/8 | 1,5 | 50 |
| 009 15 13 | 17 | 1/4 | 1,5 | 50 |
| 009 15 17 | 21 | 3/8 | 1,5 | 50 |
| 009 15 21 | 26 | 1/2 | 1,5 | 50 |

009

JOINT IMPERDABLE PLASTIQUE

Plastic unloosed seal

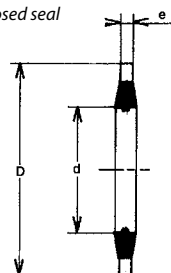

| Référence | D | d | e | Sachet |
|-----------|----|-----|-----|--------|
| 009 00 05 | 10 | M5 | 1,2 | 50 |
| 009 00 10 | 14 | 1/8 | 1,5 | 50 |
| 009 00 13 | 17 | 1/4 | 1,5 | 50 |
| 009 00 17 | 21 | 3/8 | 1,5 | 50 |
| 009 00 21 | 26 | 1/2 | 1,5 | 50 |

BI

JOINT IMPERDABLE MÉTAL-NITRILE

Metal-nitril unloosed seal

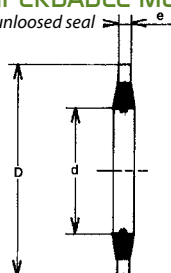

| Référence | D | d | e | Sachet |
|-----------|----|-----|-----|--------|
| BI 00 10 | 14 | 1/8 | 1 | 50 |
| BI 00 13 | 17 | 1/4 | 1 | 50 |
| BI 00 17 | 22 | 3/8 | 1,3 | 50 |
| BI 00 21 | 26 | 1/2 | 1,6 | 50 |
| BI 00 27 | 32 | 3/4 | 1,6 | 50 |
| BI 00 34 | 39 | 1" | 3,5 | 50 |

Les dimensions sont données à titre indicatif et peuvent être changées sans préavis.