

9035

RACCORDS EN T MÂLES AU CENTRE, ORIENTABLES

BSP CYLINDRIQUES

Central Tee male directional (BSPP)

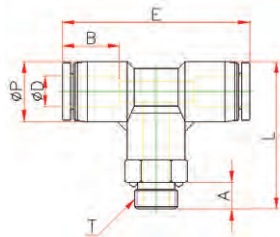

| Référence | Ø D | Ø P | T | L | E | A | B | H(Hex) | Orifice | Poids(g) | Sachet |
|------------|-----|------|---------|------|------|-----|------|--------|---------|----------|--------|
| 9035-04-05 | 4 | 10.5 | M5*0.8p | 25.7 | 37.3 | 4.0 | 14.9 | 10 | 2.0 | 10.0 | 10 |
| 9035-04-06 | 4 | 10.5 | M6*1.0p | 25.8 | 37.3 | 4.1 | 14.9 | 10 | 2.5 | 10.0 | 10 |
| 9035-04-10 | 4 | 10.5 | G 1/8 | 26.7 | 37.3 | 5.0 | 14.9 | 14 | 3.0 | 11.0 | 10 |
| 9035-04-13 | 4 | 10.5 | G 1/4 | 28.7 | 37.3 | 6.5 | 14.9 | 17 | 3.0 | 16.0 | 10 |
| 9035-04-17 | 4 | 10.5 | G 3/8 | 28.2 | 37.3 | 6.5 | 14.9 | 20 | 3.0 | 23.0 | 10 |
| 9035-06-05 | 6 | 12.5 | M5*0.8p | 28.7 | 40.7 | 4.0 | 16.4 | 12 | 2.0 | 15.0 | 10 |
| 9035-06-06 | 6 | 12.5 | M6*1.0p | 28.8 | 40.7 | 4.1 | 16.4 | 12 | 3.0 | 15.0 | 10 |
| 9035-06-10 | 6 | 12.5 | G 1/8 | 29.7 | 40.7 | 5.0 | 16.4 | 14 | 4.0 | 17.0 | 10 |
| 9035-06-13 | 6 | 12.5 | G 1/4 | 31.7 | 40.7 | 6.5 | 16.4 | 17 | 4.0 | 23.0 | 10 |
| 9035-06-17 | 6 | 12.5 | G 3/8 | 31.2 | 40.7 | 6.5 | 16.4 | 20 | 4.0 | 26.0 | 10 |
| 9035-08-10 | 8 | 14.8 | G 1/8 | 32.4 | 45.1 | 5.0 | 18.7 | 14 | 6.0 | 23.0 | 10 |
| 9035-08-13 | 8 | 14.8 | G 1/4 | 34.4 | 45.1 | 6.5 | 18.7 | 17 | 6.0 | 27.0 | 10 |
| 9035-08-17 | 8 | 14.8 | G 3/8 | 33.9 | 45.1 | 6.5 | 18.7 | 20 | 6.0 | 31.0 | 10 |
| 9035-08-21 | 8 | 14.8 | G 1/2 | 35.4 | 45.1 | 8.0 | 18.7 | 24 | 6.0 | 51.0 | 10 |
| 9035-10-10 | 10 | 17.5 | G 1/8 | 34.2 | 47.4 | 5.0 | 20.1 | 17 | 7.0 | 36.0 | 5 |
| 9035-10-13 | 10 | 17.5 | G 1/4 | 36.2 | 47.4 | 6.5 | 20.1 | 17 | 7.0 | 40.0 | 5 |
| 9035-10-17 | 10 | 17.5 | G 3/8 | 35.7 | 47.4 | 6.5 | 20.1 | 20 | 7.0 | 41.0 | 5 |
| 9035-10-21 | 10 | 17.5 | G 1/2 | 37.2 | 47.4 | 8.0 | 20.1 | 24 | 7.0 | 60.0 | 5 |
| 9035-12-13 | 12 | 20.5 | G 1/4 | 40.6 | 55.3 | 6.5 | 22.8 | 19 | 8.0 | 47.0 | 5 |
| 9035-12-17 | 12 | 20.5 | G 3/8 | 40.1 | 55.3 | 6.5 | 22.8 | 20 | 10.0 | 56.0 | 5 |
| 9035-12-21 | 12 | 20.5 | G 1/2 | 41.6 | 55.3 | 8.0 | 22.8 | 24 | 10.0 | 76.0 | 5 |
| 9035-16-17 | 16 | 25.5 | G 3/8 | 53.5 | 65.6 | 6.5 | 24.1 | 24 | 10.0 | 77.0 | 5 |
| 9035-16-21 | 16 | 25.5 | G 1/2 | 54.5 | 65.6 | 8.0 | 24.1 | 24 | 13.0 | 97.0 | 5 |

9032

RACCORDS EN T FEMELLES AU CENTRE

BSPP CYLINDRIQUES

Central Tee female directional

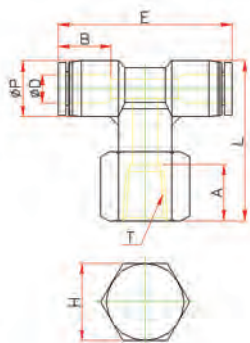

| Référence | Ø D | Ø P | T | L | E | A | B | H(Hex) | Orifice | Poids(g) | Sachet |
|------------|-----|------|-------|------|------|------|------|--------|---------|----------|--------|
| 9032-04-10 | 4 | 10.5 | G 1/8 | 27.7 | 37.3 | 9.0 | 14.9 | 14 | 3.0 | 16.0 | 10 |
| 9032-04-13 | 4 | 10.5 | G 1/4 | 29.7 | 37.3 | 11.0 | 14.9 | 17 | 3.0 | 22.0 | 10 |
| 9032-06-10 | 6 | 12.5 | G 1/8 | 30.7 | 40.7 | 9.0 | 16.4 | 14 | 4.0 | 20.0 | 10 |
| 9032-06-13 | 6 | 12.5 | G 1/4 | 32.7 | 40.7 | 11.0 | 16.4 | 17 | 4.0 | 24.0 | 10 |
| 9032-06-17 | 6 | 12.5 | G 3/8 | 33.7 | 40.7 | 12.0 | 16.4 | 22 | 4.0 | 39.0 | 10 |
| 9032-08-10 | 8 | 14.8 | G 1/8 | 33.4 | 45.1 | 9.0 | 18.7 | 14 | 6.0 | 23.0 | 10 |
| 9032-08-13 | 8 | 14.8 | G 1/4 | 35.4 | 45.1 | 11.0 | 18.7 | 17 | 6.0 | 28.0 | 10 |
| 9032-08-17 | 8 | 14.8 | G 3/8 | 36.4 | 45.1 | 12.0 | 18.7 | 22 | 6.0 | 43.0 | 10 |
| 9032-08-21 | 8 | 14.8 | G 1/2 | 38.4 | 45.1 | 14.0 | 18.7 | 24 | 6.0 | 44.0 | 5 |
| 9032-10-10 | 10 | 17.5 | G 1/8 | 37.2 | 47.4 | 9.0 | 20.1 | 17 | 7.0 | 43.0 | 5 |
| 9032-10-13 | 10 | 17.5 | G 1/4 | 37.2 | 47.4 | 11.0 | 20.1 | 17 | 7.0 | 35.0 | 5 |
| 9032-10-17 | 10 | 17.5 | G 3/8 | 38.2 | 47.4 | 12.0 | 20.1 | 22 | 7.0 | 45.0 | 5 |
| 9032-10-21 | 10 | 17.5 | G 1/2 | 40.2 | 47.4 | 14.0 | 20.1 | 24 | 7.0 | 46.0 | 5 |
| 9032-12-13 | 12 | 20.5 | G 1/4 | 41.6 | 55.3 | 11.0 | 22.8 | 19 | 8.0 | 50.0 | 5 |
| 9032-12-17 | 12 | 20.5 | G 3/8 | 42.6 | 55.3 | 12.0 | 22.8 | 22 | 10.0 | 58.0 | 5 |
| 9032-12-21 | 12 | 20.5 | G 1/2 | 44.6 | 55.3 | 14.0 | 22.8 | 24 | 10.0 | 58.0 | 5 |

9033

RACCORDS EN T MÂLES EN BOUT, ORIENTABLES

BSP CONIQUES

Lateral Tee male directional (BSPT)

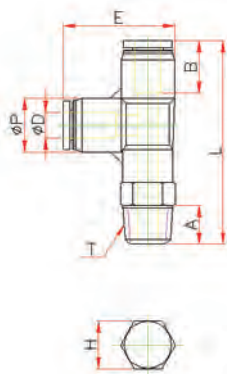

| Référence | Ø D | Ø P | T | L | E | A | B | H(Hex) | Orifice | Poids(g) | Sachet |
|------------|-----|------|-------|------|------|------|------|--------|---------|----------|--------|
| 9033-04-10 | 4 | 10.6 | R 1/8 | 45.1 | 24.9 | 8.0 | 14.9 | 10 | 3.0 | 12.0 | 10 |
| 9033-04-13 | 4 | 10.6 | R 1/4 | 47.1 | 24.9 | 10.0 | 14.9 | 14 | 3.0 | 18.0 | 10 |
| 9033-04-17 | 4 | 10.6 | R 3/8 | 48.1 | 24.9 | 11.0 | 14.9 | 17 | 3.0 | 27.0 | 10 |
| 9033-06-10 | 6 | 13.0 | R 1/8 | 48.4 | 27.9 | 8.0 | 16.4 | 12 | 4.5 | 19.0 | 10 |
| 9033-06-13 | 6 | 13.0 | R 1/4 | 51.4 | 27.9 | 10.0 | 16.4 | 14 | 4.5 | 23.0 | 10 |
| 9033-06-17 | 6 | 13.0 | R 3/8 | 52.4 | 27.9 | 11.0 | 16.4 | 17 | 4.5 | 31.0 | 10 |
| 9033-06-21 | 6 | 13.0 | R 1/2 | 55.4 | 27.9 | 14.0 | 16.4 | 21 | 4.5 | 56.0 | 10 |
| 9033-08-10 | 8 | 15.0 | R 1/8 | 52.5 | 31.3 | 8.0 | 18.7 | 14 | 6.0 | 17.0 | 10 |
| 9033-08-13 | 8 | 15.0 | R 1/4 | 55.5 | 31.3 | 10.0 | 18.7 | 14 | 6.0 | 25.0 | 10 |
| 9033-08-17 | 8 | 15.0 | R 3/8 | 56.5 | 31.3 | 11.0 | 18.7 | 17 | 6.0 | 30.0 | 10 |
| 9033-08-21 | 8 | 15.0 | R 1/2 | 59.5 | 31.3 | 14.0 | 18.7 | 21 | 6.5 | 54.0 | 5 |
| 9033-10-10 | 10 | 18.0 | R 1/8 | 55.7 | 34.7 | 8.0 | 20.1 | 17 | 6.0 | 34.0 | 5 |
| 9033-10-13 | 10 | 18.0 | R 1/4 | 58.7 | 34.7 | 10.0 | 20.1 | 17 | 7.0 | 36.0 | 5 |
| 9033-10-17 | 10 | 18.0 | R 3/8 | 59.7 | 34.7 | 11.0 | 20.1 | 17 | 7.0 | 38.0 | 5 |
| 9033-10-21 | 10 | 18.0 | R 1/2 | 62.7 | 34.7 | 14.0 | 20.1 | 21 | 7.0 | 60.0 | 5 |
| 9033-12-10 | 12 | 20.8 | R 1/8 | 63.0 | 40.5 | 8.0 | 22.8 | 19 | 6.0 | 51.0 | 5 |
| 9033-12-13 | 12 | 20.8 | R 1/4 | 65.0 | 40.5 | 10.0 | 22.8 | 19 | 7.0 | 50.0 | 5 |
| 9033-12-17 | 12 | 20.8 | R 3/8 | 66.0 | 40.5 | 11.0 | 22.8 | 19 | 10.0 | 52.0 | 5 |
| 9033-12-21 | 12 | 20.8 | R 1/2 | 69.0 | 40.5 | 14.0 | 22.8 | 21 | 10.0 | 66.0 | 5 |

Les dimensions sont données à titre indicatif et peuvent être changées sans préavis.