

Compact Guide Cylinder

Series *MGP*

ø12, ø16, ø20, ø25, ø32, ø40, ø50, ø63, ø80, ø100



- MGJ
- MGP**
- MGQ
- MGG
- MGK
- MGF
- MGZ
- MGT

Series Variations

Series	Bearing type	Cushion	Bore size (mm)									Page		
			12	16	20	25	32	40	50	63	80		100	
Standard type MGP	Slide bearing Ball bushing bearing	Rubber bumper	●	●	●	●	●	●	●	●	●	●	<ul style="list-style-type: none"> • Clean series: ø12 to ø63 • Water resistant: ø20 to ø100 (Note) • Copper/Fluorine-free: ø12 to ø100 	P. 269
With air cushion MGP		Air cushion	●	●	●	●	●	●	●	●	●	●	<ul style="list-style-type: none"> • Copper/Fluorine-free (20-) 	P. 289
With end lock MGP		Rubber bumper	●	●	●	●	●	●	●	●	●	●	<p>Note) Available with ø20 to ø100 slide bearing type only</p>	P. 307
Heavy duty guide rod type MGPS		Slide bearing	Rubber bumper	●	●	●	●	●	●	●	●	●		P. 319
High precision ball bushing bearing type MGPA		Ball bushing bearing	Rubber bumper/ Air cushion	●	●	●	●	●	●	●	●	●		P. 329

- D-
- X
- Individual
-X

Series MGP

Mass

Slide Bearing: MGPM12 to 100

(kg)

Bore size (mm)	Model	Standard stroke (mm)															
		10	20	25	30	40	50	75	100	125	150	175	200	250	300	350	400
12	MGPM12	0.24	0.28	—	0.31	0.35	0.39	0.50	0.59	0.70	0.79	0.89	0.98	1.17	—	—	—
16	MGPM16	0.33	0.38	—	0.43	0.48	0.53	0.68	0.80	0.97	1.09	1.22	1.35	1.60	—	—	—
20	MGPM20	—	0.67	—	0.75	0.83	0.91	1.17	1.37	1.57	1.76	1.96	2.16	2.63	3.03	3.42	3.82
25	MGPM25	—	0.95	—	1.05	1.16	1.27	1.65	1.92	2.19	2.47	2.74	3.01	3.67	4.21	4.76	5.30
32	MGPM32	—	—	1.69	—	—	2.07	2.47	2.85	3.24	3.62	4.00	4.38	5.33	6.09	6.86	7.62
40	MGPM40	—	—	1.95	—	—	2.37	2.83	3.25	3.68	4.10	4.53	4.95	5.99	6.85	7.70	8.55
50	MGPM50	—	—	3.36	—	—	4.00	4.73	5.37	6.01	6.65	7.29	7.93	9.54	10.8	12.1	13.4
63	MGPM63	—	—	4.18	—	—	4.94	5.78	6.54	7.29	8.05	8.80	9.56	11.4	12.9	14.4	15.9
80	MGPM80	—	—	6.49	—	—	7.43	8.67	9.61	10.5	11.5	12.4	13.4	15.8	17.7	19.5	21.4
100	MGPM100	—	—	10.5	—	—	11.9	13.6	14.9	16.3	17.6	18.9	20.2	23.6	26.2	28.9	31.5

Ball Bushing Bearing: MGPL12 to 100

(kg)

Bore size (mm)	Model	Standard stroke (mm)															
		10	20	25	30	40	50	75	100	125	150	175	200	250	300	350	400
12	MGPL12	0.24	0.27	—	0.30	0.35	0.39	0.47	0.56	0.66	0.74	0.83	0.91	1.08	—	—	—
16	MGPL16	0.34	0.39	—	0.43	0.51	0.56	0.67	0.79	0.93	1.04	1.16	1.28	1.50	—	—	—
20	MGPL20	—	0.70	—	0.77	0.89	0.97	1.14	1.31	1.52	1.69	1.87	2.04	2.42	2.77	3.12	3.47
25	MGPL25	—	0.98	—	1.07	1.25	1.34	1.57	1.81	2.08	2.31	2.54	2.77	3.27	3.74	4.20	4.66
32	MGPL32	—	—	1.54	—	—	1.85	2.30	2.62	2.99	3.31	3.62	3.94	4.63	5.26	5.89	6.52
40	MGPL40	—	—	1.79	—	—	2.15	2.64	3.00	3.42	3.78	4.14	4.50	5.28	6.00	6.72	7.44
50	MGPL50	—	—	3.11	—	—	3.66	4.41	4.96	5.60	6.15	6.70	7.25	8.48	9.57	10.7	11.8
63	MGPL63	—	—	3.93	—	—	4.59	5.46	6.12	6.88	7.54	8.21	8.87	10.3	11.7	13.0	14.3
80	MGPL80	—	—	6.25	—	—	7.39	8.69	9.51	10.3	11.1	12.0	12.8	14.7	16.3	18.0	19.6
100	MGPL100	—	—	9.89	—	—	11.6	13.4	14.5	15.7	16.9	18.1	19.3	21.9	24.2	26.6	28.9

Allowable Rotational Torque of Plate

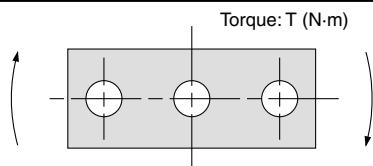

Non-rotating Accuracy of Plate

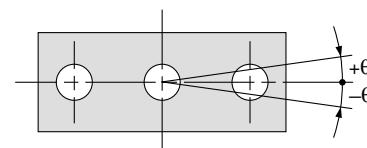

For non-rotating accuracy without load, use a value no more than the values in the table as a guide.

Bore size (mm)	Bearing type	Stroke (mm)															
		10	20	25	30	40	50	75	100	125	150	175	200	250	300	350	400
12	MGPM	0.39	0.32	—	0.27	0.24	0.21	0.43	0.36	0.31	0.27	0.24	0.22	0.19	—	—	—
	MGPL	0.61	0.45	—	0.35	0.58	0.50	0.37	0.29	0.24	0.20	0.18	0.16	0.12	—	—	—
16	MGPM	0.69	0.58	—	0.49	0.43	0.38	0.69	0.58	0.50	0.44	0.40	0.36	0.30	—	—	—
	MGPL	0.99	0.74	—	0.59	0.99	0.86	0.65	0.52	0.43	0.37	0.32	0.28	0.23	—	—	—
20	MGPM	—	1.05	—	0.93	0.83	0.75	1.88	1.63	1.44	1.28	1.16	1.06	0.90	0.78	0.69	0.62
	MGPL	—	1.26	—	1.03	2.17	1.94	1.52	1.25	1.34	1.17	1.03	0.93	0.76	0.65	0.56	0.49
25	MGPM	—	1.76	—	1.55	1.38	1.25	2.96	2.57	2.26	2.02	1.83	1.67	1.42	1.24	1.09	0.98
	MGPL	—	2.11	—	1.75	3.37	3.02	2.38	1.97	2.05	1.78	1.58	1.41	1.16	0.98	0.85	0.74
32	MGPM	—	—	6.35	—	—	5.13	5.69	4.97	4.42	3.98	3.61	3.31	2.84	2.48	2.20	1.98
	MGPL	—	—	5.95	—	—	4.89	5.11	4.51	6.34	5.79	5.33	4.93	4.29	3.78	3.38	3.04
40	MGPM	—	—	7.00	—	—	5.66	6.27	5.48	4.87	4.38	3.98	3.65	3.13	2.74	2.43	2.19
	MGPL	—	—	6.55	—	—	5.39	5.62	4.96	6.98	6.38	5.87	5.43	4.72	4.16	3.71	3.35
50	MGPM	—	—	13.0	—	—	10.8	12.0	10.6	9.50	8.60	7.86	7.24	6.24	5.49	4.90	4.43
	MGPL	—	—	9.17	—	—	7.62	9.83	8.74	11.6	10.7	9.83	9.12	7.95	7.02	6.26	5.63
63	MGPM	—	—	14.7	—	—	12.1	13.5	11.9	10.7	9.69	8.86	8.16	7.04	6.19	5.52	4.99
	MGPL	—	—	10.2	—	—	8.48	11.0	9.74	13.0	11.9	11.0	10.2	8.84	7.80	6.94	6.24
80	MGPM	—	—	21.9	—	—	18.6	22.9	20.5	18.6	17.0	15.6	14.5	12.6	11.2	10.0	9.11
	MGPL	—	—	15.1	—	—	23.3	22.7	20.6	18.9	17.3	16.0	14.8	12.9	11.3	10.0	8.94
100	MGPM	—	—	38.8	—	—	33.5	37.5	33.8	30.9	28.4	26.2	24.4	21.4	19.1	17.2	15.7
	MGPL	—	—	27.1	—	—	30.6	37.9	34.6	31.8	29.3	27.2	25.3	22.1	19.5	17.3	15.5

Bore size (mm)	Non-rotating accuracy θ	
	MGPM	MGPL
12		
16	±0.08°	±0.10°
20		
25	±0.07°	±0.09°
32		
40	±0.06°	±0.08°
50		
63	±0.05°	±0.06°
80		
100	±0.04°	±0.05°

Series MGP

Vertical Mounting (Slide Bearing)

— Operating pressure 0.4 MPa
 - - - Operating pressure 0.5 MPa or more

MGPM12 to 100

(1) 50 Stroke or Less, $V = 200$ mm/s or less

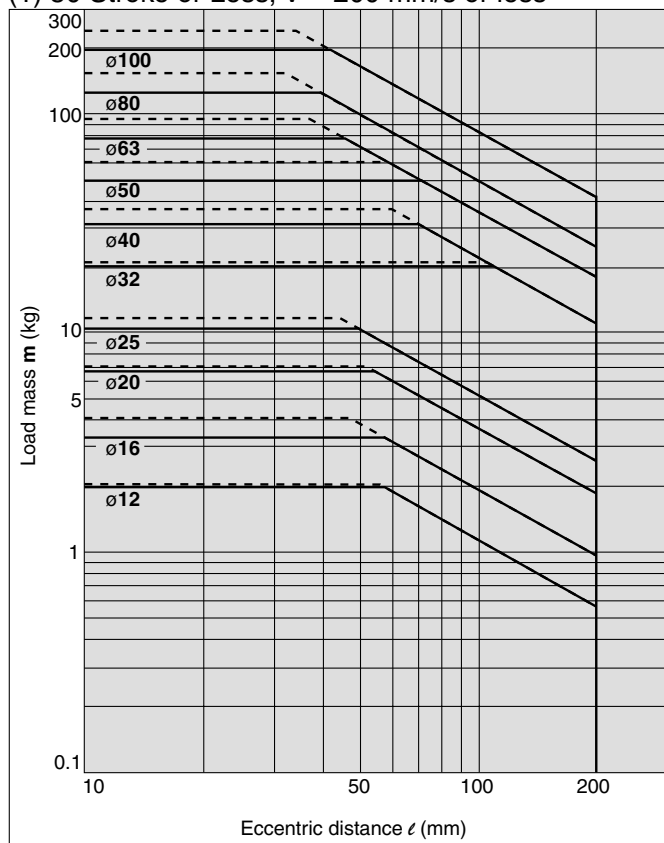

(2) Over 50 Stroke, $V = 200$ mm/s or less

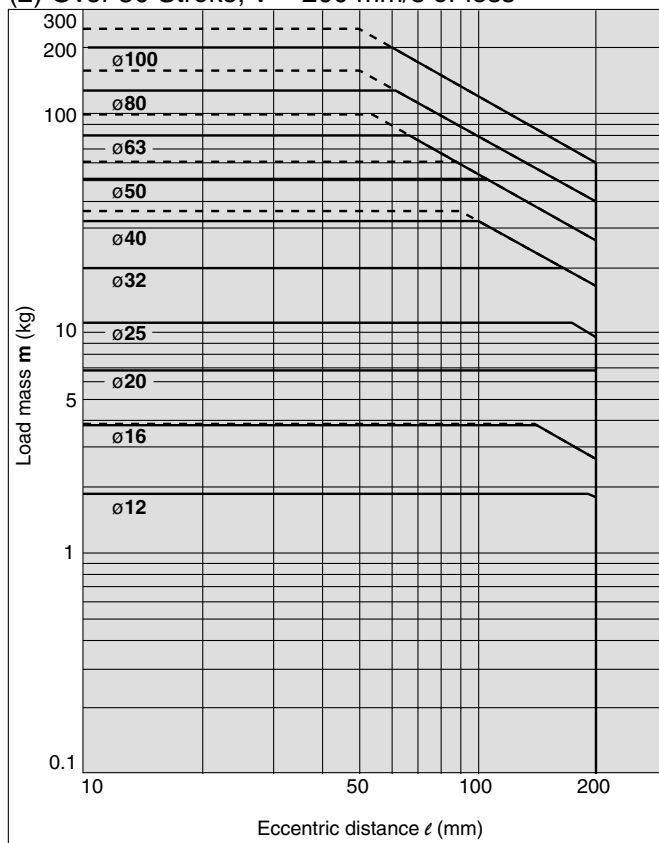

(3) 50 Stroke or Less, $V = 400$ mm/s

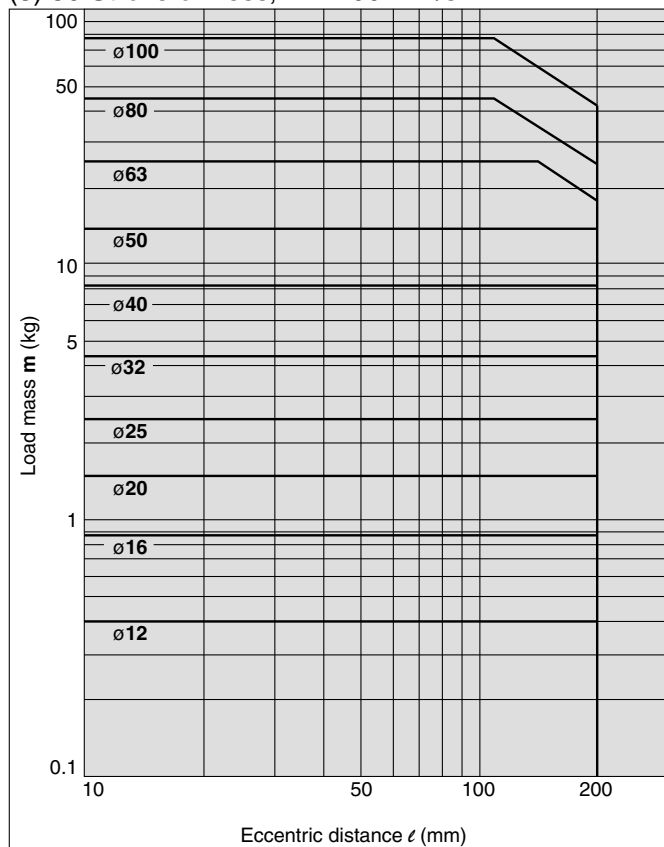

(4) Over 50 Stroke, $V = 400$ mm/s

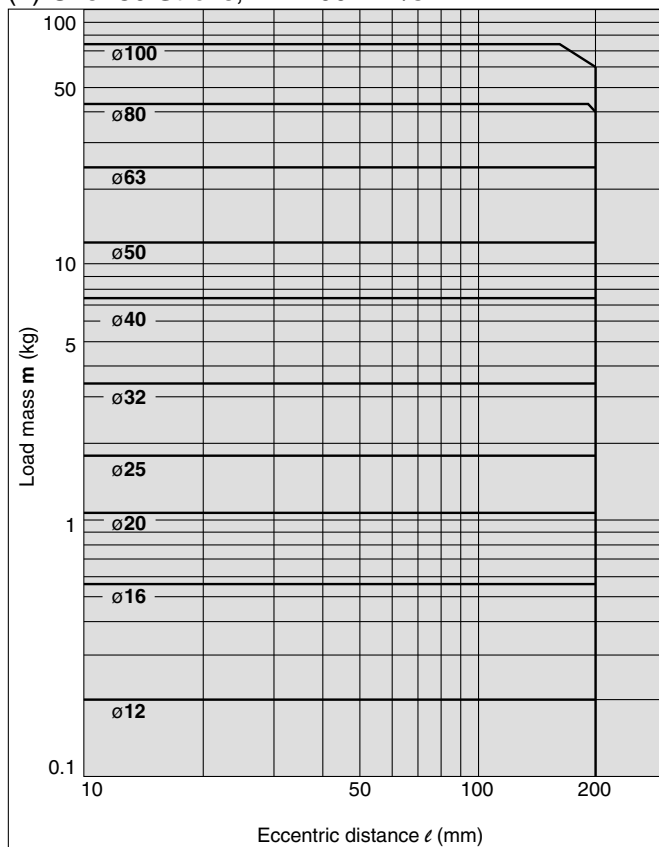

Horizontal Mounting (Slide Bearing)

MGPM12 to 100

(13) $\ell = 50$ mm, $V = 200$ mm/s or less

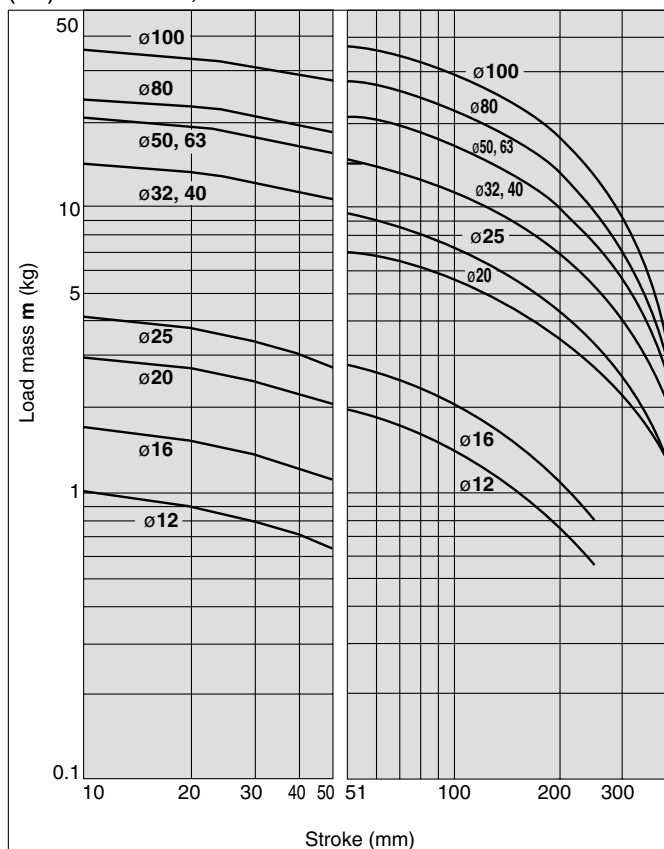

(14) $\ell = 100$ mm, $V = 200$ mm/s or less

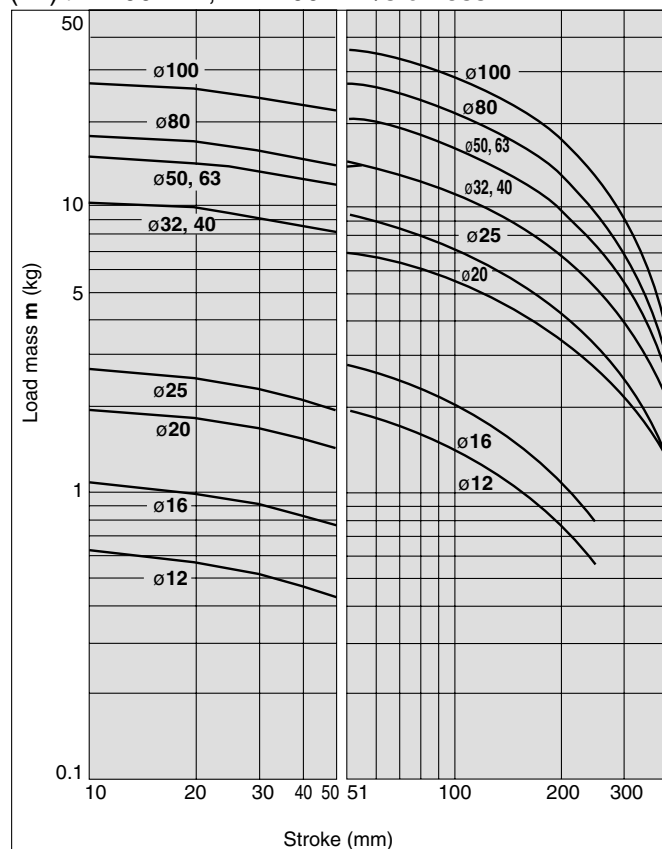

(15) $\ell = 50$ mm, $V = 400$ mm/s

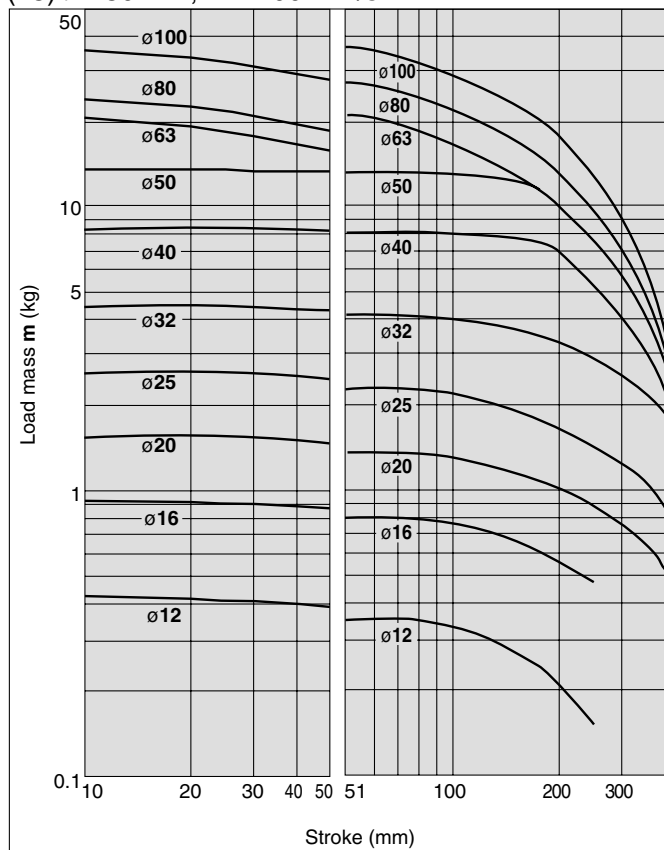

(16) $\ell = 100$ mm, $V = 400$ mm/s

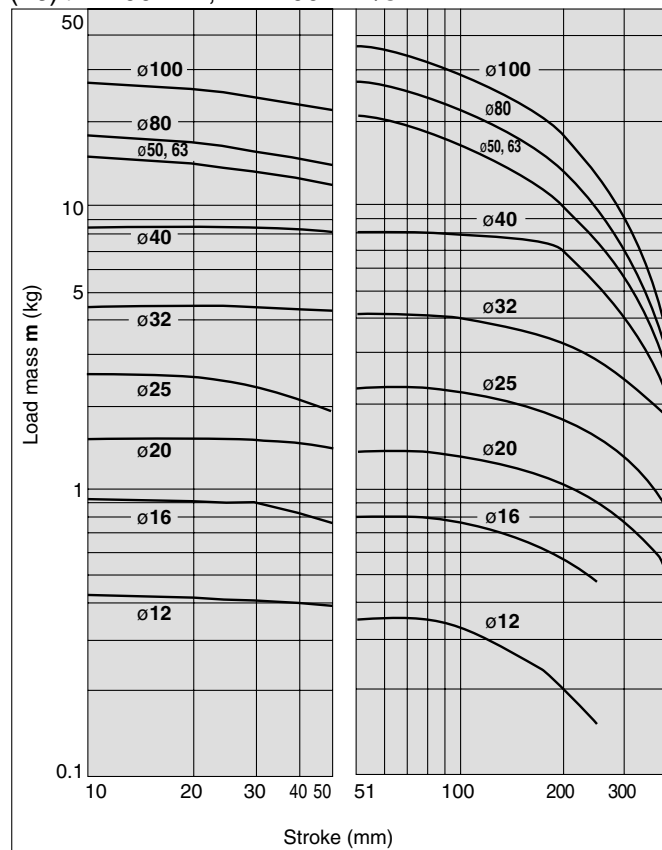

MGJ

MGP

MGQ

MGG

MGC

MGF

MGZ

MGT

D-□

-X□

Individual
-X□

Series MGP

Operating Range when Used as Stopper

Bore Size: $\phi 12$ to 25/MGPM12 to 25 (Slide bearing)

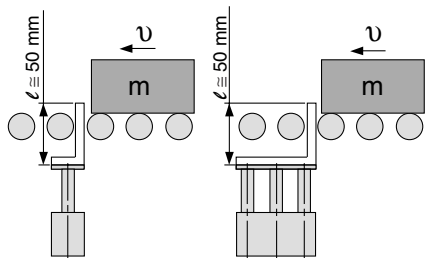

* When selecting a model with a longer l dimension, be sure to choose a bore size which is sufficiently large.

⚠ Caution

Caution on handling

Note 1) When using as a stopper, select a model with 30 stroke or less.

Note 2) Model MGPL (Ball bushing bearing) cannot be used as a stopper.

MGPM12 to 25 (Slide bearing)

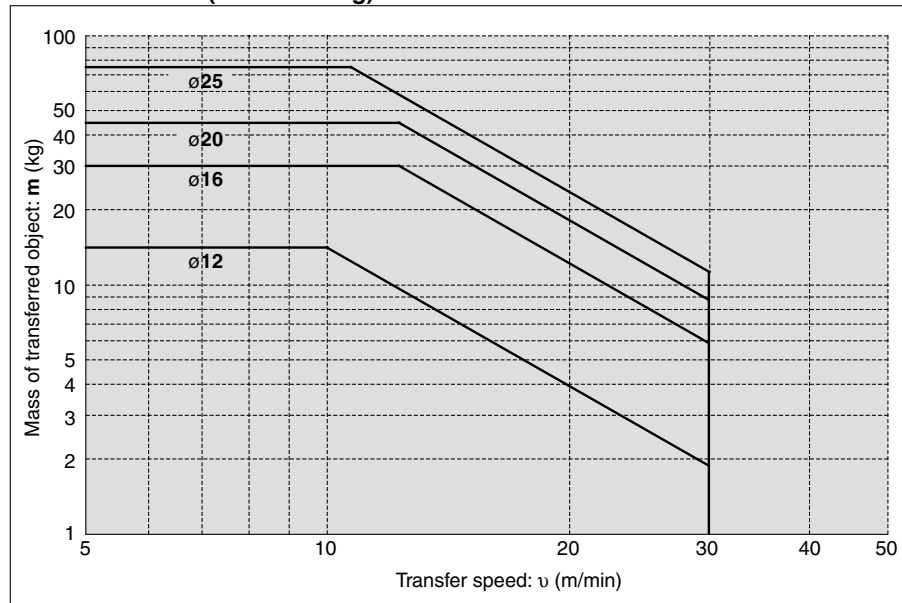

Bore Size: $\phi 32$ to 100/MGPM32 to 100 (Slide bearing)

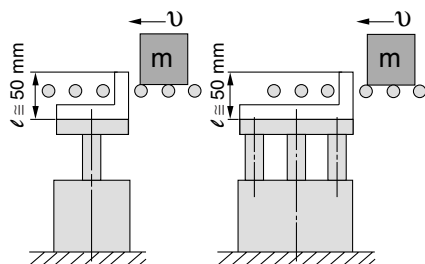

* When selecting a model with a longer l dimension, be sure to choose a bore size which is sufficiently large.

⚠ Caution

Caution on handling

Note 1) When using as a stopper, select a model with 50 stroke or less.

Note 2) Model MGPL (Ball bushing bearing) cannot be used as a stopper.

MGPM32 to 100 (Slide bearing)

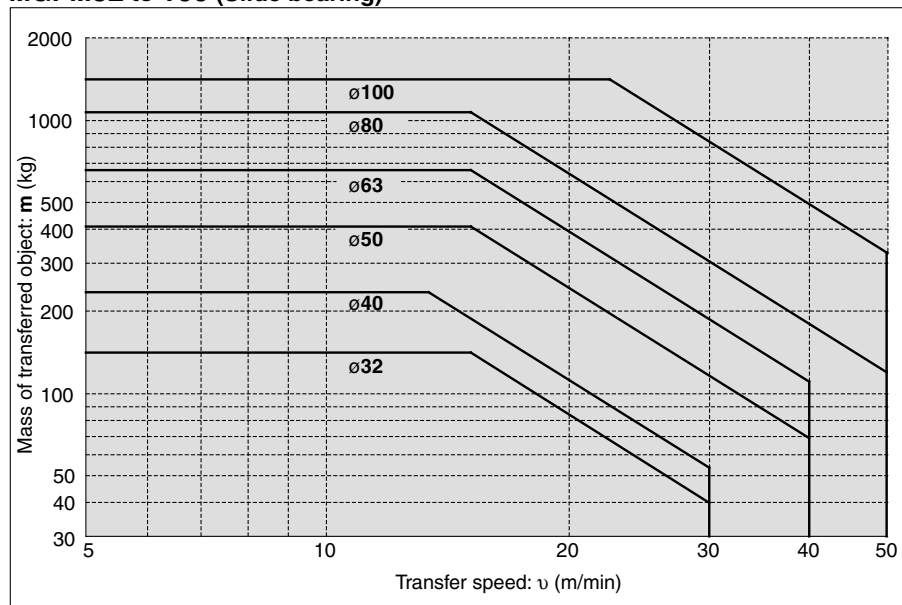

Series MGP

Construction/Series MGPM

MGPM12 to 25

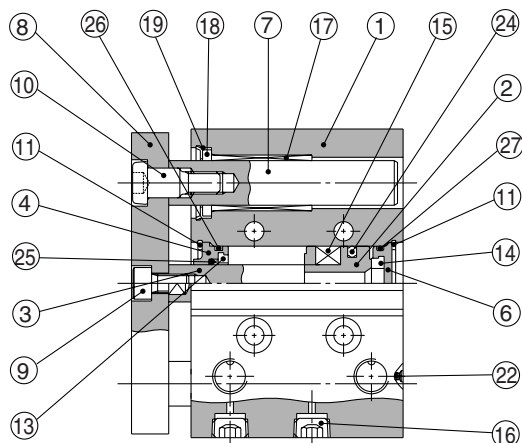

50 stroke or less

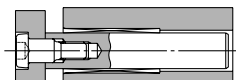

ø12, ø16 50 stroke or less

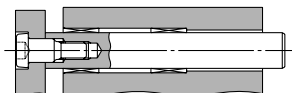

ø12, ø16 Over 50 stroke



ø20, ø25 Over 50 stroke

MGPM32 to 100

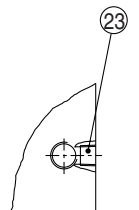
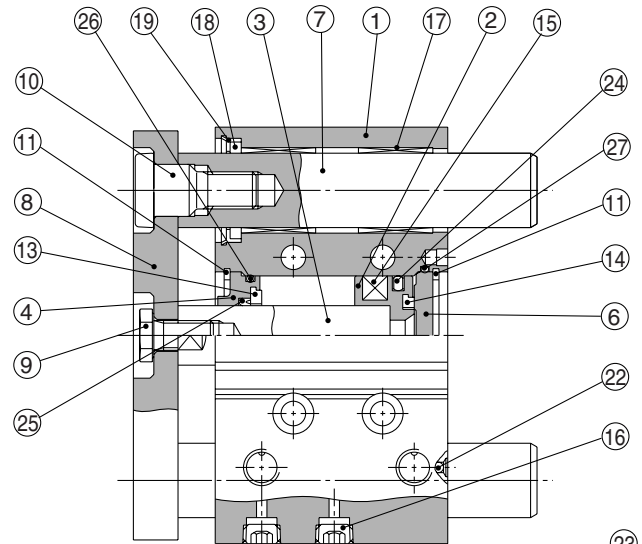

ø63 or more

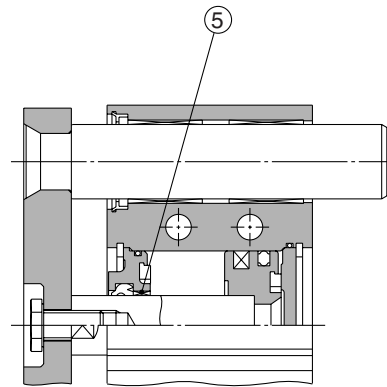

ø50 or more

Component Parts

No.	Description	Material	Note
1	Body	Aluminum alloy	Hard anodized
2	Piston	Aluminum alloy	Chromated
3	Piston rod	Stainless steel	ø12 to ø25
		Carbon steel	ø32 to ø100 Hard chrome plated
4	Collar	Aluminum bearing alloy	ø12 to ø40 Clear anodized
		Aluminum alloy casted	ø50 to ø100 Painted
5	Bushing	Babbitt	ø50 to ø100
6	Head cover	Aluminum alloy	ø12 to ø63 Chromated
			ø80 to ø100 Painted
7	Guide rod	Carbon steel	Hard chrome plated
8	Plate	Carbon steel	Nickel plated
9	Plate mounting bolt	Carbon steel	Nickel plated
10	Guide bolt	Carbon steel	Nickel plated
11	Retaining ring	Carbon tool steel	Phosphate coated
12	Retaining ring	Carbon tool steel	Phosphate coated
13	Bumper A	Urethane	
14	Bumper B	Urethane	
15	Magnet	-	
16	Plug Hexagon socket head cap plug	Carbon steel	ø12, ø16 Nickel plated
			ø20 to ø100
17	Slide Bearing	Babbitt	

Component Parts

No.	Description	Material	Note
18	Felt	Felt	
19	Holder	Resin	
20	Ball bushing		
21	Spacer	Aluminum alloy	
22	Steel ball	Carbon steel	ø12 to ø50
23	Plug	Carbon steel	ø63 to ø100 Nickel plated
24*	Piston seal	NBR	
25*	Rod seal	NBR	
26*	Gasket A	NBR	
27*	Gasket B	NBR	

Replacement Parts: Seal Kit

Bore size (mm)	Kit no.	Contents	Bore size (mm)	Kit no.	Contents
12	MGP12-PS	Set of nos. above ø12, ø25, ø26, ø27	40	MGP40-PS	Set of nos. above ø24, ø25, ø26, ø27
16	MGP16-PS		50	MGP50-PS	
20	MGP20-PS		63	MGP63-PS	
25	MGP25-PS		80	MGP80-PS	
32	MGP32-PS		100	MGP100-PS	

* Seal kit includes 24 to 27. Order the seal kit, based on each bore size.

* Since the seal kit does not include a grease pack, order it separately.
Grease pack part no.: GR-S-010 (10 g)