

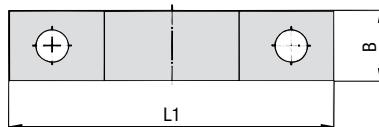

Metal DIN Clamps

Heavy Saddle with Tension Clearance (DIN 1593)
Two-Bolt Design

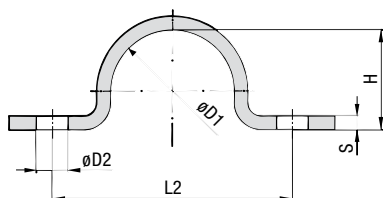

STAUFF Group	Diameter Range		Dimensions (mm/in)					
	Ø D1 (mm)	(in)	L1	L2	H	D2	B	S
7	5,5 ... 7	.2228	44	28	5	6,6	16	2
			1.73	1.10	.20	.26	.63	.08
9	7 ... 9	.2835	48	32	6	6,6	20	2
			1.89	1.26	.24	.26	.79	.08
13	9,5 ... 13	.3951	52	36	9	6,6	20	2
			2.05	1.42	.35	.26	.79	.08
15,5	13 ... 15,5	.5161	56	40	12	6,6	20	2
			2.20	1.57	.47	.26	.79	.08
19	15,5 ... 19	.6175	60	44	15	6,6	20	2
			2.36	1.73	.59	.26	.79	.08
23	20 ... 23	.7991	82	56	19	11	25	3
			3.23	2.20	.75	.43	.98	.12
26	23 ... 26	.91 ... 1.02	84	58	22	11	25	3
			3.31	2.28	.87	.43	.98	.12
28,5	26 ... 28,5	1.02 ... 1.12	90	64	24	11	25	3
			3.54	2.52	.94	.43	.98	.12
31	28,5 ... 31	1.12 ... 1.22	90	64	27	11	25	3
			3.54	2.52	1.06	.43	.98	.12
36	33 ... 36	1.30 ... 1.42	106	80	32	11	30	5
			4.17	3.15	1.26	.43	1.18	.20
39	36 ... 39	1.42 ... 1.54	110	84	34	11	30	5
			4.33	3.31	1.34	.43	1.18	.20
43	39 ... 43	1.54 ... 1.69	120	88	38	14	30	5
			4.72	3.46	1.50	.55	1.18	.20
46	43 ... 46	1.69 ... 1.81	122	90	41	14	30	5
			4.80	3.54	1.61	.55	1.18	.20
49	46 ... 49	1.81 ... 1.93	122	90	44	14	30	5
			4.80	3.54	1.73	.55	1.18	.20
58	53 ... 58	2.09 ... 2.28	142	110	52	14	40	5
			5.59	4.33	2.05	.55	1.57	.20
61	58 ... 61	2.28 ... 2.40	142	110	57	14	40	5
			5.59	4.33	2.24	.55	1.57	.20
71	67 ... 71	2.64 ... 2.80	152	120	66	14	40	5
			5.98	4.72	2.60	.55	1.57	.20
77	73 ... 77	2.87 ... 3.03	176	136	72	18	40	5
			6.93	5.35	2.83	.71	1.57	.20
81	77 ... 81	3.03 ... 3.19	184	144	76	18	40	5
			7.24	5.67	2.99	.71	1.57	.20
91	88 ... 91	3.39 ... 3.58	198	158	85	18	40	8
			7.80	6.22	3.35	.71	1.57	.31
103	99 ... 103	3.90 ... 4.06	214	174	98	18	40	8
			8.43	6.85	3.86	.71	1.57	.31
109	105 ... 109	4.13 ... 4.29	220	180	104	18	40	8
			8.66	7.09	4.09	.71	1.57	.31
115	110 ... 115	4.33 ... 4.53	226	186	109	18	40	8
			8.90	7.32	4.29	.71	1.57	.31

Ordering Codes

Heavy Saddle *DIN1593-*7-*W66

* Heavy Saddle to DIN 1593	DIN1593
* STAUFF Group (Ø D1)	7
* Material code	Carbon Steel, uncoated W1
	Carbon Steel, zinc-plated and thick-film passivated W66
	Stainless Steel V4A W5
	1.4401 / 1.4571 (AISI 316 / 316 Ti)

Applications

- Installation of pipes, tubes, poles and other round components directly on the substrate (floor, wall or ceiling)



Alternative materials and surface finishings are available upon request. Contact STAUFF for further information.

