

7. TRANSMISSION ELEMENTS

Elastic couplings	p. 172
Taper bushings	p. 175
Fixing bushings	p. 175
Racks	p. 179
Transmission crosspieces	p. 179
Chain discs	p. 180
Freewheel clutches	p. 203
Cylindrical gears	p. 204
Bevel gears	p. 207
Spindles	p. 209
Cardan joints	p. 211
Torque limiters	p. 215
Motors and reducers	p. 219
Chain sprockets	p. 223
Chain sprockets with tapered bore	p. 231
Stainless chain sprockets	p. 233
Bevel Gearboxes	p. 234
Freewheels	p. 241

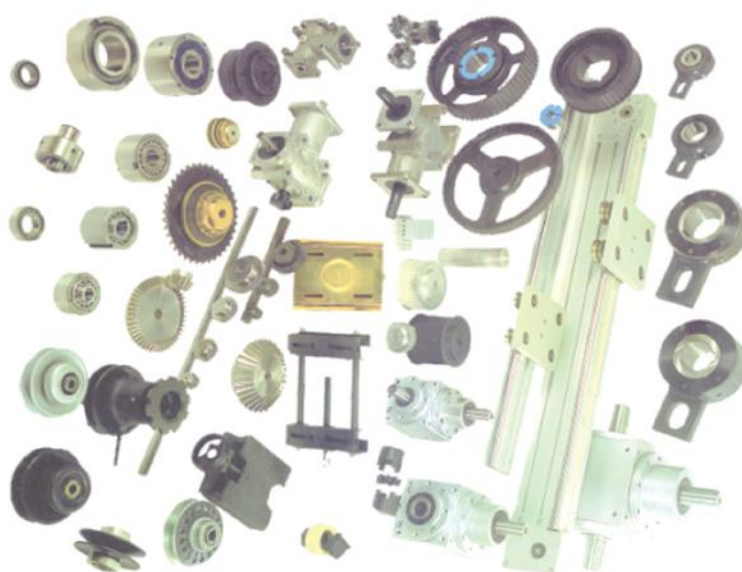



>>> Elastic Couplings and Spiders



Couplings with hubs

At www.rodavigo.net Family: Transmission elements
Product: Albert couplings

Code	A	P	C	G	I	Maximum revolutions	Torque		Spider type	Ø Int. Spider	Axles Max.	Axles Min.	Weight	MI.
							N n	CV. R.P.M						
021SR50V	50	50	18	30	16	10.000	0,0017	1,2	50x10	20	19	0	0,4	0,000062
021SRL50V	50	62	18	32	22	10.000	0,0017	1,2	50x10	20	20	0	0,5	0,000093
021SR60V	60	80	24	40	28	10.000	0,0044	3,1	60x14	27	24	0	0,9	0,00027
021SRL60V	60	96	24	40	36	10.000	0,0044	3,1	60x14	27	24	0	1	0,00030
021SN75V	75	71	27	41	22	5.000	0,0105	10	75x16	31	25	13	0,9	0,00071
021SR75V	75	75	27	50	24	5.000	0,0105	10	75x16	31	34	13	1,3	0,00085
021SRL75V	75	100	27	50	36,5	5.000	0,0105	10	75x16	31	34	13	1,6	0,00101
021SE75C	75	125	37	57	44	5.000	0,015	16	75x23	26	38	13	2,5	0,00156
021SR90V	90	88	32	60	28	5.000	0,015	16	90x20	37	40	13	2,2	0,0019
021SRL90V	90	124	32	65	46	5.000	0,015	16	90x20	37	45	13	3,3	0,00258
021SE90C	90	174	32	65	71	5.000	0,015	16	90x20	37	45	13	4,5	0,0038
021SR105V	105	110	38	72	36	4.800	0,027	27	105x20	49	48	0	4,1	0,0046
021SRL105V	105	150	38	72	56	4.800	0,027	27	105x20	49	48	0	5,3	0,0053
021SN120V	120	100	38	70	31	4.000	0,041	40	120x20	47	48	0	4,2	0,0063
021SRL120V	120	158	38	80	60	4.000	0,041	40	120x20	47	55	0	7	0,0095
021SN12028C	120	108	45	70	31,5	4.000	0,054	60	120x28	42	48	0	4,6	0,0079
021SN150V	150	128	48	80	40	3.500	0,061	71	150x28	63	55	0	7,7	0,015
021SRL150V	150	212	52	100	80	3.500	0,061	71	150x28	63	70	0	15	0,027
021SN20025V	200	145	45	100	50	3.000	0,136	148	200x25	70	70	0	13,8	0,061
021SRL20030V	200	260	60	130	100	3.000	0,164	158	200x30	70	100	0	30	0,115
021SRL20040V	200	270	70	130	100	2.800	0,352	305	200x40	100	100	0	30	0,1250
021SN245V	245	260	80	170	90	2.700	0,682	489	245x40	120	130	38	60	0,270
021SR245V	245	340	80	170	130	2.700	0,682	489	245x40	120	130	38	65	0,391
021SRL245V	245	386	80	170	153	2.700	0,682	489	245x40	120	130	38	70	0,650
021SR300V	300	395	5	200	150	1.800	0,55	470	300x40	110	140	38	110	0,941
021SR350V	350	425	105	250	160	1.750	1,665	1.193	350x55	175	180	38	170	2,06
021SR445V	445	500	140	300	180	1.000	2,91	2.000	445x70	230	200	38	305	5,99

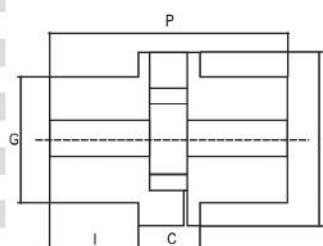

Couplings with hubs. TYPE A

At www.rodavigo.net Family: Transmission elements
Product: Samiflex Couplings

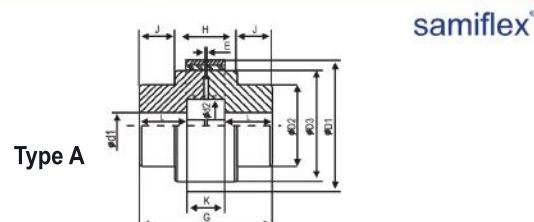

Code	D1	G	L	d2	D2	D3	K	J	H	E	*Nominal torque	*Max. torque	Max. speed	Max. Diam	Pre diam.	Torsional rigidity	Relative cushioning	Moment inertia	Weight
022A0	66	73	28	25	52	52	16	-	-	1,5	2	5	9.000	23	8	0,32	0,65	-	0,8
022A2	111	127	46	44	80	86	32	36	55	2,5	10	25	6.500	42	17	2,1	0,65	0,005	3,9
022A3	144	154	56	51	85	116	42	45	64	2,5	20	50	4.800	50	19	4,2	0,65	0,012	6,8
022A3B	144	154	56	51	105	116	42	45	64	2,5	20	50	4.800	55	19	4,2	0,65	0,02	8,5
022A4	182	179	63	66	110	150	51	47	85	3,5	40	100	3.500	65	24	9,5	0,65	0,05	13
022A4B	182	179	63	66	135	150	51	47	85	3,5	40	100	3.500	70	24	9,5	0,65	0,075	16
022A45	202	196	70	90	125	170	55	52	92	3,5	70	175	3.100	75	25	11,2	0,65	0,102	19
022A5	225	215	76	90	140	190	59	57	101	3,5	100	250	2.900	85	29	16	0,65	0,155	26
022A55	250	244	90	115	155	215	63	68	108	3,5	150	300	2.600	95	30	42	0,65	0,275	36
022A6	265	259	94	119	180	234	67	71	117	3,5	200	400	2.500	110	39	65	0,65	0,437	50
022A7	306	309	115	131	205	267	75	88	133	4	400	800	2.200	130	48	112	0,65	0,825	70
022A8	363	379	146	157	140	326	85	114	151	5	750	1.500	1.850	150	63	200	0,65	2,325	140
022A9	425	418	162	182	280	385	92	129	160	5	1.250	2.500	1.600	180	73	214	0,65	4,95	215
022A10	523	479	188	212	330	484	102	145	189	6	2.500	4.000	1.250	210	96	460	0,65	12	350
022A11	503	510	190	212	350	458	128	148	214	6	3.500	5.600	1.250	210	96	580	0,65	16	410

Type CS

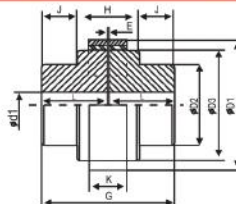

Code	D1	G	L	d2	D2	D3	K	J	H	E	*Nominal torque	*Max. torque	Max. speed	Max. Diam. d1	Pre diam.	Torsional rigidity	Relative cushioning	Moment inertia J	Weight
											daNm	daNm	R.P.M.	10 ³ Nm.rad ⁻¹	Ψ	[Kg-m ²]	Kg		
022A1CS	83	92	45	-	65	65	22	-	-	1,5	5	9	8.000	28	14	0,95	0,65	0,0015	1,9
022A2CS	111	127	62	-	80	86	32	36	55	2,5	10	25	6.500	35	17	2,1	0,65	0,006	4,2
022A3CS	144	154	75	-	85	116	42	45	64	2,5	20	50	4.800	42	19	4,2	0,65	0,020	7,2
022A4CS	182	179	88	-	110	150	51	47	85	3,5	40	100	3.500	55	24	9,5	0,65	0,07	13,8
022A45CS	202	196	96	-	125	170	55	52	92	3,5	70	175	3.100	65	25	11,2	0,65	0,115	20
022A5CS	225	215	105	-	140	190	59	57	101	3,5	100	250	2.900	75	29	16	0,65	0,195	27
022A55CS	250	244	120	-	155	215	63	68	108	3,5	150	300	2.600	85	30	42	0,65	0,305	38
022A6CS	265	259	127	-	180	234	67	71	117	3,5	200	400	2.500	90	39	65	0,65	0,510	55
022A7CS	306	309	152	-	205	267	75	88	133	4	400	800	2.200	110	48	112	0,65	0,995	77
022A8CS	363	379	187	-	240	326	85	114	151	5	750	1.500	1.850	130	63	200	0,65	2,635	150
022A9CS	425	418	206	-	280	385	92	129	160	5	1.250	2.500	1.600	160	73	214	0,65	5,85	230
022A10CS	523	479	236	-	330	484	102	145	189	6	2.500	4.000	1.250	190	96	460	0,65	13,5	370
022A11CS	503	510	250	-	350	458	128	148	214	6	3.500	5.600	1.250	190	96	580	0,65	16	440

* Nominal torque/Maximum torque, with standard elastic sheathing, 95 Shore A hardness (Yellow colour)

The nominal and maximum torques are increased by 40% using the high performance elastic sheathing Ref. HD, 97 Shore A hardness (ocher colour). Consult.

All types are manufactured with hubs in the qualities Gg25 (pearlitic cast iron), GGG40 (nodular cast iron) and Gs45 (cast steel).

Types A00 to A4 are also manufactured with C135 (Alcan) aluminum alloy hubs.

Couplings are supplied as standard in quality Gg25 and with 95 Shore A elastic sheathing.

Spider. The elastic sheathing

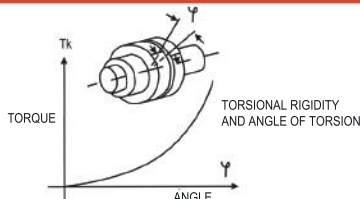
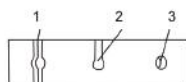
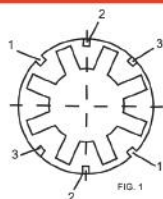

Quality	Hardness	Colour	Work temp.	
Standard	80 Shore A	Clear	- 40°/80 °C	STD
	90 Shore A	blue		
	95 Shore A	Yellow		
High Temp.	95 Shore A	Orange	-40°/140 °C	HT
High benefit	97 Shore A	Ocher	-40°/80 °C	HD
	97 Shore A	Red	-40°/140 °C	HDT
	65 Shore D	Green	-40°/140 °C	HR

It is made of a special polyurethane blend and has, to an exceptional degree, all the required characteristics.

- High resistance to breakage, shear, torsion.
 - Great damping capacity, stable and constant resistance.
 - Excellent behavior to abrasion, humidity, oils, corrosive vapors and numerous chemical products.
 - Stability of the main characteristics between -40° and 80° C for standard manufacturing sheathings. Elastic sheathings are manufactured between -40° and 140° C, HT reference.
 - Absence of aging.
 - Excellent behaviour and long life of the elastic sheathing, in abrasive, corrosive, wet media and everything without greasing or any maintenance.
- Elastic sheathings are manufactured in three qualities and five hardnesses, according to applications.

If the quality is not specified in advance, the supply is made with a standard 95 Shore A elastic sheathing, yellow colour. High performance sheathings, HD and HDT reference, ocher and red colour respectively, allow to increase the nominal torque by 40%.

The elastic sheathing allows 3 types of symmetrical housings, FIG 1.

Housing 1, for inserting the lugs of the clamping ring in horizontal mounting.

Housing 2, for inserting the lugs of the clamping ring in vertical mounting.

Housing 3, optional use, allows introducing through the two threaded holes of the clamping ring, two allen studs, in order to avoid the axial displacement of the mentioned ring.

Elastic sheathing / Torsional rigidity 103 Nm.rad-1

Code													Hardness Shore.
024A1	024A2	024A3	024A4	024A45	024A5	024A55	024A6	024A7	024A8	024A9	024A10	024A11	
0,22	0,50	1,05	1,90	2,04	2,85	7,50	10,80	19,35	33,50	39,70	74,20	92,70	80 A
0,43	1,08	2,00	4,35	5,30	7,25	19,00	30,90	50,80	95,20	101,90	209,00	250,00	90A
0,95	2,10	4,20	9,50	11,20	16,00	42,00	65,00	112,00	200,00	214,00	460,00	580,00	95A
1,71	3,78	7,56	17,10	20,16	28,80	79,80	123,50	212,80	380,00	406,00	874,00	1.095,00	97A
2,37	5,25	10,50	23,75	28,00	40,00	109,20	169,00	291,20	520,00	556,00	1.196,00	1.480,00	65D

>>> Elastic Couplings and Spiders

Couplings, B Series

At www.rodavigo.net

Family: Transmission elements
Product: Couplings and Spiders

Code	Dimensions											Pre Ø	Finish ¹ d		Hub length L ₂	Weight 2) Kg	Moment inertia 2) [Kg·m ²]
	A	B	L	L ₁ +L ₂	E	H*	C	F	g	f	J		min.	max.			
025B14D	40	25	50	23	4	15	6,5	37	M 5	6	-	6	14	40	0,175	0,00003	
025B24D	52	36	56	26	4	17	7,5	41	M 5	6	-	10	24	50	0,316	0,000093	
025B28D	66	44	84	40	4	20	19	46	M 8	10	7	10	28	55	0,739	0,00031	
025B32D	76	50	84	40	4	20	18	48	M 8	10	12	12	32	55	0,95	0,00055	
025B38D	83	58	84	40	4	20	18	48	M 8	10	12	14	38	60	1,22	0,00087	
025B42D	92	68	88	42	4	22	19	50	M 8	10	12	20	42	60	1,49	0,0014	
025B48D	100	68	104	50	4	22	27	50	M 8	10	12	20	48	60	1,81	0,0018	
025B55D	125	83	124	60	4	30	30	65	M 10	20	-	25	55	-	3,45	0,0046	
025B65D	140	96	144	70	4	32	36	72	M 10	20	-	25	65	-	5,18	0,0099	
025B80D	175	124	186	90	6	45	46,5	93	M 10	20	-	30	80	-	11,5	0,0370	
025B100D	210	152	228	110	8	55	63	102	M 12	30	-	40	100	-	20,5	0,1156	

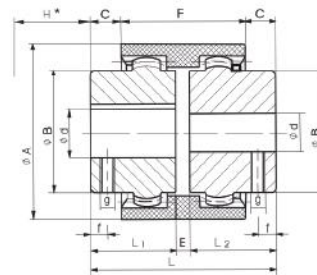

H* Minimum required H* for decoupling in radial direction.

1) Finish according to ISO standard H/, keyway DIN 6885.

2) Weights and moments of inertia for max. d without keyways.

Assembly instructions:

When assembling it is important that the hubs are correctly adjusted on the shafts and that dimension E is maintained. The E dimension can be controlled by the total length of the assembly (L).

An inaccurate E dimension has a negative influence on the behavior of the coupling.

The admissible displacement values depend on the speed (r.p.m) and the transmitted power (kW).



Standard Couplings Material: Light Alloy

Code	Dimensions											Pre Ø	Holes Finishes 1) 2)		Weight 2) Kg	Moment inertia 2) Kg m ²	
	A	B	L	L ₁ ³⁾ L ₂	E	s	b	C	d _h	g	f		H*	min.			max.
025AA19ALU	40	32	66	25	16	2	12	20	18	M 5	10	14	-	6	19	0,10	0,0003
025AA24ALU	55	40	78	30	18	2	14	24	27	M 5	10	16	-	8	24	0,25	0,0008
025AA28ALU	65	48	90	35	20	2,5	15	28	30	M 6	15	18	-	10	28	0,40	0,0002
025AA38ALU	80	66	114	45	24	3	18	37	38	M 8	15	19	10	14	38	0,80	0,0007
025AA42ALU	95	75	126	50	26	3	20	40	46	M 8	20	21	13	19	42	1,30	0,0015
025AA48ALU	105	85	140	56	28	3,5	21	45	51	M 8	20	22	18	19	48	1,75	0,0024

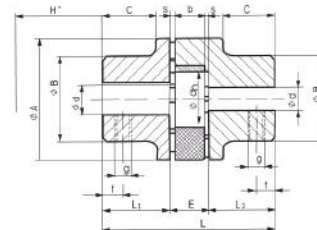



>>> Fixing bushings

Type BK40 fixing bushings

At www.rodavigo.net Family: Transmission elements
Product: Fixing bushings

Code	Dimensions				Code	Dimensions			
	d	D	B	L		d	D	B	L
mm									
028BK402047	20	47	20	26	028BK4095135	95	135	28	38
028BK402247	22	47	20	26	028BK40100145	100	145	30	42
028BK402450	24	50	20	26	028BK40110155	110	155	30	42
028BK402550	25	50	20	26	028BK40120165	120	165	30	42
028BK402855	28	55	20	26	028BK40130180	130	180	38	50
028BK403055	30	55	20	26	028BK40140190	140	190	38	50
028BK403260	32	60	20	26	028BK40150200	150	200	38	50
028BK403560	35	60	20	26	028BK40160210	160	210	38	50
028BK403865	38	65	20	26	028BK40170225	170	225	44	58
028BK404065	40	65	20	26	028BK40180235	180	235	44	58
028BK404275	42	75	24	32	028BK40190250	190	250	52	66
028BK404575	45	75	24	32	028BK40200260	200	260	52	66
028BK404880	48	80	24	32	028BK40220285	220	285	56	72
028BK405080	50	80	24	32	028BK40240305	240	305	56	72
028BK405585	55	85	24	32	028BK40260325	260	325	56	72
028BK406090	60	90	24	32	028BK40280355	280	355	66	84
028BK406595	65	95	24	32	028BK40300375	300	375	66	84
028BK4070110	70	110	28	38	028BK40320405	320	405	78	101
028BK4075115	75	115	28	38	028BK40340425	340	425	78	101
028BK4080120	80	120	28	38	028BK40360455	360	455	90	116
028BK4085125	85	125	28	38	028BK40380475	380	475	90	116
028BK4090130	90	130	28	38	028BK40400495	400	495	90	116

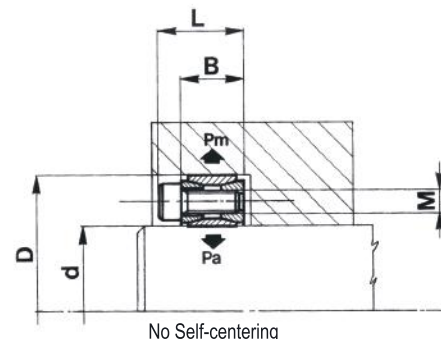

Type BK80 fixing bushings

Code	Dimensions							
	d	D	D1	D2	A	A1	B	L
mm								
028BK801016	10	16	28	25	14	9	26	30
028BK801218	12	18	32	28	14	9	26	31
028BK801423	14	23	38	33	14	9	26	31
028BK801524	15	24	45	40	16	13	36	42
028BK801624	16	24	45	40	16	13	36	42
028BK801725	17	25	45	40	16	13	36	42
028BK801826	18	26	47	42	18	13	38	44
028BK801927	19	27	49	43	18	13	38	44
028BK802028	20	28	49	45	18	13	38	44
028BK802232	22	32	54	49	25	13	45	51
028BK802434	24	34	56	51	25	13	45	51
028BK802534	25	34	56	51	25	13	45	51
028BK802839	28	39	61	56	25	13	45	51
028BK803041	30	41	62	57	25	13	45	51
028BK803243	32	43	65	59	30	13	50	56
028BK803547	35	47	69	64	30	13	50	56
028BK803850	38	50	72	67	30	13	50	56
028BK804053	40	53	75	70	30	13	50	56
028BK804255	42	55	78	73	40	17	65	73
028BK804559	45	59	85	79	40	17	65	73
028BK804862	48	62	87	82	45	17	70	78
028BK805065	50	65	92	85	45	17	70	78
028BK805571	55	71	98	92	50	17	75	83
028BK806077	60	77	104	98	50	17	75	83
028BK806584	65	84	111	105	50	17	75	83
028BK807090	70	90	119	114	60	20	91	101
028BK807595	75	95	126	120	60	20	91	101
028BK8080100	80	100	131	125	70	20	101	111
028BK8085106	85	106	137	131	70	20	101	111
028BK8090112	90	112	143	137	70	20	101	111
028BK8095120	95	120	153	146	70	20	101	111
028BK80100125	100	125	162	155	80	24	117	129
028BK80110140	110	140	175	167	70	24	107	119
028BK80120155	120	155	195	187	90	24	127	139
028BK80130165	130	165	205	197	90	24	127	139

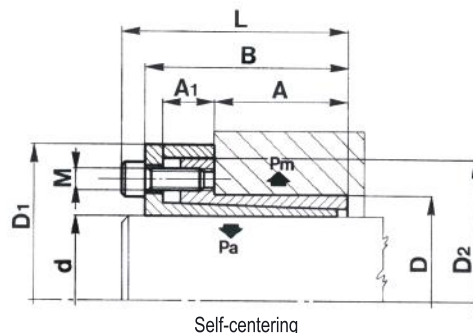

Precision axial positioning

TRANSMISSION ELEMENTS

>>> Fixing bushings

At www.rodavigo.net

Family: Transmission elements
Product: Fixing bushings

Type BK50 fixing bushings

Code	Dimensions			Code	Dimensions		
	d	D	L		d	D	L
	mm				mm		
028BK501013	10	13	4,5	028BK504552	45	52	10,0
028BK501215	12	15	4,5	028BK504855	48	55	10,0
028BK501316	13	16	4,5	028BK505057	50	57	10,0
028BK501418	14	18	6,3	028BK505562	55	62	10,0
028BK501519	15	19	6,3	028BK505664	56	64	12,0
028BK501620	16	20	6,3	028BK506068	60	68	12,0
028BK501721	17	21	6,3	028BK506371	63	71	12,0
028BK501822	18	22	6,3	028BK506573	65	73	12,0
028BK501924	19	24	6,3	028BK507079	70	79	14,0
028BK502025	20	25	6,3	028BK507180	71	80	14,0
028BK502226	22	26	6,3	028BK507584	75	84	14,0
028BK502428	24	28	6,3	028BK508091	80	91	17,0
028BK502530	25	30	6,3	028BK508596	85	96	17,0
028BK502832	28	32	6,3	028BK5090101	90	101	17,0
028BK503035	30	35	6,3	028BK5095106	95	106	17,0
028BK503236	32	36	6,3	028BK50100114	100	114	21,0
028BK503540	35	40	7,0	028BK50110124	110	124	21,0
028BK503642	36	42	7,0	028BK50120134	120	134	21,0
028BK503844	38	44	7,0	028BK50130148	130	148	28,0
028BK504045	40	45	8,0	028BK50140158	140	158	28,0
028BK504248	42	48	8,0	028BK50150168	150	168	28,0

To transmit medium-weak torques

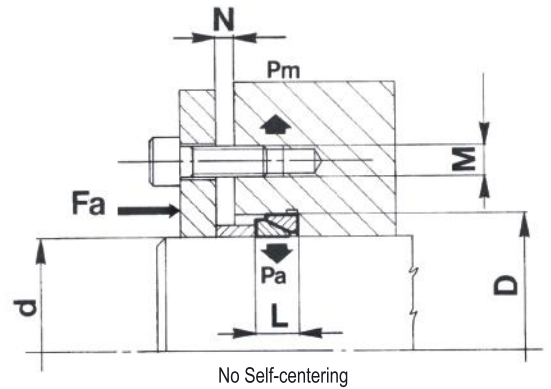

Type BK70 fixing bushings

Type BK25 clamping bushings

Code	Dimensions			
	d	D	B	L
	mm			
028BK701947	19	47	42	48
028BK702047	20	47	42	48
028BK702247	22	47	42	48
028BK702450	24	50	42	48
028BK702550	25	50	42	48
028BK702855	28	55	42	48
028BK703055	30	55	42	48
028BK703260	32	60	42	48
028BK703560	35	60	42	48
028BK703865	38	65	42	48
028BK704065	40	65	42	48
028BK704275	42	75	50	58
028BK704575	45	75	50	58
028BK704880	48	80	50	58
028BK705080	50	80	50	58
028BK705585	55	85	50	58
028BK706090	60	90	50	58
028BK706595	65	95	50	58
028BK7070110	70	110	60	70
028BK7075115	75	115	60	70
028BK7080120	80	120	60	70
028BK7085125	85	125	60	70
028BK7090130	90	130	60	70
028BK7095135	95	135	60	70
028BK70100145	100	145	68	80
028BK70110155	110	155	68	80
028BK70120165	120	165	68	80

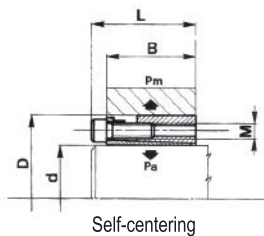

To transmit high torques

Code	Dimensions				
	d	D	D1	B	L
	mm				
028BK251425	14	25	32	6,5	16,5
028BK251525	15	25	32	6,5	16,5
028BK251625	16	25	32	6,5	16,5
028BK251725	17	25	32	6,5	16,5
028BK251830	18	30	38	6,5	16,5
028BK251930	19	30	38	6,5	18,0
028BK252030	20	30	38	6,5	18,0
028BK252235	22	35	38	6,5	18,0
028BK252435	24	35	45	6,5	18,0
028BK252535	25	35	45	6,5	18,0
028BK252840	28	40	52	6,5	18,0
028BK253040	30	40	52	8,0	19,5
028BK253245	32	45	58	8,0	21,5
028BK253545	35	45	58	8,0	21,5
028BK253650	36	50	65	8,0	21,5
028BK253850	38	50	65	8,0	21,5
028BK254050	40	50	64	10,0	25,5
028BK254255	42	55	70	10,0	25,5
028BK254555	45	55	70	10,0	25,5
028BK254860	48	60	75	10,0	25,5
028BK255060	50	60	75	10,0	25,5
028BK255565	55	65	80	12,0	27,5
028BK255668	56	68	80	12,0	27,5
028BK256070	60	70	85	12,0	28,5

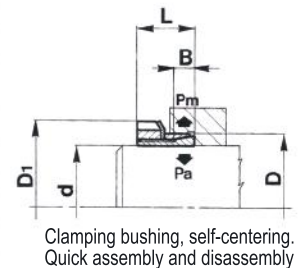



>>> Fixing bushings

Type BK26 clamping bushings

At www.rodavigo.net

Family: Transmission elements
Product: Fixing bushings

Type BK95 clamping bushings

Code	Dimensions				
	d	D	D1	B	L
	mm				
028BK261425	14	25	32	20	30
028BK261525	15	25	32	20	30
028BK261625	16	25	32	20	30
028BK261725	17	25	32	20	32
028BK261830	18	30	38	20	32
028BK261930	19	30	38	20	32
028BK262030	20	30	38	20	32
028BK262235	22	35	38	25	36
028BK262435	24	35	45	25	36
028BK262535	25	35	45	25	36
028BK262840	28	40	52	25	36
028BK263040	30	40	52	25	36
028BK263245	32	45	58	30	44
028BK263545	35	45	58	30	44
028BK263650	36	50	64	30	44
028BK263850	38	50	64	30	45
028BK264050	40	50	64	30	45
028BK264255	42	55	70	30	45
028BK264555	45	55	70	30	46
028BK264860	48	60	75	30	46
028BK265060	50	60	75	30	46
028BK265565	55	65	80	30	46
028BK265668	56	68	80	30	46
028BK266070	60	70	85	30	52

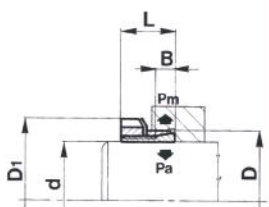

Clamping bushing, self-centering.
Quick assembly and disassembly

Code	Dimensions			
	d	D	B	L
	mm			
028BK951545	15	45	50	56
028BK951645	16	45	50	56
028BK951745	17	45	50	56
028BK951850	18	50	50	56
028BK951950	19	50	50	56
028BK952050	20	50	50	56
028BK952255	22	55	60	66
028BK952455	24	55	60	66
028BK952555	25	55	60	66
028BK952860	28	60	60	66
028BK953060	30	60	60	66
028BK953275	32	75	75	83
028BK953575	35	75	75	83
028BK953875	38	75	75	83
028BK954075	40	75	75	83
028BK954285	42	85	85	93
028BK954585	45	85	85	93
028BK954890	48	90	85	93
028BK955090	50	90	85	93
028BK955595	55	95	85	93
028BK9560100	60	100	85	93
028BK9565110	65	110	85	93
028BK9570120	70	120	100	110
028BK9580125	80	125	100	110

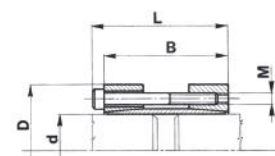

Rigid coupling

To connect the shaft ends.

Type BK19 clamping bushings

Code	Dimensions						
	dh8	ds	D	L	B	1	C
	mm						
							máx.
028BK192450	24	19	50	23	19	14	0,017
							20
							21
028BK193060	30	24	60	25	21	16	0,017
							25
							26
028BK193672	36	28	72	27	23	18	0,017
							30
							31
028BK194480	44	32	80	29	25	20	0,032
							35
							36
028BK195090	50	38	90	31	27	22	0,032
							40
							42
028BK1955100	55	42	100	34	30	23	0,032
							45
							48
028BK1962110	62	48	110	34	30	23	0,032
							50
							52
028BK1968115	68	50	115	34	30	23	0,038
							55
							60
028BK1980145	80	60	145	38	32	25	0,048
							65
							70
028BK19100170	100	70	170	49,5	44	34	0,048
							75
							80
028BK19125215	125	85	215	61	54	42	0,056
							90
							95

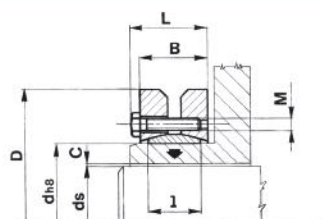

Outer Lock Clamping Bushing

Excellent concentricity.

Type BK11 clamping bushings

Code	Dimensions			
	d	D	B	L
	mm			
028BK114065	40	65	45	51
028BK114575	45	75	45	51
028BK114880	48	80	64	72
028BK115080	50	80	64	72
028BK115585	55	85	64	72
028BK116090	60	90	64	72
028BK116595	65	95	64	72
028BK1170110	70	110	78	88
028BK1175115	75	115	78	88
028BK1180120	80	120	78	88
028BK1185125	85	125	78	88
028BK1190130	90	130	78	88
028BK1195135	95	135	78	88
028BK11100145	100	145	100	112
028BK11110155	110	155	100	112
028BK11120165	120	165	100	112
028BK11130180	130	180	116	130
028BK11140190	140	190	116	130
028BK11150200	150	200	116	130
028BK11160210	160	210	116	130
028BK11170225	170	225	146	162
028BK11180235	180	235	146	162
028BK11190250	190	250	146	162
028BK11200260	200	260	146	162

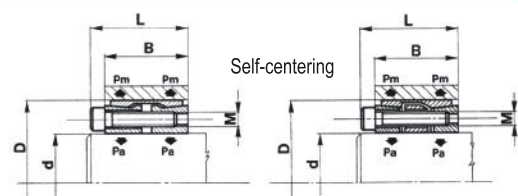

Self-centering

To transmit very high torques.

TRANSMISSION ELEMENTS

>>> Racks

At www.rodavigo.net Family: Transmission elements
Product: Racks

Racks

We have an extensive stock in our warehouses, so delivery would be immediate. We also inform you that under a drawing or sample we can offer you any type of sprocket, gear, pulley, rack... that may arise.

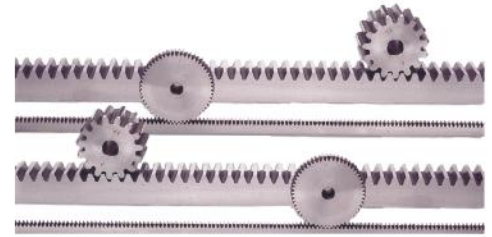
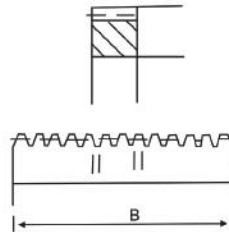

Racks
20° precision angle

On demand
- Rack of mod. from 7 to 12
- Rack of mod. from 1 to 12
with tilted teeth from 0 to 30° as max.

Code	Mod.	L	
		AxB	500
19511515500	1	15x15	500
195151717500	1,5	17x17	500
19522020500	2	20x20	500
-	-	-	-
195252525500	2,5	25x25	500
19533030500	3	30x30	500
-	-	-	-
-	-	-	-
-	-	-	-
19544040500	4	40x40	500
19555050500	5	50x50	500
-	-	-	-

Code	Mod.	L	
		AxB	1000
195115151000	1	15x15	1000
1951517171000	1,5	17x17	1000
195220201000	2	20x20	1000
195222221000	2	22x22	1000
1952525251000	2,5	25x25	1000
195330301000	3	30x30	1000
195420201000	4	20x20	1000
195430401000	4	30x40	1000
195440301000	4	40x30	1000
195435401000	4	35x40	1000
195440401000	4	40x40	1000
195550501000	5	50x50	1000
195660601000	6	60x60	1000

Code	Mod.	L	
		AxB	2000
195115152000	1	15x15	2000
1951517172000	1,5	17x17	2000
195220202000	2	20x20	2000
-	-	-	-
1952525252000	2,5	25x25	2000
195330302000	3	30x30	2000
-	-	-	2000
-	-	-	2000
-	-	-	2000
-	-	-	2000
195440402000	4	40x40	2000
195550502000	5	50x50	2000
195660602000	6	60x60	2000

>>> Transmission crosspieces

Crosspieces for agricultural applications

Crosspieces for homokinetic knots

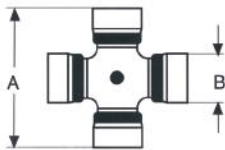

*Crosspieces without needles in the bearing.

Code	Dimensions		Model
	A	B	
mm			
0811*	44	19	
0812*	48	19	
0813	44	20	
0814	48	20	
081407	47	20	
081400	54	22	
081401	52	22	
081402*	54,8	22	02
081403	54,8	22	03
081840	61,2	23,8	
081404	61,2	24	
081405	66,2	24	04

Code	Dimensions		Model
	A	B	
mm			
081406	70	27	05
0812140A	74,5	27	35
0812224	76	32	06
0812150	80	30,2	36
0812226	89	36	07
0812200A	92	30,16	
0812200AB	92	30,2	
0812225	94	35	08
0812220A	106,3	30,16	
0812220AB	106,3	30,2	09
0812230	106,3	35	10
0812240A	115,9	39,7	

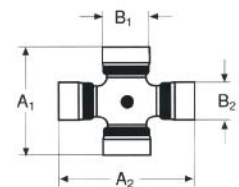

Code	Dimensions				Model
	A1	B1	A2	B2	
mm					
081621	75	27	91	24	05
081635	76	32	94	27	35
081636	89	36	106	32	36

>>> Chain discs

 At www.rodavigo.net Family: Transmission elements
 Product: Chain discs

8x3 mm discs 05B-1

Disc	mm	
Tooth radius r_3	8	For roller chain according to DIN 8187 ISO / R 606
Radius length C	0,8	
Tooth width B_1	2,8	
Tooth width b_1	2,7	
Tooth width B_2	8,3	
Chain	mm	
Pitch	8	
Inner width	3	
Roller - \varnothing	5	

From Z 51h-4,4mm

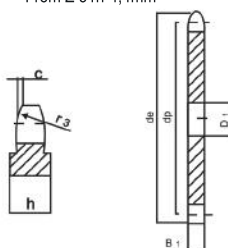

Code	Dimensions			
	Z	de	dp	S D1

mm				
1938P81	8	23,4	20,90	6
1939P81	9	25,9	23,39	6
19310P81	10	28,4	25,89	8
19311P81	11	31,0	28,39	8
19312P81	12	33,7	30,91	8
19313P81	13	36,7	33,42	8
19314P81	14	39,2	39,95	8
19315P81	15	41,7	38,48	8
19316P81	16	44,2	41,01	8
19317P81	17	46,7	45,53	8
19318P81	18	49,2	46,07	8
19319P81	19	51,7	48,61	8
19320P81	20	54,2	51,14	8
19321P81	21	57,2	53,67	10
19322P81	22	59,4	56,21	10
19323P81	23	62,2	58,75	10
19324P81	24	64,7	61,29	10
19325P81	25	67,2	63,83	10
19326P81	26	69,7	66,37	10
19327P81	27	72,3	68,91	10
19328P81	28	74,7	71,45	10
19329P81	29	77,2	73,99	10
19330P81	30	80,2	76,53	10
19331P81	31	82,7	79,08	10
19332P81	32	85,2	81,61	10
19333P81	33	87,7	84,16	10
19334P81	34	90,2	86,70	10
19335P81	35	92,7	89,24	10
19336P81	36	95,2	91,79	10
19337P81	37	97,7	94,33	12
19338P81	38	100,2	96,88	12
19339P81	39	102,7	99,42	12
19340P81	40	105,2	101,97	12
19341P81	41	108,4	104,51	12
19342P81	42	111,0	107,05	12
19343P81	43	113,5	109,60	

Code	Dimensions			
	Z	de	dp	S D1

mm				
19344P81	44	116,1	112,14	12
19345P81	45	118,6	114,69	12
19346P81	46	121,2	117,23	12
19347P81	47	123,7	119,77	
19348P81	48	126,4	122,32	12
19349P81	49	128,9	124,86	
19350P81	50	131,5	127,41	12
19351P81	51	134,0	129,95	
19352P81	52	136,6	132,49	16
19353P81	53	139,1	135,04	
19354P81	54	141,7	137,59	16
19355P81	55	144,2	140,13	16
19356P81	56	146,8	142,68	16
19357P81	57	149,3	145,22	16
19358P81	58	151,9	147,77	16
19359P81	59	154,4	150,31	
19360P81	60	157,1	152,85	16
19362P81	62	162,2	157,95	16
19364P81	64	167,3	163,04	16
19365P81	65	169,8	165,68	16
19366P81	66	172,4	168,13	16
19368P81	68	177,5	173,22	
19370P81	70	182,6	178,31	16
19372P81	72	187,7	183,41	
19375P81	75	195,3	191,04	20
19376P81	76	197,9	193,59	20
19378P81	78	203,0	198,68	
19380P81	80	208,1	203,77	20
19385P81	85	220,8	216,50	20
19390P81	90	233,6	229,23	20
19395P81	95	246,3	241,96	20
193100P81	100	259,1	254,68	20
193110P81	110	284,6	280,15	
193114P81	114	294,8	290,33	20
193120P81	120	310,1	350,61	20
193125P81	125	322,8	318,34	20

>>> Chain discs

At www.rodavigo.net

Family: Transmission elements
Product: Chain discs

8x3 mm discs 05B-2

Disc	mm	For roller chain according to DIN 8187 ISO / R 606
Tooth radius r_s	8	
Radius length C	0,8	
Tooth width B_1	2,8	
Tooth width b_1	2,7	
Tooth width B_2	8,3	
Chain	mm	
Pitch	8	
Inner width	3	
Roller - \varnothing	5	

From Z 51h-4,4mm

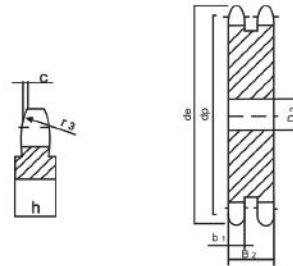

Code	Dimensions			
	Z	d _e	d _p	D D ₂
mm				
1938P82	8	23,4	20,90	8
1939P82	9	25,9	23,39	8
19310P82	10	28,4	25,89	8
19311P82	11	31,0	28,39	8
19312P82	12	33,7	30,91	8
19313P82	13	36,7	33,42	8
19314P82	14	39,2	39,95	8
19315P82	15	41,7	38,48	8
19316P82	16	44,2	41,01	10
19317P82	17	46,7	45,53	10
19318P82	18	49,2	46,07	10
19319P82	19	51,7	48,61	10
19320P82	20	54,2	51,14	10
19321P82	21	57,2	53,67	10
19322P82	22	59,4	56,21	10
19323P82	23	62,2	58,75	10
19324P82	24	64,7	61,29	10
19325P82	25	67,2	63,83	10
19326P82	26	69,7	66,37	12
19327P82	27	72,3	68,91	12
19328P82	28	74,7	71,45	12
19329P82	29	77,2	73,99	
19330P82	30	80,2	76,53	12
19331P82	31	82,7	79,08	
19332P82	32	85,2	81,61	12
19333P82	33	87,7	84,16	
19334P82	34	90,2	86,70	12
19335P82	35	92,7	89,24	12
19336P82	36	95,2	91,79	12
19337P82	37	97,7	94,33	
19338P82	38	100,2	96,88	12
19339P82	39	102,7	99,42	
19340P82	40	105,2	101,97	12
19341P82	41	108,4	104,51	
19342P82	42	111,0	107,05	
19343P82	43	113,5	109,60	
19344P82	44	116,1	112,14	
19345P82	45	118,6	114,69	
19346P82	46	121,2	117,23	16
19347P82	47	123,7	119,77	
19348P82	48	126,4	122,32	16
19349P82	49	128,9	124,86	
19350P82	50	131,5	127,41	16
19351P82	51	134,0	129,95	

Code	Dimensions			
	Z	d _e	d _p	D D ₂
mm				
19352P82	52	136,6	132,49	16
19353P82	53	139,1	135,04	
19354P82	54	141,7	137,59	
19355P82	55	144,2	140,13	16
19356P82	56	146,8	142,68	16
19357P82	57	149,3	145,22	16
19358P82	58	151,9	147,77	
19359P82	59	154,4	150,31	
19360P82	60	157,1	152,85	16
19362P82	62	162,2	157,95	
19364P82	64	167,3	163,04	
19365P82	65	169,8	165,68	20
19366P82	66	172,4	168,13	
19368P82	68	177,5	173,22	20
19370P82	70	182,6	178,31	20
19372P82	72	187,7	183,41	
19375P82	75	195,3	191,04	
19376P82	76	197,9	193,59	20
19378P82	78	203,0	198,68	
19380P82	80	208,1	203,77	20
19385P82	85	220,8	216,50	
19390P82	90	233,6	229,23	
19395P82	95	246,3	241,96	
193100P82	100	259,1	254,68	
193110P82	110	284,6	280,15	
193114P82	114	294,8	290,33	20
193120P82	120	310,1	350,61	
193125P82	125	322,8	318,34	



>>> Chain discs

Discs 3/8"x7/32" 9,525x5,72 mm. 06B-1

At www.rodavigo.net Family: Transmission elements
Product: Chain discs

Disc	mm	
Tooth radius r_3	10	For roller chain according to DIN 8187 ISO / R 606
Radius length C	1	
Tooth width B_1	5,3	
Tooth width b_1	5,2	
Tooth width B_2	15,4	
Tooth width B_3	25,6	
Chain	mm	
Pitch	9,525	
Inner width	5,72	
Roller - \varnothing	6,35	

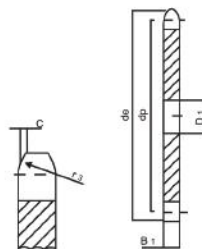

Code	Dimensions				Code	Dimensions			
	Z	d _e	d _p	S D ₁		Z	d _e	D _p	S D ₁
mm					mm				
1938381	8	28,6	24,89	6	19344381	44	138,1	133,52	16
1939381	9	31,5	27,85	8	19345381	45	141,1	136,54	16
19310381	10	34,5	30,82	8	19346381	46	144,2	139,58	16
19311381	11	37,5	33,80	8	19347381	47	147,2	142,61	16
19312381	12	40,5	36,80	8	19348381	48	150,2	145,64	16
19313381	13	43,5	39,80	8	19349381	49	153,3	148,66	16
19314381	14	46,5	42,80	8	19350381	50	156,3	151,69	16
19315381	15	49,5	45,81	8	19351381	51	159,3	154,72	20
19316381	16	52,5	48,82	10	19352381	52	162,4	157,75	20
19317381	17	55,5	51,83	10	19353381	53	165,4	160,78	20
19318381	18	58,6	54,85	10	19354381	54	168,4	163,82	20
19319381	19	61,6	57,87	10	19355381	55	171,4	166,85	20
19320381	20	64,6	60,89	10	19356381	56	174,5	169,88	20
19321381	21	67,6	63,91	10	19357381	57	177,5	172,91	20
19322381	22	70,6	66,93	10	19358381	58	180,5	175,93	20
19323381	23	73,7	69,95	10	19359381	59	183,6	178,96	
19324381	24	76,7	72,97	10	19360381	60	186,6	181,99	20
19325381	25	79,7	76,00	10	19362381	62	192,7	188,06	20
19326381	26	82,7	79,02	10	19364381	64	198,7	194,12	20
19327381	27	85,7	82,04	10	19365381	65	201,8	197,15	20
19328381	28	88,8	85,07	10	19366381	66	204,8	200,18	20
19329381	29	91,8	88,09	10	19368381	68	210,8	206,24	20
19330381	30	94,8	91,12	10	19370381	70	216,9	212,30	20
19331381	31	97,9	94,15	12	19372381	72	223,0	218,37	20
19332381	32	100,9	97,17	12	19375381	75	232,1	227,46	20
19333381	33	103,9	100,20	12	19376381	76	235,1	230,49	20
19334381	34	106,9	103,23	12	19378381	78	241,2	236,55	
19335381	35	110,0	106,26	12	19380381	80	247,2	242,61	20
19336381	36	113,0	109,29	12	19385381	85	262,4	257,77	25
19337381	37	116,0	112,32	12	19390381	90	277,5	272,93	25
19338381	38	119,0	115,34	12	19395381	95	292,7	288,08	25
19339381	39	122,1	118,37	12	193100381	100	307,8	303,25	25
19340381	40	125,1	121,40	12	193110381	110	338,2	335,55	25
19341381	41	129,0	124,43	16	193114381	114	350,3	245,68	25
19342381	42	132,1	127,46	16	193120381	120	368,5	363,86	25
19343381	43	135,1	130,49	16	193125381	125	383,6	379,02	25

>>> Chain discs

At www.rodavigo.net

Family: Transmission elements
Product: Chain discs

Discs 3/8"x7/32" 9,525x5,72 mm. 06B-2

Disc	mm	For roller chain according to DIN 8187 ISO / R 606
Tooth radius r_3	10	
Radius length C	1	
Tooth width B_1	5,3	
Tooth width b_1	5,2	
Tooth width B_2	15,4	
Tooth width B_3	25,6	
Chain	mm	
Pitch	9,525	
Inner width	5,72	
Roller - \varnothing	6,35	

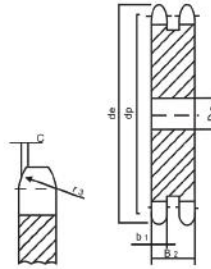

Code	Dimensions			
	Z	de	dp	D D2
mm				
1938382	8	28,6	24,89	8
1939382	9	31,5	27,85	8
19310382	10	34,5	30,82	8
19311382	11	37,5	33,80	10
19312382	12	40,5	36,80	10
19313382	13	43,5	39,80	10
19314382	14	46,5	42,80	10
19315382	15	49,5	45,81	10
19316382	16	52,5	48,82	12
19317382	17	55,5	51,83	12
19318382	18	58,6	54,85	12
19319382	19	61,6	57,87	12
19320382	20	64,6	60,89	12
19321382	21	67,6	63,91	12
19322382	22	70,6	66,93	12
19323382	23	73,7	69,95	12
19324382	24	76,7	72,97	12
19325382	25	79,7	76,00	12
19326382	26	82,7	79,02	16
19327382	27	85,7	82,04	16
19328382	28	88,8	85,07	16
19329382	29	91,8	88,09	16
19330382	30	94,8	91,12	16
19331382	31	97,9	94,15	16
19332382	32	100,9	97,17	16
19333382	33	103,9	100,20	16
19334382	34	106,9	103,23	16
19335382	35	110,0	106,26	16
19336382	36	113,0	109,29	16
19337382	37	116,0	112,32	16
19338382	38	119,0	115,34	16
19339382	39	122,1	118,37	16
19340382	40	125,1	121,40	16
19341382	41	129,0	124,43	20
19342382	42	132,1	127,46	20
19343382	43	135,1	130,49	20

Code	Dimensions			
	Z	de	dp	D D2
mm				
19344382	44	138,1	133,52	20
19345382	45	141,1	136,54	20
19346382	46	144,2	139,58	20
19347382	47	147,2	142,61	
19348382	48	150,2	145,64	20
19349382	49	153,3	148,66	20
19350382	50	156,3	151,69	20
19351382	51	159,3	154,72	20
19352382	52	162,4	157,75	20
19353382	53	165,4	160,78	20
19354382	54	168,4	163,82	20
19355382	55	171,4	166,85	20
19356382	56	174,5	169,88	20
19357382	57	177,5	172,91	20
19358382	58	180,5	175,93	20
19359382	59	183,6	178,96	
19360382	60	186,6	181,99	20
19362382	62	192,7	188,06	25
19364382	64	198,7	194,12	25
19365382	65	201,8	197,15	25
19366382	66	204,8	200,18	
19368382	68	210,8	206,24	25
19370382	70	216,9	212,30	25
19372382	72	223,0	218,37	25
19375382	75	232,1	227,46	25
19376382	76	235,1	230,49	25
19378382	78	241,2	236,55	25
19380382	80	247,2	242,61	25
19385382	85	262,4	257,77	25
19390382	90	277,5	272,93	25
19395382	95	292,7	288,08	25
193100382	100	307,8	303,25	25
193110382	110	338,2	335,55	25
193114382	114	350,3	245,68	25
193120382	120	368,5	363,86	25
193125382	125	383,6	379,02	25



>>> Chain discs

Discs 3/8"x7/32" 9,525x5,72 mm. 06B-3

At www.rodavigo.net Family: Transmission elements
Product: Chain discs

Disc	mm	
Tooth radius r_3	10	For roller chain according to DIN 8187 ISO / R 606
Radius length C	1	
Tooth width B_1	5,3	
Tooth width b_1	5,2	
Tooth width B_2	15,4	
Tooth width B_3	25,6	
Chain	mm	
Pitch	9,525	
Inner width	5,72	
Roller \varnothing	6,35	

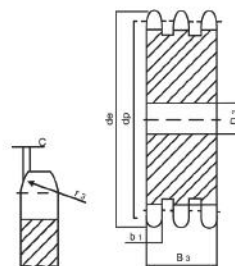

Code	Dimensions			
	Z	d_e	d_p	T D ₃
mm				
1938383	8	28,6	24,89	8
1939383	9	31,5	27,85	8
19310383	10	34,5	30,82	10
19311383	11	37,5	33,80	12
19312383	12	40,5	36,80	12
19313383	13	43,5	39,80	12
19314383	14	46,5	42,80	12
19315383	15	49,5	45,81	12
19316383	16	52,5	48,82	12
19317383	17	55,5	51,83	12
19318383	18	58,6	54,85	12
19319383	19	61,6	57,87	12
19320383	20	64,6	60,89	16
19321383	21	67,6	63,91	16
19322383	22	70,6	66,93	16
19323383	23	73,7	69,95	16
19324383	24	76,7	72,97	16
19325383	25	79,7	76,00	16
19326383	26	82,7	79,02	16
19327383	27	85,7	82,04	16
19328383	28	88,8	85,07	16
19329383	29	91,8	88,09	16
19330383	30	94,8	91,12	16
19331383	31	97,9	94,15	16
19332383	32	100,9	97,17	16
19333383	33	103,9	100,20	20
19334383	34	106,9	103,23	20
19335383	35	110,0	106,26	20
19336383	36	113,0	109,29	20
19337383	37	116,0	112,32	20
19338383	38	119,0	115,34	20
19339383	39	122,1	118,37	20
19340383	40	125,1	121,40	20
19341383	41	129,0	124,43	20
19342383	42	132,1	127,46	20
19343383	43	135,1	130,49	20

Code	Dimensions			
	Z	d_e	D_p	T D ₃
mm				
19344383	44	138,1	133,52	20
19345383	45	141,1	136,54	20
19346383	46	144,2	139,58	20
19347383	47	147,2	142,61	20
19348383	48	150,2	145,64	20
19349383	49	153,3	148,66	20
19350383	50	156,3	151,69	20
19351383	51	159,3	154,72	20
19352383	52	162,4	157,75	20
19353383	53	165,4	160,78	20
19354383	54	168,4	163,82	20
19355383	55	171,4	166,85	20
19356383	56	174,5	169,88	20
19357383	57	177,5	172,91	25
19358383	58	180,5	175,93	25
19359383	59	183,6	178,96	25
19360383	60	186,6	181,99	25
19362383	62	192,7	188,06	25
19364383	64	198,7	194,12	25
19365383	65	201,8	197,15	25
19366383	66	204,8	200,18	25
19368383	68	210,8	206,24	25
19370383	70	216,9	212,30	25
19372383	72	223,0	218,37	25
19375383	75	232,1	227,46	25
19376383	76	235,1	230,49	25
19378383	78	241,2	236,55	25
19380383	80	247,2	242,61	25
19385383	85	262,4	257,77	25
19390383	90	277,5	272,93	25
19395383	95	292,7	288,08	25
193100383	100	307,8	303,25	25
193110383	110	338,2	335,55	25
193114383	114	350,3	345,68	25
193120383	120	368,5	363,86	25
193125383	125	383,6	379,02	25

>>> Chain discs

At www.rodavigo.net

Family: Transmission elements
Product: Chain discs

Discs 1/2"x5/16" 12,7x7,75 mm. 08B-1

Disc	mm	
Tooth radius r_3	13	For roller chain according to DIN 8187 ISO / R 606
Radius length C	1,3	
Tooth width B_1	7,2	
Tooth width b_1	7	
Tooth width B_2	21	
Tooth width B_3	34,9	
Chain	mm	
Pitch	12,7	
Inner width	7,75	
Roller - \varnothing	8,51	

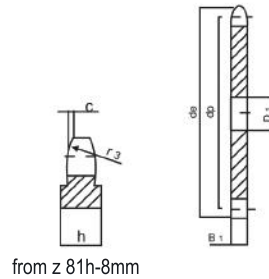

Code	Dimensions			
	Z	d _e	d _p	S D ₁
mm				
1938121	8	38,0	33,18	8
1939121	9	42,0	37,13	8
19310121	10	45,9	41,10	8
19311121	11	49,9	45,07	10
19312121	12	53,9	49,07	10
19313121	13	57,9	53,06	10
19314121	14	61,9	57,07	10
19315121	15	65,9	61,09	10
19316121	16	69,9	65,10	10
19317121	17	74,0	69,11	10
19318121	18	78,0	73,14	10
19319121	19	82,0	77,16	10
19320121	20	86,0	81,19	10
19321121	21	90,1	85,22	12
19322121	22	94,1	89,24	12
19323121	23	98,1	93,27	10
19324121	24	102,1	97,29	12
19325121	25	106,2	101,33	12
19326121	26	110,2	105,36	16
19327121	27	114,2	109,40	16
19328121	28	118,3	113,42	16
19329121	29	122,3	117,46	16
19330121	30	126,3	121,50	16
19331121	31	130,4	125,54	16
19332121	32	134,4	129,56	16
19333121	33	138,4	133,60	16
19334121	34	142,5	137,64	16
19335121	35	146,5	141,68	16
19336121	36	150,6	145,72	16
19337121	37	154,6	149,76	16
19338121	38	158,6	153,80	16
19339121	39	162,7	157,83	16
19340121	40	166,7	161,87	16
19341121	41	172,4	165,91	20
19342121	42	176,5	169,95	20
19343121	43	180,5	173,99	20

Code	Dimensions			
	Z	d _e	d _p	S D ₁
mm				
19344121	44	184,6	178,03	20
19345121	45	188,6	182,07	20
19346121	46	192,6	186,10	20
19347121	47	196,7	190,14	20
19348121	48	200,7	194,18	20
19349121	49	204,8	198,22	20
19350121	50	208,8	202,26	20
19351121	51	212,8	206,30	20
19352121	52	216,9	210,34	20
19353121	53	220,9	214,37	20
19354121	54	225,0	218,43	20
19355121	55	229,0	222,46	20
19356121	56	233,0	226,50	20
19357121	57	237,1	230,54	20
19358121	58	241,1	234,58	20
19359121	59	245,2	238,62	
19360121	60	249,2	242,66	20
19362121	62	257,3	250,75	25
19364121	64	265,4	258,82	25
19365121	65	269,4	262,86	25
19366121	66	273,0	266,90	25
19368121	68	281,5	274,99	25
19370121	70	289,6	283,07	25
19372121	72	297,7	291,16	25
19375121	75	309,8	303,27	25
19376121	76	313,9	307,33	25
19378121	78	321,9	315,40	25
19380121	80	330,0	323,48	25
19385121	85	350,2	343,69	25
19390121	90	370,4	363,90	25
19395121	95	390,7	384,11	25
193100121	100	410,9	404,31	25
193110121	110	451,3	444,74	25
193114121	114	467,4	460,90	25
193120121	120	491,7	491,7	25
193125121	125	511,9	511,0	25



>>> Chain discs

Discs 1/2"x5/16" 12,7x7,75 mm. 08B-2

At www.rodavigo.net Family: Transmission elements
Product: Chain discs

Disc	mm	
Tooth radius r_3	13	For roller chain according to DIN 8187 ISO / R 606
Radius length C	1,3	
Tooth width B_1	7,2	
Tooth width b_1	7	
Tooth width B_2	21	
Tooth width B_3	34,9	
Chain	mm	
Pitch	12,7	
Inner width	7,75	
Roller - \varnothing	8,51	

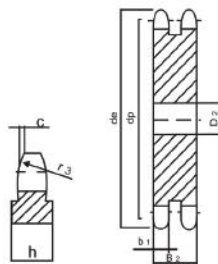

from z 81h-8mm

Code	Dimensions			
	Z	de	dp	D D2
mm				
1938122	8	38,0	33,18	10
1939122	9	42,0	37,13	10
19310122	10	45,9	41,10	10
19311122	11	49,9	45,07	10
19312122	12	53,9	49,07	10
19313122	13	57,9	53,06	10
19314122	14	61,9	57,07	10
19315122	15	65,9	61,09	10
19316122	16	69,9	65,10	12
19317122	17	74,0	69,11	12
19318122	18	78,0	73,14	12
19319122	19	82,0	77,16	12
19320122	20	86,0	81,19	12
19321122	21	90,1	85,22	16
19322122	22	94,1	89,24	16
19323122	23	98,1	93,27	16
19324122	24	102,1	97,29	16
19325122	25	106,2	101,33	16
19326122	26	110,2	105,36	16
19327122	27	114,2	109,40	16
19328122	28	118,3	113,42	16
19329122	29	122,3	117,46	16
19330122	30	126,3	121,50	16
19331122	31	130,4	125,54	16
19332122	32	134,4	129,56	16
19333122	33	138,4	133,60	16
19334122	34	142,5	137,64	16
19335122	35	146,5	141,68	16
19336122	36	150,6	145,72	20
19337122	37	154,6	149,76	20
19338122	38	158,6	153,80	20
19339122	39	162,7	157,83	20
19340122	40	166,7	161,87	20
19341122	41	172,4	165,91	20
19342122	42	176,5	169,95	20
19343122	43	180,5	173,99	20

Code	Dimensions			
	Z	de	dp	D D2
mm				
19344122	44	184,6	178,03	20
19345122	45	188,6	182,07	20
19346122	46	192,6	186,10	20
19347122	47	196,7	190,14	20
19348122	48	200,7	194,18	20
19349122	49	204,8	198,22	20
19350122	50	208,8	202,26	20
19351122	51	212,8	206,30	25
19352122	52	216,9	210,34	25
19353122	53	220,9	214,37	25
19354122	54	225,0	218,43	25
19355122	55	229,0	222,46	25
19356122	56	233,0	226,50	25
19357122	57	237,1	230,54	25
19358122	58	241,1	234,58	25
19359122	59	245,2	238,62	
19360122	60	249,2	242,66	25
19362122	62	257,3	250,75	25
19364122	64	265,4	258,82	25
19365122	65	269,4	262,86	25
19366122	66	273,0	266,90	
19368122	68	281,5	274,99	25
19370122	70	289,6	283,07	25
19372122	72	297,7	291,16	25
19375122	75	309,8	303,27	25
19376122	76	313,9	307,33	25
19378122	78	321,9	315,40	
19380122	80	330,0	323,48	25
19385122	85	350,2	343,69	25
19390122	90	370,4	363,90	25
19395122	95	390,7	384,11	25
193100122	100	410,9	404,31	25
193110122	110	451,3	444,74	25
193114122	114	467,4	460,90	25
193120122	120	491,7	491,7	25
193125122	125	511,9	511,0	25

>>> Chain discs

At www.rodavigo.net Family: Transmission elements
Product: Chain discs

Discs 1/2"x5/16" 12,7x7,75 mm. 08B-3

Disc	mm
Tooth radius r_3	13
Radius length C	1,3
Tooth width B_1	7,2
Tooth width b_1	7
Tooth width B_2	21
Tooth width B_3	34,9
Chain	mm
Pitch	12,7
Inner width	7,75
Roller - \varnothing	8,51

For roller chain
according to DIN 8187 ISO / R 606

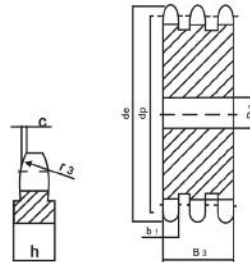

from z 81h-8mm

Code	Dimensions			
	Z	de	dp	T D ₃
mm				
1938123	8	38,0	33,18	10
1939123	9	42,0	37,13	10
19310123	10	45,9	41,10	10
19311123	11	49,9	45,07	12
19312123	12	53,9	49,07	12
19313123	13	57,9	53,06	12
19314123	14	61,9	57,07	12
19315123	15	65,9	61,09	12
19316123	16	69,9	65,10	16
19317123	17	74,0	69,11	16
19318123	18	78,0	73,14	16
19319123	19	82,0	77,16	16
19320123	20	86,0	81,19	16
19321123	21	90,1	85,22	16
19322123	22	94,1	89,24	16
19323123	23	98,1	93,27	16
19324123	24	102,1	97,29	16
19325123	25	106,2	101,33	16
19326123	26	110,2	105,36	16
19327123	27	114,2	109,40	16
19328123	28	118,3	113,42	16
19329123	29	122,3	117,46	16
19330123	30	126,3	121,50	16
19331123	31	130,4	125,54	20
19332123	32	134,4	129,56	20
19333123	33	138,4	133,60	20
19334123	34	142,5	137,64	20
19335123	35	146,5	141,68	20
19336123	36	150,6	145,72	20
19337123	37	154,6	149,76	
19338123	38	158,6	153,80	20
19339123	39	162,7	157,83	
19340123	40	166,7	161,87	20
19341123	41	172,4	165,91	
19342123	42	176,5	169,95	25
19343123	43	180,5	173,99	25

Code	Dimensions			
	Z	de	dp	T D ₃
mm				
19344123	44	184,6	178,03	25
19345123	45	188,6	182,07	25
19346123	46	192,6	186,10	25
19347123	47	196,7	190,14	25
19348123	48	200,7	194,18	25
19349123	49	204,8	198,22	25
19350123	50	208,8	202,26	25
19351123	51	212,8	206,30	
19352123	52	216,9	210,34	25
19353123	53	220,9	214,37	25
19354123	54	225,0	218,43	25
19355123	55	229,0	222,46	25
19356123	56	233,0	226,50	25
19357123	57	237,1	230,54	25
19358123	58	241,1	234,58	
19359123	59	245,2	238,62	
19360123	60	249,2	242,66	25
19362123	62	257,3	250,75	25
19364123	64	265,4	258,82	25
19365123	65	269,4	262,86	25
19366123	66	273,0	266,90	
19368123	68	281,5	274,99	25
19370123	70	289,6	283,07	25
19372123	72	297,7	291,16	25
19375123	75	309,8	303,27	25
19376123	76	313,9	307,33	25
19378123	78	321,9	315,40	25
19380123	80	330,0	323,48	25
19385123	85	350,2	343,69	25
19390123	90	370,4	363,90	25
19395123	95	390,7	384,11	25
193100123	100	410,9	404,31	25
193110123	110	451,3	444,74	25
193114123	114	467,4	460,90	25
193120123	120	491,7	491,7	
193125123	125	511,9	511,0	25



>>> Chain discs

Discs 5/8"x3/8" 15,875x9,65 mm. 10B-1

At www.rodavigo.net Family: Transmission elements
Product: Chain discs

Disc	mm
Tooth radius r_3	16
Radius length C	1,6
Tooth width B_1	9,1
Tooth width b_1	9
Tooth width B_2	25,5
Tooth width B_3	42,1
Chain	mm
Pitch	15,875
Inner width	9,65
Roller - \varnothing	10,16

For roller chain
according to DIN 8187 ISO / R 606

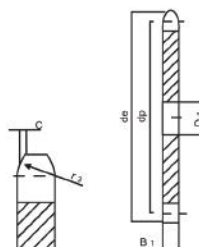

from z 111h-10mm

Code	Dimensions			
	Z	de	dp	S D1
	mm			
1938581	8	48,4	41,48	10
1939581	9	53,3	46,42	10
19310581	10	58,3	51,37	10
19311581	11	63,2	56,34	10
19312581	12	68,2	61,34	10
19313581	13	73,2	66,32	10
19314581	14	78,2	71,34	12
19315581	15	83,2	76,36	12
19316581	16	88,2	81,37	12
19317581	17	93,3	86,39	12
19318581	18	98,3	91,42	12
19319581	19	103,3	96,45	12
19320581	20	108,4	101,49	12
19321581	21	113,4	106,52	12
19322581	22	118,4	111,55	12
19323581	23	123,5	116,58	12
19324581	24	128,5	121,62	12
19325581	25	133,6	126,66	12
19326581	26	138,6	131,70	16
19327581	27	143,6	136,75	16
19328581	28	148,7	141,78	16
19329581	29	153,7	146,83	16
19330581	30	158,8	151,87	16
19331581	31	163,8	156,92	16
19332581	32	168,9	161,95	16
19333581	33	173,9	167,00	16
19334581	34	178,9	172,05	16
19335581	35	184,0	177,10	16
19336581	36	189,0	182,15	20
19337581	37	194,1	187,20	20
19338581	38	199,1	192,24	20
19339581	39	204,2	197,29	20
19340581	40	209,2	202,34	20
19341581	41	215,8	207,39	20
19342581	42	220,8	212,44	20
19343581	43	225,9	217,49	20

Code	Dimensions			
	Z	de	Dp	S D1
	mm			
19344581	44	230,9	222,53	20
19345581	45	236,0	227,58	20
19346581	46	241,0	236,63	20
19347581	47	246,1	237,68	20
19348581	48	251,1	242,73	20
19349581	49	256,2	247,78	20
19350581	50	261,2	252,82	20
19351581	51	266,3	257,87	20
19352581	52	271,3	262,92	20
19353581	53	276,4	267,97	20
19354581	54	281,4	273,03	20
19355581	55	286,5	278,08	20
19356581	56	291,5	283,13	25
19357581	57	296,6	288,18	25
19358581	58	301,6	293,23	25
19359581	59	306,7	298,28	
19360581	60	311,7	303,32	25
19362581	62	321,8	313,43	25
19364581	64	331,9	323,53	25
19365581	65	337,0	328,58	25
19366581	66	342,0	333,63	
19368581	68	352,1	343,74	25
19370581	70	362,2	353,84	25
19372581	72	372,3	363,95	25
19375581	75	387,5	379,09	25
19376581	76	392,5	384,16	25
19378581	78	402,6	394,25	25
19380581	80	412,7	404,35	25
19385581	85	438,0	429,62	30
19390581	90	463,3	454,88	30
19395581	95	488,5	480,14	30
193100581	100	513,8	505,40	30
193110581	110	564,3	555,92	30
193114581	114	584,5	576,13	30
193120581	120	614,8	606,44	30
193125581	125	640,1	631,71	30

>>> Chain discs

At www.rodavigo.net Family: Transmission elements
Product: Chain discs

Discs 5/8"x3/8" 15,875x9,65 mm. 10B-2

Disc	mm
Tooth radius r_3	16
Radius length C	1,6
Tooth width B_1	9,1
Tooth width b_1	9
Tooth width B_2	25,5
Tooth width B_3	42,1
Chain	mm
Pitch	15,875
Inner width	9,65
Roller - \varnothing	10,16

For roller chain
according to DIN 8187 ISO / R 606

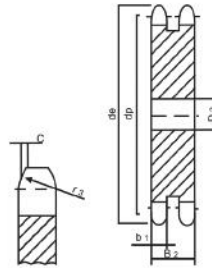

Code	Dimensions			
	Z	de	dp	D D2
mm				
1938582	8	48,4	41,48	10
1939582	9	53,3	46,42	10
19310582	10	58,3	51,37	10
19311582	11	63,2	56,34	10
19312582	12	68,2	61,34	10
19313582	13	73,2	66,32	10
19314582	14	78,2	71,34	10
19315582	15	83,2	76,36	12
19316582	16	88,2	81,37	12
19317582	17	93,3	86,39	12
19318582	18	98,3	91,42	12
19319582	19	103,3	96,45	12
19320582	20	108,4	101,49	12
19321582	21	113,4	106,52	16
19322582	22	118,4	111,55	16
19323582	23	123,5	116,58	16
19324582	24	128,5	121,62	16
19325582	25	133,6	126,66	16
19326582	26	138,6	131,70	20
19327582	27	143,6	136,75	20
19328582	28	148,7	141,78	20
19329582	29	153,7	146,83	20
19330582	30	158,8	151,87	20
19331582	31	163,8	156,92	20
19332582	32	168,9	161,95	20
19333582	33	173,9	167,00	20
19334582	34	178,9	172,05	20
19335582	35	184,0	177,10	20
19336582	36	189,0	182,15	20
19337582	37	194,1	187,20	20
19338582	38	199,1	192,24	20
19339582	39	204,2	197,29	20
19340582	40	209,2	202,34	20
19341582	41	215,8	207,39	25
19342582	42	220,8	212,44	25
19343582	43	225,9	217,49	25

Code	Dimensions			
	Z	de	Dp	D D2
mm				
19344582	44	230,9	222,53	25
19345582	45	236,0	227,58	25
19346582	46	241,0	236,63	25
19347582	47	246,1	237,68	25
19348582	48	251,1	242,73	25
19349582	49	256,2	247,78	25
19350582	50	261,2	252,82	25
19351582	51	266,3	257,87	25
19352582	52	271,3	262,92	25
19353582	53	276,4	267,97	25
19354582	54	281,4	273,03	25
19355582	55	286,5	278,08	25
19356582	56	291,5	283,13	25
19357582	57	296,6	288,18	25
19358582	58	301,6	293,23	25
19359582	59	306,7	298,28	25
19360582	60	311,7	303,32	25
19362582	62	321,8	313,43	25
19364582	64	331,9	323,53	25
19365582	65	337,0	328,58	25
19366582	66	342,0	333,63	25
19368582	68	352,1	343,74	25
19370582	70	362,2	353,84	25
19372582	72	372,3	363,95	25
19375582	75	387,5	379,09	25
19376582	76	392,5	384,16	25
19378582	78	402,6	394,25	25
19380582	80	412,7	404,35	25
19385582	85	438,0	429,62	30
19390582	90	463,3	454,88	30
19395582	95	488,5	480,14	30
193100582	100	513,8	505,40	30
193110582	110	564,3	555,92	30
193114582	114	584,5	576,13	30
193120582	120	614,8	606,44	30
193125582	125	640,1	631,71	30



>>> Chain discs

Discs 5/8"x3/8" 15,875x9,65 mm. 10B-3

At www.rodavigo.net Family: Transmission elements
Product: Chain discs

Disc	mm
Tooth radius r_3	16
Radius length C	1,6
Tooth width B_1	9,1
Tooth width b_1	9
Tooth width B_2	25,5
Tooth width B_3	42,1
Chain	mm
Pitch	15,875
Inner width	9,65
Roller - \varnothing	10,16

For roller chain
according to DIN 8187 ISO / R 606

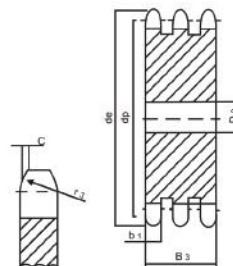

from z 111h-10mm

Code	Dimensions			
	Z	de	dp	T D3
	mm			
1938583	8	48,4	41,48	12
1939583	9	53,3	46,42	12
19310583	10	58,3	51,37	12
19311583	11	63,2	56,34	12
19312583	12	68,2	61,34	12
19313583	13	73,2	66,32	12
19314583	14	78,2	71,34	12
19315583	15	83,2	76,36	16
19316583	16	88,2	81,37	16
19317583	17	93,3	86,39	16
19318583	18	98,3	91,42	16
19319583	19	103,3	96,45	16
19320583	20	108,4	101,49	16
19321583	21	113,4	106,52	16
19322583	22	118,4	111,55	16
19323583	23	123,5	116,58	16
19324583	24	128,5	121,62	20
19325583	25	133,6	126,66	20
19326583	26	138,6	131,70	20
19327583	27	143,6	136,75	20
19328583	28	148,7	141,78	20
19329583	29	153,7	146,83	20
19330583	30	158,8	151,87	20
19331583	31	163,8	156,92	20
19332583	32	168,9	161,95	20
19333583	33	173,9	167,00	25
19334583	34	178,9	172,05	25
19335583	35	184,0	177,10	25
19336583	36	189,0	182,15	25
19337583	37	194,1	187,20	25
19338583	38	199,1	192,24	25
19339583	39	204,2	197,29	25
19340583	40	209,2	202,34	
19341583	41	215,8	207,39	
19342583	42	220,8	212,44	
19343583	43	225,9	217,49	

Code	Dimensions			
	Z	de	Dp	T D3
	mm			
19344583	44	138,1	133,52	25
19345583	45	141,1	136,54	25
19346583	46	144,2	139,58	25
19347583	47	147,2	142,61	25
19348583	48	150,2	145,64	25
19349583	49	153,3	148,66	
19350583	50	156,3	151,69	25
19351583	51	159,3	154,72	
19352583	52	162,4	157,75	25
19353583	53	165,4	160,78	
19354583	54	168,4	163,82	
19355583	55	171,4	166,85	25
19356583	56	174,5	169,88	
19357583	57	177,5	172,91	25
19358583	58	180,5	175,93	
19359583	59	183,6	178,96	
19360583	60	186,6	181,99	25
19362583	62	192,7	188,06	
19364583	64	198,7	194,12	30
19365583	65	201,8	197,15	30
19366583	66	204,8	200,18	
19368583	68	210,8	206,24	
19370583	70	216,9	212,30	30
19372583	72	223,0	218,37	
19375583	75	232,1	227,46	30
19376583	76	235,1	230,49	30
19378583	78	241,2	236,55	
19380583	80	247,2	242,61	30
19385583	85	262,4	257,77	
19390583	90	277,5	272,93	30
19395583	95	292,7	288,08	30
193100583	100	307,8	303,25	
193110583	110	338,2	335,55	
193114583	114	350,3	245,68	30
193120583	120	368,5	363,86	
193125583	125	383,6	379,02	30

>>> Chain discs

At www.rodavigo.net Family: Transmission elements
Product: Chain discs

Discs 3/4"x7/16" 19,05x11,68 mm. 12B-1

Disc	mm
Tooth radius r_3	19
Radius length C	2
Tooth width B_1	11,1
Tooth width b_1	10,8
Tooth width B_2	30,3
Tooth width B_3	49,8
Chain	mm
Pitch	19,05
Inner width	11,68
Roller - \varnothing	12,07

For roller chain
according to DIN 8187 ISO / R 606

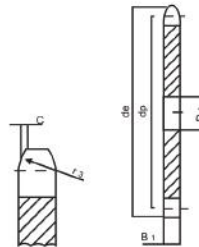

Code	Dimensions			
	Z	d _e	d _p	S D ₁
mm				
1938341	8	58,0	49,78	10
1939341	9	63,9	55,70	10
19310341	10	69,8	61,64	10
19311341	11	75,8	67,61	12
19312341	12	81,8	63,50	14
19313341	13	87,8	79,50	14
19314341	14	93,8	85,61	14
19315341	15	99,8	91,63	14
19316341	16	105,8	97,65	14
19317341	17	111,9	103,67	14
19318341	18	117,9	109,71	14
19319341	19	123,9	115,75	14
19320341	20	130,0	121,78	14
19321341	21	136,0	127,82	16
19322341	22	142,0	133,86	16
19323341	23	148,1	139,90	16
19324341	24	154,1	145,94	16
19325341	25	160,2	152,00	16
19326341	26	166,2	158,04	16
19327341	27	172,3	164,09	16
19328341	28	178,3	170,13	16
19329341	29	184,4	176,19	16
19330341	30	190,4	182,25	16
19331341	31	196,5	188,31	20
19332341	32	202,5	194,35	20
19333341	33	208,6	200,40	20
19334341	34	214,6	206,46	20
19335341	35	220,7	212,52	20
19336341	36	226,8	218,58	20
19337341	37	232,8	224,64	20
19338341	38	238,9	230,69	20
19339341	39	244,9	236,75	20
19340341	40	251,0	242,81	20
19341341	41	258,9	248,87	25
19342341	42	265,0	254,93	25
19343341	43	271,1	260,98	25

Code	Dimensions			
	Z	d _e	D _p	S D ₁
mm				
19344341	44	277,1	267,03	25
19345341	45	283,2	273,10	25
19346341	46	289,2	279,16	25
19347341	47	295,3	285,21	25
19348341	48	301,4	291,27	25
19349341	49	307,4	297,33	25
19350341	50	313,5	303,39	25
19351341	51	319,5	309,45	25
19352341	52	325,6	315,50	25
19353341	53	331,6	321,56	25
19354341	54	337,7	327,64	25
19355341	55	343,8	333,70	25
19356341	56	349,8	339,75	25
19357341	57	355,9	345,81	25
19358341	58	362,0	351,87	25
19359341	59	368,0	357,93	
19360341	60	374,1	363,99	25
19362341	62	386,2	376,12	25
19364341	64	398,3	388,24	25
19365341	65	404,4	394,29	25
19366341	66	410,1	400,35	
19368341	68	422,6	412,49	30
19370341	70	434,7	424,60	30
19372341	72	446,8	436,74	30
19375341	75	465,0	454,91	30
19376341	76	471,1	460,99	30
19378341	78	483,2	473,10	30
19380341	80	495,3	485,22	30
19385341	85	525,6	515,55	30
19390341	90	555,9	545,86	30
19395341	95	586,2	576,17	30
193100341	100	616,6	606,47	30
193110341	110	677,2	667,11	30
193114341	114	701,4	691,36	30
193120341	120	737,8	727,74	30
193125341	125	768,1	758,05	30



>>> Chain discs

Discs 3/4"x7/16" 19,05x11,68 mm. 12B-2

At www.rodavigo.net Family: Transmission elements
Product: Chain discs

Disc	mm
Tooth radius r_3	19
Radius length C	2
Tooth width B_1	11,1
Tooth width b_1	10,8
Tooth width B_2	30,3
Tooth width B_3	49,8
Chain	mm
Pitch	19,05
Inner width	11,68
Roller - \varnothing	12,07

For roller chain according to DIN 8187 ISO / R 606

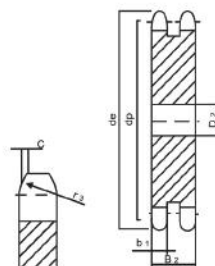

Code	Dimensions			
	Z	d _e	d _p	D D ₂
mm				
1938342	8	58,0	49,78	12
1939342	9	63,9	55,70	12
19310342	10	69,8	61,64	12
19311342	11	75,8	67,61	12
19312342	12	81,8	63,50	14
19313342	13	87,8	79,50	14
19314342	14	93,8	85,61	16
19315342	15	99,8	91,63	16
19316342	16	105,8	97,65	16
19317342	17	111,9	103,67	16
19318342	18	117,9	109,71	16
19319342	19	123,9	115,75	16
19320342	20	130,0	121,78	16
19321342	21	136,0	127,82	20
19322342	22	142,0	133,86	20
19323342	23	148,1	139,90	20
19324342	24	154,1	145,94	20
19325342	25	160,2	152,00	20
19326342	26	166,2	158,04	20
19327342	27	172,3	164,09	20
19328342	28	178,3	170,13	20
19329342	29	184,4	176,19	20
19330342	30	190,4	182,25	20
19331342	31	196,5	188,31	20
19332342	32	202,5	194,35	20
19333342	33	208,6	200,40	20
19334342	34	214,6	206,46	20
19335342	35	220,7	212,52	20
19336342	36	226,8	218,58	25
19337342	37	232,8	224,64	25
19338342	38	238,9	230,69	25
19339342	39	244,9	236,75	25
19340342	40	251,0	242,81	25
19341342	41	258,9	248,87	25
19342342	42	265,0	254,93	25
19343342	43	271,1	260,98	25

Code	Dimensions			
	Z	d _e	D _p	D D ₂
mm				
19344342	44	277,1	267,03	
19345342	45	283,2	273,10	25
19346342	46	289,2	279,16	
19347342	47	295,3	285,21	25
19348342	48	301,4	291,27	25
19349342	49	307,4	297,33	25
19350342	50	313,5	303,39	25
19351342	51	319,5	309,45	25
19352342	52	325,6	315,50	25
19353342	53	331,6	321,56	25
19354342	54	337,7	327,64	25
19355342	55	343,8	333,70	25
19356342	56	349,8	339,75	25
19357342	57	355,9	345,81	25
19358342	58	362,0	351,87	25
19359342	59	368,0	357,93	
19360342	60	374,1	363,99	25
19362342	62	386,2	376,12	
19364342	64	398,3	388,24	30
19365342	65	404,4	394,29	30
19366342	66	410,1	400,35	30
19368342	68	422,6	412,49	
19370342	70	434,7	424,60	30
19372342	72	446,8	436,74	30
19375342	75	465,0	454,91	30
19376342	76	471,1	460,99	30
19378342	78	483,2	473,10	
19380342	80	495,3	485,22	30
19385342	85	525,6	515,55	30
19390342	90	555,9	545,86	30
19395342	95	586,2	576,17	30
193100342	100	616,6	606,47	30
193110342	110	677,2	667,11	
193114342	114	701,4	691,36	30
193120342	120	737,8	727,74	30
193125342	125	768,1	758,05	30

>>> Chain discs

At www.rodavigo.net

Family: Transmission elements
Product: Chain discs

Discs 3/4"x7/16" 19,05x11,68 mm. 12B-3

Disc	mm
Tooth radius r_3	19
Radius length C	2
Tooth width B_1	11,1
Tooth width b_1	10,8
Tooth width B_2	30,3
Tooth width B_3	49,8
Chain	mm
Pitch	19,05
Inner width	11,68
Roller - \varnothing	12,07

For roller chain
according to DIN 8187 ISO / R 606

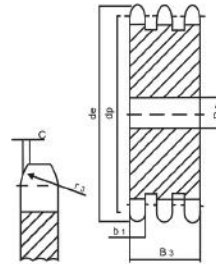

Code	Dimensions			
	Z	d _e	d _p	T D ₃
mm				
1938343	8	58,0	49,78	12
1939343	9	63,9	55,70	12
19310343	10	69,8	61,64	12
19311343	11	75,8	67,61	16
19312343	12	81,8	63,50	16
19313343	13	87,8	79,50	16
19314343	14	93,8	85,61	16
19315343	15	99,8	91,63	16
19316343	16	105,8	97,65	20
19317343	17	111,9	103,67	20
19318343	18	117,9	109,71	20
19319343	19	123,9	115,75	20
19320343	20	130,0	121,78	20
19321343	21	136,0	127,82	20
19322343	22	142,0	133,86	20
19323343	23	148,1	139,90	20
19324343	24	154,1	145,94	20
19325343	25	160,2	152,00	20
19326343	26	166,2	158,04	20
19327343	27	172,3	164,09	20
19328343	28	178,3	170,13	20
19329343	29	184,4	176,19	20
19330343	30	190,4	182,25	20
19331343	31	196,5	188,31	25
19332343	32	202,5	194,35	25
19333343	33	208,6	200,40	25
19334343	34	214,6	206,46	25
19335343	35	220,7	212,52	25
19336343	36	226,8	218,58	25
19337343	37	232,8	224,64	25
19338343	38	238,9	230,69	25
19339343	39	244,9	236,75	25
19340343	40	251,0	242,81	25
19341343	41	258,9	248,87	
19342343	42	265,0	254,93	25
19343343	43	271,1	260,98	25

Code	Dimensions			
	Z	d _e	D _p	T D ₃
mm				
19344343	44	277,1	267,03	25
19345343	45	283,2	273,10	25
19346343	46	289,2	279,16	
19347343	47	295,3	285,21	25
19348343	48	301,4	291,27	25
19349343	49	307,4	297,33	
19350343	50	313,5	303,39	25
19351343	51	319,5	309,45	
19352343	52	325,6	315,50	25
19353343	53	331,6	321,56	
19354343	54	337,7	327,64	25
19355343	55	343,8	333,70	25
19356343	56	349,8	339,75	
19357343	57	355,9	345,81	30
19358343	58	362,0	351,87	30
19359343	59	368,0	357,93	
19360343	60	374,1	363,99	30
19362343	62	386,2	376,12	
19364343	64	398,3	388,24	
19365343	65	404,4	394,29	30
19366343	66	410,1	400,35	30
19368343	68	422,6	412,49	
19370343	70	434,7	424,60	30
19372343	72	446,8	436,74	30
19375343	75	465,0	454,91	
19376343	76	471,1	460,99	30
19378343	78	483,2	473,10	
19380343	80	495,3	485,22	30
19385343	85	525,6	515,55	30
19390343	90	555,9	545,86	30
19395343	95	586,2	576,17	30
193100343	100	616,6	606,47	30
193110343	110	677,2	667,11	
193114343	114	701,4	691,36	30
193120343	120	737,8	727,74	30
193125343	125	768,1	758,05	30

>>> Chain discs

Discs 1"x17/02" mm 25,4x17,02 mm. 16B-1

 At www.rodavigo.net Family: Transmission elements
 Product: Chain discs

Disc	mm
Tooth radius r_3	26
Radius length C	2,5
Tooth width B_1	16,2
Tooth width b_1	15,8
Tooth width B_2	47,7
Tooth width B_3	79,6
Chain	mm
Pitch	25,4
Inner width	17,02
Roller -	15,88

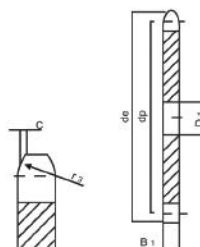
 For roller chain
 according to DIN 8187 ISO / R 606

Code	Dimensions			
	Z	de	dp	S D1
mm				
193811	8	77,49	66,37	16
193911	9	85,8	74,24	16
1931011	10	93,8	82,19	16
1931111	11	101,7	90,14	16
1931211	12	109,7	98,14	16
1931311	13	117,7	106,12	16
1931411	14	125,7	114,15	16
1931511	15	133,7	122,17	16
1931611	16	141,8	130,20	20
1931711	17	149,8	138,22	20
1931811	18	157,8	146,28	20
1931911	19	165,9	154,33	20
1932011	20	173,9	160,38	20
1932111	21	182,0	170,43	20
1932211	22	190,1	178,48	20
1932311	23	198,1	186,53	20
1932411	24	206,2	194,59	20
1932511	25	214,2	202,66	20
1932611	26	222,3	210,72	20
1932711	27	230,4	218,79	20
1932811	28	238,4	226,85	20
1932911	29	246,5	234,92	20
1933011	30	254,6	243,00	20
1933111	31	262,6	251,08	25
1933211	32	270,7	259,13	25
1933311	33	278,8	267,21	25
1933411	34	286,9	275,28	25
1933511	35	294,9	283,36	25
1933611	36	303,0	291,44	25
1933711	37	311,1	299,51	25
1933811	38	319,2	307,59	25
1933911	39	327,2	315,67	25
1934011	40	335,3	323,73	25
1934111	41	345,6	331,82	25
1934211	42	323,7	339,90	25
1934311	43	361,7	347,98	25

Code	Dimensions			
	Z	de	dp	S D1
mm				
1934411	44	369,8	356,06	25
1934511	45	377,9	364,12	25
1934611	46	386,0	372,21	25
1934711	47	394,1	380,29	25
1934811	48	402,1	388,26	25
1934911	49	410,2	396,44	25
1935011	50	418,3	404,52	25
1935111	51	426,4	412,60	30
1935211	52	434,5	420,67	30
1935311	53	442,5	428,65	30
1935411	54	450,6	436,85	30
1935511	55	458,7	444,93	30
1935611	56	466,8	453,01	30
1935711	57	474,9	461,07	30
1935811	58	482,9	469,16	30
1935911	59	491,0	477,24	30
1936011	60	499,1	485,32	30
1936211	62	515,3	501,50	30
1936411	64	531,4	517,65	30
1936511	65	539,5	525,73	30
1936611	66	547,6	533,80	30
1936811	68	563,8	549,98	30
1937011	70	579,9	566,14	30
1937211	72	596,1	582,32	30
1937511	75	620,3	606,55	30
1937611	76	628,4	614,65	30
1937811	78	644,6	630,80	30
1938011	80	660,7	646,96	30
1938511	85	701,2	687,40	30
1939011	90	741,6	727,81	30
1939511	95	782,0	768,22	30
19310011	100	822,4	808,63	30
19311011	110	903,3	889,48	30
19311411	114	935,6	921,82	30
19312011	120	984,1	970,33	30
19312511	125	1024,5	1010,73	30