

9. SEALING

V-Ring	p. 250
Mechanical seals	p. 250
Collars	p. 251
Gland packing	p. 252
Roof and piston packing	p. 253
Guides	p. 254
Cord stock	p. 254
Special seals under drawing	p. 255
O-rings	p. 256
Scrapers	p. 257
Oil seals	p. 257





>>> V-Rings

At www.rodavigo.net Family: Sealing
Product: Sealing materials



V-Rings



VA Type
Flat back
face (normal)



VS Type
Inclined back face
(axial mounting dimension
higher than VA Type)



VL Type
Special small section profile
for labyrinth mounting
sealing system



VE Type
For Ø shafts
greater than 450 mm.

Product 313

The V-Ring seal is a sealing ring, for rotary axes. The flexible lip rests on a seat perpendicular to the axis and ensures axial tightness.

Thanks to the elastic mounting tension itself, the ring body presses against the shaft, guiding together and keeping the flexible lip in contact with the seat.

In some cases it can be mounted on a static surface and it seals on a rotating face. This mounting can be advantageous when the peripheral speed is high or when you want to keep the pressure of the ring on the seat constant.

SCOPE

This gasket ensures the seal against dust, mud, oil, water and other fluids. At equal shaft diameter choose the V-Ring with the largest diameter.

Temperature	NBR -30° TO + 130°C / viton -20° to + 220°
Speed	up to 15 m / s. with clamp
Fluid	Any fluid depending on the material

>>> Mechanical seals

Mechanical seals with conical and cylindrical spring

Product 313

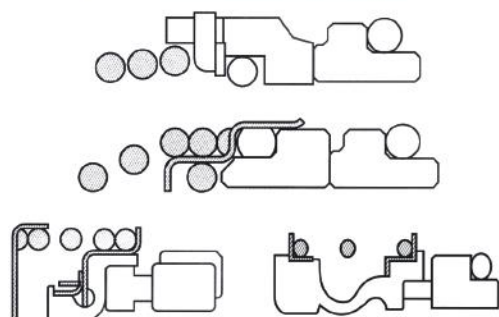

Due to its design and versatility, this range of mechanical seals can be used in a wide variety of pumps, for example: clean water pumps, heating, sewage, submersibles, etc.

In conical spring closures, their direction of rotation will depend on the direction rotation. Mainly used at low pressures and speeds.

There is a wide range depending on each type of application, always according to DIN 24960 or according to customer needs.

Multi-spring mechanical seals

Product 313

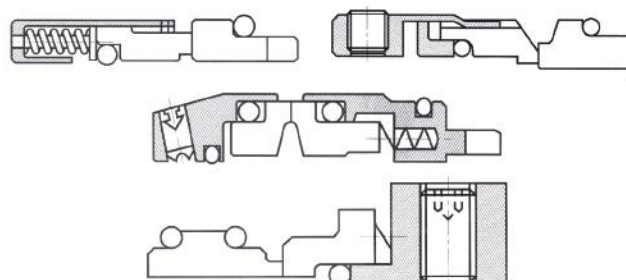

There is a wide range of unbalanced multi-spring mechanical seals, balanced for pressures up to 25 bar, external for very aggressive fluids, double for polluting products and gases, and protected springs for the food industry or products with a high content of solid particles.

This type of closure is independent of the direction of rotation; widely used in the Petrochemical and Chemical sector.

Dimensions according to DIN 24960 and market standards.

>>> Collars



Collars

Material	Hardness Shore a	Pressure Bar	T°C	Speed	Resistant to:
NBR	90°	≤120	-30° +100°	≤0,5 m/s	Mineral oils DIN 51524
Vulk-A	94°	≤300	-30° +100°	≤0,5 m/s	
NBR	80°	≤120	-30° +100°	≤0,5 m/s	Mineral oils DIN 51524
Vulk-A	94°	≤300	-30° +100°	≤0,5 m/s	
NBR	90°	≤120	-30° +100°	≤0,5 m/s	Mineral oils DIN 51524
Vulk-A	94°	≤250	-30° +100°	≤0,5 m/s	
NBR + Fabric		250	-30° +100°	≤0,5 m/s	Mineral oils DIN 51524
NBR	85°	100	-30° +100°	≤0,5 m/s	Mineral oils DIN 51524

Product 304

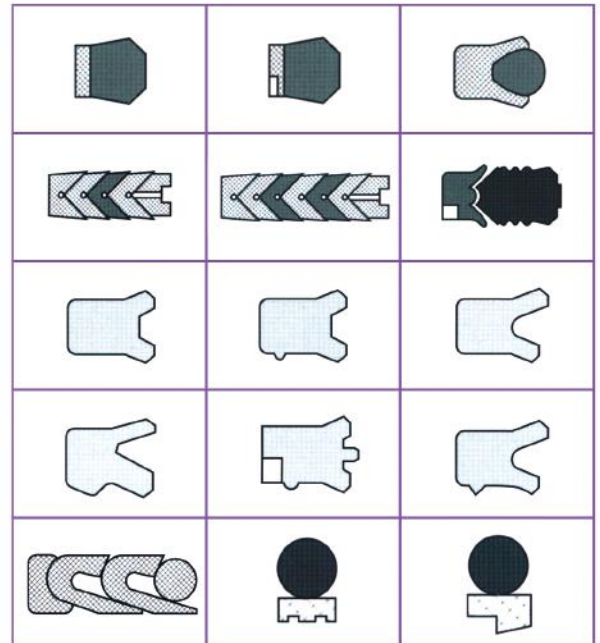

Vulk-A collars friction inside-outside

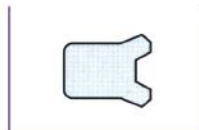

Code	Inside	External	Height	Code	Inside	External	Height
3045125	5	12	5	30442508	42	50	8
30412186	12	18	6	304455510	45	55	10
30412225	12	22	5	304456010	45	60	10
30412228	12	22	8	304506010	50	60	10
30414226	14	22	6	304506510	50	65	10
30415258	15	25	8	304507012	50	70	12
30416224	16	22	4	304536365	53	63	6.5
30416268	16	26	8	304556510	55	65	10
30418288	18	28	8	304556512	55	65	12
30420284	20	28	4	304557012	55	70	12
30420288	20	28	8	304557512	55	75	12
304203010	20	30	10	304607012	60	70	12
30420308	20	30	8	30460708	60	70	8
30422306	22	30	6	304607510	60	75	10
30422328	22	32	8	304607512	60	75	12
304253510	25	35	10	304608010	60	80	10
30425355	25	35	5	304608012	60	80	12
30425358	25	35	8	304658012	65	80	12
304254010	25	40	10	304708010	70	80	10
30428388	28	38	8	304708012	70	80	12
304304010	30	40	10	30470808	70	80	8
304304210	30	42	10	304708512	70	85	12
30430429	30	42	9	304758512	75	85	12
304304510	30	45	10	304809012	80	90	12
30432405	32	40	5	304809512	80	95	12
30432408	32	40	8	3048010012	80	100	12
304324210	32	42	10	304859512	85	95	12
304324510	32	45	10	3048510011	85	100	11
30434457	34	45	7	3048510012	85	100	12
304354510	35	45	10	3049010012	90	100	12
30435458	35	45	8	3049010512	90	105	12
304355010	35	50	10	3049011012	90	110	12
304404811	40	48	11	30410011512	100	115	12
304405010	40	50	10	30410012012	100	120	12
30440508	40	50	8	30410012512	100	125	12
304405510	40	55	10	30410012515	100	125	15
304406013	40	60	13	30411013010	110	130	10



>>> Gland packing

At www.rodavigo.net Family: Sealing
Product: Sealing materials



Substitution for asbestos products

Product 313

FABRICS

Asbestos product	Asbestos-free substitute product	Temperature max. °C	Delivery form
Asbestos fabrics	Glass fabrics	550	50m rolls. long, 1 m. width. Thicknesses 2 to 3 mm.
	Ceramic fabrics	1100	50m rolls. long, 1 m. width. Thicknesses 2 to 3 mm.
	Silica fabrics	1200	50m rolls. long, 1 m. width. Thickness 0.7 and 1.4 mm.
	Aramid fabrics	400	50m rolls. long, 1 m. width. Thickness 2 mm.

Applications: - Manufacture of curtains, blankets, mats, protective clothing, etc.
- Protection of special welds.
- Insulation coating.
- Preparation of seals, bands, compensators, etc.

BRAIDS (Sec. Ø and □)

Asbestos product	Asbestos-free substitute product	Temperature max. °C	Delivery form
Asbestos braids	Glass braids	550	Rolls of variable length according to sections. Measures from 6 to 60 mm. Ø or □.
	Ceramic braids	1100	

Applications: - Oven closures, stoves, etc.
- Heat insulation of pipes. - Heat duct seals.
- Ingot mould seals. - Thermal isolation.

WEATHER STRIP

Asbestos product	Asbestos-free substitute product	Temperature max. °C	Delivery form
Asbestos weather strip	Mineral wool weather strip	550	Rolls of 30 m. length. Measurements of 30 mm.Ø. Rolls of 30 m. length. Measurements from 12 to 50 mm.Ø.
	Ceramic fiber weather strip	1100	

Applications: - Pipe insulation.
- Ingot mold joints.
- Thermal protection.

CORDS

Asbestos product	Asbestos-free substitute product	Temperature max. °C	Delivery form
Asbestos cord	Glass bead	550	Rolls of variable lengths according to diameter. Measures from 3 to 50 mm.Ø.
	Ceramic cord	1100	

Applications: - Ingot mould seals.
- Hot air duct seals.
- Pipe insulation.
- Thermal protection.

TAPES

Asbestos product	Asbestos-free substitute product	Temperature max. °C	Delivery form
Asbestos cord	Glass tapes	550	50 m rolls. long. Thicknesses 2 and 3 mm. Widths from 20 to 200 mm.
	Ceramic tapes	1100	

Applications: - Pipe insulation.
- Insulation of electrical cables.
- Expansion joints.
- Thermal protection.

CARDBOARDS

Asbestos product	Asbestos-free substitute product	Temperature max. °C	Delivery form
Asbestos fabrics	Cardboard "BARLAN" 850	850	1000 x 1000 mm sheets. Standard thicknesses: 2-3-4-5-6-8 and 10 mm.
	Cardboard "BARLAN" 110	1100	
	Cardboard "BARLAN" 1250	1250	

Applications: - Preparation of seals for thermal and insulating uses.
- Coating of element transport rollers at high temperatures.
- Thermal isolation.

>>> Roof and piston packing

At www.rodavigo.net Family: Sealing
Product: Simko piston seals

Gaskets

Piston packing profiles

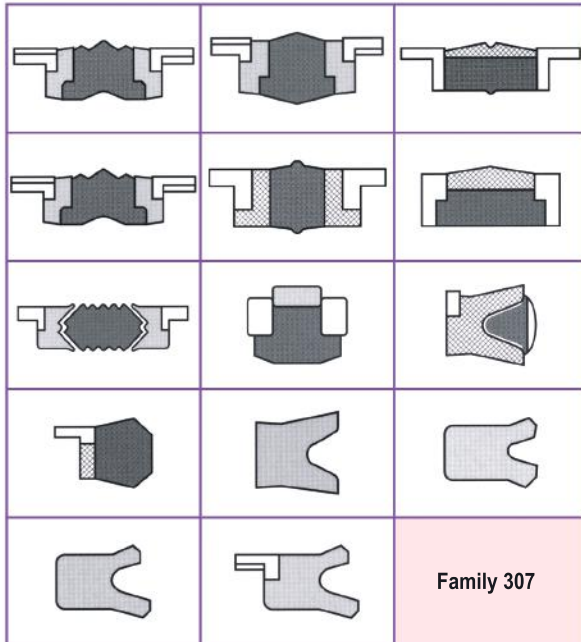

Roof seal profiles

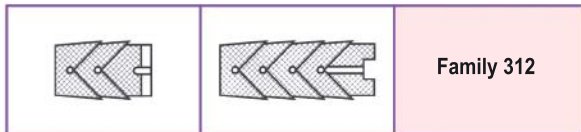

Roof seals

Material	Hardness Shore a	Pressure bar	T°C	Speed	Resistant to:
NBR	90°	100	-30° +100°	≤0,5 m/s	Mineral oils DIN 51524
NBR + Fabric		300	-30° +100°		
NBR + Fabric		400	-30° +100°	≤0,5 m/s	Mineral oils DIN 51524
Vulk-A	94°	450	-30° +100°	≤0,5 m/s	
NBR + Fabric		300	-30° +100°	≤1 m/s	Mineral oils DIN 51524
NBR + Fabric		250	-30° +100°	≤1 m/s	Mineral oils DIN 51524
NBR + Fabric		400	-30° +100°	≤0,5 m/s	Mineral oils DIN 51524

SIMKO seals 3 pieces

Code	Nº. pcs	Inside	External	Height	Type
30732E		24	32	15.5	3224
30735E		27	35	15.5	3527
30740E		32	40	15.5	4032
30745E		37	45	15.5	4537
30750E		38	50	20.5	5038
30755E		43	55	20.5	5543
30760E		48	60	20.5	6048
30763E	3	51	63	20.5	6351
30765E		53	65	20.5	6553
30770E		58	70	20.5	7058
30775E		63	75	20.5	7563
30780E		66	80	22.5	8066
30790E		76	90	22.5	9076
307100E		86	100	22.5	10086

SIMKO seals 5 pieces

Code	Nº. pcs	Inside	External	Height	Type
30832		22	32	16.4	125086/1
30835		25	35	16.4	137098
30840		30	40	16.4	157118
30850		34	50	18.4	196133
30855		39	55	18.4	216153
30860		44	60	18.4	236173
30863		47	63	18.4	248185
30865		50	65	18.4	255196
30870		50	70	22.4	275196
30875	5	55	75	22.4	295216
30880		60	80	22.4	314236
30885		65	85	22.4	334255
30890		70	90	22.4	354275
30895		75	95	22.4	374295
308100		75	100	22.4	393295
308105		80	105	22.4	413314
308125		100	125	25.4	492393
308130		105	130	25.4	511413
308140		115	140	25.4	551452



>>> Guides

Guides

At www.rodavigo.net Family: Sealing
Product: Guide tape

Product 311



Guide ring profiles

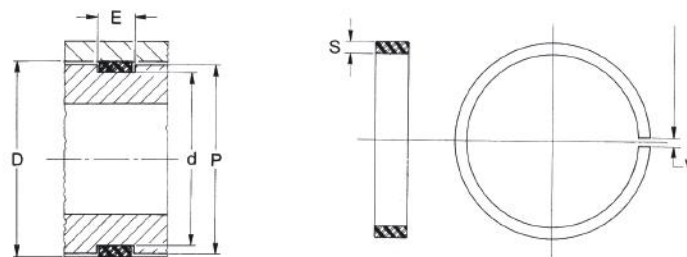

D nominal Tolerances on nominal dimensions

D nominal	D	d	E	P
30 ÷ 50		+ 0,00 - 0,10		
51 ÷ 180	ISO - H 11	+ 0,00 - 0,20	+ 0,10 - 0,00	+/- 0,05
181 ÷ 300		+ 0,00 - 0,30		

>>> Cord stock

O-rings

At www.rodavigo.net Family: Sealing
Product: Cord stock

CONSERVATION AND STORAGE

The action of certain external factors such as heat, humidity, light, oxygen, ozone, etc., on the different types of vulcanized rubber, can cause alterations and deformations on the surface, premature aging and regression of the physical-mechanical characteristics. For good conservation, the ideal temperature in the warehouse is 5 to 20°. Avoid proximity of steam and hot water pipes.

MOISTURE: It must be avoided in the most absolute way.

LIGHT: The building designed as warehouse should be in semi-darkness. Ensure effective protection against sunlight. Also protect against artificial light containing ultraviolet rays.

OXYGEN: O-rings should not be in contact with air. They must be kept in sealed containers.

OZONE: Avoid exposing O-rings to devices that can produce ozone. Example: mercury vapor lamps, high voltage electrical appliances, electric motors.

STATIC APPLICATION. RECTANGULAR SLOT DIMENSIONS

This type of application allows to support very high working pressures (1,000 kg / cm²).

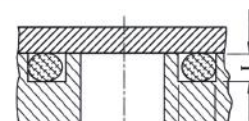

ALLOWABLE DEFECTS

The burr must not exceed ASTM standards for 0.125mm. thick and 0.075 mm. Tall.

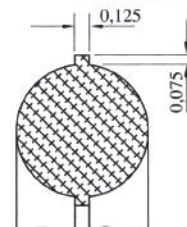

Product 316



In the table, the dimensions of the slot are related to o-rings section.

Rectangular slot dimensions. Static application

SECTION s	L	C	SECTION s	L	C
1,5	1,1	1,9	3,53	2,90	4,50
1,6	1,20	2,10	4	3,30	5,10
1,78	1,40	2,50	5	4,20	6,50
1,90	1,50	2,55	5,33	4,50	7
2	1,60	2,70	5,70	4,80	7,50
2,40	2	3,20	6	5,00	8,20
2,62	2,20	3,50	6,99	6	9,50
3	2,50	3,80	8,40	7,20	11,40

Code	Section	Type	Code	Section	Type
316100	1,00	NBR-70	316650	6,50	NBR-70
316150	1,50	NBR-70	316700	7,00	NBR-70
316200	2,00	NBR-70	316750	7,50	NBR-70
316250	2,50	NBR-70	316800	8,00	NBR-70
316300	3,00	NBR-70	316850	8,50	NBR-70
316353	3,53	NBR-70	316900	9,00	NBR-70
316400	4,00	NBR-70	3161000	10,00	NBR-70
316450	4,50	NBR-70	3161100	11,00	NBR-70
316500	5,00	NBR-70	3161200	12,00	NBR-70
316533	5,33	NBR-70	3161400	14,00	NBR-70
316550	5,50	NBR-70	3161500	15,00	NBR-70
316570	5,70	NBR-70	3162000	20,00	NBR-70
316600	6,00	NBR-70	3162200	22,00	NBR-70

>>> Special joints under drawing

At www.rodavigo.net Family: Sealing
Product: Sealing materials

Special seals under drawing

MECHANIZATION

The available materials offer a wide range of possibilities.

- Any piece:**
- Metallic
 - Nylon
and other polyamides
 - Pure or loaded Teflon; bronze, glass, graphite etc.
 - Vulkollan
 - Adriprene
and any type of elastomer in general.

Product 313



>>> O-rings

At www.rodavigo.net Family: Sealing
Product: O-rings

O-rings

MATERIAL CHARACTERISTICS

To identify the most specific mixtures to the requirements of use, we have prepared a table where the fundamental data related to each composition is exposed:

Base elastomer	Hardness Shore a	Work pressure Kg / cm ²	Utilization temperature °C	To seal	Not recommended
Acrylic Nitrile NBR	70 80 90	80 80 >160	- 40 + 125	Good resistance to fuels and oils. High working temperature. Optimum resistance to permanent deformation.	Organic and inorganic acids, strongly aromatic hydrocarbons.
Ethylene Propylene Copolymer EPM	75	≤ 80	- 40 + 150	Ozone, atmospheric agents, heat, steam. Good resistance to permanent deformation, ketones, dilute acids.	Oils and gasoline.
Fluorine Elastomer (Viton) FKM	70 90	≤ 80 ≤ 80	- 40 + 250 - 30 + 250	High temperatures in the presence of oils and lubricants. Good resistance to permanent deformation, acid, ozone and oxygen.	Dynamic use.
Chloroprene (Neoprene) CR	70	≤ 80	- 40 + 125	Ozone, atmospheric agents. Good resistance to flame.	Solvent chlorinated aromatic hydrocarbons.
Silicone VMQ	60 70	≤ 50 ≤ 80	- 60 + 230	High and low temperatures, air, gas and atmospheric agents.	Water vapor, low aniline grade oils.

Seals profiles for static closing



O-RINGS DIMENSIONAL TOLERANCES

Ø internal (d)			SECTION (s)		
DE	A	Tolerance	DE	A	Tolerance
0	3	0,1	0	1,6	0,07
3,1	6	0,16	1,6	2	0,08
6,1	10	0,2	2	2,5	0,09
10,1	18	0,25	2,5	3	0,1
18,1	50	0,4	3	4	0,11
50,1	80	0,63	4	5	0,12
80,1	100	0,8	5	7	0,14
100,1	120	1	7	8	0,16
120,1	180	1,25	8	10	0,18
181	250	1,6	10	15	0,22
251	315	2			
316	400	2,5			
401	500	3,15			

Product 303

In this table, the tolerances of the internal diameters (d) and the section or bull (s) are related. They are valid for O-Rings made of BUTADIENE ACRYL NITRILE (NBR), which is the standard material and has an approximate hardness of 70 shore grade A. There are variations for other materials and hardnesses.

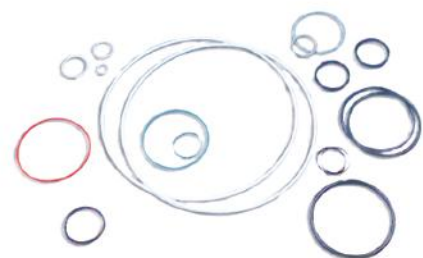

>>> O-rings

O-rings

At www.rodavigo.net Family: Sealing
Product: O-rings

MACHINING SLOT HOUSING

The optimal profile is the one represented in the figure.
In steel, especially for dynamic applications, it is the ideal material.
The finish of the fixed and sliding surfaces must have the lowest possible roughness after machining.
The housing diameter tolerance about cylinder is ISAH9.
The cylinder housing diameter tolerance is ISA H9.

Product 303

C	R1	R2
UNTIL 3	0,1	0,25
OVER 3	0,2	0,5

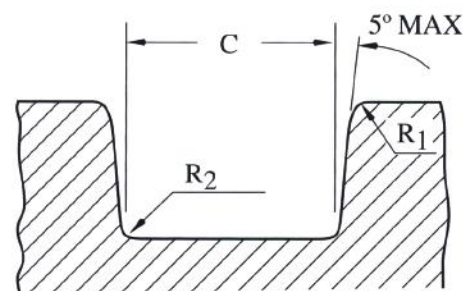

DYNAMIC APPLICATION RECTANGULAR SLOT DIMENSIONS

Due to the O-rings friction the deformation of the section must be kept somewhat less than in the case of static sealing.
The following table specifies the different dimensions for hydraulics and pneumatics.

RECTANGULAR SLOT DIMENSIONS. DYNAMIC APPLICATION.

O-ring section S	Hydraulics C	Pneumatics C	C
1,5	1,3	1,35	1,9
1,6	1,40	1,45	2,10
1,78	1,50	1,55	2,3
1,90	1,60	1,65	2,5
2	1,70	1,75	2,7
2,40	2,10	2,15	2,9
2,62	2,30	2,35	3,10
3	2,6	2,75	3,6
3,53	3,1	3,25	4,2
4	3,5	3,7	4,8
5	4,45	4,65	6
5,33	4,7	4,95	6,4
5,7	5,1	5,35	6,9
6	5,4	5,65	7,2
6,99	6,3	6,6	8,4
8,40	7,7	7,9	10,6

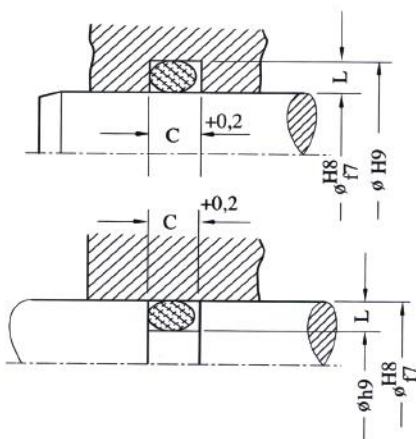

TOLERANCES AND EXTRUSION SLOT

(Play between piston and cylinder).
To avoid the possibility of extrusion, the cylinder and the piston must be manufactured as indicated in table 5.

Product 303

H7/g6 ISA TOLERANCES			H7/g6 ISA TOLERANCES			H7/g6 ISA TOLERANCES		
Nominal diameter	H7 cylinder	G6 piston	Nominal diameter	H7 cylinder	G6 piston	Nominal diameter	H7 cylinder	G6 piston
1 a 3	+ 0,009 + 0	- 0,003 - 0,010	19 a 30	+ 0,021 + 0	- 0,007 - 0,020	121 a 180	+ 0,040 + 0	- 0,014 - 0,039
4 a 6	+ 0,012 + 0	- 0,004 - 0,012	31 a 50	+ 0,025 + 0	- 0,009 - 0,025	181 a 250	+ 0,046 + 0	- 0,015 - 0,044
7 a 10	+ 0,015 + 0	- 0,005 - 0,014	51 a 80	+ 0,030 + 0	- 0,010 - 0,029	251 a 315	+ 0,052 + 0	- 0,017 - 0,049
11 a 18	+ 0,018 + 0	- 0,006 - 0,017	81 a 120	+ 0,035 + 0	- 0,012 - 0,034	316 a 400	+ 0,057 + 0	- 0,018 - 0,054
						401 a 500	+ 0,063 + 0	- 0,020 - 0,060

O-RING DIMENSIONS

Bellow we list all the standardized dimensions.
They are grouped by the size of the section or bull.
The indicated diameter is the O-ring internal diameter (d) followed by the section or bull (s).
The exposed measures correspond to the ACRYLIC NITRILE (NBR) quality.
For VITON (FKM), ETHYLENE PROPYLENE (EPDM), NEOPRENE (CR) AND SILICONE (VMQ) qualities, the available range is very extensive, superior to the mentioned, consequently we kindly ask you to consult.

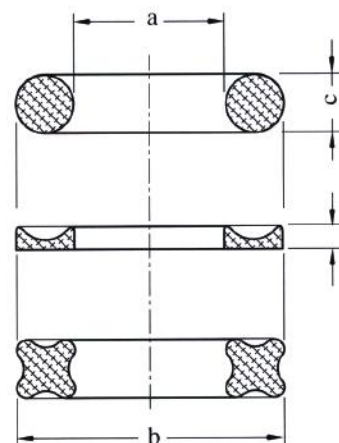

>>> SCRAPERS

At www.rodavigo.net Family: Sealing
Product: Cylinder scrapers

Scrapers

Metal scrapers NBR + Metal

Code	Ext.	Int.	Height	Code	Ext.	Int.	Height
309162234	16	22	3/4	3094252710	42	52	7/10
309182657	18	26	5/7	3094555710	45	55	7/10
3092028355	20	28	3,5/5	3094560710	45	60	7/10
309202858	20	28	5/8	309505658	50	56	5/8
3092030710	20	30	7/10	3095060710	50	60	7/10
309222858	22	28	5/8	3095065710	50	65	7/10
309223257	22	32	5/7	3095565710	55	65	7/10
3092232710	22	32	7/10	3096070710	60	70	7/10
309223558	22	35	5/8	3096075710	60	75	7/10
309253558	25	35	5/8	3096375710	63	75	7/10
3092535710	25	35	7/10	3096575710	65	75	7/10
309283858	28	38	5/8	3097080710	70	80	7/10
309304058	30	40	5/8	3098090710	80	90	7/10
3093040710	30	40	7/10	30990100710	90	100	7/10
3093245710	32	45	7/10	309110120710	110	120	7/10
3093545710	35	45	7/10	309135145710	135	145	7/10
3093547710	35	47	7/10	3091801951014	180	195	10/14
309364658	36	46	5/8				
309405058	40	50	5/8				
3094050710	40	50	7/10				

Flexible scrapers NBR

Code	Ext.	Int.	Height	Code	Ext.	Int.	Height
309RF1218638	12	18,6	3,8	309RF4250653	42	50,6	5,3
309RF1319638	13	19,6	3,8	309RF4553653	45	53,6	5,3
309RF1420638	14	20,6	3,8	309RF4555653	45	55,6	5,3
309RF1521638	15	21,6	3,8	309RF4654653	46	54,6	5,3
309RF162474	16	24	7/4	309RF4856653	48	56,6	5,3
309RF1723638	17	23,6	3,8	309RF5058653	50	58,6	5,3
309RF1928653	19	28,6	5,3	309RF5060653	50	60,6	5,3
309RF2028653	20	28,6	5,3	309RF5361653	53	61,6	5,3
309RF2230653	22	30,6	5,3	309RF5563653	55	63,6	5,3
309RF2432653	24	32,6	5,3	309RF5565653	55	65,6	5,3
309RF2533653	25	33,6	5,3	309RF5664653	56	64,6	5,3
309RF2634653	26	34,6	5,3	309RF5666653	56	66,6	5,3
309RF2735653	27	35,6	5,3	309RF6068653	60	68,6	5,3
309RF2836653	28	36,6	5,3	309RF6371653	63	71,6	5,3
309RF3038653	30	38,6	5,3	309RF6573653	65	73,6	5,3
309RF3240653	32	40,6	5,3	309RF6575653	65	75,6	5,3
309RF3341653	33	41,6	5,3	309RF7078653	70	78,6	5,3
309RF3543653	35	43,6	5,3	309RF8088653	80	88,6	5,3
309RF3644653	36	44,6	5,3	309RF909874	90	98	7/4
309RF3846653	38	46,6	5,3	309RF9010271	90	102	7,1
309RF4048653	40	48,6	5,3				

Scraper rings are an essential component in any hydraulic or pneumatic installation, since they ensure that no contaminating particles are introduced into the system, thus avoiding wear and tear of internal components.

Type	Material	Hardness Shore a	Temp. °C	Speed	Fluid resistance
1	NBR	90	- 30 + 100	≤ 2 m/s	Mineral oils DIN 51524
	Vulkollan®	90	- 30 + 100		
	Vitón®	90	- 20 + 220		
2	NBR+Metal	90	- 30 + 100	≤ 2 m/s	Mineral oils DIN 51524
	Vulkollan®+Metal	90	- 30 + 100		
	Vitón®+Metal	90	- 20 + 220		



Scraper rings are an essential component in any hydraulic or pneumatic installation, since they ensure that no contaminating particles are introduced into the system, thus avoiding wear and tear of internal components.

For extreme working conditions, such as sludge, mud, ice, etc. We recommend the Vulkollan model

>>> Oil seals

At www.rodavigo.net Family: Sealing
Product: Oil seals

Oil seals

TECHNICAL INFORMATION. GENERAL CHARACTERISTICS

The Rotary Shaft Oil Seal is an indispensable component for any tool that works with lubrication and the right design and material must be very carefully selected to guarantee correct use and a long life.

MATERIALS

Oil Seals are manufactured following modern techniques with extremely reliable materials to fully guarantee all requirements in their use. The main elements of a oil seal, which are subjected to a strict quality control, are: metal support, toroidal spring and elastomer.

1. Metal support, usually a steel sheet is used and a stainless steel sheet may also be used.
2. Toroidal spring made of C72 phosphated steel (standard) AISI 302 stainless steel (for acid and Water).
3. Elastomer, in the following list the physical and mechanical properties of the different components used in standard production are mentioned.

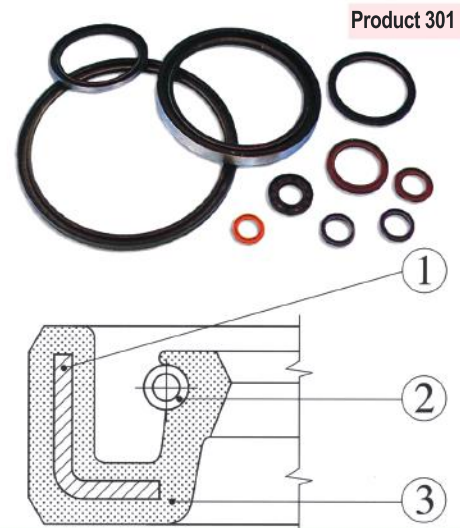



>>> Oil seals

Oil seals

At www.rodavigo.net Family: Sealing
Product: Oils seals

● NITRILE RUBBER (NBR)

Mineral oils and high-alloy mineral oils (hypoid oils) contain large amounts of aromatic hydrocarbons, and are critical since they produce a high absorption effect on the NBR components. The absorption behavior can be improved by increasing the acrylonitrile content. In this case we would have a reduction in cold flexibility and compressive strength.

ADVANTAGES	DISADVANTAGES
Good resistance to oil.	Poor resistance to weather and ozone
Temperatures of 125°C in oil, 100°C in air and 80°C in water	Poor resistance against polar liquids. (esters, ether, acetone and aniline)
High tensile strength	Poor resistance to chlorinated hydrocarbons
High water absorption	Poor resistance to aromatic fluids (benzene and toluene)
High resistance to breakage	

● ACRYLIC RUBBER (ACM)

ADVANTAGES	DISADVANTAGES
Good resistance against oil and liquid fuels (better than NBR)	Cannot be used in contact with water or aqueous solutions, not even in small quantities of water in oil.
Heat resistance of approx. 50°C better than nitrile rubber, 150°C in oil and 125°C in air	The cold yield limit at a temperature of 20°C is somewhat worse than NBR
Good resistance to weathering and ozone	Poor wear resistance
	Poor resistance to polar fluids, aromatic and chlorinated hydrocarbons

● SILICONE RUBBER (MVQ)

ADVANTAGES	DISADVANTAGES
The best heat resistance of all rubbers	Poor tensile and break strength
The best cold resistance of all rubbers	Poor wear resistance
Excellent resistance to weathering and ozone	Sensitive to hydrolysis
Resistant against pure oils and most greases.	Poor resistance to aromatic oils, and oxidation mineral oils

● FLOWERED RUBBER (FPM)

Commonly known as Viton, denomination of Du Pont

ADVANTAGES	DISADVANTAGES
Resistance against oils and fuels it is better than for any other type of rubber.	Cold flexibility limit between approx. -20°C and -25°C
It is the only rubber material with high elasticity that is resistant against aromatic fluids and chlorinated hydrocarbons	Limited tensile and break strength, especially above 100°C
Excellent heat resistance, the best after silicone	Limited wear resistance
Excellent resistance to weathering and ozone	High compression with hot water
Excellent acid resistance	Poor resistance to polar solvents
Reduced swelling in steam and hot water	

>>> Oil seals

At www.rodavigo.net Family: Sealing
Product: Oil seals

Oil seals

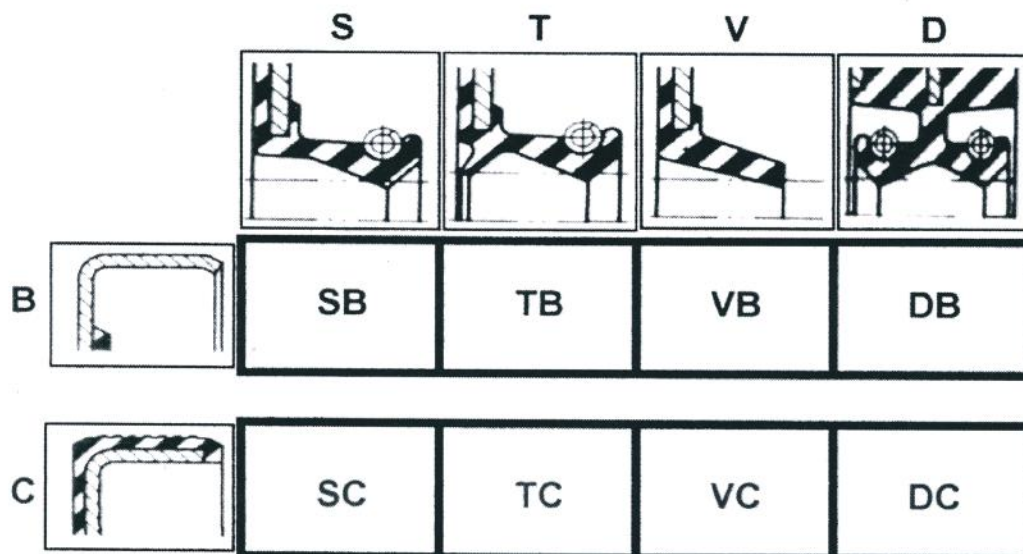

Oil seal models and designations

The designation of the NTK oil seals is indicated in the upper table according to the lip shape and type of cover.

Oil seal models

SC and TC models

The SC and TC types have an outer elastic rubber cover with a metal armor that provides a perfect seal between the outside of the oil seal and the housing hole, even in rough and highly dilated housings.

SB and TB models

Types SB and TB have metal outer casing. SB and TB types have special advantages when used in applications where the elastic rubber can be damaged during assembly.

DB and DC models

They are oil seals with two sealing lips to separate spaces with different environments.

VB and VC models

They are oil seals with metal casing, with or without coating, for lubrication with grease and slow-moving shafts.

Oil seal size

55 Oil seal lip nominal diameter (= shaft diameter)
72 Nominal outside diameter (= housing diameter)
8 Seal ring width.

55 x 72 x 8 TC - NBR

Designations

Lip material

NBR Nitrile rubber
F Fluorinated rubber (viton)

Design

SC Oil seal with a lip, with a toroidal spring.
TC Oil seal with a lip, secondary lip and toroidal spring.
VC Oil seal with a lip, without toroidal spring.
DC Oil seal with double lip and two toroidal springs.
SB Oil seal with steel casing, a lip and a toroidal spring.
TB Oil seal with steel casing, one lip, secondary lip and toroidal spring.
VB Oil seal with steel casing, one lip without toroidal spring.
DB Oil seal with steel casing, double lip and two springs.



>>> Oil seals

Oil seals measures by internal diameter

At www.rodavigo.net Family: Sealing
Product: Oil seals

TC- Double lip
SC- Simple lip

Code	Measurements-Type	Code	Measurements-Type	Code	Measurements-Type	Code	Measurements-Type
3016165DL	6x16x5 TC -NBR	30112183DL	12x18x3 TC -NBR	30115255DL	15x25x5 TC -NBR	30117285DL	17x28x5 TC -NBR
3016167DL	6x16x7 TC -NBR	30112184DL	12x18x4 TC -NBR	30115257DL	15x25x7 TC -NBR	30117286DL	17x28x6 TC -NBR
3016196	6x19x6 SC -NBR	30112187DL	12x18x7 TC -NBR	30115265DL	15x26x5 TC -NBR	30117287DL	17x28x7 TC -NBR
3016197	6x19x7 SC -NBR	30112195DL	12x19x5 TC -NBR	30115267DL	15x26x7 TC -NBR	30117305DL	17x30x5 TC -NBR
3016227DL	6x22x7 TC -NBR	30112205DL	12x20x5 TC -NBR	30115277DL	15x27x7 TC -NBR	30117307DL	17x30x7 TC -NBR
3016227	6x22x7 SC -NBR	30112224DL	12x22x4 TC -NBR	30115285DL	15x28x5 TC -NBR	30117307	17x30x7 SC -NBR
3017167DL	7x16x7 TC -NBR	30112225DL	12x22x5 TC -NBR	30115287DL	15x28x7 TC -NBR	30117308DL	17x30x8 TC -NBR
3017227DL	7x22x7 TC -NBR	30112226DL	12x22x6 TC -NBR	30115305DL	15x30x5 TC -NBR	30117308	17x30x8 SC -NBR
3017227	7x22x7 SC -NBR	30112227DL	12x22x7 TC -NBR	30115307DL	15x30x7 TC -NBR	30117327DL	17x32x7 TC -NBR
3018145DL	8x14x5 TC -NBR	30112246DL	12x24x6 TC -NBR	30115308DL	15x30x8 TC -NBR	30117327	17x32x7 SC -NBR
3018155DL	8x15x5 TC -NBR	30112246	12x24x6 SC -NBR	301153010DL	15x30x10 TC -NBR	30117337DL	17x33x7 TC -NBR
3018167DL	8x16x7 TC -NBR	30112247DL	12x24x7 TC -NBR	30115327DL	15x32x7 TC -NBR	30117344DL	17x34x4 TC -NBR
3018167	8x16x7 SC -NBR	30112257DL	12x25x7 TC -NBR	30115355DL	15x35x5 TC -NBR	30117356DL	17x35x6 TC -NBR
3018185DL	8x18x5 TC -NBR	30112258DL	12x25x8 TC -NBR	30115357DL	15x35x7 TC -NBR	30117357DL	17x35x7 TC -NBR
3018185	8x18x5 SC -NBR	30112267DL	12x26x7 TC -NBR	30115357	15x35x7 SC -NBR	30117358DL	17x35x8 TC -NBR
3018226DL	8x22x6 TC -NBR	30112268	12x26x8 SC -NBR	301153510DL	15x35x10 TC -NBR	30117377DL	17x37x7 TC -NBR
3018227DL	8x22x7 TC -NBR	30112287DL	12x28x7 TC -NBR	301153710	15x37x10 SC -NBR	30117405DL	17x40x5 TC -NBR
3018247	8x24x7 SC -NBR	30112305DL	12x30x5 TC -NBR	30115407DL	15x40x7 TC -NBR	30117407DL	17x40x7 TC -NBR
3019185	9x18x5 SC -NBR	30112307DL	12x30x7 TC -NBR	30115408DL	15x40x8 TC -NBR	30117408DL	17x40x8 TC -NBR
3019188	9x18x8 SC -NBR	301123010	12x30x10 SC -NBR	301154010DL	15x40x10 TC -NBR	301174010DL	17x40x10 TC -NBR
3019206	9x20x6 SC -NBR	30112327DL	12x32x7 TC -NBR	30115427DL	15x42x7 TC -NBR	301174710DL	17x47x10 TC -NBR
3019227DL	9x22x7 TC -NBR	30112327	12x32x7 SC -NBR	30115427	15x42x7 SC -NBR	301174710	17x47x10 SC -NBR
3019247	9x24x7 SC -NBR	301123210	12x32x10 SC -NBR	30115428DL	15x42x8 TC -NBR	30118256DL	18x25x6 TC -NBR
3019267	9x26x7 SC -NBR	30112357DL	12x35x7 TC -NBR	30116214	16x21x4 SC -NBR	30118265DL	18x26x5 TC -NBR
3019268DL	9x26x8 TC -NBR	30113225DL	13x22x5 TC -NBR	30116224	16x22x4 SC -NBR	30118266DL	18x26x6 TC -NBR
3019268	9x26x8 SC -NBR	30113227DL	13x22x7 TC -NBR	30116244DL	16x24x4 TC -NBR	30118267DL	18x26x7 TC -NBR
30110164	10x16x4 SC -NBR	30113247DL	13x24x7 TC -NBR	30116244	16x24x4 SC -NBR	30118286DL	18x28x6 TC -NBR
30110184DL	10x18x4 TC -NBR	30113247	13x24x7 SC -NBR	30116245DL	16x24x5 TC -NBR	30118287DL	18x28x7 TC -NBR
30110185DL	10x18x5 TC -NBR	30113257DL	13x25x7 TC -NBR	30116246DL	16x24x6 TC -NBR	30118288DL	18x28x8 TC -NBR
30110186DL	10x18x6 TC -NBR	30113267DL	13x26x7 TC -NBR	30116247DL	16x24x7 TC -NBR	30118305DL	18x30x5 TC -NBR
30110197DL	10x19x7 TC -NBR	30113307	13x30x7 SC -NBR	30116247	16x24x7 SC -NBR	30118306DL	18x30x6 TC -NBR
30110197	10x19x7 SC -NBR	30113308	13x30x8 SC -NBR	30116257DL	16x25x7 TC -NBR	30118307DL	18x30x7 TC -NBR
30110204DL	10x20x4 TC -NBR	30114224DL	14x22x4 TC -NBR	30116265DL	16x26x5 TC -NBR	30118307	18x30x7 SC -NBR
30110206DL	10x20x6 TC -NBR	30114224	14x22x4 SC -NBR	30116267DL	16x26x7 TC -NBR	30118324DL	18x32x4 TC -NBR
30110207DL	10x20x7 TC -NBR	30114227DL	14x22x7 TC -NBR	30116267	16x26x7 SC -NBR	30118326DL	18x32x6 TC -NBR
30110207	10x20x7 SC -NBR	30114227	14x22x7 SC -NBR	30116287DL	16x28x7 TC -NBR	30118327DL	18x32x7 TC -NBR
301102065	10x20x65 SC -NBR	30114237DL	14x23x7 TC -NBR	30116287	16x28x7 SC -NBR	30118328DL	18x32x8 TC -NBR
30110226	10x22x6 SC -NBR	30114245DL	14x24x5 TC -NBR	30116299DL	16x29x9 TC -NBR	301183310DL	18x33x10 TC -NBR
30110227DL	10x22x7 TC -NBR	30114246DL	14x24x6 TC -NBR	30116299	16x29x9 SC -NBR	30118357DL	18x35x7 TC -NBR
30110228	10x22x8 SC -NBR	30114247DL	14x24x7 TC -NBR	30116307DL	16x30x7 TC -NBR	30118358DL	18x35x8 TC -NBR
30110247DL	10x24x7 TC -NBR	30114255DL	14x25x5 TC -NBR	30116308DL	16x30x8 TC -NBR	301183510DL	18x35x10 TC -NBR
30110247	10x24x7 SC -NBR	30114255	14x25x5 SC -NBR	30116308	16x30x8 SC -NBR	301183675	18x36x75 SC -NBR
30110257DL	10x25x7 TC -NBR	30114267DL	14x26x7 TC -NBR	301163010	16x30x10 SC -NBR	30118407DL	18x40x7 TC -NBR
30110267DL	10x26x7 TC -NBR	30114267	14x26x7 SC -NBR	30116327DL	16x32x7 TC -NBR	30118407	18x40x7 SC -NBR
30110267	10x26x7 SC -NBR	30114285DL	14x28x5 TC -NBR	301163210DL	16x32x10 TC -NBR	30119276DL	19x27x6 TC -NBR
30110276	10x27x6 SC -NBR	30114287DL	14x28x7 TC -NBR	30116357DL	16x35x7 TC -NBR	30119307DL	19x30x7 TC -NBR
30110308DL	10x30x8 TC -NBR	30114287	14x28x7 SC -NBR	30116405DL	16x40x5 TC -NBR	30119308DL	19x30x8 TC -NBR
301103210	10x32x10 SC -NBR	30114307DL	14x30x7 TC -NBR	301164010DL	16x40x10 TC -NBR	30119327DL	19x32x7 TC -NBR
30110357	10x35x7 SC -NBR	30114327DL	14x32x7 TC -NBR	30117247	17x24x7 SC -NBR	30119347DL	19x34x7 TC -NBR
30111174	11x 17x4 SC -NBR	30114357DL	14x35x7 TC -NBR	30117254DL	17x25x4 TC -NBR	30119356DL	19x35x6 TC -NBR
30111217DL	11x21x7 TC -NBR	30115245DL	15x24x5 TC -NBR	30117254	17x25x4 SC -NBR	301193510	19x35x10 SC -NBR
30111227DL	11x22x7 TC -NBR	30115246DL	15x24x6 TC -NBR	30117255DL	17x25x5 TC -NBR	30119378DL	19x37x8 TC -NBR
30111267	11x26x7 SC -NBR	30115247DL	15x24x7 TC -NBR	30117277DL	17x27x7 TC -NBR	301193710DL	19x37x10 TC -NBR

>>> Oil seals

At www.rodavigo.net Family: Sealing
Product: Oil seals

Oil seals measures by internal diameter

TC- Double lip
SC- Simple lip

Code	Measurements-Type	Code	Measurements-Type	Code	Measurements-Type	Code	Measurements-Type
301193710	19x37x10 SC -NBR	30120527	20x52x7 SC -NBR	30124477DL	24x47x7 TC -NBR	30125627DL	25x62x7 TC -NBR
30119408DL	19x40x8 TC -NBR	301205210DL	20x52x10 TC -NBR	301244710DL	24x47x10 TC -NBR	30125628DL	25x62x8 TC -NBR
30119427DL	19x42x7 TC -NBR	301206265	20x62x65 SC -NBR	30124528DL	24x52x8 TC -NBR	30125629DL	25x62x9 TC -NBR
30119477DL	19x47x7 TC -NBR	30121407DL	21x40x7 TC -NBR	30125326	25x32x6 SC -NBR	301256210DL	25x62x10 TC -NBR
30120264DL	20x26x4 TC -NBR	30122307DL	22x30x7 TC -NBR	30125327DL	25x32x7 TC -NBR	30125727DL	25x72x7 TC -NBR
30120264	20x26x4 SC -NBR	30122307	22x30x7 SC -NBR	30125355DL	25x35x5 TC -NBR	30126357DL	26x35x7 TC -NBR
30120284DL	20x28x4 TC -NBR	30122308DL	22x30x8 TC -NBR	30125355	25x35x5 SC -NBR	30126377DL	26x37x7 TC -NBR
30120284	20x28x4 SC -NBR	30122327DL	22x32x7 TC -NBR	30125356DL	25x35x6 TC -NBR	30126394DL	26x39x4 TC -NBR
30120286DL	20x28x6 TC -NBR	30122356DL	22x35x6 TC -NBR	30125357DL	25x35x7 TC -NBR	30126394	26x39x4 SC -NBR
30120286	20x28x6 SC -NBR	30122357DL	22x35x7 TC -NBR	30125357	25x35x7 SC -NBR	30126406DL	26x40x6 TC -NBR
30120305DL	20x30x5 TC -NBR	30122357	22x35x7 SC -NBR	30125367DL	25x36x7 TC -NBR	30126406	26x40x6 SC -NBR
30120306DL	20x30x6 TC -NBR	30122358DL	22x35x8 TC -NBR	30125367	25x36x7 SC -NBR	30126407DL	26x40x7 TC -NBR
30120307DL	20x30x7 TC -NBR	30122358	22x35x8 SC -NBR	30125368DL	25x36x8 TC -NBR	30126427DL	26x42x7 TC -NBR
30120324	20x32x4 SC -NBR	301223510DL	22x35x10 TC -NBR	301253610DL	25x36x10 TC -NBR	301264210DL	26x42x10 TC -NBR
30120325DL	20x32x5 TC -NBR	301223510	22x35x10 SC -NBR	30125375DL	25x37x5 TC -NBR	30126394DL	26x39x4 TC -NBR
30120326DL	20x32x6 TC -NBR	30122366	22x36x6 SC -NBR	30125376DL	25x37x6 TC -NBR	30126528DL	26x52x8 TC -NBR
30120326	20x32x6 SC -NBR	30122367DL	22x36x7 TC -NBR	30125377DL	25x37x7 TC -NBR	30127376DL	27x37x6 TC -NBR
30120327DL	20x32x7 TC -NBR	30122368DL	22x36x8 TC -NBR	30125387DL	25x38x7 TC -NBR	30127377DL	27x37x7 TC -NBR
30120334DL	20x33x4 TC -NBR	30122377DL	22x37x7 TC -NBR	30125389DL	25x38x9 TC -NBR	30127406DL	27x40x6 TC -NBR
30120354DL	20x35x4 TC -NBR	30122387	22x38x7 SC -NBR	30125405DL	25x40x5 TC -NBR	30127408DL	27x40x8 TC -NBR
30120355DL	20x35x5 TC -NBR	30122388DL	22x38x8 TC -NBR	30125406DL	25x40x6 TC -NBR	301274110	27x41x10 SC -NBR
30120356DL	20x35x6 TC -NBR	30122407DL	22x40x7 TC -NBR	30125407DL	25x40x7 TC -NBR	30127427DL	27x42x7 TC -NBR
30120357DL	20x35x7 TC -NBR	30122407	22x40x7 SC -NBR	30125408DL	25x40x8 TC -NBR	301274210DL	27x42x10 TC -NBR
30120358DL	20x35x8 TC -NBR	30122408DL	22x40x8 TC -NBR	30125409DL	25x40x9 TC -NBR	30127438DL	27x43x8 TC -NBR
301203510DL	20x35x10 TC -NBR	301224010DL	22x40x10 TC -NBR	301254010DL	25x40x10 TC -NBR	30127476DL	27x47x6 TC -NBR
301203510	20x35x10 SC -NBR	301224029	22x40x29 SC -NBR	30125426DL	25x42x6 TC -NBR	30127477DL	27x47x7 TC -NBR
30120367DL	20x36x7 TC -NBR	30122427	22x42x7 SC -NBR	30125426	25x42x6 SC -NBR	301274710DL	27x47x10 TC -NBR
30120377DL	20x37x7 TC -NBR	301224210DL	22x42x10 TC -NBR	30125427DL	25x42x7 TC -NBR	30127488	27x48x8 SC -NBR
30120378DL	20x37x8 TC -NBR	30122457DL	22x45x7 TC -NBR	30125428DL	25x42x8 TC -NBR	30128354	28x35x4 SC -NBR
301203710DL	20x37x10 TC -NBR	30122457	22x45x7 SC -NBR	301254210DL	25x42x10 TC -NBR	30128387DL	28x38x7 TC -NBR
30120387DL	20x38x7 TC -NBR	30122477DL	22x47x7 TC -NBR	30125439DL	25x43x9 TC -NBR	30128406DL	28x40x6 TC -NBR
30120387	20x38x7 SC -NBR	30122477	22x47x7 SC -NBR	30125439	25x43x9 SC -NBR	30128407DL	28x40x7 TC -NBR
30120388DL	20x38x8 TC -NBR	301224710DL	22x47x10 TC -NBR	301254310DL	25x43x10 TC -NBR	30128408DL	28x40x8 TC -NBR
30120406DL	20x40x6 TC -NBR	30123388	23x38x8 SC -NBR	30125457DL	25x45x7 TC -NBR	301284010DL	28x40x10 TC -NBR
30120406	20x40x6 SC -NBR	30123408DL	23x40x8 TC -NBR	30125457	25x45x7 SC -NBR	301284010	28x40x10 SC -NBR
30120407DL	20x40x7 TC -NBR	301234010DL	23x40x10 TC -NBR	30125458DL	25x45x8 TC -NBR	30128427DL	28x42x7 TC -NBR
30120408DL	20x40x8 TC -NBR	301234010	23x40x10 SC -NBR	301254510DL	25x45x10 TC -NBR	30128427	28x42x7 SC -NBR
301204010DL	20x40x10 TC -NBR	30124324	24x32x4 SC -NBR	30125467DL	25x46x7 TC -NBR	30128428DL	28x42x8 TC -NBR
301204010	20x40x10 SC -NBR	30124327DL	24x32x7 TC -NBR	30125476DL	25x47x6 TC -NBR	301284210DL	28x42x10 TC -NBR
30120426DL	20x42x6 TC -NBR	30124336	24x33x6 SC -NBR	30125477DL	25x47x7 TC -NBR	301284310DL	28x43x10 TC -NBR
30120426	20x42x6 SC -NBR	30124355DL	24x35x5 TC -NBR	30125477	25x47x7 SC -NBR	30128457DL	28x45x7 TC -NBR
30120427DL	20x42x7 TC -NBR	30124356DL	24x35x6 TC -NBR	30125478DL	25x47x8 TC -NBR	30128457DL	28x45x7 TC -NBR
301204210DL	20x42x10 TC -NBR	30124357DL	24x35x7 TC -NBR	301254710DL	25x47x10 TC -NBR	30128458DL	28x45x8 TC -NBR
301204210	20x42x10 SC -NBR	30124367DL	24x36x7 TC -NBR	30125488DL	25x48x8 TC -NBR	30128458	28x45x8 SC -NBR
30120457DL	20x45x7 TC -NBR	30124377DL	24x37x7 TC -NBR	301255010DL	25x50x10 TC -NBR	30128477DL	28x47x7 TC -NBR
30120458DL	20x45x8 TC -NBR	30124377	24x37x7 SC -NBR	30125525DL	25x52x5 TC -NBR	30128478DL	28x47x8 TC -NBR
30120477DL	20x47x7 TC -NBR	30124385DL	24x38x5 TC -NBR	30125527DL	25x52x7 TC -NBR	301284710DL	28x47x10 TC -NBR
30120478DL	20x47x8 TC -NBR	30124407DL	24x40x7 TC -NBR	30125528DL	25x52x8 TC -NBR	301284710	28x47x10 SC -NBR
301204710DL	20x47x10 TC -NBR	30124407	24x40x7 SC -NBR	30125529DL	25x52x9 TC -NBR	30128486DL	28x48x6 TC -NBR
301204712DL	20x47x12 TC -NBR	301244010	24x40x10 SC -NBR	301255210DL	25x52x10 TC -NBR	30128488DL	28x48x8 TC -NBR
30120488DL	20x48x8 TC -NBR	30124428DL	24x42x8 TC -NBR	301255210	25x52x10 SC -NBR	301284810DL	28x48x10 TC -NBR
30120527DL	20x52x7 TC -NBR	30124428	24x42x8 SC -NBR	301255510DL	25x55x10 TC -NBR	30128508DL	28x50x8 TC -NBR
						301285010DL	28x50x10 TC -NBR



>>> Oil seals

Oil seals measures by internal diameter

At www.rodavigo.net Family: Sealing
Product: Oil seals

TC- Double lip
SC- Simple lip

Code	Measurements-Type	Code	Measurements-Type	Code	Measurements-Type	Code	Measurements-Type
301285012	28x50x12 SC -NBR	301306210DL	30x62x10 TC -NBR	30133546DL	33x54x6 TC -NBR	30135728DL	35x72x8 TC -NBR
30128525	28x52x5 SC -NBR	301306211DL	30x62x11 TC -NBR	30133546	33x54x6 SC -NBR	301357210DL	35x72x10 TC -NBR
30128527DL	28x52x7 TC -NBR	301306212DL	30x62x12 TC -NBR	30133628	33x62x8 SC -NBR	301357210	35x72x10 SC -NBR
301285210DL	28x52x10 TC -NBR	301306212	30x62x12 SC -NBR	30134479DL	34x47x9 TC -NBR	301357212DL	35x72x12 TC -NBR
301285210	28x52x10 SC -NBR	301306510	30x65x10 SC -NBR	301344710DL	34x47x10 TC -NBR	301358010DL	35x80x10 TC -NBR
30128588DL	28x58x8 TC -NBR	301306810DL	30x68x10 TC -NBR	30134528DL	34x52x8 TC -NBR	301358013DL	35x80x13 TC -NBR
301286210	28x62x10 SC -NBR	30130728DL	30x72x8 TC -NBR	30134528	34x52x8 SC -NBR	30136477DL	36x47x7 TC -NBR
30129407DL	29x40x7 TC -NBR	301307210DL	30x72x10 TC -NBR	301345410DL	34x54x10 TC -NBR	30136477	36x47x7 SC -NBR
301294610DL	29x46x10 TC -NBR	301307210	30x72x10 SC -NBR	301346210DL	34x62x10 TC -NBR	30136507DL	36x50x7 TC -NBR
30130384	30x38x4 SC -NBR	301314710	31x47x10 SC -NBR	301346210	34x62x10 SC -NBR	30136527DL	36x52x7 TC -NBR
30130404DL	30x40x4 TC -NBR	30131527DL	31x52x7 TC -NBR	301347210DL	34x72x10 TC -NBR	30136529DL	36x52x9 TC -NBR
30130404	30x40x4 SC -NBR	30132424	32x42x4 SC -NBR	30135424	35x42x4 SC -NBR	30137628DL	37x62x8 TC -NBR
30130407DL	30x40x7 TC -NBR	30132425	32x42x5 SC -NBR	30135456DL	35x45x6 TC -NBR	301365610	36x56x10 SC -NBR
30130407	30x40x7 SC -NBR	30132427DL	32x42x7 TC -NBR	30135457DL	35x45x7 TC -NBR	30136627DL	36x62x7 TC -NBR
301304010DL	30x40x10 TC -NBR	30132436DL	32x43x6 TC -NBR	30135468DL	35x46x8 TC -NBR	301366810DL	36x68x10 TC -NBR
301304010	30x40x10 SC -NBR	30132437DL	32x43x7 TC -NBR	30135476DL	35x47x6 TC -NBR	301366810	36x68x10 SC -NBR
30130427DL	30x42x7 TC -NBR	30132447DL	32x44x7 TC -NBR	30135476	35x47x6 SC -NBR	30137529	37x52x9 SC -NBR
30130427	30x42x7 SC -NBR	30132448DL	32x44x8 TC -NBR	30135477DL	35x47x7 TC -NBR	301375210DL	37x52x10 TC -NBR
30130428DL	30x42x8 TC -NBR	30132456DL	32x45x6 TC -NBR	301354710DL	35x47x10 TC -NBR	30137628DL	37x62x8 TC -NBR
30130438DL	30x43x8 TC -NBR	30132457DL	32x45x7 TC -NBR	301354712DL	35x47x12 TC -NBR	301384810DL	38x48x10 TC -NBR
30130439DL	30x43x9 TC -NBR	301324510DL	32x45x10 TC -NBR	30135488DL	35x48x8 TC -NBR	30138507DL	38x50x7 TC -NBR
301304410DL	30x44x10 TC -NBR	30132477DL	32x47x7 TC -NBR	30135507DL	35x50x7 TC -NBR	30138507	38x50x7 SC -NBR
301304410	30x44x10 SC -NBR	30132477	32x47x7 SC -NBR	30135508DL	35x50x8 TC -NBR	30138527DL	38x52x7 TC -NBR
30130455DL	30x45x5 TC -NBR	301324710DL	32x47x10 TC -NBR	30135508	35x50x8 SC -NBR	30138528DL	38x52x8 TC -NBR
30130455	30x45x5 SC -NBR	301324710	32x47x10 SC -NBR	301355010DL	35x50x10 TC -NBR	301385210DL	38x52x10 TC -NBR
30130457DL	30x45x7 TC -NBR	30132488DL	32x48x8 TC -NBR	301355012DL	35x50x12 TC -NBR	30138549DL	38x54x9 TC -NBR
30130457	30x45x7 SC -NBR	30132507DL	32x50x7 TC -NBR	30135517DL	35x51x7 TC -NBR	301385410DL	38x54x10 TC -NBR
30130458DL	30x45x8 TC -NBR	30132508DL	32x50x8 TC -NBR	30135526DL	35x52x6 TC -NBR	301385410	38x54x10 SC -NBR
30130458	30x45x8 SC -NBR	30132508	32x50x8 SC -NBR	30135527DL	35x52x7 TC -NBR	30138557DL	38x55x7 TC -NBR
301304510DL	30x45x10 TC -NBR	301325010DL	32x50x10 TC -NBR	30135528DL	35x52x8 TC -NBR	30138557	38x55x7 SC -NBR
30130467DL	30x46x7 TC -NBR	30132526	32x52x6 SC -NBR	301355210DL	35x52x10 TC -NBR	301385510DL	38x55x10 TC -NBR
30130468DL	30x46x8 TC -NBR	30132527DL	32x52x7 TC -NBR	301355210	35x52x10 SC -NBR	301385610DL	38x56x10 TC -NBR
30130476DL	30x47x6 TC -NBR	30132527	32x52x7 SC -NBR	301355212	35x52x12 SC -NBR	301385610	38x56x10 SC -NBR
30130477DL	30x47x7 TC -NBR	30132528DL	32x52x8 TC -NBR	30135538	35x53x8 SC -NBR	301385810DL	38x58x10 TC -NBR
30130478DL	30x47x8 TC -NBR	30132529DL	32x52x9 TC -NBR	30135557DL	35x55x7 TC -NBR	301385810	38x58x10 SC -NBR
301304710DL	30x47x10 TC -NBR	30132529	32x52x9 SC -NBR	30135558DL	35x55x8 TC -NBR	301386010DL	38x60x10 TC -NBR
301304710	30x47x10 SC -NBR	301325210DL	32x52x10 TC -NBR	301355510DL	35x55x10 TC -NBR	30138627DL	38x62x7 TC -NBR
30130488DL	30x48x8 TC -NBR	301325210	32x52x10 SC -NBR	301355511DL	35x55x11 TC -NBR	301386210DL	38x62x10 TC -NBR
30130507DL	30x50x7 TC -NBR	301325211DL	32x52x11 TC -NBR	301355512	35x55x12 SC -NBR	301386212DL	38x62x12 TC -NBR
30130508DL	30x50x8 TC -NBR	301325410DL	32x54x10 TC -NBR	301355610DL	35x56x10 TC -NBR	301386510DL	38x65x10 TC -NBR
30130508	30x50x8 SC -NBR	301325510DL	32x55x10 TC -NBR	301355610	35x56x10 SC -NBR	30138688	38x68x8 SC -NBR
301305010DL	30x50x10 TC -NBR	301325510	32x55x10 SC -NBR	301355810DL	35x58x10 TC -NBR	301387210	38x72x10 SC -NBR
30130527DL	30x52x7 TC -NBR	301325610DL	32x56x10 TC -NBR	301355812	35x58x12 SC -NBR	301387212DL	38x72x12 TC -NBR
30130528DL	30x52x8 TC -NBR	301325610	32x56x10 SC -NBR	301356010DL	35x60x10 TC -NBR	301387212	38x72x12 SC -NBR
301305210DL	30x52x10 TC -NBR	301325812DL	32x58x12 TC -NBR	30135627DL	35x62x7 TC -NBR	301387410DL	38x74x10 TC -NBR
30130557DL	30x55x7 TC -NBR	301326210DL	32x62x10 TC -NBR	30135627	35x62x7 SC -NBR	301387410	38x74x10 SC -NBR
301305510DL	30x55x10 TC -NBR	301326212	32x62x12 SC -NBR	30135628DL	35x62x8 TC -NBR	3013863695	38x636x95 SC -NBR
301305512DL	30x55x12 TC -NBR	30133457DL	33x45x7 TC -NBR	301356210DL	35x62x10 TC -NBR	301395510DL	39x55x10 TC -NBR
30130566	30x56x6 SC -NBR	30133457	33x45x7 SC -NBR	301356212DL	35x62x12 TC -NBR	30140504	40x50x4 SC -NBR
301305610DL	30x56x10 TC -NBR	30133506DL	33x50x6 TC -NBR	301356212	35x62x12 SC -NBR	30140507DL	40x50x7 TC -NBR
301305610	30x56x10 SC -NBR	301335010	33x50x10 SC -NBR	301356510DL	35x65x10 TC -NBR	30140508DL	40x50x8 TC -NBR
301306010DL	30x60x10 TC -NBR	30133526DL	33x52x6 TC -NBR	301356512DL	35x65x12 TC -NBR	30140525	40x52x5 SC -NBR
30130627DL	30x62x7 TC -NBR	30133526	33x52x6 SC -NBR	30135727DL	35x72x7 TC -NBR	30140527DL	40x52x7 TC -NBR

>>> Oil seals

At www.rodavigo.net Family: Sealing
Product: Oil seals

Oil seals measures by internal diameter

TC- Double lip
SC- Simple lip

Code	Measurements-Type	Code	Measurements-Type	Code	Measurements-Type	Code	Measurements-Type
301405210DL	40x52x10 TC -NBR	301409010DL	40x90x10 TC -NBR	301456212DL	45x62x12 TC -NBR	30148728	48x72x8 SC -NBR
30140557DL	40x55x7 TC -NBR	301409010	40x90x10 SC -NBR	30145657DL	45x65x7 TC -NBR	301487210DL	48x72x10 TC -NBR
30140558DL	40x55x8 TC -NBR	30142524DL	42x52x4 TC -NBR	30145658DL	45x65x8 TC -NBR	301487210	48x72x10 SC -NBR
30140559DL	40x55x9 TC -NBR	30142524	42x52x4 SC -NBR	30145658	45x65x8 SC -NBR	301487212DL	48x72x12 TC -NBR
301405510DL	40x55x10 TC -NBR	30142527DL	42x52x7 TC -NBR	301456510DL	45x65x10 TC -NBR	301487410DL	48x74x10 TC -NBR
30140567DL	40x56x7 TC -NBR	30142557DL	42x55x7 TC -NBR	301456512DL	45x65x12 TC -NBR	301488010DL	48x80x10 TC -NBR
30140568DL	40x56x8 TC -NBR	30142558DL	42x55x8 TC -NBR	30145689DL	45x68x9 TC -NBR	301488013DL	48x80x13 TC -NBR
301405610DL	40x56x10 TC -NBR	30142558	42x55x8 SC -NBR	301456810DL	45x68x10 TC -NBR	301489011DL	48x90x11 TC -NBR
301405610	40x56x10 SC -NBR	30142567DL	42x56x7 TC -NBR	301456812DL	45x68x12 TC -NBR	30150605DL	50x60x5 TC -NBR
301405612	40x56x12 SC -NBR	30142567	42x56x7 SC -NBR	301456812	45x68x12 SC -NBR	30150608	50x60x8 SC -NBR
30140577DL	40x57x7 TC -NBR	301425810DL	42x58x10 TC -NBR	301457010DL	45x70x10 TC -NBR	301506010DL	50x60x10 TC -NBR
30140577	40x57x7 SC -NBR	301425810	42x58x10 SC -NBR	30145728DL	45x72x8 TC -NBR	30150625	50x62x5 SC -NBR
30140586	40x58x6 SC -NBR	30142607DL	42x60x7 TC -NBR	301457210DL	45x72x10 TC -NBR	30150627DL	50x62x7 TC -NBR
30140588DL	40x58x8 TC -NBR	301426010DL	42x60x10 TC -NBR	301457210	45x72x10 SC -NBR	30150627	50x62x7 SC -NBR
30140589DL	40x58x9 TC -NBR	30142626DL	42x62x6 TC -NBR	301457212DL	45x72x12 TC -NBR	301506210DL	50x62x10 TC -NBR
301405810DL	40x58x10 TC -NBR	30142626	42x62x6 SC -NBR	301457212	45x72x12 SC -NBR	301506210	50x62x10 SC -NBR
301405810	40x58x10 SC -NBR	30142628DL	42x62x8 TC -NBR	30145756DL	45x75x6 TC -NBR	30150656DL	50x65x6 TC -NBR
301405812	40x58x12 SC -NBR	301426210DL	42x62x10 TC -NBR	30145756	45x75x6 SC -NBR	30150658DL	50x65x8 TC -NBR
30140607DL	40x60x7 TC -NBR	301426210	42x62x10 SC -NBR	301457510DL	45x75x10 TC -NBR	301506510DL	50x65x10 TC -NBR
301406010DL	40x60x10 TC -NBR	30142658DL	42x65x8 TC -NBR	301457512DL	45x75x12 TC -NBR	30150688DL	50x68x8 TC -NBR
301406010	40x60x10 SC -NBR	30142658	42x65x8 SC -NBR	301457810	45x78x10 SC -NBR	301506810DL	50x68x10 TC -NBR
301406012DL	40x60x12 TC -NBR	301426510DL	42x65x10 TC -NBR	30145807DL	45x80x7 TC -NBR	30150708DL	50x70x8 TC -NBR
301406012	40x60x12 SC -NBR	301426510	42x65x10 SC -NBR	30145808DL	45x80x8 TC -NBR	30150708	50x70x8 SC -NBR
30140627DL	40x62x7 TC -NBR	301426512DL	42x65x12 TC -NBR	301458010DL	45x80x10 TC -NBR	301507010DL	50x70x10 TC -NBR
30140627	40x62x7 SC -NBR	30142728DL	42x72x8 TC -NBR	301458012DL	45x80x12 TC -NBR	301507012DL	50x70x12 TC -NBR
30140628DL	40x62x8 TC -NBR	301427210DL	42x72x10 TC -NBR	301458013DL	45x80x13 TC -NBR	30150727DL	50x72x7 TC -NBR
30140628	40x62x8 SC -NBR	301436010DL	43x60x10 TC -NBR	301458013DL	45x80x13 TC -NBR	30150728DL	50x72x8 TC -NBR
301406210DL	40x62x10 TC -NBR	301436010	43x60x10 SC -NBR	301458513DL	45x85x13 TC -NBR	301507210DL	50x72x10 TC -NBR
301406211DL	40x62x11 TC -NBR	301436011	43x60x11 SC -NBR	3014510015DL	45x100x15 TC -NBR	301507212DL	50x72x12 TC -NBR
301406212DL	40x62x12 TC -NBR	30144607DL	44x60x7 TC -NBR	301466510DL	46x65x10 TC -NBR	301507510DL	50x75x10 TC -NBR
301406212	40x62x12 SC -NBR	301446010DL	44x60x10 TC -NBR	301466510	46x65x10 SC -NBR	301507510	50x75x10 SC -NBR
301406310DL	40x63x10 TC -NBR	30144628DL	44x62x8 TC -NBR	301467810DL	46x78x10 TC -NBR	301507512DL	50x75x12 TC -NBR
30140657DL	40x65x7 TC -NBR	30144658DL	44x65x8 TC -NBR	30147658DL	47x65x8 TC -NBR	301507512	50x75x12 SC -NBR
301406510DL	40x65x10 TC -NBR	301446510DL	44x65x10 TC -NBR	301476510DL	47x65x10 TC -NBR	301507812	50x78x12 SC -NBR
301406510	40x65x10 SC -NBR	301446510	44x65x10 SC -NBR	301476510	47x65x10 SC -NBR	30150808DL	50x80x8 TC -NBR
301406512DL	40x65x12 TC -NBR	301447210	44x72x10 SC -NBR	301477010	47x70x10 SC -NBR	30150808	50x80x8 SC -NBR
301406512	40x65x12 SC -NBR	301447212DL	44x72x12 TC -NBR	30148607DL	48x60x7 TC -NBR	301508010DL	50x80x10 TC -NBR
301406611	40x66x11 SC -NBR	30145524	45x52x4 SC -NBR	30148627DL	48x62x7 TC -NBR	301508013DL	50x80x13 TC -NBR
30140687DL	40x68x7 TC -NBR	30145554DL	45x55x4 TC -NBR	30148627	48x62x7 SC -NBR	301508013	50x80x13 SC -NBR
30140688DL	40x68x8 TC -NBR	30145557DL	45x55x7 TC -NBR	30148628DL	48x62x8 TC -NBR	301508510DL	50x85x10 TC -NBR
30140688	40x68x8 SC -NBR	30145558DL	45x55x8 TC -NBR	30148628	48x62x8 SC -NBR	301508510	50x85x10 SC -NBR
301406810DL	40x68x10 TC -NBR	30145587DL	45x58x7 TC -NBR	301486210DL	48x62x10 TC -NBR	301508512DL	50x85x12 TC -NBR
301406811	40x68x11 SC -NBR	30145607DL	45x60x7 TC -NBR	30148658DL	48x65x8 TC -NBR	301508512	50x85x12 SC -NBR
301407010DL	40x70x10 TC -NBR	30145608DL	45x60x8 TC -NBR	30148658	48x65x8 SC -NBR	301509010DL	50x90x10 TC -NBR
301407010	40x70x10 SC -NBR	30145609DL	45x60x9 TC -NBR	301486510DL	48x65x10 TC -NBR	301509013DL	50x90x13 TC -NBR
301407012	40x70x12 SC -NBR	301456010DL	45x60x10 TC -NBR	301486512	48x65x12 SC -NBR	30152658DL	52x65x8 TC -NBR
30140727DL	40x72x7 TC -NBR	301456010	45x60x10 SC -NBR	301486610	48x66x10 SC -NBR	30152658	52x65x8 SC -NBR
301407210DL	40x72x10 TC -NBR	301456012DL	45x60x12 TC -NBR	301486810DL	48x68x10 TC -NBR	30152688DL	52x68x8 TC -NBR
301407210	40x72x10 SC -NBR	301456013DL	45x60x13 TC -NBR	30148709DL	48x70x9 TC -NBR	301526810DL	52x68x10 TC -NBR
301407212	40x72x12 SC -NBR	30145627DL	45x62x7 TC -NBR	301487010	48x70x10 SC -NBR	301527010DL	52x70x10 TC -NBR
301407513DL	40x75x13 TC -NBR	30145627	45x62x7 SC -NBR	301487012	48x70x12 SC -NBR	30152728DL	52x72x8 TC -NBR
301408010DL	40x80x10 TC -NBR	30145628DL	45x62x8 TC -NBR	30148727DL	48x72x7 TC -NBR	301527210DL	52x72x10 TC -NBR
301408012DL	40x80x12 TC -NBR	301456210DL	45x62x10 TC -NBR	30148728DL	48x72x8 TC -NBR	301527212DL	52x72x12 TC -NBR



>>> Oil seals

Oil seals measures by internal diameter

At www.rodavigo.net Family: Sealing
Product: Oil seals

TC- Double lip
SC- Simple lip

Code	Measurements-Type	Code	Measurements-Type	Code	Measurements-Type	Code	Measurements-Type
301527512DL	52x75x12 TC -NBR	301559013	55x90x13 SC -NBR	301609012DL	60x90x12 TC -NBR	3016511010DL	65x110x10 TC -NBR
301528010DL	52x80x10 TC -NBR	3015510010DL	55x100x10 TC -NBR	301609013DL	60x90x13 TC -NBR	3016512010DL	65x120x10 TC -NBR
301528010	52x80x10 SC -NBR	3015510012DL	55x100x12 TC -NBR	30160958	60x95x8 SC -NBR	3016512012DL	65x120x12 TC -NBR
301528012DL	52x80x12 TC -NBR	3015510013	55x100x13 SC -NBR	301609510DL	60x95x10 TC -NBR	301669212	66x92x12 SC -NBR
301528013DL	52x80x13 TC -NBR	30156708DL	56x70x8 TC -NBR	301609513	60x95x13 SC -NBR	301679513DL	67x95x13 TC -NBR
301528510DL	52x85x10 TC -NBR	30156708	56x70x8 SC -NBR	3016010010DL	60x100x10 TC -NBR	30168827DL	68x82x7 TC -NBR
301528512DL	52x85x12 TC -NBR	30156728	56x72x8 SC -NBR	3016011010	60x110x10 SC -NBR	301688210	68x82x10 SC -NBR
301528513DL	52x85x13 TC -NBR	30156808	56x80x8 SC -NBR	3016011013DL	60x110x13 TC -NBR	30168858DL	68x85x8 TC -NBR
301528513	52x85x13 SC -NBR	30156858DL	56x85x8 TC -NBR	301628010	62x80x10 SC -NBR	30168858	68x85x8 SC -NBR
301529012DL	52x90x12 TC -NBR	3015610010	56x100x10 SC -NBR	301628510DL	62x85x10 TC -NBR	301689010DL	68x90x10 TC -NBR
301529012	52x90x12 SC -NBR	301579010DL	57x90x10 TC -NBR	301628512DL	62x85x12 TC -NBR	301689012DL	68x90x12 TC -NBR
301529213DL	52x92x13 TC -NBR	30158728DL	58x72x8 TC -NBR	301629010DL	62x90x10 TC -NBR	301689012	68x90x12 SC -NBR
301536810	53x68x10 SC -NBR	30158728	58x72x8 SC -NBR	301629010	62x90x10 SC -NBR	301689510DL	68x95x10 TC -NBR
30153709DL	53x70x9 TC -NBR	301587512	58x75x12 SC -NBR	301629013	62x90x13 SC -NBR	3016810010DL	68x100x10 TC -NBR
301538212DL	53x82x12 TC -NBR	301587813	58x78x13 SC -NBR	301638510DL	63x85x10 TC -NBR	3016810013DL	68x100x13 TC -NBR
30154688	54x68x8 SC -NBR	30158808DL	58x80x8 TC -NBR	301638510	63x85x10 SC -NBR	3016810013	68x100x13 SC -NBR
301547010DL	54x70x10 TC -NBR	30158808	58x80x8 SC -NBR	301638810	63x88x10 SC -NBR	30170858DL	70x85x8 TC -NBR
301547010	54x70x10 SC -NBR	301588010DL	58x80x10 TC -NBR	301639010DL	63x90x10 TC -NBR	30170858	70x85x8 SC -NBR
301547012DL	54x70x12 TC -NBR	301588010	58x80x10 SC -NBR	3016310010DL	63x100x10 TC -NBR	301708510DL	70x85x10 TC -NBR
301547210DL	54x72x10 TC -NBR	301588012	58x80x12 SC -NBR	3016310013DL	63x100x13 TC -NBR	301708510	70x85x10 SC -NBR
301547210	54x72x10 SC -NBR	301588013DL	58x80x13 TC -NBR	3016310013	63x100x13 SC -NBR	301708512DL	70x85x12 TC -NBR
301547212DL	54x72x12 TC -NBR	301588013	58x80x13 SC -NBR	30164808DL	64x80x8 TC -NBR	30170907DL	70x90x7 TC -NBR
301547813DL	54x78x13 TC -NBR	301588510	58x85x10 SC -NBR	30164808	64x80x8 SC -NBR	301709010DL	70x90x10 TC -NBR
301548210DL	54x82x10 TC -NBR	301588512DL	58x85x12 TC -NBR	30164809	64x80x9 SC -NBR	301709012DL	70x90x12 TC -NBR
30155688DL	55x68x8 TC -NBR	301589010DL	58x90x10 TC -NBR	301648510DL	64x85x10 TC -NBR	301709012	70x90x12 SC -NBR
30155688	55x68x8 SC -NBR	301589010	58x90x10 SC -NBR	30164889	64x88x9 SC -NBR	301709013DL	70x90x13 TC -NBR
30155708DL	55x70x8 TC -NBR	301589013	58x90x13 SC -NBR	301649012DL	64x90x12 TC -NBR	30170955DL	70x95x5 TC -NBR
301557010DL	55x70x10 TC -NBR	30160707	60x70x7 SC -NBR	301649012	64x90x12 SC -NBR	301709510DL	70x95x10 TC -NBR
301557012DL	55x70x12 TC -NBR	301607012	60x70x12 SC -NBR	301657510DL	65x75x10 TC -NBR	301709513DL	70x95x13 TC -NBR
301557012	55x70x12 SC -NBR	30160727DL	60x72x7 TC -NBR	30165808DL	65x80x8 TC -NBR	301709513	70x95x13 SC -NBR
30155728DL	55x72x8 TC -NBR	30160728DL	60x72x8 TC -NBR	30165808	65x80x8 SC -NBR	3017010010DL	70x100x10 TC -NBR
30155729DL	55x72x9 TC -NBR	30160728	60x72x8 SC -NBR	30165809DL	65x80x9 TC -NBR	3017010013DL	70x100x13 TC -NBR
301557210DL	55x72x10 TC -NBR	30160758DL	60x75x8 TC -NBR	301658010DL	65x80x10 TC -NBR	3017010013	70x100x13 SC -NBR
301557212DL	55x72x12 TC -NBR	301607510DL	60x75x10 TC -NBR	301658010	65x80x10 SC -NBR	3017010513DL	70x105x13 TC -NBR
301557212	55x72x12 SC -NBR	301607810DL	60x78x10 TC -NBR	301658012	65x80x12 SC -NBR	3017010513	70x105x13 SC -NBR
30155758DL	55x75x8 TC -NBR	301607810	60x78x10 SC -NBR	30165838	65x83x8 SC -NBR	301701108DL	70x110x8 TC -NBR
301557510DL	55x75x10 TC -NBR	30160808DL	60x80x8 TC -NBR	30165858DL	65x85x8 TC -NBR	3017011012	70x110x12 SC -NBR
301557512DL	55x75x12 TC -NBR	301608010DL	60x80x10 TC -NBR	301658510DL	65x85x10 TC -NBR	3017011013DL	70x110x13 TC -NBR
301557512	55x75x12 SC -NBR	301608010	60x80x10 SC -NBR	301658510	65x85x10 SC -NBR	3017011513	70x115x13 SC -NBR
301557612DL	55x76x12 TC -NBR	301608012DL	60x80x12 TC -NBR	301658512DL	65x85x12 TC -NBR	3017012010DL	70x120x10 TC -NBR
301557810DL	55x78x10 TC -NBR	301608012	60x80x12 SC -NBR	301658513DL	65x85x13 TC -NBR	3017012014DL	70x120x14 TC -NBR
30155808DL	55x80x8 TC -NBR	301608013DL	60x80x13 TC -NBR	301658812DL	65x88x12 TC -NBR	30171888DL	71x88x8 TC -NBR
301558010DL	55x80x10 TC -NBR	30160829DL	60x82x9 TC -NBR	301659010DL	65x90x10 TC -NBR	301729010	72x90x10 SC -NBR
301558010	55x80x10 SC -NBR	301608210DL	60x82x10 TC -NBR	301659010	65x90x10 SC -NBR	30172957	72x95x7 SC -NBR
301558012DL	55x80x12 TC -NBR	301608212DL	60x82x12 TC -NBR	301659012DL	65x90x12 TC -NBR	301729510DL	72x95x10 TC -NBR
301558013DL	55x80x13 TC -NBR	301608412	60x84x12 SC -NBR	301659012	65x90x12 SC -NBR	3017210010DL	72x100x10 TC -NBR
301558013	55x80x13 SC -NBR	30160858DL	60x85x8 TC -NBR	301659013DL	65x90x13 TC -NBR	3017210010	72x100x10 SC -NBR
30155858DL	55x85x8 TC -NBR	301608510DL	60x85x10 TC -NBR	301659013	65x90x13 SC -NBR	3017210012DL	72x100x12 TC -NBR
301558510DL	55x85x10 TC -NBR	301608513DL	60x85x13 TC -NBR	301659013	65x90x13 SC -NBR	3017210013DL	72x100x13 TC -NBR
301558513DL	55x85x13 TC -NBR	301608513	60x85x13 SC -NBR	301659510DL	65x95x10 TC -NBR	3017210013DL	72x100x13 TC -NBR
30155908	55x90x8 SC -NBR	30160908DL	60x90x8 TC -NBR	301659513DL	65x95x13 TC -NBR	3017210513DL	72x105x13 TC -NBR
301559010DL	55x90x10 TC -NBR	301609010DL	60x90x10 TC -NBR	3016510010DL	65x100x10 TC -NBR	3017211013DL	72x110x13 TC -NBR
				3016510012	65x100x12 SC -NBR	3017211013	72x110x13 SC -NBR

>>> Oil seals

At www.rodavigo.net Family: Sealing
Product: Oil seals

Oil seals measures by internal diameter

TC- Double lip
SC- Simple lip

Code	Measurements-Type	Code	Measurements-Type	Code	Measurements-Type	Code	Measurements-Type
301759010	75x90x10 SC -NBR	3018510510DL	85x105x10 TC -NBR	3019614513	96x145x13 SC -NBR	30112014512	120x145x12 SC -NBR
301759510DL	75x95x10 TC -NBR	3018510513DL	85x105x13 TC -NBR	3019812013	98x120x13 SC -NBR	30112015012DL	120x150x12 TC -NBR
301759512DL	75x95x12 TC -NBR	3018511012DL	85x110x12 TC -NBR	3011001159	100x115x9 SC -NBR	30112015013DL	120x150x13 TC -NBR
301759513DL	75x95x13 TC -NBR	3018511012	85x110x12 SC -NBR	30110011510	100x115x10 SC -NBR	30112015014DL	120x150x14 TC -NBR
3017510010DL	75x100x10 TC -NBR	3018511013DL	85x110x13 TC -NBR	30110011512	100x115x12 SC -NBR	30112015015DL	120x150x15 TC -NBR
3017510010	75x100x10 SC -NBR	3018511513DL	85x115x13 TC -NBR	30110012010DL	100x120x10 TC -NBR	30112015015	120x150x15 SC -NBR
3017510012DL	75x100x12 TC -NBR	3018511513	85x115x13 SC -NBR	30110012012DL	100x120x12 TC -NBR	30112016012	120x160x12 SC -NBR
3017510013DL	75x100x13 TC -NBR	301851207	85x120x7 SC -NBR	30110012013DL	100x120x13 TC -NBR	30112016015	120x160x15 SC -NBR
3017510513DL	75x105x13 TC -NBR	3018512012DL	85x120x12 TC -NBR	30110012512DL	100x125x12 TC -NBR	30112514313DL	125x143x13 TC -NBR
3017510513	75x105x13 SC -NBR	3018512013DL	85x120x13 TC -NBR	30110012512	100x125x12 SC -NBR	30112514513	125x145x13 SC -NBR
3017511010DL	75x110x10 TC -NBR	3018512512	85x125x12 SC -NBR	30110012513DL	100x125x13 TC -NBR	30112515012DL	125x150x12 TC -NBR
3017511012DL	75x110x12 TC -NBR	3018512513DL	85x125x13 TC -NBR	30110013012DL	100x130x12 TC -NBR	30112515013DL	125x150x13 TC -NBR
3017511012	75x110x12 SC -NBR	3018512513	85x125x13 SC -NBR	30110013013DL	100x130x13 TC -NBR	30112515015	125x150x15 SC -NBR
3017511013DL	75x110x13 TC -NBR	3018513012DL	85x130x12 TC -NBR	30110013013	100x130x13 SC -NBR	30112516012DL	125x160x12 TC -NBR
3017511513DL	75x115x13 TC -NBR	3018513012	85x130x12 SC -NBR	30110013513DL	100x135x13 TC -NBR	30112516015DL	125x160x15 TC -NBR
3017511513	75x115x13 SC -NBR	3018712512	87x125x12 SC -NBR	30110014013DL	100x140x13 TC -NBR	30113015010	130x150x10 SC -NBR
3017512012DL	75x120x12 TC -NBR	3018811013DL	88x110x13 TC -NBR	30110015013DL	100x150x13 TC -NBR	30113015015DL	130x150x15 TC -NBR
3017512512	75x125x12 SC -NBR	3018811013	88x110x13 SC -NBR	30110015013	100x150x13 SC -NBR	30113015015	130x150x15 SC -NBR
301769010DL	76x90x10 TC -NBR	3018812612	88x126x12 SC -NBR	30110112416	101x124x16 SC -NBR	30113015412DL	130x154x12 TC -NBR
301769010	76x90x10 SC -NBR	3019010012	90x100x12 SC -NBR	30110412510DL	104x125x10 TC -NBR	30113015412	130x154x12 SC -NBR
301761008DL	76x100x8 TC -NBR	3019010510DL	90x105x10 TC -NBR	30110512512DL	105x125x12 TC -NBR	30113016012DL	130x160x12 TC -NBR
3017612712	76x127x12 SC -NBR	301901108DL	90x110x8 TC -NBR	30110512513DL	105x125x13 TC -NBR	30113016015DL	130x160x15 TC -NBR
3017810010DL	78x100x10 TC -NBR	3019011010DL	90x110x10 TC -NBR	30110512513	105x125x13 SC -NBR	30113016015	130x160x15 SC -NBR
3017810010	78x100x10 SC -NBR	3019011012DL	90x110x12 TC -NBR	30110513012DL	105x130x12 TC -NBR	30113020013DL	130x200x13 TC -NBR
3017810013DL	78x100x13 TC -NBR	3019011013DL	90x110x13 TC -NBR	30110513012	105x130x12 SC -NBR	30113020016DL	130x200x16 TC -NBR
30180955	80x95x5 SC -NBR	3019011013	90x110x13 SC -NBR	30110513013DL	105x130x13 TC -NBR	30113216012	132x160x12 SC -NBR
30180958DL	80x95x8 TC -NBR	3019011513DL	90x115x13 TC -NBR	30110513015DL	105x130x15 TC -NBR	30113515512DL	135x155x12 TC -NBR
301801007DL	80x100x7 TC -NBR	3019011513	90x115x13 SC -NBR	30110513514DL	105x135x14 TC -NBR	30113515513DL	135x155x13 TC -NBR
3018010010DL	80x100x10 TC -NBR	3019012012DL	90x120x12 TC -NBR	30110514013DL	105x140x13 TC -NBR	30113516013	135x160x13 SC -NBR
3018010012DL	80x100x12 TC -NBR	3019012012	90x120x12 SC -NBR	30110514018DL	105x140x18 TC -NBR	30113516015DL	135x160x15 TC -NBR
3018010013DL	80x100x13 TC -NBR	3019012013DL	90x120x13 TC -NBR	30110813013DL	108x130x13 TC -NBR	30113516514DL	135x165x14 TC -NBR
3018010513DL	80x105x13 TC -NBR	3019012513DL	90x125x13 TC -NBR	30111012512DL	110x125x12 TC -NBR	30113517012DL	135x170x12 TC -NBR
3018010513	80x105x13 SC -NBR	3019012513	90x125x13 SC -NBR	3011101289	110x128x9 SC -NBR	30113517015DL	135x170x15 TC -NBR
3018010515DL	80x105x15 TC -NBR	3019013010	90x130x10 SC -NBR	30111013012DL	110x130x12 TC -NBR	30114016012DL	140x160x12 TC -NBR
3018011010DL	80x110x10 TC -NBR	3019013013DL	90x130x13 TC -NBR	30111013012	110x130x12 SC -NBR	30114016013DL	140x160x13 TC -NBR
3018011012DL	80x110x12 TC -NBR	3019014013DL	90x140x13 TC -NBR	30111013013DL	110x130x13 TC -NBR	30114016015	140x160x15 SC -NBR
3018011013DL	80x110x13 TC -NBR	3019212012	92x120x12 SC -NBR	30111013512DL	110x135x12 TC -NBR	30114017013DL	140x170x13 TC -NBR
3018011510DL	80x115x10 TC -NBR	3019212013DL	92x120x13 TC -NBR	30111013512	110x135x12 SC -NBR	30114017015DL	140x170x15 TC -NBR
3018011510	80x115x10 SC -NBR	3019511010DL	95x110x10 TC -NBR	30111014012DL	110x140x12 TC -NBR	30114017015	140x170x15 SC -NBR
3018011513DL	80x115x13 TC -NBR	3019511012DL	95x110x12 TC -NBR	30111014012	110x140x12 SC -NBR	30114018012DL	140x180x12 TC -NBR
3018012012DL	80x120x12 TC -NBR	3019511012	95x110x12 SC -NBR	30111014013DL	110x140x13 TC -NBR	30114018015DL	140x180x15 TC -NBR
3018012513DL	80x125x13 TC -NBR	3019511513DL	95x115x13 TC -NBR	30111014014DL	110x140x14 TC -NBR	30114416012DL	144x160x12 TC -NBR
3018012513	80x125x13 SC -NBR	3019511513	95x115x13 SC -NBR	30111514012DL	115x140x12 TC -NBR	30114516513DL	145x165x13 TC -NBR
3018013013DL	80x130x13 TC -NBR	3019512012DL	95x120x12 TC -NBR	30111514013DL	115x140x13 TC -NBR	30114516713	145x167x13 SC -NBR
3018210513DL	82x105x13 TC -NBR	3019512012	95x120x12 SC -NBR	30111514510	115x145x10 SC -NBR	30114517012DL	145x170x12 TC -NBR
3018211013DL	82x110x13 TC -NBR	3019512013DL	95x120x13 TC -NBR	30111515012DL	115x150x12 TC -NBR	30114517012	145x170x12 SC -NBR
3018211013	82x110x13 SC -NBR	3019512013	95x120x13 SC -NBR	30111515012	115x150x12 SC -NBR	30114517014DL	145x170x14 TC -NBR
3018211513	82x115x13 SC -NBR	3019512512DL	95x125x12 TC -NBR	30111515015DL	115x150x15 TC -NBR	30114517014	145x170x14 SC -NBR
3018410010DL	84x100x10 TC -NBR	3019512513	95x125x13 SC -NBR	30111814013	118x140x13 SC -NBR	30114517515DL	145x175x15 TC -NBR
3018410010	84x100x10 SC -NBR	3019512710DL	95x127x10 TC -NBR	30112014012DL	120x140x12 TC -NBR	30115017015	150x170x15 SC -NBR
3018410013DL	84x100x13 TC -NBR	3019512710	95x127x10 SC -NBR	30112014012	120x140x12 SC -NBR	30115018012DL	150x180x12 TC -NBR
3018510010DL	85x100x10 TC -NBR	3019513012DL	95x130x12 TC -NBR	30112014013DL	120x140x13 TC -NBR	30115018013DL	150x180x13 TC -NBR
3018510013DL	85x100x13 TC -NBR	3019514513DL	95x145x13 TC -NBR	30112014013	120x140x13 SC -NBR	30115018014DL	150x180x14 TC -NBR



>>> Oil seals

Oil seals measures by internal diameter

At www.rodavigo.net Family: Sealing
Product: Oil seals

TC- Double lip
SC- Simple lip

Code	Measurements-Type	Code	Measurements-Type
30115018015DL	150x180x15 TC -NBR	30120025016	200x250x16 SC -NBR
30115018018DL	150x180x18 TC -NBR	30120026516	200x265x16 SC -NBR
30115019015DL	150x190x15 TC -NBR	30121024015DL	210x240x15 TC -NBR
30115218215DL	152x182x15 TC -NBR	30121024015	210x240x15 SC -NBR
30115517412DL	155x174x12 TC -NBR	30121025016	210x250x16 SC -NBR
30115517412	155x174x12 SC -NBR	30122025015DL	220x250x15 TC -NBR
30115517418	155x174x18 SC -NBR	30122025015	220x250x15 SC -NBR
30115517512	155x175x12 SC -NBR	30122025016	220x250x16 SC -NBR
30115518015DL	155x180x15 TC -NBR	30123026015DL	230x260x15 TC -NBR
30115518018	155x180x18 SC -NBR	30123026015	230x260x15 SC -NBR
30115519015DL	155x190x15 TC -NBR	30123026018	230x260x18 SC -NBR
30115519015	155x190x15 SC -NBR	30124027015DL	240x270x15 TC -NBR
30116018010DL	160x180x10 TC -NBR	30124027615	240x276x15 SC -NBR
30116018012DL	160x180x12 TC -NBR	30124028015DL	240x280x15 TC -NBR
30116018013DL	160x180x13 TC -NBR	30125028015DL	250x280x15 TC -NBR
30116018510DL	160x185x10 TC -NBR	30126030018	260x300x18 SC -NBR
30116018512DL	160x185x12 TC -NBR	30128031015	280x310x15 SC -NBR
30116018513DL	160x185x13 TC -NBR	30130034018	300x340x18 SC -NBR
30116018515	160x185x15 SC -NBR	30130034020DL	300x340x20 TC -NBR
30116019013DL	160x190x13 TC -NBR	30135039018DL	350x390x18 TC -NBR
30116019015DL	160x190x15 TC -NBR	30138147663	381x476x63 SC -NBR
30116020012DL	160x200x12 TC -NBR	30139768211	397x682x11 SC -NBR
30116020012	160x200x12 SC -NBR	30141260395	412x603x95 SC -NBR
30116518512	165x185x12 SC -NBR	30144463595	444x635x95 SC -NBR
30116519013DL	165x190x13 TC -NBR	30147052020	470x520x20 SC -NBR
30116519013	165x190x13 SC -NBR	30148663595	486x635x95 SC -NBR
30116519015DL	165x190x15 TC -NBR	30149269895	492x698x95 SC -NBR
3011701908DL	170x190x8 TC -NBR	30152057023	520x570x23 SC -NBR
30117020012DL	170x200x12 TC -NBR	30182086020	820x860x20 SC -NBR
30117020015DL	170x200x15 TC -NBR		
30117020015	170x200x15 SC -NBR		
30117020018DL	170x200x18 TC -NBR		
30117520015DL	175x200x15 TC -NBR		
30117520015	175x200x15 SC -NBR		
30117520515	175x205x15 SC -NBR		
30117820012	178x200x12 SC -NBR		
30118020015DL	180x200x15 TC -NBR		
30118021013DL	180x210x13 TC -NBR		
30118021015DL	180x210x15 TC -NBR		
30118021015	180x210x15 SC -NBR		
30118021515DL	180x215x15 TC -NBR		
30118021517DL	180x215x17 TC -NBR		
30118022015DL	180x220x15 TC -NBR		
30118521012DL	185x210x12 TC -NBR		
30118521013DL	185x210x13 TC -NBR		
30118521013	185x210x13 SC -NBR		
30119022012DL	190x220x12 TC -NBR		
30119022015DL	190x220x15 TC -NBR		
30119022015	190x220x15 SC -NBR		
30119023016	190x230x16 SC -NBR		
30120023015DL	200x230x15 TC -NBR		
30120023015	200x230x15 SC -NBR		
30120023016	200x230x16 SC -NBR		