

24. SCREWS AND RELATED

Endless Hose Clamps	p. 648
Super Hose Clamps	p. 648
Retaining Rings	p. 649
Nylon Cable Ties	p. 653
Hexagon socket set screws	p. 653
Screws	p. 655
Screws index	p. 660



MIKALOR

NORMA

Unbrako



>>> Endless hose clamps

Light series DIN 3017 Stainless W2

At www.rodavigo.net

Family: Screws
Product: Fastening elements

Light series DIN 3017 Stainless W4

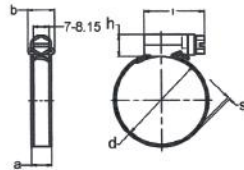

W2:
Band and housing: Stainless steel. X8Cr. 17 (DIN 1.4016) (AISI-430)
Captive screw: Qst Steel 34-3 (DIN 1.0213) Zinc plated.

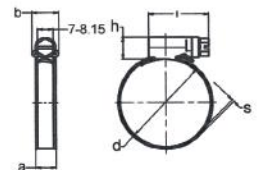

W4:
Band and housing: Stainless steel. X5CrNi 1810 (DIN 1.4301) (AISI-304)
Captive screw: Stainless Steel. AISI 302 Cu.

Code	Ø d application	l máx.	s +/-0,1	h máx.	a +/-0,3	b máx.
401812LW2	8-12	18	0,6	9,5	7,5	11,5
401816LW2	8-16	23	0,6	11	9	13
4011222LW2	12-22	23	0,6	11	9	13
4011627LW2	16-27	25	0,6	11	9	13
4012032LW2	20-32	25	0,6	11	9	13
4012035LW2	20-35	25	0,6	11	9	13
4012540LW2	25-40	27,5	0,7	11	9	13
4013045LW2	30-45	27,5	0,7	11	9	13
4013250LW2	32-50	27,5	0,7	11	9	13
4014460LW2	44-60	27,5	0,7	11	9	13
4015070LW2	50-70	29	0,7	11	9	13
4016080LW2	60-80	29	0,7	11	9	13
4017090LW2	70-90	29	0,7	11	9	13
40180100LW2	80-100	29	0,7	11	9	13
40190110LW2	90-110	29	0,7	11	9	13
401100120LW2	100-120	29	0,7	11	9	13
401110130LW2	110-130	29	0,7	11	9	13
401120140LW2	120-140	29	0,7	11	9	13
401130150LW2	130-150	29	0,7	11	9	13
401140160LW2	140-160	29	0,7	11	9	13

Code	Ø d application	l máx.	s +/-0,1	h máx.	a +/-0,3	b máx.
401816LW4	8-16	23	0,6	11	9	13
4011222LW4	12-22	23	0,6	11	9	13
4011627LW4	16-27	25	0,6	11	9	13
4012032LW4	20-32	25	0,6	11	9	13
4012035LW4	20-35	25	0,6	11	9	13
4012540LW4	25-40	27,5	0,7	11	9	13
4013045LW4	30-45	27,5	0,7	11	9	13
4013250LW4	32-50	27,5	0,7	11	9	13
4014060LW4	40-60	27,5	0,7	11	9	13
4015070LW4	50-70	29	0,7	11	9	13
4016080LW4	60-80	29	0,7	11	9	13
4017090LW4	70-90	29	0,7	11	9	13
40180100LW4	80-100	29	0,7	11	9	13
40190110LW4	90-110	29	0,7	11	9	13
401100120LW4	100-120	29	0,7	11	9	13
401110130LW4	110-130	29	0,7	11	9	13
401120140LW4	120-140	29	0,7	11	9	13
401130150LW4	130-150	29	0,7	11	9	13
401140160LW4	140-160	29	0,7	11	9	13

>>> Super hose clamps

Super W1 High Pressure Clamp

Code	Ø d application	a	b	c	Code	Ø d application	a	b	c		
4011719	17-19	18	0/+0,2	19,8	0,6	4018691	86-91	24	0/+0,4	26,5	1,5
4012022	20-22	18	0/+0,2	19,8	0,6	4019297	92-97	24	0/+0,4	26,5	1,5
4012325	23-25	18	0/+0,2	19,8	0,6	40198103	98-103	24	0/+0,4	26,5	1,5
4012628	26-28	18	0/+0,2	19,8	0,6	401104112	104-112	24	0/+0,4	26,5	1,5
4012931	29-31	20	0/+0,3	22	0,8	401113121	113-121	24	0/+0,4	26,5	1,5
4013235	32-35	20	0/+0,3	22	0,8	401122130	122-130	24	0/+0,4	26,5	1,5
4013639	36-39	20	0/+0,3	22	0,8	401131139	131-139	26	0/+0,5	29	1,7
4014043	40-43	20	0/+0,3	22	0,8	401140148	140-148	26	0/+0,5	29	1,7
4014447	44-47	22	0/+0,2	24,5	1,2	401149161	149-161	26	0/+0,5	29	1,7
4014851	48-51	22	0/+0,2	24,5	1,2	401162174	162-174	26	0/+0,5	29	1,7
4015255	52-55	22	0/+0,2	24,5	1,2	401175187	175-187	26	0/+0,5	29	1,7
4015659	56-59	22	0/+0,2	24,5	1,2	401188200	188-200	26	0/+0,5	29	1,7
4016063	60-63	22	0/+0,2	24,5	1,2	401201213	201-213	26	0/+0,5	29	1,7
4016467	64-67	22	0/+0,2	24,5	1,2	401214226	214-226	26	0/+0,5	29	1,7
4016873	68-73	24	0/+0,4	26,5	1,5	401227239	227-239	26	0/+0,5	29	1,7
4017479	74-79	24	0/+0,4	26,5	1,5	401240252	240-252	26	0/+0,5	29	1,7
4018085	80-85	24	0/+0,4	26,5	1,5						

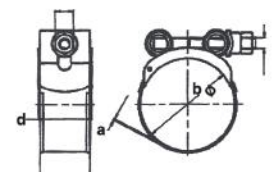

W1:
Material: semi-mild steel
Captive screw: Strength class steel 8.8
Protection: Bichromatized yellow zinc plated.

>>> Retaining rings

At www.rodavigo.net Family: Screws
Product: Fastening elements

Lock washers for DIN 6799 shafts

Code	Ø d1		d2	a	d1		m	n Min.		
					since	until				
401679912	1,2	-0,06	2,9	1,01	+/-0,04	1,4	2	0,34	+/-0,02	0,6
401679915	1,5	-0,06	3,9	1,28	+/-0,04	2	2,5	0,44	+/-0,04	0,8
401679919	1,9	-0,06	4,4	1,61	+/-0,04	2,5	3	0,54	+/-0,05	1
401679923	2,3	-0,06	5,9	1,94	+/-0,04	3	4	0,64	+/-0,05	1
401679932	3,2	-0,075	6,85	2,7	+/-0,04	4	5	0,64	+/-0,05	1
401679940	4,0	-0,075	8,85	3,34	+/-0,048	5	7	0,74	+/-0,05	1,2
401679950	5,0	-0,075	10,85	4,11	+/-0,048	6	8	0,74	+/-0,05	1,2
401679960	6,0	-0,075	11,85	5,26	+/-0,048	7	9	0,74	+/-0,05	1,2
401679970	7,0	-0,09	13,8	5,84	+/-0,048	8	11	0,94	+/-0,08	1,5
401679980	8,0	-0,09	15,8	6,52	+/-0,058	9	12	1,05	+/-0,08	1,8
401679990	9,0	-0,09	18,3	7,63	+/-0,058	10	14	1,15	+/-0,08	2
4016799100	10,0	-0,09	19,8	8,32	+/-0,058	11	15	1,25	+/-0,08	2
4016799120	12,0	-0,11	22,7	10,45	+/-0,07	13	18	1,35	+/-0,08	2,5
4016799150	15,0	-0,11	28,7	12,61	+/-0,07	16	24	1,55	+/-0,08	3
4016799190	19,0	-0,13	36,6	15,92	+/-0,07	20	31	1,8	+/-0,08	3,5
4016799240	24,0	-0,13	43,6	21,88	+/-0,08	25	38	2,05	+/-0,08	4

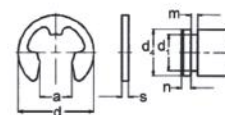

SPRING STEEL:
HRc 47+ 54 (HV 460-580)
Antioxidant oil

Lock washers for DIN 471-E shafts

Code	Ø nom	s	a max.	b _≈	d _s	d ₅ Min.		
4014713	3	0,4	-0,05	1,9	0,8	2,7	+0,04/-0,15	1
4014714	4	0,4	-0,05	2,2	0,9	3,7	+0,04/-0,15	1
4014715	5	0,6	-0,05	2,5	1,1	4,7	+0,04/0,15	1
4014716	6	0,7	-0,05	2,7	1,3	5,6	+0,04/0,15	1,2
4014717	7	0,8	-0,05	3,1	1,4	6,5	+0,06/0,18	1,2
4014718	8	0,8	-0,05	3,2	1,5	7,4	+0,6/0,18,	1,2
4014719	9	1	-0,06	3,3	1,7	8,4	+0,6/0,18	1,2
40147110	10	1	-0,06	3,3	1,8	9,3	+0,10/0,36	1,2
40147111	11	1	-0,06	3,3	1,8	10,2	+0,10/-0,36	1,5
40147112	12	1	-0,06	3,3	1,8	11	+0,10/-0,36	1,5
40147113	13	1	-0,06	3,4	2	11,9	+0,10/-0,36	1,7
40147114	14	1	-0,06	3,5	2,1	12,9	+0,10/-0,36	1,7
40147115	15	1	-0,06	3,6	2,2	13,8	+0,10/-0,36	1,7
40147116	16	1	-0,06	3,7	2,2	14,7	+0,10/-0,36	1,7
40147114	14	1	-0,06	3,8	2,3	15,7	+0,10/-0,36	1,7
40147118	18	1,2	-0,06	3,9	2,4	16,5	+0,10/-0,36	1,7
40147119	19	1,2	-0,06	3,9	2,5	17,5	+0,13/-0,36	2
40147120	20	1,2	-0,06	4	2,6	18,5	+0,13/-0,42	2
40147121	21	1,2	-0,06	4,1	2,7	19,5	+0,13/-0,42	2
40147122	22	1,2	-0,06	4,2	2,8	20,5	+0,21/-0,42	2
40147124	24	1,2	-0,06	4,4	3	22,2	+0,21/-0,42	2
40147125	25	1,2	-0,06	4,5	3	23,2	+0,21/-0,42	2
40147126	26	1,2	-0,06	4,7	3,1	24,2	+0,21/-0,42	2
40147128	28	1,5	-0,06	4,8	3,2	25,9	+0,21/-0,42	2
40147129	29	1,5	-0,06	5	3,4	26,9	+0,21/-0,42	2
40147130	30	1,5	-0,06	5,2	3,5	27,9	+0,21/-0,42	2
40147132	32	1,5	-0,06	5,4	3,6	29,6	+0,25/-0,42	2,5
40147134	34	1,5	-0,06	5,4	3,8	31,5	+0,25/-0,5	2,5
40147135	35	1,5	-0,06	5,6	3,9	32,2	+0,25/-0,5	2,5

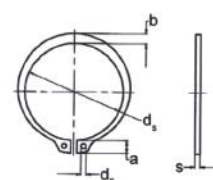

SPRING STEEL
≤ Ø48 HRc 47+54 (HV 470-580)
> Ø48 HRc 44+51 (HV 435-530)
Antioxidant oil



>>> Retaining rings

Lock washers for DIN 471-E shafts

At www.rodavigo.net Family: Screws
Product: Fastening elements

Code	Ø nom	s	a max.	b _≈	d ₃	d ₅ Min.		
40147136	36	1,75	-0,06	5,6	4	33,2	+0,25/-0,5	2,5
40147138	38	1,75	-0,06	5,8	4,2	35,2	+0,25/-0,5	2,5
40147140	40	1,75	-0,06	6	4,4	36,5	+0,39/-0,9	2,5
40147142	42	1,75	-0,06	6,5	4,5	38,5	+0,39/-0,9	2,5
40147145	45	1,75	-0,06	6,7	4,7	41,5	+0,39/-0,9	2,5
40147148	48	1,75	-0,06	6,9	5	44,5	+0,39/-0,9	2,5
40147150	50	2	-0,07	6,9	5,1	45,8	+0,39/-0,9	2,5
40147152	52	2	-0,07	7	5,2	47,8	+0,39/-0,9	2,5
40147155	55	2	-0,07	7,2	5,4	50,8	+0,46/-1,1	2,5
40147156	56	2	-0,07	7,3	5,5	51,8	+0,46/-1,1	2,5
40147158	58	2	-0,07	7,3	5,6	53,8	+0,46/-1,1	2,5
40147160	60	2	-0,07	7,4	5,8	55,8	+0,46/-1,1	2,5
40147162	62	2	-0,07	7,5	6	57,8	+0,46/-1,1	2,5
40147163	63	2	-0,07	7,6	6,2	58,8	+0,46/-1,1	2,5
40147165	65	2,5	-0,07	7,8	6,3	60,8	+0,46/-1,1	3
40147168	68	2,5	-0,07	8	6,5	63,5	+0,46/-1,1	3
40147170	70	2,5	-0,07	8,1	6,6	65,5	+0,46/-1,1	3
40147172	72	2,5	-0,07	8,2	6,8	67,5	+0,46/-1,1	3
40147175	75	2,5	-0,07	8,4	7	70,5	+0,46/-1,1	3
40147178	78	2,5	-0,07	8,6	7,3	73,5	+0,46/-1,1	3
40147180	80	2,5	-0,07	8,6	7,4	74,5	+0,46/-1,1	3
40147182	82	2,5	-0,07	8,7	7,6	76,5	+0,46/-1,1	3
40147185	85	3	-0,07	8,7	7,8	79,5	+0,46/-1,1	3,5
40147190	90	3	-0,07	8,8	8,2	84,5	+0,54/-1,08	3,5
40147195	95	3	-0,07	9,4	8,6	89,5	+0,54/-1,08	3,5
401471100	100	3	-0,07	9,6	9	94,5	+0,54/-1,08	3,5
401471105	105	4	-0,07	9,9	9,3	98	+0,54/-1,08	3,5
401471110	110	4	-0,07	10,1	9,6	103	+0,54/-1,08	3,5
401471115	115	4	-0,07	10,6	9,8	108	+0,54/-1,08	3,5
401471120	120	4	-0,07	11	10,2	113	+0,54/-1,08	3,5
401471125	125	4	-0,07	11,4	10,4	118	+0,54/-1,08	4
401471130	130	4	-0,07	11,6	10,7	123	+0,54/-1,08	4
401471135	135	4	-0,07	11,8	11	128	+0,54/-1,08	4
401471140	140	4	-0,07	12	11,2	133	+0,54/-1,08	4
401471145	145	4	-0,07	12,2	11,5	138	+0,54/-1,08	4
401471150	150	4	-0,07	13	11,8	142	+0,54/-1,08	4

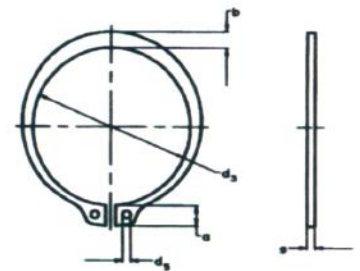

SPRING STEEL
≤ Ø48 HRc 47÷54 (HV 470-580)
> Ø48 HRc 44÷51 (HV 435-530)
Antioxidant oil

>>> Retaining rings

At www.rodavigo.net Family: Screws
Product: Fastening elements

Lock washer for DIN 472-1 holes

Code	Ø nom	s	a max.	b≈	d3	d5 min.		
4014728	8	0,8	0,05	2,4	1,1	8,7	+0,36/-0,10	1
4014729	9	0,8	0,05	2,5	1,3	9,8	+0,36/-0,10	1
40147210	10	1	0,06	3,2	1,4	10,8	+0,36/-0,10	1,2
40147211	11	1	0,06	3,3	1,5	11,8	+0,36/-0,10	1,2
40147212	12	1	0,06	3,4	1,7	13	+0,36/-0,10	1,5
40147213	13	1	0,06	3,6	1,8	14,1	+0,36/-0,10	1,5
40147214	14	1	0,06	3,7	1,9	15,1	+0,36/-0,10	1,7
40147215	15	1	0,06	3,7	2	16,2	+0,36/-0,10	1,7
40147216	16	1	0,06	3,8	2	17,3	+0,36/-0,10	1,7
40147217	17	1	0,06	3,9	2,1	18,3	+0,42/-0,13	1,7
40147218	18	1	0,06	4,1	2,2	19,5	+0,42/-0,13	2
40147219	19	1	0,06	4,1	2,2	20,5	+0,42/-0,13	2
40147220	20	1	0,06	4,2	2,3	21,5	+0,42/-0,13	2
40147221	21	1	0,06	4,2	2,4	22,5	+0,42/-0,13	2
40147222	22	1	0,06	4,2	2,5	23,5	+0,42/-0,13	2
40147224	24	1,2	0,06	4,4	2,6	25,9	+0,42/-0,21	2
40147225	25	1,2	0,06	4,5	2,7	26,9	+0,42/-0,21	2
40147226	26	1,2	0,06	4,7	2,8	27,9	+0,42/-0,21	2
40147228	28	1,2	0,06	4,8	2,9	30,1	+0,5/-0,25	2,5
40147230	30	1,2	0,06	4,8	3	32,1	+0,5/-0,25	2,5
40147231	31	1,2	0,06	5,2	3,2	33,4	+0,5/-0,25	2,5
40147232	32	1,2	0,06	5,4	3,2	34,4	+0,5/-0,25	2,5
40147234	34	1,5	0,06	5,4	3,3	36,5	+0,5/-0,25	2,5
40147235	35	1,5	0,06	5,4	3,4	37,8	+0,5/-0,25	2,5
40147236	36	1,5	0,06	5,4	3,5	38,8	+0,5/-0,25	2,5
40147237	37	1,5	0,06	5,5	3,6	39,8	+0,5/-0,25	2,5
40147238	38	1,5	0,06	5,5	3,7	40,8	+0,5/-0,25	2,5
40147240	40	1,5	0,06	5,8	3,9	43,5	+0,9/-0,39	2,5
40147242	42	1,5	0,06	5,9	4,1	45,5	+0,9/-0,39	2,5
40147245	45	1,75	0,07	6,2	4,3	48,5	+0,9/-0,39	2,5
40147247	47	1,75	0,07	6,4	4,4	50,5	+1,1/-0,46	2,5
40147248	48	1,75	0,07	6,4	4,5	51,5	+1,1/-0,46	2,5
40147250	50	2	0,07	6,5	4,6	54,2	+1,1/-0,46	2,5
40147252	52	2	0,07	6,7	4,7	56,2	+1,1/-0,46	2,5
40147255	55	2	0,07	6,8	5	59,2	+1,1/-0,46	2,5
40147256	56	2	0,07	6,8	5,1	60,2	+1,1/-0,46	2,5
40147258	58	2	0,07	6,9	5,2	62,2	+1,1/-0,46	2,5
40147260	60	2	0,07	7,3	5,4	64,2	+1,1/-0,46	2,5
40147262	62	2	0,07	7,3	5,5	66,2	+1,1/-0,46	2,5
40147263	63	2	0,07	7,3	5,6	67,2	+1,1/-0,46	2,5
40147265	65	2,5	0,07	7,6	5,8	69,2	+1,1/-0,46	3
40147268	68	2,5	0,07	7,8	6,1	72,5	+1,1/-0,46	3
40147270	70	2,5	0,07	7,8	6,2	74,5	+1,1/-0,46	3
40147272	72	2,5	0,07	7,8	6,4	76,5	+1,1/-0,46	3
40147275	75	2,5	0,07	7,8	6,6	79,5	+1,1/-0,46	3
40147278	78	2,5	0,07	8,5	6,8	82,5	+1,3/-0,54	3
40147280	80	2,5	0,07	8,5	7	85,5	+1,3/-0,54	3
40147282	82	2,5	0,07	8,5	7	87,5	+1,3/-0,54	3
40147285	85	3	0,07	8,5	7,2	90,5	+1,08/-0,54	3,5

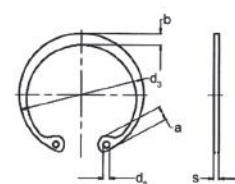

SPRING STEEL
 $\leq \varnothing 48$ HRc 47÷54 (HV 470-580)
 $> \varnothing 48$ HRc 44÷51 (HV 435-530)
 Antioxidant oil



>>> Retaining rings

Lock washer for DIN 472-I holes

At www.rodavigo.net Family: Screws
Product: Fastening elements

Code	Ø1	Ø nom	s	a max.	b _≈	d ₃	d ₅ Min.		
40147290	90	3	-0,07	-0,07	8,6	7,6	95,5	+1,08/-0,54	3,5
40147295	95	3	-0,07	-0,07	8,8	8,1	100,5	+1,08/-0,54	3,5
401472100	100	3	-0,07	-0,07	9	8,4	100,5	+1,08/-0,54	3,5
401472105	105	4	-0,07	-0,07	9,5	8,7	112	+1,08/-0,54	3,5
401472110	110	4	-0,07	-0,07	10,4	9	117	+1,08/-0,54	3,5
401472115	115	4	-0,07	-0,07	10,5	9,3	122	+1,26/-0,63	3,5
401472120	120	4	-0,07	-0,07	11	9,7	127	+1,26/-0,63	3,5
401472125	125	4	-0,07	-0,07	11	10	132	+1,26/-0,63	4
401472130	130	4	-0,07	-0,07	11	10,2	137	+1,26/-0,63	4
401472135	135	4	-0,07	-0,07	11,2	10,5	142	+1,26/-0,63	4
401472140	140	4	-0,07	-0,07	11,2	10,7	147	+1,26/-0,63	4
401472145	145	4	-0,07	-0,07	11,4	10,9	152	+1,26/-0,63	4
401472150	150	4	-0,07	-0,07	12	11,2	158	+1,26/-0,63	4

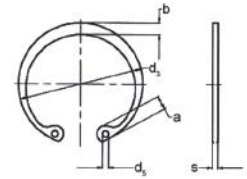

Fan washer DIN 6798

Code	Ø d1	d2	s1 +/- 0,1	Thread diameter		
				M.	W.	
4016798A3	3,2	6	-0,3	0,4	3	1/8"
4016798A4	4,3	8	-0,36	0,5	4	5/32"
4016798A5	5,1	9	-0,36	0,5	5	3/16"
4016798A6	6,4	11	-0,43	0,7	6	1/4"
4016798A7	7,4	12,5	-0,43	0,8	7	-
4016798A8	8,2	14	-0,43	0,8	8	5/16"
4016798A10	10,5	18	-0,43	0,9	10	3/8"
4016798A12	12,5	20,5	-0,52	1	12	-
4016798A14	14,5	24	-0,52	1	14	9/16"
4016798A16	16,5	26	-0,52	1,2	16	5/8"
4016798A18	19	30	-0,52	1,4	18	-
4016798A20	21	33	-0,62	1,4	20	4/4"

Washer Form A

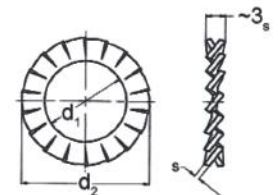

Code	Ø d1	d2	s	For Ø of thread			
				M.	W.		
4016798V3	3,2	6	-0,3	0,4	+/-0,1	3	1/8"
4016798V4	4,3	8	-0,36	0,5	+/-0,1	4	5/32"
4016798V5	5,1	9	-0,36	0,5	+/-0,1	5	3/16"
4016798V6	6,4	11	-0,43	0,7	+/-0,1	6	1/4"
4016798V8	8,2	14	-0,43	0,8	+/-0,1	8	5/16"
4016798V10	10,5	18	-0,43	0,9	+/-0,1	10	3/8"
4016798V12	12,5	20,5	-0,52	1	+/-0,1	12	1/2"
4016798V14	14	24	-0,52	1	+/-0,1	14	9/16"
4016798V16	16	26	-0,52	1,2	+/-0,2	16	5/8"

Washer Form B

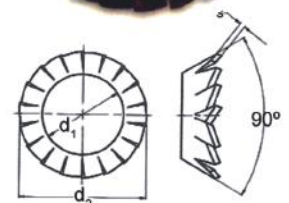

SPRING STEEL
HRc 37+43 (HV 365-425)
Antioxidant oil

>>> Nylon cable ties

At www.rodavigo.net Family: Screws
Product: Fastening elements

Precision nylon cable ties

Black colour Code	Natural colour Code	Dimensions	Black colour Code	Natural colour Code	Dimensions
401NYL2480B	401NYL2480N	2.4x80	401NYL76150B	401NYL76150N	7.6x150
401NYL25100B	401NYL25100N	2.5x100	401NYL76200B	401NYL76200N	7.6x200
401NYL25120B	401NYL25120N	2.5x120	401NYL76250B	401NYL76250N	7.6x250
401NYL25140B	401NYL25140N	2.5x140	401NYL76300B	401NYL76300N	7.6x300
401NYL25160B	401NYL25160N	2.5x160	401NYL76370B	401NYL76370N	7.6x370
401NYL25200B	401NYL25200N	2.5x200	401NYL76430B	401NYL76430N	7.6x430
401NYL28250B	401NYL28250N	2.8x250	401NYL76530B	401NYL76530N	7.6x530
401NYL28300B	401NYL28300N	2.8x300	401NYL90430B	401NYL90430N	9.0x430
401NYL36150B	401NYL36150N	3.6x150	401NYL90530B	401NYL90530N	9.0x530
401NYL36180B	401NYL36180N	3.6x180	401NYL90610B	401NYL90610N	9.0x610
401NYL36215B	401NYL36215N	3.6x215	401NYL90710B	401NYL90710N	9.0x710
401NYL36250B	401NYL36250N	3.6x250	401NYL90780B	401NYL90780N	9.0x780
401NYL36300B	401NYL36300N	3.6x300	401NYL90830B	401NYL90830N	9.0x830
401NYL36370B	401NYL36370N	3.6x370	401NYL90920B	401NYL90920N	9.0x920
401NYL48120B	401NYL48120N	4.8x120	401NYL901020B	401NYL901020N	9.0x120
401NYL48160B	401NYL48160N	4.8x160	401NYL901070B	401NYL901070N	9.0x170
401NYL48190B	401NYL48190N	4.8x190	401NYL901220B	401NYL901220N	9.0x1220
401NYL48200B	401NYL48200N	4.8x200	401NYL901530B	401NYL901530N	9.0x1530
401NYL48216B	401NYL48216N	4.8x216	401NYL126240B	401NYL126240N	12.6x240
401NYL48250B	401NYL48250N	4.8x250	401NYL126300B	401NYL126300N	12.6x300
401NYL48266B	401NYL48266N	4.8x266	401NYL126390B	401NYL126390N	12.6x390
401NYL48280B	401NYL48280N	4.8x280	401NYL126490B	401NYL126490N	12.6x490
401NYL48300B	401NYL48300N	4.8x300	401NYL126590B	401NYL126590N	12.6x590
401NYL48370B	401NYL48370N	4.8x370	401NYL126740B	401NYL126740N	12.6x740
401NYL48390B	401NYL48390N	4.8x390	401NYL126840B	401NYL126840N	12.6x840
401NYL48430B	401NYL48430N	4.8x430	401NYL126890B	401NYL126890N	12.6x890
401NYL48450B	401NYL48450N	4.8x450	401NYL1261040B	401NYL1261040N	12.6x1040
401NYL48530B	401NYL48530N	4.8x530			
401NYL48550B	401NYL48550N	4.8x550			
401NYL48635B	401NYL48635N	4.8x635			
401NYL48685B	401NYL48685N	4.8x685			
401NYL48730B	401NYL48730N	4.8x730			



>>> Hexagon socket set screws with flat point

Iso Metric Stud DIN-913

Family 401



L	Diameter / Allen wrench										
	M3	M4	M5	M6	M8	M10	M12	M16	M20	M24	
	1,5 mm A/F	2 mm A/F	2,5 mm A/F	3 mm A/F	4 mm A/F	5 mm A/F	6 mm A/F	8 mm A/F	10 mm A/F	12 mm A/F	
3	●	-	-	-	-	-	-	-	-	-	
4	●	●	-	-	-	-	-	-	-	-	
5	●	●	●	-	-	-	-	-	-	-	
6	●	●	●	●	-	-	-	-	-	-	
8	●	●	●	●	●	-	-	-	-	-	
10	-	●	●	●	●	●	-	-	-	-	
12	●	●	●	●	●	●	●	-	-	-	
15	-	-	●	●	●	●	-	-	-	-	
16	●	●	●	●	●	●	●	●	-	-	
20	-	●	●	●	●	●	●	●	●	-	
25	-	-	●	●	●	●	●	●	●	●	
30	-	-	●	●	●	●	●	●	-	-	
35	-	-	-	●	●	●	-	●	-	-	
40	-	-	-	●	●	●	●	-	-	-	
45	-	-	-	-	-	-	●	-	-	-	
50	-	-	-	-	●	●	●	-	-	-	
60	-	-	-	-	-	-	●	-	-	-	

● Product available

Specifications:

Metric socket: BS 4168 - Grade 45H

Flat point: ISO 4026 - DIN 913

Reference is: 401913 + metric+ length

Example: Stud-DIN 913 + metric 10 + length

12 mm = 4019131012

>>> Allen Drive Studs

DIN 916 - Hexagon socket set screws with cup point

 At www.rodavigo.net Family: Screws
 Product: Fastening elements

Family 401

L	Diameter / Allen wrench										
	M3 1,5 mm A/F	M4 2 mm A/F	M5 2,5 mm A/F	M6 3 mm A/F	M8 4 mm A/F	M10 5 mm A/F	M12 6 mm A/F	M16 8 mm A/F	M20 10 mm A/F	M24 12 mm A/F	
3	●	-	-	-	-	-	-	-	-	-	
4	●	●	-	-	-	-	-	-	-	-	
5	●	●	●	-	-	-	-	-	-	-	
6	●	●	●	●	-	-	-	-	-	-	
8	●	●	●	●	●	-	-	-	-	-	
10	●	●	●	●	●	●	-	-	-	-	
12	●	●	●	●	●	●	●	-	-	-	
15	-	●	●	●	●	●	-	-	-	-	
16	●	●	●	●	●	●	●	●	-	-	
20	-	●	●	●	●	●	●	●	●	-	
25	-	-	●	●	●	●	●	●	●	●	
30	-	-	●	●	●	●	●	●	●	●	
35	-	-	-	●	●	●	●	●	●	●	
40	-	-	-	●	●	●	●	●	●	●	
45	-	-	-	●	●	●	●	●	-	-	
50	-	-	-	●	●	●	●	●	●	●	
55	-	-	-	-	-	-	-	●	-	●	
60	-	-	-	-	-	-	●	●	●	●	

● Product available

Specifications:

 Metric socket: BS 4168 - Grade 45SH
 Cup point: ISO 4029 - DIN 916

 Reference is: 401913 + metric+ length
 Example: Stud-DIN 915 + metric 10 + length
 12 mm = 4019131012

DIN 914 - Hexagon socket set screws with cone point
Family 401

L	Diameter / Allen wrench						
	M3 1,5 mm A/F	M4 2 mm A/F	M5 2,5 mm A/F	M6 3 mm A/F	M8 4 mm A/F	M10 5 mm A/F	M12 6 mm A/F
5	●	●	-	-	-	-	-
6	●	●	●	●	-	-	-
8	●	●	●	●	●	-	-
10	●	●	●	●	●	●	-
12	-	●	●	●	●	●	-
15	-	-	-	-	●	-	-
16	-	-	●	●	●	●	●
20	-	-	●	●	●	●	●
25	-	-	-	●	●	●	-
30	-	-	-	●	●	-	-
40	-	-	-	-	-	●	-
50	-	-	-	-	-	-	-
55	-	-	-	-	-	-	-

● Product available

Specifications:

 Metric socket: BS 4168 - Grade 45SH
 Cone point: ISO 4027 - DIN 914

 Reference is: 401913 + metric+ length
 Example: Stud-DIN 915 + metric 10 + length
 12 mm = 4019131012

SCREWS AND RELATED

>>> Screws

At www.rodavigo.net Family: Screws
Product: Fastening elements

Screws

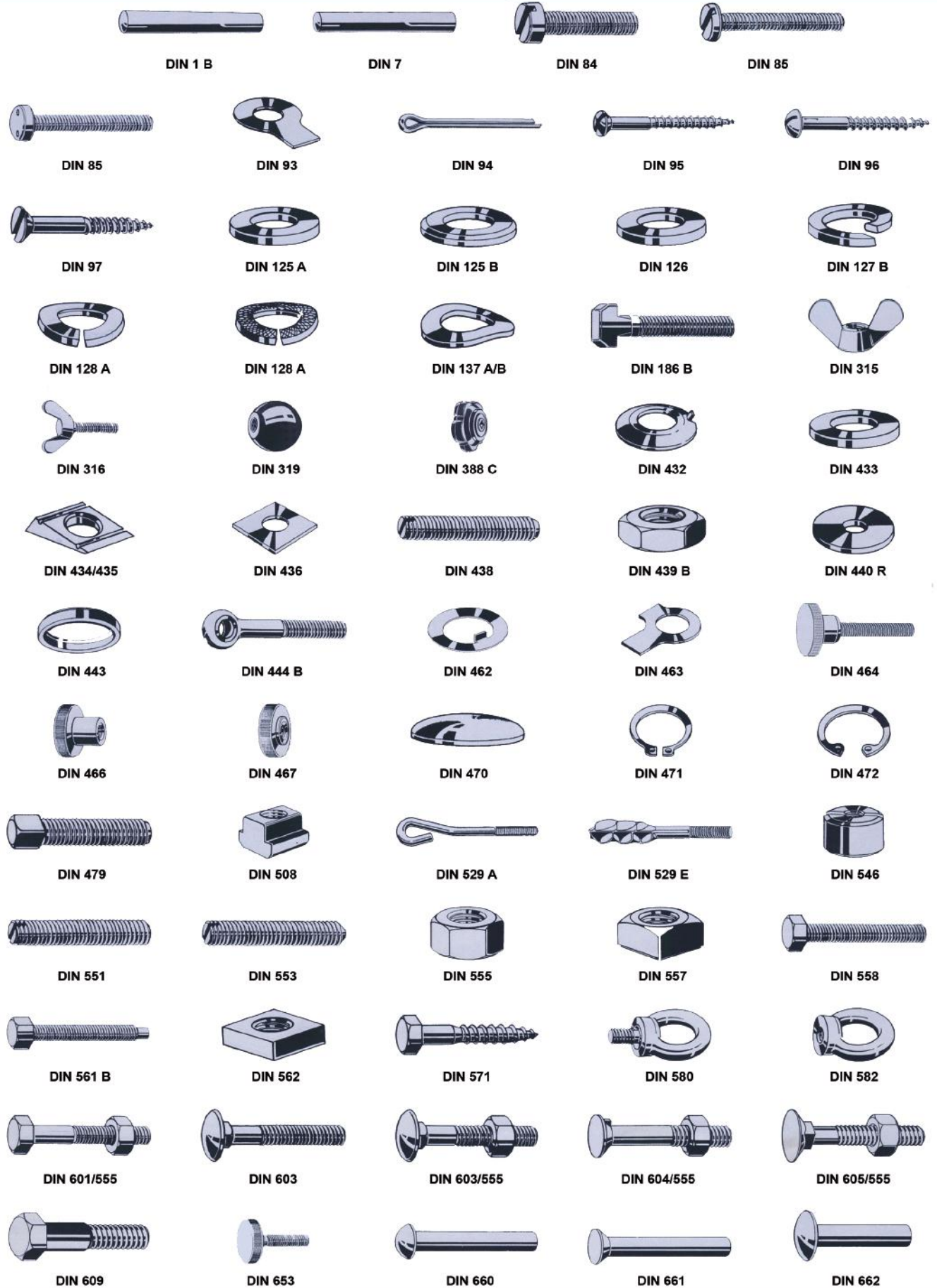



>>> Screws

Screws

At www.rodavigo.net Family: Screws
Product: Fastening elements



DIN 705 A/916



DIN 705 A/553



DIN 741/555



DIN 787



DIN 808 D



DIN 808 E



DIN 906



DIN 908



DIN 910



DIN 911



DIN 912



DIN 913



DIN 914



DIN 915



DIN 916



DIN 917

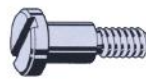

DIN 923



DIN 928



DIN 929



DIN 931



DIN 933



DIN 934



DIN 935



DIN 938/939



DIN 950



DIN 960



DIN 961



DIN 963



DIN 963



DIN 964



DIN 965



DIN 966



DIN 975



DIN 976 A



DIN 979



DIN 980 V



DIN 982/985



DIN 986



DIN 988



DIN 1440



DIN 1470



DIN 1471



DIN 1472



DIN 1473



DIN 1474



DIN 1475



DIN 1476



DIN 1480



DIN 1480



DIN 1480



DIN 1481



DIN 1587



DIN 1804 W



DIN 2093 A/B/C



DIN 2095



DIN 2097



DIN 2510 L/NF



DIN 4626 A/934



DIN 5401



DIN 6319



DIN 6319 D



DIN 6325



DIN 6330 B



DIN 6331

>>> Screws

At www.rodavigo.net Family: Screws
Product: Fastening elements

Screws





>>> Screws

Screws

At www.rodavigo.net Family: Screws
Product: Fastening elements

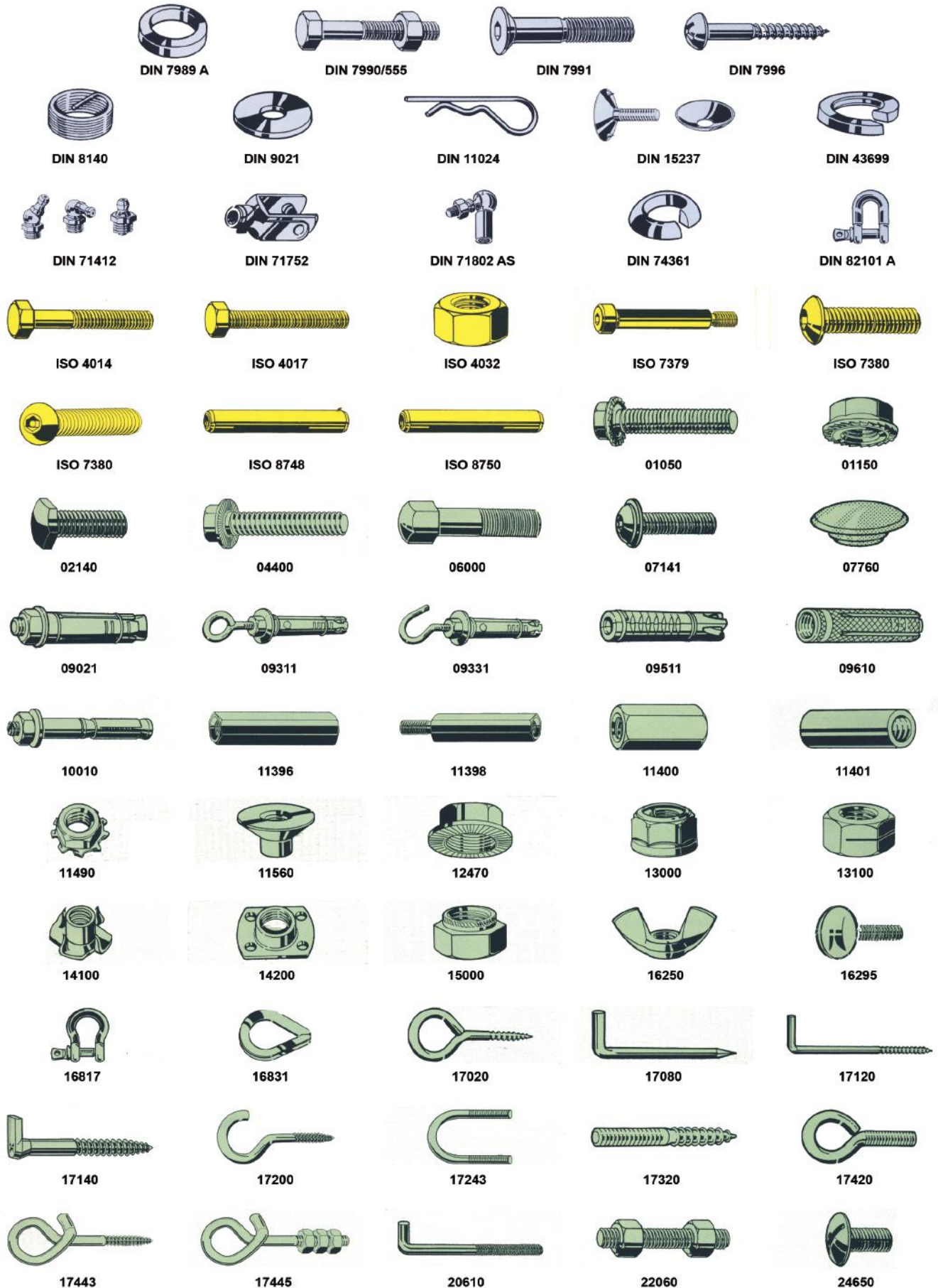

>>> Screws

At www.rodavigo.net Family: Screws
Product: Fastening elements

Screws





>>> Index

At www.rodavigo.net Family: Screws
Product: Fastening elements

DIN 1B	Taper pins	DIN 934	Hexagon nuts
DIN 7	Dowel pins	DIN 935	Hexagon slotted castle nuts
DIN 84	Slotted cheese head screws	DIN 938	Studs with engagement length 1 xd
DIN 85	Slotted pan head screws	DIN 939	Studs, with engagement length 1,25 xd
DIN 85	Round head screws with 2 holes	DIN 950	Hose clamps with worm gear drive
DIN 93	Slices with a cloth (lock washers)	DIN 960	Partially Threaded Hex Cap Screws (Fine Thread)
DIN 94	Split pins	DIN 961	Hex Cap Screws, Metric Fine Thread - Full Thread
DIN 95	Slotted oval head wood screws	DIN 963	Slotted countersunk head screws
DIN 96	Slotted Round Head Wood Screws	DIN 963	Countersunk head screws with 2 holes
DIN 97	Slotted Flat Head Wood Screws	DIN 964	Slotted raised countersunk oval head screws
DIN 125A	Plain washers, Form A	DIN 965	Cross recessed countersunk flat head screws
DIN 125B	Plain washers, Form B	DIN 966	Cross recessed raised countersunk head screws
DIN 126	Plain washers	DIN 975	Threaded rods
DIN 127B	Spring lock washers, Form B	DIN 976A	Metric thread stud bolts, Form A
DIN 128A	Split Spring Washers, Curved, Form A	DIN 979	Hex thin slotted and castle nuts-coarse and fine pitch thread
DIN 128A	Rings with locking edges	DIN 980V	DIN 980 - Hexagon nuts with clamping part, all metal nut, Form V
DIN 137 A/B	Spring washers curved, Form A/Spring washers curved, Form B	DIN 982	Prevailing torque nuts with nonmetallic insert
DIN 186B	T-Head bolts with square neck Head	DIN 985	Prevailing torque type hexagon thin nuts with non-metallic insert
DIN 315	Wing nuts with rectangular wings	DIN 986	Prevailing torque hexagon domed nuts with non-metallic insert
DIN 316	Wing screws with rectangular wings	DIN 988	Shim rings and supporting rings
DIN 319	Ball Knobs	DIN 1440	Medium type washers for pins
DIN 388C	Hand wheels, Form C	DIN 1470	Grooved Pins, Full Length Parallel Grooved with Pilot
DIN 432	External tabs	DIN 1471	Grooved Pins, Full Length Taper-grooved
DIN 433	Washers for cheese head screws	DIN 1472	Parallel Grooved Pins
DIN 434	Square taper washers for U-sections	DIN 1473	Cylindrical grooved pins
DIN 435	Square taper washers for I-sections	DIN 1474	Grooved pins full length parallel
DIN 436	Square Washers for wood constructions	DIN 1475	Grooved Pins, Third Length Centre-grooved
DIN 438	Slotted set screws with cup point	DIN 1476	Round Head Grooved Pins
DIN 439B	Hexagon thin nuts chamfered	DIN 1480	Turnbuckles, forged (open form)
DIN 440R	Washers for use in timber constructions	DIN 1480	Turnbuckles, forged (open form)
DIN 443	Cover plates	DIN 1480	Turnbuckles, forged (open form)
DIN 444B	Eyebolts, Form B	DIN 1481	Spring-Type Straight Pins (Roll Pins) - Heavy Type
DIN 462	Retaining plates with internal nose	DIN 1587	Hexagon domed cap nuts
DIN 463	Lock washers with two flaps	DIN 1804W	Slotted round nuts for hook spanners
DIN 464	Knurled thumb screws, high type	DIN 2093A/B/C	A/B/C- Discs Spring Washer
DIN 466	Knurled nuts, high type	DIN 2095	Helical compression springs
DIN 467	Knurled nuts, low type	DIN 2097	Helical tension springs
DIN 470	Sealing washers	DIN 2510L/NF	Double end studs with reduced shank with 2 hexagon nuts
DIN 471	Retaining rings for shafts	DIN 4626A/934	Center bolts for laminated leaf springs
DIN 472	Retaining rings for bores	DIN 5401	Steel balls
DIN 479	Square head bolts with short dog point	DIN 6319C	Spherical washers, Form C
DIN 508	Nuts for T-slots	DIN 6319D	Spherical washers, Form D
DIN 529A	Anchor Bolts (Stone Bolt), Form A	DIN 6325	Dowel Pins
DIN 529E	Anchor Bolts (Stone Bolt), Form E	DIN 6330B	Hexagon nuts height 1.5 xD
DIN 546	Slotted Round Nuts	DIN 6331	Hexagon nuts with collar height 1.5 x D
DIN 551	Slotted set screws	DIN 6336	Star knobs Form D with through holes
DIN 553	Slotted set screws with cone point	DIN 6340	Washers for clamping devices
DIN 555	Hexagon Nuts, production class C	DIN 6379	Studs for T-nuts
DIN 557	Square Nuts	DIN 6797A	Toothed lock washers, external Form A
DIN 558	Hexagonal screws, production class C	DIN 6797J	Toothed lock washers, internal Form J
DIN 561B	Hexagon head screws with small hexagon and dog point - steel	DIN 6798A	Serrated lock washers, Form I - external
DIN 562	Square thin nuts	DIN 6798J	Serrated lock washers, Form J - internal
DIN 571	Hex wood screws	DIN 6798V	Serrated lock washers, V - conical
DIN 580	Lifting Eye Bolts (Collar eyebolts for lifting purposes)	DIN 6799	Retaining washers for shafts
DIN 582	Lifting Eye Nuts	DIN 6880	Keys steel
DIN 601/555	Hexagon head bolts with hexagon nuts	DIN 6885A	Parallel keys high type
DIN 603	Mushroom head square neck bolts	DIN 6887	Taper keys gip head
DIN 603/555	Carriage bolt with hexagon nuts	DIN 6888	Disc springs
DIN 604/555	Flat countersunk nib bolts with hexagon nuts	DIN 6900	Disc springs
DIN 605/555	Flat countersunk square neck bolts with hexagon nuts	DIN 6911	Hexagon socket screw keys
DIN 609	Hexagon fits bolts with long thread	DIN 6912	Hexagon socket head cap screws with low head and centre
DIN 653	Flat Knurled Thumb Screws	DIN 6914	Hexagon bolts with large head
DIN 660	Round Head Rivets	DIN 6915	Hexagon nuts with large wrench size
DIN 661	Countersunk Head Rivets	DIN 6916	Plain chamfered washers
DIN 662	Head rivets (rivets sheet)	DIN 6917	Square taper washers for friction grip bolts on double T-sections
DIN 705A/916	Adjusting rings, Form A, with Hexagon socket set screws with cup point	DIN 6918	Square taper washers for friction grip bolts on U-sections
DIN 705A/553	Adjusting rings, Form A, with Slotted set screws with cone point	DIN 6921	Hexagon flange bolts metric
DIN 741/555	Wire rope clips	DIN 6923	Hexagon nuts with flange
DIN 787	Bolts and screws for T-slots	DIN 6926	Hexagon flange lock nuts
DIN 808D	Cardans, Form D	DIN 7337	Break mandrel blind rivets
DIN 808E	Cardans, Form E	DIN 7349	Washers for bolts with heavy clamping sleeves
DIN 906	Locking screws with hexagon socket, taper thread	DIN 7500	Thread forming screws
DIN 908	Cap with hexagonal head and collar	DIN 7500A	Thread forming screws with slotted cheese head
DIN 910	Screw plugs with collar and outer hexagon, cylindrical thread	DIN 7500C	Thread forming screws with cross recessed raised cheese head Z
DIN 911	Hex key	DIN 7500D	Thread forming screws for hexagon head
DIN 912	Hexagon socket Head Cap Screws	DIN 7500M	Thread forming screws with cross recessed countersunk flat head screws
DIN 913	Hexagon socket set screws with flat point	DIN 7500N	Thread forming screws with cross recessed raised countersunk head screws
DIN 914	Hexagon socket set screws with cone point	DIN 7504K	Drilling screws hex
DIN 915	Hexagon socket set screws with full dog point	DIN 7504N	Panhead self drilling screws
DIN 916	Hexagon socket set screws with cup point	DIN 7504P	Countersunk head self drilling screws
DIN 917	Hexagon Cup Nuts - Low Pattern	DIN 7513A	Hex tapping screws
DIN 923	Slotted pan head screws with shoulder	DIN 7516A	Self-Tapping Thread Cutting Screw with Phillips, Form A
DIN 928	Square Weld Nuts	DIN 7516D	Self-Tapping Thread Cutting Screw whit flat head with Phillips, Form D
DIN 929	Hexagon weld nuts		
DIN 931	Hexagon head bolts with shank		
DIN 933	Hexagon head bolts with thread up to head		

>>> Index

At www.rodavigo.net Family: Screws
Product: Fastening elements

DIN 7516E	Self-tapping screws raised countersunk Phillips, form E	14100	Four claw furniture nuts
DIN 7603	Sealing rings	14290	Weld nuts
DIN 7965	Slotted inserts	15000	Four claw nuts
DIN 7967	Self-locking counter nuts PAL	16250	Wint nuts, type american, light weight
DIN 7971C	Slotted pan head tapping screws with cone end	16295	Thumbscrews
DIN 7971C	Self tapping screws	16817	Shackles with eye screw pin
DIN 7971F	Slotted pan head tapping screws whitout point	16831	Thimbles
DIN 7972C	Slotted countersunk head tapping screws with cone end	17020	Screw eyes
DIN 7973C	Slotted raised countersunk head tapping screws with cone end	17080	Square hooks
DIN 7973F	Slotted raised countersunk head tapping screws without point	17120	Square screw hooks
DIN 7976C	Hexagon head self tapping screws with cone end	17140	Cross recessed head square screw hooks
DIN 7976C	Hexagon head self tapping screws	17200	Cup hooks
DIN 7976F	Hexagon head self tapping screws without point	17243	U-bolts
DIN 7977	Taper pins with external thread	17320	Coach screw rods
DIN 7978A	Taper pins with internal thread, form A	17420	Bolt eyes
DIN 7979D	Parallel Pins with Internal Thread, form D	17443	Safety screw eyes
DIN 7980	Spring lock washers for cylinder head screws	17445	Safety screw eyes
DIN 7981C	Pan head tapping screws with cross recess H and Z, form C	20610	50 mm L shaped hook bolts
DIN 7981C	Pan head tapping screws with cross recess H and Z and pin, form C	22060	Fully threaded rod with 2 hex nuts
DIN 7981F	Self tapping screws with domed cylindrical head with cruciform hole	24650	Locker slotted head bolts
DIN 7982C	Cross recessed countersunk head tapping screws, Form C	24700	Pointed nuts
DIN 7982C	Cross recessed countersunk head tapping screws with pin, Form C	26456	Flat head flange screws
DIN 7983C	Countersunk (Flat) Head Tapping Screws with Cross Recess, form C	26720	Hexagon head flange drilling screws
DIN 7984	Hexagon socket thin head cap screws	26750	Pan head cross recessed drilling screws
DIN 7985	Cross recessed raised cheese head screws	26752	Torx socket lens head drilling screws
DIN 7985	Cross recessed raised cheese head screws with cross recess whole	26754	Flat head flange drilling screws
DIN 7985	Self tapping cross recessed raised cheese head screws with cross recess	27410	Mushroom head rivets
DIN 7989A	Washers for steel constructions	31710	Hexagon head drilling screw with washers
DIN 7990/555	Hexagon head bolts for steel structures with hexagon nuts	31780	Ogee washers
DIN 7991	Hexagon socket countersunk head cap screws	36230	Internal tooth lock washers
DIN 7996	Cross recessed pan head wood screws	36233	Cap nuts (type A)
DIN 8140	Threaded inserts	36239	Cap nuts (type C)
DIN 9021	Plain washers, outer diameter about 3 d	36320	Nord-lock washers
DIN 11024	Spring cotters of a bolt	36322	Overlap washer externals
DIN 15237	Plate screws	37280	Contact washers
DIN 43699	Reinforced contact spring lock washers	37840	Adjusting rings with hexagon set screws
DIN 71412	Taper type grease nipples, short m. Allen, A = cone head straight / axial	37900	Retaining rings for hex screws and nuts
DIN 71752	Clevis joints	38801	Assorted rubber rings
DIN 71802AS	Shackles	38900	Conical spring washers
DIN 74361	Spherical collar nuts, form A	38950	Rubber closed plugs
DIN 82101A	Straight shackles	39660	Linch pins
ISO 4014	Hexagon head bolts with shank	39797	Cotter pin bolts
ISO 4017	Hexagon head bolts with thread up to head	43025	ABA - Hose clamps in two parts
ISO 4032	Hexagon Nuts	43060	Mini hose clamps
ISO7379	Pass-shoulder screws with hexagon socket	43080	Hose clamps
ISO 7380	Hexagon socket button head screws	43110	Metal clip rubber hose clamps
ISO 7380	Socket button head screws	43246	Exhaust hope clamps
ISO 8748	Spiral dowel pins, heavy duty	47710	Book screws
ISO 8750	Spiral-span pins, rule execution	51350	Decoration washers, open model
01050	Hexagon security screws	56660	Hexagonal hoods
01150	Hexagon security nuts	56819	Drive rivet
02140	Hexagon head seat belt mount bolts	56917	Pearl shaped handle with threaded bolts
04400	Hexagon flange bolts metric	56924	Star knobs
06000	Track shoe bolts, caterpillar type.	56931	Knurled screws with threaded bolts
07141	Hexagon socket button head flange screws	56950	Spring plungers with slot
07760	Hexagon head cover cap protectors	56952	Conicals door knobs without latch
09021	Expansion bolts	56954	Hand wheels with foldable handle
09311	Eye expansion bolts	56955	Fixed conical handle
09331	Open cup hook expansion bolts	56956	Tension levers
09511	Expansion anchors	57005	Clamping levers
09610	Expansion anchors	57007	Connection multi system
10010	Expansion bolts, form B	57040	Door knobs with highlights
11396	Spacer nuts, 2 x internal threads.	57063	Cranks with handle
11398	Spacer nuts with threaded pin, internal and external thread	57067	Bridge handles
11400	Hexagon extension nuts - height 3xD	57081	Handle a steering wheels, closed
11401	Round cylindrical extension nuts	57775	Rubber cylindrical shock absorbers, type A
11490	Hexagon safety nuts	60311	Fixing elements, type BC
11560	Slotted countersunk nuts	63158	Expansion anchor wall plugs
12470	Hexagon flange nuts	63200	Frame anchors, type S-RS/T
13000	Hexagon security nuts, full metal options	64010	Thread sleeves , type C
13100	Hexagon security nuts, full metal options, type H100-ESN	69100	Threaded rivets with cylindrical head
		69991	Screw rivets with cylindrical head
		70410	Anchors with expansion bolts
		70610	Chemical fastening mortar blister
		70630	Chemical anchoring threaded rods
		70660	Rivet nails
		70710	Heavy duty anchors type B
		71550	Self cutting threaded inserts type 300
		72005	Self tapping screws with plastic cowl
		72293	Speednuts type SNU

www.rodavigo.net

EN +34 986 288 118 wob@rodavigo.com FEDER

REGISTRATION

B2B ACCESS

rodavigo.net

All Categories Search by keyword or reference



Search by Several Concepts



ALL CATEGORIES

MANUFACTURERS

PDF CATALOGUE

ABOUT RODAVIGO

BLOG

CONTACT

GUIDED SEARCH

About Rodavigo Corporate Video

Corporate Video

We are Rodavigo and we have a history. We were born more than 30 years ago, when the world was very different. Our clients believed in us and in our way of working, so we are committed to continuous innovation and find our place: the world. Today we are the fastest and we are always there, where we are needed.

Our goal is to constantly improve and make available the widest range of products on the market. That is Rodavigo. A big family.



More than 1.8 million references



More than 1500 Manufacturers



Counseling of Experts



International Shipments

Need help?

Leave us your phone number. We call you.

LEAVE YOUR NUMBER



Are you looking for a Specialized Product?

Our professional team can find it for you.

CONTACT

